

Design ID: 313358243692

Estimate ID: 35867

CORREEN DAMMEN

MENARDS

Design & Buy™ DECK

How to purchase at the store

1. Take this packet to any Menards store.
2. Have a building materials team member enter the design number into the Deck Estimator Search Saved Designs page.
3. Apply the design to System V to create the material list.
4. Take the purchase documents to the register and pay.

How to recall and purchase a saved design at home

1. Go to Menards.com.
2. Select the Deck Estimator from the Project Center.
3. Select Search Saved Designs.
4. Log into your account.
5. Select the saved design to load back into the estimator.
6. Add your deck to the cart and purchase.

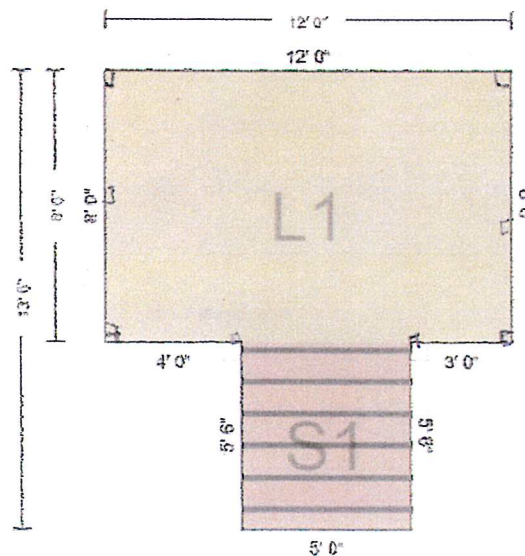

Illustration intended to show general deck size and shape. Some options may not be shown for picture clarity.

Estimated Price: \$1,406.31

**Today's estimated price. Future pricing may go up or down. Tax, labor, and delivery not included.*

Layout dimension sheets are intended as a construction aid. Not all options selected are shown.

Final design should be performed by a registered professional engineer to ensure all applicable building codes and regulations are met. This is an estimate. It is only for general price information. This is not an offer and there can be no legally binding contract between the parties based on this estimate. The prices stated herein are subject to change depending upon the market conditions. The prices stated on this estimate are not firm for any time period unless specifically written otherwise on this form. The availability of materials is subject to inventory conditions. MENARDS IS NOT RESPONSIBLE FOR ANY LOSS INCURRED BY THE GUEST WHO RELIES ON PRICES SET FORTH HEREIN OR ON THE AVAILABILITY OF ANY MATERIALS STATED HEREIN. All information on this form, other than price, has been provided by the guest. Menards is not responsible for any errors in the information on this estimate, including but not limited to quantity, dimension and quality. Please examine this estimate carefully. MENARDS MAKES NO REPRESENTATIONS, ORAL, WRITTEN OR OTHERWISE THAT THE MATERIALS LISTED ARE SUITABLE FOR ANY PURPOSE BEING CONSIDERED BY THE GUEST. BECAUSE OF THE WIDE VARIATION IN MATERIALS, THERE ARE NO REPRESENTATIONS THAT THE MATERIALS LISTED HEREIN MEET YOUR CODE REQUIREMENTS.



All Pro Maintenance

Travis Falcon

Cell 605.222.5305

Rapid City, SD

L1 - Deck Boards and Treads

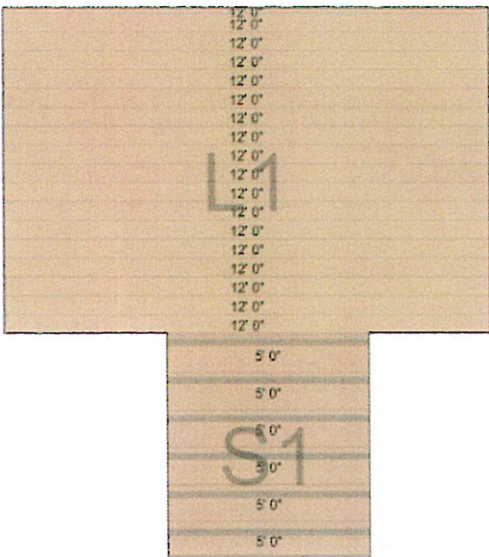

Lengths displayed are provided as general guide. The deck board lengths and/or quantities may need to be adjusted based on framing or the deck board splice pattern you prefer. Please confirm deck board lengths estimated and quantities prior to the start of your project.

Deck Board

Length	Count
12' 0"	18

Tread

Length	Count
S1 5' 0"	6

L1 - Stair Framing

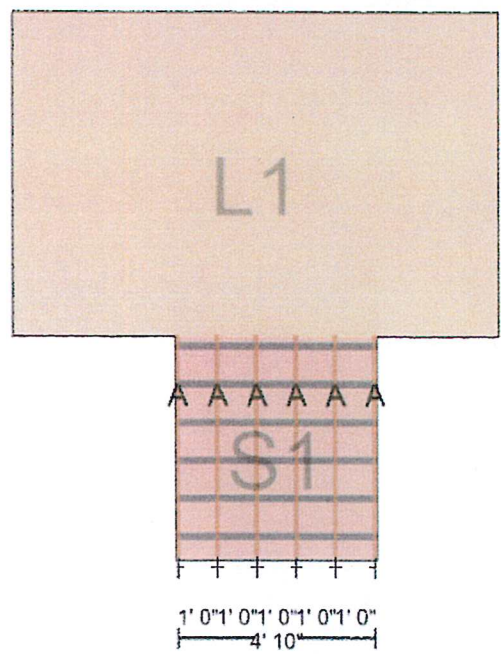

S1 - Stringer

Label	Length	Count
A	5' 9"	6

Deck Hardware

See back for additional
installation images

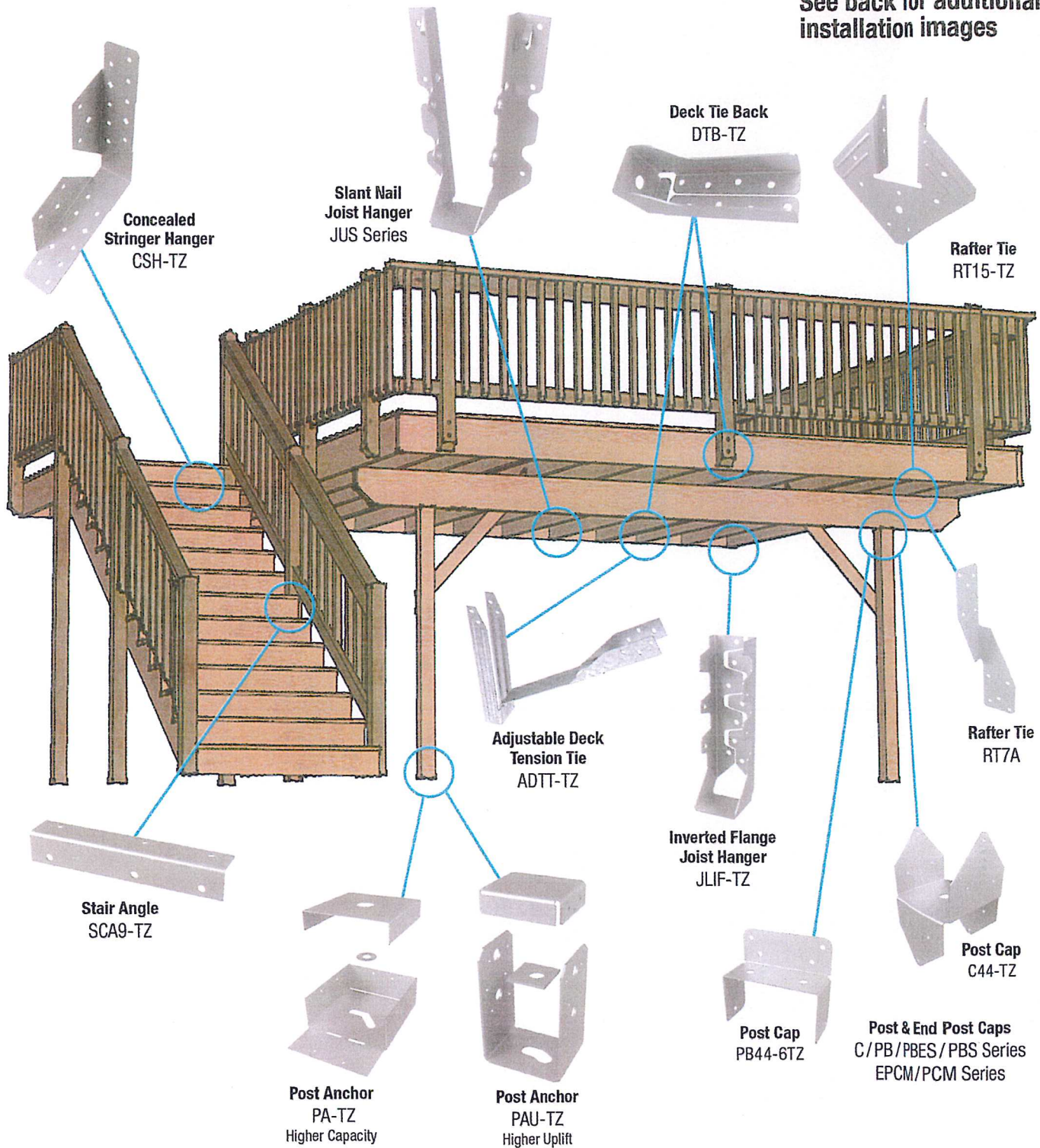

Disclaimer: Some of the products displayed
are optional and not estimated

Customer Service 1-800-328-5934 • **MiTek-US.com**

©2018 MiTek Industries, Inc. All Rights Reserved.

Deck Hardware Installation

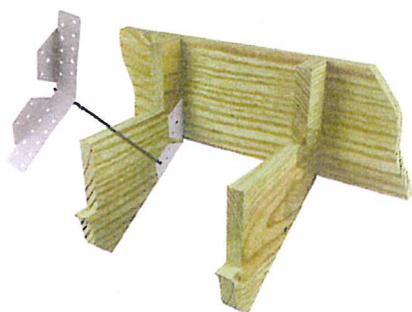

Typical CSH-TZ installation

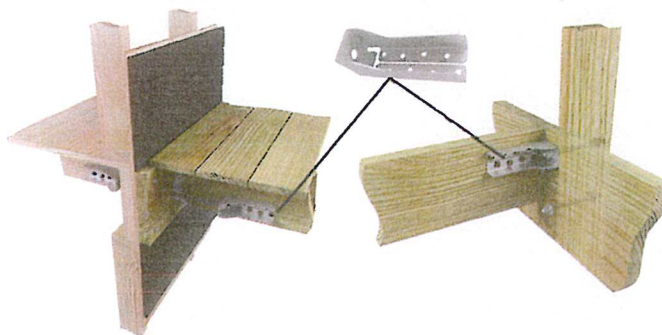

Typical DTB-TZ installations

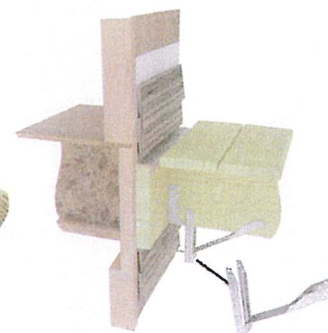

Typical ADTT-TZ installation

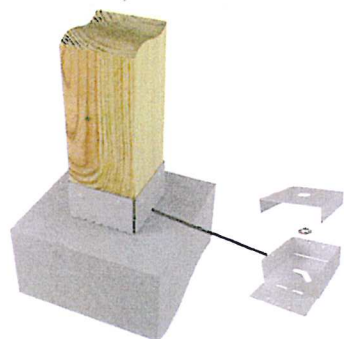

Typical PA-TZ installation

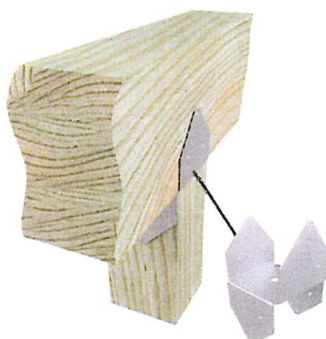

Typical C44-TZ installation

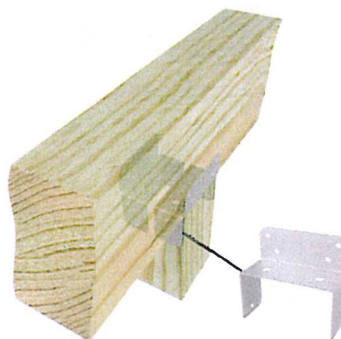

Typical PB44-6TZ installation

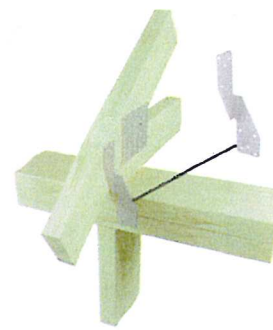

Typical RT7A installation

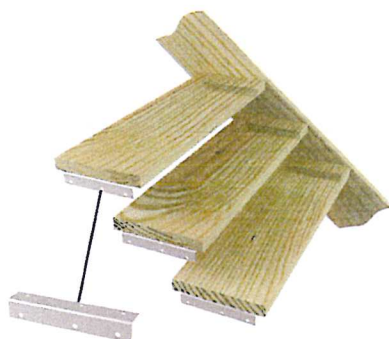

Typical SCA9-TZ installation

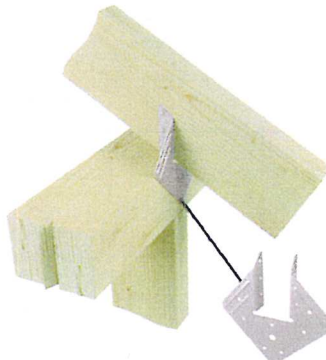

Typical RT15-TZ installation

The type and quantity of fasteners used to install MiTek USP products is critical to connector performance. MiTek has a full range of structurally-rated fasteners for wood frame structures. Hot-dip galvanized, stainless steel, and Gold Coat corrosion resistant finishes are available for exterior applications.

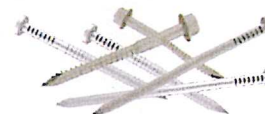

MiTek USP Deck Hardware is available in Triple Zinc (TZ) and Gold Coat (GC).



TZ galvanizing provides a prefabrication coating of 1.85 (G-185) ounces of zinc per square foot of surface area (both sides) measured in accordance with ASTM A 653. Use with Hot-dip galvanized fasteners.

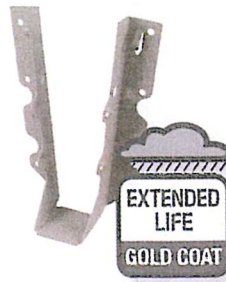

Gold Coat is a proprietary multi-layer protection system. It is comprised of an organic top coat barrier layer and a zinc layer placed over a steel substrate. Use with Gold Coat or Hot-dip galvanized fasteners.

Design ID: 313358243692
Estimate ID: 35867

MENARDS
Design & Buy™ DECK

L1

Height off the ground: 4' 0" *46 inches -*
Width: 12' 0"
Length: 8' 0"

S1

Height off the ground: 4' 0" *46 inches*
Width: 5' 0"
Length: 5' 6"

Decking

Deck Board Material Type: AC2 CedarTone Treated
Deck Board: 5/4x6 Premium Decking
Deck Board Fastener: 6-Lobe Drive Tan Premium Exterior Deck Screw

Framing

Framing Material Type: AC2 CedarTone Treated
Joist: 2x8
Joist Spacing: 16" On Center
Beam: 2x8
Framing Post: 4x4 Framing Post
Framing Fastener Type: Galvanized Framing Fastener
Footing: 4x4/6x6 Deck Block
Joist Hanger Type: Galvanized Joist Hanger
Joist Hanger Fastener Type: Joist Hanger Fastener Nail

Railing

Railing Material Type: No Railing

Additional Options

Deck Flashing: No Rolled Joist Flashing
Lattice/Skirting: None
Underdecking: No Underdecking

L1 - Beams

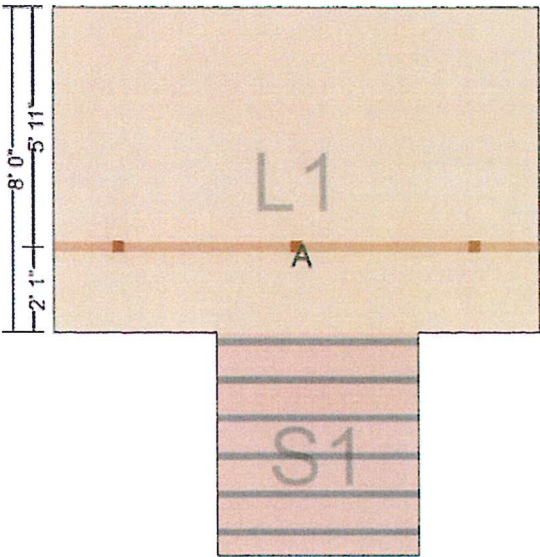

2 boards nailed together is 2 ply

L1 - Lumber: 2 ply - 2 x 8 CedarTone

Label	Length	Count
A	12' 0"	1

L1 - Joists

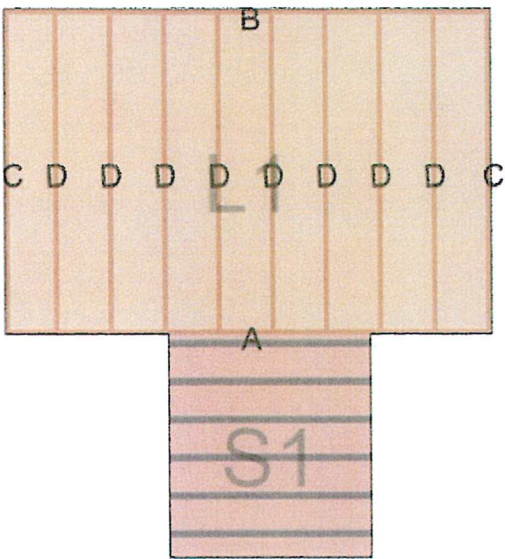

Lumber: 2 x 8 CedarTone

Joist Spacing: 16" on center

Label	Length	Count	Usage
A	12' 0"	1	Rim Joist
B	12' 0"	1	Ledger Joist
C	7' 9"	2	Rim Joist
D	7' 9"	8	Internal Joist

Design ID: 313358243692

Estimate ID: 35867

CORREEN DAMMEN

MEVARDS

Design & Buy™ DECK

L1 - Posts and Footings

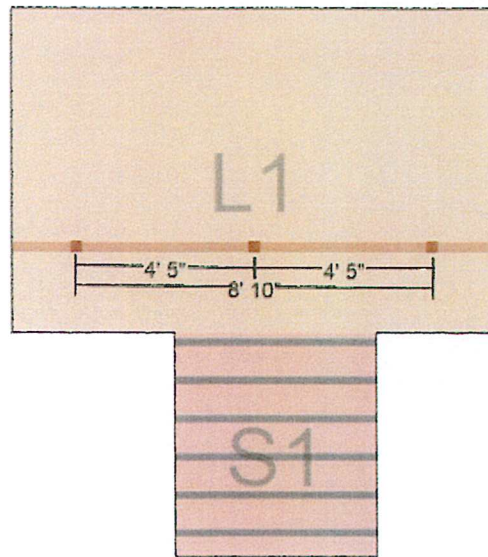

Dimensions displayed are from center of post to center of post.

Railing - for Deck + Steps.

8 - 4x4 x 54" Handrailing Posts

4 - 2x4 x 8'

2x4 handrail covers 8' lengths

20' sticks of 3/4 Rebar (20' will do 6' panels)