

PUBLIC ACCESS AND UTILITY EASEMENT

LOT 1 OF THE DAYS OF '76 TRACT,
FORMERLY THE DAYS OF '76 TRACT BEING A PORTION OF M.S. 569,
ALL LOCATED IN THE NE 1/4 OF SECTION 23, T5N, R3E BHM
CITY OF DEADWOOD, LAWRENCE COUNTY, SOUTH DAKOTA

LEGEND

- FOUND PROPERTY MONUMENT
- PROPERTY AS DESCRIBED
- - - PROPERTY LINE
- - - LOT LINE
- ▨ PROPOSED ACCESS AND UTILITY EASEMENT THIS DOCUMENT

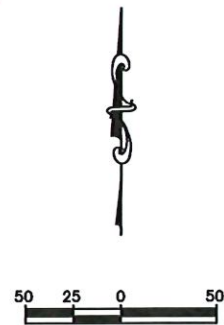
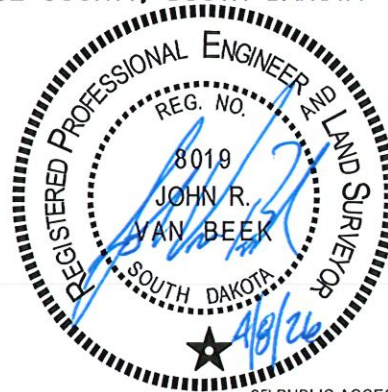

PUBLIC ACCESS AND UTILITY EASEMENT (THIS EXHIBIT) CONTAINING 11,979 SQ FT ±

CITY OF DEADWOOD
LOT A REVISED OF M.S. 840 AND M.S. 569

25' PUBLIC ACCESS AND UTILITY EASEMENT
DOC. NO. 1978-00866
DOC. NO. 2013-02127

20' POWER EASEMENT
DOC. NO. 2007-03023

5' DRAINAGE AND UTILITY EASEMENT
DOC. NO. 2010-01329

25' SEWER EASEMENT
DOC. NO. 1978-00786

DEADWOOD DAYS OF '76, INC.
LOT 1 OF THE DAYS OF '76 TRACT

25' PUBLIC ACCESS AND UTILITY EASEMENT
DOC. NO. 2013-02127

CITY OF DEADWOOD
DEADWOOD AMUSEMENT PARK TRACT

CITY OF DEADWOOD
LOT 2 OF THE DAYS OF '76 TRACT

LINE TABLE

LINE #	DIRECTION	L (FT)
L1	N78°47'34"E	86.63
L2	S75°46'53"W	41.14
L3	S73°39'25"W	156.59
L4	S41°29'35"E	64.54

CURVE TABLE

CURVE #	DELTA ANGLE	R (FT)	L (FT)	CHORD BEARING	LC (FT)
C1	20°12'12"	38.33	13.52	N88°53'40"E	13.45
C2	138°20'46"	52.67	127.18	N29°49'23"E	98.46

NOTE:
BEARINGS REFERENCED TO SOUTH DAKOTA STATE PLANE, NORTH ZONE, NAD83(2011).
DISTANCES ARE GRID DISTANCES.
PROJECT SCALE FACTOR = 0.999795111

P:\26-106\AutoCAD\Figures\Days_of_'76_EXHIBIT_A.dwg 04-8-26



EXHIBIT A