

ELEVATION

SIGN
1



SCOPE OF WORK:

Remove and discard existing sign.
Patch holes. Paint wall area seam to seam.
Manufacture & install new non-illuminated channel letters.
Remove and discard existing awning.
Replace all 4 metal RAB brand shade cans on gooseneck lights.

It is the sign installers responsibility
to connect the new sign to the
existing electrical at the time of install.

PAINTING SCOPE OF WORK:

Paint roof trim & goose neck lamps
left side red & right side green as shown.

 Red - SW 2911 Pompeii Red
 Green- SW 6925 Envy Green

EXISTING



PROPOSED



Address _____
#10984
124 Sherman Street
City _____ Deadwood,
State _____ SD 57732-1309

Account Representative:
Kristy Ewell

This design and engineering is
submitted as our proposal, and
the right to use or exhibit in any
form, is not authorized without
written permission by Vixxo.

Notes

*
*
*
*
*

Designer _____ Peter Cardinal
Design # _____ Vx1103117 R2
Original Date _____ 8/23/22
Revision Date _____ 9/12/22

All electrical scope to be completed in a U.L. approved
method and shall meet current N.E.C. standards



* All electrical components shall be U.L. Listed.
* Sign shall be grounded per N.E.C. Article 250.
* Insulated conductors as per N.E.C. Code 310.8.
type to be used - metallic insulated sealtite.
* Disconnect switch as per N.E.C. Code 600.6.



sign & lighting

page 5

The purchaser agrees to hold the seller harmless against
any cause for action for damages which may occur as a
result of drilling for piers and foundations, including but not
limited to sewer, gas lines or any underground obstacles
which the purchaser or others may deem valuable.

SIGN
1

71 sq/ft

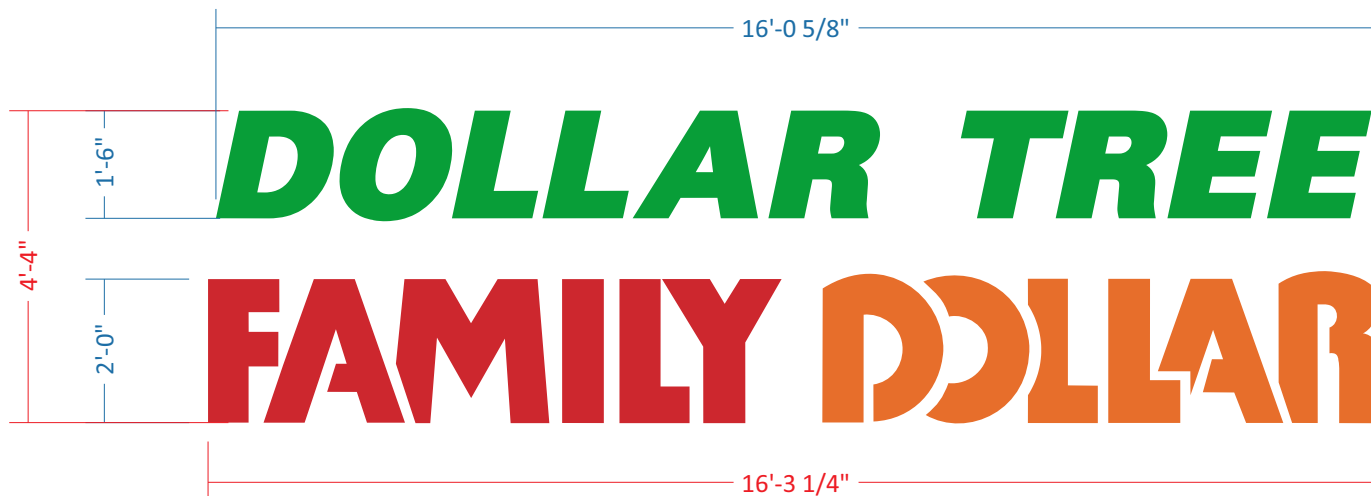

SPECIFICATION

- 1 3" DEEP FABRICATED ALUMINUM LETTER
PAINTED AS SHOWN
- 2 NON-CORROSIVE INSTALLATION HARDWARE

- Green- SW 6925 Envy Green
- Red - SW 2911 Pompeii Red
- Orange - paint to match Pantone 166c

SECTION DETAIL

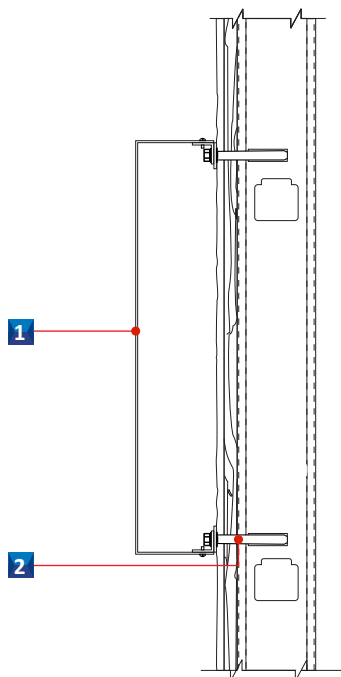

MOUNTING DETAILS

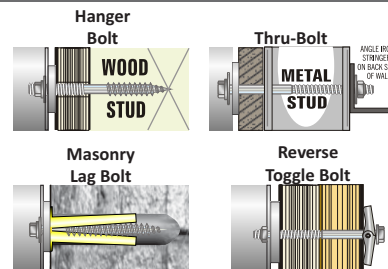

*All Hardware to be
Galvanized and Non Corrosive

DOLLAR TREE **FAMILY DOLLAR**

Address _____
#10984
124 Sherman Street
City _____ Deadwood,
State _____ SD 57732-1309

Account Representative:
_____ Kristy Ewell

This design and engineering is submitted as our proposal, and the right to use or exhibit in any form, is not authorized without written permission by Vixxo.

Notes

*
*
*
*
*

Designer _____ Peter Cardinal
Design # _____ Vx1103117 R2
Original Date _____ 8/23/22
Revision Date _____ 9/12/22

All electrical scope to be completed in a U.L. approved method and shall meet current N.E.C. standards



* All electrical components shall be U.L. Listed.
* Sign shall be grounded per N.E.C. Article 250.
* Insulated conductors as per N.E.C. Code 310.8.
type to be used - metallic insulated sealite.
* Disconnect switch as per N.E.C. Code 600.6.



sign & lighting

page 6



The purchaser agrees to hold the seller harmless against any cause for action for damages which may occur as a result of drilling for piers and foundations, including but not limited to sewer, gas lines or any underground obstacles which the purchaser or others may deem valuable.

ELEVATION



SCOPE OF WORK:

Remove & dispose of (2) two existing sign faces.
Manufacture & install (2) two new sign faces.
Split-paint cabinet SW2911 red & SW6925 green,
corresponding with face.
Paint pole(s) SW7037 balanced beige.

	Red - SW 2911 Pompeii Red
	Green- SW 6925 Envy Green
	SW-7037 Balanced Beige

NOTE :
NEW SOLID WOOD SPHERE POST CAP ARE NEEDED.

PROPOSED



EXISTING



Address _____
#10984
124 Sherman Street
City _____ Deadwood,
State _____ SD 57732-1309

Account Representative:
Kristy Ewell

This design and engineering is submitted as our proposal, and the right to use or exhibit in any form, is not authorized without written permission by Vixxo.

Notes

*
*
*
*
*

Designer _____ Peter Cardinal
Design # _____ Vx1103117 R2
Original Date _____ 8/23/22
Revision Date _____ 9/12/22

All electrical scope to be completed in a U.L. approved method and shall meet current N.E.C. standards



* All electrical components shall be U.L. Listed.
* Sign shall be grounded per N.E.C. Article 250.
* Insulated conductors as per N.E.C. Code 310.8 type to be used - metallic insulated sealtite.
* Disconnect switch as per N.E.C. Code 600.6.



sign & lighting

page 7

The purchaser agrees to hold the seller harmless against any cause for action for damages which may occur as a result of drilling for piers and foundations, including but not limited to sewer, gas lines or any underground obstacles which the purchaser or others may deem valuable.

Aluminum Face Layout

Scale 1'=1"



Double Sided



Address _____
 _____ #10984
 _____ 124 Sherman Street
 City _____ Deadwood,
 State _____ SD 57732-1309

Account Representative:
 _____ Kristy Ewell

This design and engineering is submitted as our proposal, and the right to use or exhibit in any form, is not authorized without written permission by Vixxo.

Notes

*
 *
 *
 *
 *

Designer _____ Peter Cardinal
 Design # _____ Vx1103117 R2
 Original Date _____ 8/23/22
 Revision Date _____ 9/12/22

All electrical scope to be completed in a U.L. approved method and shall meet current N.E.C. standards



* All electrical components shall be U.L. Listed.
 * Sign shall be grounded per N.E.C. Article 250.
 * Insulated conductors as per N.E.C. Code 310.8.
 type to be used - metallic insulated sealtite.
 *Disconnect switch as per N.E.C. Code 600.6.

ACM Face Specifications

- ☐ Substrate - White .125" aluminum
- ☒ 3M 7125-63
- ☒ 3M 7125-44
- ☒ 3M 50-745



sign & lighting

page 8

The purchaser agrees to hold the seller harmless against any cause for action for damages which may occur as a result of drilling for piers and foundations, including but not limited to sewer, gas lines or any underground obstacles which the purchaser or others may deem valuable.