

FULL SIZE PLOT 11X17 COLOR

P:\25-149\AUTOCAD\PLANSHEETS\25-149SITE_LAYOUT.DWG

6/18/2026

Grading Callouts

- | | | | |
|---|---|---|---|
| 1. N = 218170.84
E = 993938.29
Elev = 4573.12 | 3. N = 218206.66
E = 993965.12
Elev = 4572.35
TT | 5. N = 218240.28
E = 993990.30
Elev = 4571.39
BT | 7. N = 218261.40
E = 994006.06
Elev = 4570.85 |
| 2. N = 218186.48
E = 993949.98
Elev = 4572.77 | 4. N = 218224.29
E = 993978.29
Elev = 4571.87
BT | 6. N = 218246.68
E = 993995.10
Elev = 4571.20
TT | |

Surface Callout Acronyms

All grading callouts are to edge of pavement unless otherwise noted.
 All sidewalk callouts are to edge of sidewalk unless otherwise noted.
 BT - Bottom of Taper
 TT - Top of Taper

PROPOSED LEGEND

- ⊙ Sanitary Sewer Cleanout
- Curb Stop
- Sanitary Sewer Service
- Water Service
- Proposed Property Line

Striping Legend

- | | |
|---|--|
| 4
WT Thermoplastic Pavement Marking, 4" White | 4
YP High Build Waterborne Pavement Marking Paint, 4" Yellow |
| 12
WT Thermoplastic Pavement Marking, 12" White | 12
YP High Build Waterborne Pavement Marking Paint, 12" Yellow |

SURFACING LEGEND

- 5" Asphalt Concrete Composite 6" Base Course
- 6" Reinforced PCC Pavement, on 4" Aggregate Base Course
- 4" Nonreinforced Sidewalk, on 2" Aggregate Base Course
- Buildings Moved By Owner

NOT FOR CONSTRUCTION

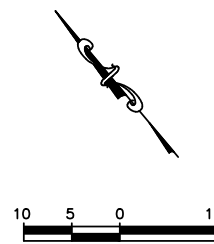

Building Corner Locations		390	
A.	N = 218196.94 E = 994009.21		
B.	N = 218174.16 E = 994031.81		
C.	N = 218171.75 E = 994029.38		
D.	N = 218163.24 E = 994037.83		
E.	N = 218180.62 E = 993992.77		
F.	N = 218174.94 E = 993998.41		
G.	N = 218170.01 E = 993993.44		
H.	N = 218152.92 E = 994010.40		
I.	N = 218155.48 E = 994012.99		
J.	N = 218146.97 E = 994021.44		

Building Corner Locations		388	
A.	N = 218165.87 E = 993983.46		
B.	N = 218142.32 E = 994002.61		
C.	N = 218144.43 E = 994004.73		
D.	N = 218135.25 E = 994012.44		
E.	N = 218133.84 E = 994011.02		
F.	N = 218104.19 E = 994043.26		
G.	N = 218149.00 E = 993966.39		
H.	N = 218127.78 E = 993987.45		
I.	N = 218128.48 E = 993988.16		
J.	N = 218088.70 E = 994027.64		

Building Corner Locations		306	
A.	N = 218164.16 E = 994105.32		
B.	N = 218149.86 E = 994119.78		
C.	N = 218142.56 E = 994083.94		
D.	N = 218128.25 E = 994098.39		

Building Corner Locations		390 1/2	
A.	N = 218127.47 E = 994079.08		
B.	N = 218103.55 E = 994103.24		
C.	N = 218094.13 E = 994093.92		
D.	N = 218097.12 E = 994090.90		
E.	N = 218106.15 E = 994057.98		
F.	N = 218085.22 E = 994079.12		

Building Corner Locations		308	
A.	N = 218219.69 E = 994044.01		
B.	N = 218192.99 E = 994073.95		
C.	N = 218202.98 E = 994029.10		
D.	N = 218176.27 E = 994059.04		

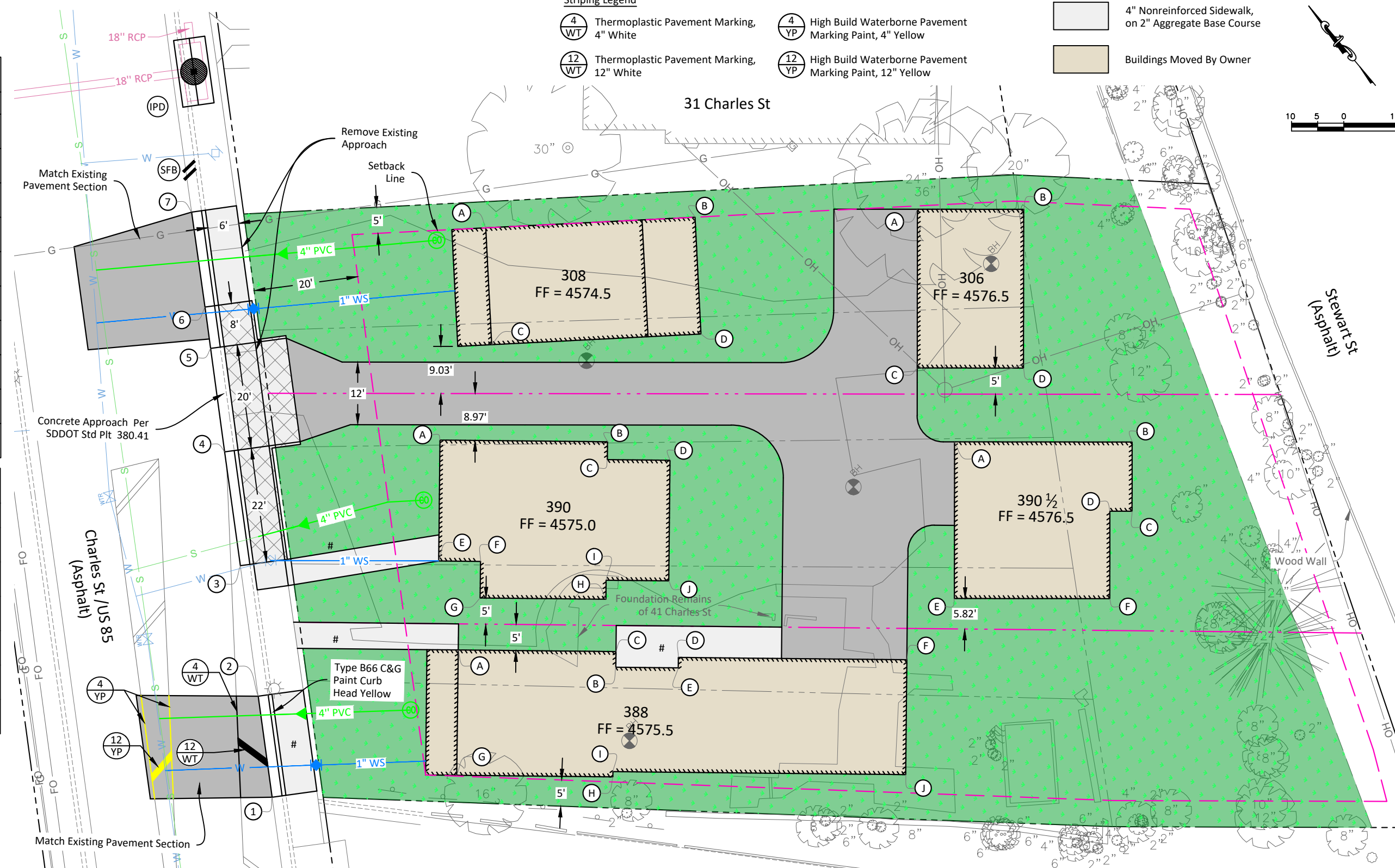

Consulting Firm:
 Consultant Project No: J25-149
 Designed By: JRV
 Drawn By: IMM, BDH



No.	Date	By	Revision Description

Optima, LLC

Replat of Charles Street Lots
 Relocated Main Street Buildings
 Deadwood, South Dakota

Site Layout

Sheet No.
 5