

Dimensioning Explanation/Door & Window Sizing Description:

All Exterior Dimensions Are From Outside Of Framing To Outside Of Framing/All Interior Dimensions Are From Edge Of Framing To Edge Of Framing/All Exterior Foundation Walls Dimensioned From Outside Of Foundation Wall To Outside Of Foundation Wall/All Interior Dimensions Are From The Inside Edge Of The Concrete Foundation Wall To Edge Of Interior Wall Framing Or From Edge Of Framing To Edge Of Framing/Interior Bearing Walls Are Represented By Solid Walls. Door Labels Are Specified By 3068 Which Translates To 3'-0" x 6'-8", Window Labels Are Specified By 2040 Which Translates To 2'-0" x 4'-0". Foundation Walls Include a 1" Air Gap Between Foundation & Stud Per Code.

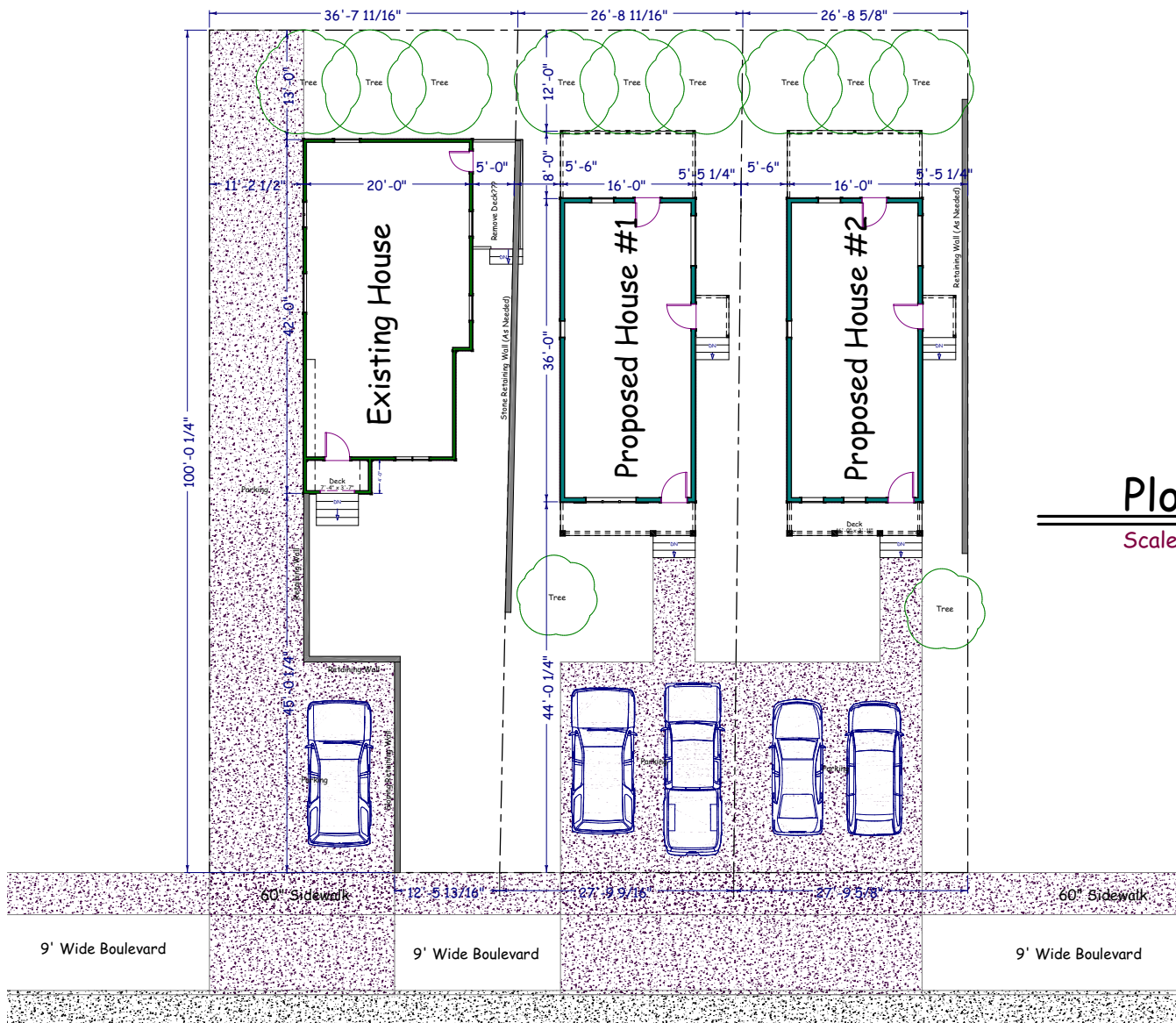

Plot Plan
 Scale: 1"=20'-0"

Inline Designs, Inc
 Shawn Whitney - Owner
 Bismarck, North Dakota
 (email) inlinedesign@msn.com
 (cell) 701-214-3311

Client Name & Address:
 Deadwood Cabins - 2026
 59 & 61 Lincoln Avenue
 Plans Drawn For: FTH General

**Inline
 Designs Inc.**
 701-214-3311

Date Published
 5/12/2026

Disclaimer For Plans Designed:
 The plans and elevations are only conceptual and give the client an example of what is to be built. A contractor or an Architect is responsible for verifying the dimensions and other information on these plans. Verify all local building codes. All plot plans to be verified by an engineer for setbacks and easements. Property contours and stepped foundation walls may be different from that shown on plans. Stone, siding types, and exterior materials have to be verified by the contractor and may "NOT" be included in the estimate of the house. Inline Designs cannot be held responsible for inaccurate information that may lead to additional cost for the owner or a delay in the project.