



# DICKINSON STATE UNIVERSITY



Ag/Tech Renovation Project

---

**Telephone**  
701-483-2486

**Address**  
291 Campus Drive  
Dickinson, ND 58601

**Website**  
[www.dickinsonstate.edu](http://www.dickinsonstate.edu)

# ECONOMIC IMPACT

## DSU AND THE COMMUNITY

### 01 Student Population

- Over 1,100 students in the city of Dickinson
- 300 in resident halls
- 800 in apartments and homes
- \$12,535\* in annual economic impact per student
- \$796,000 in annual student-generated state and local taxes

### 02 DSU Activities Economic Impact

- Overall economic impact \$85.8 million annually
- 80+ Sporting events a year
- Camps hosting 1,000+ students from the region
- Partnerships with area schools to provide college level classes to juniors and seniors
- Primary educational partner with the Theodore Roosevelt Presidential Library (anticipated 280,000 visitors per year)



### 03 Agriculture and Rodeo Renovation

- Potential events:
- Indoor Rodeos
  - Clinics/Schools
  - Ag Based Programing
  - Entertainment

## Updating Existing Ag Building (Base Bid)

### Overall Project:

**Thinner Black Line:** Base bid of \$18 million

**Bold Black Line:** Alternates at \$25 million

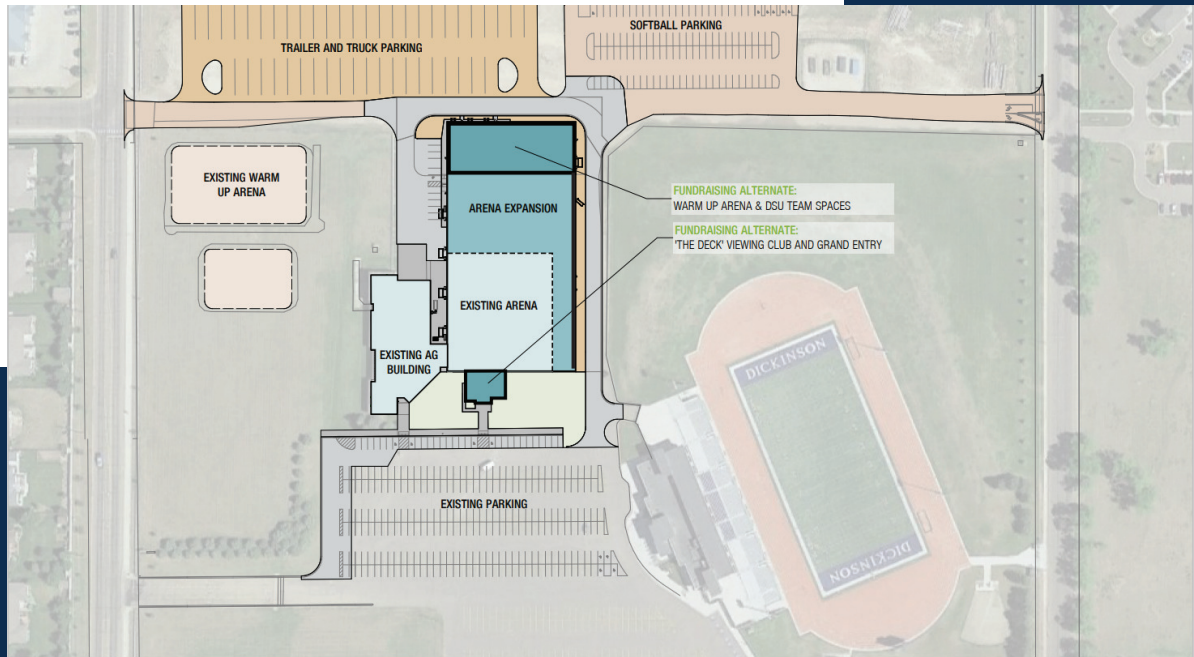

### DSU AG BUILDING AND INDOOR ARENA SITE PLAN

FEBRUARY 24, 2024 | JLG 23183 | © 2024 JLG ARCHITECTS



## OPTION #2 - EXTERIOR VIEW \$25M

The exterior view for the \$25M renovation  
of the DSU Indoor Arena.

- Complete main lobby with viewing deck and conference room
- Indoor practice area and indoor livestock stalls
- Complete exterior renovation



DSU AG BUILDING AND INDOOR ARENA  
EXTERIOR VIEW - FUNDRAISING ALTERNATE  
FEBRUARY 24, 2024 | 8:02 20183 | © 2024 JLG ARCHITECTS



# OPTION #2 - \$25M

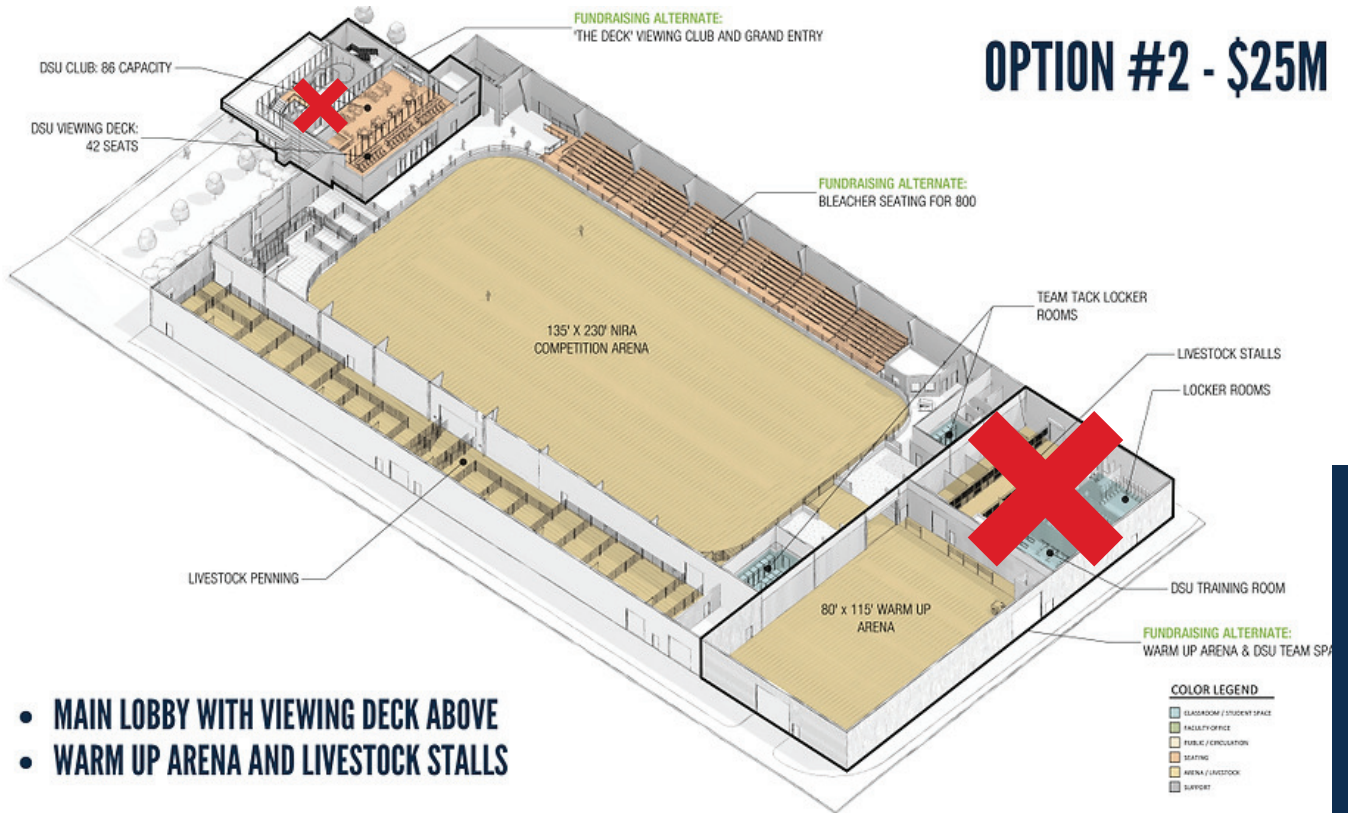

- MAIN LOBBY WITH VIEWING DECK ABOVE
- WARM UP ARENA AND LIVESTOCK STALLS



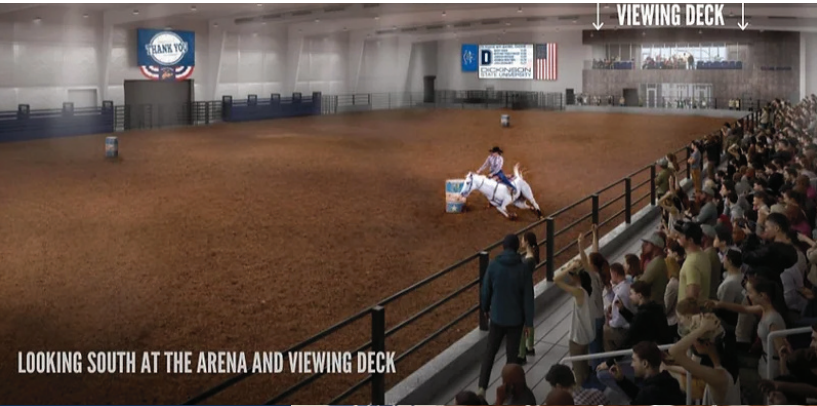

LOOKING SOUTH AT THE ARENA AND VIEWING DECK



INSIDE THE VIEWING DECK THAT HAS A CAPACITY OF 150



MAIN LOBBY AREA WITH VIEWING DECK ABOVE

OPTION #2 -  
INTERIOR DETAILS (\$25M)

Universal adult changing area.

- Provides an accessible bathtub, ceiling track lift system, shower, adult changing table, in addition to the standard restroom amenities.

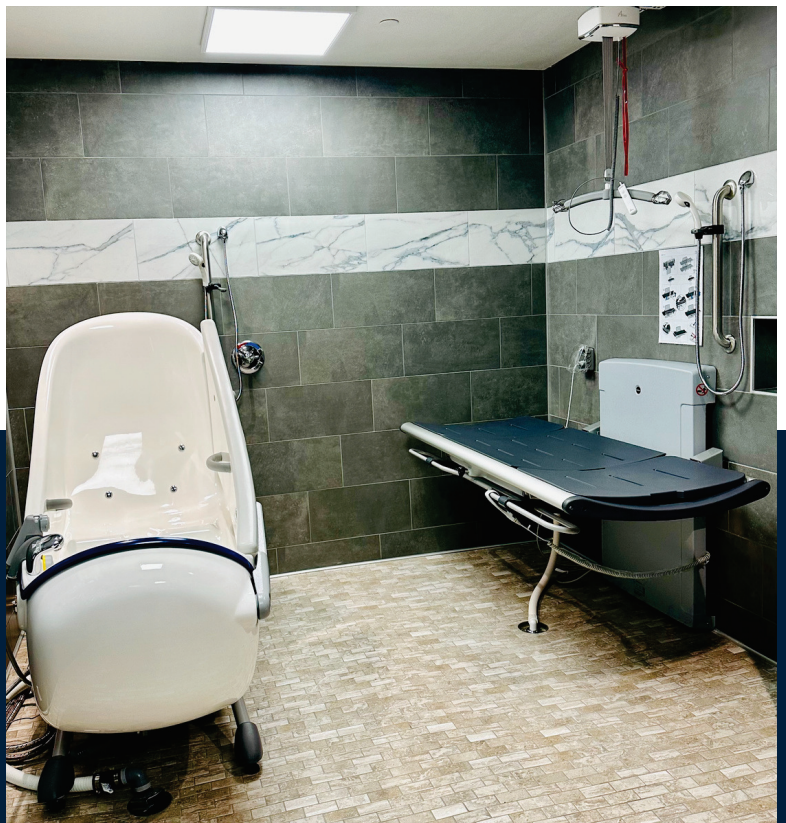

**D** DICKINSON<sup>®</sup>  
STATE UNIVERSITY

DSU HERITAGE  
*Foundation*

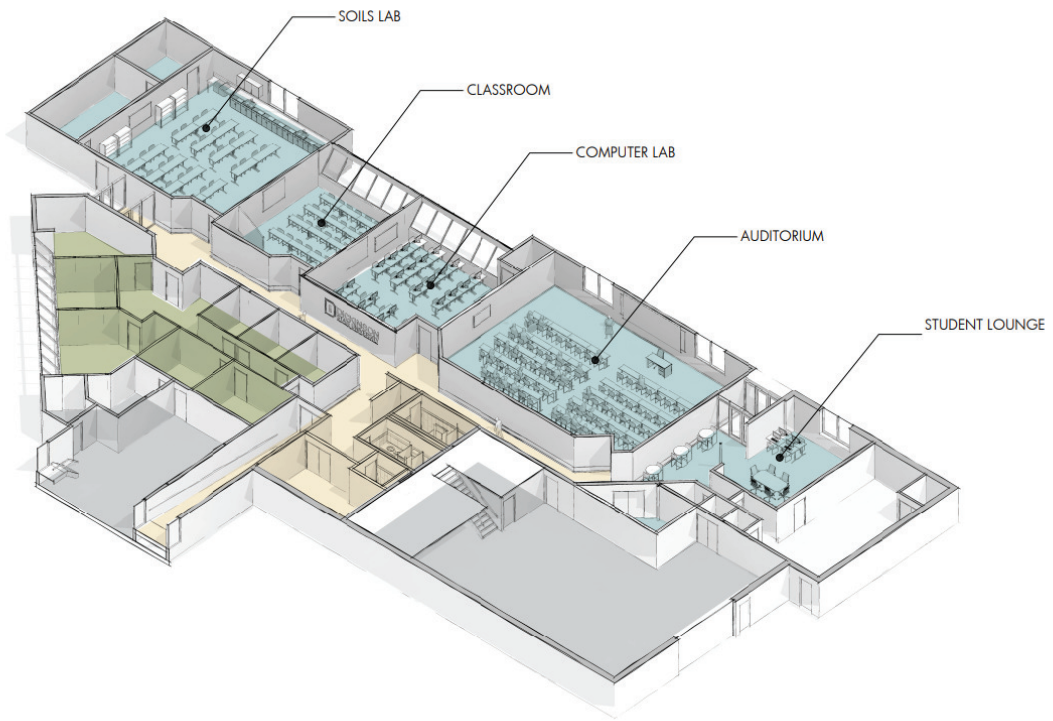

**COLOR LEGEND**

<span style="color: #4682B4;">■</span>	CLASSROOM / STUDENT SPACE
<span style="color: #6AA84F;">■</span>	FACULTY OFFICE
<span style="color: #D9EAD3;">■</span>	PUBLIC / CIRCULATION
<span style="color: #F4B084;">■</span>	SEATING
<span style="color: #F79646;">■</span>	ARENA / LIVESTOCK
<span style="color: #A6A6A6;">■</span>	SUPPORT

# DSU AG BUILDING AND INDOOR ARENA

## AG CLASSROOM BUILDING - AXON PLAN

FEBRUARY 24, 2024 | JLG 23183 | © 2024 JLG ARCHITECTS







## COMMUNITY DEVELOPMENT

- Renovation of a facility for DSU and community
- Serving the community need for an indoor riding arena
- Providing educational space for training

### EXAMPLE COMMUNITY SCHEDULE

\*Estimated DSU daily practice 2-7PM (MST)

MONDAY - Community Barrel Racing Practices

TUESDAY - Community Team Roping Practices

WEDNESDAY - Training With DSU Rodeo Team

THURSDAY - \*Open Ride or Community Event

FRI - SUN - \*Open Ride or Community Event



With this facility, our community could host 20+ spectator rodeo, equine, or other performances and events annually.

The additional warm-up space provides potential for other DSU and community events.

## OPTION #1 - EXTERIOR VIEW \$18M

The exterior view of the \$18M renovation for the DSU Indoor Arena.

- No main lobby
- No practice area or indoor livestock stalls
- No enclosed roughstock area
- Existing siding remains



DSU AG BUILDING AND INDOOR ARENA  
EXTERIOR VIEW - BASE BID DESIGN

FEBRUARY 24, 2024 | 450 271810 | © 2024 JLG ARCHITECTS



## OPTION #1 - EXTERIOR VIEW \$18M

The exterior view for the \$18M renovation for the DSU Agriculture Building.



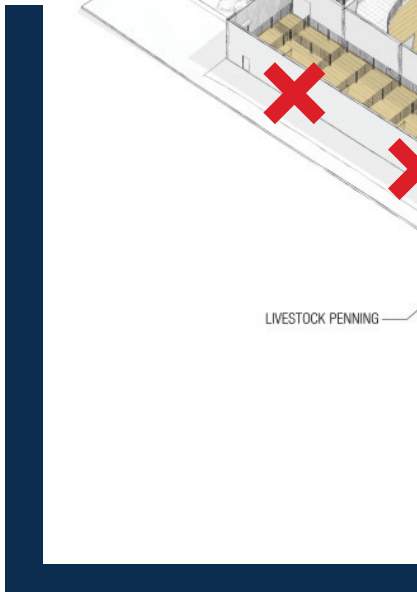
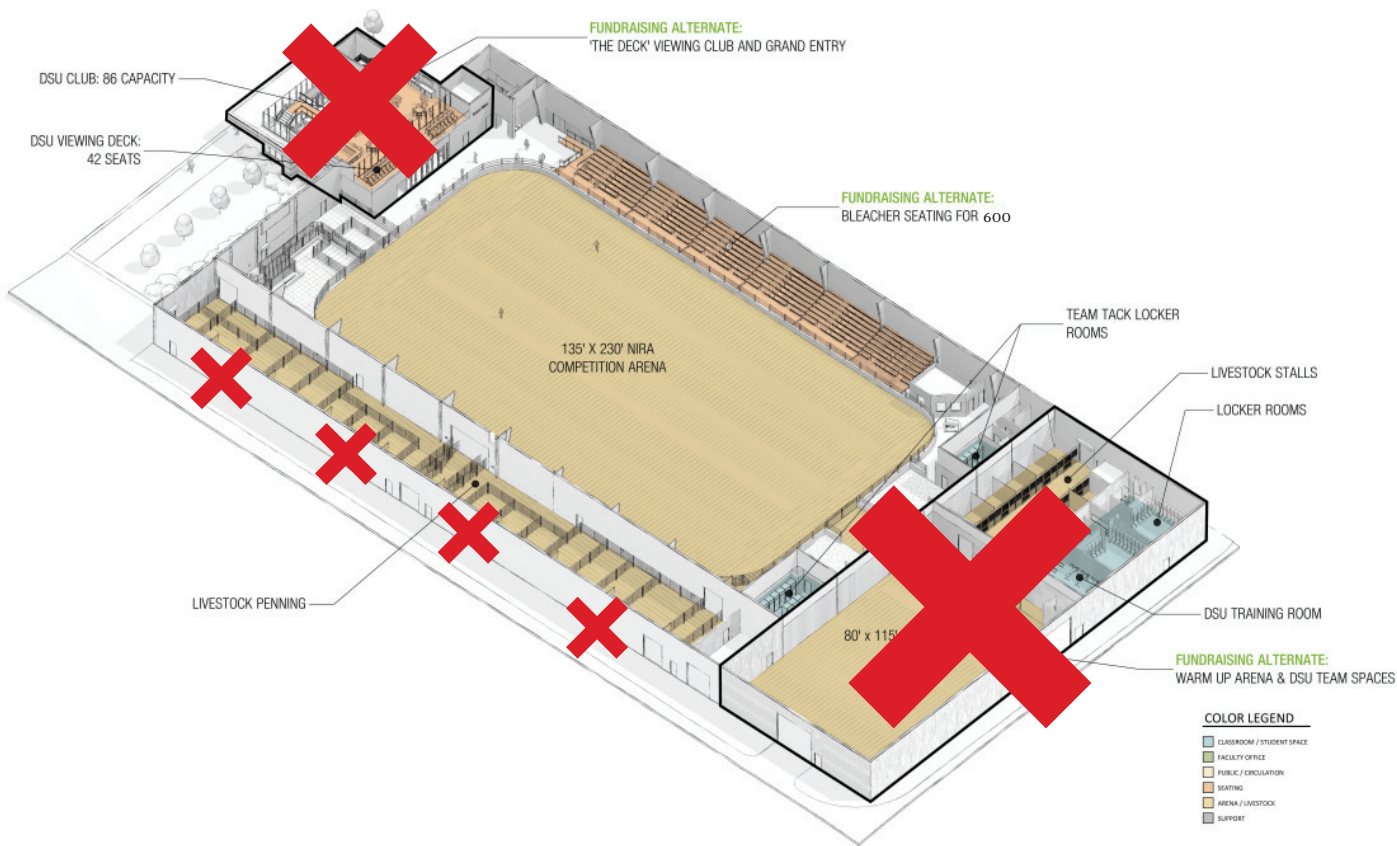

# ANNUAL EXPENSE BREAK DOWN



- 1 FTE- \$60,000
- INDOOR MAINTENANCE OF ARENA - \$25,000
- PER SQUARE FOOT OPERATION -
- EQUIPMENT EXPENSES - \$20,000

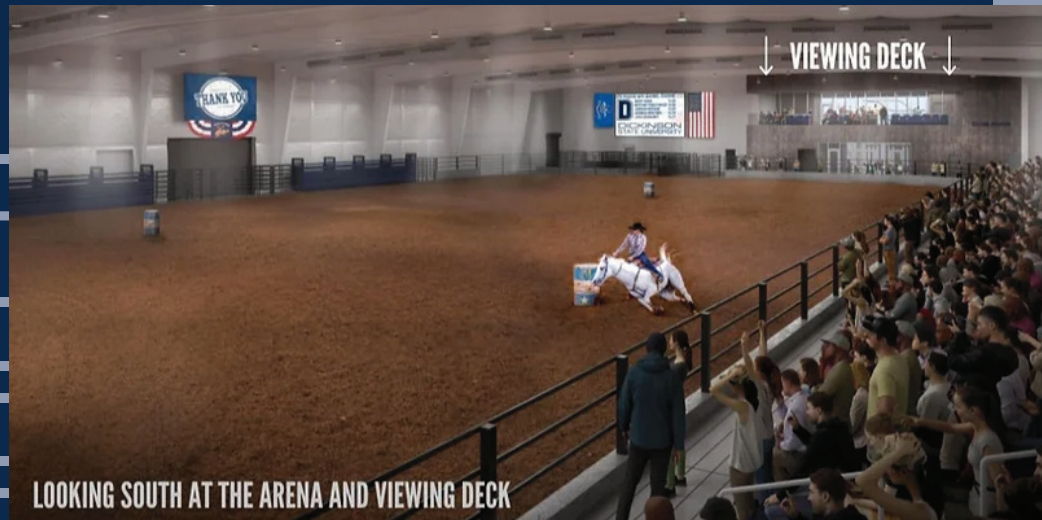



**THANK YOU**

