

# DICKINSON STATE UNIVERSITY



---

**Telephone**

701-483-2486

**Address**

291 Campus Drive  
Dickinson, ND 58601

**Website**

[www.dickinsonstate.edu](http://www.dickinsonstate.edu)

# ECONOMIC IMPACT

## DSU AND THE COMMUNITY

01

### Student Population

- Over 1,100 students in the city of Dickinson
- 300 in resident halls
- 800 in apartments and homes
- \$12,535\* in annual economic impact per student
- \$796,000 in annual student-generated state and local taxes

02

### DSU Activities Economic Impact

- Overall economic impact \$85.8 million annually
- 80+ Sporting events a year
- Camps hosting 1,000+ students from the region
- Partnerships with area schools to provide college level classes to juniors and seniors
- Primary educational partner with the Theodore Roosevelt Presidential Library (anticipated 280,000 visitors per year)

03

### Agriculture and Rodeo Renovation

- Potential events:
- Indoor Rodeos
  - Clinics/Schools
  - Ag Based Programing
  - Entertainment



# Updating Existing Ag Building (Base Bid)

## Overall Project:

**Thinner Black Line:** Base bid of \$18 million

**Bold Black Line:** Alternates at \$25 million

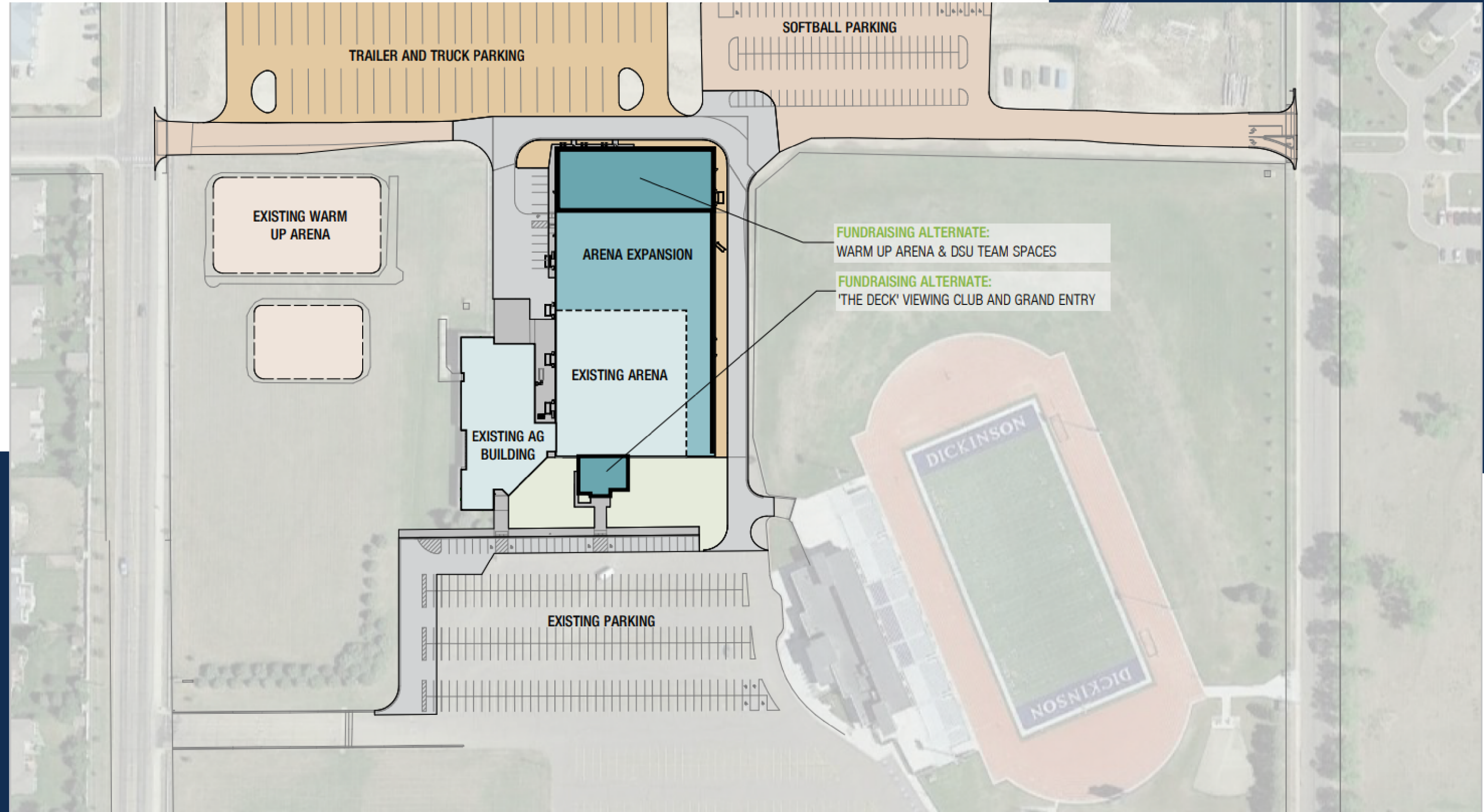

DSU AG BUILDING AND INDOOR ARENA  
SITE PLAN

FEBRUARY 24, 2024 | JLG 23183 | © 2024 JLG ARCHITECTS



## OPTION #2 - EXTERIOR VIEW \$25M

The exterior view for the \$25M renovation for the DSU  
Agriculture Building.

- Main lobby area with viewing deck and conference room above
- Practice arena and indoor livestock stalls
- Outdoor livestock penning



DSU AG BUILDING AND INDOOR ARENA  
EXTERIOR VIEW - FUNDRAISING ALTERNATE  
FEBRUARY 24, 2024 | JLG 23183 | © 2024 JLG ARCHITECTS



## OPTION #2 - EXTERIOR VIEW \$25M

The exterior view for the \$18M renovation for the DSU  
Agriculture Building.

# OPTION #2 - \$25M

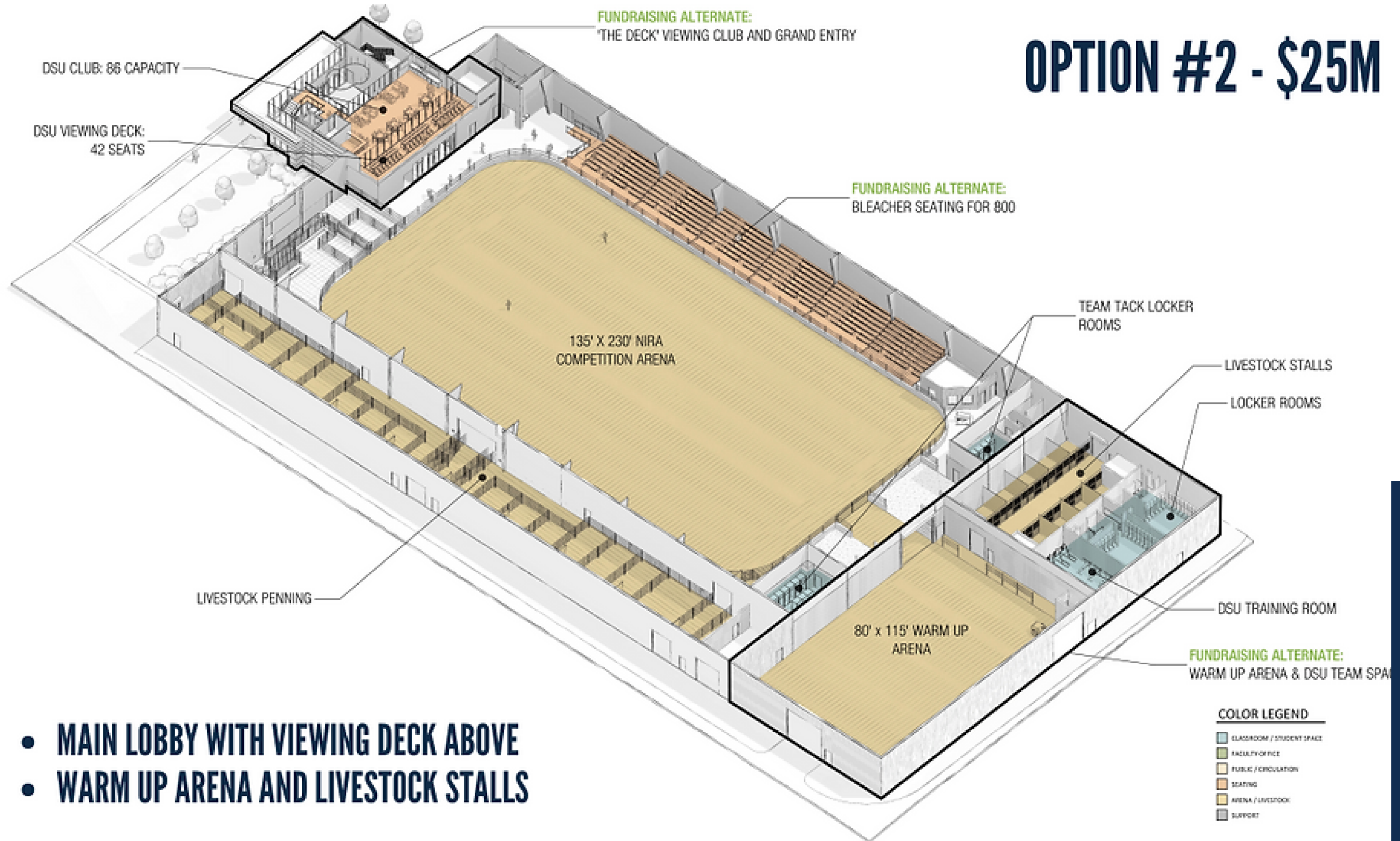

- MAIN LOBBY WITH VIEWING DECK ABOVE
- WARM UP ARENA AND LIVESTOCK STALLS



VIEWING DECK

LOOKING SOUTH AT THE ARENA AND VIEWING DECK



INSIDE THE VIEWING DECK THAT HAS A CAPACITY OF 150



MAIN LOBBY AREA WITH VIEWING DECK ABOVE



# COMMUNITY DEVELOPMENT

- Building a facility for DSU and community
- Serving the need for an indoor riding arena
- Providing educational space for training

With this facility our community could host 20+ spectator rodeo, equine, or other performances and events annually.

The additional warm-up space would provide the the potential for other events.



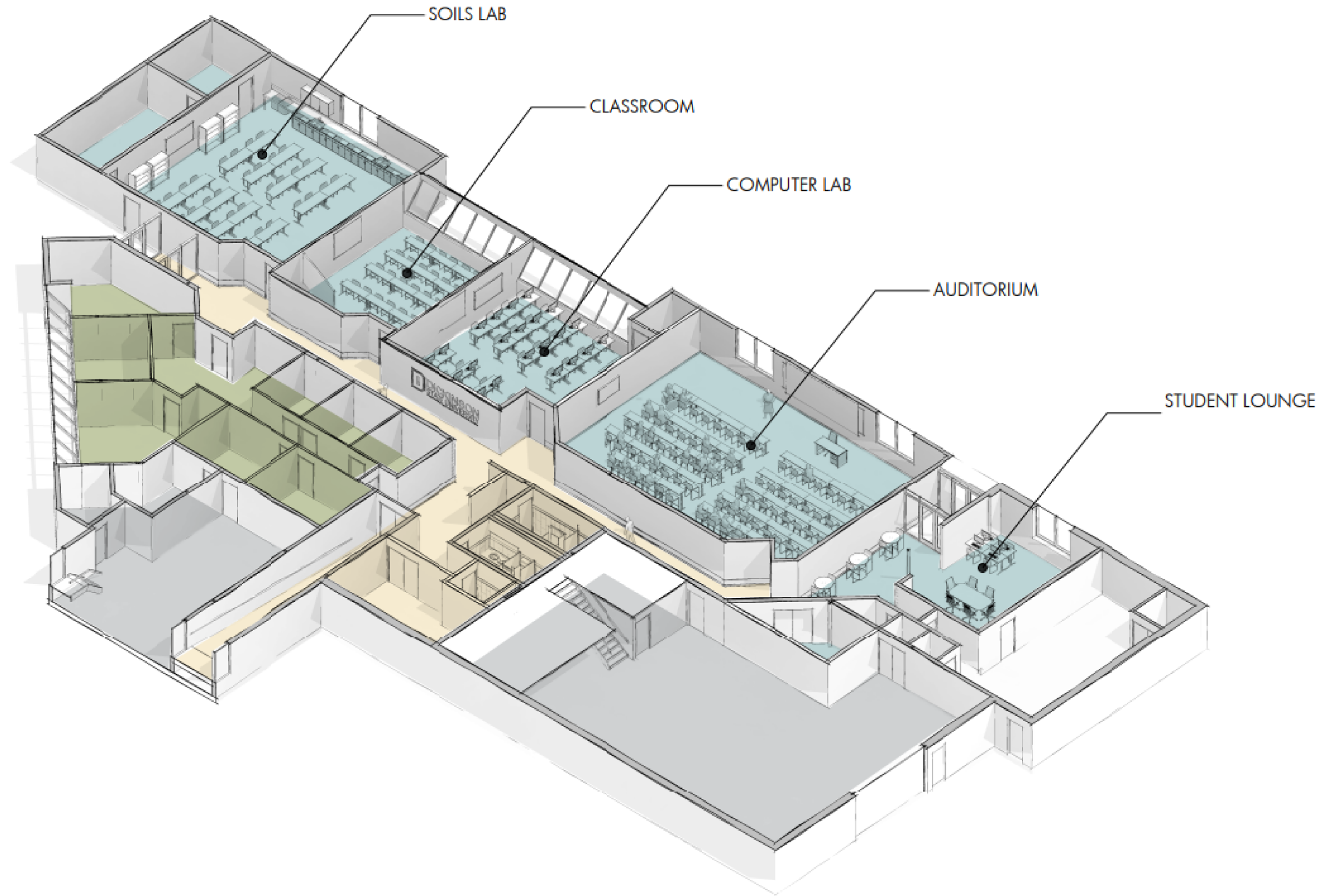

**COLOR LEGEND**

- CLASSROOM / STUDENT SPACE
- FACULTY OFFICE
- PUBLIC / CIRCULATION
- SEATING
- ARENA / LIVESTOCK
- SUPPORT



# DSU AG BUILDING AND INDOOR ARENA

## AG CLASSROOM BUILDING - AXON PLAN

FEBRUARY 24, 2024 | JLG 23183 | © 2024 JLG ARCHITECTS



# OPTION #1 - EXTERIOR VIEW \$18M

The exterior view for the \$18M renovation for the DSU  
Agriculture Building.

- No main lobby area with viewing deck above
- No practice arena or indoor livestock stalls
- Outdoor livestock penning



DSU AG BUILDING AND INDOOR ARENA  
EXTERIOR VIEW - BASE BID DESIGN  
FEBRUARY 24, 2024 | JLG 23183 | © 2024 JLG ARCHITECTS



# OPTION #1 - EXTERIOR VIEW \$18M

The exterior view for the \$18M renovation for the DSU  
Agriculture Building.



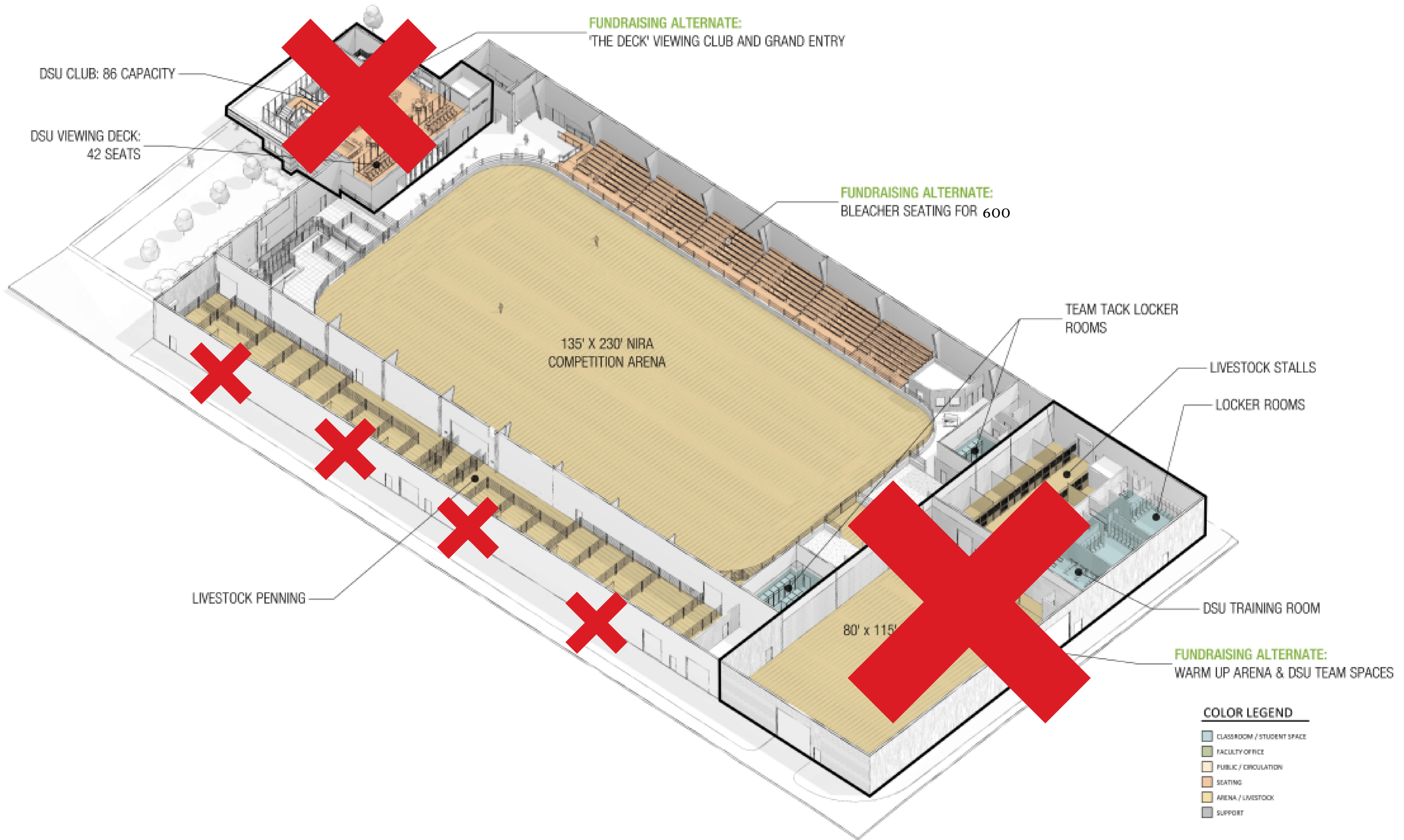

DSU CLUB: 86 CAPACITY

DSU VIEWING DECK:  
42 SEATS

FUNDRAISING ALTERNATE:  
"THE DECK" VIEWING CLUB AND GRAND ENTRY

FUNDRAISING ALTERNATE:  
BLEACHER SEATING FOR 600

135' X 230' NIRA  
COMPETITION ARENA

TEAM TACK LOCKER  
ROOMS

LIVESTOCK STALLS

LOCKER ROOMS

LIVESTOCK PENNING

80' x 115'

DSU TRAINING ROOM

FUNDRAISING ALTERNATE:  
WARM UP ARENA & DSU TEAM SPACES

**COLOR LEGEND**

- CLASSROOM / STUDENT SPACE
- FACULTY OFFICE
- PUBLIC / CIRCULATION
- SEATING
- ARENA / LIVESTOCK
- SUPPORT

**THANK YOU**

The image features a minimalist design with the text "THANK YOU" in a bold, dark blue, sans-serif font. The text is centered horizontally. Behind the letters "YOU", there is a large, light gray circle. In the bottom left corner, there are two overlapping circles: a smaller, darker gray one in front of a larger, lighter gray one. A thin, dark blue horizontal line spans across the bottom of the image, starting from the left edge and extending towards the right.