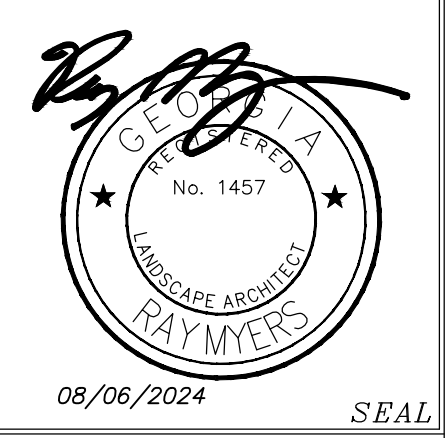

**REVISIONS**  
 REVISIONS 8-6-2024

**LANDSCAPE PLAN**

**PROPOSED FOODMART & RETAIL AT THE COMET**  
 DALLAS, GEORGIA

DATE: 02-15-2024  
 JOB NO.: 2024014  
 SCALE:  
 DRAWN BY: RM  
 CHKD BY: RM

**DISCLAIMER**  
 THIS DRAWING IS THE PROPERTY OF RAA DESIGN AND MAY NOT BE REPRODUCED WITHOUT WRITTEN CONSENT.  
 RAA DESIGN

SHEET  
**LS-1**  
 1 OF 2

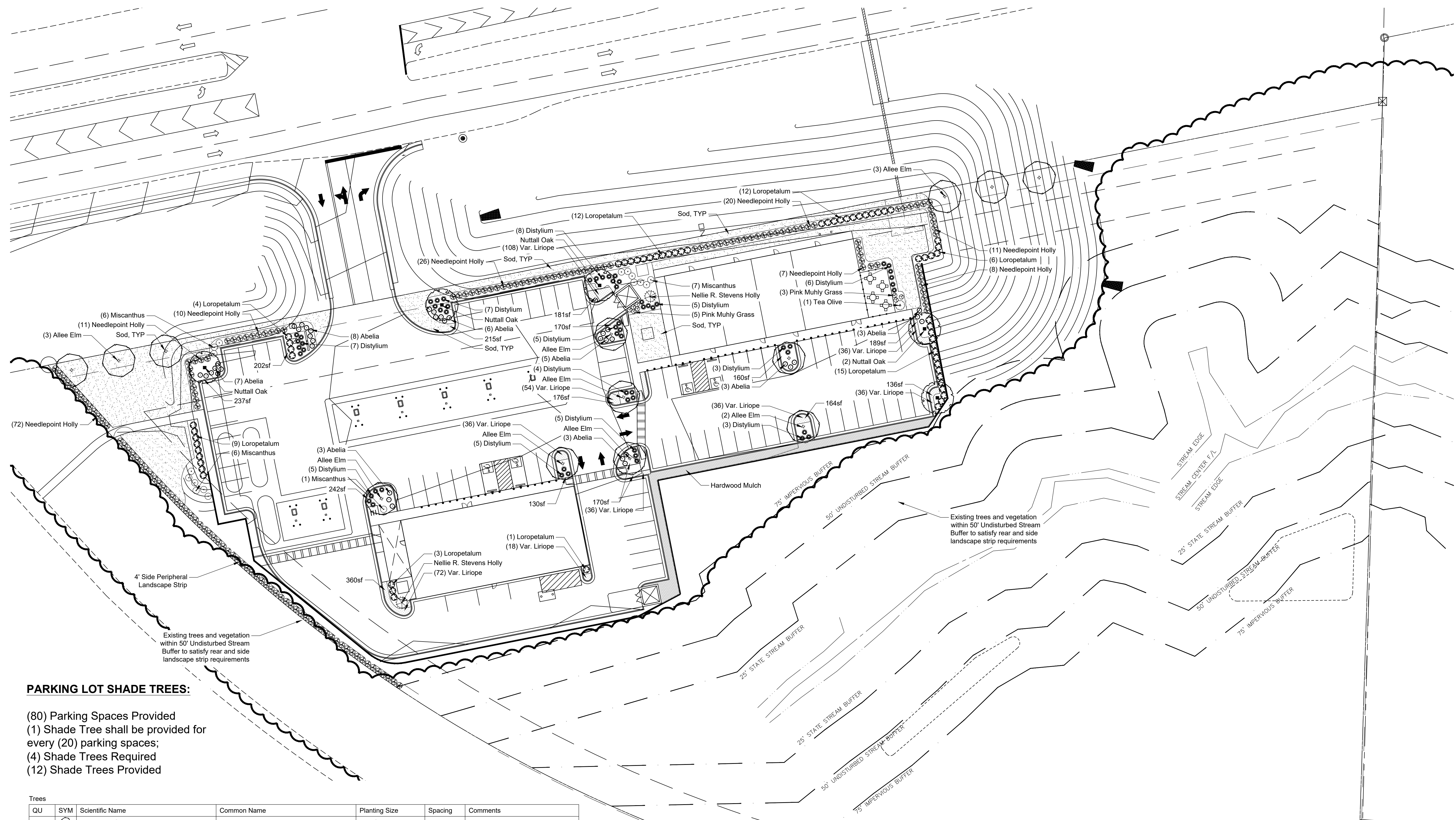

**PARKING LOT SHADE TREES:**

- (80) Parking Spaces Provided
- (1) Shade Tree shall be provided for every (20) parking spaces;
- (4) Shade Trees Required
- (12) Shade Trees Provided

Trees

QU	SYM	Scientific Name	Common Name	Planting Size	Spacing	Comments
13	⊙	Ulmus parvifolia 'Bosque'	Bosque Elm	2.5"-Cal, 8' height	As shown	
5	⊙	Quercus nuttallii	Nuttall Oak	2.5"-Cal, 8' height	As shown	
2	⊙	Ilex x 'Nellie R. Holly'	Nellie R. Stevens Holly	6' - 8'	As shown	

Shrub

QU	SYM	Scientific Name	Common Name	Planting Size	Spacing	Comments
38	⊙	Abelia x grandiflora 'Kaleidoscope'	Kaleidoscope Abelia	3-Gal	3' o.c.	
59	⊙	Distylium x 'Cinnamon Girl'	Cinnamon Girl Distylium	3-Gal	3' o.c.	
165	⊙	Ilex cornuta 'Needlepoint'	Needlepoint Holly	3-Gal	4' o.c.	
62	⊙	Loropetalum chinense var. Rubrum 'Ruby'	Ruby Loropetalum	3-Gal	4' o.c.	
17	⊙	Miscanthus sinensis 'Gracillimus'	Miscanthus	3-Gal	4' o.c.	
8	⊙	Muhlenbergia capillaris	Pink Muhly Grass	3-Gal	3' o.c.	
1	⊙	Osmanthus fragrans	Tea Olive	7-Gal	as shown	

Ground Cover

QU	SYM	Scientific Name	Common Name	Planting Size	Spacing	Comments
432	⊙	Liriope muscari 'Variegata'	Variegated Liriope	4" pot	1' o.c.	

**CORRIDOR OVERLY DISTRICT REQUIREMENTS:**

**Greenbelt:**  
 The greenbelt (located on the front-side of buildings) shall be suitably landscaped and shall be otherwise unoccupied except for steps, walks, terraces, driveways, lighting standards, and other similar structures, but excluding private parking areas. The greenbelt shall be a minimum of ten feet wide. Mounding and other innovative treatments are to be especially encouraged in this area.

**Planting within parking lots:**  
 Landscaping and planting areas shall be reasonably dispersed throughout the parking area and not less than five percent of a private parking lot shall be landscaped.

**Parking Lot Area: 56,616 sf x 5% = 2630 sf required  
 2732 sf provided**

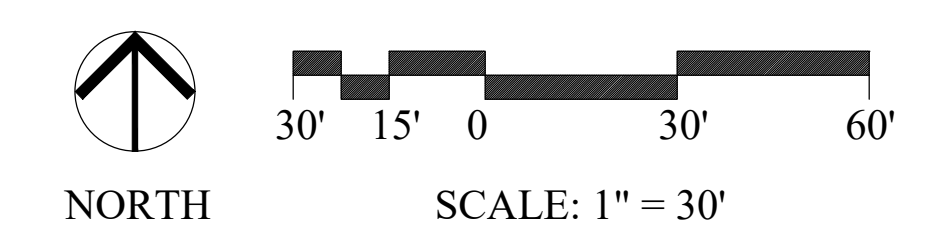

Date: Aug 08, 2024, 12:24pm User: ID: rmpm  
 File: C:\Users\royano\Dropbox\RAA Design\2024\2024014 - Dallas CA Mixed Use Vapn\Dallas Georgia Mixed Use\_current.dwg