



31 Ellis Circle
Chatsworth, GA 30705
X2mhunt@southernco.com
404-323-1075

09/12/2023

RE: Georgia Power Tree Trim/Clearing Distribution Project in Bartow County

RE: 2023060346-009

My name is Melissa Hunt, and I am a Land Agent assigned to the Georgia Power project that includes Tax Parcel ID#C127-0002-002. Georgia Power Company ("GPC") is working on a tree trim/clearing project to increase service reliability in your area. As you may already know, during inclement weather trees and limbs located too close to power lines can fall into the lines, resulting in flickering lights, power outages or even property damage. To help GPC continue providing safe and reliable service to residents and businesses in your area, we would like to acquire rights in the form of a tree trim/clearing easement on your property located on River Shoals Drive. The easement is approximately 17 linear feet in length.

The easement we seek will grant GPC permission to trim, cut or remove all trees and other obstructions located within twenty feet (20') from the center line of the pole (the "Easement Area"). In addition, the easements will allow GPC to trim, cut, or remove any branches that overhang into the Easement Area even if the tree itself is located outside of the Easement Area.

Even if you don't have trees or other obstructions located within the Easement Area, GPC would still like to acquire a tree trim/clearing easement from you so it can keep the Easement Area clear and free from obstructions well into the future.

This is a voluntary project, and you are not obligated to participate. However, GPC is willing to compensate you for the rights it seeks, with the amount to be based upon the length of the easement.

If you would be so kind as to contact me at 404-323-1075 or x2mhunt@southernco.com I would greatly appreciate it! Thank you for your assistance—I look forward to hearing from you!

Compensation: \$300.00

With kindest regards,

Melissa Hunt

Acquisition Representative,
Contract Land Staff LLC



In support of Georgia Power Company



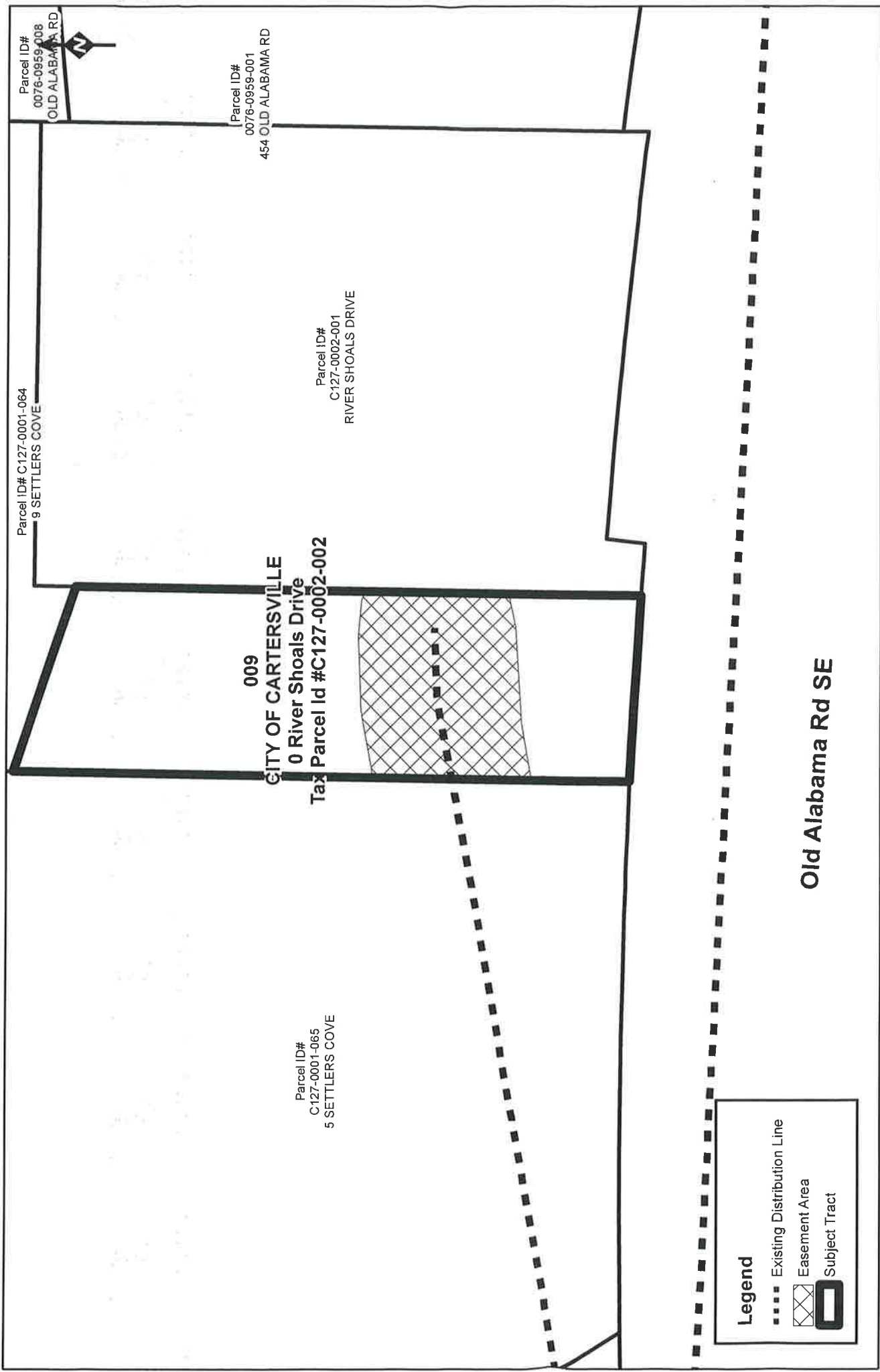

Legend

- Existing Distribution Line
-  Easement Area
-  Subject Tract

Georgia Power
Land Engineering

LAND LOT: 958
DISTRICT: 4

GPC Tree Trim easement is measured 20 feet from either side of existing Distribution Line

Exhibit A
PARCEL 009

MAP NOT BASED ON SURVEY DATA
Structure and line locations based on Pre-Engineering data and subject to change.

NOT TO SCALE

RED TOP MOUNTAIN - TREE TRIM -
E7882-KDS RECLOSER KK8633
(BARTOW COUNTY)
DISTRIBUTION LINE
LIMS : 2023060346

Prepare Date: 7/7/2023

After recording, return to:
Georgia Power Company
Attn: Land Acquisition (Recording)
241 Ralph McGill Blvd NE
Bin 10151
Atlanta, GA 30308-3374

PROJECT 2023060346 LETTER FILE DEED FILE MAP FILE
ACCOUNT NUMBER 11051327-GPC9596-0-12.02.01
NAME OF LINE/PROJECT: RED TOP MOUNTAIN - TREE TRIM - E7882-KDS RECLOSER KK8633 (BARTOW COUNTY) -DL

PARCEL NUMBER 009

STATE OF GEORGIA
BARTOW COUNTY

DISTRIBUTION TREE TRIM / CLEARING EASEMENT

For and in consideration of the sum of Ten and No/100 Dollars (\$10.00) and other good and valuable consideration, in hand paid by GEORGIA POWER COMPANY, a Georgia corporation (the "Company"), the receipt and sufficiency of which are hereby acknowledged, CITY OF CARTERSVILLE (the "Undersigned", which term shall include heirs, successors and/or assigns), whose mailing Address is PO Box 1390, Cartersville, GA 30120-1390, does hereby grant and convey to the Company, its successors and assigns, the right, privilege and easement to cut, trim, remove, clear and keep clear any and all trees and other obstructions located on the Easement Area (as defined below), as well as the right, privilege and easement to cut, trim and/or remove any trees which now or may hereafter endanger the electric transmission and/or distribution lines and/or communication lines of the Company, its successors and assigns now constructed or which may hereafter be constructed on or adjacent to the Property (as defined below) and the right of ingress and egress over the Property to and from the Easement Area in connection therewith.

The "Property" is defined as that certain tract of land owned by the Undersigned at 0 RIVER SHOALS DRIVE, CARTERSVILLE, GA 30120 (Tax Parcel ID No. C127-0002-002) in Land Lot 958, SECTION 3 of the 4 District of Bartow County, Georgia.

The "Easement Area" is defined as the portion of the Property located within twenty (20) feet of the centerline of the existing overhead of the existing electric transmission, distribution and/or communication lines of the Company, such Easement area being more particularly shown on "Exhibit A" attached hereto and made a part hereof.

[Signature(s) on Following Page(s)]

PARCEL 009

NAME OF
LINE/PROJECT:

RED TOP MOUNTAIN - TREE TRIM - E7882-KDS RECLOSER
KK8633 (BARTOW COUNTY) -DL

IN WITNESS WHEREOF, the Undersigned has/have hereunto set his/her/their hand(s) and seal(s), this _____ day of _____, _____.

Signed, sealed and delivered in the CITY OF CARTERSVILLE presence of:

Witness

By: _____ (SEAL)
Name:
Title:

Notary Public

Attest: _____ (SEAL)
Name:
Title:

[CORPORATE SEAL]

Payment Request Form

Owner Name: City of Cartersville

LIMS Project & Parcel: 2023060346-009

Agent Name: Melissa Hunt

Payment Amount: \$300.00

Verified By: _____

Payment Options (Select one – Check or Zelle)

Check

Payable To: City of Cartersville

Street Address: 1 N Erwin Street

City, State & Zip: Cartersville, GA 30120

Phone No: (770) 387-5616

E-mail Address: dporta@cartersvillega.gov

Zelle Electronic Payment (*In addition to above items*, owner must select **one** of the following.)

E-mail Address: _____

Or

U.S. Mobile No: _____

By selecting one of the above options, I hereby authorize payment by the chosen method.

- By selecting the first option, I understand that a paper check will be processed and delivered by Federal Express to me at the street address provided within 2-4 weeks.
- By selecting the second option, I understand that a notification message will be sent via e-mail or text message to my e-mail address or U. S. mobile phone number with instructions for completing the electronic payment process from Bank of America to my bank account. This should be processed within 2-4 business days. Further, if my e-mail address or U.S. mobile number is not currently enrolled with the Zelle payment system, I understand that I am responsible for associating the provided notification method with my bank account by following the instructions in the notification message and/or contacting my bank for assistance.

Prior to processing payments of \$600.00 or more, I also understand that I must complete an IRS-required Form W-9 to collect information which Southern Company will report according to law.

Owner's Signature: _____

Date: _____