

TASK ORDER NO. 4

Consisting of 2 pages.

In accordance with Paragraph 1.01 of the Agreement Between Owner and Engineer for Professional Services – Task Order Edition, dated August 18, 2022 ("Agreement"), or subsequent renewals thereof, Owner and Engineer agree as follows:

1. Specific Project Data

Title: **OVERLOOK PARKWAY SEWER PUMP STATION**

Engineer's Project No. **338-113**

Description: A Project to design and construct a sanitary sewage pump station to replace Cartersville's existing Komatsu Sewer Pump Station. The Project will consist of two Divisions. Division I will be a new pump station located on a site to be obtained by Owner on the Prose Atlanta apartment tract at overlook Parkway. The Owner will acquire an access easement to the new pump station from Overlook Parkway. Division II will consist of approximately 4,350 linear ft. of 8-inch ductile iron forcemain to parallel an existing 6-inch forcemain on existing easement between the new pump station and Cartersville's existing receiving manhole at Center Road.

The Project is to be constructed under two (2) Construction Contracts.

The Project is to be funded by local funds.

2. Services of Engineer [Check all that apply.]

- ✓ Preliminary Design
- ✓ Final Design and Bidding Documents
- ✓ Bidding or Negotiating Services
- ✓ Construction Phases
- ✓ Resident Project Representative Services

Engineer will provide Resident Project Representatives services pursuant to Part 4 of Exhibit A; Exhibit D is attached to the Task Order and expressly incorporated by reference.

- ✓ Additional Services, if authorized

3. Owner Responsibilities

Owner shall have those responsibilities set forth in Article 2 and in Exhibit B of the Agreement.

4. Times for Rendering Services by Engineer

<u>Phase</u>	<u>Completion Date</u>
Study and Report	Completed
Preliminary Design	30 days after authorization to begin
Final Design & Bidding Documents	60 days after authorization to design
Bidding or Negotiation	TBD at time of authorization
Construction	TBD at time of authorization
Resident Representative	TBD at time of authorization
Additional Services	TBD at time of authorization

TASK ORDER NO. 4

5. Payments to Engineer by Owner

A. The terms of payment are set forth in Article 4 of the Agreement and in Exhibit C. Owner shall pay Engineer for services rendered as follows:

<i>Category of Services</i>	<i>Compensation Method</i>	<i>Estimate of Compensation for Services</i>
Study and Report	Hourly, plus Reimbursable Expenses	\$ Completed
Preliminary Design	Hourly, plus Reimbursable Expenses	\$ 25,000
Final Design	Hourly, plus Reimbursable Expenses	\$ 48,000
Bidding or Negotiation	Hourly, plus Reimbursable Expenses	\$ 15,000
Construction	Hourly, plus Reimbursable Expenses	TBD when authorized
Resident Representative	Hourly, plus Reimbursable Expenses	TBD when authorized
Additional Services	Hourly, plus Reimbursable Expenses	\$ 15,000

6. Consultants to be utilized: Atlanta Consulting Engineers, Inc. (Electrical Engineering).

7. Other Modifications to Agreement: A description of services provided shall be included on Engineer's invoices.

8. Attachments: Preliminary Project May, No. 338-113, May 01, 2023.

9. Documents Incorporated by Reference: None.

10. Terms and Conditions: Execution of this Task Order by Owner and Engineer shall make it subject to the terms and conditions of the Agreement (as modified above), which Agreement is incorporated by this reference. Engineer is authorized to begin performance upon its receipt of a copy of this Task Order signed by Owner.

The Effective Date of this Task Order is May 01, 2023.

OWNER
CITY OF CARTERSVILLE, GA

By: _____

Name: _____

Title: _____

Date: _____

ENGINEER
SWEITZER ENGINEERING, INC.

By: 

Name: John H. Sweitzer

Title: President

Date: 5/8/23

- GENERAL NOTES
1. SEE SHEETS OF THIS GENERAL NOTES AND LEGEND APPLICABLE TO ALL SHEETS.

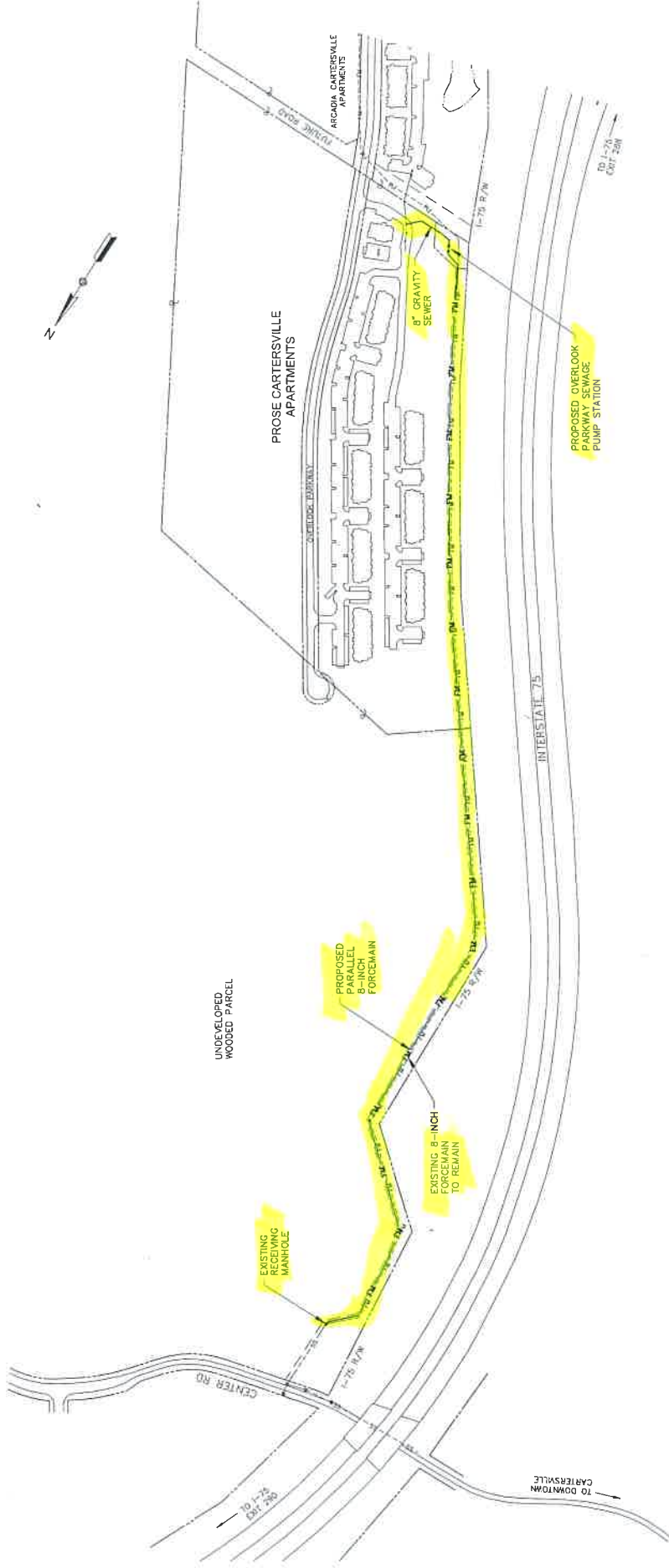

GRAPHIC SCALE
0 100 200
1 INCH = 200 FEET

<p>DATE: MAY 11, 2023 SHEET: 02 SEQUENCE: 02 OF 25 PROJECT NO. 2023-113</p>		<p>SHEET TITLE PROJECT MAP</p>				<p>CITY OF CARTERSVILLE SEWER SYSTEM IMPROVEMENTS OVERLOOK PARKWAY LIFT STATION & FORCEMAIN</p>		<p>PRELIMINARY</p>		<p>SWITZER ENGINEERING, INC. CONSULTING ENGINEERS 680 Douglas Ferry Rd., Suite 105 Cartersville, Georgia 30120 Telephone: 678-569-4290 COA #PEF005720 Exp. 6-30-24</p>		<p>DESIGNED: JMC DRAWN: SHS CHECKED: JHS</p>		<p>THE SCALE BAR SHOWN BELOW THE INCH LONG ON THE ORIGINAL DRAWING.</p>		<p>BY: _____ REVISION: _____</p>		<p>SWITZER ENGINEERING, INC. 2023</p>	
---	--	------------------------------------	--	---	--	---	--	--------------------	--	--	--	--	--	---	--	--------------------------------------	--	---------------------------------------	--