

OVERALL LANDSCAPE PLAN

SCALE: 1" = 40'-0"

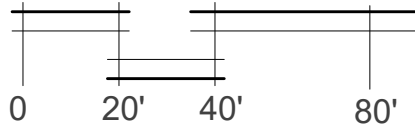
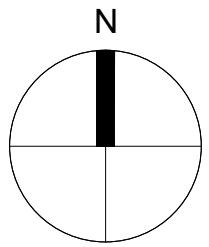

PLANT KEY

SHADE TREE

ORNAMENTAL TREE

EVERGREEN TREE

SEED MIX & GROUND TREATMENT KEY

DETENTION AREAS - NATIVE SWALE MIX

OPEN AREAS - NATIVE NO MOW

TURF GRASS - MOWED LAWN

PRELIMINARY LANDSCAPE PLAN

PROPOSED COMMERCIAL
DEVELOPMENT
CREST HILL, ILLINOIS

no.	revision	description	initial	date
1	1	ISSUED FOR REVIEW	KMT	07-01-21
2				
3				
4				

date	07-06-21
drawn	DW
checked	KMT

job no.
21250
sheet no.
L 1.1

Kathryn Talty
landscape architecture

Winnetka, Illinois 60093
847.612.5154
www.kmtaltdesign.com



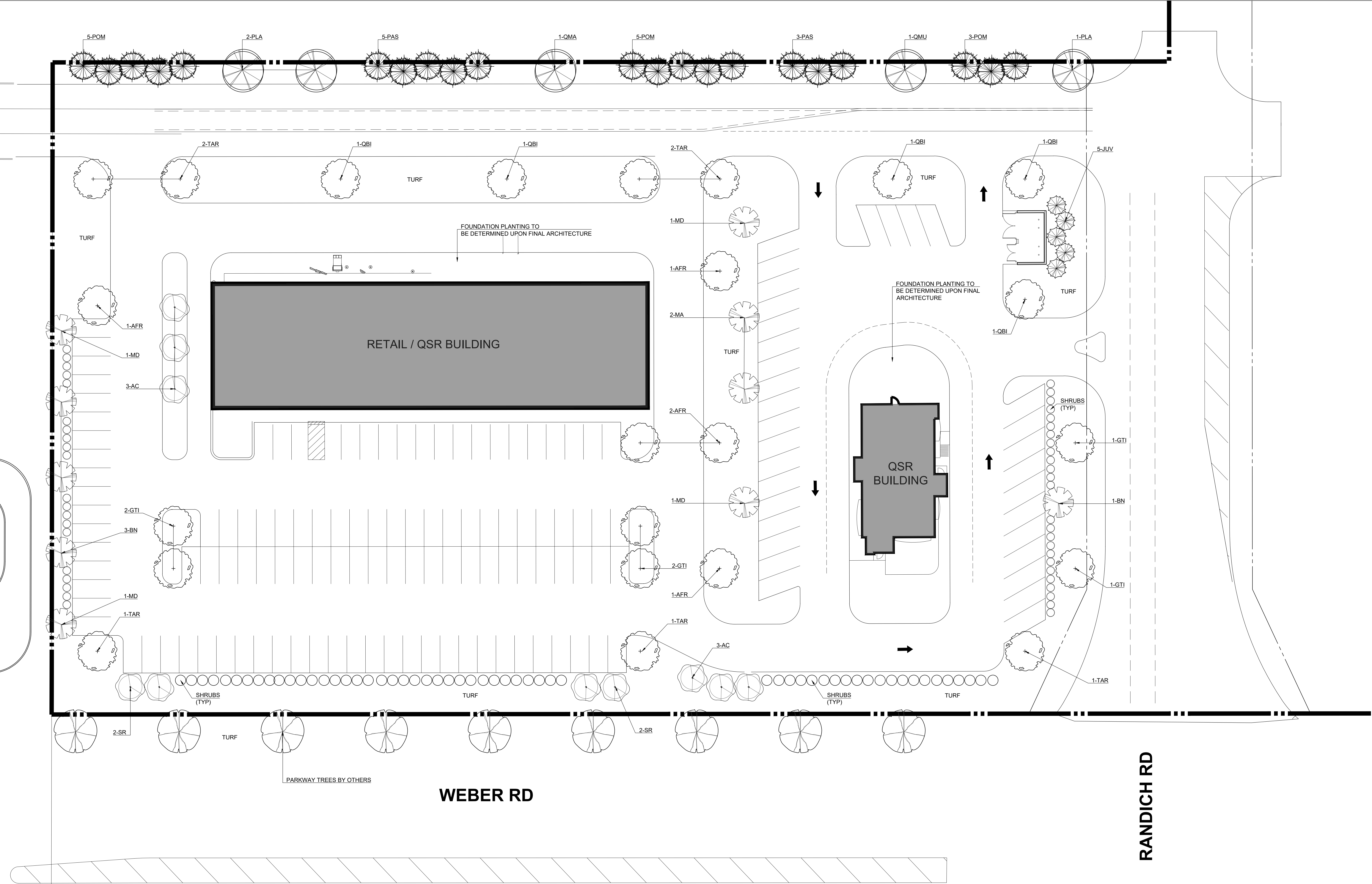

COMMERCIAL LOT
LANDSCAPE PLAN

SCALE: 1" = 20'-0"

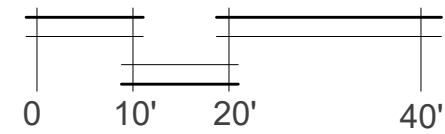
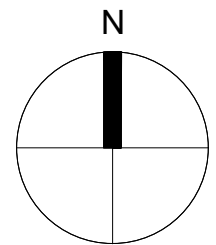

Kathryn Talty

landscape architecture

Winnetka, Illinois 60093

847.612.5154

www.kmtaltdesign.com

REGISTERED LANDSCAPE ARCHITECT

KATHRYN MAXWELL TALTY

157-001196

STATE OF ILLINOIS

KMT

no.	revision	description	initial	date
1	ISSUED FOR REVIEW		KMT	07-02-21
2				
3				
4				
5				
6				
7				
8				

PRELIMINARY LANDSCAPE PLAN

PROPOSED COMMERCIAL
DEVELOPMENT
CREST HILL, ILLINOIS

date
07-06-21

drawn
DW

checked
KMT

job no.
21250

sheet no.
L 1.2

Master Plant List					
Symbol	Quantity	Botanical Name	Common Name	Size	Notes
Shade Trees					
AFR	5	ACER X FREEMANI 'AUTUMN BLAZE'	AUTUMN BLAZE FREEMAN MAPLE	3" BB	
GTI	6	GLEDITSIA TRIACANTHOS F. INERMIS	THORNLLESS HONEYLOCUST	3" BB	
PLA	3	PLATANUS X ACERIFOLIA 'MORTON CIRCLE'	EXCLAMATION LONDON PLANETREE	3" BB	
QBI	5	QUERCUS BICOLOR	SWAMP WHITE OAK	3" BB	
QMA	1	QUERCUS MACROCARPA	BUR OAK	3" BB	
QMU	1	QUERCUS MUEHLENBERGII	CHINKAPIN OAK	3" BB	
TAR	7	TILIA AMERICANA 'REDMOND'	REDMOND AMERICAN LINDEN	3" BB	
Evergreen Trees					
JUV	5	JUNIPERUS VIRGINIANA	EASTERN RED CEDAR	8" BB	
PAS	8	PICEA AIBES	NORWAY SPRUCE	8" BB	
POM	13	PICEA OMORIKA	SERBIAN SPRUCE	8" BB	
Ornamental Trees					
AC	6	AMELANCHIER CANADENSIS	SHADBLow SERVICEBERRY	6" BB	
BN	4	BETULA NIGRA	RIVER BIRCH	8" BB	
MA	2	MALUS 'ADAMS'	CRABAPPLE	6" BB	20' RED, PINK
MD	4	MALUS 'DONALD WYMAN'	CRABAPPLE	6" BB	25' GREEN, LT PINK
SR	4	SYRINGA RETICULATA 'IVORY SILK'	IVORY SILK TREE LILAC	8" BB	
Evergreen Shrubs					
JCM		JUNIPERUS CHINENSIS 'MINT JULIP'	MINT JULIP SPREADING JUNPER	24" BB	
TD		TAXUS x MEDIA 'DENSII'	DENSE YEW	24" BB	
Deciduous Shrubs					
EA		EUONYMUS ALATA 'COMPACTA'	DWARF BURNING BUSH	36" BB	
HA		HYDRANGEA ARBORESCENS	ANNABELLE HYDRANGEA	5 GAL	
HP		HYDRANGEA PANICULATA 'TARDIVA'	TARDIVA HYDRANGEA	36" BB	
PF		POTENTILLA FRUITICOSA 'GOLD DROP'	GOLD DROP POTENTILLA	5 GAL	
RA		RHUS AROMATICA 'GRO LOW'	GRO LOW SUMAC	5 GAL	
SM		SYRINGA MEYER 'PALIBIN'	DWARF KOREAN LILAC	24" BB	
VC		VIBURNUM CARLESII 'COMPACTUM'	DWARF KOREANSPICE VIBURNUM	36" BB	
VD		VIBURNUM DENTATUM 'CHICAGO LUSTRE'	CHICAGO LUSTRE ARROWWOOD VIBURNUM	48" BB	
VJ		VIBURNUM X JUDDI	JUDD VIBURNUM	36" BB	
Perennials					
ep		ECHINACEA PURPUREA 'MAGNUS'	CONEFLOWER	1 GAL	36" PURPLE
hs		HEMEROCALLIS 'STELLA D'ORO'	SELLA D'ORO DAYLILY	1 GAL	18" YELLOW
nf		NEPETA X FAASSENII	FAASSEN'S CATMINT	1 GAL	12" LAVENDER
Grasses					
pv		PANICUM VIRGATUM 'NORTH WIND'	SWITCH GRASS	3 GAL	4'

Swale Seed Mix					
Botanical Name	Common Name	PLS Ounces/Acre			
Permanent Grasses/Sedges:					
Andropogon gerardii	Big Bluestem	4.00			
Carex cristatella	Crested Oval Sedge	0.50			
Carex lurida	Bottlebrush Sedge	3.00			
Carex spp	Prairie Sedge Species	8.00			
Carex vulpinoidea	Brown Fox Sedge	3.00			
Elymus canadensis	Canada Wild Rye	16.00			
Elymus virginicus	Virginia Wild Rye	16.00			
Juncus canadensis	Canadian Rush	1.00			
Panicum virgatum	Switch Grass	3.00			
Scirpus atrovirens	Dark Green Rush	2.00			
Scirpus cyparissus	Wool Grass	0.50			
Spartina pectinata	Prairie Cord Grass	3.00			
Total		60.00			
Temporary Cover:					
Avena sativa	Common Oat	360.00			
Lolium multiflorum	Annual Rye	100.00			
Total		460.00			
Forbs:					
Alisma subcordatum	Common Water Plantain	1.00			
Asclepias incarnata	Swamp Milkweed	2.00			
Coreopsis tripteris	Tall Coreopsis	1.00			
Euthamia graminifolia	Common Grass-Leaved Goldenrod	0.50			
Eutrochium maculatum	Spotted Joe-Pye Weed	1.00			
Iris virginica v. shrevei	Blue Flag	4.00			
Liatris spicata	Marsh Blazing Star	1.00			
Lycopus americanus	Common Water Horehound	0.50			
Mimulus ringens	Monkey Flower	0.50			
Panthorum sedoides	Ditch Stonecrop	1.00			
Pycnanthemum virginianum	Common Mountain Mint	0.50			
Rudbeckia triloba	Brown-Eyed Susan	1.00			
Senna hebecarpa	Wild Senna	1.00			
Silphium terebinthinaceum	Prairie Dock	1.00			
Symphotrichum novae-angliae	New England Aster	0.50			
Verbena hastata	Blue Vervain	1.50			
Zizia aurea	Golden Alexanders	2.00			
Total		20.00			
Mix Statistics					
Native Component	PLS lbs./Acre	PLS Seeds/Acre	PLS Seeds/Sq. Ft.	% of Native Mix	
Forbs	1.25	1,181,855	27.13	31.09%	
Grasses	3.75	2,619,949	60.15	68.91%	
Total Natives	5.00	3,801,804	87.28	100.00%	
Cover	28.75	4,343,800	99.72		
Totals	33.75	8,145,604	187.00		

No-Mow Fescue Seed Mix		
Botanical Name	Common Name	PERCENTAGE
Permanent Grasses/Sedges:		
Festuca brevipila	Hard Fescue	19.20%
Festuca ovina	Sheep Fescue	19.20%
Festuca rubra subs. fallax	Chewings Fescue	19.20%
Festuca rubra	Red Fescue	19.20%
Festuca rubra var. rubra	Creeping Red Fescue	19.20%
Total		96.00%
Temporary Cover:		
Lolium multiflorum	Annual Rye	4.00%
Total		4.00%

GENERAL CONSTRUCTION NOTES

- REQUIRED LANDSCAPE MATERIAL SHALL SATISFY AMERICAN ASSOCIATION OF NURSERYMEN STANDARDS AND BE STAKED, WRAPPED, WATERED AND MULCHED PER ORDINANCE.
- BEFORE ANY EXCAVATION ON THE SITE, CALL TO LOCATE ANY EXISTING UTILITIES ON THE SITE. THE CONTRACTOR SHALL FAMILIARIZE HIM/HERSELF WITH THE LOCATIONS OF ALL BURIED UTILITIES IN THE AREAS OF WORK BEFORE STARTING OPERATIONS. THE CONTRACTOR SHALL BE LIABLE FOR THE COST OF REPAIRING OR REPLACING ANY BURIED CONDUITS, CABLES OR PIPING DAMAGED DURING THE INSTALLATION OF THIS WORK.
- FOUR FOOT HIGH FENCING OR OTHER RIGID MATERIAL IS TO BE ERECTED AROUND THE DRIP-LINE OF ALL TREES TO BE SAVED. SEE TREE PRESERVATION PLAN, SHEET L0.1, FOR DETAILS.
- A TREE REMOVAL PERMIT MUST BE OBTAINED FROM THE FORESTRY DEPARTMENT PRIOR TO ALL TREE REMOVAL ACTIVITY INVOLVING TREES TWO AND A HALF (2.5) INCHES OR MORE D.B.H. SEE TREE PRESERVATION PLAN, SHEET L0.1, FOR DETAILS.
- PLANT QUANTITIES ON PLANT LIST INTENDED TO BE A GUIDE. ALL QUANTITIES SHALL BE CHECKED AND VERIFIED ON PLANTING PLAN. ANY DISCREPANCIES SHALL BE DISCUSSED WITH THE LANDSCAPE ARCHITECT.
- ANY DEVIATIONS FROM OR MODIFICATIONS TO THIS PLAN SHALL BE APPROVED BY THE LANDSCAPE ARCHITECT PRIOR TO INSTALLATION.
- CONTRACTOR TO NOTIFY LANDSCAPE ARCHITECT UPON DELIVERY OF PLANT MATERIAL TO THE SITE. LANDSCAPE ARCHITECT RESERVES THE RIGHT TO REJECT ANY PLANT MATERIAL THAT DOESN'T MEET STANDARDS OR SPECIFICATIONS OF THE PROJECT.
- ALL PLANT MATERIAL TO BE INSTALLED PER THE PLANTING DETAILS PROVIDED ON THIS PLAN SET.
- ALL BED EDGES TO BE WELL SHAPED, SPADE CUT, WITH LINES AND CURVES AS SHOWN ON THIS PLAN SET.
- ALL PLANTING BEDS TO BE PREPARED WITH PLANTING MIX: 50% TOPSOIL, 50% SOIL AMENDMENTS (3 PARTS PEATMOSS, 1 PART COMPOST, 1 PART SAND)
- ALL PARKING LOT ISLANDS SHALL BE BACKFILLED WITH THE FOLLOWING: 2' OF BLENDED GARDEN SOIL MIX (60% TOPSOIL, 30% COMPOST, 10% SAND) OR 6" OF ONE STEP BY MIDWEST TRADING, TOP DRESSED AND TILLED INTO 18" OF TOPSOIL.
- ALL SPECIFIED LANDSCAPE MATERIAL INDICATED ON THE CONSTRUCTION DOCUMENTS WILL BE REQUIRED TO BE MAINTAINED THROUGHOUT THE LIFE OF THE PROJECT AND MUST BE REPLACED SHOULD IT DIE OR BECOME DAMAGED.
- ALL PLANT MATERIAL SHALL HAVE A ONE YEAR GUARANTEE FROM SUBSTANTIAL COMPLETION AS DETERMINED BY THE LANDSCAPE ARCHITECT, AND SHALL BE REPLACED SHOULD IT DIE WITHIN THAT PERIOD.
- PROTECT STRUCTURES, SIDEWALKS, PAVEMENTS AND UTILITIES TO REMAIN FROM DAMAGE CAUSED BY SETTLEMENT, LATERAL MOVEMENT, UNDERMINING, WASHOUTS AND OTHER HAZARDS CAUSED BY SITE IMPROVEMENT OPERATIONS.
- ALL LAWN AREAS TO BE SEEDED WITH STANDARD TURF GRASS SEED AND COVERED WITH EROSION CONTROL BLANKET, UNLESS OTHERWISE SPECIFIED ON THE PLAN.
- CAREFULLY MAINTAIN PRESENT GRADE AT BASE OF ALL EXISTING TREES TO REMAIN. PREVENT ANY DISTURBANCE OF EXISTING TREES INCLUDING ROOT ZONES. USE TREE PROTECTION BARRICADES WHERE INDICATED. PROTECT EXISTING TREES TO REMAIN AGAINST UNNECESSARY CUTTING, BREAKING OR SKINNING OF ROOTS, BRUISING OF BARK OR SMOTHERING OF TREES. DRIVING, PARKING, DUMPING, STOCKPILING AND/OR STORAGE OF VEHICLES, EQUIPMENT, SUPPLIES, MATERIALS OR DEBRIS ON TOP THE ROOT ZONES AND/OR WITHIN THE DRIFLINE OF EXISTING TREES OR OTHER PLANT MATERIAL TO REMAIN IS STRICTLY PROHIBITED.
- THE CONTRACTOR AT ALL TIMES SHALL KEEP THE PREMISES ON WHICH WORK IS BEING DONE, CLEAR OF RUBBISH AND DEBRIS. ALL PAVEMENT AND DEBRIS REMOVED FROM THE SITE SHALL BE DISPOSED OF LEGALLY.
- ALL WORK AND OPERATIONS SHALL COMPLY WITH ALL APPLICABLE FEDERAL, STATE AND LOCAL CODES AND ORDINANCES.

PLANTING NOTES FOR DETENTION AREAS

- REFER TO CIVIL ENGINEERING DRAWINGS FOR CONSTRUCTION DETAILS OF DETENTION AREAS
- REQUIRED LANDSCAPE MATERIAL SHALL SATISFY AMERICAN ASSOCIATION OF NURSERYMEN STANDARDS AND BE WATERED AND MULCHED PER CONSTRUCTION DOCUMENTS.
- ALL PROPOSED PLANT SUBSTITUTIONS WITHIN DETENTION AREAS MUST BE APPROVED BY LANDSCAPE ARCHITECT PRIOR TO INSTALLATION.
- ALL REQUIRED LANDSCAPE MATERIAL INDICATED ON THE APPROVED PLANS WILL BE MAINTAINED THROUGHOUT THE LIFE OF THE PROJECT AND MUST BE REPLACED SHOULD IT DIE.
- CONTRACTOR RESPONSIBLE FOR THE MAINTENANCE ALL PLANT MATERIAL WITHIN DETENTION AREAS AS SPECIFIED BY THE LANDSCAPE ARCHITECT FOR THE FIRST YEAR AFTER INSTALLATION.
- ALL PLANT MATERIAL WITHIN DETENTION AREAS TO HAVE A 1 YEAR WARRANTEE STARTING UPON LANDSCAPE ARCHITECT ISSUING "SUBSTANTIAL COMPLETION".
- WATER FOWL BARRIER CONTROL TO BE INSTALLED AT 8" O.C. IN ALL DETENTION AREAS PLANTED WITH PLUGS.
- METAL SIGNS (12"x18") TO BE INSTALLED AT 150' INTERVALS AROUND ALL NATIVE AREAS STATING "NATIVE PLANTING DO NOT MOW".
- ALL WORK AND OPERATIONS SHALL COMPLY WITH ALL APPLICABLE FEDERAL, STATE AND LOCAL CODES AND ORDINANCES.

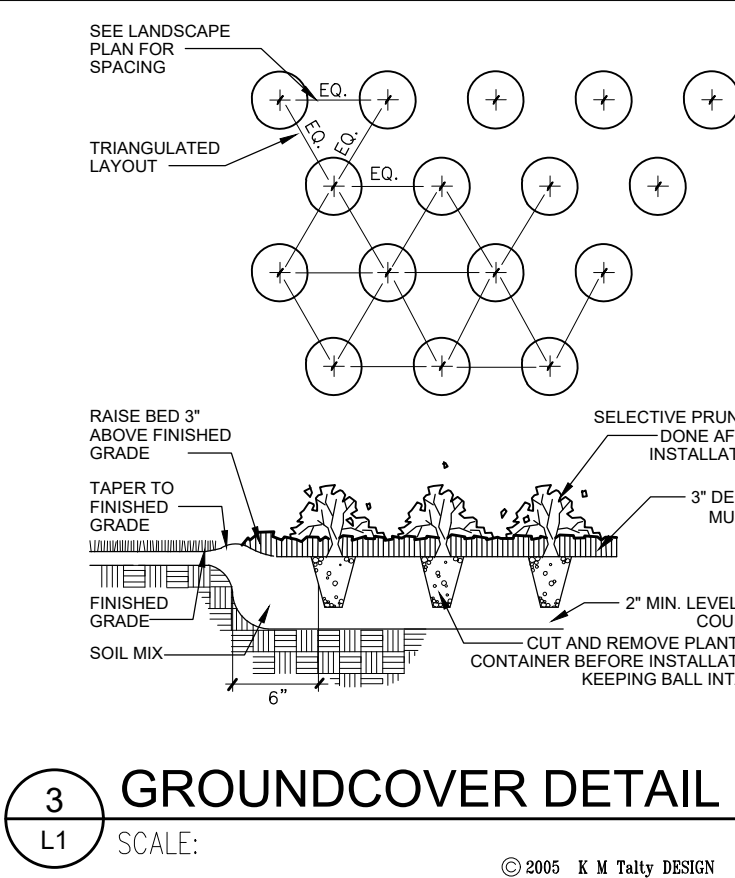
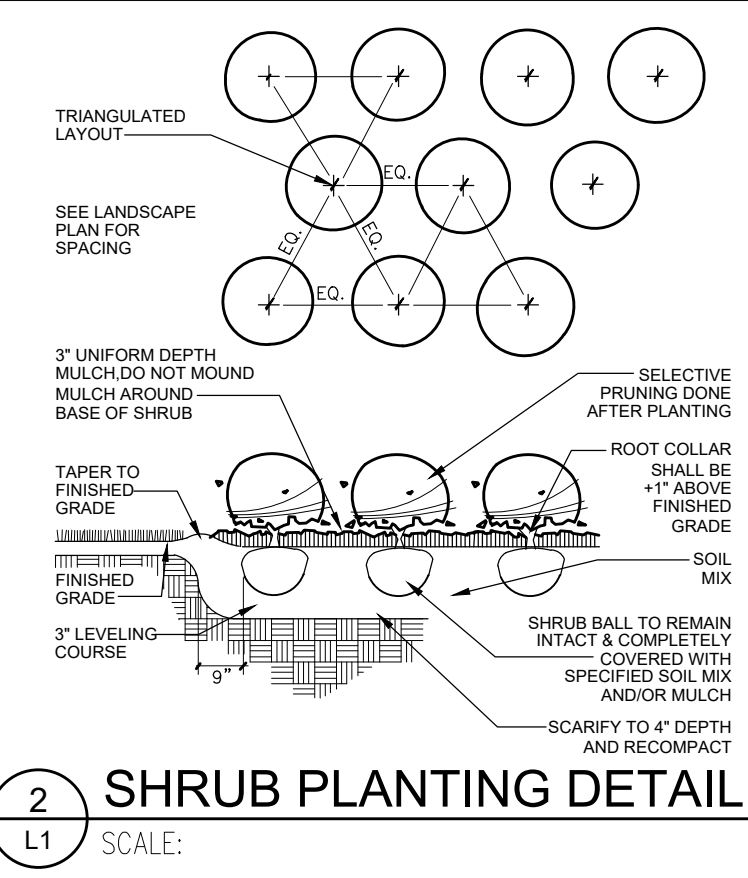
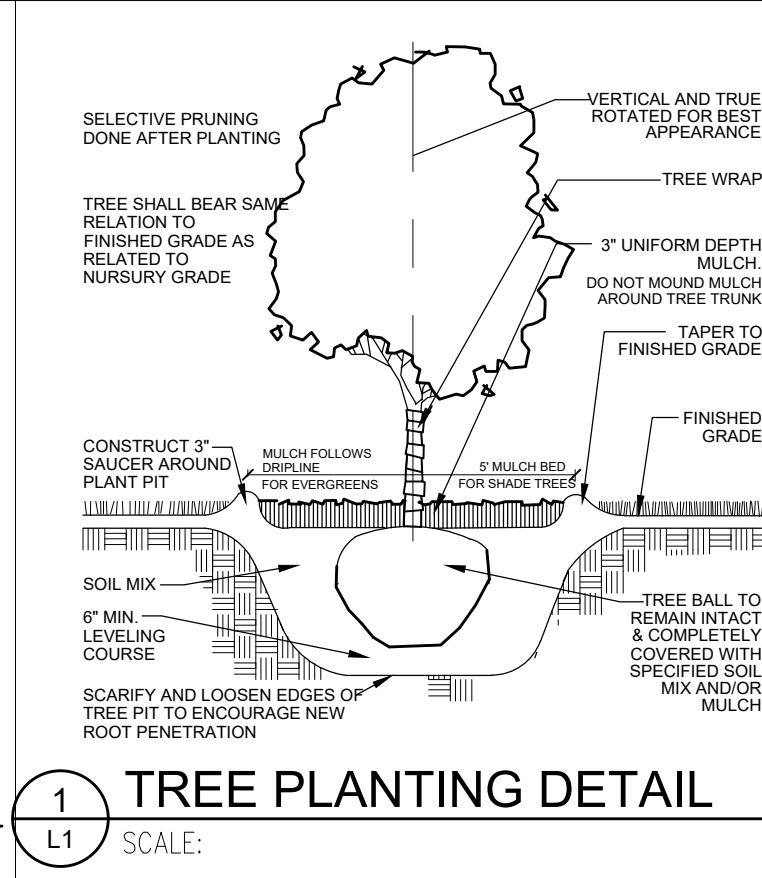
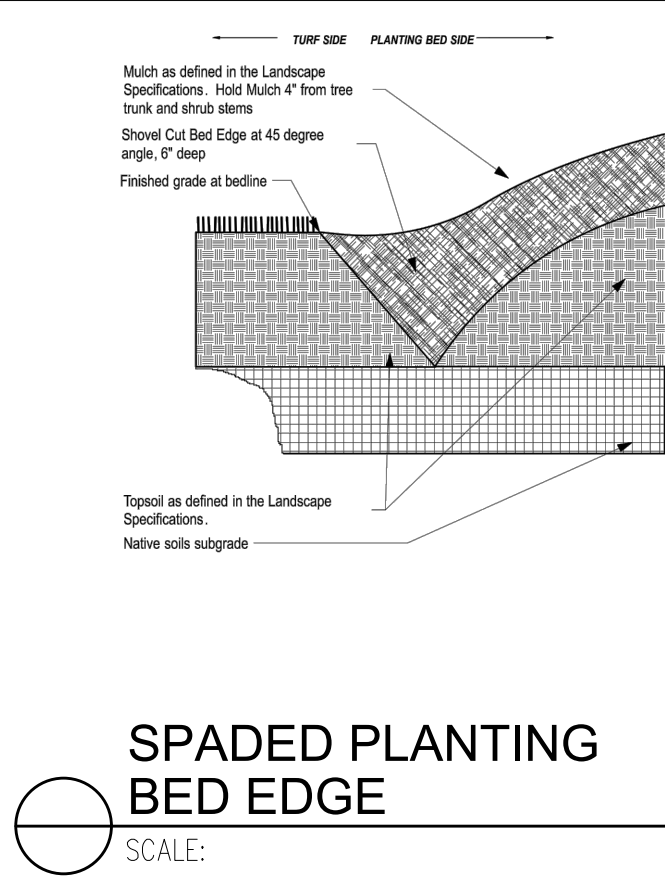
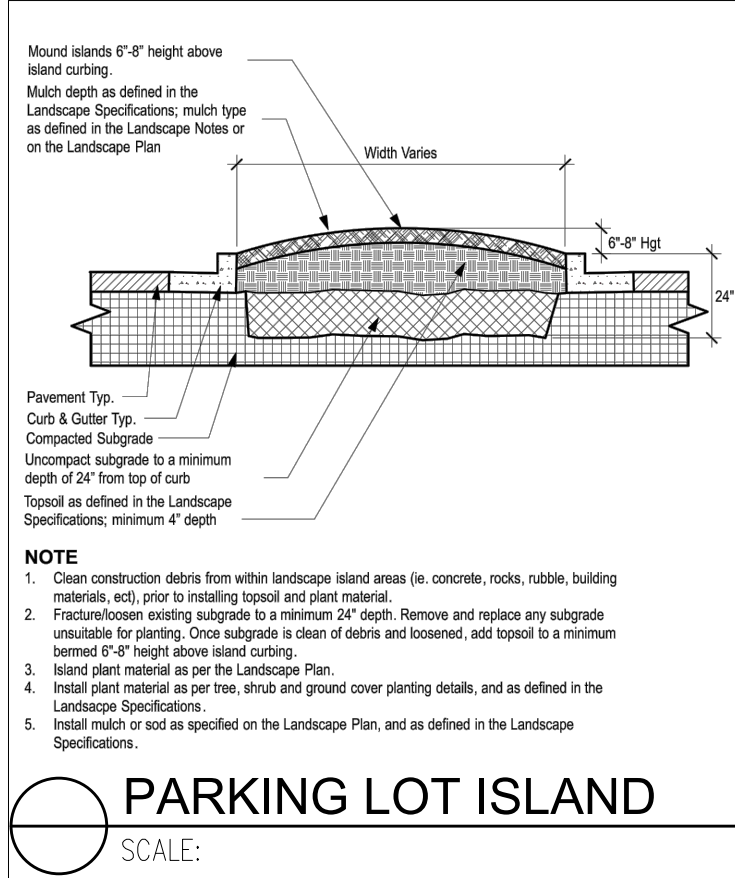

PROPOSED FACILITY
CREST HILL, ILLINOIS

LANDSCAPE NOTES
MASTER PLANT LIST
PLANTING SPECIFICATIONS
DETAILS

date	07-06-21	drawn	KMT	checked	KMT
job no.	21250				
sheet no.	L 2.1				

no.	1	2	3	4	5
revision	ISSUED FOR REVIEW				
description					
initial	KMT				
date	07-06-21				

Kathryn Talty
landscape architecture

Winnetka, Illinois 60093
847.612.5154
www.kmtaltdesign.com