

J:\Projects\Alpha\Lockport Township Park District\Prairie Bluff Pickleball-Range\09 Graphics\02 DD-CD\Layout and Materials Plan - Pickleball.dwg

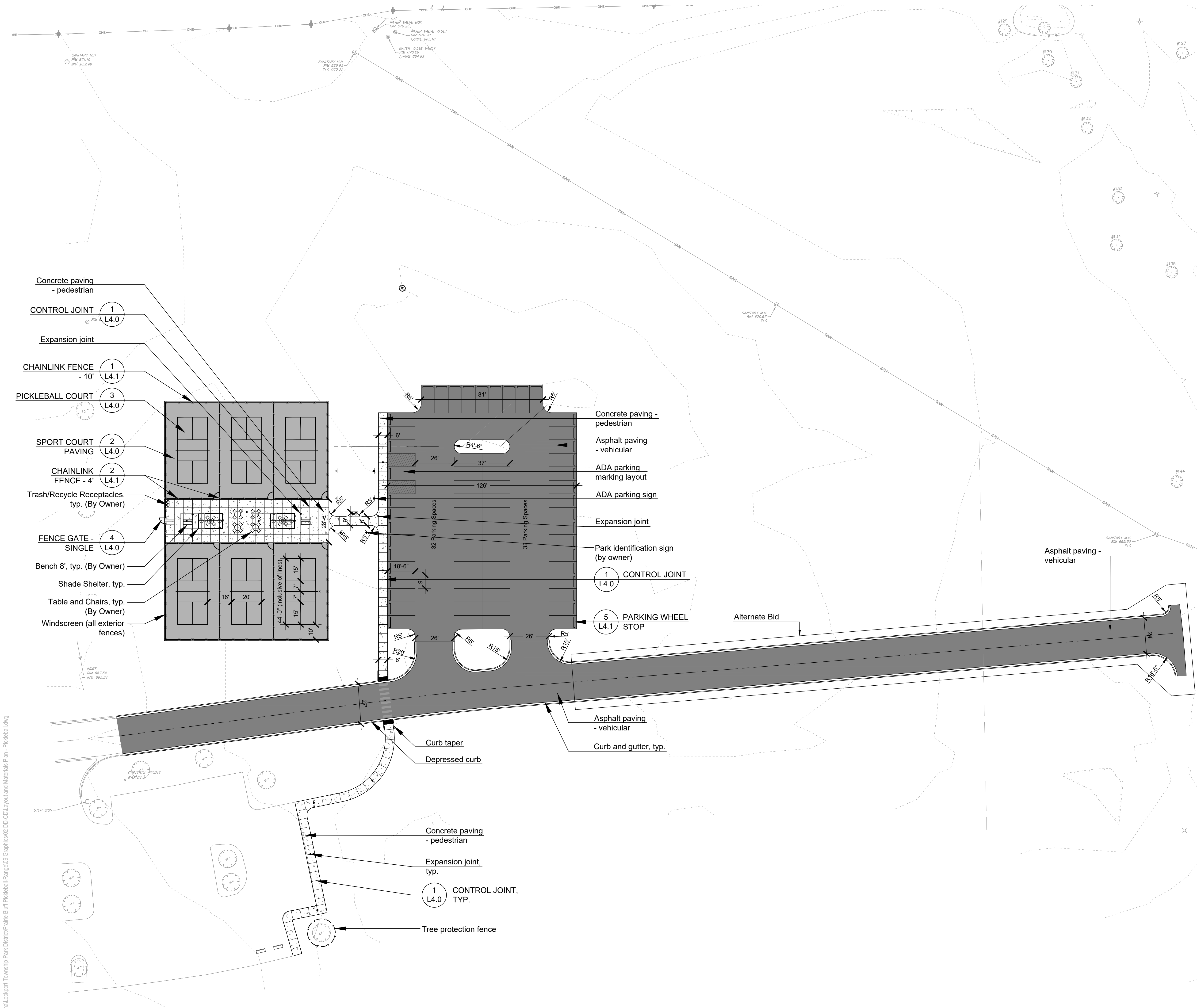

LAYOUT NOTES

1. Contractor responsible for field layout of all new improvements. Digital files of geometric information will be provided upon request in AutoCAD format. No additional payment will be made for adjustments necessary to construct the work as drawn.
2. Contractor responsible to coordinate work in order to obtain approval of all layout by Owners Representative prior to construction. No additional payment will be made to correct work if constructed incorrectly without pre-approval by Owners Representative.
3. Contractor responsible to maintain all layout stakes during construction. No additional payment will be made to replace layout stakes.
4. Place stakes at edges of sport courts, fields, limits of playground, shelter, and every 25 feet on center along centerline of all pathways for review by the Owner's Representative prior to earthwork operations.
5. All walls are dimensioned to Face of Wall unless otherwise noted.
6. All dimensions from roadway are from Back of Curb unless otherwise noted.
7. All curves and radii to be smooth and not segmented.
8. Contractor to provide layout stakes every 10 feet minimum for large arcs where radius points are not accessible.
9. Adjustment to stake locations due to discrepancies between coordinates and dimensions is incidental to the contract. No additional payments will be made for this work.
10. All roadway widths are measured from edge of pavement to edge of pavement unless otherwise shown on the plans.
11. Contractor responsible to take delivery, assemble and install all materials and furnishings per manufacturer's instructions.
12. Place control and expansion joints as shown on plans and details for all curbs, walks, walls, steps, and concrete paving. Where joints are not shown, place control joints a maximum of 10 feet on center, expansion joints a maximum of 30 feet on center, and between all separate pours.
13. Refer to specifications for additional conditions, standards and notes.

LAYOUT LEGEND

	Expansion Joint
	Asphalt Paving, Vehicular
	Concrete Paving, Vehicular
	Concrete Paving, Pedestrian
	Asphalt Paving, Pedestrian
	Asphalt Paving, Sport Court



22 E. Chicago Avenue
Suite 200A
Naperville, IL 60540
T 630.961.1787
hitchcockdesigngroup.com

PREPARED FOR Lockport Township Park District

1811 South Lawrence Avenue
Lockport, Illinois 60441

PROJECT Prairie Bluff Pickleball-Range

19433 Renwick Road
Crest Hill, Illinois 60403

CONSULTANTS
Civil Engineer
Ruettgiger, Tonelli &
Associates, Inc.
Shorewood, IL 60404
T 815.744.6600

Electrical Engineer
Nova Engineering PC
Schereville, IN 46375
T 219.865.3352

Architect
Jon S. Ditter Architect PLLC
Lockport, IL 60441
T 815.834.0522

ISSUE FOR BID
September 1, 2022
REVISIONS

No	Date	Issue

CHECKED BY
EFH

DRAWN BY
LJL / AMM

SHEET TITLE Layout and Materials Plan

SCALE IN FEET
1" = 30'

0' 15' 30' 90'

NORTH

SHEET NUMBER

L1.0

©2022 Hitchcock Design Group