

GENERAL NOTES: LANDSCAPE

- Notes indicated on grading plans shall pertain to landscape plans. Final grade of planting beds shall be as per grading plan.
- The landscape contractor shall be responsible for making themselves familiar with all underground utilities and structures.
- All existing plant material and trees shall be saved and protected unless otherwise noted. Contractor to protect new and existing trees and landscaping from damage and shall restore all areas disturbed as a result of construction.
- Plant material shall be supplied from Northern Illinois nursery stock, shall be dug the planting season it is installed, and shall conform to the American Association of Nurseryman's standards.
- Plant material shall be size and type specified. Substitution of plant material shall be on a case by case basis and approved in writing by the Owner's Representative. In no case shall plant material be smaller than indicated in the plans.
- Do not wilfully proceed with plantings as designed when it is obvious that obstructions and/or grade differences exist that may not have been known during the design process. Such conditions shall be immediately brought to the attention of the Owner's Representative.
- All plant material shall be inspected and approved by the Owner's Representative prior to the installation of any and all plant material.
- Plant locations shall be flagged in field with Owner's Rep. Final location of all plant material shall be subject to approval of the Owner's Representative prior to digging any holes. The landscape contractor is responsible for providing Owner's Representative with 48 hour minimum advance notice prior to planting.
- Plants shall be watered on the day they are planted and maintained with watering until final acceptance of the project.
- Apply a pre-emergent as per manufacturer's specification prior to installing mulch.
- Beds and tree rings (6" diameter) shall have 3" of hardwood shredded mulch applied and a 4" deep spade edge at lawn. Trees that are not located in beds, shall have a tree ring.
- Landscape plant material shall be guaranteed for 12 months from final acceptance. Any plant 1/3 dead or more shall be replaced under the guarantee.
- Contractor to prepare landscape beds by roto-tilling 2" of Mushroom Compost into new beds. Do not add compost nor roto-till within drip line of existing trees.
- Lawn Seeding shall be under favorable weather conditions, and shall follow dates in specification.
- Turf mixes shall be installed and lawn established at all disturbed areas.
- Do not overseed into mulch beds and paving.
- Contractor shall restore all areas disturbed as a result of construction.

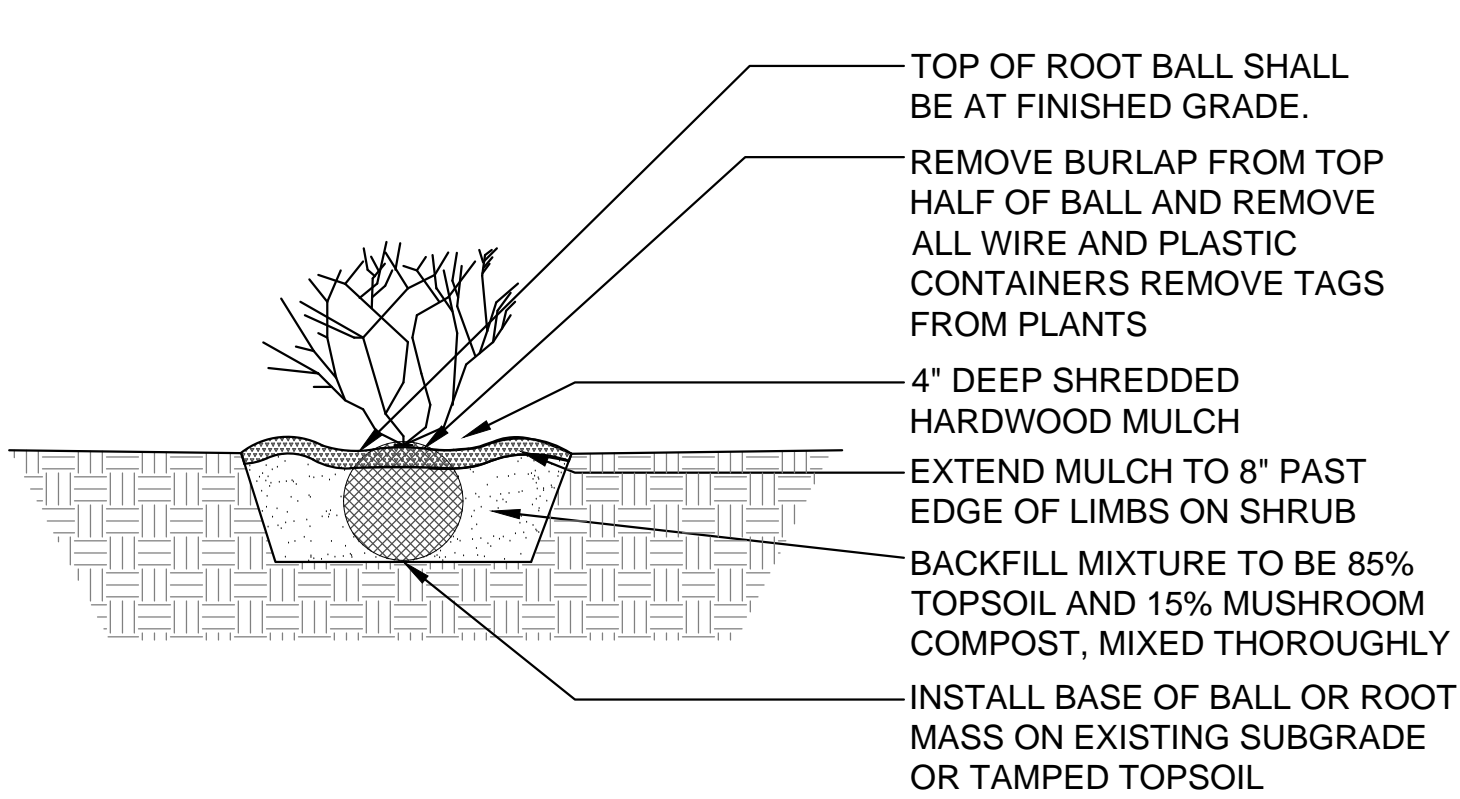

1 Shrub Installation

SCALE: N.T.S.

d-plant-shrub_12

PLANT LIST

Evergreen Shrubs - Balled and Burlap or Pot

6	24" Ht. x 24" Spr.	Juniperus chinensis var. sargentii 'Vividis'	Green Sargent Juniper
12	36" Ht. x 36" Wt.	Taxus x media 'Densiformis'	Dense Yew
8	24" Ht. x 24" Wt.	Thuja occidentalis 'Fire Chief'	Fire Chief Arborvitae
26	Total		

Deciduous Shrubs - Balled and Burlap or Pot

8	24" Ht. x 24" Spr.	Cornus sericea 'Kelseyi'	Dwarf Redosier Dogwood
6	24" Ht. x 24" Wt.	Hydrangea quercifolia 'Ruby Slippers'	Ruby Slippers Hydrangea
5	18" Ht. x 18" Wt.	Spiraea betulifolia 'COURISPIO 1'	Pink Sparkler Spirea
6	24" Ht. x 24" Wt.	Spiraea betulifolia 'Tor'	Birchleaf Spirea
25	Total		

LEGEND

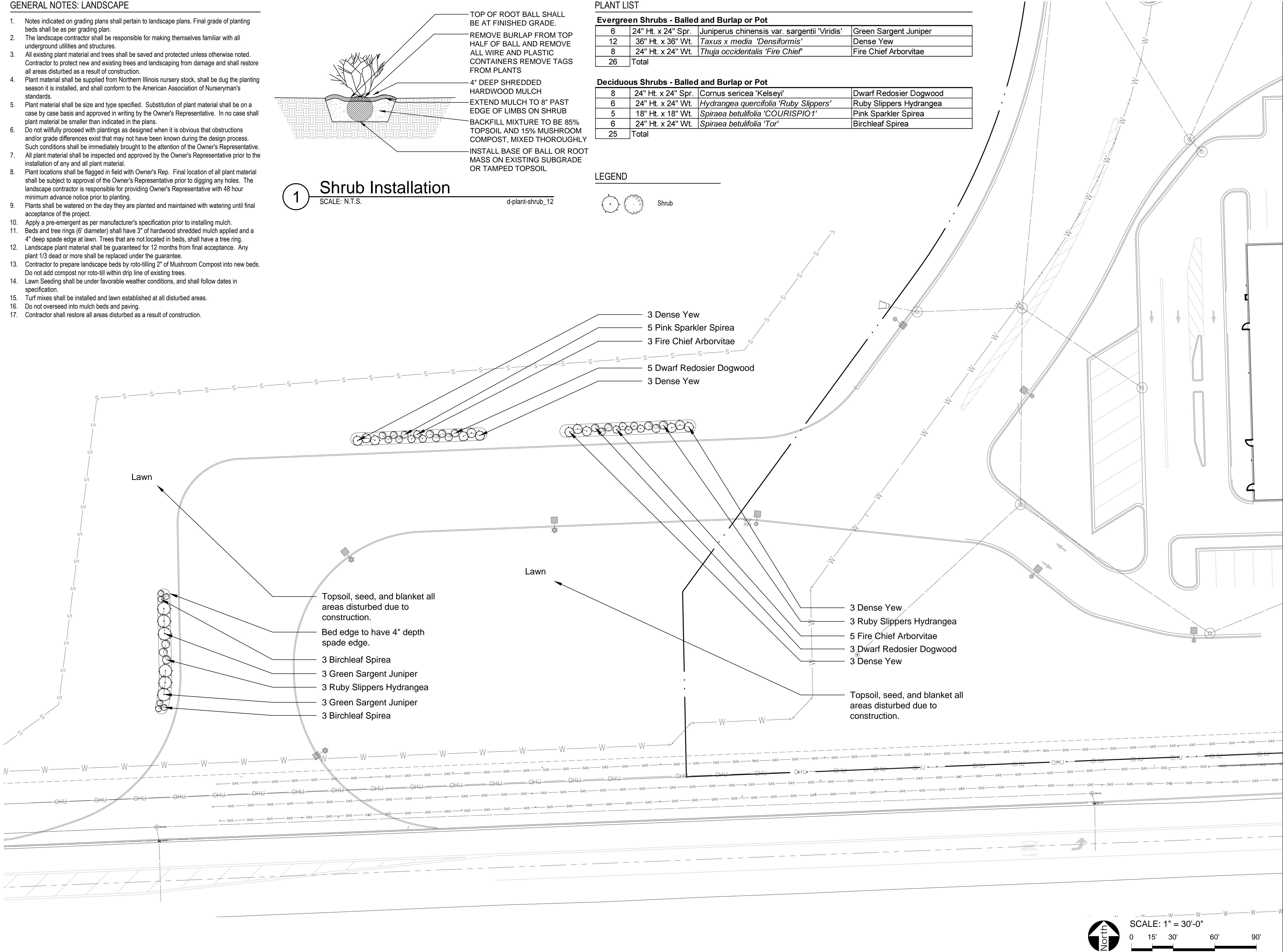
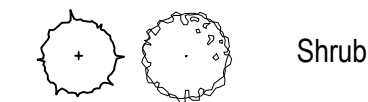

PROJECT

Gas N Wash

16664 Weber Rd
Crest Hill, IL 60403



uplandDesign Ltd

Park Planning and Landscape Architecture
24042 Lockport St, Plainfield, Illinois 60544
815-254-0091 www.uplanddesign.com

SHEET TITLE

Landscape Plan

SHEET NUMBER L1.0

DRAW / REVISION

CS/MO	Permit Submittal	11APR2024

Project Number 1261
© Copyright 2024 Upland Design Ltd.
W11261-Gas N Wash - Crest Hill - Len McEnery/30-CD-files
PLOT: UPLAND 2021