

CONTRACT PLANS COMPONENTS

- ROADWAY PLANS
- SIGNING AND PAVEMENT MARKING PLANS (TO BE INCLUDED NEXT SUBMITTAL)
- SIGNALIZATION PLANS (TO BE INCLUDED NEXT SUBMITTAL)
- LIGHTING PLANS (TO BE INCLUDED NEXT SUBMITTAL)

STATE OF FLORIDA
DEPARTMENT OF TRANSPORTATION

LIGHTING PLANS

FINANCIAL PROJECT ID 448399-1-52-01

BROWARD COUNTY (86015)

STATE ROAD NO. 818 (GRIFFIN ROAD)
RRR FROM W OF SW 90TH AVE TO SUNDANCE WAY

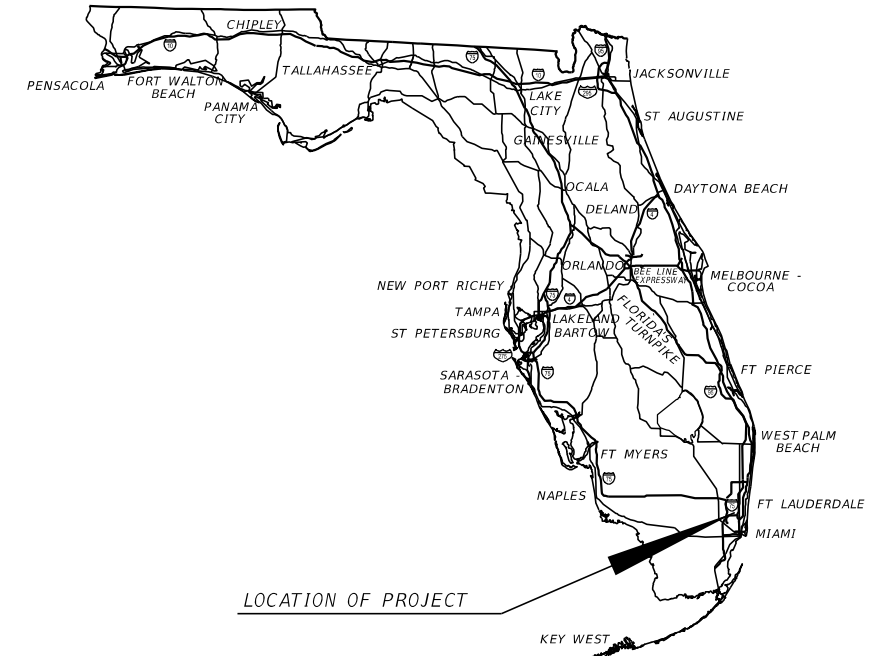

INDEX OF SIGNALIZATION PLANS

SHEET NO.	SHEET DESCRIPTION
L-1	KEY SHEET
L-2	GENERAL NOTES
L-3	LIGHTING DATA TABLE
L-4 - L-8	LIGHTING PLAN
L-9	SERVICE POINT DETAIL

PROJECT LOCATION URL:	https://tinyurl.com/4cy73rek
PROJECT LIMITS:	BEGIN MP 2.507 - END MP 3.924
EXCEPTIONS:	NONE
BRIDGE LIMITS:	NONE
RAILROAD CROSSING:	NONE

THIS ITEM HAS BEEN DIGITALLY SIGNED AND SEALED BY:

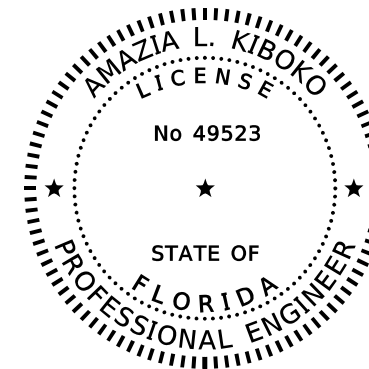

ON THE DATE ADJACENT TO THE SEAL PRINTED COPIES OF THIS DOCUMENT ARE NOT CONSIDERED SIGNED AND SEALED AND THE SIGNATURE MUST BE VERIFIED ON ANY ELECTRONIC COPIES.

**LIGHTING PLANS
ENGINEER OF RECORD:**

AMAZIA L. KIBOKO, P.E., PTOE
P.E. LICENSE NUMBER 49523
GOAL ASSOCIATES INC.
14750 NW 77TH COURT, SUITE 320
MIAMI LAKES, FL 33016
(786) 600-3350
CONTRACT NO.:
VENDOR NO.: F464649215

FDOT PROJECT MANAGER:
BRAD SALISBURY, P.E.

GOVERNING STANDARD PLANS:

Florida Department of Transportation, FY2024-25 Standard Plans for Road and Bridge Construction and applicable Interim Revisions (IRs).

Standard Plans for Road Construction and associated IRs are available at the following website: <http://www.fdot.gov/design/standardplans>

GOVERNING STANDARD SPECIFICATIONS:

Florida Department of Transportation, FY 2024-25 Standard Specifications for Road and Bridge Construction at the following website: <http://www.fdot.gov/programmanagement/Implemented/SpecBooks>

CONSTRUCTION CONTRACT NO.	FISCAL YEAR	SHEET NO.
TBD	26	L-1





GENERAL NOTES:

1. THE LIGHTING MAINTAINING AGENCY IS:

COOPER CITY
9090 SW 50TH PLACE
COOPER CITY, FL 33328

DELIVER REMOVED LIGHTING EQUIPMENT TO THE COOPER CITY PUBLIC WORKS DEPARTMENT LOCATED AT 9070 SW 51ST STREET, COOPER CITY, FL 33328.
CONTACT THE CITY AT LEAST SEVEN WORKING DAYS PRIOR TO INTENDED DELIVERY.

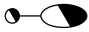
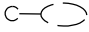
LIGHTING LEGEND

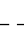
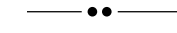
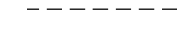
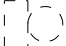
SYMBOL:	DESCRIPTION:
	LIGHT POLE COMPLETE WITH LED LUMINAIRE DESIGNED FOR 24,770.9 LUMENS, TYPE 3L MEDIUM DISTRIBUTION, 3000K CCT, RECTANGLE W/ LUMINOUS SIDES RECEPTACLE, AND WIRED FOR #V OPERATION. NO PHOTOCCELL REQUIRED. SINGLE ARM POLE. MAX CD: 17, 798.7 AT HORIZONTAL: 77.5, VERTICAL: 75
	RETROFIT LIGHT POLE WITH LED LUMINAIRE DESIGNED FOR 24,770.9 LUMENS, TYPE 3L MEDIUM DISTRIBUTION, 3000K CCT, RECTANGLE W/ LUMINOUS SIDES RECEPTACLE, AND WIRED FOR #V OPERATION. NO PHOTOCCELL REQUIRED. SINGLE ARM POLE. MAX CD: 17, 798.7 AT HORIZONTAL: 77.5, VERTICAL: 75
	LIGHT POLE COMPLETE WITH LED LUMINAIRE DESIGNED FOR 24,280.7 LUMENS, TYPE II MEDIUM DISTRIBUTION, 3000K CCT, RECTANGLE RECEPTACLE, AND WIRED FOR #V OPERATION. NO PHOTOCCELL REQUIRED. SINGLE ARM POLE. MAX CD: 17,281.0 AT HORIZONTAL: 80, VERTICAL: 72.5
	RETROFIT LIGHT POLE WITH LED LUMINAIRE DESIGNED FOR 16,912.2 LUMENS, TYPE II MEDIUM DISTRIBUTION NARROW ROADWAY, 3000 K CCT, 7 PIN PHOTOCNTROL CIRCULAR RECEPTACLE, AND WIRED FOR XV OPERATION. NO PHOTOCCELL REQUIRED. SINGLE ARM POLE. MAX CD: 14,304.2 AT HORIZONTAL: 75, VERTICAL: 67.5
	EXISTING LIGHT POLE TO REMAIN.
	PROPOSED PULL BOX.
	EXISTING PULL BOX.
	2" SCHEDULE 40 HDPE CONDUIT (DIRECTIONAL BORE) WITH THREE CONDUCTORS INSIDE THE CONDUIT: ONE WITH RED INSULATION, ONE WITH BLACK INSULATION, AND ONE GROUND WITH GREEN INSULATION. (NUMBER AND SIZE OF CONDUCTORS AS SHOWN ON PLAN SHEETS).
	EXISTING CONDUCTOR, CONDUITS AND PULL BOXES TO REMAIN UNLESS OTHERWISE NOTED ON PLANS.
	EXISTING SERVICE POINT TO REMAIN.

**SIGNALIZED INTERSECTION LIGHTING
DESIGN CRITERIA**

AVERAGE INITIAL HORIZONTAL ILLUMINATION	1.5 MIN. TO 3.0 STD. FOOT CANDLES
AVERAGE INITIAL VERTICAL ILLUMINATION	1.0 MIN. TO 1.5 STD. FOOT CANDLES
UNIFORMITY RATIO AVE./MIN.	4:1 OR LESS
UNIFORMITY RATIO MAX./MIN.	10:1 OR LESS
WIND SPEED	160 MPH

REVISIONS				ENGINEER OF RECORD		STATE OF FLORIDA DEPARTMENT OF TRANSPORTATION			GENERAL NOTES	SHEET NO.
DATE	DESCRIPTION	DATE	DESCRIPTION			ROAD NO.	COUNTY	FINANCIAL PROJECT ID		
				AMAZIA L. KIBOKO, P.E. LICENSE NUMBER: 49523 GOAL ASSOCIATES, INC. 14750 NW 77TH COURT, SUITE 320 MIAMI LAKES, FL 33016		SR 818	BROWARD	448399-1-52-01		L-2

**POLE DATA
SR 818 / GRIFFIN RD**

POLE NO.	CIRCUIT NO.	STATION	POLE OFFSET	POLE OWNER	MAINTAINING AGENCY	POLE TYPE	MOUNTING HEIGHT (ft.)	ARM LENGTH (ft.)	TILT ANGLE	ARM CONFIGURATION	INPUT WATTAGE	PHOTOMETRIC DATA FILE	POLE DETAILS	FOUNDATION TYPE	PAY ITEM
A-I-10	A-I	276+06.29	13.83' LT	COOPER CITY	BROWARD COUNTY	STANDARD	45	15	0	SINGLE	196	ATB2 P602 R3L 3K	RETROFIT EXIST. LIGHT POLE	N/A	715 11 211
A-I-11	A-I	277+39.08	13.87' LT	COOPER CITY	BROWARD COUNTY	STANDARD	45	15	0	SINGLE	196	ATB2 P602 R3L 3K	RETROFIT EXIST. LIGHT POLE	N/A	716 11 211
A-I-11B	A-I	275+21.13	114.08' RT	COOPER CITY	BROWARD COUNTY	STANDARD	35	15	0	SINGLE	196	ATB2 P602 R3L 3K	NEW POLE AND LUMINARE	SPREAD FOOTER	715 62 252
A-I-11A	A-I	277+21.11	133.08' RT	COOPER CITY	BROWARD COUNTY	STANDARD	40	12	0	SINGLE	175	ATB2 P601 R2 3K	NEW POLE AND LUMINARE	SPREAD FOOTER	715 62 342
A-I-11C	A-I	278+46.01	114.72' RT	COOPER CITY	BROWARD COUNTY	STANDARD	35	15	0	SINGLE	196	ATB2 P602 R3L 3K	NEW POLE AND LUMINARE	SPREAD FOOTER	715 62 252
A-II-23	A-II	294+45.19	13.71' LT	COOPER CITY	BROWARD COUNTY	STANDARD	50	15	0	SINGLE	196	ATB2 P602 R3L 3K	RETROFIT EXIST. LIGHT POLE	N/A	716 11 211
A-II-23A	A-II	294+84.26	17.36' LT	COOPER CITY	BROWARD COUNTY	STANDARD	45	12	0	SINGLE	175	ATB2 P601 R2 3K	NEW POLE AND LUMINARE	SPREAD FOOTER	715 62 442
A-II-24	A-II	296+10.60	13.76' LT	COOPER CITY	BROWARD COUNTY	STANDARD	50	15	0	SINGLE	196	ATB2 P602 R3L 3K	RETROFIT EXIST. LIGHT POLE	N/A	716 11 211
A-II-24A	A-II	293+83.40	116.12' RT	COOPER CITY	BROWARD COUNTY	STANDARD	35	15	0	SINGLE	196	ATB2 P602 R3L 3K	NEW POLE AND LUMINARE	SPREAD FOOTER	715 62 252
A-II-24B	A-II	296+89.01	117.61' RT	COOPER CITY	BROWARD COUNTY	STANDARD	35	15	0	SINGLE	196	ATB2 P602 R3L 3K	NEW POLE AND LUMINARE	SPREAD FOOTER	715 62 252
A-II-28	A-II	301+88.60	5.32' LT	COOPER CITY	BROWARD COUNTY	STANDARD	50	15	0	SINGLE	196	ATB2 P602 R3L 3K	RETROFIT EXIST. LIGHT POLE	N/A	716 11 211
A-II-29	A-II	303+38.49	5.27' LT	COOPER CITY	BROWARD COUNTY	STANDARD	50	15	0	SINGLE	196	ATB2 P602 R3L 3K	RETROFIT EXIST. LIGHT POLE	N/A	716 11 211
A-II-28B	A-II	301+02.68	116.16' RT	COOPER CITY	BROWARD COUNTY	STANDARD	35	15	0	SINGLE	196	ATB2 P602 R3L 3K	NEW POLE AND LUMINARE	SPREAD FOOTER	715 62 252
A-II-28A	A-II	302+02.62	148.76' RT	COOPER CITY	BROWARD COUNTY	STANDARD	40	12	0	SINGLE	175	ATB2 P601 R2 3K	NEW POLE AND LUMINARE	SPREAD FOOTER	715 62 342
A-II-28C	A-II	303+89.18	123.27' RT	COOPER CITY	BROWARD COUNTY	STANDARD	35	15	0	SINGLE	196	ATB2 P602 R3L 3K	NEW POLE AND LUMINARE	SPREAD FOOTER	715 62 252
A-II-35	A-II	310+70.75	9.67' LT	COOPER CITY	BROWARD COUNTY	STANDARD	45	12	0	DOUBLE	170	ATBL A XXXXX N2 3K	RETROFIT EXIST. LIGHT POLE	N/A	716 11 211
B-I-36	B-I	312+52.83	8.77' LT	TOWN OF DAVIE	BROWARD COUNTY	STANDARD	45	12	0	DOUBLE	170	ATBL A XXXXX N2 3K	RETROFIT EXIST. LIGHT POLE	N/A	716 11 211
18	EXIST.	310+81.02	141.54' RT	FPL	BROWARD COUNTY	STANDARD	45	12	0	DOUBLE	170	ATBL A XXXXX N2 3K	LUMINAIRE ON FPL POLE	N/A	-
19	EXIST.	312+64.37	124.32' RT	FPL	BROWARD COUNTY	STANDARD	45	12	0	DOUBLE	170	ATBL A XXXXX N2 3K	LUMINAIRE ON FPL POLE	N/A	-
B-I-44	B-I	322+15.90	6.11' LT	TOWN OF DAVIE	BROWARD COUNTY	STANDARD	50	15	0	SINGLE	196	ATB2 P602 R3L 3K	RETROFIT EXIST. LIGHT POLE	N/A	716 11 211
B-I-45	B-I	323+80.20	7.17' LT	TOWN OF DAVIE	BROWARD COUNTY	STANDARD	50	15	0	SINGLE	196	ATB2 P602 R3L 3K	RETROFIT EXIST. LIGHT POLE	N/A	716 11 211
B-I-47A	B-I	321+66.18	127.11' RT	TOWN OF DAVIE	BROWARD COUNTY	STANDARD	35	15	0	SINGLE	196	ATB2 P602 R3L 3K	NEW POLE AND LUMINARE	SPREAD FOOTER	715 62 252
B-I-47B	B-I	324+25.83	127.88' RT	TOWN OF DAVIE	BROWARD COUNTY	STANDARD	35	15	0	SINGLE	196	ATB2 P602 R3L 3K	NEW POLE AND LUMINARE	SPREAD FOOTER	715 62 252

REVISIONS				ENGINEER OF RECORD		STATE OF FLORIDA DEPARTMENT OF TRANSPORTATION			LIGHTING DATA TABLE	SHEET NO.
DATE	DESCRIPTION		DATE	DESCRIPTION		ROAD NO.	COUNTY	FINANCIAL PROJECT ID		L-3
						SR 818	BROWARD	448399-1-52-01		

AMAZIA L. KIBOKO, P.E.
LICENSE NUMBER: 49523
GOAL ASSOCIATES, INC.
14750 NW 77TH COURT, SUITE 320
MIAMI LAKES, FL 33016

THE OFFICIAL RECORD OF THIS SHEET IS THE ELECTRONIC FILE DIGITALLY SIGNED AND SEALED UNDER RULE 61G15-23.004, F.A.C.

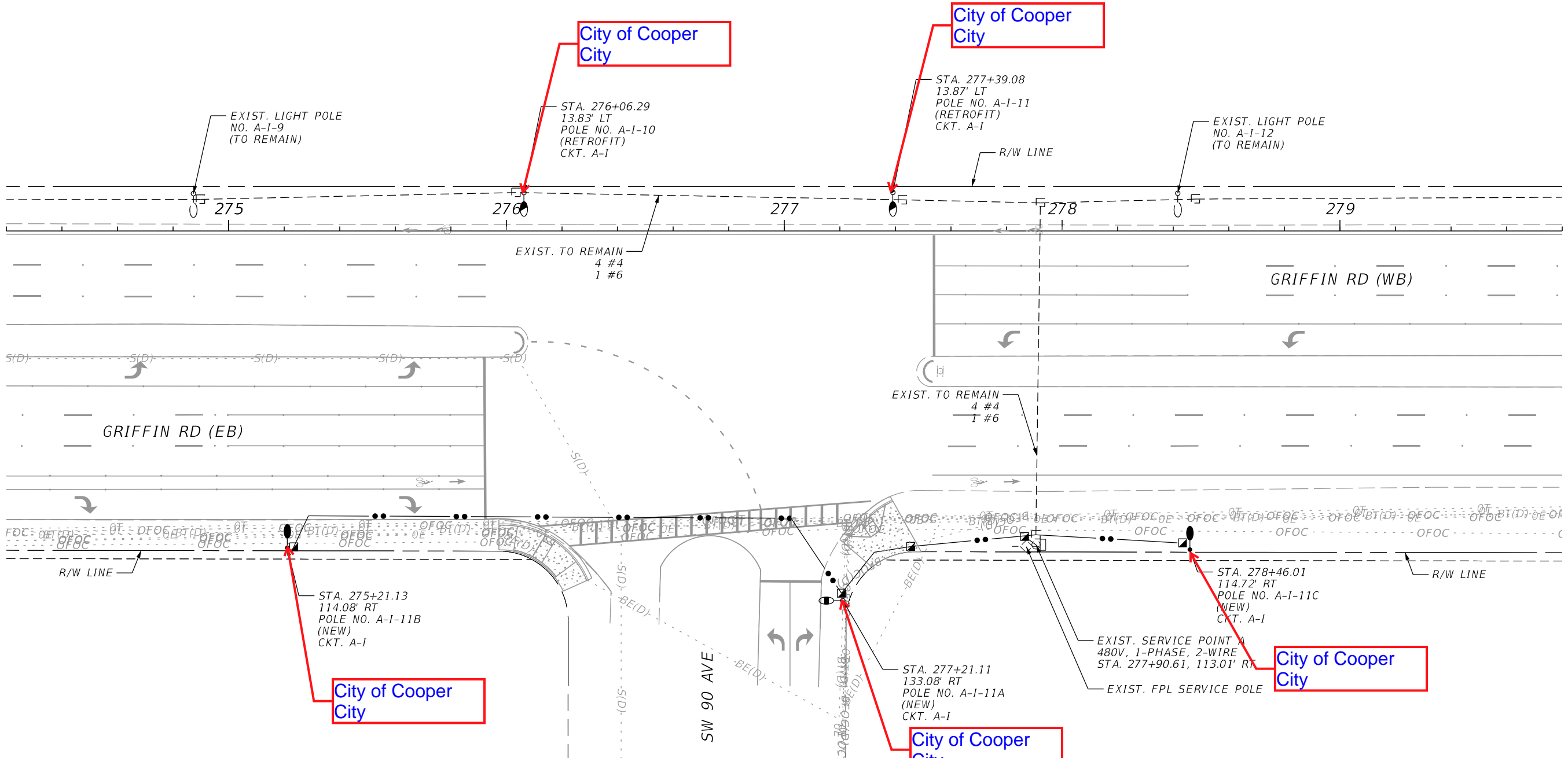
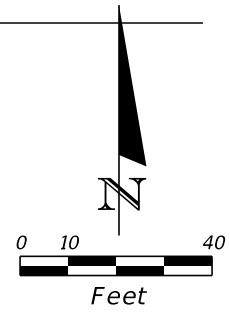

REVISIONS				ENGINEER OF RECORD			STATE OF FLORIDA DEPARTMENT OF TRANSPORTATION			SHEET NO.
DATE	DESCRIPTION	DATE	DESCRIPTION	AMAZIA L. KIBOKO, P.E. LICENSE NUMBER: 49523 GOAL ASSOCIATES, INC. 14750 NW 77TH COURT, SUITE 320 MIAMI LAKES, FL 33016			ROAD NO.	COUNTY	FINANCIAL PROJECT ID	
							SR 818	BROWARD	448399-1-52-01	L-4

LIGHTING PLANS

THE OFFICIAL RECORD OF THIS SHEET IS THE ELECTRONIC FILE DIGITALLY SIGNED AND SEALED UNDER RULE 61G15-23.004, F.A.C.

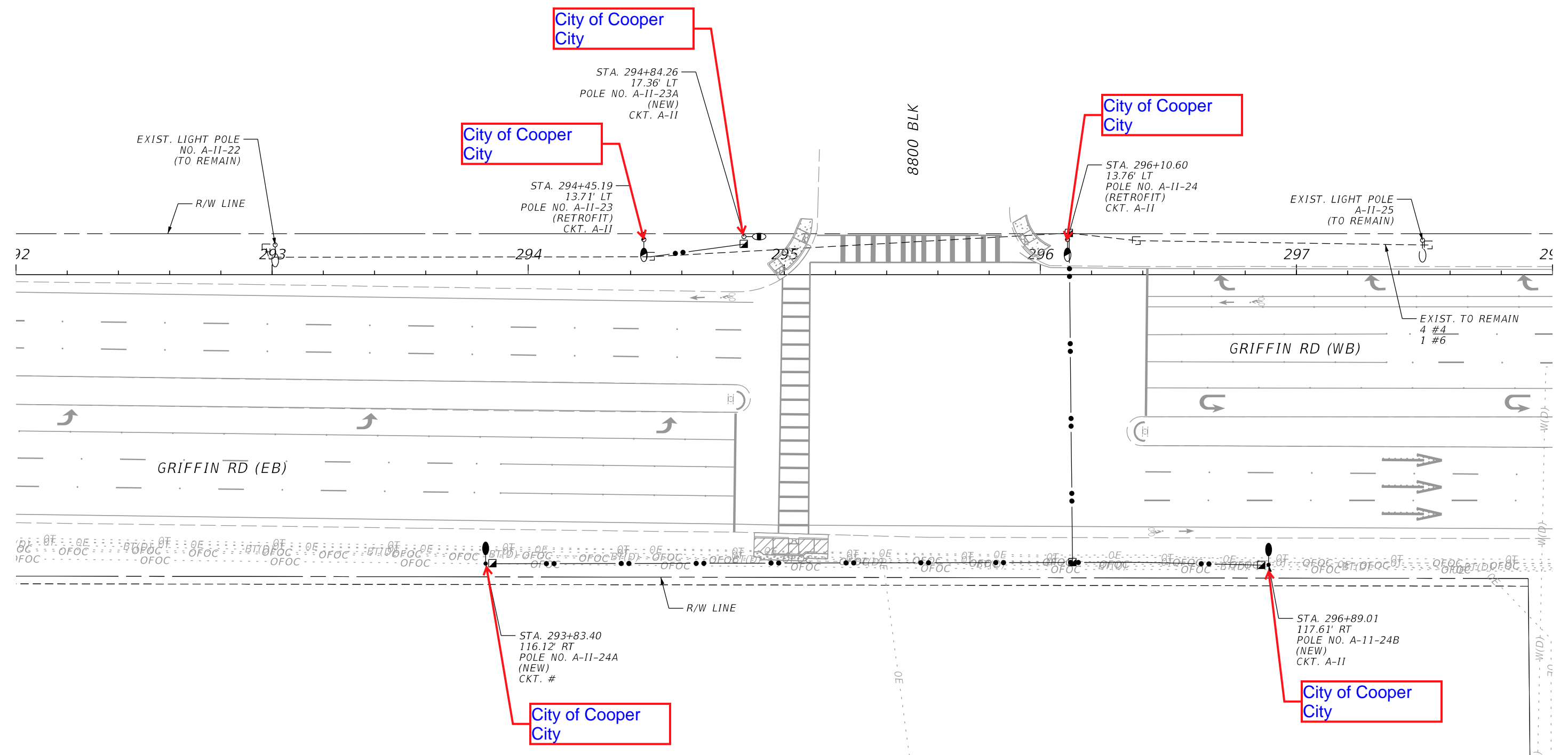
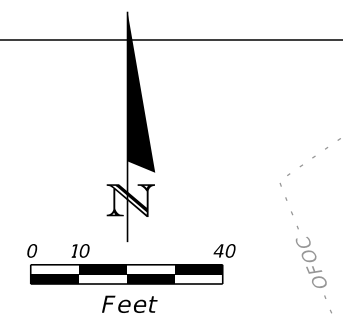

REVISIONS				ENGINEER OF RECORD		STATE OF FLORIDA DEPARTMENT OF TRANSPORTATION			SHEET NO.
DATE	DESCRIPTION	DATE	DESCRIPTION	AMAZIA L. KIBOKO, P.E. LICENSE NUMBER: 49523 GOAL ASSOCIATES, INC. 14750 NW 77TH COURT, SUITE 320 MIAMI LAKES, FL 33016		ROAD NO.	COUNTY	FINANCIAL PROJECT ID	
						SR 818	BROWARD	448399-1-52-01	L-5

LIGHTING PLAN

THE OFFICIAL RECORD OF THIS SHEET IS THE ELECTRONIC FILE DIGITALLY SIGNED AND SEALED UNDER RULE 61G15-23.004, F.A.C.

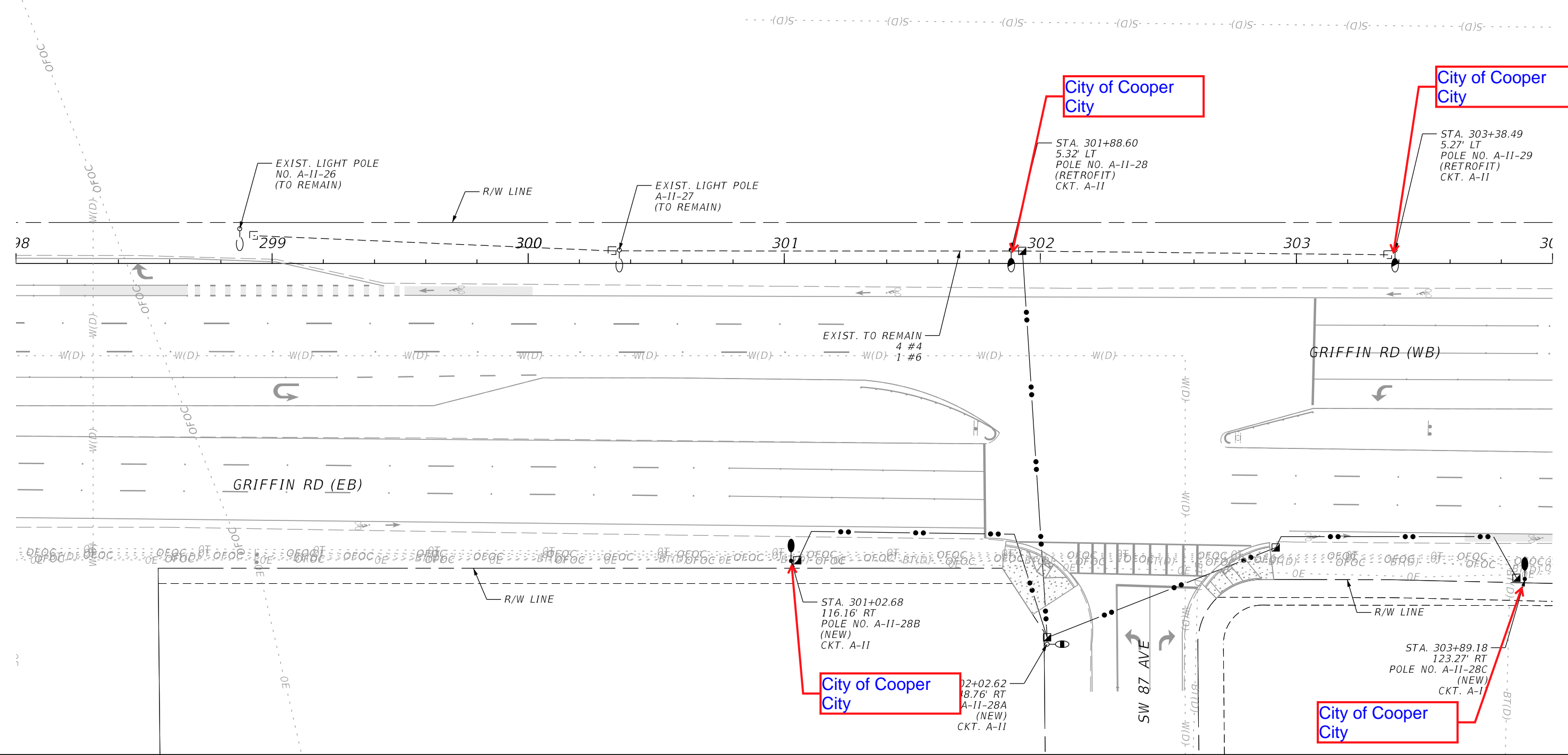
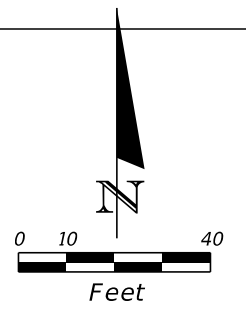

REVISIONS				ENGINEER OF RECORD		STATE OF FLORIDA DEPARTMENT OF TRANSPORTATION			SHEET NO.
DATE	DESCRIPTION	DATE	DESCRIPTION			ROAD NO.	COUNTY	FINANCIAL PROJECT ID	
				AMAZIA L. KIBOKO, P.E. LICENSE NUMBER: 49523 GOAL ASSOCIATES, INC. 14750 NW 77TH COURT, SUITE 320 MIAMI LAKES, FL 33016		SR 818	BROWARD	448399-1-52-01	L-6

LIGHTING PLAN

THE OFFICIAL RECORD OF THIS SHEET IS THE ELECTRONIC FILE DIGITALLY SIGNED AND SEALED UNDER RULE 61G15-23.004, F.A.C.

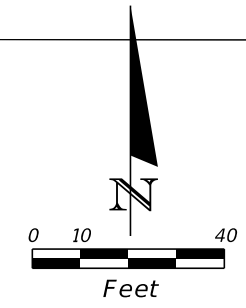

City of Cooper City

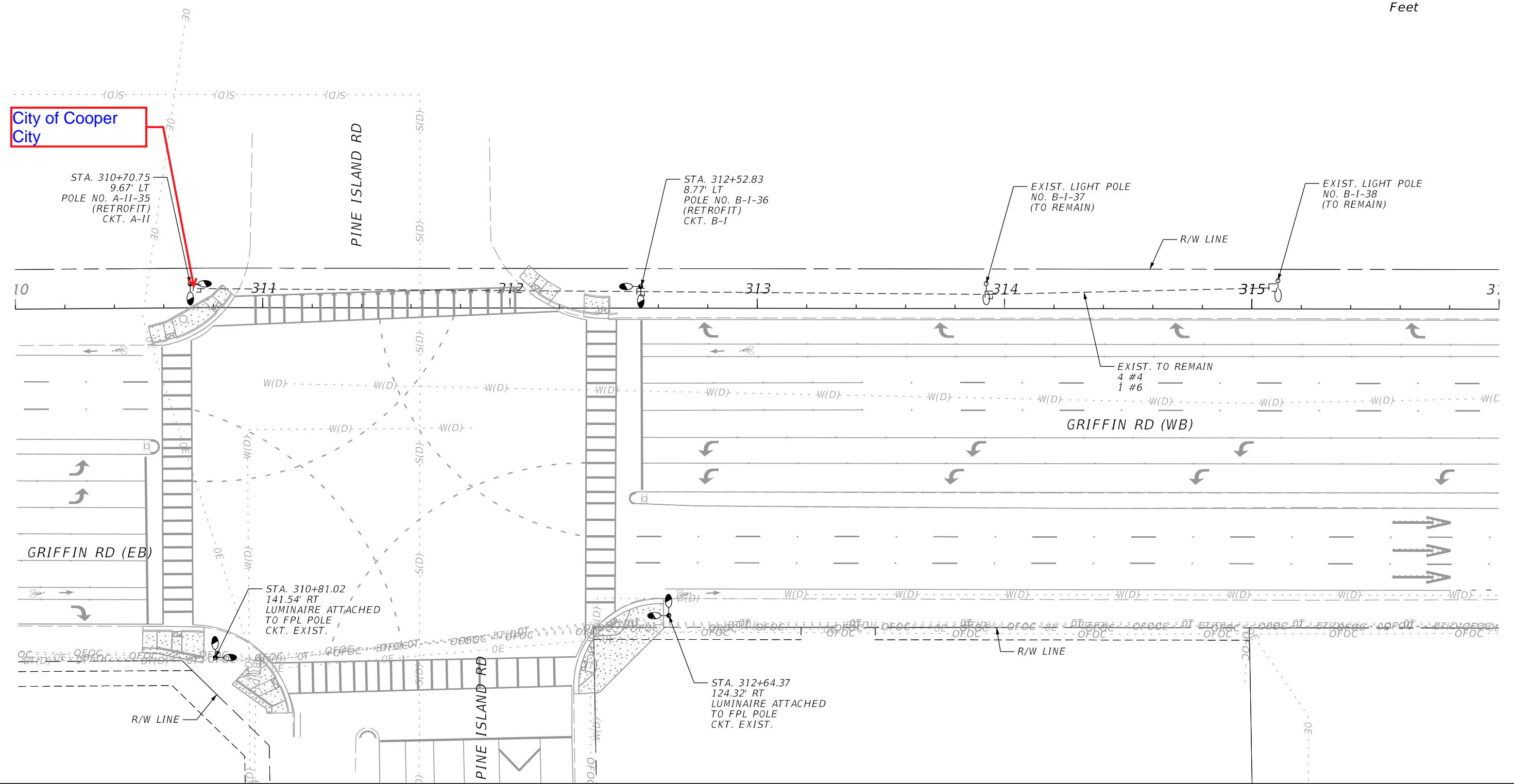

REVISIONS		REVISIONS		ENGINEER OF RECORD		STATE OF FLORIDA DEPARTMENT OF TRANSPORTATION			SHEET NO.
DATE	DESCRIPTION	DATE	DESCRIPTION			ROAD NO.	COUNTY	FINANCIAL PROJECT ID	
				AMAZIA L. KIBOKO, P.E. LICENSE NUMBER: 49523 GOAL ASSOCIATES, INC. 14750 NW 77TH COURT, SUITE 320 MIAMI LAKES, FL 33016		SR 818	BROWARD	448399-1-52-01	L-7

LIGHTING PLAN

THE OFFICIAL RECORD OF THIS SHEET IS THE ELECTRONIC FILE DIGITALLY SIGNED AND SEALED UNDER RULE 61G15-23.004, F.A.C.

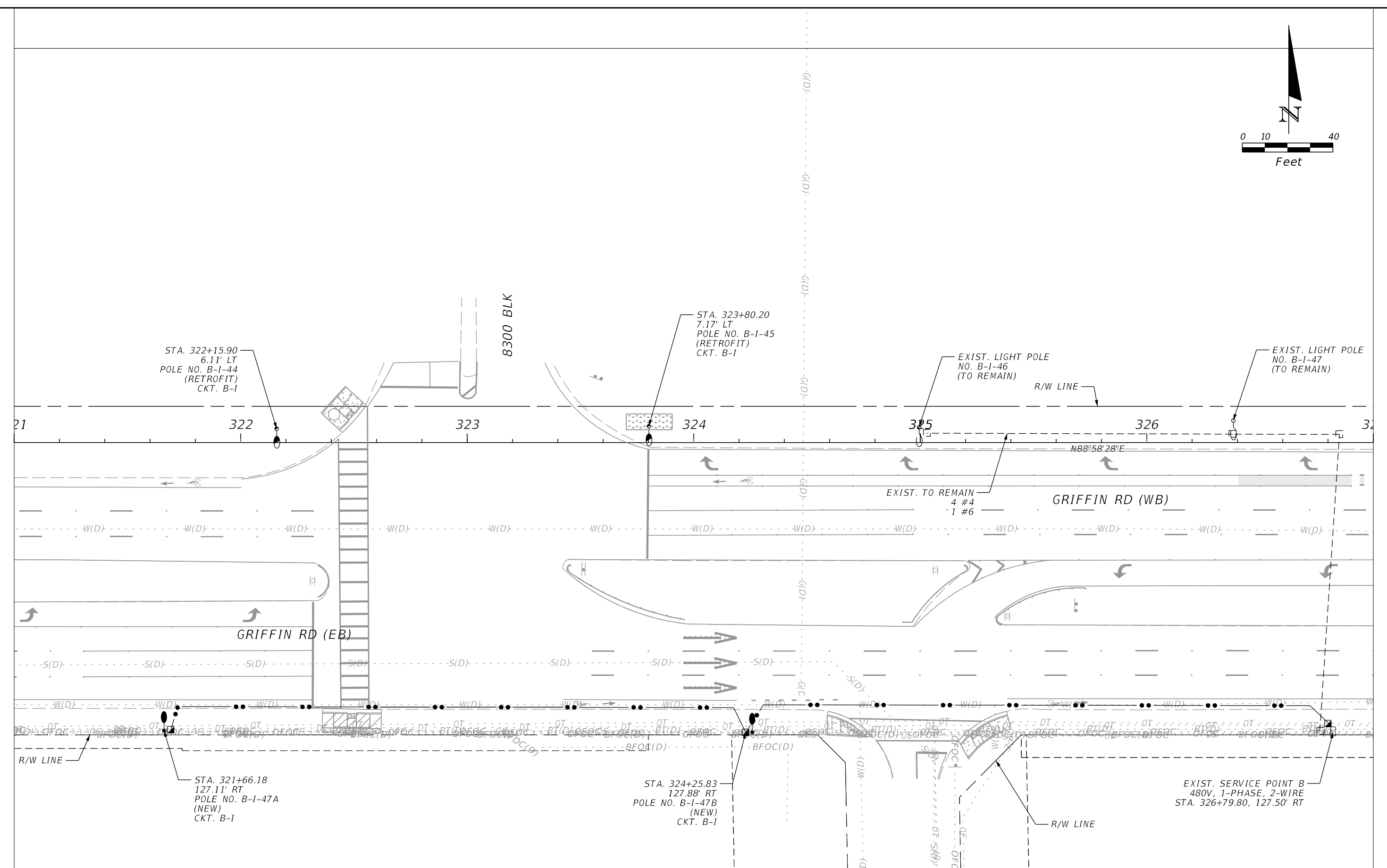
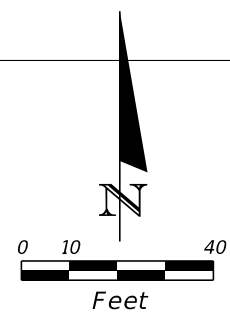

REVISIONS				ENGINEER OF RECORD		STATE OF FLORIDA DEPARTMENT OF TRANSPORTATION			SHEET NO. L-8
DATE	DESCRIPTION	DATE	DESCRIPTION	AMAZIA L. KIBOKO, P.E. LICENSE NUMBER: 49523 GOAL ASSOCIATES, INC. 14750 NW 77TH COURT, SUITE 320 MIAMI LAKES, FL 33016		ROAD NO.	COUNTY	FINANCIAL PROJECT ID	
						SR 818	BROWARD	448399-1-52-01	

LIGHTING PLAN

THE OFFICIAL RECORD OF THIS SHEET IS THE ELECTRONIC FILE DIGITALLY SIGNED AND SEALED UNDER RULE 61G15-23.004, F.A.C.

LOAD CENTERS

SERVICE POINT	CIRCUIT	TOTAL NO. OF FIXTURES	SYSTEM VOLTAGE (V)	CURRENT (A)	CONNECTED LOAD (VA)	DEMAND LOAD (AMPS)	BREAKER SIZE	BREAKER SIZE	MAINTAINING AGENCY
LOAD CENTER A STA. 227+90.61, 113.0' RT 480V, 1-PHASE, 2-WIRE	A-I	20	480	15.39	7388	19.24	30	60	COOPER CITY
	A-II	24	480	17.41	8355	21.76	30		
LOAD CENTER B STA. 326+79.80, 127.5' RT 480V, 1-PHASE, 2-WIRE	B-I	12	480	9.15	4392	11.44	20	60	TOWN OF DAVIE
	B-II	10	480	10.00	4800	12.50	20		

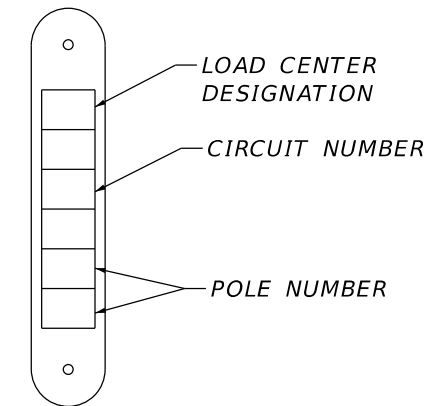

POLE IDENTIFICATION NUMBERS SHALL BE AS SHOWN IN THE POLE DATA SHEET

POLE IDENTIFICATION TAG DETAIL

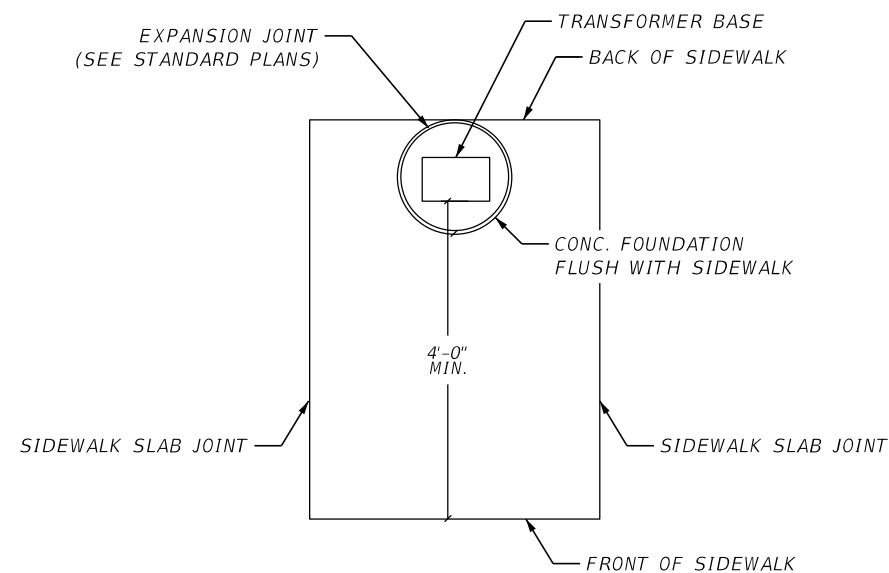

**LIGHT POLE
INSTALLATION DETAIL
ON SIDEWALK
(N.T.S)**

REVISIONS				ENGINEER OF RECORD		STATE OF FLORIDA DEPARTMENT OF TRANSPORTATION			SHEET NO. L-9
DATE	DESCRIPTION	DATE	DESCRIPTION	AMAZIA L. KIBOKO, P.E. LICENSE NUMBER: 49523 GOAL ASSOCIATES, INC. 14750 NW 77TH COURT, SUITE 320 MIAMI LAKES, FL 33016		ROAD NO.	COUNTY	FINANCIAL PROJECT ID	
						SR 818	BROWARD	448399-1-52-01	