

date: September 14, 2022  
to: Thomas Good, Public Works Director, Cooper City, Florida  
from: Eric Czerniejewski, P.E., ENV SP  
subject: Broward MAP Technical Memorandum- Proposed Roundabout Hiatus Road and NE Lake Boulevard

## MEMORANDUM

Enclosed please find a copy of the following items related to the potential Broward Mobility Advancement Program (MAP) project in Cooper City, Florida.

- Conceptual Traffic Calming Exhibit for Roundabout at Hiatus Road and NE Lake Boulevard
- AutoTURN Design Vehicle Maneuverability Tracking Exhibits

The conceptual design has been prepared based on available aerial imagery and ROW property information from the Broward County Property Appraiser site.

Please note the following based on our initial design evaluation of the potential intersection improvement:

- The Embassy Lakes entrance gate is approximately 150 LF east of Hiatus Road on NE Lake Boulevard. The entrance gate may impact the design transition for the roundabout.



- There are a couple locations where there appears to be ROW acquisition necessary. This includes NE Lake Boulevard east of Hiatus Road and the southwest corner of the intersection. Final evaluation would need to be determined during the design plan phase.



Please review and let us know if you have any questions, comments or suggested revisions.



ROW ACQUISITION  
227 SF

ICD 150 FT

HIATUS ROAD

MOUNTABLE  
TRUCK APRON

CENTRAL ISLAND  
RADIUS  
57 FT

NE LAKE BOULEVARD

ROW ACQUISITION  
13,264 SF

REVISIONS	
DATE	DESCRIPTION

Exhibit 3  
Page 4 of 11

ROAD NO.	COUNTY	FINANCIAL PROJECT ID

*PROPOSED ROUNDABOUT  
HIATUS RD & NE LAKE BLVD.*

SHEET NO.

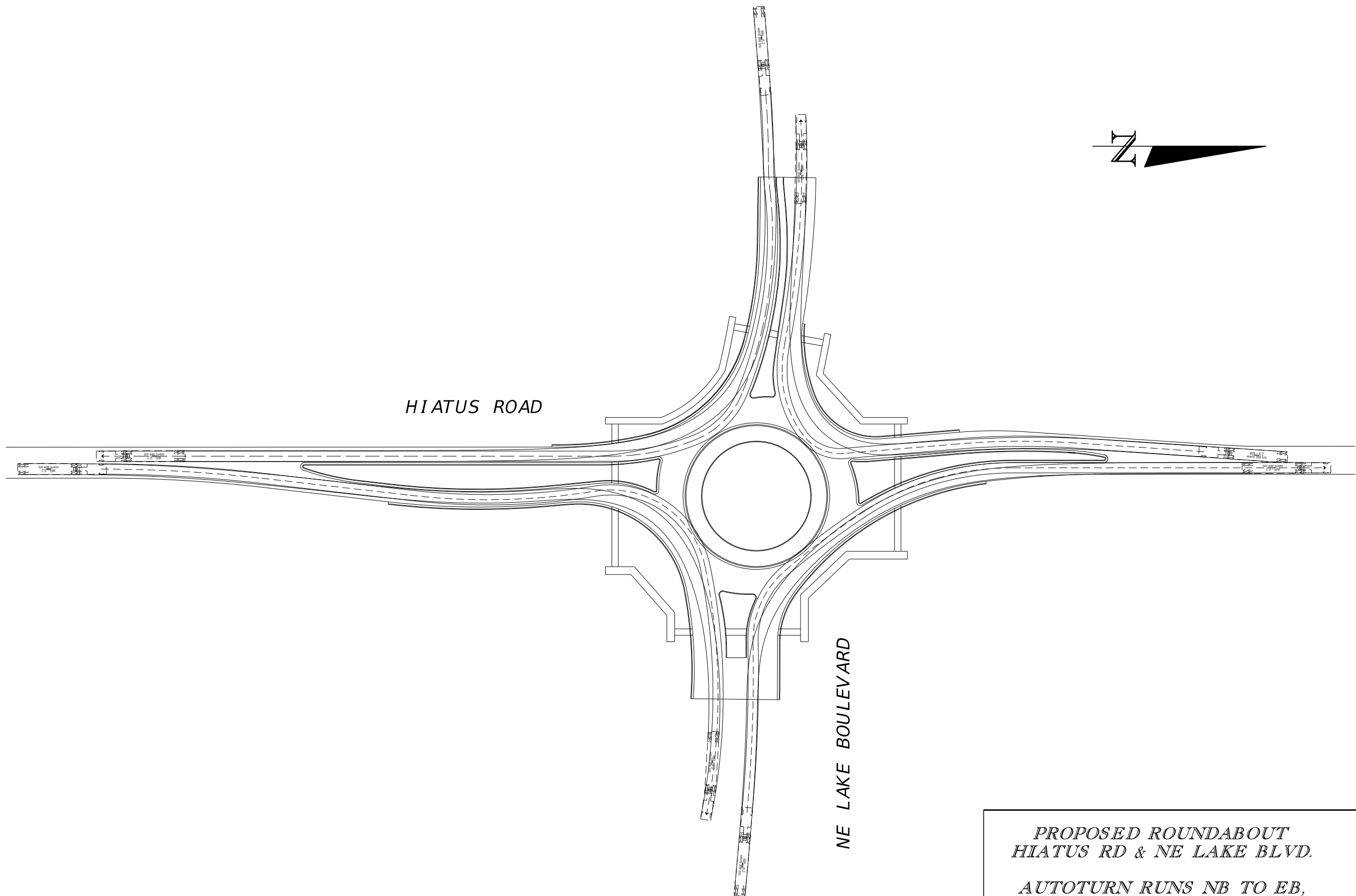

HIATUS ROAD

NE LAKE BOULEVARD

*PROPOSED ROUNDABOUT  
HIATUS RD & NE LAKE BLVD.  
AUTOTURN RUNS NB TO EB,  
WB TO NB, EB TO SB, SB TO WB*

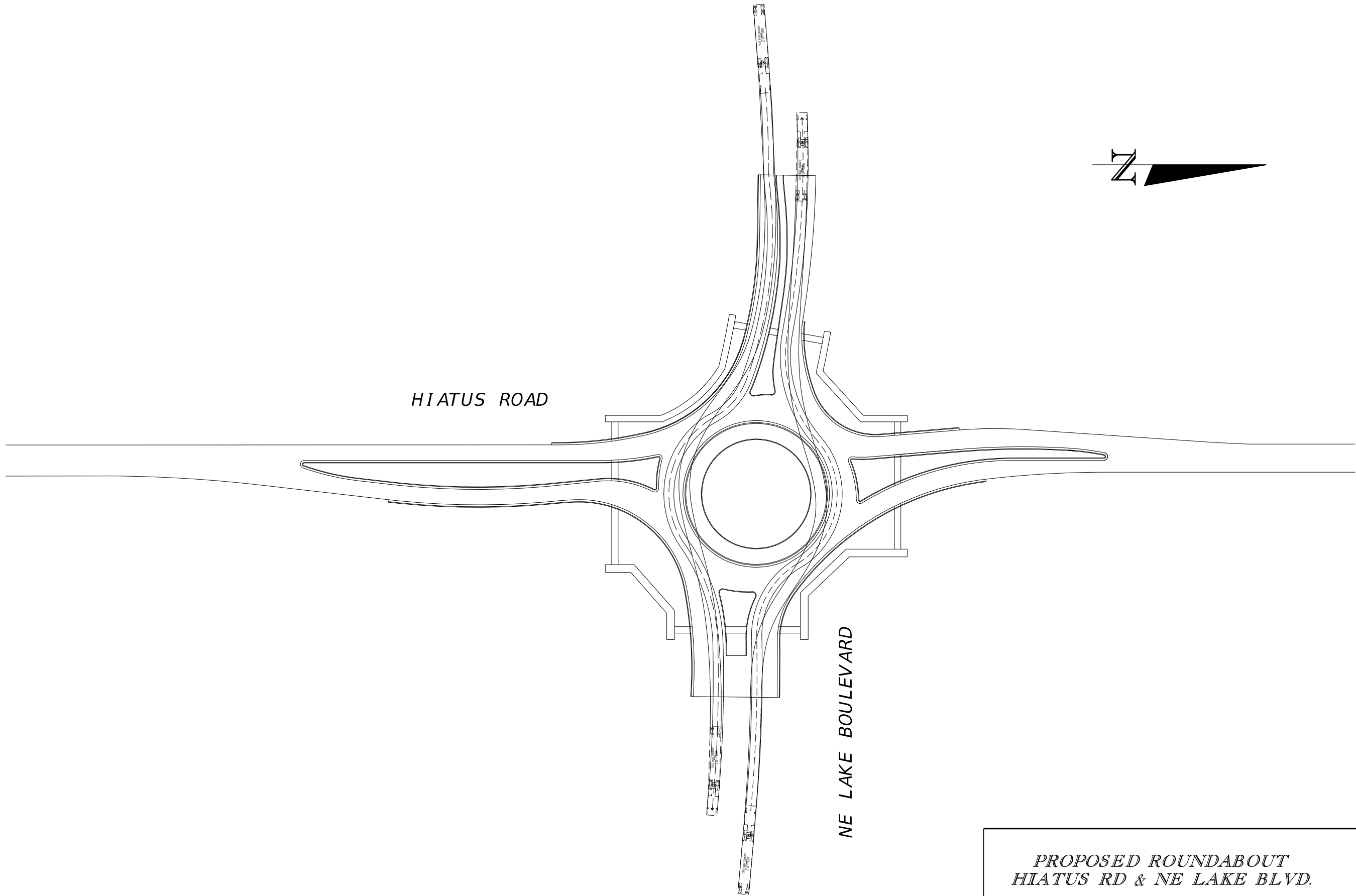

HIATUS ROAD

NE LAKE BOULEVARD

*PROPOSED ROUNDABOUT  
HIATUS RD & NE LAKE BLVD.  
AUTOTURN RUNS EB AND WB*

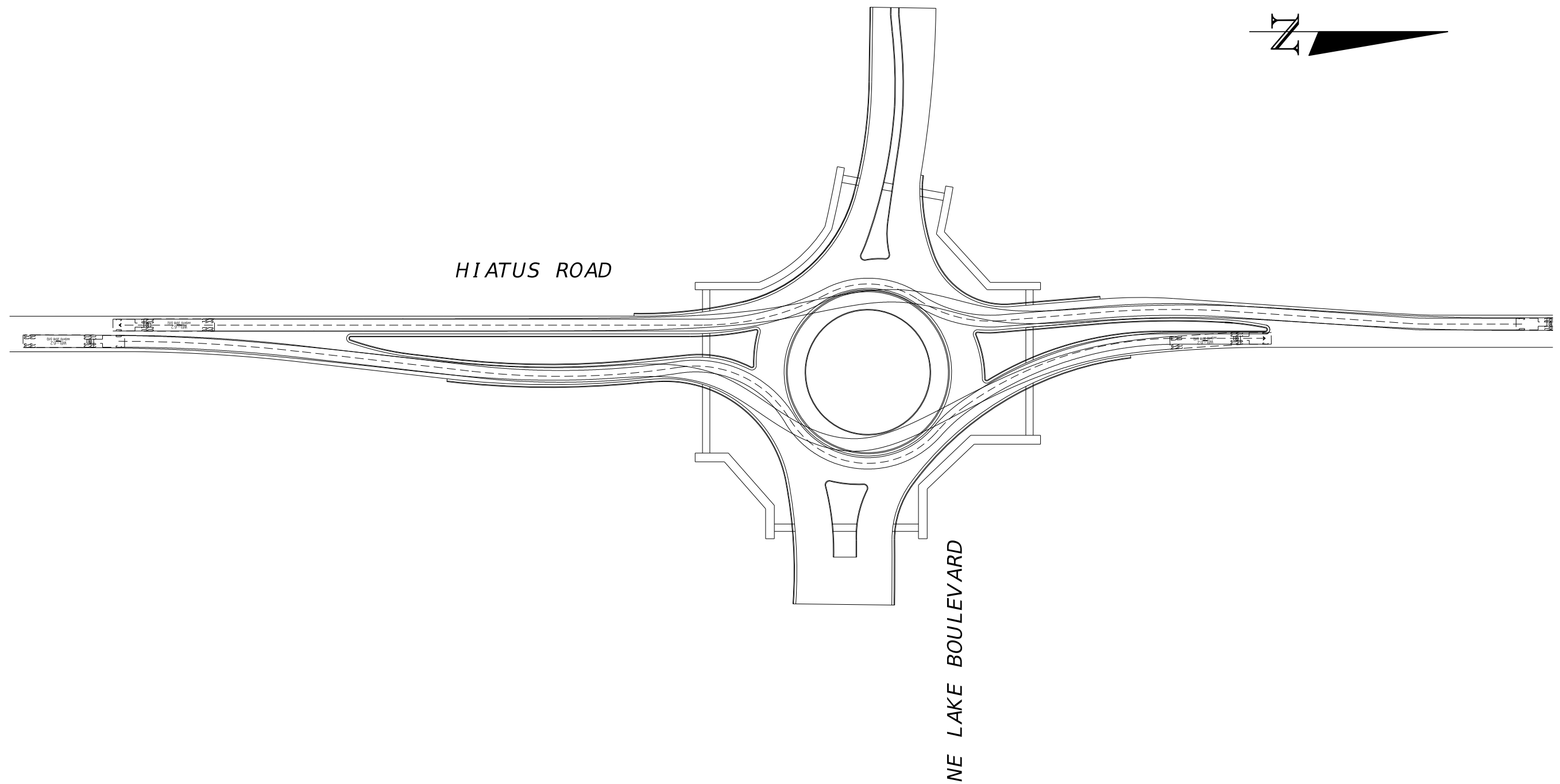

HIATUS ROAD

NE LAKE BOULEVARD

*PROPOSED ROUNDABOUT  
HIATUS RD & NE LAKE BLVD.*

*AUTOTURN RUNS NB AND SB*



HIATUS ROAD

NE LAKE BOULEVARD

PROPOSED ROUNDABOUT  
HIATUS RD & NE LAKE BLVD.

AUTOTURN RUN EB TO NB



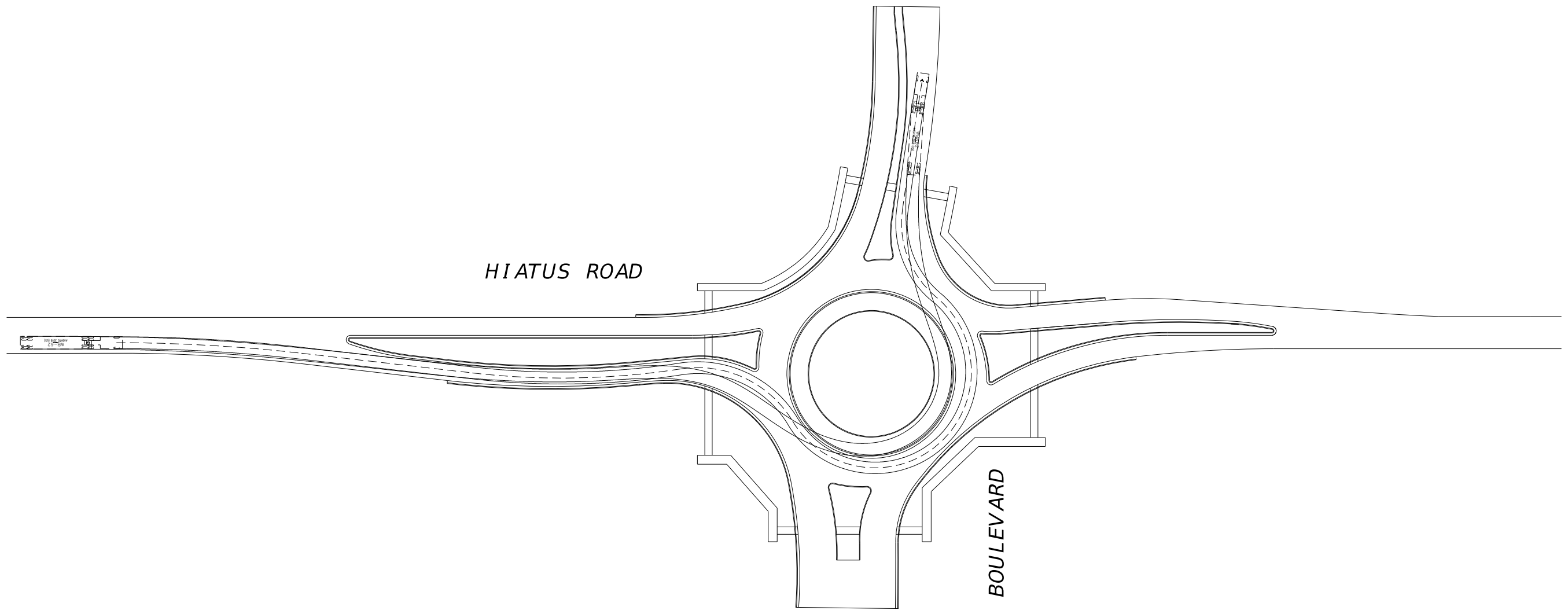

HIATUS ROAD

NE LAKE BOULEVARD

*PROPOSED ROUNDABOUT  
HIATUS RD & NE LAKE BLVD.  
AUTOTURN RUN NB TO WB*



*HIATUS ROAD*

*NE LAKE BOULEVARD*

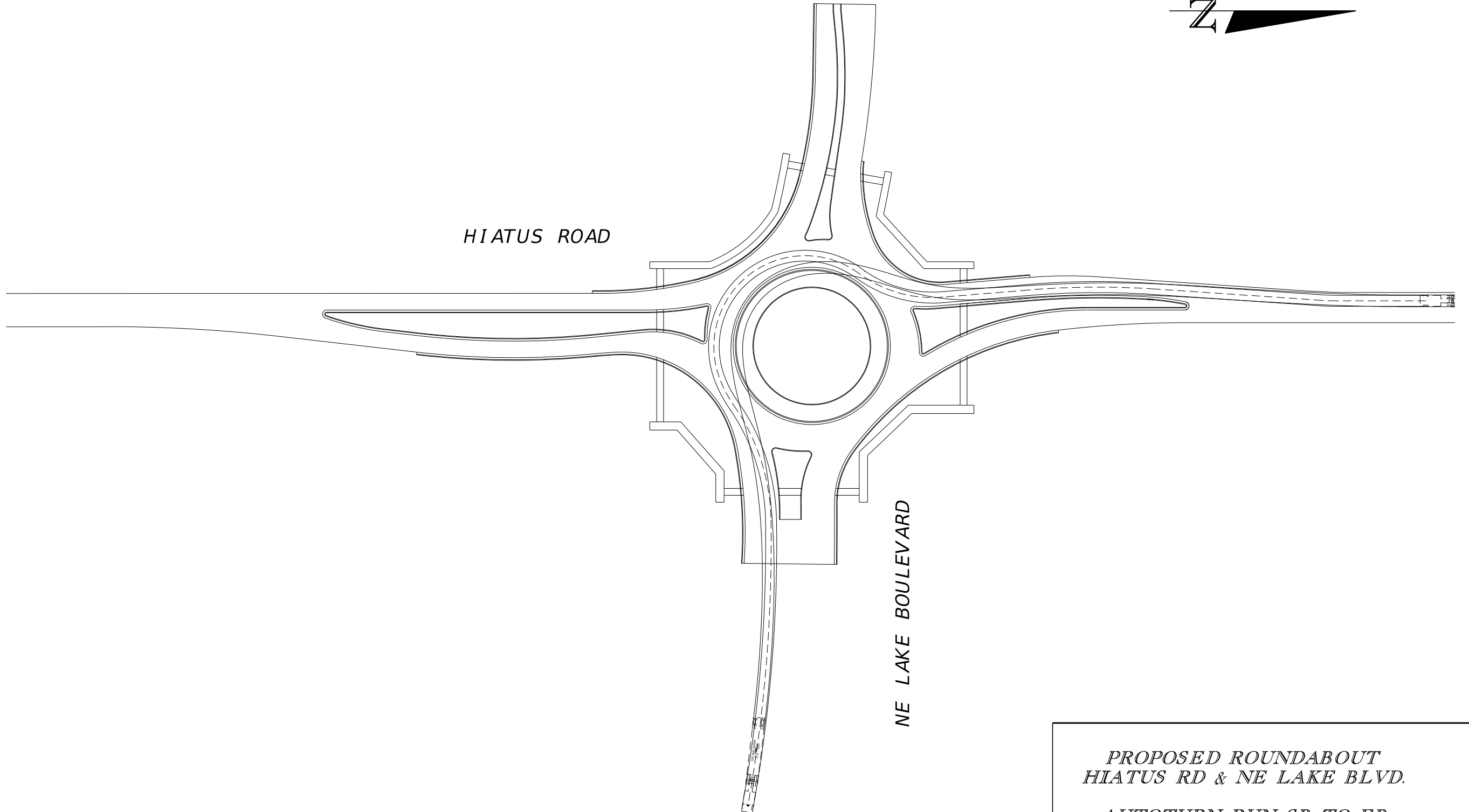

*PROPOSED ROUNDABOUT  
HIATUS RD & NE LAKE BLVD.  
AUTOTURN RUN SB TO EB*

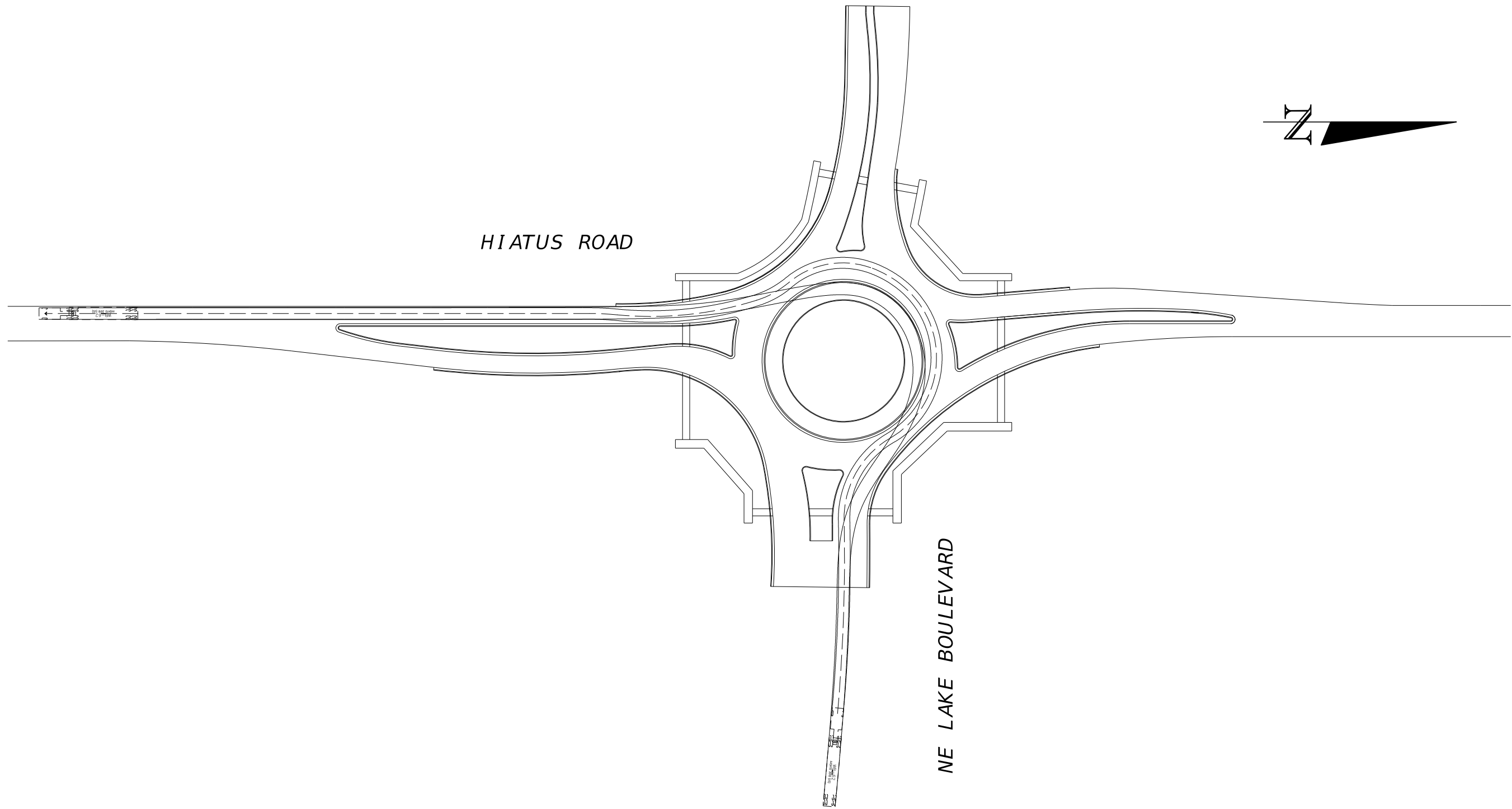

HIATUS ROAD

NE LAKE BOULEVARD



*PROPOSED ROUNDABOUT  
HIATUS RD & NE LAKE BLVD.*

*AUTOTURN RUN WB TO SB*