

"ALL EXISTING, PROTECTED TREES TO REMAIN; AND SHALL BE PROTECTED DURING DEMOLITION" (BY GENERAL CONTRACTOR)

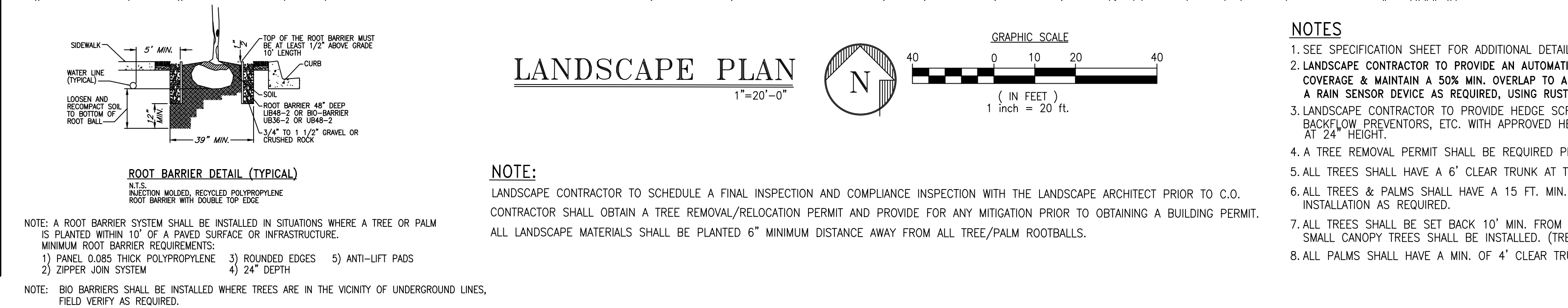

**Sunshine811**  
Call 811 or visit sunshine811.com two full business days before digging to have buried facilities located and marked.  
Check positive response codes before you dig!

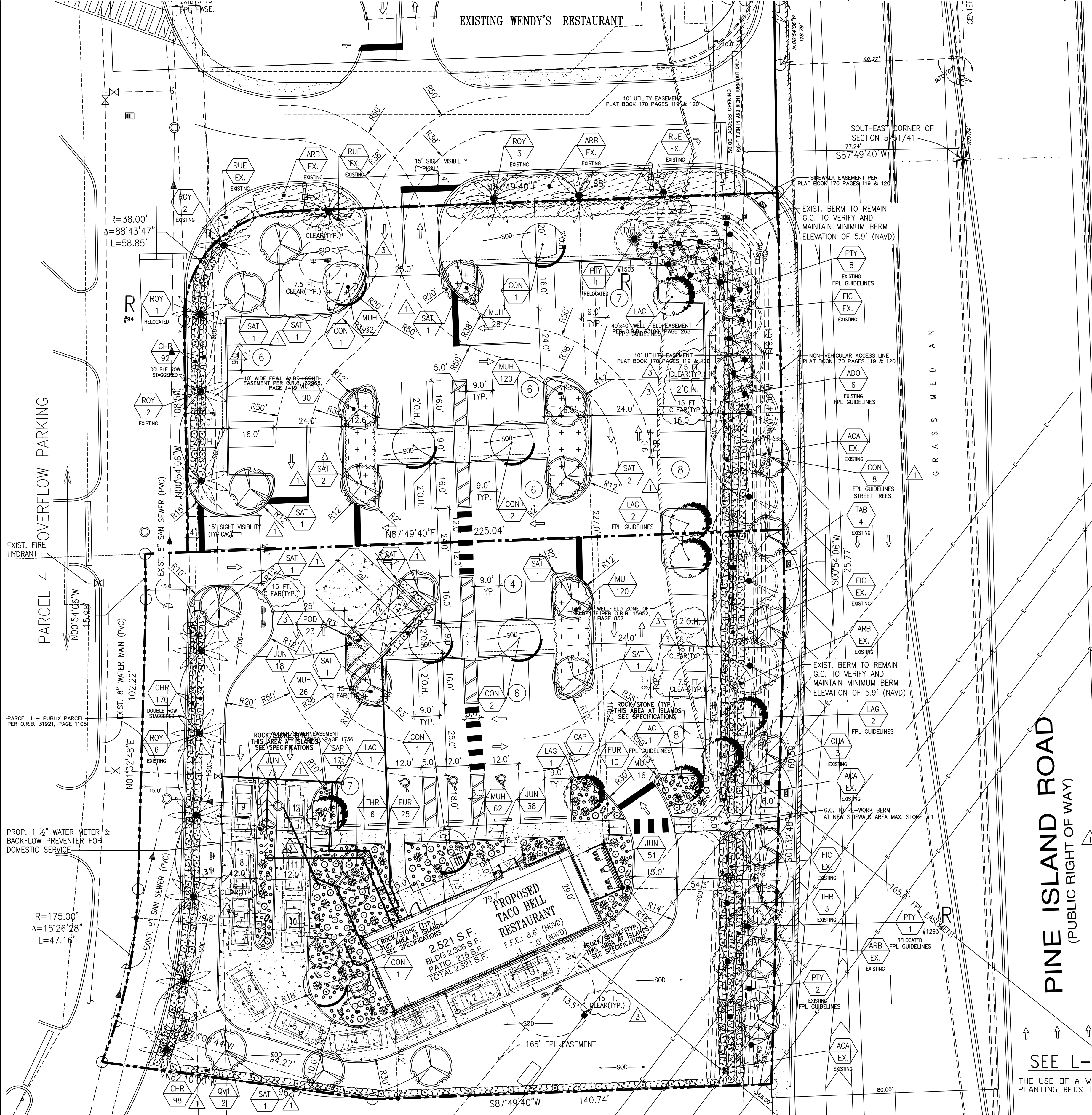
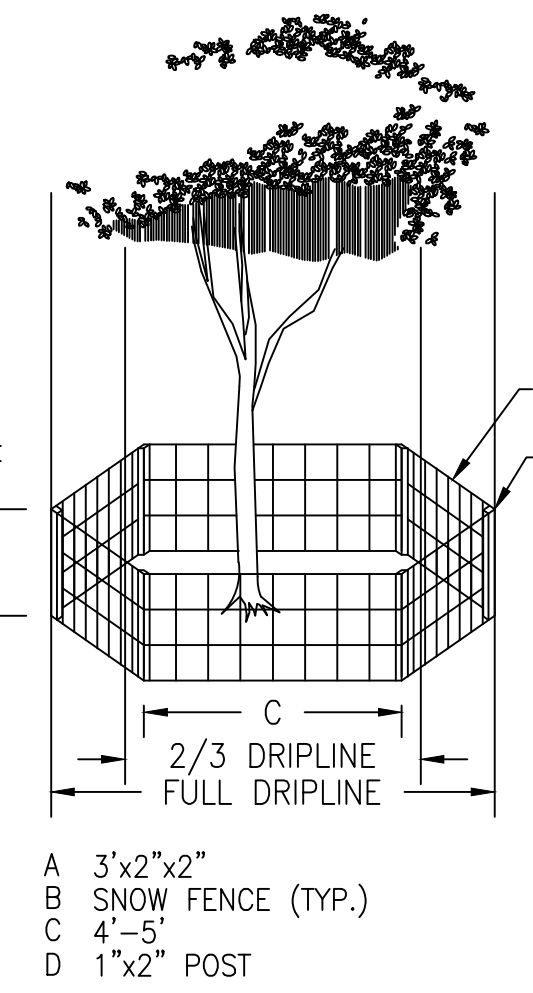
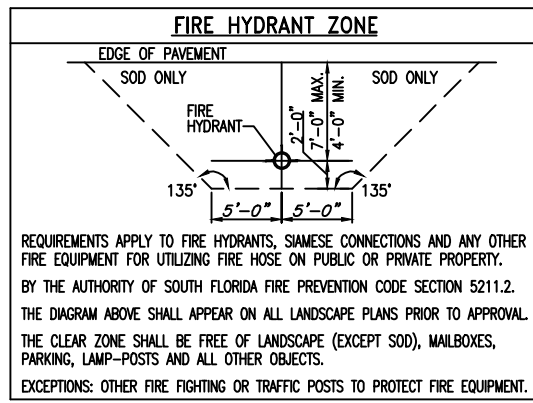

TREE BARRICADE DETAIL

NOTE: WATER SOURCE AND METHODS COMPLY WITH FLORIDA FRIENDLY LANDSCAPE NINE PRINCIPLES.  
DROUGHT TOLERANCE= SFWM GREEN BUILDING ORDINANCE REQUIRED SECTION 151.153#16 80% OF PLANTS, TREES, AND GRASSES PER "SOUTH FLORIDA WATER MANAGEMENT DISTRICT" RECOMMENDATIONS (LATEST EDITION).  
\* MODERATE  
\*\* VERY

LANDSCAPE LEGEND						
DROUGHT TOLERANCE	NATIVE	CODE	AMOUNT	BOTANICAL NAME / COMMON NAME	SIZE	REMARKS
**	YES	QV1	2	QUERCUS VIRGINIANA / LIVE OAK "HIGRISSE"	16"-18"X 7"-8"	F.G. 5' C.T. 3" CALIPER @D.B.H.
**	YES	SAT	14	CHRYSOPHYLLUM OLIVIFORME / SATINLEAF	16"-18"X 7"-8"	F.G. 5' C.T. 3" CALIPER @D.B.H.
**	YES	ROY	14	ROYSTONIA ELATA / FLORIDA ROYAL PALM	24"-36" X 20"	EXISTING TO REMAIN-RELOCATE (1) #94
**	NO	PTY	12	PTYCHOSPERMA ELEGANS / ALEXANDER PALM	20"-27" X 14"	EXISTING TO REMAIN-RELOCATE (2) #1293, #1503
**	NO	TAB	4	TABEBUIA PALLIDA / PINK TRUMPET	15"-24" X 18"	EXISTING TO REMAIN
*	NO	LAG	8	LAGERSTROMIA "NATCHEZ" GRAPE MYRTLE	15"-16"X 7"-8"	F.G. 5' C.T. "STANDARD" 2 1/2" CAL.
**	YES	THR	9	THRINAX RADIATA / FLORIDA THATCH PALM	14"-15" X 6"-7"	F.G. 8' C.T. (3) EXISTING TO REMAIN
**	YES	CON	16	CONOCARPUS SERICEUS / SILVER BUTTWOOD	14"-15" X 6"-7"	F.G. 5' C.T. "STANDARD" 2 1/2" CAL.
**	NO	CHA	3	CHAMEROPS HUMILIS / EUROPEAN FAN PALM	3'-4" HGT.	EXISTING TO REMAIN
**	NO	ADO	6	ADONIDIA MERRILLII / CHRISTMAS PALM	14"-15" X 12"	EXISTING TO REMAIN
**	NO	FIC	EX.	FICUS MICROCARPA / GREEN ISLAND	20"-24" HGT.	EXISTING TO REMAIN
*	NO	ARB	EX.	SCHOFFLERA ARBORICOLA / "TRINETTES"	20"-30" HGT.	EXISTING TO REMAIN
**	NO	FIC	EX.	FICUS MICROCARPA / GREEN ISLAND	24"-26" HGT.	EXISTING TO REMAIN
**	NO	ACA	EX.	ACALYPHA WILKESIANA / COOPER LEAF	3'-4" HGT.	EXISTING TO REMAIN
*	NO	RUE	EX.	RUELLIA BRITTONIANA / PURPLE SHOWERS	24"-32" HGT.	EXISTING TO REMAIN
*	NO	ARB	EX.	SCHOFFLERA ARBORICOLA / "TRINETTES"	24"-32" HGT.	EXISTING TO REMAIN
**	YES	MUH	494	MUHLENBERGIA CAPILLARIS / PINK MUHLY GRASS	24" X 18" 3 GAL.	24" O.C. -AS SHOWN
**	YES	CHR	360	CHRYSOBALANUS ICACO / RED TIP	24" X 24" 3 GAL.	24" O.C. FULL TO BASE
**	NO	POD	23	PODOCARPUS MACROPHYLLUS / YEW PODOCARPUS	48" X 24" 7 GAL.	24" O.C. FULL TO BASE
--	--	CAP	24	SANDSTONE BOULDER/DESERT SAND COLOR	34"X26"X20"	AS SHOWN (INSTALL HALF WAY INTO GROUND)
**	NO	FUR	35	FURCRAEA FOETIDA / GIANT FALSE AGAVE	30" X 30" 7 GAL.	AS SHOWN
**	NO	JUN	182	JUNIPER HORIZONTALIS / CREEPING JUNIPER	6" 1 GAL.	18" O.C. MIN. -AS SHOWN FULL POT
-	-	RED GRANITE	32 CYS	+- RED GRANITE 3" AGGREGATE GRAVEL-VERIFY	-	3" DEPTH MIN.
-	-	MULCH	36 CYS	+- SHREDDED "FLORIMULCH"-VERIFY	-	3" DEPTH MIN.

LANDSCAPE DATA- COOPER CITY, FL CODE OF ORDINANCES		
CATEGORY	REQUIRED	PROVIDED
SEC. 25-42 PERIMETER LANDSCAPE V.U.A. 25 FT BUFFER; 1 TREE PER 25 L.F.(314.15 L.F.)	13	13
SEC. 25-43 INTERIOR LANDSCAPE V.U.A.		
(1) 10 S.F. PER EACH PARKING SPACE (Ø 60 SPACES=600 S.F.)	600 S.F.	600 S.F.
(2) 1 S.F. PER 100 S.F. ASPHALT AREA:	323 S.F.	323 S.F.
(7) PARKING ISLANDS 1 TREE PER ISLAND (TREES 16" MIN. HT.)	18	18
SEC. 25-44 LANDSCAPE STREET BUFFERS		
(E) BERMS (2)b. 42" HTS.	YES	YES (EXISTING)
(F) TREES 1 PER 30 L.F. MIN. HTS. 15". (314.15 L.F.)	13	13
(G) B. SHRUBS 20/40 L.F. Ø 24" O.C.	314	314+ (EXISTING)
SEC. 25-45 STREET SWALE LANDSCAPE REQUIREMENTS		
(2) ONE SWALE TREE PER 40 L.F. OF SWALE. (TREES 14' MIN. HT.) 314.15 L.F.	8	1 8
SEC. 25-47 SUPPLEMENTAL LANDSCAPE REQUIREMENT: COMMERCIAL DEVELOPMENT		
1 TREE/5 SHRUBS PER 1000 S.F. NOT UTILIZED FOR PARKING (7,243.00 SQ.FT.)	7/35	7/416 (EXISTING)
SEC. 25-49 (E) TREE SPECIES MIX = 41+	5	9
TOTAL SHADE TREES 50% MIN.	30	30
TOTAL TREES	59	59

NOTE: A ROOT BARRIER SYSTEM SHALL BE INSTALLED IN SITUATIONS WHERE A TREE OR PALM IS PLANTED WITHIN 10' OF A PAVED SURFACE OR INFRASTRUCTURE. MINIMUM ROOT BARRIER REQUIREMENTS: 1) PANEL 0.085 THICK POLYPROPYLENE 2) 25\"/>

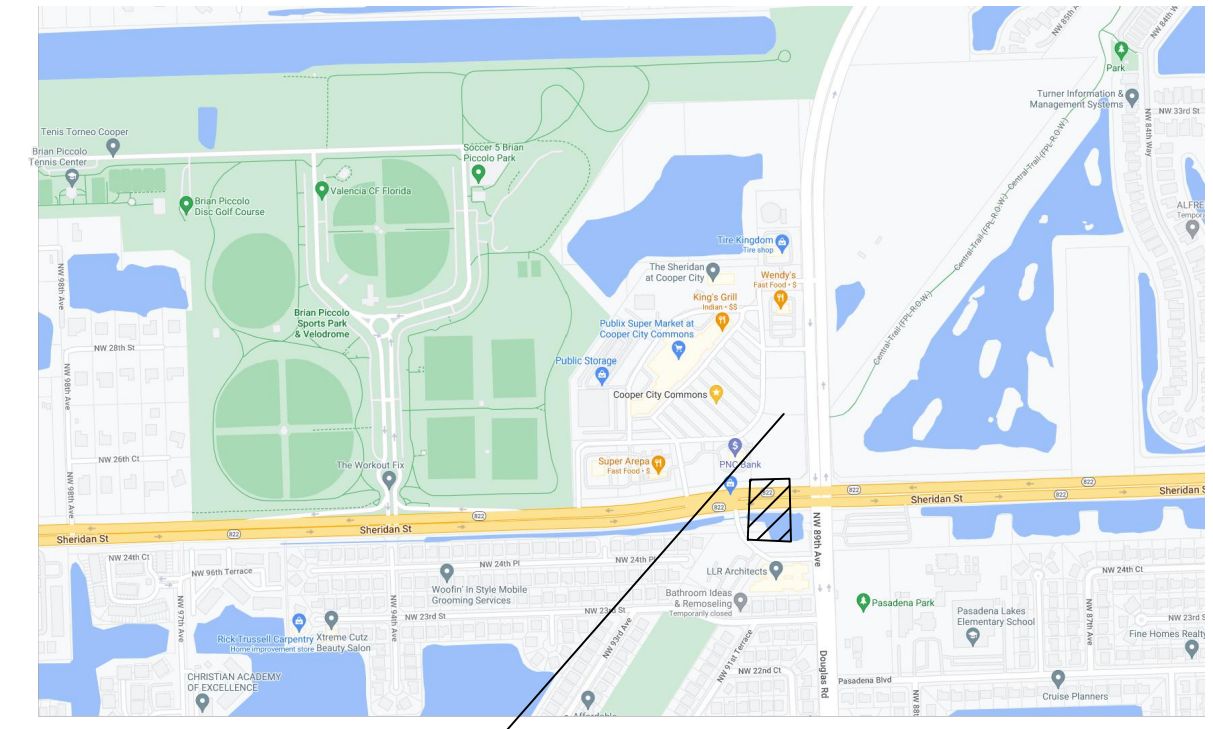

LOCATION MAP NOT TO SCALE

PROTECTION FROM CONSTRUCTION WORK

- DURING ANY CONSTRUCTION, LAND DEVELOPMENT OR LOT CLEARING, THE CONTRACTOR AND THE OWNER OF THE PROPERTY SUBJECT TO THIS SECTION SHALL ADHERE TO THE REQUIREMENTS WHICH FOLLOW:
- GENERAL CONTRACTOR TO PREPARE FINAL RELOCATION SITES FOR TREES THAT ARE PROPOSED TO BE RELOCATED. TREES ARE ONLY TO BE MOVED ONCE AND SHALL HAVE TREE BARRICADES IN PLACE THE ENTIRE DURATION ON CONSTRUCTION.
  - GENERAL CONTRACTOR SHALL GRADE AND FILL ALL TREE & PALM HOLES ONCE TREES & PALMS ARE REMOVED AND OR RELOCATED.
  - LANDSCAPE AND LAWN IRRIGATION, TREE REMOVAL & RELOCATION PERMITS SHALL BE REQUIRED.
  - A PRE-PLANTING MEETING SHALL BE HELD WITH THE CITY LANDSCAPE DEPARTMENT PRIOR TO ANY INSTALLATION.
  - ALL PROPOSED TREES TO BE RELOCATED SHALL BE ROOT PRUNED 8 WEEKS PRIOR TO CONSTRUCTION AND DONE ACCORDING TO GOOD NURSERY PRACTICE AS REQUIRED. TRENCH DEPTH SHALL BE 18"-36" ROOT BALL SHALL BE A MINIMUM OF 60" WHEN ROOT PRUNED. FILL TRENCH WITH FIBROUS MATERIAL SUCH AS LEAVES, OR WOOD SHAVINGS. WATERING SHALL BE ONCE A WEEK DURING ROOT PRUNING. TORN ROOTS SHALL BE TRIMMED TO SOLID WOOD. RELOCATED TREES SHALL BE LIGHTLY PRUNED BY HAND. A ISA CERTIFIED ARBORIST SHALL ROOT PRUNE ANY AND ALL EXISTING TREES WITHIN PAVING/CURBING AREAS TO BE INSTALLED; VERIFY ON SITE WITH CITY LANDSCAPE DEPARTMENT PRIOR TO ANY INSTALLATION; FIELD VERIFY WITH GENERAL CONTRACTOR AS REQUIRED. LANDSCAPE CONTRACTOR SHALL WATER RELOCATED TREES W/ TEMPORARY IRRIGATION EVERYDAY FOR THE FIRST MONTH THEN 2-3 TIMES A WEEK UNTIL SYSTEM IS FULLY AUTOMATIC; OWNER TO SUPPLY WATER ON SITE. TRANSPLANT TREES W/ 60" TREE SPADE, AND / OR TREE CRANE. TRANSPLANTING HOLE SHALL BE AT LEAST 1/3 BIGGER THAN THE AREA THAT WAS TRENCHED FOR TRANSPLANTING.
  - GENERAL CONTRACTOR SHALL REMOVE ALL ROAD ROCK, ASPHALT, DEBRIS, ETC. IN ALL LANDSCAPE AREAS TO A MIN. DEPTH OF 30" AND PROVIDE PLANTING SOIL AS REQUIRED(SEE SOIL SPECIFICATIONS).
  - ALL TREES, PALMS AND OTHER PLANTS SHALL BE PLANTED WITH THE TOP OF THEIR ROOTBALLS NO DEEPER THAN THE FINAL GRADE SURROUNDING THE PLANTING AREA (1'-2').
  - PLACE A MAINTAIN PROTECTIVE BARRIERS AROUND THE DRIP LINE OF ALL TREES TO BE RETAINED ON THE SITE TO PREVENT THEIR DESTRUCTION OR DAMAGE. THE PROTECTIVE BARRIERS SHALL BE AT LEAST (4) FEET IN HEIGHT AND CONSPICUOUSLY COLORED TO BE SEEN EASILY BY OPERATORS OF TRUCKS AND OTHER EQUIPMENT. PROTECTIVE BARRIERS SHALL BE CONSTRUCTED OF STURDY MATERIAL (NOT FLAGGING OR RIBBONS) AND SHALL BE INSTALLED PRIOR TO AND DURING CONSTRUCTION/AND OR LAND DEVELOPMENT.
  - NOT STORE OR USE MATERIALS OR EQUIPMENT WITHIN THE DRIP LINE OF ANY TREE TO BE RETAINED ON SITE UNLESS THE ACTIVITY IS BEING DONE TO PROTECT THE TREES.
  - NOT DISCHARGE OR CONTAMINATE THE SOIL WITHIN THE DRIP LINE OF ANY TREE TO BE RETAINED ON SITE WITH ANY CONSTRUCTION MATERIALS SUCH AS PAINT, OIL, SOLVENTS, PETROLEUM PRODUCTS, ASPHALT, CONCRETE, MORTAR, OR OTHER MATERIALS THAT MAY CAUSE ADVERSE IMPACTS.
  - CLEARING OF VEGETATION WITHIN THE DRIP LINE OF TREES DESIGNATED FOR PRESERVATION SHALL ONLY BE BY HAND OR LIGHT RUBBER WHEELED EQUIPMENT THAT WILL NOT DAMAGE THE TREE ROOTS; SAID EQUIPMENT SHALL BE A MAXIMUM OF FORTY-EIGHT (48) INCHES WIDE, TIRE TREAD WITH A MAXIMUM WEIGHT OF THREE THOUSAND FIVE HUNDRED (3,500) POUNDS.
  - UTILIZE RETAINING WALLS AND DRYWELLS WHERE NEEDED TO PROTECT TREES TO BE PRESERVED FROM SEVERE GRADE CHANGES.
  - PRUNING OF TREES TO BE PRESERVED SHALL BE IN ACCORDANCE WITH THE STANDARDS FOR PRUNING ESTABLISHED BY ANSI A-300.
  - MAKE NO ATTACHMENTS, OTHER THAN THOSE OF A PROTECTIVE AND NON-DAMAGING NATURE, TO THE TREE TO BE RETAINED ON THE SITE.
  - DO NOT CHANGE THE NATURAL GRADE ABOVE THE ROOT SYSTEM WITHIN THE DRIP LINE OF ANY TREE TO BE RETAINED ON SITE UNLESS IT CAN BE DEMONSTRATED TO THE CITY THAT IT WILL NOT DAMAGE ANY TREE.
  - AVOID ANY ENCROACHMENTS, EXCAVATIONS OR SEVERE GRADE CHANGES WITHIN THE DRIP LINE OF PRESERVED TREES UNLESS IT CAN BE DEMONSTRATED TO THE CITY THAT IT WILL NOT IMPACT ANY TREE, NOT CAUSE SOIL COMPACTION WITHIN THE DRIP LINE OF ANY TREE TO BE RETAINED ON SITE, AND ANY TREES DESIGNATED TO BE PRESERVED WHICH ARE DAMAGED DURING CONSTRUCTION SHALL BE REPAIRED.
  - MITIGATION REQUIRED, IF APPLICABLE FOR TREE REMOVAL OF EXISTING TREES SHALL BE DETERMINED BY THE CITY OF COOPER CITY.

**CKE GROUP INCORPORATED**  
engineering • architecture • planning  
17190 ROYAL PALM BLVD.  
SUITE #2  
WESTON, FLORIDA 33326  
PHONE: (305) 558-4124  
FAX: (305) 826-0619  
EB#0004432

**EDUARDO L. CARGACHE**  
LICENSE  
No. 31914  
STATE OF FLORIDA  
PROFESSIONAL ENGINEER  
SEAL  
EDUARDO L. CARGACHE  
CIVIL ENGINEER-PE 31914  
RICARDO J. PEREZ  
ARCHITECT A 14985

This item has been digitally signed by Eduardo L. Cargache on the date adjacent to the seal.

Printed copies of the document are not considered signed and sealed and the signature must be verified on any electronic copies.

**RICHARD BARTLETT LANDSCAPE, INC.**  
14417 STUBBINS LANE  
WELLINGTON, FL 33414  
TEL: (407) 758-7707  
LANDSCAPE ARCHITECTURE LC26000352  
MICHAEL E. RAWLS RA#001633  
E-MAIL: -richard@bartlettlandscape.com  
PRINTED COPIES OF THIS DOCUMENT ARE NOT CONSIDERED SIGNED AND SEALED AND THE SIGNATURE MUST BE VERIFIED ON ANY ELECTRONIC COPIES  
SEAL  
RICHARD BARTLETT  
LANDSCAPE ARCHITECT  
STATE OF FLORIDA  
NO. 14985

RBL#23-08-2214  
DRAWN BY: RICK BARTLETT  
CHECKED: RGB/MER

DATE	REMARKS
05-23-24	CITY COMMENTS
10/09/24	ADDRESS
10/24/24	CITY COMMENTS

CONTRACT DATE: MAY 29, 2023  
BUILDING TYPE: ENDEAVOR PRE-PAY  
PLAN VERSION:  
BRAND DESIGNER: TIFFANIE SHIVELY  
SITE NUMBER: 316151  
STORE NUMBER: TB-592827  
PAP/M: DIANA DE CICCO  
DRAWN BY: AG.  
JOB NO.: CKE 1851

**TACO BELL**  
COOPER CITY COMMONS  
2500 PINE ISLAND RD.  
COOPER CITY, FL 33024

**TACO BELL**  
ENDEAVOR PRE-PAY  
LANDSCAPE PLAN

**L-1**

PLOT DATE: