



Playpalette: Mangrove

4/16/25

Intellectual property of GameTime, a PlayCore Company. The site shown in rendering is an interpretation and may not reflect exact site conditions.

Ellie Kozak Park ~ Revision 1

City of Cooper City, FL



www.gametime.com



www.playdrp.com



Playpalette: Mangrove

Intellectual property of GameTime, a PlayCore Company. The site shown in rendering is an interpretation and may not reflect exact site conditions. 4/16/25

Ellie Kozak Park ~ Revision 1

City of Cooper City, FL



www.gametime.com



www.playdrp.com



Playpalette: Mangrove

4/16/25
Intellectual property of GameTime, a PlayCore Company. The site shown in rendering is an interpretation and may not reflect exact site conditions.

Ellie Kozak Park ~ Revision 1

City of Cooper City, FL



www.gametime.com



www.playdrp.com



Playpalette: Mangrove

4/10/25

Intellectual property of GameTime, a PlayCore Company. The site shown in rendering is an interpretation and may not reflect exact site conditions.

Ellie Kozak Park ~ Revision 1

City of Cooper City, FL



www.gametime.com



www.playdrp.com



Playpalette: Mangrove

4/10/25

Intellectual property of GameTime, a PlayCore Company. The site shown in rendering is an interpretation and may not reflect exact site conditions.

Ellie Kozak Park ~ Revision 1

City of Cooper City, FL



www.gametime.com



www.playdrp.com



Playpalette: Mangrove

Intellectual property of GameTime, a PlayCore Company. The site shown in rendering is an interpretation and may not reflect exact site conditions. 4/10/25

Ellie Kozak Park ~ Revision 1

City of Cooper City, FL



www.gametime.com



www.playdrp.com



Playpalette: Mangrove

Intellectual property of GameTime, a PlayCore Company. The site shown in rendering is an interpretation and may not reflect exact site conditions.

4/10/25

Ellie Kozak Park ~ Revision 1

City of Cooper City, FL



www.gametime.com



www.playdrp.com



Playpalette: Mangrove

4/10/25

Intellectual property of GameTime, a PlayCore Company. The site shown in rendering is an interpretation and may not reflect exact site conditions.

Ellie Kozak Park ~ Revision 1

City of Cooper City, FL



www.gametime.com



www.playdrp.com



Playpalette: Mangrove

Intellectual property of GameTime, a PlayCore Company. The site shown in rendering is an interpretation and may not reflect exact site conditions. 4/10/25

Ellie Kozak Park ~ Revision 1

City of Cooper City, FL



www.gametime.com



www.playdrp.com



Playpalette: Mangrove

4/10/25

Intellectual property of GameTime, a PlayCore Company. The site shown in rendering is an interpretation and may not reflect exact site conditions.

Ellie Kozak Park ~ Revision 1

City of Cooper City, FL



www.gametime.com



www.playdrp.com

Conceptual Drawing ONLY

Existing Shade
to remain

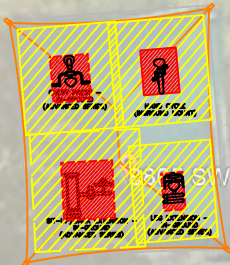

SW 56th Pl

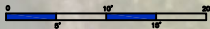
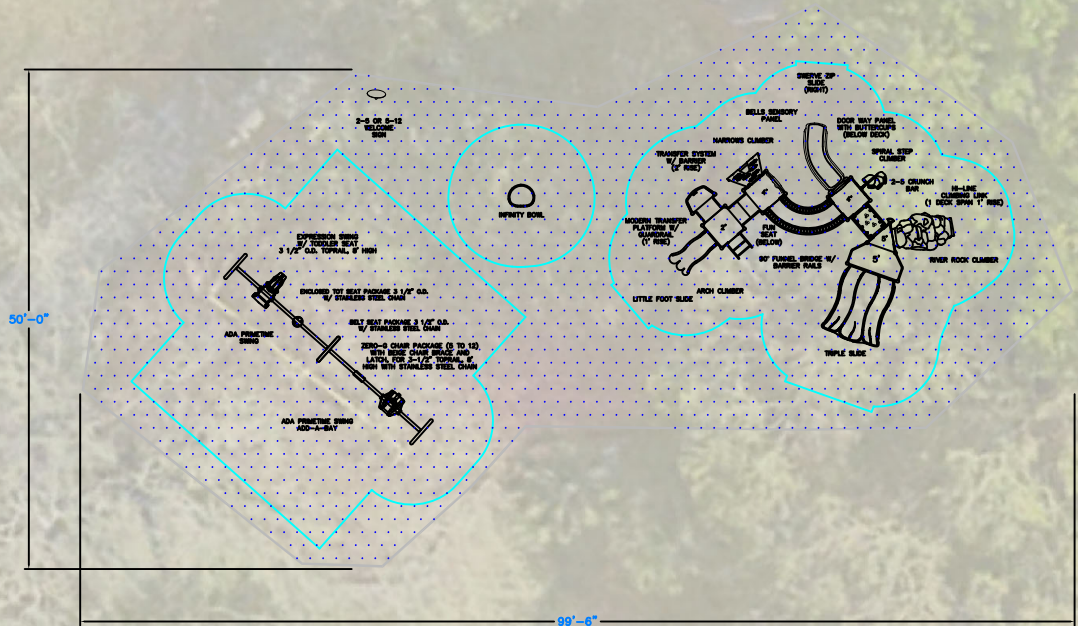

Google Earth



150 PlayCore Drive SE
Fort Payne, AL 35967
www.gametime.com

Ellie Kozak Park ~ Revision 1
City of
Cooper City
Representative
DRP

This play
equipment is
recommended
for children ages
2-5 & 5-12

Minimum Area Required:
see drawing
Scale: NTS
This drawing can be
scaled only when in
an 36" x 48" format

IMPORTANT: Soft resilient surfacing
should be placed in the use zones of all
equipment, as specified for each type of
equipment, and at depths to meet the
critical fall heights as specified by the U.S.
consumer Product Safety Commission,
ASTM standard F 1487 and Canadian
Standard CAN/CSA-Z-614

Drawn By:
GW
Date:
04/10/2025
Drawing Name:
Kozak Park Rev 1

Existing Shade
to remain

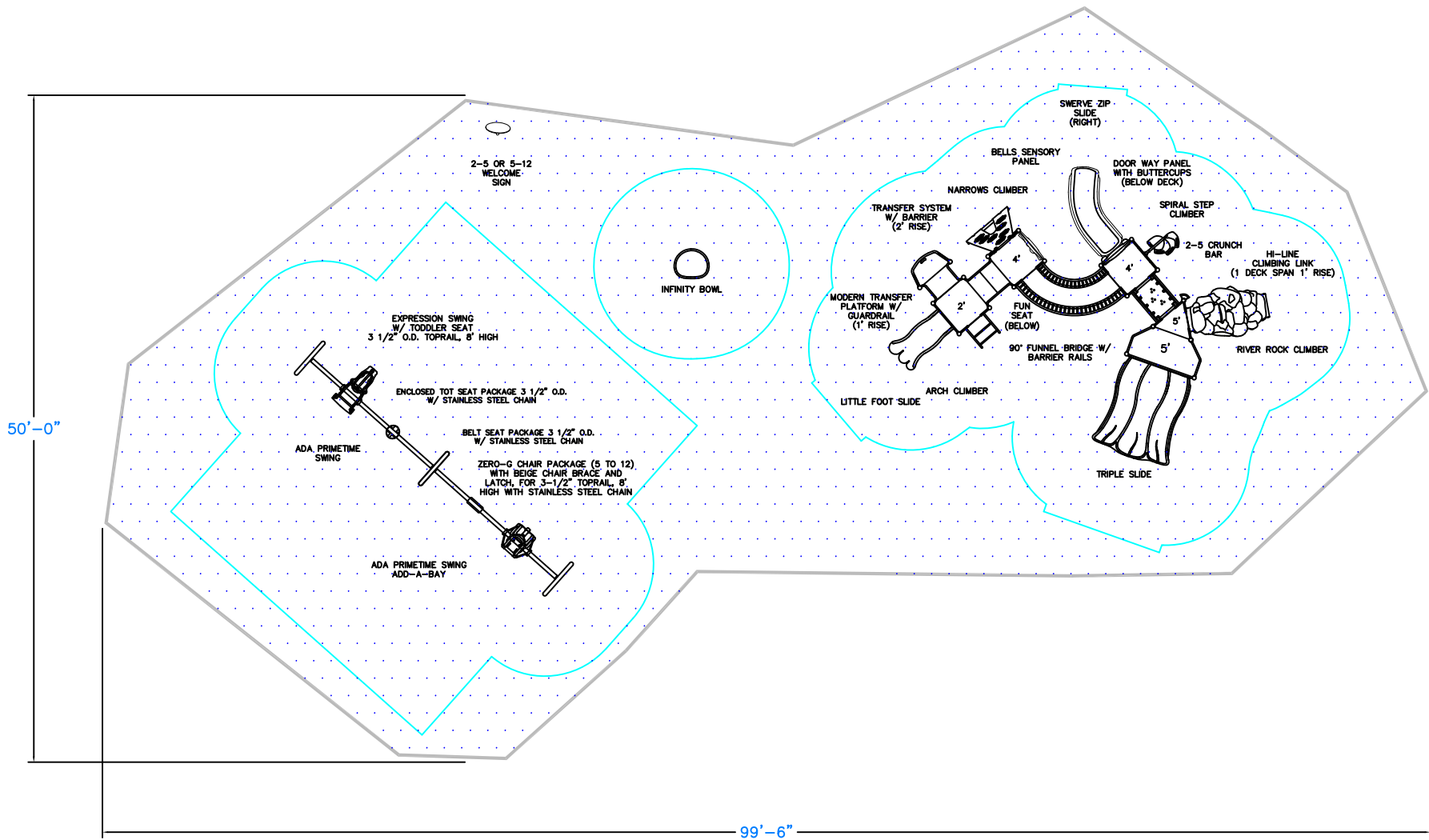
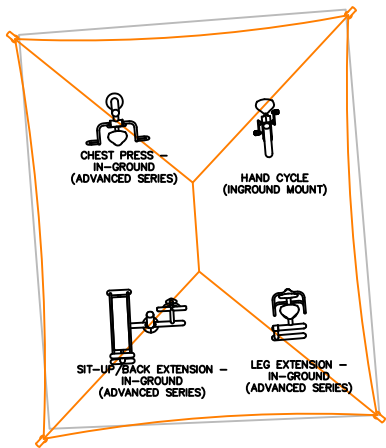



GameTime
 c/o Dominica Recreation Products, Inc.
 P.O. Box 520700
 Longwood, FL 32752-0700
 800-432-0162 * 407-331-0101
 Fax: 407-331-4720
www.playdrp.com

04/15/2025
 Quote #
 106181-01-02

Ellie Kozak Park ~ Revision 1

City of Cooper City
 Attn: Joshua Rhodes
 9000 SW 50th Place, Community Center
 Cooper City, FL 33328
 United States
 Phone: 954-434-2300
 Fax: 954-433-1365
Jrhodes@coopercity.gov

Ship to Zip 33328

Quantity	Part #	Description	Unit Price	Amount
1	INSTALL	5-Star Plus - Removal of Existing Playground Equipment & Borders- <i>Includes disposal</i>	\$3,250.00	\$3,250.00
1	5180	GameTime - Welcome Sign (2-5 or 5-12)	\$774.00	\$774.00
1	RDU	GameTime - Custom PrimeTime System- ages 2-5 & 5-12	\$55,563.00	\$55,563.00
		(4) 12023 -- 3 1/2" Uprt Ass'Y Alum 8'		
		(2) 12024 -- 3 1/2" Uprt Ass'Y Alum 9'		
		(8) 12025 -- 3 1/2" Uprt Ass'Y Alum 10'		
		(5) 12026 -- 3 1/2" Uprt Ass'Y Alum 11'		
		(1) 12502 -- Lil Foot Slide Attachment		
		(1) 13540 -- Crunch Bar		
		(3) 18200 -- 36" Sq Punched Deck P/T 1.3125		
		(1) 18201 -- 36" Tri Punched Deck P/T		
		(1) 18233 -- 90 Deg Funnel W/Barrier		
		(1) 18766 -- Fun Seat 36"		
		(1) 19005 -- Transfer System W/Barrier (2' Rise)		
		(1) 19075 -- Arch (2')		
		(1) 19267 -- Triple Slide		
		(1) 19287 -- River Rock Climber		
		(1) 19331 -- Spiral Step Climber 4' & 4'6"		
		(1) 19363 -- 3'-6"/4'-0" Zip Swerve Slide Right		
		(1) 19456 -- Bells Panel (Roto)		
		(1) 19872 -- Door Way Panel with Buttercups		
		(1) 19882 -- Hi Line Climb Link 1 Deck 1' Rise		
		(1) 19916 -- Modern Transfer w/Guardrail 1' Rise		
		(1) 19949 -- Narrows Climber (3'-4'6")		
1	12583	GameTime - Ada Primetime Swing Frame, 3 1/2" Od	\$1,952.00	\$1,952.00
1	5158	GameTime - Express Swing W/Todd Seat 3 1/2"X8'	\$2,456.00	\$2,456.00
1	SS8696	GameTime - Encl Tot Seat 3 1/2"/8' High W/Clevis	\$534.00	\$534.00
1	12584	GameTime - Ada Primetime Swing Aab, 3 1/2" Od	\$1,208.00	\$1,208.00
1	SS8558	GameTime - 3 1/2" Zero-G Chair (5-12)-Stainless	\$909.00	\$909.00



GameTime
 c/o Dominica Recreation Products, Inc.
 P.O. Box 520700
 Longwood, FL 32752-0700
 800-432-0162 * 407-331-0101
 Fax: 407-331-4720
www.playdrp.com

04/15/2025
 Quote #
 106181-01-02

Ellie Kozak Park ~ Revision 1

Quantity	Part #	Description	Unit Price	Amount
1	SS8910	GameTime - Belt Seat 3 1/2" /8' W/Clevis	\$448.00	\$448.00
1	8476	GameTime - Infinity Bowl	\$3,199.00	\$3,199.00
1	Sealed	5-Star Plus - Signed/Sealed FBC 2023 8th Edition Building Code Drawings	\$1,350.00	\$1,350.00
1	13555I	GameTime - Chest Press (Single) - In-Ground Mount	\$6,087.00	\$6,087.00
1	13561I	GameTime - Sit Up/ Back Extension	\$6,377.00	\$6,377.00
1	13563I	GameTime - Leg Extension (In Ground)	\$4,425.00	\$4,425.00
1	14924I	GameTime - Hand Cycle (In-Ground)	\$7,553.00	\$7,553.00
1	Sealed	5-Star Plus - Signed/Sealed FBC 2023 8th Edition Building Code Drawings	\$1,350.00	\$1,350.00
1	178749	GameTime - Owner's Kit	\$92.08	\$92.08
1	INSTALL	5-Star Plus - Five Star Plus Playground Installation Services- <i>Performed by a Certified Installer, includes meeting and unloading delivery truck, signed completion forms, site walkthrough, and 3-Year Labor Warranty!</i>	\$30,825.00	\$30,825.00
1	Permits	5-Star Plus - Building Permits- <i>Estimated Costs of Permits plus Time. If actual permit fees are significantly higher or lower, final invoice will be adjusted accordingly. If additional time spent acquiring permits, due to lack of information from owner, final invoice to be adjusted. Survey & Siteplan are to be provided by the owner for the permit application. Correct legal address will be required.</i>	\$1,500.00	\$1,500.00
3350	Digout	GT-Impax - Digout/Sitework of area (per sq. ft.)- <i>Does not include removal of spoils</i>	\$1.90	\$6,365.00
3350	Spoils	GT-Impax - Removal/Disposal from Site the Spoils from Digout (per sq. ft.)	\$1.75	\$5,862.50
250	Curb	GT-Impax - Concrete Curb (In. ft.)- <i>Not Reinforced</i>	\$47.56	\$11,890.00
3350	Crush	GT-Impax - Crushed & Compacted Stone Sub-Base (sq. ft.)- <i>Installed per specification of Unitary Surfacing requirements.</i>	\$6.16	\$20,636.00
3350	Poured- 8	GT-Impax - Poured Rubber Surfacing - 8' fall height- <i>50% Standard Color - Aromatic Binder - 3.75" Thick with 1/2" EPDM wear course cap - 5-year warranty</i>	\$29.33	\$98,255.50
			Sub Total	\$272,861.08
			Discount	(\$10,418.50)
			Freight	\$5,670.46
			Total	\$268,113.04

This quote was prepared by Gina Wilson, Vice President / Senior Project Manager.
 For questions or to order please call - 800-432-0162 ext. 101 ginaw@gametime.com

All pricing in accordance with Omnia Partners / U.S. Communities Contract #2017001134.

All terms in the Omnia Partners / U.S. Communities Contract take precedence over terms shown below.

For more information on the Omnia Partners / U.S. Communities contract please visit [Omnia Partners Public Sector GameTime](#)



GameTime
c/o Dominica Recreation Products, Inc.
P.O. Box 520700
Longwood, FL 32752-0700
800-432-0162 * 407-331-0101
Fax: 407-331-4720
www.playdrp.com

04/15/2025
Quote #
106181-01-02

Ellie Kozak Park ~ Revision 1

Permits are not included in cost, unless specifically listed in pricing. If permits are required Signed/Sealed drawings are needed and are also not included unless specifically listed in pricing. Any costs for municipal permits, paid by installer, will be charged back to the owner. Adding permits to any job will increase the length of completion, expect total time to be about **150 days**, after receipt of Site Plan from owner/customer (this is not due to manufacturing but rather the permit process at the municipality level). It is expected that the **owner will provide approved site plans** of the area for the permit office, and will help and assist in the securing of all required approvals before assembly of equipment can begin. Installer cannot provide site plans. **The permit process can not begin until appropriate and current site plans are provided by owner.** If there are no current surveys or site plans available, the owner may be required to obtain a new survey for the permit. This is the responsibility of the owner to obtain. If additional permitting requirements are needed during the process, those will be added and billed accordingly, i.e. soil density test, formed footers, etc.

Payment Terms: Governmental Purchase Order.

Purchases in excess of \$1,000.00 to be supported by your written purchase order made out to GameTime.

Net 30 days subject to approval by GameTime Credit Manager. A completed Credit Application and Bank Reference Authorization, must be received with the order. The decision on credit is the sole discretion of GameTime/PlayCore. A 1.5% per month finance charge will be imposed on all past due accounts.

Multiple Invoices: Invoices will be generated upon services rendered. When equipment ships it will be invoiced separately from installation and/or other services. Terms are Net 30 for each individual invoice.

This Quotation is subject to policies in the current GameTime Park and Playground Catalog and the following terms and conditions. Our quotation is based on shipment of all items at one time to a single destination, unless noted, and changes are subject to price adjustment.

Pricing: Firm for 60 days from date of quotation.

Shipment: F.O.B. factory, order shall ship within 120 days after GameTime's receipt and acceptance of your purchase order, color selections, approved submittals, and receipt of payment.

Taxes: State and local taxes will be added at time of invoicing, if not already included, unless a tax exempt certificate is provided at the time of order entry.

Exclusions: Unless specifically discussed, this quotation excludes all sitework and landscaping; removal of existing equipment; acceptance of equipment and off-loading; lift gate delivery; storage of goods prior to installation; security of equipment (on site and at night); equipment assembly and installation; safety surfacing; borders; drainage; signed/sealed drawings; or permits.

Installation Terms: Shall be by a Certified Installer. The installer is an independent installer and not part of PlayCore, GameTime, nor Dominica Recreation Products. If playground equipment, installer will be NPSI and Factory Trained and Certified. Unless otherwise noted, installation is based on a standard installation consistent with GameTime installation sheets and in suitable soil with a sub-base that will allow proper playground installation. Drainage is not part of our scope of work unless otherwise noted. Customer shall be responsible for scheduling and coordination with the installer. Site should be level and allow for unrestricted access of trucks and machinery. Customer shall also provide a staging and construction area. Installer not responsible for sod replacement or damage to access path and staging area. Customer shall be responsible for unknown conditions such as buried utilities, tree stumps, rock, or any concealed materials or conditions that may result in additional labor or material costs. Customer will be billed hourly or per job directly by the installer for any additional costs that were not previously included.

ORDER INFORMATION

Bill To: _____ Ship To: _____

Contact: _____ Contact: _____

Address: _____ Address: _____

Address: _____ Address: _____

City, State, Zip: _____ City, State, Zip: _____

Tel: _____ Fax: _____ Tel: _____ Fax: _____

SALES TAX EXEMPTION CERTIFICATE #: _____ (PLEASE PROVIDE A COPY OF CERTIFICATE)



GameTime
c/o Dominica Recreation Products, Inc.
P.O. Box 520700
Longwood, FL 32752-0700
800-432-0162 * 407-331-0101
Fax: 407-331-4720
www.playdrp.com

04/15/2025
Quote #
106181-01-02

Ellie Kozak Park ~ Revision 1

Acceptance of quotation:

Accepted By (printed): _____

P.O. No: _____

Signature: _____

Date: _____

Title: _____

Phone: _____

E-Mail: _____

Purchase Amount: **\$268,113.04**