



Playpalette: Whimsy Way

10/30/24

Intellectual property of GameTime, a PlayCore Company. The site shown in rendering is an interpretation and may not reflect exact site conditions.

Flamingo Park ~ 2024 Revision 3

Cooper City, FL



www.gametime.com



www.playdrp.com



Playpalette: Whimsy Way

Intellectual property of GameTime, a PlayCore Company. The site shown in rendering is an interpretation and may not reflect exact site conditions. 10/30/24

Flamingo Park ~ 2024 Revision 3

Cooper City, FL



Playpalette: Whimsy Way

Intellectual property of GameTime, a PlayCore Company. The site shown in rendering is an interpretation and may not reflect exact site conditions. 10/30/24

Flamingo Park ~ 2024 Revision 3

Cooper City, FL



www.gametime.com



www.playdrp.com



Playpalette: Whimsy Way

Intellectual property of GameTime, a PlayCore Company. The site shown in rendering is an interpretation and may not reflect exact site conditions. 10/30/24

Flamingo Park ~ 2024 Revision 3

Cooper City, FL



A PLAYCORE Company
www.gametime.com



www.playdrp.com

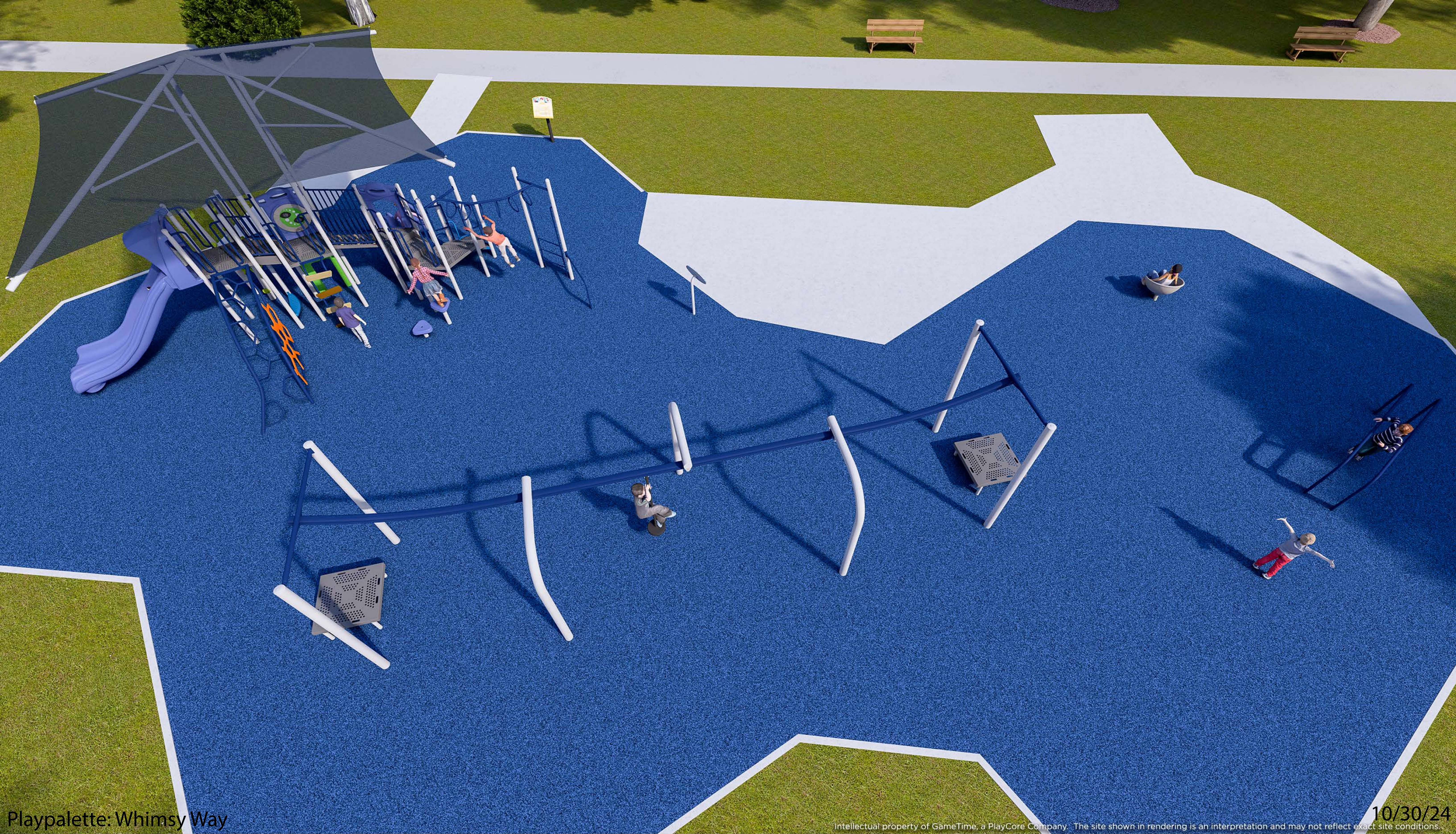

Playpalette: Whimsy Way

Intellectual property of GameTime, a PlayCore Company. The site shown in rendering is an interpretation and may not reflect exact site conditions. 10/30/24

Flamingo Park ~ 2024 Revision 3

Cooper City, FL



Playpalette: Whimsy Way

Intellectual property of GameTime, a PlayCore Company. The site shown in rendering is an interpretation and may not reflect exact site conditions. 10/30/24

Flamingo Park ~ 2024 Revision 3

Cooper City, FL



www.gametime.com



www.playdrp.com



Playpalette: Whimsy Way

Intellectual property of GameTime, a PlayCore Company. The site shown in rendering is an interpretation and may not reflect exact site conditions. 10/30/24

Flamingo Park ~ 2024 Revision 3

Cooper City, FL

Conceptual Drawing Only

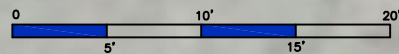
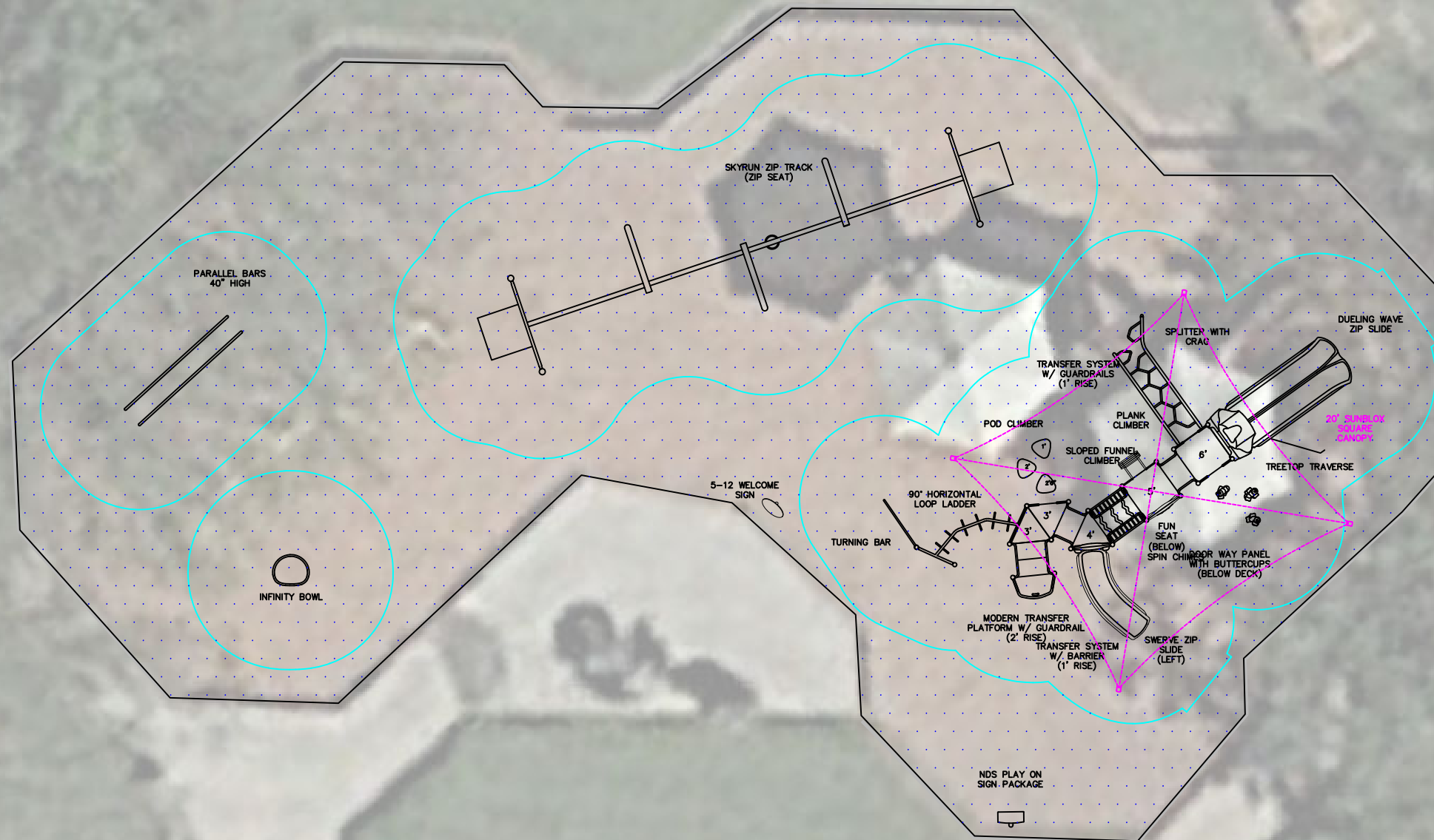

150 PlayCore Drive SE
Fort Payne, AL 35967
www.gametime.com

Flamingo Park ~ 2024 Revision 3
City of
Cooper City
Representative
DRP

This play equipment is recommended for children ages
5-12

Minimum Area Required:
see drawing
Scale: NTS
This drawing can be scaled only when in an 24" x 36" format

IMPORTANT: Soft resilient surfacing should be placed in the use zones of all equipment, as specified for each type of equipment, and at depths to meet the critical fall heights as specified by the U.S. consumer Product Safety Commission, ASTM standard F 1487 and Canadian Standard CAN/CSA-Z-614

Drawn By:
gw
Date:
10/30/2024
Drawing Name:
Flamingo Pk 2024 rev 3 w shade & PIP



GameTime
 c/o Dominica Recreation Products, Inc.
 P.O. Box 520700
 Longwood, FL 32752-0700
 800-432-0162 * 407-331-0101
 Fax: 407-331-4720
www.playdrp.com

10/30/2024
 Quote #
 106136-01-06

Flamingo Park ~ 5-12 Playground Area Revision 3 w/ Shade

City of Cooper City
 Attn: Tim Fleming
 9000 SW 50th Place, Community Center
 Cooper City, FL 33328
 United States
 Phone: 954-434-2300
 Fax: 954-433-1365
tfleming@coopercityfl.org

Ship to Zip 33328

Quantity	Part #	Description	Unit Price	Amount
<i>Site access for construction equipment and staging area must be provided by owner. Quote does not include any additional EWF. Topoff of existing may be needed.</i>				
1	INSTALL	5-Star Plus - Removal of Existing Playground Equipment & Borders- <i>Includes disposal</i>	\$4,825.00	\$4,825.00
1	14927	GameTime - NDS Play On Sign Package		
1	5179	GameTime - Welcome Sign (5-12)	\$748.00	\$748.00
1	RDU	GameTime - Custom PrimeTime System with Shade	\$62,995.00	\$62,995.00
1	4629	GameTime - Parallel Bar 40"	\$926.00	\$926.00
1	8476	GameTime - Infinity Bowl	\$3,527.00	\$3,527.00
1	91778	GameTime - SkyRun Zip Track 35 - Zip Seat	\$16,999.00	\$16,999.00
1	Sealed	5-Star Plus - Signed/Sealed FBC 2023 8th Edition Building Code Drawings- playground equipment	\$1,250.00	\$1,250.00
1	INSTALL	5-Star Plus - Five Star Plus Playground Installation Services- <i>Performed by a Certified Installer, includes meeting and unloading delivery truck, signed completion forms, site walkthrough, and 3-Year Labor Warranty!</i>	\$28,480.00	\$28,480.00
1	Permits	5-Star Plus - Building Permits- <i>Estimated Costs of Permits plus Time. If actual permit fees are significantly higher or lower, final invoice will be adjusted accordingly. If additional time spent acquiring permits, due to lack of information from owner, final invoice to be adjusted. Survey & Siteplan are to be provided by the owner for the permit application. Correct legal address will be required.</i>	\$1,400.00	\$1,400.00
3830	Digout	GT-Impax - Digout/Sitework of area (per sq. ft.)- <i>Does not include removal of spoils</i>	\$1.40	\$5,362.00
3830	Spoils	GT-Impax - Removal/Disposal from Site the Spoils from Digout (per sq. ft.)	\$1.75	\$6,702.50
225	Curb	GT-Impax - Concrete Curb (In. ft.)- <i>4" Wide - Not Reinforced</i>	\$41.00	\$9,225.00
3830	Crush	GT-Impax - Crushed & Compacted Stone Sub-Base (sq. ft.)- <i>Installed per specification of Unitary Surfacing requirements.</i>	\$6.15	\$23,554.50
3830	Poured- 8	GT-Impax - Poured Rubber Surfacing - 8' fall height- <i>50% Standard Color - Aromatic Binder - 3.75" Thick with 1/2" EPDM wear course cap - 5-year warranty</i>	\$28.77	\$110,189.10
1	178749	GameTime - Owner's Kit	\$89.00	\$89.00
			Sub Total	\$276,272.10
			Discount	(\$44,442.53)
			Freight	\$5,595.87





GameTime
 c/o Dominica Recreation Products, Inc.
 P.O. Box 520700
 Longwood, FL 32752-0700
 800-432-0162 * 407-331-0101
 Fax: 407-331-4720
www.playdrp.com

10/30/2024
 Quote #
 106136-01-06

Flamingo Park ~ 5-12 Playground Area Revision 3 w/ Shade

Quantity	Part #	Description	Unit Price	Amount
			Total	\$237,425.44

This quote was prepared by Gina Wilson, Vice President / Senior Project Manager.
 For questions or to order please call - 800-432-0162 ext. 101 ginaw@gametime.com

All pricing in accordance with Omnia Partners / U.S. Communities Contract #2017001134.

All terms in the Omnia Partners / U.S. Communities Contract take precedence over terms shown below.
 For more information on the Omnia Partners / U.S. Communities contract please visit [Omnia Partners Public Sector GameTime](#)

Permits are not included in cost, unless specifically listed in pricing. If permits are required Signed/Sealed drawings are needed and are also not included unless specifically listed in pricing. Any costs for municipal permits, paid by installer, will be charged back to the owner. Adding permits to any job will increase the length of completion, expect total time to be about **150 days**, after receipt of Site Plan from owner/customer (this is not due to manufacturing but rather the permit process at the municipality level). It is expected that the **owner will provide approved site plans** of the area for the permit office, and will help and assist in the securing of all required approvals before assembly of equipment can begin. Installer cannot provide site plans. **The permit process can not begin until appropriate and current site plans are provided by owner.** If there are no current surveys or site plans available, the owner may be required to obtain a new survey for the permit. This is the responsibility of the owner to obtain. If additional permitting requirements are needed during the process, those will be added and billed accordingly, i.e. soil density test, formed footers, etc.

Payment Terms: Governmental Purchase Order.

Purchases in excess of \$1,000.00 to be supported by your written purchase order made out to GameTime.

Net 30 days subject to approval by GameTime Credit Manager. A completed Credit Application and Bank Reference Authorization, must be received with the order. The decision on credit is the sole discretion of GameTime/PlayCore. A 1.5% per month finance charge will be imposed on all past due accounts.

Multiple Invoices: Invoices will be generated upon services rendered. When equipment ships it will be invoiced separately from installation and/or other services. Terms are Net 30 for each individual invoice.

This Quotation is subject to policies in the current GameTime Park and Playground Catalog and the following terms and conditions. Our quotation is based on shipment of all items at one time to a single destination, unless noted, and changes are subject to price adjustment.

Pricing: Firm for 60 days from date of quotation.

Shipment: F.O.B. factory, order shall ship within 120 days after GameTime's receipt and acceptance of your purchase order, color selections, approved submittals, and receipt of payment.

Taxes: State and local taxes will be added at time of invoicing, if not already included, unless a tax exempt certificate is provided at the time of order entry.

Exclusions: Unless specifically discussed, this quotation excludes all sitework and landscaping; removal of existing equipment; acceptance of equipment and off-loading; lift gate delivery; storage of goods prior to installation; security of equipment (on site and at night); equipment assembly and installation; safety surfacing; borders; drainage; signed/sealed drawings; or permits.

Installation Terms: Shall be by a Certified Installer. The installer is an independent installer and not part of PlayCore, GameTime, nor Dominica Recreation Products. If playground equipment, installer will be NPSI and Factory Trained and Certified. Unless otherwise noted, installation is based on a standard installation consistent with GameTime installation sheets and in suitable soil with a sub-base that will allow proper playground installation. Drainage is not part of our scope of work unless otherwise noted. Customer shall be responsible for scheduling and coordination with the installer. Site should be level and allow for unrestricted access of trucks and machinery. Customer shall also provide a staging and construction area. Installer not responsible for sod replacement or damage to access path and staging area. Customer shall be responsible for unknown conditions such as buried utilities, tree stumps, rock, or any concealed materials or conditions that may result in additional labor or material costs. Customer will be billed hourly or per job directly by the installer for any additional costs that were not previously included.

Unitary Surfacing Notes : The installer of the Unitary Surfacing (Poured, Bonded, Turf, Tiles) is not the same installer of the playground equipment. However, your certified equipment installer will coordinate the timing of the unitary surfacing installation, but more than likely they will not be on-site at the time. They will continue to be your contact should you have any questions. Security is needed to protect surfacing at night or after installation as the product set. Normally it is not needed or a concern, however in some areas additional security is needed to prevent vandalism. **Security is not included.** Vandalism will be the responsible of the owner.





GameTime
 c/o Dominica Recreation Products, Inc.
 P.O. Box 520700
 Longwood, FL 32752-0700
 800-432-0162 * 407-331-0101
 Fax: 407-331-4720
www.playdrp.com

10/30/2024
 Quote #
 106136-01-06

Flamingo Park ~ 5-12 Playground Area Revision 3 w/ Shade

ORDER INFORMATION

Bill To: _____ Ship To: _____

Contact: _____ Contact: _____

Address: _____ Address: _____

Address: _____ Address: _____

City, State, Zip: _____ City, State, Zip: _____

Tel: _____ Fax: _____ Tel: _____ Fax: _____

SALES TAX EXEMPTION CERTIFICATE #: _____ (PLEASE PROVIDE A COPY OF CERTIFICATE)

Acceptance of quotation:

Accepted By (printed): _____ P.O. No: _____

Signature: _____ Date: _____

Title: _____ Phone: _____

E-Mail: _____ Purchase Amount: **\$237,425.44**

