



Dragonfly Trail Network

Fall Line Trace Extension & Lakebottom Park Trail Alignment

February 13, 2024

Existing Trail Projects

		Under Design	Design Completed
1	River Road Connector		X
2	5th Avenue Connector	X	
3	Dinglewood Park Trail		X
4	Fall Line Trace Connector	X	
5	Follow Me Trail Extension (not pictured)	X	



Fall Line Trace Extension



- Request to apply for **Surface Transportation Block Grant** through MPO
- 3.84-mile extension from Pslamond Road to the Metropolitan Planning Organization (MPO) boundary in Harris County
- Two Applications
 - Muscogee County – 2.2 Miles of Trail + Pslamond Road Trailhead Improvements
 - Harris County – 1.62 Miles + New Trailhead
- Funding: 80% Y230 Funds / 20% Local Match

Proposed Budget – Muscogee County



Activity	Desired Fiscal Year for TIP Programming (GDOT Fiscal Year)	Total Estimate	Y230 Funds – 80%	Local Match – 20%
PE	FY 25	\$1,000,000	\$800,000	\$200,000
ROW	FY 27	\$1,000,000	\$800,000	\$200,000
Utilities	FY 29	\$1,000,000	\$800,000	\$200,000
Construction	FY 29	\$7,000,000	\$5,600,000	\$1,400,000
Project Total		\$10,000,000	\$8,000,000	\$2,000,000



Brand Standards

1. Concrete
2. 8' to 10' Wide, AASHTO Standard
3. Landscape Buffer
4. Trail Signage & Wayfinding
5. Mileage Markers
6. Trees & Native Plant Species



Master Plan Legend

- Trailhead
- Chattahoochee RiverWalk
- Fall Line Trace
- Linwood Connector (2019)
- MLK Jr. Trail (2019)
- 10th St. Connector (2022)
- Follow Me Trail
- Trail in Design
- Future Trail
- Park
- School / Public Area Facility
- Creek / River

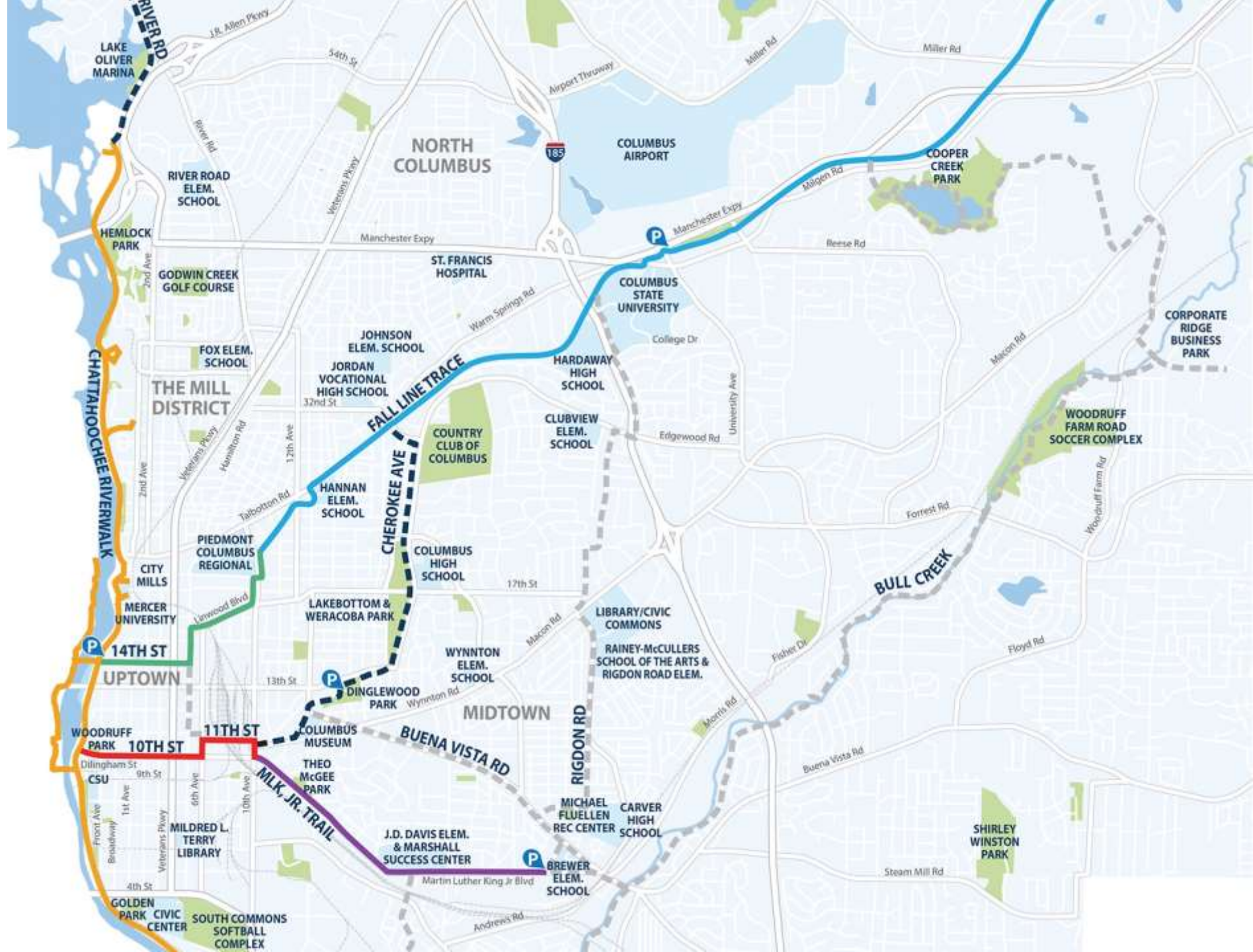

MAN O' WAR TRAIL

Open at Dawn & Closed at Dusk



All pets must be on a leash. Please help keep the trail tidy and clean up after your pet.



Trail accessibility: 10 ft wide asphalt pavement trail. Max 2% cross slope. Max 5% running slope.



Please don't litter. This is a carry-in/carry-out trail.



Please stay on the trail at all times. This trail is for walking, jogging, and bicycling only.

Please help keep the trail clean for all to enjoy.

TRAIL ETIQUETTE

No use of any motorized vehicles (except for motorized wheelchairs)

No horses, donkeys, or mules

No littering

No alcohol, smoking, vaping, e-cigarettes, or drugs

No camping, cooking or open flames

No use of metal detectors or hunting for artifacts

No amplified sounds

No use of remote controlled equipment, toys, models, or drones

No displaying of items or services for sale

Wear orange in remote areas during hunting seasons



www.harriscountyga.gov



HARRIS COUNTY GEORGIA
exploreharriscountyga.com



FOR NON-EMERGENCIES
CALL HARRIS COUNTY
PARKS & RECREATION
DEPARTMENT AT
(706) 488-0000



IN CASE OF
EMERGENCY
CALL 911



Scan for history,
maps & more.

Region 8

River Valley Rail-Trail Connectivity Map

Rail-Trails

-  Rail-Trail Projects: Existing/In-Progress
-  Inactive Rail Line
-  Abandoned Rail Line
-  Rail-Trail Projects: Proposed
-  Inactive Rail Line
-  Potential Rail-Trail Connectivity (Rail-with-Trail, Rail-to-Trail, ect.)
-  Inactive Rail Line

Railroads

- CSXT: CSX Transportation
- GSWR: Georgia Southwestern
- HOG: Heart of Georgia
- NS: Norfolk Southern

Roads

-  Interstate
-  US Highway
-  State Route

Boundaries

-  DCA Region
-  County

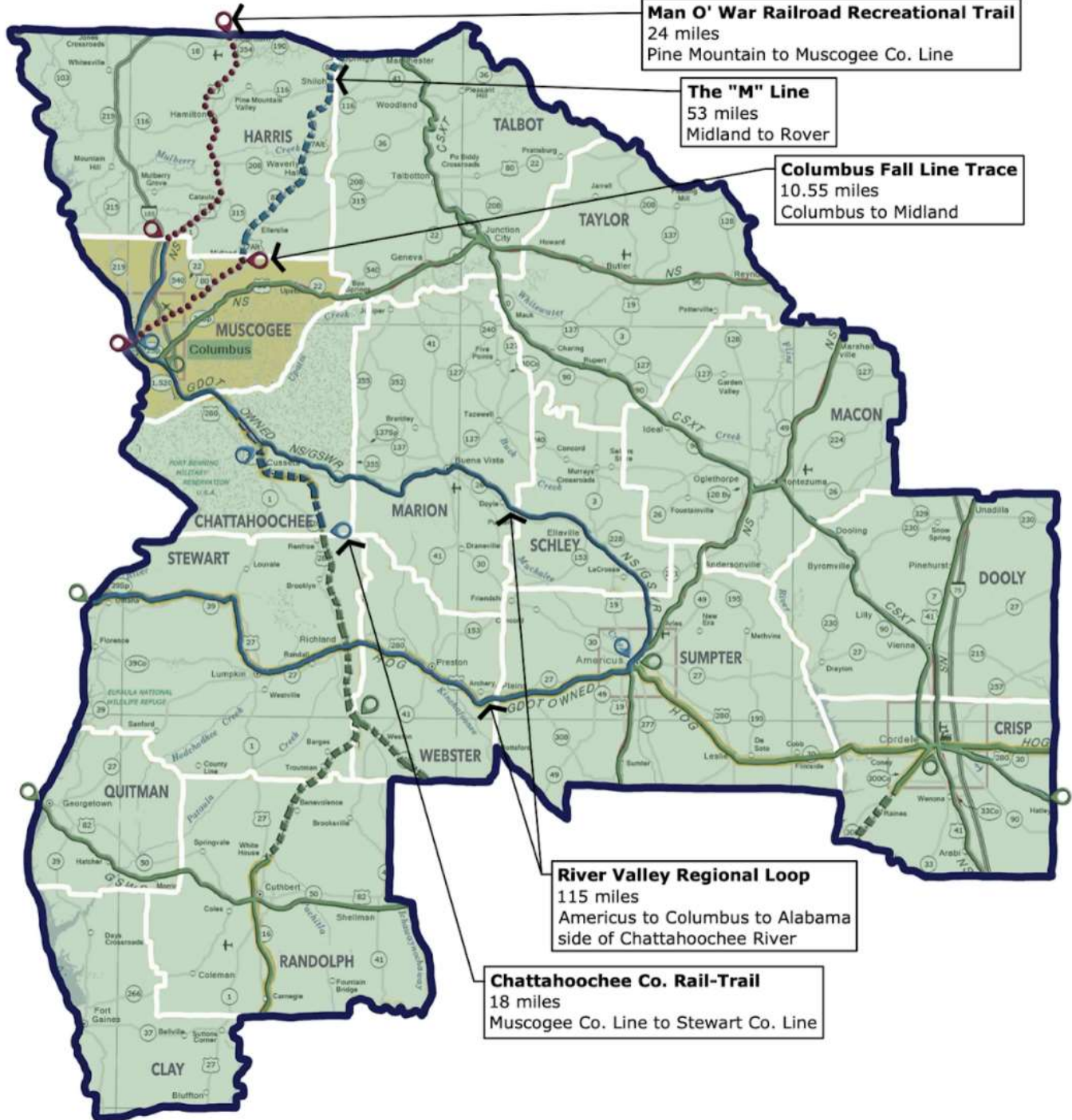

Fall Line Trace Extension

This material is made available as a public service. Maps and data are to be used for reference purposes only. The data contained is subject to constant change. Map information is believed to be correct but is not guaranteed.

**MPO
Boundary**

**Muscogee/Harris
County
Boundary**

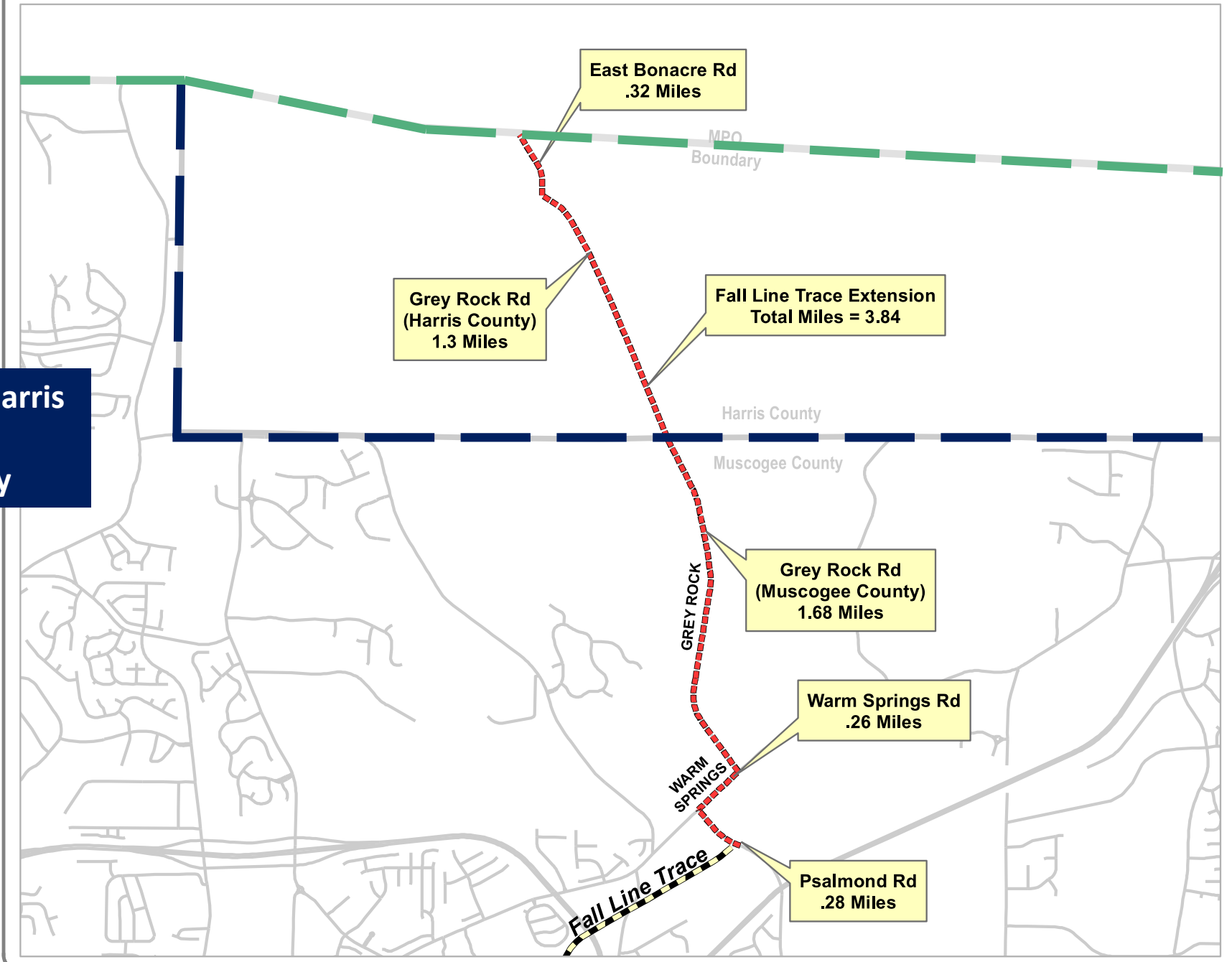

Planning Department
Map Created By: Dave Cooper
Date: 11/14/2023

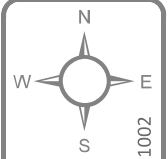

Not to Scale
Projection: NAD 83
Datum: State Plane GA West 1002



**Muscogee/Harris
County
Boundary**

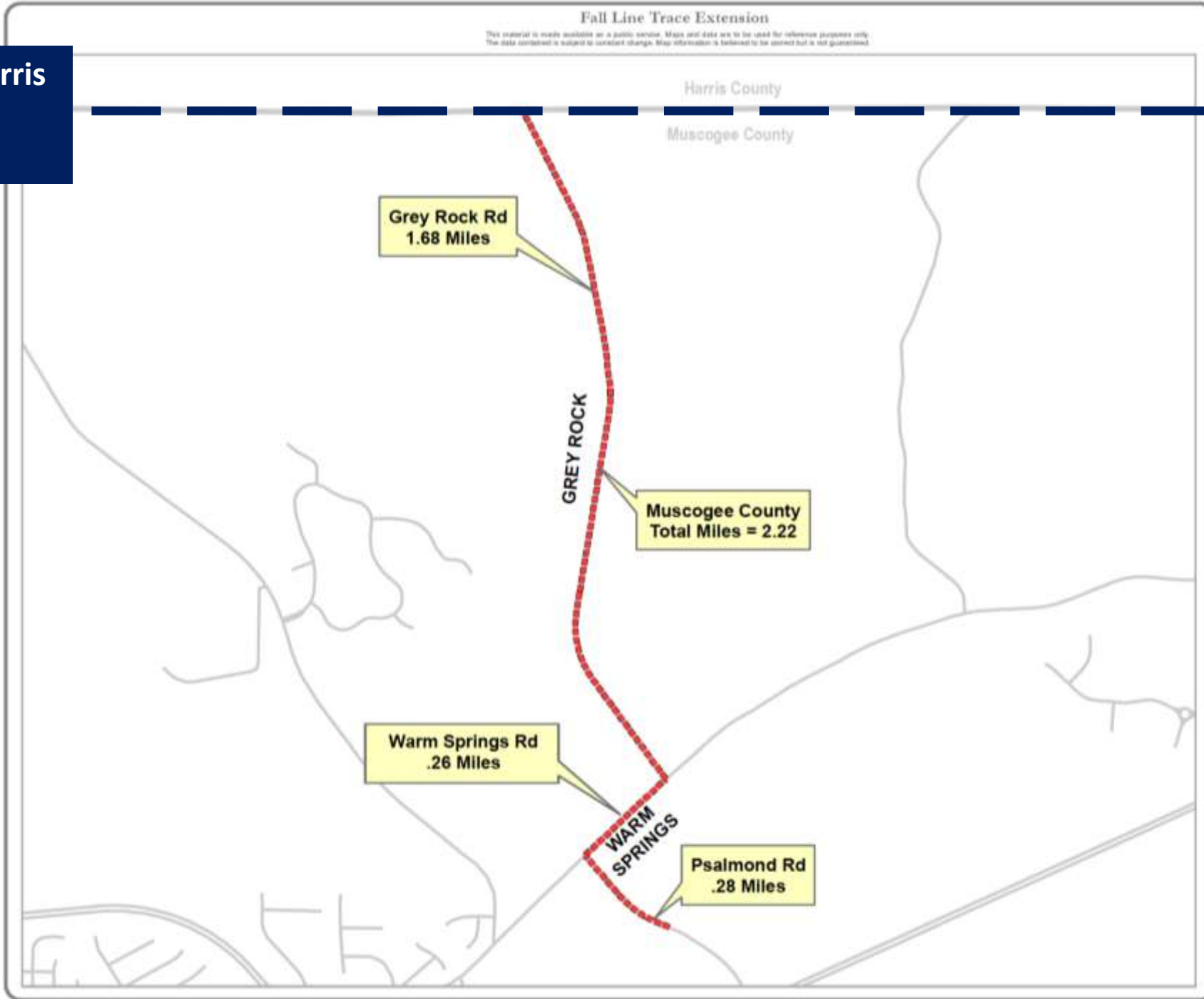

**Columbus
Plans!**

Planning Department
Map Created By: Dave Cooper
Date: 11/14/2023

CPC
MPO
COLUMBIA PLANNING DEPARTMENT
MUSCOGEE COUNTY, GEORGIA

Not to Scale
Projection: NAD 83
Datum: State Plane GA West 1002 ft



Fall Line Trace Extension

This material is made available as a public service. Maps and data are to be used for reference purposes only. The data contained is subject to constant change. Map information is believed to be correct but is not guaranteed.

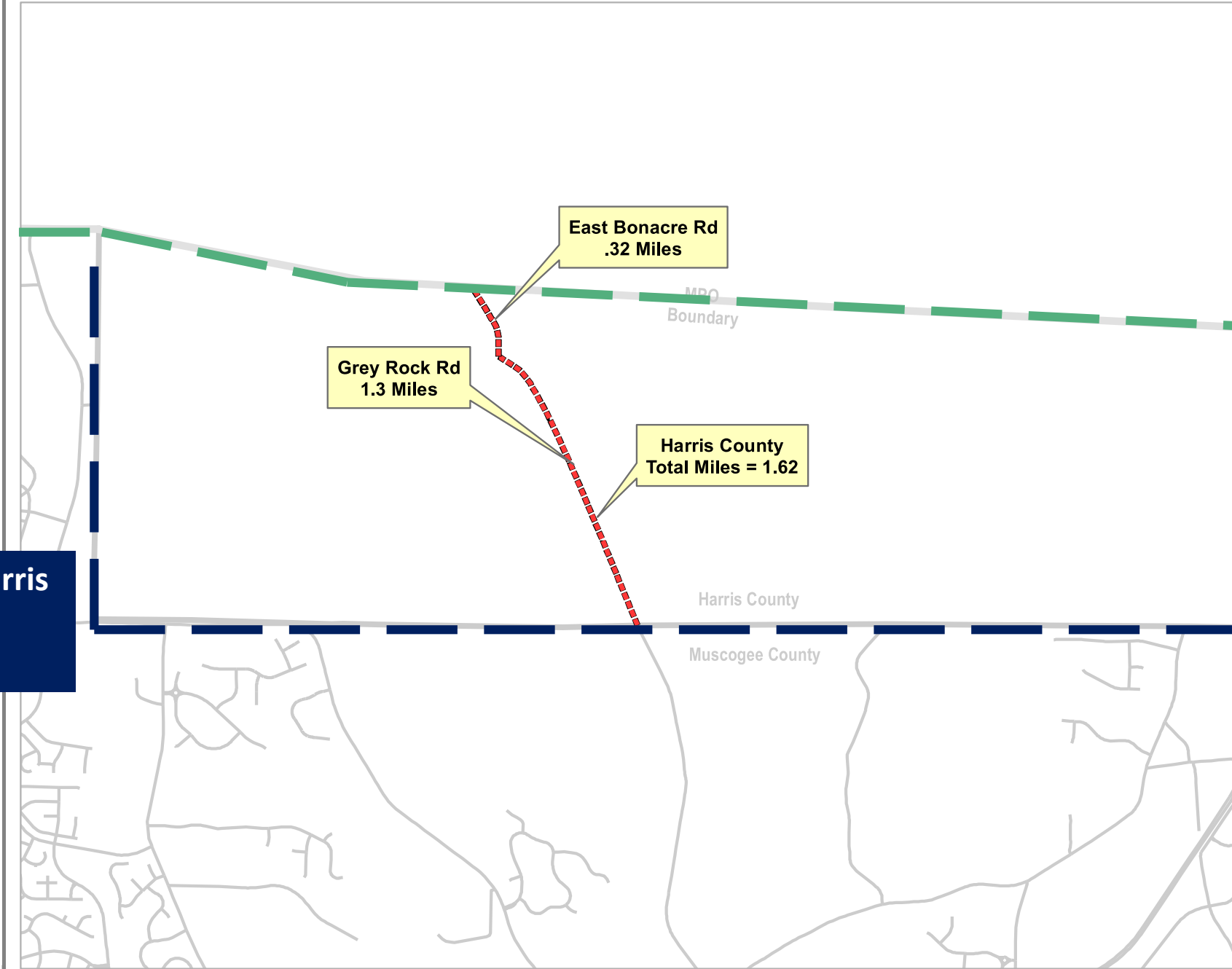

**MPO
Boundary**

**Muscogee/Harris
County
Boundary**



Planning Department
Map Created By: Dave Cooper
Date: 11/14/2023

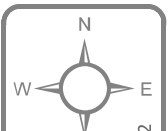

Not to Scale
Projection: NAD 83
Datum: State Plane GA West 1002





FALL LINE TRACE
PSALM ROAD

STOP

TRAIL MAP

Informational sign with text and images.









SPEED LIMIT
25





Master Plan Legend

- Trailhead
- Chattahoochee RiverWalk
- Fall Line Trace
- Linwood Connector (2019)
- MLK Jr. Trail (2019)
- 10th St. Connector (2022)
- Follow Me Trail
- Trail in Design
- Future Trail
- Park
- School / Public Area Facility
- Creek / River

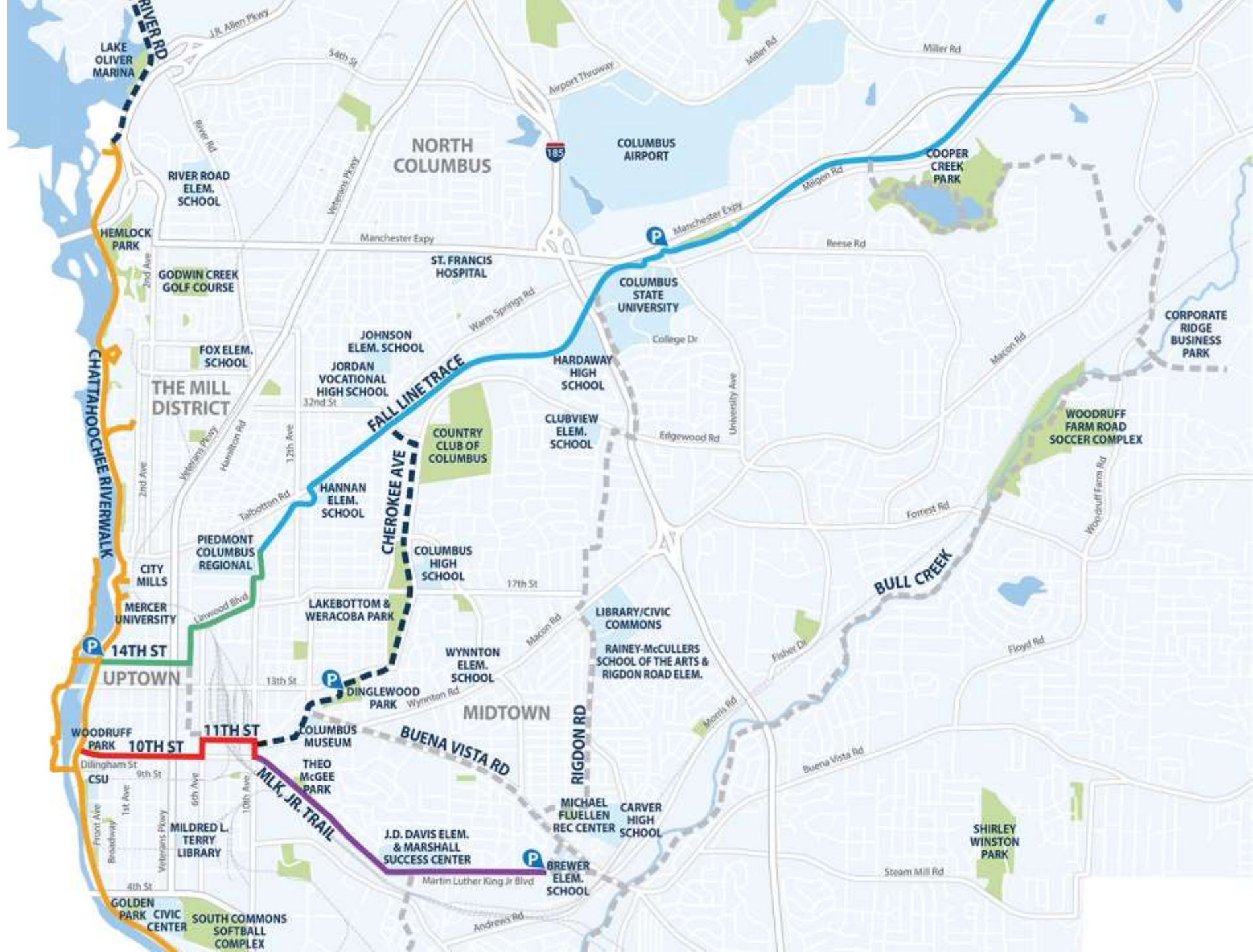

Lakebottom Park Trail Alignment



Timeline

- 2021 – 2023: Alignment Planning
 - Studied Multiple Alignments
 - Gathered Input from Stakeholders, Residents, & Park Users
 - Walked Options
- February 2023: Stakeholder Meeting
 - Eastern Option Preferred
- November 2023: Two Public Meetings
 - M-10/Gravel Preferred
- Benefits: greenspace remains passive, minimal impact on parking & trees, slows traffic on Cherokee





EXISTING



PROPOSED

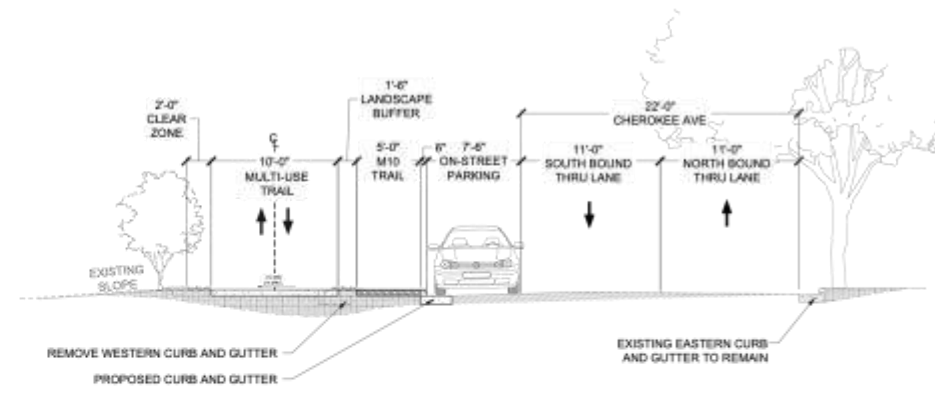

C PROPOSED SECTION - C

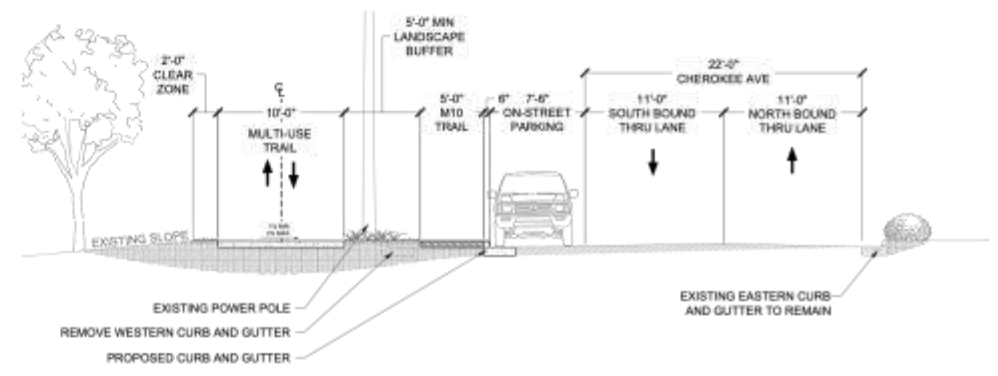

B PROPOSED SECTION - B

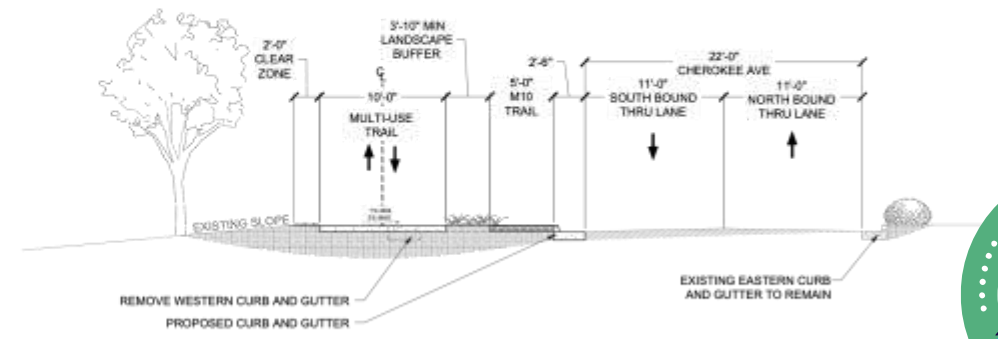

A PROPOSED SECTION - A





Chattahoochee
Riverwalk

Becca Zajac
Dragonfly Trails
706.405.0009
becca@dragonflytrails.org

