



Columbus Health Department  
5601 Veterans Parkway

June 16, 2020





TRICK CALDWELL



Future Home of  
**COLUMBUS  
HEALTH  
DEPARTMENT**

Opening Summer 2020

**COLUMBUS**  
GEORGIA

We do amazing.



Georgia Department of Public Health  
Columbus Health Department

**bgp** | barnes gibson partners  
ARCHITECTS

**R** River City  
CONTRACTING













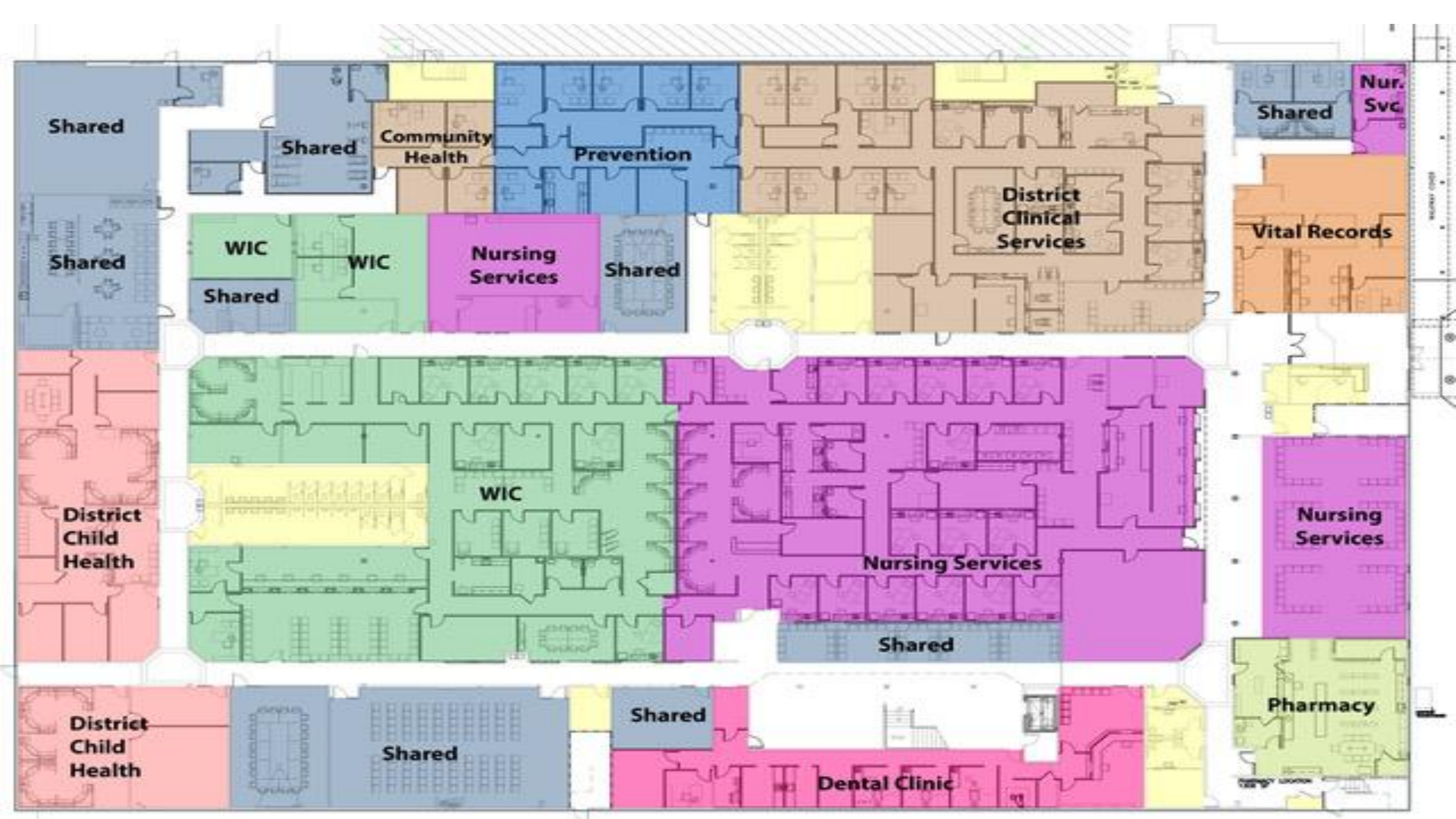

Shared

Shared

Community Health

Prevention

Shared

Nur. Svc

Shared

WIC

WIC

Nursing Services

Shared

District Clinical Services

Vital Records

District Child Health

WIC

Nursing Services

Nursing Services

District Child Health

Shared

Shared

Dental Clinic

Pharmacy





RICK CALDWELL

































**RICK CALDWELL**  
photography













**RICK CALDWELL**

photography













TRICK CALDWELL

photography





















RICK CALDWELL



# H&H Services Shuttle Map

Monday-Friday, 7:30am - 5:10pm

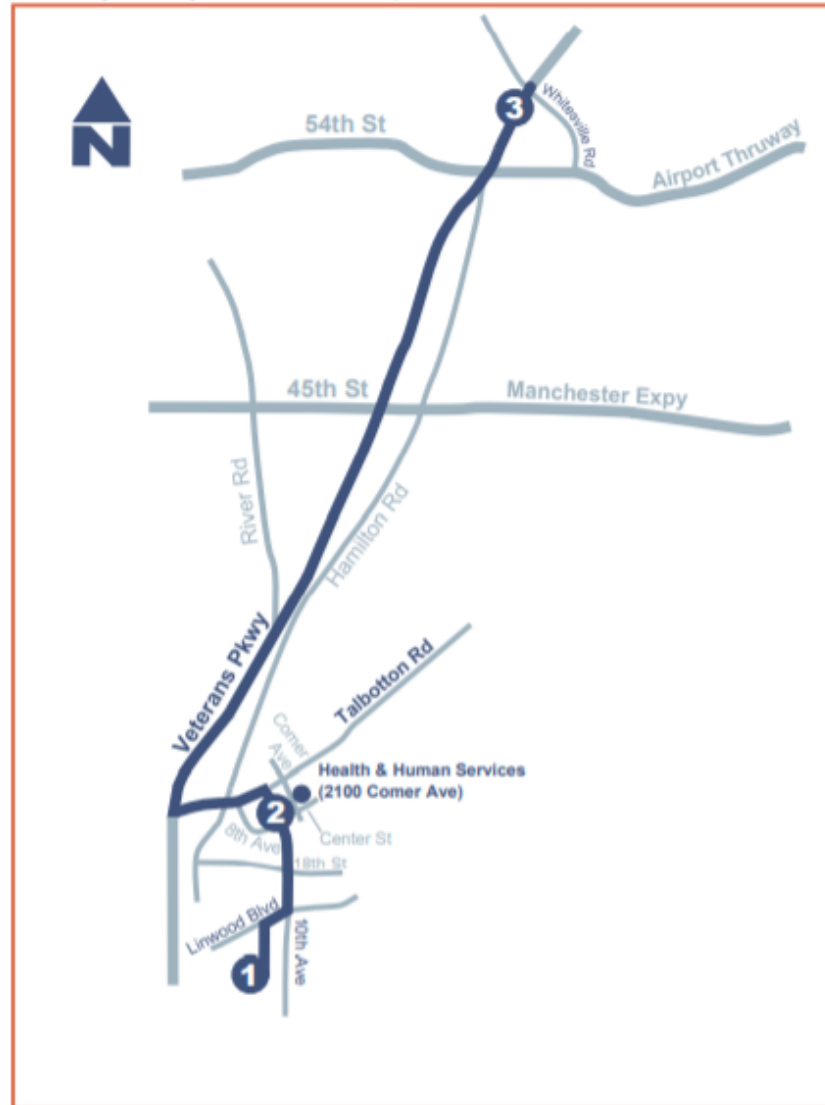

# Schedule

## Outbound to Health & Human Services Locations

METRA Transfer Center	H & H Services at 2100 Comer Ave.	H & H Services at 5601 Veterans Pkwy
1	2	3
7:30 AM	7:35 AM	7:48 AM
8:30 AM	8:35 AM	8:48 AM
9:30 AM	9:35 AM	9:48 AM
10:30 AM	10:35 AM	10:48 AM
11:30 AM	11:35 AM	11:48 AM
12:30 PM	12:35 PM	12:48 PM
1:30 PM	1:35 PM	1:48 PM
2:30 PM	2:35 PM	2:48 PM
3:30 PM	3:35 PM	3:48 PM
4:30 PM*	4:35 PM*	4:48 PM*

## Inbound to METRA Transfer Center

H & H Services at 5601 Veterans Pkwy	H & H Services at 2100 Comer Ave.	METRA Transfer Center
3	2	1
7:52 AM	8:05 AM	8:10 AM
8:52 AM	9:05 AM	9:10 AM
9:52 AM	10:05 AM	10:10 AM
10:52 AM	11:05 AM	11:10 AM
11:52 AM	12:05 PM	12:10 PM
12:52 PM	1:05 PM	1:10 PM
1:52 PM	2:05 PM	2:10 PM
2:52 PM	3:05 PM	3:10 PM
3:52 PM	4:05 PM	4:10 PM
4:52 PM*	5:05 PM*	5:10 PM*

\*Indicates that stops on the 4:30pm trip are for returns only.

Please note that the shuttle will only depart the METRA Transfer Center at the times listed and if a ride has been scheduled. Customers who have not scheduled a trip will not be picked up at the stops listed.



For more information:  
 Call (706) 225-4581  
 or visit [columbusga.gov/Metra](http://columbusga.gov/Metra)