

Final Special Assessments for 2025 Street and Utility Improvements

Columbus, Wisconsin

Preliminary - April 8, 2025

Final – October 16, 2025

Prepared for:

**City of Columbus
Columbia County, Wisconsin**

Contents

In accordance with Final Resolution No.14-25 of The Common Council of the City of Columbus, dated 11/18/2025, this report presents the final construction quantities and costs associated with the residential portion of the 2025 Street and Utility Reconstruction in accordance with the approved plans and specifications and a schedule of the final assessments.

The assessable work includes:

- Full cost of curb and gutter, regardless of style or type (not including intersections).
- Full cost for concrete driveway aprons.
- Full cost for sidewalk through driveways (6" thick).
- 50% of the cost for new sidewalk in terrace areas (not including intersections and through driveway aprons).
- 15% of the cost of storm sewer within the right-of-way, with 85% of the cost to the City and 15% of the cost to the property owner.

List of Appendices

Appendix A: City of Columbus Resolution No.14-25

Appendix B: Construction Bid Prices from 02/14/2025

Appendix C: Final Special Assessment

Appendix D: Parcel Location Map

Appendix E: Storm Sewer System Map

Appendix A

City of Columbus Resolution No.14-25

RESOLUTION NO. 14-25

FINAL RESOLUTION AUTHORIZING PUBLIC IMPROVEMENTS AND LEVYING SPECIAL ASSESSMENTS AGAINST BENEFITED PROPERTIES

WHEREAS, a preliminary Resolution declaring intent to levy special assessments under municipal police powers pursuant to §66.0703, Stats., was approved at the January 21, 2025, meeting of the City of Columbus Common Council; and

WHEREAS, the preliminary assessment report was filed by the City Engineer with the City Clerk, and the City Clerk prepared a notice stating the nature of the proposed work or improvement, the general boundary lines of the proposed assessment district, including a small map, the place and time at which the report may be inspected and the place and time at which all interested persons or their agents or attorneys may appear before the City Council and be heard concerning the matters contained in the preliminary resolution and the report. This notice was published as a Class 1 Notice under Chapter 985 of the Wisconsin Statutes and a copy of the notice was mailed at least 10 days before the public hearing to every interested person; and

WHEREAS, the Columbus Common Council held a public hearing regarding the preliminary assessment report on June 17, 2025; and

WHEREAS, the Columbus Common Council has reviewed the final report of the City Engineer, has directed the City Engineer to modify certain plans and specifications and certain provisions of the preliminary assessment report to accomplish a fair and equitable assessment.

RESOLUTION NO. 14-25

FINAL RESOLUTION AUTHORIZING PUBLIC IMPROVEMENTS AND LEVYING SPECIAL ASSESSMENTS AGAINST BENEFITED PROPERTIES

WHEREAS, a preliminary Resolution declaring intent to levy special assessments under municipal police powers pursuant to §66.0703, Stats., was approved at the January 21, 2025, meeting of the City of Columbus Common Council; and

WHEREAS, the preliminary assessment report was filed by the City Engineer with the City Clerk, and the City Clerk prepared a notice stating the nature of the proposed work or improvement, the general boundary lines of the proposed assessment district, including a small map, the place and time at which the report may be inspected and the place and time at which all interested persons or their agents or attorneys may appear before the City Council and be heard concerning the matters contained in the preliminary resolution and the report. This notice was published as a Class 1 Notice under Chapter 985 of the Wisconsin Statutes and a copy of the notice was mailed at least 10 days before the public hearing to every interested person; and

WHEREAS, the Columbus Common Council held a public hearing regarding the preliminary assessment report on June 17, 2025; and

WHEREAS, the Columbus Common Council has reviewed the final report of the City Engineer, has directed the City Engineer to modify certain plans and specifications and certain provisions of the preliminary assessment report to accomplish a fair and equitable assessment.

NOW, THEREFORE, the City of Columbus, Columbia County, Wisconsin, by its Common Council, does hereby resolve as follows:

1. The draft Final Assessment report dated October 16, 2025, as amended by the terms of this Resolution, is now adopted and approved as the Final Assessment Report of City Engineer, Ruekert & Mielke Inc. A copy of the Final Assessment Report is attached hereto and incorporated herein.
2. Payment for the improvements set forth in the attached report shall be made by assessing the cost of the improvements to the properties benefitted as set forth in the attached report.
3. Assessments shown on the report represent an exercise of the police powers of the City of Columbus and have been determined on a reasonable basis and are hereby confirmed.
4. Upon receipt of the final notice of assessment, any owner of a benefitted property may pay the assessment in full, without interest, if paid to the City Treasurer prior to November 1, 2026. In the alternative, upon receipt of the final notice of assessment, the owner of a benefitted property may determine it is in its best interest to make payments on an installment basis. If a benefitted property owner chooses to make payments on an installment basis, the payments shall be divided into equal installment payments and paid pursuant to the repayment schedule as follows:

Range of Assessment	Term of Repayment
\$1.00 - \$2,000.99	5 years
\$2,001.00 - \$6,999.99	10 years
\$7,000.00 - \$9,999.99	15 years
\$10,000.00 and over	20 years

The interest rate for the repayment of special assessments paid on an installment basis shall be the net interest rate of the bond issued for the project plus 1%. Installment payments shall be due by November 1 of each year. If not received by November 1, the amount due shall be placed on the next tax roll for collection. If a benefitted property owner chooses an installment repayment plan as set forth above, the owner may still pay the assessment in advance without penalty.

5. The Municipal Clerk shall publish this resolution as a Class 1 Notice under Chapter 985 of the Wisconsin Statutes in the assessment district and mail a copy of this resolution and a statement of the final assessment against the benefitted property to every property owner within the assessment district whose name appears on the

assessment roll whose post office address is known or can, with reasonable diligence, be ascertained.

Dated this ____ day of _____, 2025.

CITY OF COLUMBUS

By: _____
Joseph Hammer, Mayor

By: _____
Susan L. Caine, Clerk

Resolution Published: _____

Appendix B
Construction Bid Prices
From 02/27/2025

CITY OF COLUMBUS
2025 Street and Utility Improvements
10/14/2025

No	Description	Approx		Unit	Total
		Unit	Quantity	Price	Price
Base Bid					
1	Traffic Control	LS	1	\$4,500.00	\$4,500.00
2	Tracking Pad	EA	1	\$1,000.00	\$1,000.00
3	Inlet Protection	EA	18	\$155.00	\$2,790.00
4	Silt Fence	LF	796	\$3.00	\$2,388.00
5	Full Depth Saw Cutting	LF	136	\$6.00	\$816.00
6	Construct Roadway to Subgrade	LS	1	\$45,000.00	\$45,000.00
7	Excavation Below Subgrade (EBS)	CY	805	\$36.00	\$28,980.00
8	Geogrid Subgrade Reinforcement	SY	4127	\$3.00	\$12,381.00
9	Crushed Aggregate Base Course	TON	2355	\$13.00	\$30,615.00
10	(30-Inch) Concrete Curb and Gutter	LF	1760	\$20.00	\$35,200.00
11	6-Inch Concrete Driveway Apron	SF	2136	\$9.00	\$19,224.00
12	New Concrete Sidewalk	SF	6280	\$9.00	\$56,520.00
13	Detectable Warning Fields	EA	6	\$450.00	\$2,700.00
14	2.25-Inch Asphaltic Concrete Binder Course	TON	420	\$88.00	\$36,960.00
15	1.75-Inch Asphaltic Concrete Surface Course	TON	310	\$80.00	\$24,800.00
16	Topsoil, Seed, Fertilizer, (Class 1) (Type A) Erosion Mat	LS	1	\$28,500.00	\$28,500.00
17	8-inch PVC Sanitary Sewer w/ Granular Backfill	LF	45	\$110.00	\$4,950.00
18	12-Inch PVC Sanitary Sewer w/ Granular Backfill	LF	634	\$115.00	\$72,910.00
19	48-Inch Sanitary Sewer Manhole w/ Frame and Cover	EA	3	\$4,900.00	\$14,700.00
20	6-Inch PVC Sanitary Sewer Lateral	LF	306	\$88.00	\$26,928.00
21	Raise Existing Sanitary Sewer Manhole	VF	7	\$400.00	\$2,800.00
22	12-Inch RCP Class V Storm Sewer w/ Granular Backfill	LF	243	\$75.00	\$18,225.00
23	18-Inch RCP Class IV Storm Sewer w/ Granular Backfill	LF	78	\$85.00	\$6,630.00
24	24-Inch RCP Class IV Storm Sewer w/ Granular Backfill	LF	160	\$90.00	\$14,400.00
25	2'x3' Standard Catch Basin Precast Box w/ Frame and Grate	EA	13	\$2,400.00	\$31,200.00
26	48-Inch Storm Sewer Manhole w/ Frame and Cover	EA	1	\$4,000.00	\$4,000.00
27	60-Inch Storm Sewer Manhole w/ Frame and Cover	EA	4	\$5,400.00	\$21,600.00
28	6-Inch Storm Sewer Lateral	LF	106	\$50.00	\$5,300.00
29	6-Inch DIP Water Main w/Granular Backfill	LF	12	\$110.00	\$1,320.00
30	8-Inch DIP Water Main w/Granular Backfill	LF	97	\$120.00	\$11,640.00
31	10-Inch DIP Water Main w/Granular Backfill	LF	84	\$180.00	\$15,120.00
32	12-Inch DIP Water Main w/Spoil Backfill	LF	475	\$160.00	\$76,000.00
33	12-Inch DIP Water Main w/Granular Backfill	LF	665	\$170.00	\$113,050.00
34	8-Inch Water Main Valve	EA	3	\$3,800.00	\$11,400.00
35	10-Inch Water Main Valve	EA	2	\$4,200.00	\$8,400.00
36	12-Inch Water Main Valve	EA	5	\$4,600.00	\$23,000.00
37	Hydrant Assembly	EA	4	\$8,200.00	\$32,800.00
38	6-Inch Water Lead	LF	50	\$120.00	\$6,000.00
39	1-Inch Copper Water Services - Open Trench w/Granular Backfill	LF	293	\$85.00	\$24,905.00
40	1-Inch Tap and Corporation Valve	EA	8	\$450.00	\$3,600.00
41	1-Inch Curb Valve and Curb Box	EA	8	\$450.00	\$3,600.00
42	Pipe Insulation	LF	40	\$85.00	\$3,400.00
43	Street Trees	EA	4	\$500.00	\$2,000.00
44	Tree Removal	ID	95	\$50.00	\$4,750.00
TOTAL					\$897,002.00

Assessable Improvements for 2025 Street and Utility Improvements

The assessable items from the project are as follows:

1. New Concrete Sidewalk
2. 6-Inch Concrete Driveway Approach
3. 30-Inch Concrete Curb and Gutter
4. 12-Inch RCP CL V Storm Sewer w/Granular Backfill
5. 15-Inch RCP CL IV Storm Sewer w/Granular Backfill
6. 18-Inch RCP CL IV Storm Sewer w/Granular Backfill
7. New 48-Inch Storm Manhole w/Frame and Cover
8. New 60-Inch Storm Manhole w/Frame and Cover
9. 24-Inch x 36-Inch Standard Catch Basin w/Frame and Grate
10. 6-Inch PVC Storm Sewer Lateral

Appendix C

Final Total Assessment

CITY OF COLUMBUS**2025 Street and Utility Improvements**

10/14/2025

EXPLANATION OF ASSESSABLE COSTS**1. New Concrete Sidewalk**

The assessable cost is based on the area of sidewalk to be installed for each parcel and does not include intersections. 100% of the cost of sidewalk through the driveway is assessed to the respective property owner. This project will be receiving sidewalk on the north and south side (both sides). As a result the sidewalk cost will be shared 50% by property owners and 50% by the City for that portion of sidewalk along the property frontage minus the sidewalk through the driveway assessed at 100%.

2. 6 - Inch Concrete Driveway Approach

The assessable cost is based on the area of new concrete driveway approach for each parcel.

3. 30-Inch Concrete Curb and Gutter

The assessable cost is based on the length of new curb and gutter along the frontage of each parcel and does not include intersections. The quantity of 30-Inch Concrete Curb and Gutter per parcel is calculated in attached table.

4. 12-Inch RCP CL V Storm Sewer w/Granular Backfill

The assessable cost for this item is based on the lot frontage of each lot which contributes and benefits to a specific storm sewer system. The cost is assessed on a percentage basis of total lot frontage for each system. Storm sewer systems and their respective contributing parcels are depicted on the attached exhibits in Appendix E. Overall system costs are listed in attached tables.

5. 18-Inch RCP CL IV Storm Sewer w/Granular Backfill

The assessable cost for this item is based on the lot frontage of each lot which contributes and benefits to a specific storm sewer system. The cost is assessed on a percentage basis of total lot frontage for each system. Storm sewer systems and their respective contributing parcels are depicted on the attached exhibits in Appendix E. Overall system costs are listed in attached tables.

6. 24-Inch RCP CL IV Storm Sewer w/Granular Backfill

The assessable cost for this item is based on the lot frontage of each lot which contributes and benefits to a specific storm sewer system. The cost is assessed on a percentage basis of total lot frontage for each system. Storm sewer systems and their respective contributing parcels are depicted on the attached exhibits in Appendix E. Overall system costs are listed in attached tables.

7. New 48-Inch Storm Manhole w/Frame and Cover

The assessable cost for this item is based on the lot frontage of each lot which contributes and benefits to a specific storm sewer system. The cost is assessed on a percentage basis of total lot frontage for each system. Storm sewer systems and their respective contributing parcels are depicted on the attached exhibits in Appendix E. Overall system costs are listed in attached tables.

8. New 60-Inch Storm Manhole w/Frame and Cover

The assessable cost for this item is based on the lot frontage of each lot which contributes and benefits to a specific storm sewer system. The cost is assessed on a percentage basis of total lot frontage for each system. Storm sewer systems and their respective contributing parcels are depicted on the attached exhibits in Appendix E. Overall system costs are listed in attached tables.

9. 24-Inch x 36-Inch Standard Catch Basin w/Frame and Grate

The assessable cost for this item is based on the lot frontage of each lot which contributes and benefits to a specific storm sewer system. The cost is assessed on a percentage basis of total lot frontage for each system. Storm sewer systems and their respective contributing parcels are depicted on the attached exhibits in Appendix E. Overall system costs are listed in attached tables.

10. 6-Inch PVC Storm Sewer Lateral

The assessable cost for this item is based on the parcel served by each lateral. The cost assessed to each parcel is listed in attached tables.

CITY OF COLUMBUS
2025 Street and Utility Improvements
10/14/2025
Total Final Assessments Per Parcel

Owner and Description of Property										Assessment Amounts Per Parcel													
TAX PARCEL		LOT ADDRESS		OWNER		MAILING ADDRESS		STREET FRONTAGE		FRONTAGE (FT)		Final		CONCRETE DRIVEWAY APRONS		30-INCH CONCRETE CURB & GUTTER		CONCRETE SIDEWALK (THROUGH DRIVEWAY)		NEW CONCRETE SIDEWALK		STORM SEWER	
												TOTAL		100% to Prop. Owners		100% to Prop. Owners		100% to Prop. Owners		50% to Prop. Owners		15% to Tributary Prop. Owners	
														Amount		Amount		Amount		Amount		Amount	
2025 Street and Utility Improvements																							
1	11211-1327	218 Avalon Road	Jared Guelig	218 Avalon Road	Columbus WI 53925	Brookside	128.20	\$8,065.44		\$0.00	\$2,564.00	\$0.00	\$2,884.50			\$0.00						\$2,616.54	
2	11211-1345	302 Brookside Lane	James Mccann	302 Brookside Lane	Columbus WI 53925	Brookside	128.20	\$10,015.72		\$1,520.28	\$2,564.00	\$810.00	\$2,479.50			\$810.00						\$2,641.54	
3	11211-1262	424 Parkview Drive	Steven A. Vick	424 Parkview Drive	Columbus WI 53925	Brookside	100.00	\$6,333.26			\$2,000.00	\$0.00	\$2,250.00			\$0.00						\$2,083.26	
4	11211-1263	402 Brookside Lane	Terry L. Pribbeno	402 Brookside Lane	Columbus WI 53925	Brookside	133.11	\$8,477.19		\$990.72	\$2,662.20	\$508.50	\$2,740.73			\$508.50						\$1,575.04	
5	11211-1264	402 Brookside Lane	Terry L. Pribbeno	402 Brookside Lane	Columbus WI 53925	Brookside	81.23	\$6,757.49		\$1,754.55	\$1,624.60	\$1,179.00	\$1,238.18			\$1,179.00						\$961.17	
6	11211-1265	407 Brookside Lane	Justin Robert & Crystal Lyn Morgan	407 Brookside Lane	Columbus WI 53925	Brookside	57.33	\$4,584.05		\$1,057.41	\$1,146.60	\$823.50	\$978.18			\$823.50						\$678.37	
7	11211-1266	405 Brookside Lane	Dillen & Kaleigh Wedel	405 Brookside Lane	Columbus WI 53925	Brookside	82.88	\$6,409.74		\$1,389.15	\$1,657.60	\$1,035.00	\$1,347.30			\$1,035.00						\$980.69	
8	11211-1267	403 Brookside Lane	Ronald P. & Lorraine A. Durst	403 Brookside Lane	Columbus WI 53925	Brookside	106.72	\$7,629.20		\$1,457.33	\$2,134.40	\$810.00	\$1,262.78			\$810.00						\$1,183.26	
9	11211-1268	401 Brookside Lane	Kerry J. & Kathleen M. Freidel	401 Brookside Lane	Columbus WI 53925	Brookside	100.00	\$7,349.14		\$1,510.88	\$2,000.00	\$810.00	\$1,183.26			\$810.00						\$1,183.26	
10	11211-1269	305 Brookside Lane	Robert & Sandra Pratt Living Trust	305 Brookside Lane	Columbus WI 53925	Brookside	100.00	\$7,406.96		\$1,568.70	\$2,000.00	\$810.00	\$1,183.26			\$810.00						\$1,183.26	
11	11211-1270	303 Brookside Lane	Todd A. & Bridget E. Morris	303 Brookside Lane	Columbus WI 53925	Brookside	100.00	\$7,660.22		\$1,772.46	\$2,000.00	\$969.00	\$1,183.26			\$2,000.00						\$1,183.26	
12	11211-1271	301 Brookside Lane	James R. & Peggy J. First	301 Brookside Lane	Columbus WI 53925	Brookside	100.00	\$7,753.01		\$1,836.00	\$2,000.00	\$967.50	\$1,183.26			\$2,000.00						\$1,183.26	
TOTALS BROOKSIDE LANE										\$88,441.45	\$14,857.47	\$24,353.40	\$8,599.50	\$23,097.83			\$8,599.50						\$17,533.25

Parcels include cost of storm lateral

CITY OF COLUMBUS
2025 Street and Utility Improvements
10/14/2025
Concrete Driveway Approaches

Parcel No.	Address	Frontage	Qty (SF)	Unit Price	Total
11211-1327	218 Avalon Road	128.20	-	\$9.00	\$ -
11211-1345	302 Brookside Lane	128.20	168.92	\$9.00	\$ 1,520.28
11211-1262	424 Parkview Drive	100.00	-	\$9.00	\$ -
11211-1263	402 Brookside Lane	133.11	110.08	\$9.00	\$ 990.72
11211-1264	402 Brookside Lane	81.23	194.95	\$9.00	\$ 1,754.55
11211-1265	407 Brookside Lane	57.33	117.49	\$9.00	\$ 1,057.41
11211-1266	405 Brookside Lane	82.88	154.35	\$9.00	\$ 1,389.15
11211-1267	403 Brookside Lane	106.72	161.93	\$9.00	\$ 1,457.33
11211-1268	401 Brookside Lane	100.00	167.88	\$9.00	\$ 1,510.88
11211-1269	305 Brookside Lane	100.00	174.30	\$9.00	\$ 1,568.70
11211-1270	303 Brookside Lane	100.00	196.94	\$9.00	\$ 1,772.46
11211-1271	301 Brookside Lane	100.00	204.00	\$9.00	\$ 1,836.00

CITY OF COLUMBUS
2025 Street and Utility Improvements
10/14/2025
Sidewalk in Driveways

TAX PARCEL	LOT ADDRESS	OWNER	MAILING ADDRESS	STREET FRONTAGE	Sidewalk area within Driveway (SF)	Total Area of apron to ROW	Sidewalk Length through Drive	Unit Price	Total Sidewalk Cost through Driveway
11211-1327	218 Avalon Road	Jared Guelig	218 Avalon Road	Brookside	0.00	-	0.00	\$9.00	\$ -
11211-1345	302 Brookside Lane	James McCann	302 Brookside Lane	Brookside	90.00	168.92	18.00	\$9.00	\$ 810.00
11211-1262	424 Parkview Drive	Steven A. Vick	424 Parkview Drive	Brookside	0.00	-	0.00	\$9.00	\$ -
11211-1263	402 Brookside Lane	Terry L. Pribbeno	402 Brookside Lane	Brookside	56.50	110.08	11.30	\$9.00	\$ 508.50
11211-1264	407 Brookside Lane	Terry L. Pribbeno	407 Brookside Lane	Brookside	131.00	194.95	26.20	\$9.00	\$ 1,179.00
11211-1265	407 Brookside Lane	Justin Robert & Crystal Lyn Morgan	407 Brookside Lane	Brookside	91.50	117.49	18.30	\$9.00	\$ 823.50
11211-1266	405 Brookside Lane	Dillon & Kaleigh Wedel	405 Brookside Lane	Brookside	115.00	154.35	23.00	\$9.00	\$ 1,035.00
11211-1267	403 Brookside Lane	Ronald P. & Lorraine A. Durst	403 Brookside Lane	Brookside	83.00	161.93	16.60	\$9.00	\$ 747.00
11211-1268	401 Brookside Lane	Kerry J. & Kathleen M. Freidel	401 Brookside Lane	Brookside	90.00	167.88	18.00	\$9.00	\$ 810.00
11211-1269	305 Brookside Lane	Robert & Sandra Pratt Living Trust	305 Brookside Lane	Brookside	90.00	174.30	18.00	\$9.00	\$ 810.00
11211-1270	303 Brookside Lane	Todd A. & Bridget E. Morris	303 Brookside Lane	Brookside	101.00	196.94	20.20	\$9.00	\$ 909.00
11211-1271	301 Brookside Lane	James R. & Peggy J. First	301 Brookside Lane	Brookside	107.50	204.00	21.50	\$9.00	\$ 967.50

CITY OF COLUMBUS
2025 Street and Utility Improvements
10/14/2025
Sidewalk

Parcel No.	Address	Frontage	Sidewalk Lengths per Frontage (LF)	Sidewalk Minus Driveway Width (LF)	Sidewalk Through Drive (100%)	Sidewalk Outside of Drive (50%)
11211-1327	218 Avalon Road	Brookside	128.20	128.20	\$ -	\$2,884.50
11211-1345	302 Brookside Lane	Brookside	128.20	110.20	\$ 810.00	\$2,479.50
11211-1262	424 Parkview Drive	Brookside	100.00	100.00	\$ -	\$2,250.00
11211-1263	402 Brookside Lane	Brookside	133.11	121.81	\$ 508.50	\$2,740.73
11211-1264	402 Brookside Lane	Brookside	81.23	55.03	\$ 1,179.00	\$1,238.18
11211-1265	407 Brookside Lane	Brookside	57.33	39.03	\$ 823.50	\$878.18
11211-1266	405 Brookside Lane	Brookside	82.88	59.88	\$ 1,035.00	\$1,347.30
11211-1267	403 Brookside Lane	Brookside	106.72	90.12	\$ 747.00	\$2,027.70
11211-1268	401 Brookside Lane	Brookside	100.00	82.00	\$ 810.00	\$1,845.00
11211-1269	305 Brookside Lane	Brookside	100.00	82.00	\$ 810.00	\$1,845.00
11211-1270	303 Brookside Lane	Brookside	100.00	79.80	\$ 909.00	\$1,795.50
11211-1271	301 Brookside Lane	Brookside	100.00	78.50	\$ 967.50	\$1,766.25

CITY OF COLUMBUS
2025 Street and Utility Improvements
10/14/2025
30-Inch Concrete Curb & Gutter

Parcel No.	Address	Frontage	Curb Lengths per Frontage (LF)	Unit Price	30-Inch Concrete Curb and Gutter
11211-1327	218 Avalon Road	Brookside	128.20	\$20.00	\$ 2,564.00
11211-1345	302 Brookside Lane	Brookside	128.20	\$20.00	\$ 2,564.00
11211-1262	424 Parkview Drive	Brookside	100.00	\$20.00	\$ 2,000.00
11211-1263	402 Brookside Lane	Brookside	133.11	\$20.00	\$ 2,662.20
11211-1264	402 Brookside Lane	Brookside	81.23	\$20.00	\$ 1,624.60
11211-1265	407 Brookside Lane	Brookside	57.33	\$20.00	\$ 1,146.60
11211-1266	405 Brookside Lane	Brookside	82.88	\$20.00	\$ 1,657.60
11211-1267	403 Brookside Lane	Brookside	106.72	\$20.00	\$ 2,134.40
11211-1268	401 Brookside Lane	Brookside	100.00	\$20.00	\$ 2,000.00
11211-1269	305 Brookside Lane	Brookside	100.00	\$20.00	\$ 2,000.00
11211-1270	303 Brookside Lane	Brookside	100.00	\$20.00	\$ 2,000.00
11211-1271	301 Brookside Lane	Brookside	100.00	\$20.00	\$ 2,000.00

CITY OF COLUMBUS

2025 Street and Utility Improvements

10/14/2025

Storm System Costs

Note: for location and contributing properties for each system, see maps in Appendix E

Storm Sewer Total Project One Contributing Area

Item No	Item	Unit	Quantity	Unit \$	Total
22	12-Inch RCP Class V Storm Sewer w/ Granular Backfill	LF	201	\$ 75.00	\$ 18,225.00
23	18-Inch RCP Class IV Storm Sewer w/ Granular Backfill	LF	75	\$ 85.00	\$ 6,630.00
24	24-Inch RCP Class IV Storm Sewer w/ Granular Backfill	LF	158	\$ 90.00	\$ 14,400.00
25	2'x3' Standard Catch Basin Precast Box w/ Frame and Grate	EA	13	\$ 2,400.00	\$ 31,200.00
26	48-Inch Storm Sewer Manhole w/ Frame and Cover	EA	1	\$ 4,000.00	\$ 4,000.00
27	60-Inch Storm Sewer Manhole w/ Frame and Cover	EA	4	\$ 5,400.00	\$ 21,600.00
Total					\$96,055.00

CITY OF COLUMBUS
2025 Street and Utility Improvements
10/14/2025
Storm System Assessed By Property

Parcel No.	Address	Frontage Street	Frontage Length (LF)	% of Total	100% Sub-total System Cost	15% Sub-total System Cost	Total Storm Water Assessment (% of total)
11211-1327	218 Avalon Road	Brookside	128.20	10.53%	\$10,112.96	\$2,616.94	15%
11211-1345	302 Brookside Lane	Brookside	128.20	10.53%	\$10,112.96	\$2,641.94	15%
11211-1262	424 Parkview Drive	Brookside	100.00	8.21%	\$7,888.43	\$2,083.26	15%
11211-1263	402 Brookside Lane	Brookside	133.11	10.93%	\$10,500.28	\$1,575.04	15%
11211-1264	402 Brookside Lane	Brookside	81.23	6.67%	\$6,407.77	\$961.17	15%
11211-1265	407 Brookside Lane	Brookside	57.33	4.71%	\$4,522.43	\$678.37	15%
11211-1266	405 Brookside Lane	Brookside	82.88	6.81%	\$6,537.93	\$980.69	15%
11211-1267	403 Brookside Lane	Brookside	106.72	8.76%	\$8,418.53	\$1,262.78	15%
11211-1268	401 Brookside Lane	Brookside	100.00	8.21%	\$7,888.43	\$1,183.26	15%
11211-1269	305 Brookside Lane	Brookside	100.00	8.21%	\$7,888.43	\$1,183.26	15%
11211-1270	303 Brookside Lane	Brookside	100.00	8.21%	\$7,888.43	\$1,183.26	15%
11211-1271	301 Brookside Lane	Brookside	100.00	8.21%	\$7,888.43	\$1,183.26	15%
TOTAL			1,217.67	100%	\$96,055.00	\$17,533.25	18%

Parcels include assessed cost for storm lateral

Appendix D

Parcel Location Map

Appendix E

Storm Sewer System Map

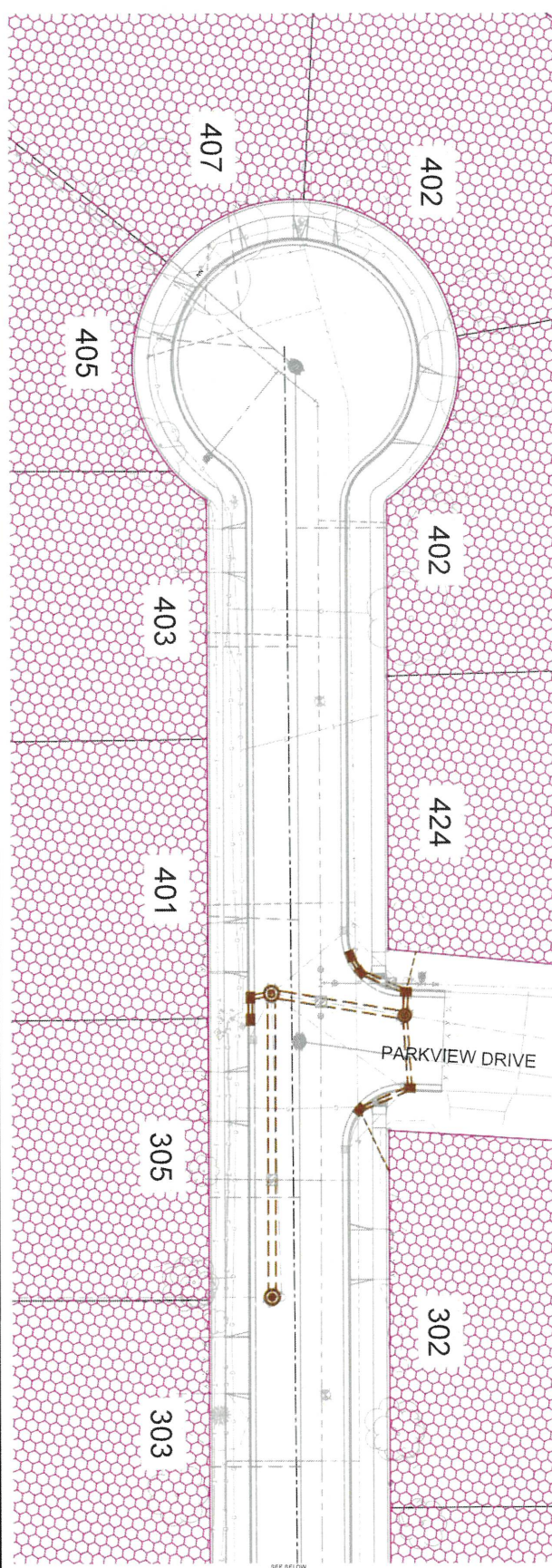

SEE BELOW