

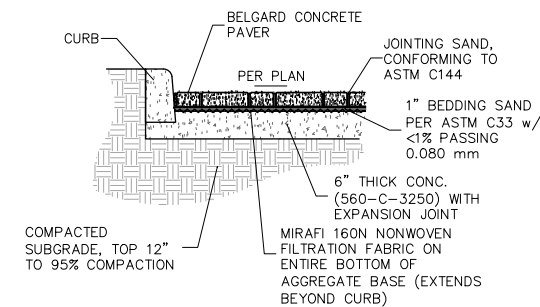

CONSTRUCTION NOTES

	UNITS	QUANTITY
1) PROTECT IN PLACE	--	--
(1) 2) REMOVE CURB & GUTTER	LF	195
(1) 3) REMOVE SIDEWALK	SF	1,075
(1) 4) REMOVE DRIVEWAY	SF	164
5) SALVAGE & REINSTALL STREET SIGN	EA	1
6) COMMUNICATIONS POLE TO BE REMOVED BY OTHERS	EA	3
7) CONST. 6" CONC. w/ FIBER MESH OVER 8" CMB	SF	13,050
8) CONST. 6" TYPE D CURB PER COC STD S-10	LF	508
9) CONST. 6" C&G PER COC STD S-7	LF	366
10) CONST. SIDEWALK (WIDTH PER PLAN) PER COC STD S25.1	SF	5,741
11) CONST. CURB RAMP TYPE 1, CASE B PER SPPIC DWG 111-5	EA	2
12) CONST. CROSSWALK w/ TRAFFIC RATED INTERLOCKING PAVERS (SANDSTONE COLOR) PER DETAIL ON SHEET 2	SF	228
13) CONST. BUS TURNOUT PER RCTD STD 814	SF	2,292
14) CONST. 8" CONCRETE BUILDING SLAB PER DETAIL ON SHEET 2	SF	514
15) F&I METAL BOLLARD PER DETAIL ON SHEET 2	EA	3
16) CONST. CONC. CURB OPENING w/ SPILLWAY PER DETAIL ON SHEET 2	SF	225
17) RIPRAP PER DETAIL ON SHEET 2	SF	45
18) CONST. PARTIAL CONC. SPANDREL PER DETAIL ON SHEET 2	SF	142
19) F&I PARKING LOT LIGHT, POST TYPE PER DETAIL ON SHEET 9	EA	5
20) F&I PARKING LOT LIGHT, SINGLE HEAD MAST, PER DETAIL ON SHEET 9	EA	3
21) F&I PARKING LOT LIGHT, DUAL HEAD MAST, PER DETAIL ON SHEET 9	EA	3
22) F&I 1.5" PVC CONDUIT & CONDUCTORS FOR SITE LIGHTING	LF	560
23) F&I IID TRANSFORMER PAD PER IID PLANS	EA	1
24) F&I 4" SCH 40 PVC CONDUIT (IID)	LF	20
25) F&I 6" SCH 40 PVC CONDUIT (IID)	LF	112
26) INSTALL SIGN	EA	4
27) INSTALL STOP BAR & "STOP" PM	EA	1
28) F&I 6" SDR-26 PVC SEWER LATERAL w/ BENDS & WYES PER COC STD. D-11	LF	105
29) F&I 6" SEWER CLEAN OUT PER COC STD D-1	EA	1
30) F&I 2" PVC SDR-21 DOMESTIC WATER SERVICE w/ BENDS & THRUST BLOCKS PER COC STD W-8	LF	250
31) F&I 1.5" PVC CONDUIT w/ PULL ROPE (DATA & FUTURE)	LF	570
32) F&I ELECTRICAL PULL BOX PER SPPIC STD 513-3	EA	3
33) F&I SIGN POST ONLY FOR SUNLINE BUS STOP SIGNAGE	EA	6
34) F&I SECURITY CAMERA & MOUNTING BRACKETS	EA	9
35) BUS STOP INFO SIGN INSTALLED BY SUNLINE	EA	5
36) F&I SIGNAL PULL BOX, CONDUIT & CABLING TO CONTROLLER CABINET	EA	1
37) F&I 3/4" PVC SDR-21 DOMESTIC WATER SERVICE w/ BENDS, CORP STOP & VALVE BOX	LF	40

(1) QUANTITY PROVIDED FOR INFORMATION ONLY. ITEMS OF WORK PER THE SPECIFICATIONS ARE INCIDENTAL TO OTHER CONSTRUCTION ITEMS LISTED IN THE BID SCHEDULE.
 NOTE: QUANTITIES LISTED ABOVE ARE PROVIDED FOR CONTRACTOR INFORMATION. THE BID ITEMS LISTED IN THE PROJECT BID PACKAGE UNDER THE BID SCHEDULE WILL GOVERN IN THE CASE OF A DISCREPANCY IN THE ABOVE LISTED QUANTITIES.



12) CROSSWALK DETAIL @ CURB
NOT TO SCALE

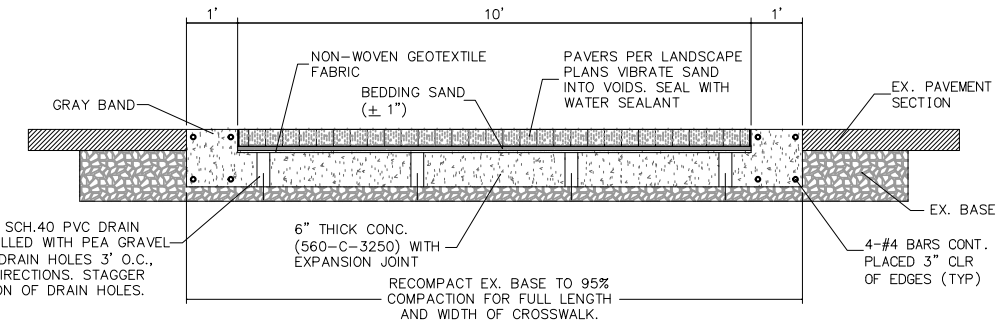

12) CROSSWALK CROSS SECTION DETAIL
NOT TO SCALE

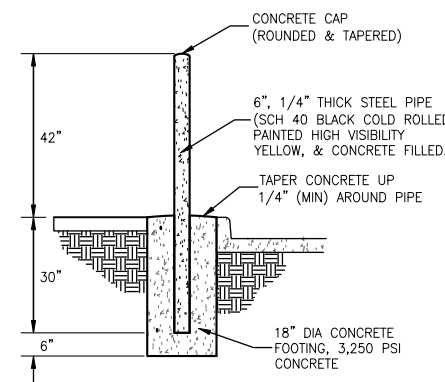

15) METAL BOLLARD
NOT TO SCALE

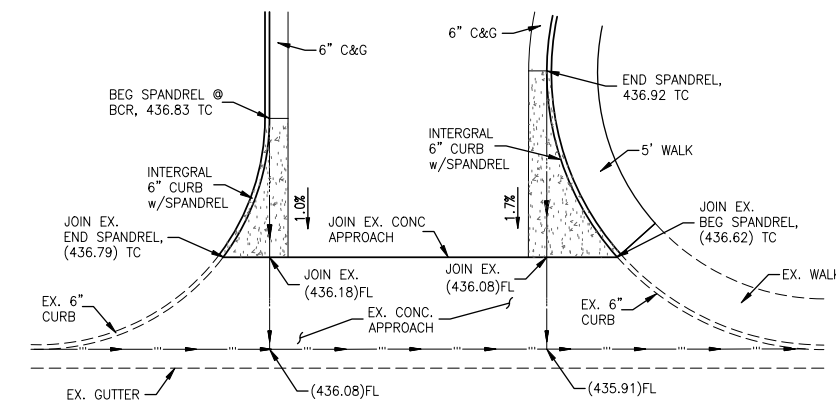

18) PARTIAL CONC. SPANDREL
NOT TO SCALE

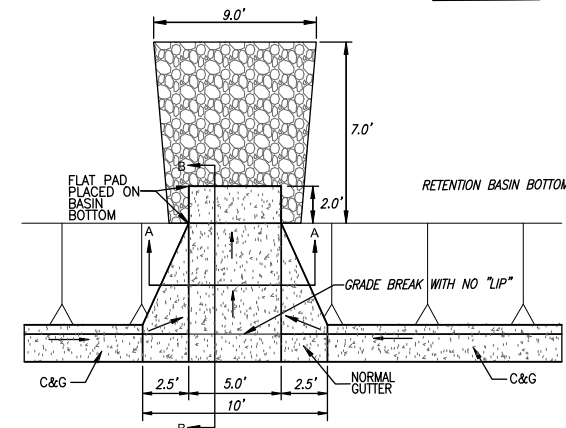
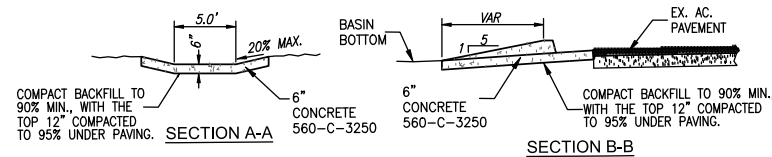

16) 17) CURB OPENING w/ SPILLWAY & RIPRAP
NOT TO SCALE

WAITING ON RECOMMENDATIONS FROM THE BUILDING MANUFACTURER

14) CONCRETE BUILDING SLAB
NOT TO SCALE

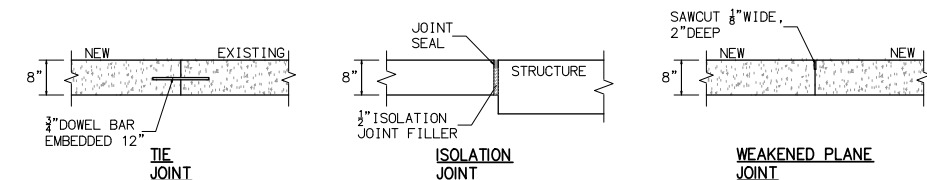

7) CONCRETE PAVEMENT JOINTS
NOT TO SCALE

CONCRETE PAVEMENT CONSTRUCTION NOTES

1. THE TOP 12" OF SUBGRADE SHALL BE COMPACTED TO 95% RELATIVE COMPACTION, WITH THE SUBGRADE BROUGHT TO JUST OVER OPTIMUM MOISTURE CONTENT DURING COMPACTION OPERATIONS.
2. THE CONCRETE STRUCTURAL SECTION FOR THE FRONT PARKING LOT/DRIVEWAY AREA SHALL BE AS FOLLOWS:
6.0" THICK 560-C-4500 CONCRETE W/ TYPE III FIBER MESH AND REINFORCEMENT OVER 8.0" THICK CRUSHED MISC. BASE (CMB) CLASS II OVER 12.0" THICK COMPACTED SUBGRADE TO 95% RELATIVE COMPACTION
3. THE FRONT PARKING LOT/DRIVEWAY AREA SHALL BE REINFORCED WITH #4 REINFORCEMENT PLACED 18" O.C., AND THE FIBER MESH SHALL BE TYPE III, BOTH IN ACCORDANCE WITH THE GREENBOOK STANDARD SPECIFICATION 201-2.
4. MAXIMUM JOINT SPACING IS 12 FEET, UNLESS OTHERWISE NOTED. LAYOUT JOINTS SHALL BE SQUARE. RECTANGULAR PANELS MAY BE ALLOWED AS LONG AS THE LONG DIMENSION IS NO MORE THAN 1.5 TIMES THE LENGTH OF THE SHORT DIMENSION.
5. WEAKENED PLANE JOINTS SHALL HAVE A DEPTH OF AT LEAST ONE-QUARTER (1/4) OF THE SLAB THICKNESS (WITH A MINIMUM DEPTH OF 1.5"). EXPANSION JOINTS SHALL EXTEND THROUGH THE ENTIRE SLAB THICKNESS AND SHALL BE USED TO ISOLATE FIXED OBJECTS ABUTTING OR WITHIN THE CONCRETE AREA. SAWED JOINTS SHALL BE COMPLETED AS SOON AS POSSIBLE WITHOUT RAVELING THE NEW CONCRETE.
6. ALL NEW CONCRETE ADJACENT TO EXISTING CONCRETE PAVEMENT, FOR THE BACK YARD PAVING, SHALL BE TIED TO THE EXISTING CONCRETE WITH A 3/8" DOWEL BAR EMBEDDED A MINIMUM OF 12" INTO BOTH THE NEW AND EXISTING CONCRETE. DOWEL BARS SHALL BE SPACED AT 24" O.C., AND A SHALL BE PLACED NO CLOSER THAN 12" FROM A WEAKENED PLANE JOINT.

NOTE: WORK CONTAINED WITHIN THESE PLANS SHALL NOT COMMENCE UNTIL AN ENCROACHMENT PERMIT AND/OR A GRADING PERMIT HAS BEEN ISSUED.
 THE PRIVATE ENGINEER SIGNING THESE PLANS IS RESPONSIBLE FOR ASSURING THE ACCURACY AND ACCEPTABILITY OF THE DESIGN HEREON. IN THE EVENT OF DISCREPANCIES ARISING AFTER CITY APPROVAL OR DURING CONSTRUCTION THE PRIVATE ENGINEER SHALL BE RESPONSIBLE FOR DETERMINING AN ACCEPTABLE SOLUTION AND REVISORING THE PLANS FOR APPROVAL BY THE CITY.



BENCHMARK: CITY OF COACHELLA 1007 ELEVATION: 437.448 DATUM: NAD83 + 500 FEET
 DESCRIPTION: 3 1/2" BRASS DISK SET IN TOP OF THE NORTHWEST CORNER OF A 1.5 FOOT HIGH PLASTER WALL AROUND THE "CITY OF COACHELLA" MONUMENT SIGN, LOCATED 25 FEET SOUTHEAST FROM THE BEGINNING OF THE SOUTH CURB RETURN AND 35 FEET SOUTH WEST OF SOUTHERLY CURB RETURN LOCATED AT THE INTERSECTION OF GRAPEFRUIT BLVD. (HIGHWAY 111) AND CESAR CHAVEZ (HARRISON STREET).
 BASIS OF BEARINGS: THE BASIS OF BEARINGS FOR THIS SURVEY IS THE CALIFORNIA COORDINATE SYSTEM (CCS83), ZONE 14, AS DETERMINED LOCALLY BY THE LINE BETWEEN CONTINUOUS OPERATING GPS BASE STATION STATIONS P491 AND P1N1, (EPOCH 2017.50) COORDINATES, AS COMPUTED AND PUBLISHED BY SCRIPPS ORBIT AND PERMANENT ARRAY CENTER (SPAC) AND THE CALIFORNIA SPATIAL REFERENCE CENTER (CSRC), BEING: NORTH 78° 59' 35.49" WEST.

BY	DATE	REVISIONS	APPR.	DATE	SEAL	CITY

RECOMMENDED FOR APPROVAL:
 NIEL OWLSLEY R.C.E. 39877 DATE: EXP. 12-31-2021
CITY OF COACHELLA
 APPROVED FOR CONSTRUCTION:
 ANDREW R. SIMMONS R.C.E. 72868 DATE: EXP. 09-30-2022

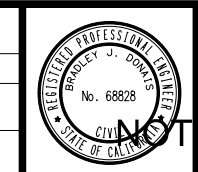

CITY OF COACHELLA
 SUNLINE TRANSIT
 COACHELLA TRANSIT HUB
CONSTRUCTION NOTES & DETAILS
 W.O. 77100149 CITY FILE NO.

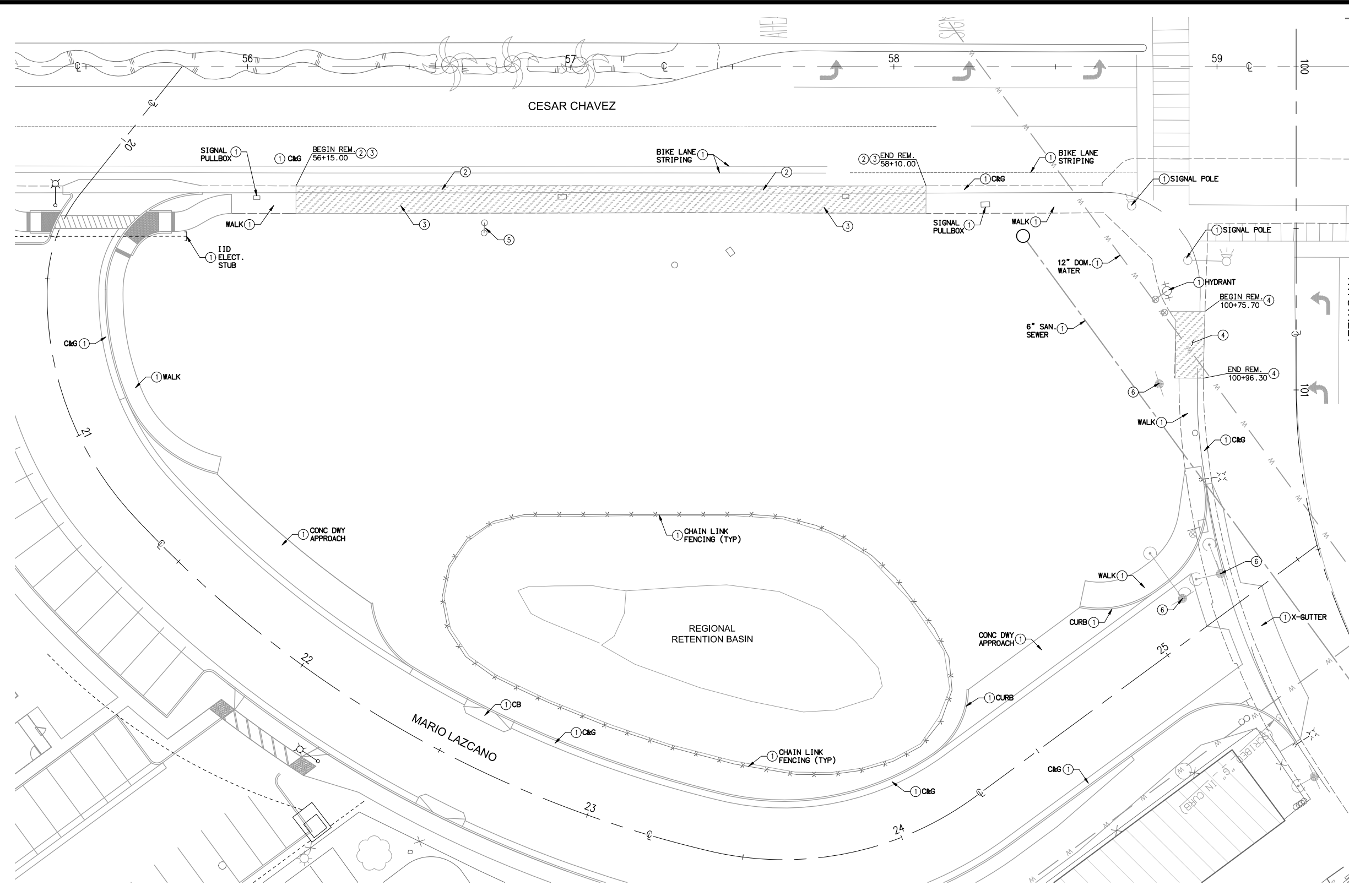

- CONSTRUCTION NOTES**
- ① PROTECT IN PLACE
 - ② REMOVE CURB & GUTTER
 - ③ REMOVE SIDEWALK
 - ④ REMOVE DRIVEWAY
 - ⑤ SALVAGE & REINSTALL STREET SIGN
 - ⑥ COMMUNICATIONS POLE TO BE REMOVED BY OTHERS

LEGEND

REMOVE CONCRETE ② ③ ④

MARIO LAZCANO NOTE:
 MARIO LAZCANO STREET IMPROVEMENTS FROM STATION 23+00 TO 4TH STREET, ARE A PART OF A SEPARATE CITY IMPROVEMENT PROJECT. SUNLINE'S CONTRACTOR SHALL COORDINATE ALL CONSTRUCTION ACTIVITIES WITH THE CITY'S CONTRACTOR FOR CONNECTIONS INTO MARIO LAZCANO.

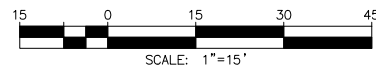

06/18/2021

NOTE: WORK CONTAINED WITHIN THESE PLANS SHALL NOT COMMENCE UNTIL AN ENCROACHMENT PERMIT AND/OR A GRADING PERMIT HAS BEEN ISSUED.

THE PRIVATE ENGINEER SIGNING THESE PLANS IS RESPONSIBLE FOR ASSURING THE ACCURACY AND ACCEPTABILITY OF THE DESIGN HEREON. IN THE EVENT OF DISCREPANCIES ARISING AFTER CITY APPROVAL OR DURING CONSTRUCTION THE PRIVATE ENGINEER SHALL BE RESPONSIBLE FOR DETERMINING AN ACCEPTABLE SOLUTION AND REVISING THE PLANS FOR APPROVAL BY THE CITY.



BENCHMARK: CITY OF COACHELLA 1007 ELEVATION: 437.448 DATUM: NAD83 + 500 FEET
 DESCRIPTION: 3 1/2" BRASS DISK SET IN TOP OF THE NORTHWEST CORNER OF A 1.5 FOOT HIGH PLASTER WALL AROUND THE "CITY OF COACHELLA" MONUMENT SIGN, LOCATED 25 FEET SOUTHEAST FROM THE BEGINNING OF THE SOUTH CURB RETURN AND 35 FEET SOUTH WEST OF SOUTHERLY CURB RETURN LOCATED AT THE INTERSECTION OF GRAPEFRUIT BLVD. (HIGHWAY 111) AND CESAR CHAVEZ (HARRISON STREET).

BASIS OF BEARINGS: THE BASIS OF BEARINGS FOR THIS SURVEY IS THE CALIFORNIA COORDINATE SYSTEM (CCS83), ZONE 14, AS DETERMINED LOCALLY BY THE LINE BETWEEN CONTINUOUS OPERATING GPS BASE STATION STATIONS P491 AND P1N1, (EPOCH 2017.50) COORDINATES), AS COMPUTED AND PUBLISHED BY SCRIPPS ORBIT AND PERMANENT ARRAY CENTER (SOPAC) AND THE CALIFORNIA SPATIAL REFERENCE CENTER (CSRC), BEING: NORTH 78° 59' 35.41" WEST.

BY	DATE	REVISIONS	APP'D	CITY	SEAL	CITY

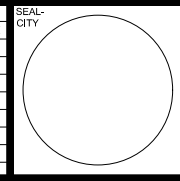

RECOMMENDED FOR APPROVAL
 DATE: EXP. 12-31-2021
 NCEL OWLSLEY R.C.E. 39877
CITY OF COACHELLA
 APPROVED FOR CONSTRUCTION
 DATE: EXP. 06-30-2022
 ANDREW R. SIMONS R.C.E. 7266

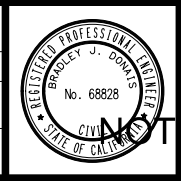

QUALITY, DEDICATION & EXPERIENCE
HEPTAGON SEVEN
 8413 E BASELINE RD SUITE 106 MESA, AZ 85209 480.757.0997
 PREPARED UNDER THE DIRECT SUPERVISION OF:
 BRADLEY DONOHUE, R.C.E. 68828

CITY OF COACHELLA
SUNLINE TRANSIT
COACHELLA TRANSIT HUB
SITE REMOVALS & EX. UTILITY PLAN

SHEET NO. **3** OF 9 SHEETS
 CITY OF COACHELLA W.O. 77100149 CITY FILE NO.

NOT FOR CONSTRUCTION

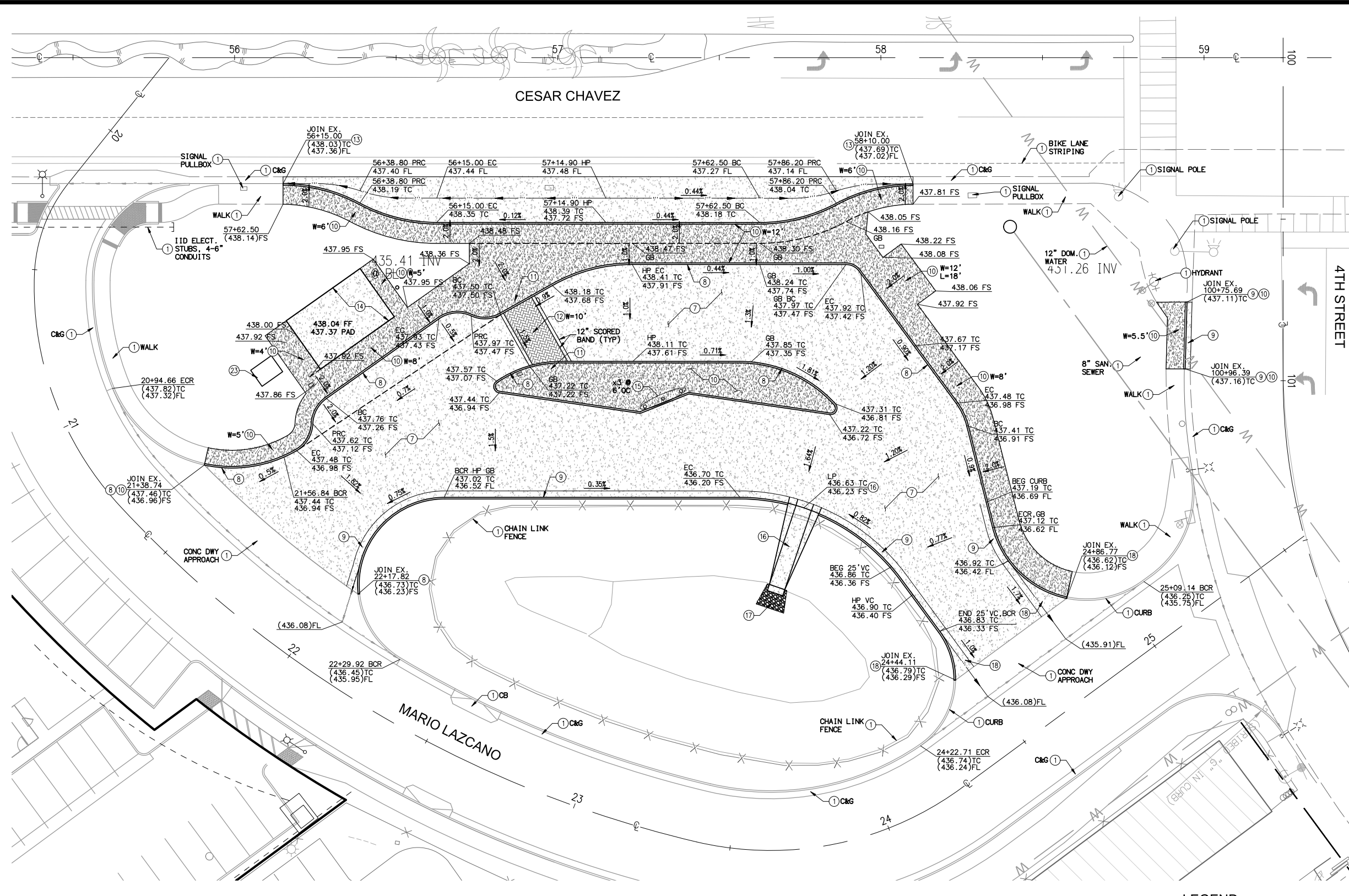

- CONSTRUCTION NOTES**
- ① PROTECT IN PLACE
 - ⑦ CONST. 6" CONC. w/ FIBER MESH OVER 8" C&G
 - ⑧ CONST. 6" TYPE D CURB PER COC STD S-10
 - ⑨ CONST. 6" C&G PER COC STD S-7
 - ⑩ CONST. SIDEWALK (WIDTH PER PLAN) PER COC STD S25.1
 - ⑪ CONST. CURB RAMP TYPE 1, CASE B PER SPPWC DWG 111-5
 - ⑫ CONST. CROSSWALK w/ TRAFFIC RATED INTERLOCKING PAVERS (SANDSTONE COLOR) PER DETAIL ON SHEET 2
 - ⑬ CONST. BUS TURNOUT PER RCTD STD 814
 - ⑭ CONST. 8" CONCRETE BUILDING SLAB PER DETAIL ON SHEET 2
 - ⑮ F&I METAL BOLLARD PER DETAIL ON SHEET 2
 - ⑯ CONST. CONC. CURB OPENING w/ SPILLWAY PER DETAIL ON SHEET 2
 - ⑰ RIPRAP PER DETAIL ON SHEET 2
 - ⑱ CONST. PARTIAL CONC. SPANDREL PER DETAIL ON SHEET 2
 - ⑳ F&I IID TRANSFORMER PAD PER IID PLANS

MARIO LAZCANO NOTE:
 MARIO LAZCANO STREET IMPROVEMENTS FROM STATION 23+00 TO 4TH STREET, ARE A PART OF A SEPARATE CITY IMPROVEMENT PROJECT. SUNLINE'S CONTRACTOR SHALL COORDINATE ALL CONSTRUCTION ACTIVITIES WITH THE CITY'S CONTRACTOR FOR CONNECTIONS INTO MARIO LAZCANO.

LINE / CURVE DATA TABLE
 SEE SHEET 5 FOR LINE / CURVE INFORMATION ON CURB AND CENTERLINES.

- LEGEND**
- MASONRY PAVERS ⑫
 - CONCRETE WALK ⑩ ⑪
 - CONCRETE CONST ⑦
 - RIP RAP ⑰



NOTE: WORK CONTAINED WITHIN THESE PLANS SHALL NOT COMMENCE UNTIL AN ENCROACHMENT PERMIT AND/OR A GRADING PERMIT HAS BEEN ISSUED.
 THE PRIVATE ENGINEER SIGNING THESE PLANS IS RESPONSIBLE FOR ASSURING THE ACCURACY AND ACCEPTABILITY OF THE DESIGN HEREON. IN THE EVENT OF DISCREPANCIES ARISING AFTER CITY APPROVAL OR DURING CONSTRUCTION THE PRIVATE ENGINEER SHALL BE RESPONSIBLE FOR DETERMINING AN ACCEPTABLE SOLUTION AND REVISIONS TO THE PLANS FOR APPROVAL BY THE CITY.



BENCHMARK: CITY OF COACHELLA 1007 ELEVATION: 437.448 DATUM: NAVD83 + 500 FEET
 DESCRIPTION: 3 1/2" BRASS DISK SET IN TOP OF THE NORTHWEST CORNER OF A 1.5 FOOT HIGH PLANTER BOLLARD AROUND THE "CITY OF COACHELLA" MONUMENT SIGN, LOCATED 25 FEET SOUTHWEST FROM THE BEGINNING OF THE SOUTH CURB RETURN AND 35 FEET SOUTH WEST OF SOUTHERLY CURB RETURN LOCATED AT THE INTERSECTION OF GRAPPESTRIT BLVD. (HIGHWAY 111) AND CESAR CHAVEZ (HARRISON STREET).
BASES OF BEARINGS: THE BASIS OF BEARINGS FOR THIS SURVEY IS THE CALIFORNIA COORDINATE SYSTEM (CCS83), ZONE 14, AS DETERMINED LOCALLY BY THE LINE BETWEEN CONTINUOUS OPERATING GPS BASE STATION STATIONS P491 AND P1N1, (EPOCH 2017.50) COORDINATES, AS COMPUTED AND PUBLISHED BY SCRIPPS ORBIT AND PERMANENT ARRAY CENTER (SOPAC) AND THE CALIFORNIA SPATIAL REFERENCE CENTER (CSRC), BEING: NORTH 78° 59' 35.41" WEST.

NO.	REVISIONS	DATE	BY	CHKD.	APP'D.	DATE

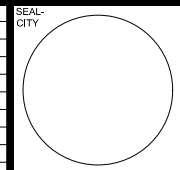

RECOMMENDED FOR APPROVAL:
 NIDEL OWLSLEY R.C.E. 39877 DATE: EXP. 12-31-2021
CITY OF COACHELLA
 APPROVED FOR CONSTRUCTION:
 ANDREW R. SIMONS R.C.E. 72868 DATE: EXP. 09-30-2022

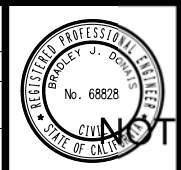

HEPTAGON SEVEN
 QUALITY, DEDICATION & EXPERIENCE
 8413 E BASELINE RD SUITE 106 MESA AZ 85209 480.757.0997
 PREPARED UNDER THE DIRECT SUPERVISION OF:
 BRADLEY J. DOWNES R.C.E. 68828 DATE: 06/18/2021

CITY OF COACHELLA
 SUNLINE TRANSIT
 COACHELLA TRANSIT HUB
 PRECISE GRADING
 W.O. 77100149 CITY FILE NO.

06/18/2021
 SHEET NO. **4**
 OF 9 SHEETS

NOT FOR CONSTRUCTION

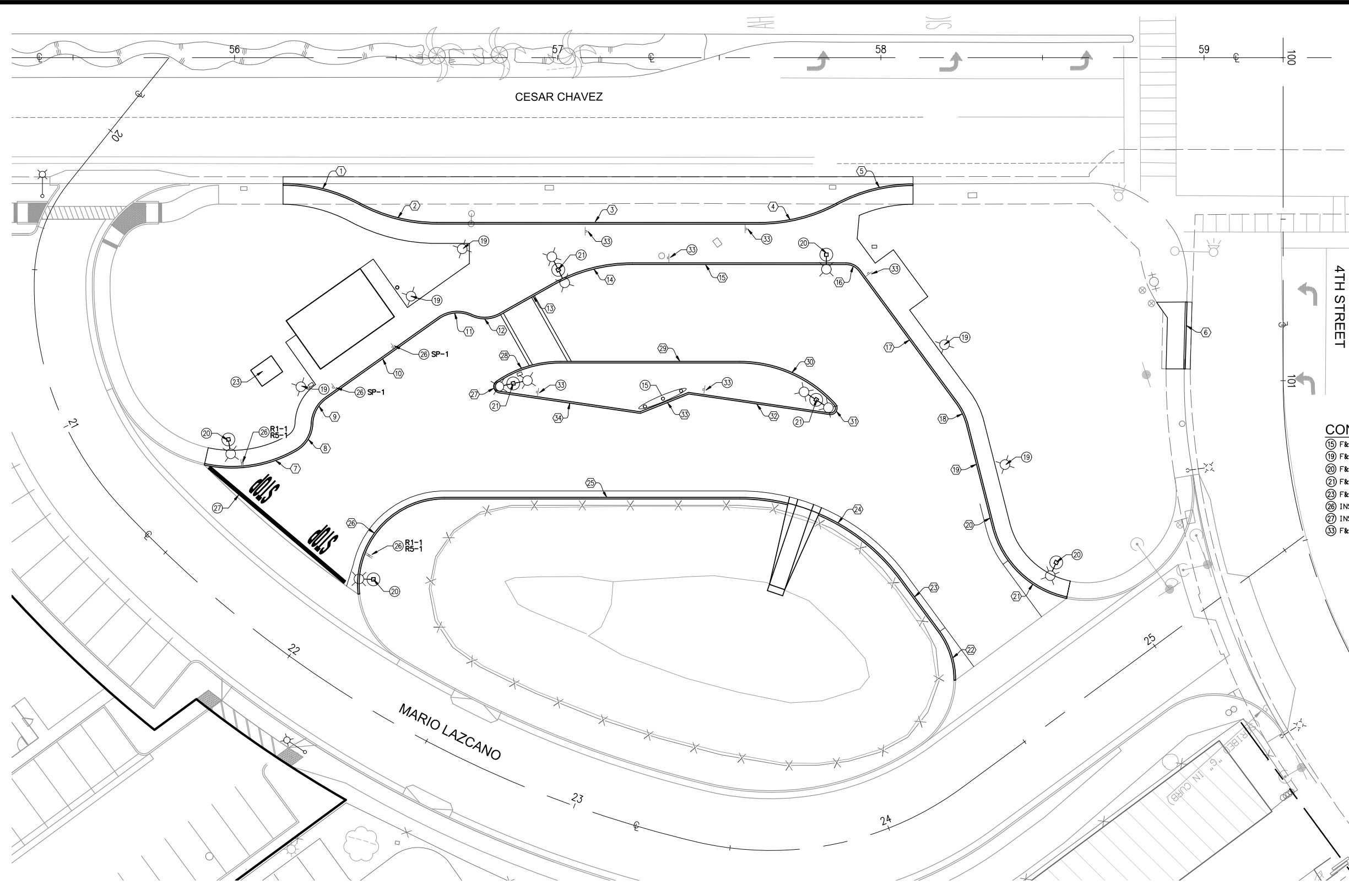

- CONSTRUCTION NOTES**
- 15 F&I METAL BOLLARD PER DETAIL ON SHEET 2
 - 19 F&I PARKING LOT LIGHT, POST TYPE PER DETAIL ON SHEET 9
 - 20 F&I PARKING LOT LIGHT, SINGLE HEAD MAST, PER DETAIL ON SHEET 9
 - 21 F&I PARKING LOT LIGHT, DUAL HEAD MAST, PER DETAIL ON SHEET 9
 - 23 F&I IID TRANSFORMER PAD PER IID PLANS
 - 26 INSTALL SIGN
 - 27 INSTALL STOP BAR & "STOP" PM
 - 33 F&I SIGN POST ONLY FOR SUNLINE BUS STOP SIGNAGE

LINE / CURVE DATA	BEARING/DELTA	RADIUS	LENGTH	DESCRIPTION
1	Δ=28°23'29"	50.00'	24.78'	BUS TURNOUT CURB
2	Δ=28°21'18"	50.00'	24.74'	BUS TURNOUT CURB
3	N00°13'00"E	---	100.00'	BUS TURNOUT CURB
4	Δ=28°17'47"	50.00'	24.69'	BUS TURNOUT CURB
5	Δ=28°20'14"	49.95'	24.71'	BUS TURNOUT CURB
6	N88°14'57"W	---	20.70'	6" CURB
7	Δ=42°22'25"	40.00'	29.58'	6" CURB
8	Δ=57°58'18"	10.00'	10.12'	6" CURB
9	Δ=52°40'09"	10.00'	9.19'	6" CURB
10	N35°08'29"W	---	42.68'	6" CURB
11	Δ=60°09'19"	10.00'	10.50'	6" CURB
12	Δ=54°12'10"	10.00'	9.46'	6" CURB
13	N29°11'20"W	---	18.57'	6" CURB
14	Δ=29°24'20"	50.00'	25.66'	6" CURB
15	N00°13'00"E	---	66.14'	6" CURB
16	Δ=53°39'58"	5.00'	4.68'	6" CURB
17	N53°52'58"E	---	50.73'	6" CURB
18	Δ=22°03'10"	20.00'	7.70'	6" CURB
19	N75°56'08"E	---	24.52'	6" CURB
20	N75°56'08"E	---	8.04'	6" CURB
21	Δ=63°53'39"	30.00'	33.45'	6" CURB SPANDREL
22	Δ=36°57'37"	25.00'	16.13'	6" CURB SPANDREL
23	N53°51'06"E	---	20.15'	6" CURB
24	Δ=53°39'02"	62.00'	58.06'	6" CURB
25	N00°12'04"E	---	91.31'	6" CURB
26	Δ=96°15'16"	27.00'	45.36'	6" CURB
27	Δ=137°20'38"	2.00'	4.79'	6" CURB
28	Δ=34°22'53"	35.00'	21.00'	6" CURB
29	N00°13'00"E	---	55.47'	6" CURB
30	Δ=47°45'11"	40.00'	33.34'	6" CURB
31	Δ=140°31'18"	2.00'	4.91'	6" CURB
32	N08°29'29"E	---	44.05'	6" CURB
33	N21°35'12"W	---	16.16'	6" CURB
34	N08°29'29"E	---	44.10'	6" CURB

SIGN LEGEND

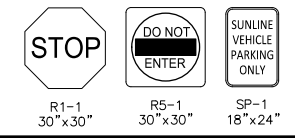

SITE LIGHTING NOTE
SEE SHEET 6, PRIVATE UTILITY, FOR DETAILS ON SITE LIGHTING.

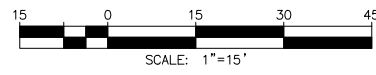

NOTE: WORK CONTAINED WITHIN THESE PLANS SHALL NOT COMMENCE UNTIL AN ENCROACHMENT PERMIT AND/OR A GRADING PERMIT HAS BEEN ISSUED.
THE PRIVATE ENGINEER SIGNING THESE PLANS IS RESPONSIBLE FOR ASSURING THE ACCURACY AND ACCEPTABILITY OF THE DESIGN HEREON. IN THE EVENT OF DISCREPANCIES ARISING AFTER CITY APPROVAL OR DURING CONSTRUCTION THE PRIVATE ENGINEER SHALL BE RESPONSIBLE FOR DETERMINING AN ACCEPTABLE SOLUTION AND REVISING THE PLANS FOR APPROVAL BY THE CITY.

DIGALERT
CALL BEFORE YOU DIG
TOLL FREE 1-800-485-2800
A PUBLIC SERVICE BY UNDERGROUND SERVICE ALERT

BENCHMARK: CITY OF COACHELLA 1007 ELEVATION: 437.448 DATUM: NAD83 + 500 FEET
DESCRIPTION: 3 1/2" BRASS DISK SET IN TOP OF THE NORTHWEST CORNER OF A 1.5 FOOT HIGH PLASTER WALL AROUND THE "CITY OF COACHELLA" MONUMENT SIGN, LOCATED 25 FEET SOUTHWEST FROM THE BEGINNING OF THE SOUTH CURB RETURN AND 35 FEET SOUTH WEST OF SOUTHERLY CURB RETURN LOCATED AT THE INTERSECTION OF GRAPEFRUIT BLVD. (HIGHWAY 111) AND CESAR CHAVEZ (HARRISON STREET).
BASES OF BEARINGS: THE BASIS OF BEARINGS FOR THIS SURVEY IS THE CALIFORNIA COORDINATE SYSTEM (CCS83), ZONE 14, AS DETERMINED LOCALLY BY THE LINE BETWEEN CONTINUOUS OPERATING GPS BASE STATION STATIONS P491 AND P101, (EPOCH 2017.50) COORDINATES, AS COMPUTED AND PUBLISHED BY SCRIPPS ORBIT AND PERMANENT ARRAY CENTER (SPAC) AND THE CALIFORNIA SPATIAL REFERENCE CENTER (CSRC), BEING: NORTH 78° 59' 35.49" WEST.

NO.	REVISIONS	DATE	BY	CHKD.	APP'D.	DATE

SEAL-CITY
CITY OF COACHELLA

RECOMMENDED FOR APPROVAL
DATE: EXP. 12-31-2021
CITY OF COACHELLA
APPROVED FOR CONSTRUCTION
ANDREW R. SIMMONS R.C.E. 72868 DATE: EXP. 09-30-2022

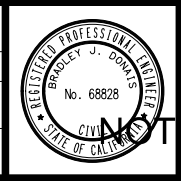

HEPTAGON SEVEN
QUALITY, DEDICATION & EXPERIENCE
8413 E BASELINE RD SUITE 106 MESA, AZ 85209 480.757.0997
PREPARED UNDER THE DIRECT SUPERVISION OF:
BRADLEY DOWNS, R.C.E. 68828 DATE:

CITY OF COACHELLA
SUNLINE TRANSIT
COACHELLA TRANSIT HUB
HORIZONTAL CONTROL,
SIGNING & STRIPING
CITY OF COACHELLA W.O. 77100149 CITY FILE NO.

NOT FOR CONSTRUCTION

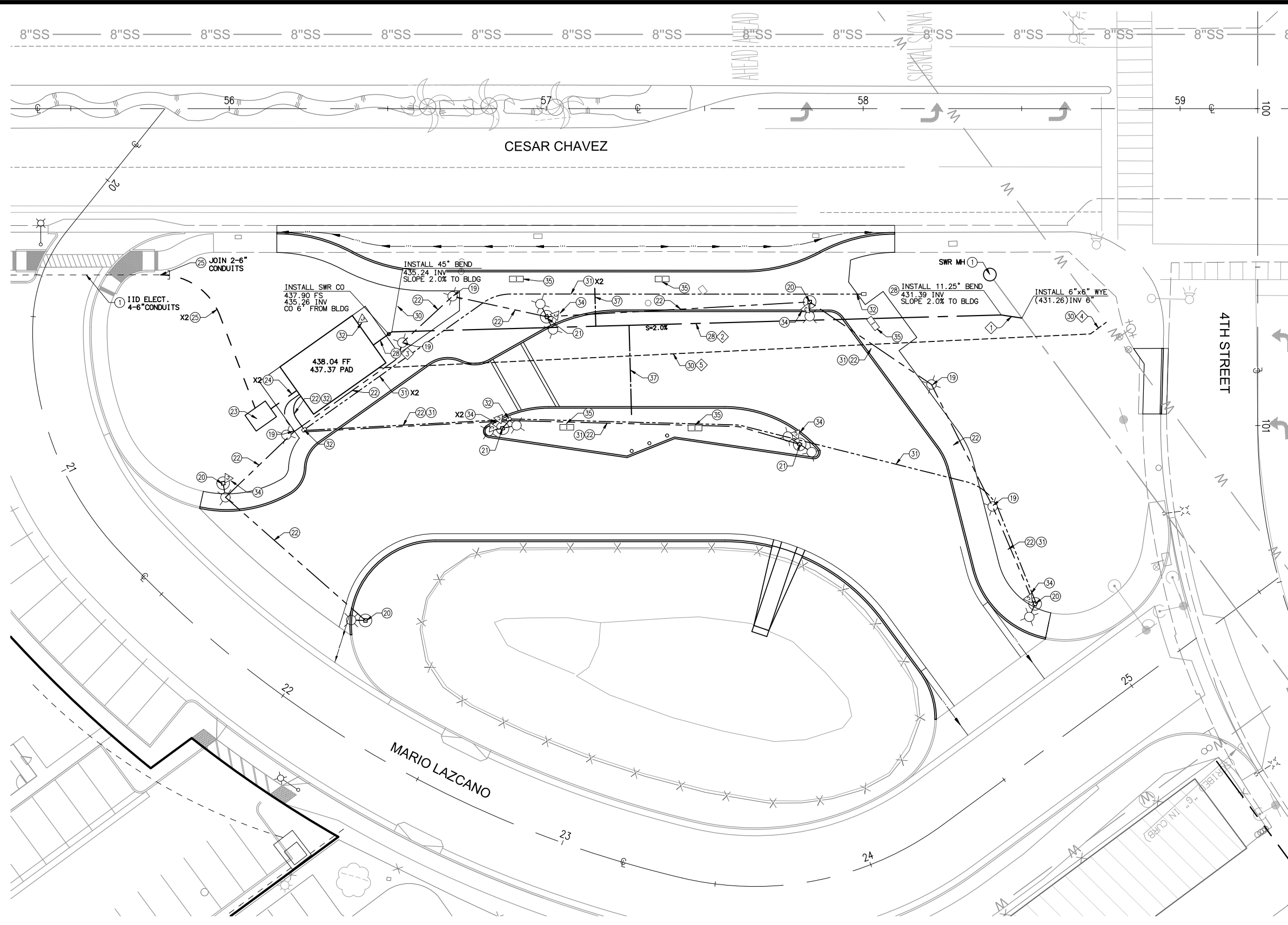

NO	BEARING/DELTA	RADIUS	LENGTH	NOTE
1	N08°51'08"E	--	6.58'	6" PVC SEWER
2	N01°23'29"W	--	192.36'	6" PVC SEWER
3	N35°08'29"W	--	7.17'	6" PVC SEWER
4	N36°07'02"W	--	6.20'	2" DW SERVICE
5	N02°32'02"W	--	224.80'	2" DW SERVICE

- CONSTRUCTION NOTES**
- 1) PROTECT IN PLACE
 - 19) F&I PARKING LOT LIGHT, POST TYPE PER DETAIL ON SHEET 9
 - 20) F&I PARKING LOT LIGHT, SINGLE HEAD MAST, PER DETAIL ON SHEET 9
 - 21) F&I PARKING LOT LIGHT, DUAL HEAD MAST, PER DETAIL ON SHEET 9
 - 22) F&I 1.5" PVC CONDUIT & CONDUCTORS FOR SITE LIGHTING
 - 23) F&I IID TRANSFORMER PAD PER IID PLANS
 - 24) F&I 4" SCH 40 PVC CONDUIT (IID)
 - 25) F&I 6" SCH 40 PVC CONDUIT (IID)
 - 26) F&I 6" SDR-26 PVC SEWER LATERAL w/ BENDS & WYES PER COC STD. D-11
 - 30) F&I 2" PVC SDR-21 DOMESTIC WATER SERVICE w/ BENDS & THRUST BLOCKS PER COC STD W-8
 - 31) F&I 1.5" PVC CONDUIT w/ PULL ROPE (DATA & FUTURE)
 - 32) F&I ELECTRICAL PULL BOX PER SWPPP STD 513-3
 - 34) F&I SECURITY CAMERA & MOUNTING BRACKETS
 - 35) BUS STOP INFO SIGN INSTALLED BY SUNLINE
 - 37) F&I 3/4" PVC SDR-21 DOMESTIC WATER SERVICE w/ BENDS, CORP STOP & VALVE BOX

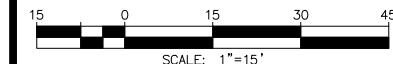

NOTE: WORK CONTAINED WITHIN THESE PLANS SHALL NOT COMMENCE UNTIL AN ENCROACHMENT PERMIT AND/OR A GRADING PERMIT HAS BEEN ISSUED.

THE PRIVATE ENGINEER SIGNING THESE PLANS IS RESPONSIBLE FOR ASSURING THE ACCURACY AND ACCEPTABILITY OF THE DESIGN HEREON. IN THE EVENT OF DISCREPANCIES ARISING AFTER CITY APPROVAL OR DURING CONSTRUCTION THE PRIVATE ENGINEER SHALL BE RESPONSIBLE FOR DETERMINING AN ACCEPTABLE SOLUTION AND REVISING THE PLANS FOR APPROVAL BY THE CITY.



BENCHMARK: CITY OF COACHELLA 1007 ELEVATION: 437.448 DATUM: NAVD83 + 500 FEET
DESCRIPTION: 3 1/2" BRASS DISK SET IN TOP OF THE NORTHWEST CORNER OF A 1.5 FOOT HIGH PLASTER WALL AROUND THE "CITY OF COACHELLA" MONUMENT SIGN, LOCATED 25 FEET SOUTHEAST FROM THE BEGINNING OF THE SOUTH CURB RETURN AND 35 FEET SOUTH WEST OF SOUTHERLY CURB RETURN LOCATED AT THE INTERSECTION OF GRAPEFRUIT BLVD. (HIGHWAY 111) AND CESAR CHAVEZ (HARRISON STREET).

BASIS OF BEARINGS: THE BASIS OF BEARINGS FOR THIS SURVEY IS THE CALIFORNIA COORDINATE SYSTEM (CCS83), ZONE 14, AS DETERMINED LOCALLY BY THE LINE BETWEEN CONTINUOUS OPERATING GPS BASE STATION STATIONS P491 AND P1N1, (EPOCH 2017.50) COORDINATES), AS COMPUTED AND PUBLISHED BY SCRIPPS ORBIT AND PERMANENT ARRAY CENTER (SOPAC) AND THE CALIFORNIA SPATIAL REFERENCE CENTER (CSRC), BEING: NORTH 78° 59' 35.44" WEST.

BY	DATE	REVISIONS	APP'D	DATE	SEAL	CITY

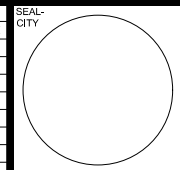

RECOMMENDED FOR APPROVAL
 NIEL OWSELEY R.C.E. 39877
 DATE: EXP. 12-31-2021
CITY OF COACHELLA
 APPROVED FOR CONSTRUCTION
 ANDREW R. SIMONS R.C.E. 72868
 DATE: EXP. 09-30-2022

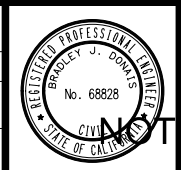

HEPTAGON SEVEN
 QUALITY, DEDICATION & EXPERIENCE
 8413 E BASELINE RD SUITE 106 MESA AZ 85209 480.757.0997
 PREPARED UNDER THE DIRECT SUPERVISION OF:
 BRADLEY DOWNS, R.C.E. 68828

CITY OF COACHELLA
SUNLINE TRANSIT
COACHELLA TRANSIT HUB
PRIVATE UTILITY PLAN
 FOR THE CITY OF COACHELLA
 W.O. 77100149
 CITY FILE NO.

07/08/2021
 SHEET NO. **6**
 OF 9 SHEETS

NOT FOR CONSTRUCTION

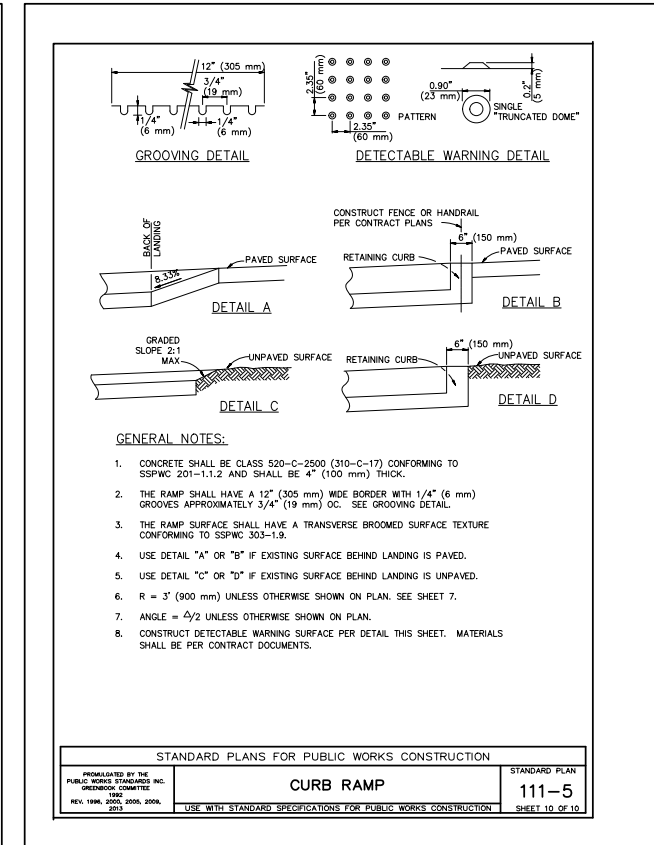
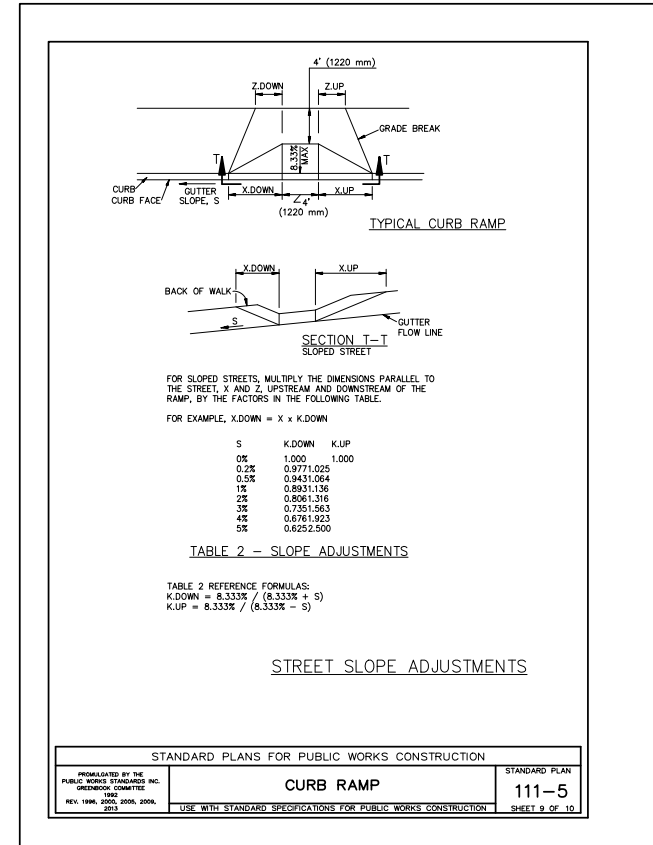
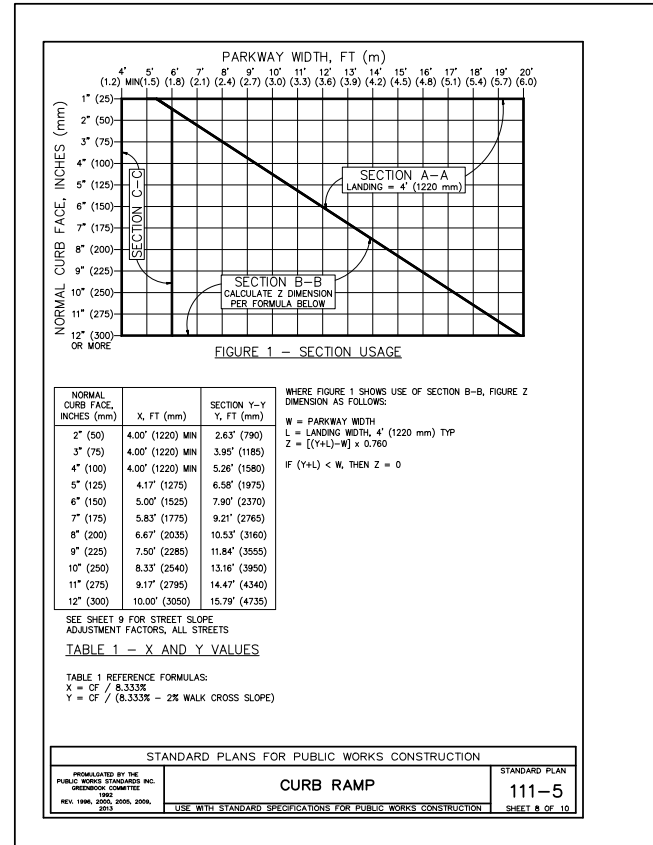
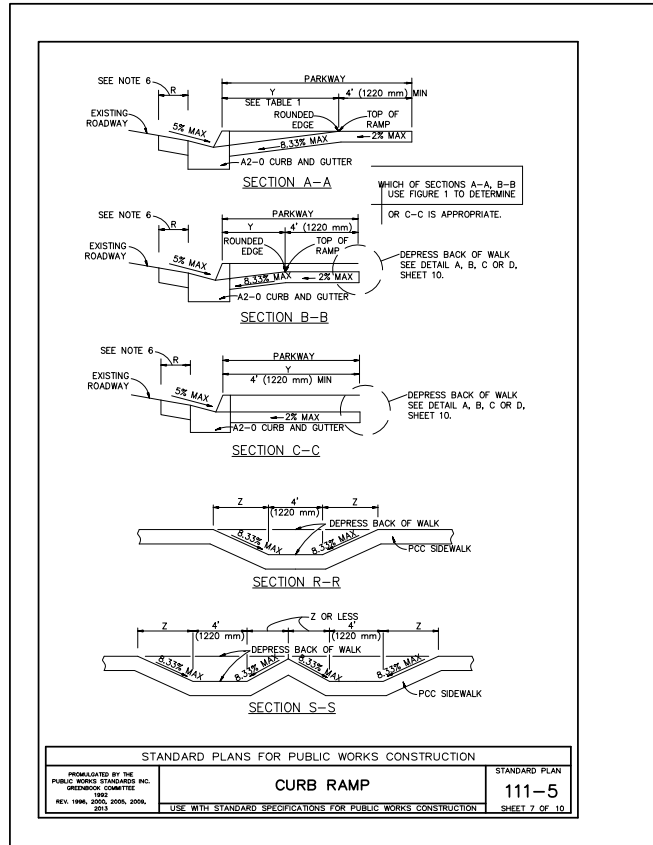
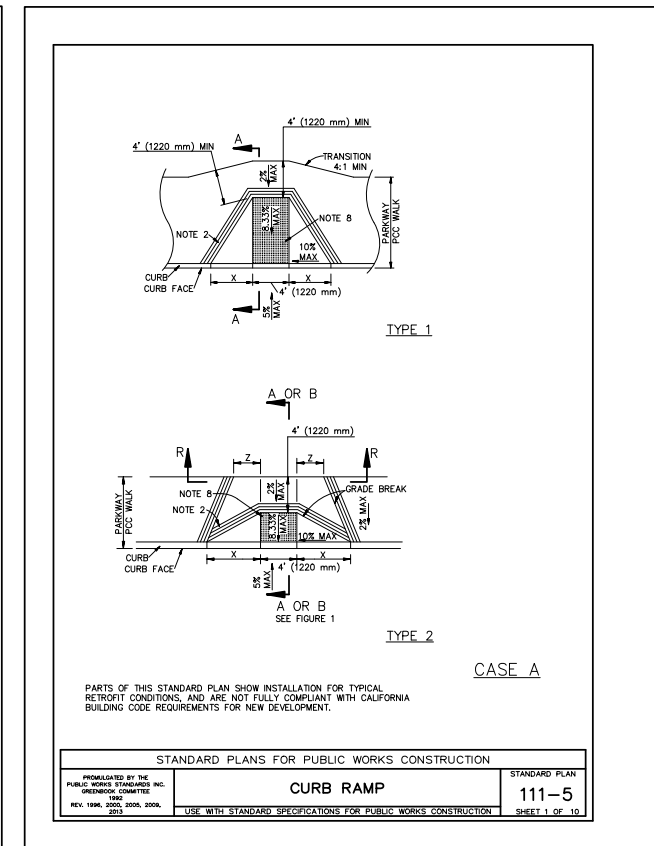
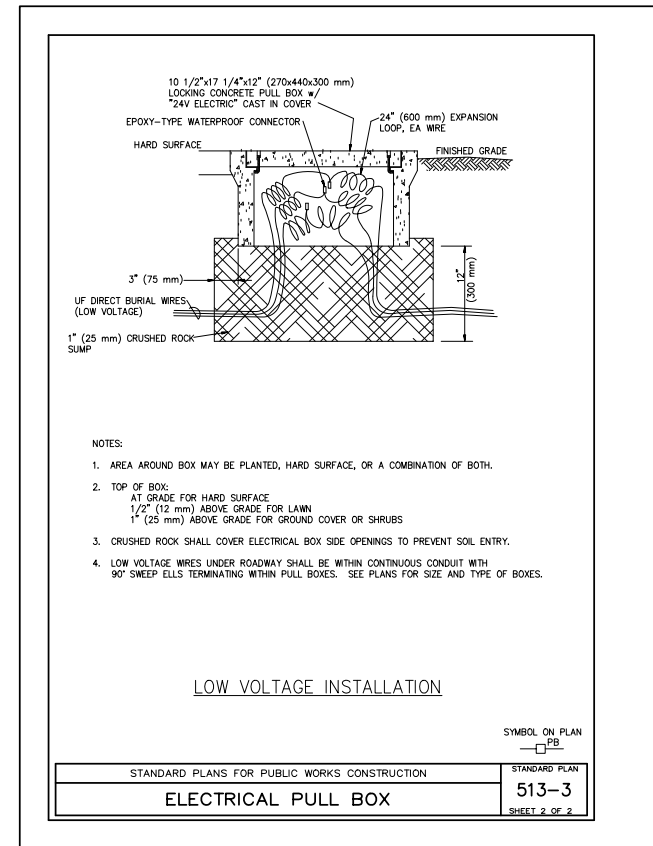
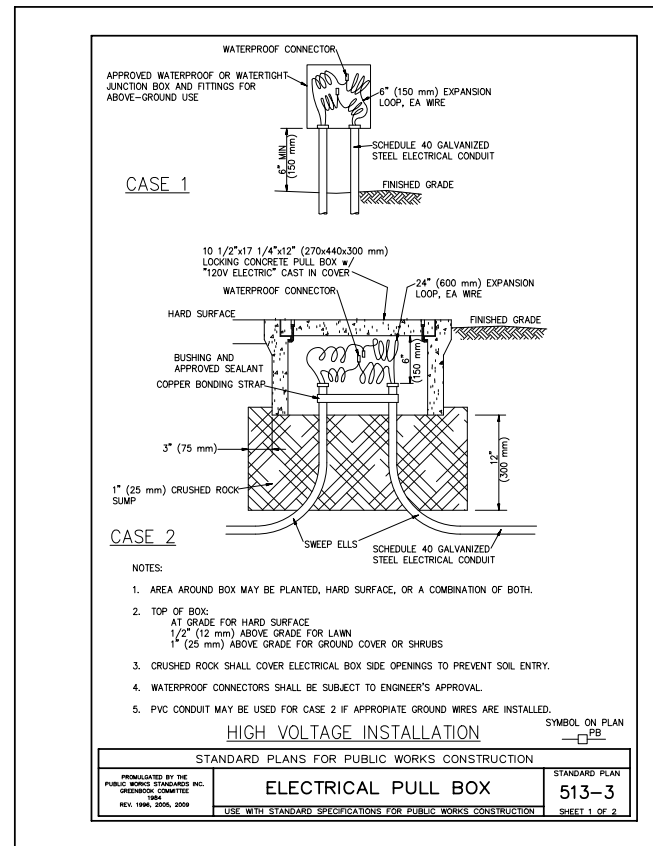
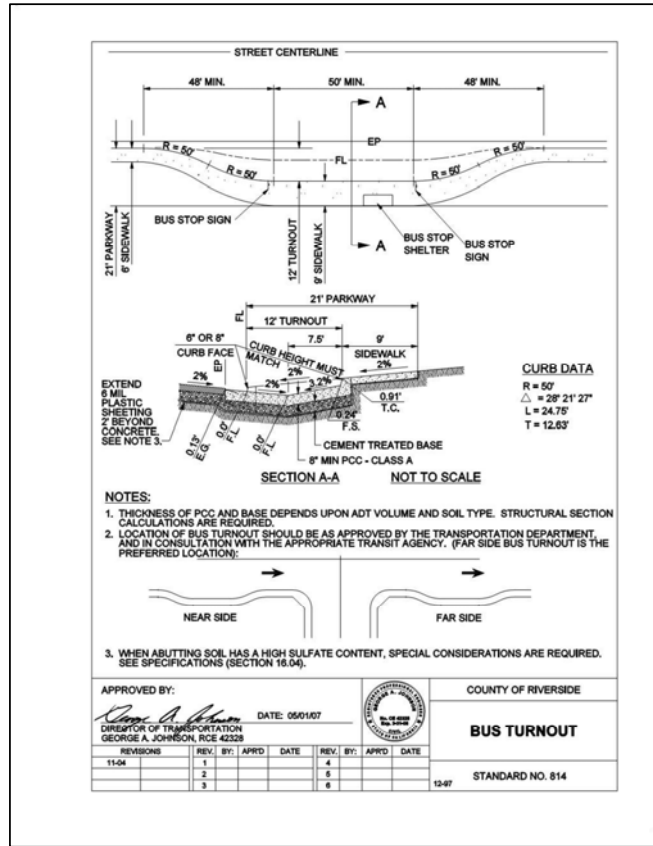

NOTE: WORK CONTAINED WITHIN THESE PLANS SHALL NOT COMMENCE UNTIL AN ENCROACHMENT PERMIT AND/OR A GRADING PERMIT HAS BEEN ISSUED.

THE PRIVATE ENGINEER SIGNING THESE PLANS IS RESPONSIBLE FOR ASSURING THE ACCURACY AND ACCEPTABILITY OF THE DESIGN HEREON. IN THE EVENT OF DISCREPANCIES ARISING AFTER CITY APPROVAL OR DURING CONSTRUCTION THE PRIVATE ENGINEER SHALL BE RESPONSIBLE FOR DETERMINING AN ACCEPTABLE SOLUTION AND REVISORING THE PLANS FOR APPROVAL BY THE CITY.



BENCHMARK: CITY OF COACHELLA 1007 ELEVATION: 437.448 DATE: MARCH 8 2005
DESCRIPTION: 3 1/2" BRASS DISK SET IN TOP OF THE NORTHWEST CORNER OF A 1.5 FOOT HIGH PLASTER WALL AROUND THE "CITY OF COACHELLA" MONUMENT SIGN, LOCATED 25 FEET SOUTHWEST FROM THE BEGINNING OF THE SOUTH CURB RETURN AND 35 FEET SOUTH WEST OF SOUTHERLY CURB RETURN LOCATED AT THE INTERSECTION OF GRAPESFRUIT BLVD. (HIGHWAY 111) AND CESAR CHAVEZ (HARRISON STREET).

BASES OF BEARINGS: THE BASIS OF BEARINGS FOR THIS SURVEY IS THE CALIFORNIA COORDINATE SYSTEM (CCS83). ZONE 14, AS DETERMINED LOCALLY BY THE LINE BETWEEN CONTINUOUS OPERATING GPS BASE STATION STATIONS P491 AND P1N1, (EPOCH 2017.50) COORDINATES, AS COMPUTED AND PUBLISHED BY SCRIPPS ORBIT AND PERMANENT ARMY CENTER (SOPAC) AND THE CALIFORNIA SPATIAL REFERENCE CENTER (CSRC), BEING: **NORTH 78° 59' 35.49" WEST.**

BY	DATE	REVISIONS	APP'D	CHECKED	DATE

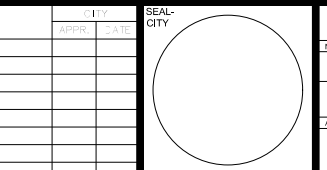

RECOMMENDED FOR APPROVAL
NIEL OWLSLEY R.C.E. 39877
DATE: EXP. 12-31-2021

CITY OF COACHELLA

APPROVED FOR CONSTRUCTION
ANDREW R. SIMONS, R.C.E. 7286
DATE: EXP. 09-30-2022



QUALITY, DEDICATION & EXPERIENCE
HEPTAGON SEVEN
8413 E BASELINE RD SUITE 108
MESA, AZ 85209
480.757.0997

PREPARED UNDER THE DIRECT SUPERVISION OF:
[Signature]

CITY OF COACHELLA
SUNLINE TRANSIT
COACHELLA TRANSIT HUB
STANDARD DETAILS

W.O. 77100149
CITY FILE NO.

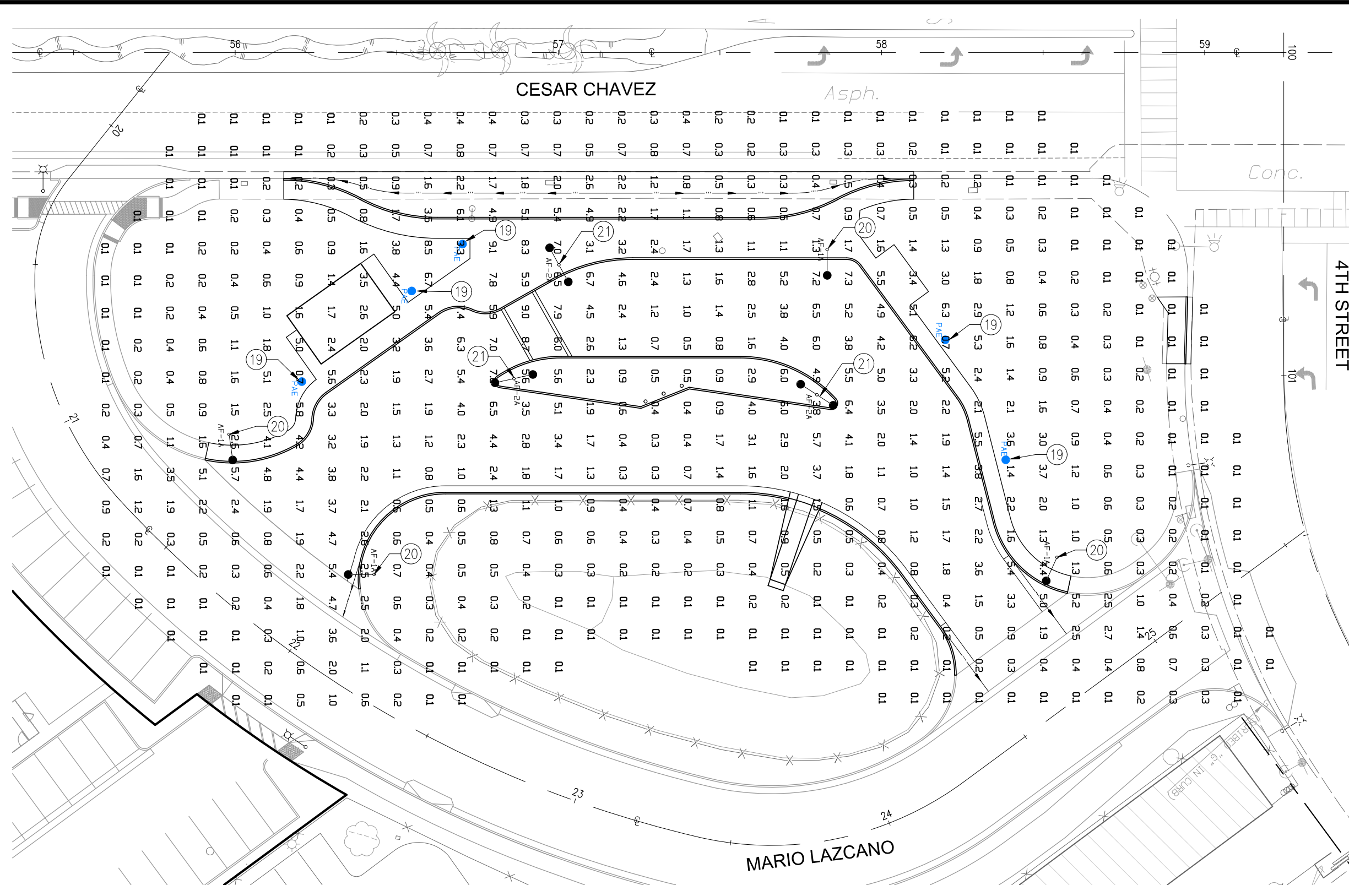

- CONSTRUCTION NOTES**
- ①9 F&I PARKING LOT LIGHT, POST TYPE PER DETAIL ON SHEET 9
 - ②0 F&I PARKING LOT LIGHT, SINGLE HEAD MAST, PER DETAIL ON SHEET 9
 - ②1 F&I PARKING LOT LIGHT, DUAL HEAD MAST, PER DETAIL ON SHEET 9

PACIFIC LIGHTING & STANDARD
 2831 LOS FLORES BLVD.
 LYNWOOD, CA 90262
 (310)603-9344

LIGHT READINGS ARE ESTIMATED LEVELS IN PRIME CONDITIONS AND SHOULD NOT BE TAKEN AS EXACT READINGS. LIGHT READINGS ARE 10 FT. APART

Target Point Set
 625 points at z=0, sp 10ft by 10ft
 HORIZONTAL FOOTCANDLES

Average	1.5
Maximum	9.9
Minimum	0.1
Avg: Min	14.91
Max: Min	99.00
Coef Var	1.28
UnifGrad	9.00

LIGHT LEGEND

- ①9 ● PAE PAE-50-LED-MT-3-4-V-PT
 RSA-5F-12'6"-BCWO-1820
 mounting height= 12.5 ft
 number locations= 5, number luminaires= 5
- ②0 ● AF-1A AF-TD-60-LED-MT-5-4-II-1A-BC4
 RSA-5F-22-BCWO-1820
 mounting height= 22 ft
 number locations= 4, number luminaires= 4
- ②1 ● AF-2A AF-TD-60-LED-MT-5-4-II-2A-BC4
 RSA-5F-22-BCWO-1820
 mounting height= 22 ft
 number locations= 3, number luminaires= 6



NOTE: WORK CONTAINED WITHIN THESE PLANS SHALL NOT COMMENCE UNTIL AN ENCROACHMENT PERMIT AND/OR A GRADING PERMIT HAS BEEN ISSUED.

THE PRIVATE ENGINEER SIGNING THESE PLANS IS RESPONSIBLE FOR ASSURING THE ACCURACY AND ACCEPTABILITY OF THE DESIGN HEREON. IN THE EVENT OF DISCREPANCIES ARISING AFTER CITY APPROVAL OR DURING CONSTRUCTION THE PRIVATE ENGINEER SHALL BE RESPONSIBLE FOR DETERMINING AN ACCEPTABLE SOLUTION AND REVISIONS TO THE PLANS FOR APPROVAL BY THE CITY.



BENCHMARK: CITY OF COACHELLA 1007 ELEVATION: 437.448 DATUM: NAD83 + 500 FEET
 DESCRIPTION: 3 1/2" BRASS DISK SET IN TOP OF THE NORTHWEST CORNER OF A 1.5 FOOT HIGH PLASTER WALL AROUND THE "CITY OF COACHELLA" MONUMENT SIGN, LOCATED 25 FEET SOUTHEAST FROM THE BEGINNING OF THE SOUTH ORBIT RETURN AND 35 FEET SOUTH WEST OF SOUTHERLY CURB RETURN LOCATED AT THE INTERSECTION OF GRAPESFRUIT BLVD. (HIGHWAY 111) AND CESAR CHAVEZ (HARRISON STREET).

BASES OF BEARINGS: THE BASIS OF BEARINGS FOR THIS SURVEY IS THE CALIFORNIA COORDINATE SYSTEM (CCS3), ZONE 14, AS DETERMINED LOCALLY BY THE LINE BETWEEN CONTINUOUS OPERATING GPS BASE STATION STATIONS P491 AND P1N1, (EPOCH 2017.50) COORDINATES), AS COMPUTED AND PUBLISHED BY SCRIPPS ORBIT AND PERMANENT ARRAY CENTER (SOAP), AND THE CALIFORNIA SPATIAL REFERENCE CENTER (CSRC), BEING: NORTH 78° 59' 35.44" WEST.

BY	DATE	REVISIONS	APP'D	DATE	SEAL	CITY

RECOMMENDED FOR APPROVAL

DATE: EXP. 12-31-2021

CITY OF COACHELLA

APPROVED FOR CONSTRUCTION

DATE: EXP. 09-30-2022



HEPTAGON SEVEN QUALITY, DEDICATION & EXPERIENCE

8413 E BASELINE RD SUITE 106 MESA, AZ 85209 480.757.0997

PREPARED UNDER THE DIRECT SUPERVISION OF:

BRADLEY DOWNS, R.C.E. 68828 DATE:

CITY OF COACHELLA
 SUNLINE TRANSIT
 COACHELLA TRANSIT HUB
 SITE LIGHTING
 PHOTOMETRICS

W.O. 77100149 CITY FILE NO.

