

CITY OF COACHELLA

STREET IMPROVEMENT PLANS FOR 52 AVENUE

FROM TYLER STREET TO 52ND WHITEWATER BRIDGE

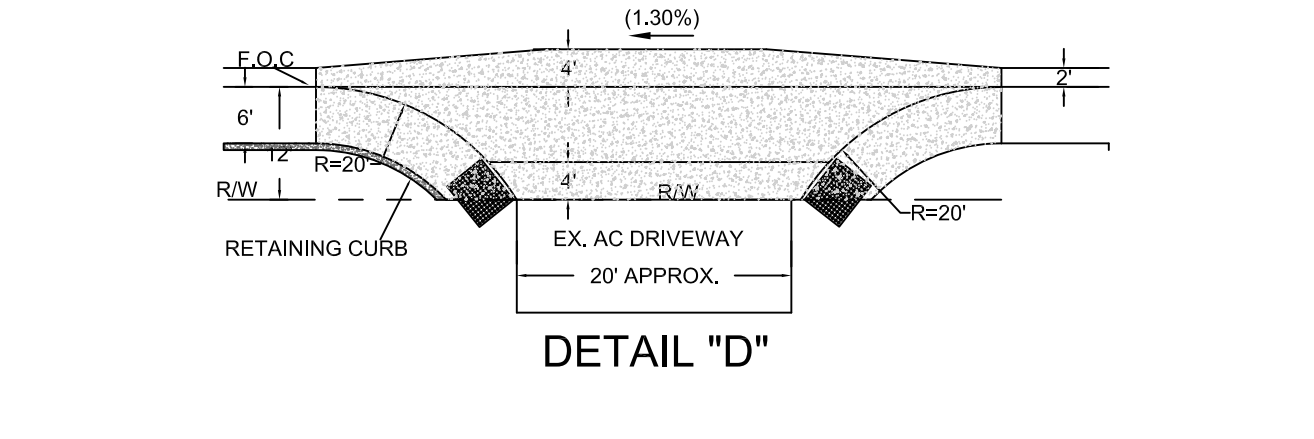
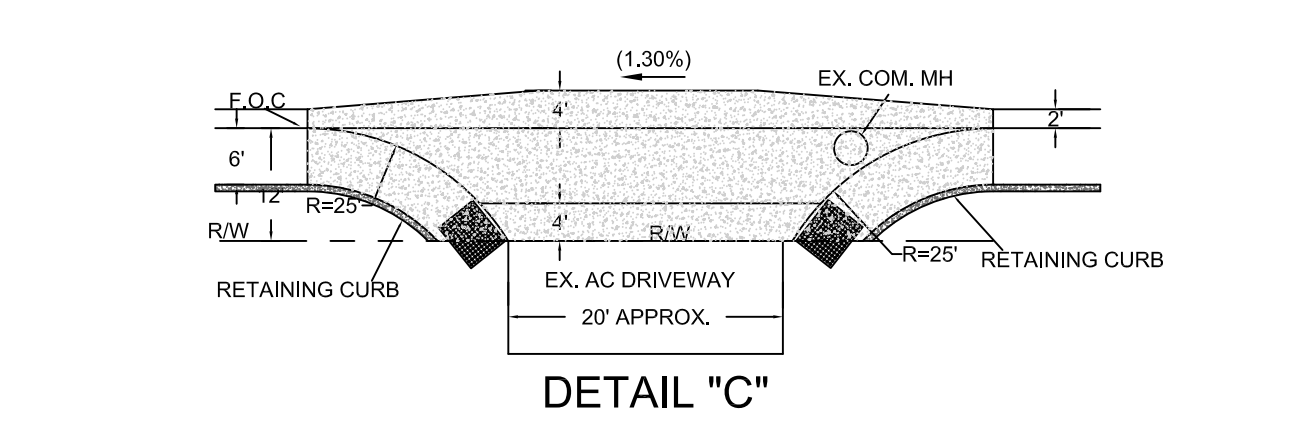
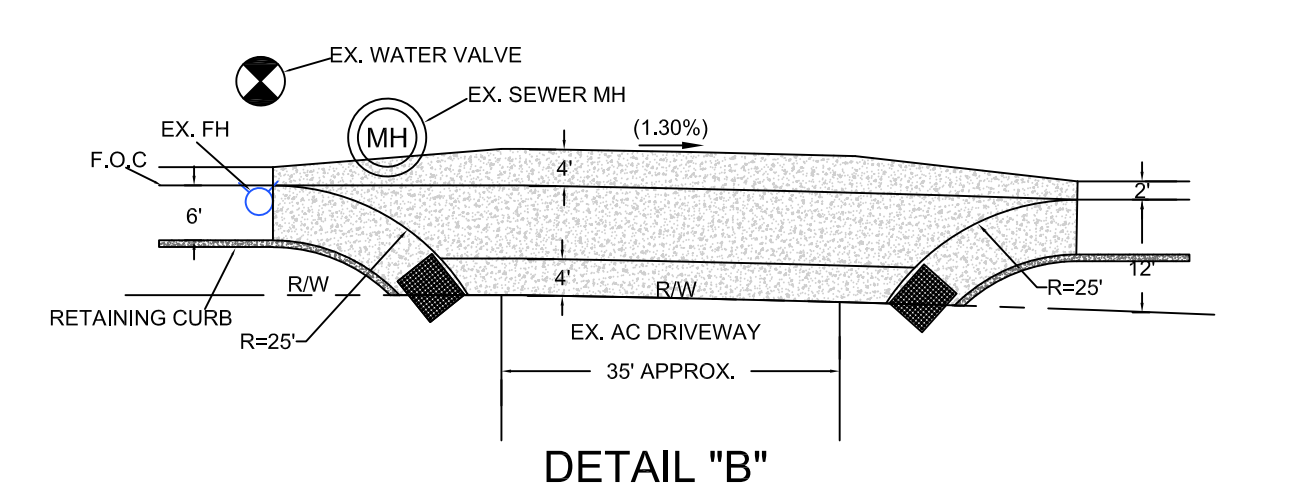
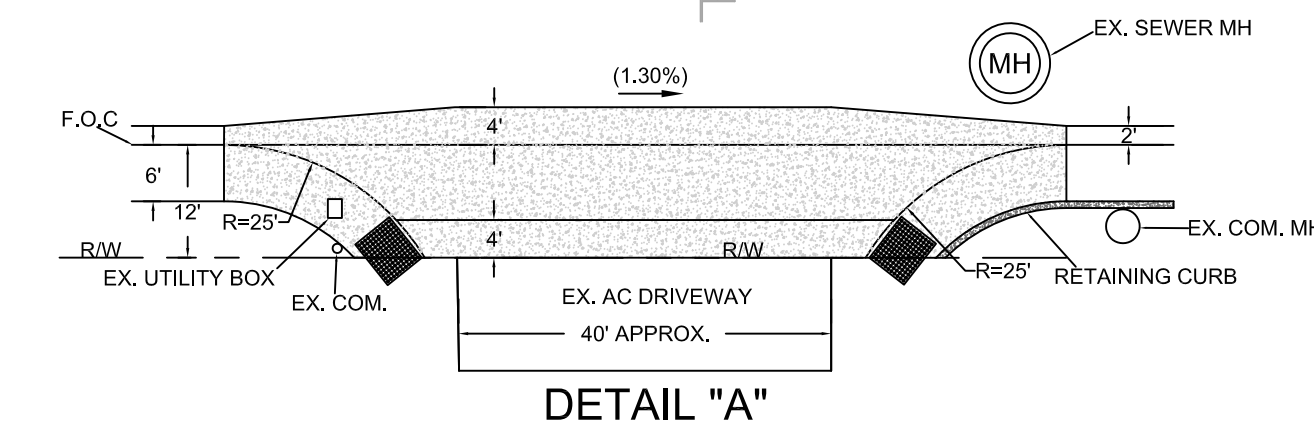
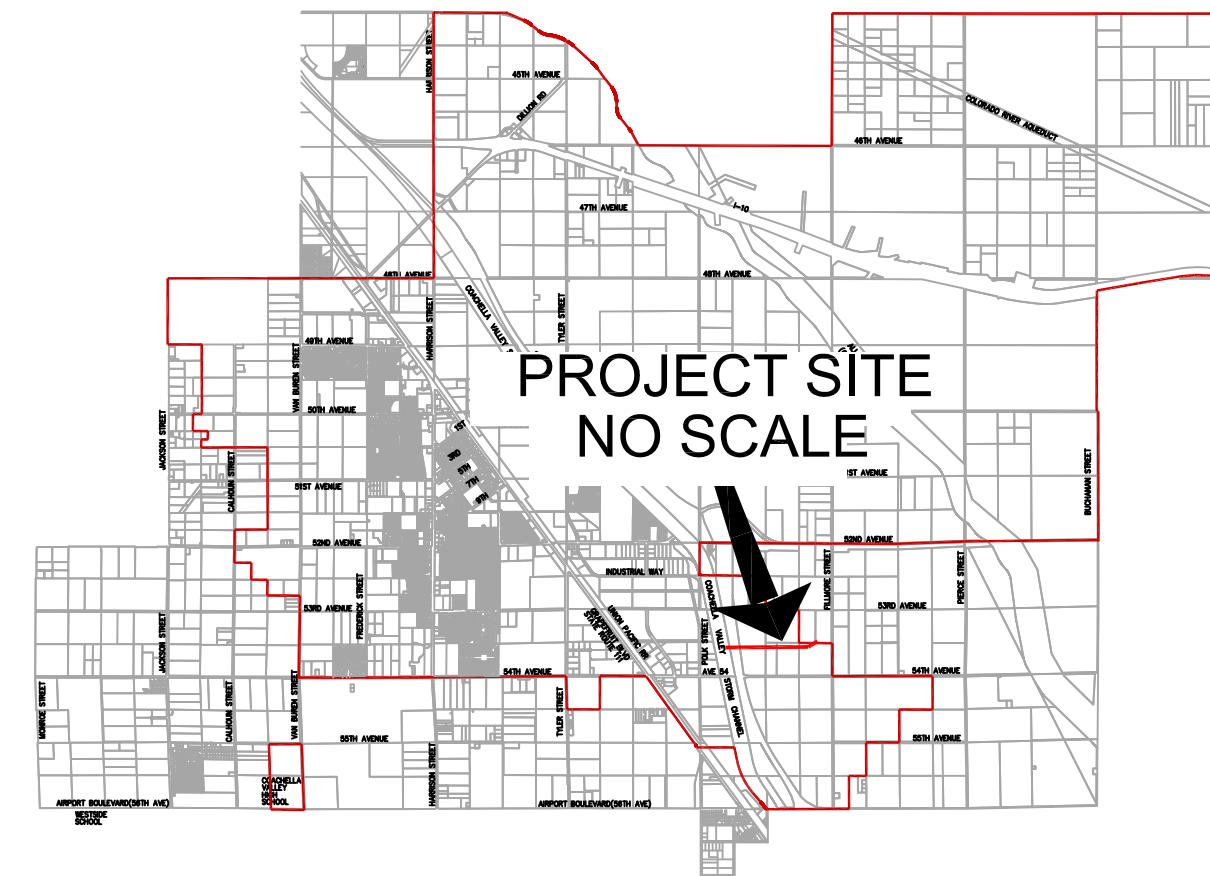
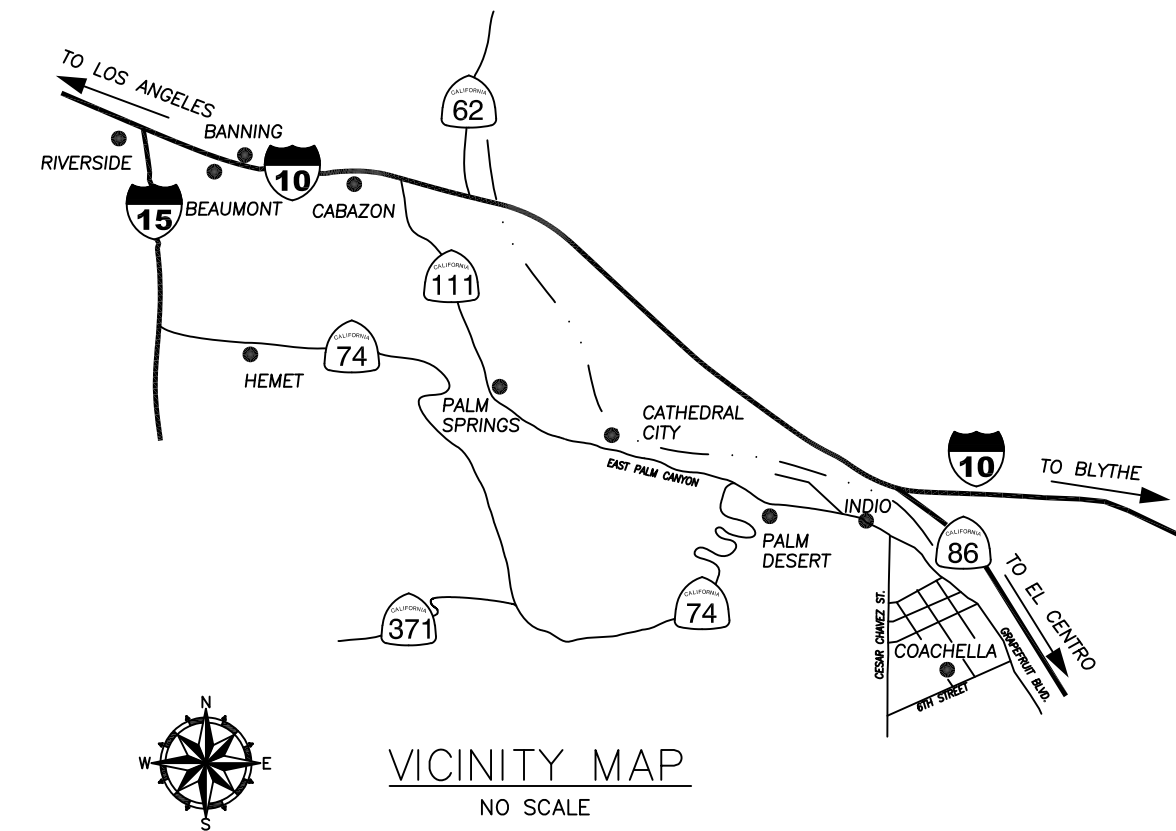

CONSTRUCTION NOTES & ESTIMATE QUANTITIES

NO.	DESCRIPTION	ESTIMATE QUANTITIES
1	PROTECT IN PLACE	
2	REMOVE EXISTING ASPHALT TO 2" DEPTH	278,500 SF
3	CONSTRUCT 2" OF ASPHALT CONCRETE PAVEMENT OVER RE-COMPACTED EXISTING BASE GRADE	278,500 SF
4	REMOVE AND REPLACE 8" CURB AND GUTTER PER C.O.C. STD. S-8	2,050 LF
5	REMOVE EXISTING DRIVEWAY APPROACH	4 EA
6	INSTALL COMMERCIAL DRIVEWAY PER C.O.C. STD. S-18	4 EA
7	INSTALL 6 FOOT WIDE SIDEWALK PER C.O.C S-25.1	2,123 LF
8	INSTALL 6" CURB OVER 6" AB PER C.O.C STD. S-10	767 LF
9	REMOVE AND REPLACE CROSS GUTTER PER C.O.C. STD. S-14	40 LF
10	REMOVE AND REPLACE CATCH BASIN PER C.O.C. STD. SD-1.1 & SD-2	1 EA
11	ADJUST EXISTING WATER VALVES TO FINAL GRADE PER CVWD STD W-17 & W-18	17 EA
12	ADJUST EXISTING SEWER MH TO FINAL GRADE PER CSD STD D-10	15 EA
13	RESET AND ADJUST SURVEYING MONUMENTS (BY CITY)	8 EA
14	REMOVE EXISTING PALM TREE	1 EA
15	ADJUST UTILITY BOX OR MH TO FINAL GRADE	
16	PAINT YELLOW TRAFFIC LINES AND INSTALL RPM IF APPLICABLE PER CALTRANS STD. A20A & A20B	
17	PAINT WHITE TRAFFIC LINES, AND INSTALL RPM IF APPLICABLE, PER NOTED CALTRANS STD. A20A	
18	PAINT 4" SOLID WHITE LINE	
19	PAINT WHITE PAVEMENT MARKINGS, PER CALTRANS STD. A24A	
20	PAINT BIKE MARKINGS WITH CYCLE GRIP MMAX GREEN PAINT. SEE DETAIL (.....)	
21	PAINT DETAIL 39A PER CALTRANS STD. PLAN A20D WITH CYCLE GRIP MMAX PAINT. SE DETAIL (.....)	
22	PAINT WHITE CROSSWALK PER CALTRANS STD.	

NOTE: CONTRACTOR SHALL RE-STRIPE REHABILITATED ROADWAYS TO MATCH EXISTING. CONTRACTOR SHALL INSTALL RPM'S, AND IDENTIFY ALL CATCH BASINS OR INLETS AND PROTECT WITH THE CORRECT BEST MANAGEMENT PRACTICE PLAN.

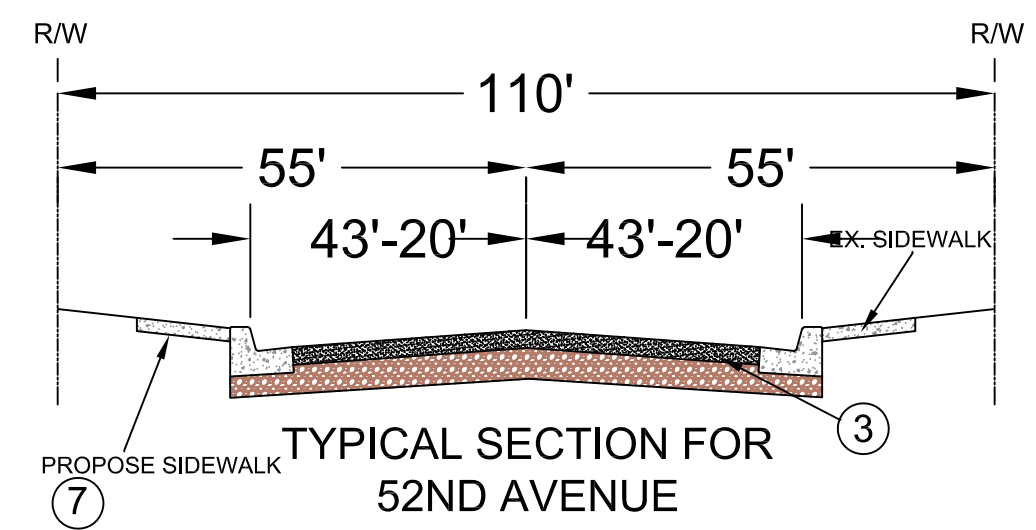

GENERAL SIGNING AND STRIPING NOTES:

- ALL MATERIAL AND WORK SHALL CONFORM TO THE LATEST EDITIONS OF THE CALIFORNIA MANUAL ON UNIFORM TRAFFIC CONTROL DEVICES (CA MUTCD).
- THE CONTRACTOR SHALL NOTIFY UNDERGROUND SERVICE ALERT, 811, AND ALL CONCERNED UTILITIES COMPANIES AT LEAST TWO WORKING DAYS IN ADVANCE OF EXCAVATION.
- ALL TRAFFIC STRIPES, PAVEMENT MARKINGS, AND SIGNS SHALL BE REFLECTORIZED AND IN STANDARD SIZES. ALL STRIPING AND MARKING DETAILS SHALL MATCH CALTRANS PLANS DETAILS. STENCILS FOR PAVEMENT MARKINGS SHALL MATCH CALTRANS STANDARD PLANS.
- THE CONTRACTOR SHALL REMOVE ALL CONFLICTING STRIPES, PAVEMENT MARKINGS, AND RAISED PAVEMENT MARKERS IN ACCORDANCE WITH THE PLANS AND AS DIRECTED BY THE ENGINEER. WORD OR SYMBOL PAVEMENT MARKING SHALL BE REMOVED BY SANDBLASTING OR GRINDING A RECTANGULAR AREA COVERING THE WHOLE MARKING.
- ALL CROSSWALKS SHALL HAVE 10 FEET IN BETWEEN THE 12-INCH WHITE OR YELLOW STRIPES, UNLESS NOTED OTHERWISE ON PLAN SHEETS.
- ALL DOUBLE YELLOW STRIPES SHALL HAVE 3-INCH PAINTED BLACK LINE SEPARATING THE YELLOW STRIPES.
- ALL CROSSWALKS, LIMIT LINES, STOP BARS, PAVEMENT MARKINGS, AND TRAFFIC STRIPES SHALL BE PAINT.
- THE CONTRACTOR SHALL FURNISH AND INSTALL RAISED PAVEMENT MARKERS (RPMs) WITHIN SEVEN WORKING DAYS OF ROADWAY STRIPING. ALL EXISTING RPMs WITHIN THE PROJECT AREA SHALL BE REPLACED IN KIND OR REMOVED IN ACCORDANCE WITH THE PLANS OR AS DIRECTED BY THE ENGINEER.
- THE CONTRACTOR SHALL INSTALL STANDARD SIZE SIGN PANEL ON 2 INCHES SQUARE GALVANIZED STEEP POST WITH BREAKAWAY POST ANCHOR. THE EXACT LOCATION OF ALL SIGNS SHALL BE DETERMINED IN THE FIELD BY THE ENGINEER.
- THE CONTRACTOR SHALL REMOVE SIGNS IN ACCORDANCE WITH THE PLANS AND AS DIRECTED BY THE ENGINEER. THE CONTRACTOR SHALL DELIVER REMOVED SIGNS TO THE CITY YARD OR AS DIRECTED BY THE ENGINEER.
- THE CONTRACTOR SHALL LAYOUT (CAT-TRACK) THE PROPOSED TRAFFIC STRIPES, CROSSWALKS, LIMIT LINES, AND PAVEMENT MARKINGS IN ACCORDANCE WITH THE PLANS WITHIN THREE WORKING DAYS OF FINAL PAVING. CONTACT CITY OF COACHELLA TRAFFIC OPERATIONS TO OBTAIN APPROVAL OF LAYOUT PRIOR TO ACTUAL INSTALLATION.
- THE CONTRACTOR SHALL COORDINATE ALL SIGNING AND STRIPING WORKS THROUGH ENGINEER PRIOR TO OPENING NEW ROADWAYS AND/OR EXISTING ROADWAYS TO NEW SIGNING AND STRIPING IN ACCORDANCE WITH THE PLANS.
- AL EXISTING ASPHALT SHALL BE "FOG SEALED" UPON REMOVAL OF TRAFFIC STRIPES AND PAVEMENT MARKINGS. (UNLESS OTHERWISE APPROVED OR DIRECTED BY THE CITY)
- REFRESH STRIPING IN ADJACENT AREAS AND APPROACHES.
 - A) EXISTING THERMO SHALL BE REFRESHED AND/OR REPLACED WITH PAINT
 - B) EXISTING PAINT SHALL BE REFRESHED AND/OR REPLACED IN PAINT
- PRIMER SHALL BE REPLACED IN ANY AREA WITH CONCRETE PRIOR TO STRIPING.
- ANY EXPOSED STRIPING OR STRIPING EXPOSED AFTER REMOVALS SHALL BE REMOVED TO THE SATISFACTION OF THE CITY BY GRINDING AND/OR BLACKING OUT PRIOR TO APPLICATION OF PAINT, THERMO OR SLURRY SEAL.

GENERAL CONSTRUCTION NOTES

- ALL DESIGN, MATERIALS, AND CONSTRUCTION WORK SHALL CONFORM TO THE CITY OF COACHELLA STANDARD SPECIFICATIONS AND PROCEDURES AND THE CITY OF COACHELLA STANDARD DRAWINGS AND TO THE REQUIREMENTS OF THE STANDARD SPECIFICATIONS FOR PUBLIC WORKS CONSTRUCTION (GREENBOOK), MOST CURRENT EDITIONS AND THESE APPROVED PLANS.
- THE CONTRACTOR SHALL, AT NO EXPENSE TO THE CITY, PROVIDE ALL NECESSARY SAMPLES AND TESTS REQUIRED BY THE CITY TO ASSURE THAT THE QUALITY OF THE MATERIALS AND WORKMANSHIP ARE IN ACCORDANCE WITH THESE PLANS AND SAID SPECIFICATIONS.
- THE CONTRACTOR SHALL BE RESPONSIBLE FOR ALL WORK AND SHALL MAINTAIN ALL FACILITIES COMPLETE AND INCOMPLETE UNTIL ACCEPTED BY THE CITY.
- IT SHALL BE THE RESPONSIBILITY OF THE CONTRACTOR TO CLEAR THE RIGHT-OF-WAY IN ACCORDANCE WITH THE PROVISIONS OF LAW AS IT AFFECTS EACH UTILITY INCLUDING IRRIGATION LINES AND APPURTENANCES AT NO COST TO THE CITY.
- THE CONTRACTOR SHALL OBTAIN AND REVIEW ALL NECESSARY STANDARDS, PLANS, AND SPECIFICATIONS IN DETAIL PRIOR TO START OF CONSTRUCTION. ALL DOCUMENTS, INCLUDING APPROVED PLANS AND REFERENCED STANDARDS SHALL BE ON-SITE AT ALL TIMES. CONFLICTS SHALL BE BROUGHT TO THE ATTENTION OF THE CITY INSPECTOR PRIOR TO WORK IN THAT AREA.
- ALL ELEVATIONS SHOWN TO BE EXISTING FROM RECENT SURVEY OF THE ENGINEER AND SHALL BE VERIFIED BY THE CONTRACTOR PRIOR TO CONSTRUCTION.
- PRIOR TO BEGINNING ANY WORK, CONTRACTOR SHALL SECURE A CITY OF COACHELLA PERMIT FOR CONSTRUCTION. THE CONTRACTOR SHALL NOTIFY THE CITY OF COACHELLA (760) 398-5744, 72 HOURS PRIOR TO STARTING ANY WORK. A PRE-CONSTRUCTION MEETING SHALL BE SET UP WITH THE CITY OF COACHELLA ENGINEERING DEPARTMENT AND ALL AFFECTED UTILITY COMPANIES SHALL BE PRESENT.
- CONTRACTOR SHALL CALL U.S.A., UNDERGROUND SERVICE ALERT, AT 1-800-227-2600 AND SHALL VERIFY LOCATION OF ALL EXISTING UTILITIES 24 HOURS IN ADVANCE OF THE COMMENCEMENT OF CONSTRUCTION.
- OSHA SAFETY ORDERS AND OSHA CONFINED SPACE ENTRY REQUIREMENTS SHALL BE FOLLOWED AT ALL TIMES WITHOUT EXCEPTION.
- THE CONTRACTOR SHALL GUARANTEE ALL WORK FOR A PERIOD OF ONE YEAR AFTER THE DATE OF FINAL ACCEPTANCE BY CITY OF COACHELLA IN ACCORDANCE WITH THE CITY OF COACHELLA STANDARD SPECIFICATIONS.
- QUANTITIES SHOWN HEREON ARE FOR ESTIMATE PURPOSES ONLY. NEITHER THE DESIGN ENGINEER NOR THE CITY OF COACHELLA GUARANTEE THE ACCURACY OR COMPLETENESS OF THE CONSTRUCTION QUANTITIES.
- CONTRACTOR SHALL CONFORM TO LABOR CODE SECTION 6705 BY SUBMITTING A DETAIL PLAN TO THE CITY ENGINEER SHOWING THE DESIGN OF SHORING, BRACING, SLOPING, OR OTHER PROVISIONS TO BE MADE FOR PROTECTION OF WORKERS FROM THE HAZARD OF CAVING GROUND DURING TRENCH EXCAVATION AND PIPE INSTALLATION THEREIN. THIS PLAN MUST BE PREPARED FOR ALL TRENCHES FIVE FEET OR MORE IN DEPTH. IF THE PLAN VARIES FROM THE SHORING SYSTEM STANDARDS ESTABLISHED BY THE CONSTRUCTION SAFETY ORDERS, TITLE 8, CALIFORNIA ADMINISTRATIVE CODE, THE PLAN SHALL BE PREPARED BY A REGISTERED ENGINEER. A COPY OF THE OSHA EXCAVATION PERMIT MUST BE SUBMITTED TO THE CITY OF COACHELLA INSPECTOR PRIOR TO EXCAVATION.
- THE EXISTENCE AND LOCATION OF UNDERGROUND UTILITIES SHOWN ON THESE PLANS WAS OBTAINED BY AVAILABLE RECORDS SEARCH BY THE DESIGN ENGINEER. TO THE BEST OF THE DESIGN ENGINEER'S KNOWLEDGE, THERE ARE NO EXISTING UTILITIES EXCEPT THOSE SHOWN ON THESE PLANS. ATTENTION IS CALLED TO THE POSSIBLE EXISTENCE OF OTHER UTILITIES OR STRUCTURES NOT SHOWN, OR IN A DIFFERENT LOCATION FROM THAT SHOWN ON THE PLANS. THE CONTRACTOR SHALL TAKE DUE PRECAUTIONARY MEASURES TO PROTECT THE UTILITIES SHOWN ON THE PLANS AND OTHER EXISTING FACILITIES OR STRUCTURES NOT SHOWN.
- APPROVAL OF THIS PLAN BY THE CITY OF COACHELLA DOES NOT CONSTITUTE A REPRESENTATION OF THE ACCURACY OF THE LOCATION OF, OR THE EXISTENCE OR NON-EXISTENCE OF, ANY UNDERGROUND UTILITY, PIPE, OR STRUCTURE WITHIN THE LIMITS OF THIS PROJECT.
- CONTRACTOR IS RESPONSIBLE FOR COMPLYING WITH ALL LOCAL, STATE, AND FEDERAL SAFETY REGULATIONS INCLUDING, BUT NOT LIMITED TO, TRENCH SAFETY AND CONFINED SPACE ENTRY.
- SOILS REPORTS SHALL BE SUBMITTED TO THE CITY OF COACHELLA BY A QUALIFIED SOILS ENGINEER WHICH CERTIFIES THAT TRENCH BACKFILL WAS COMPACTED AS DIRECTED BY THE SOILS ENGINEER IN ACCORDANCE WITH ON SITE EARTHWORK SPECIFICATIONS AND THE CITY OF COACHELLA STANDARD SPECIFICATIONS.
- ALL REVISIONS TO DRAWINGS SHALL BE APPROVED BY THE CITY ENGINEER IN WRITING PRIOR TO CONSTRUCTION.
- CONTRACTOR IS RESPONSIBLE FOR KEEPING COMPLETE RECORD OF CHANGES AND SHALL MAKE SUCH RECORD AVAILABLE TO THE DESIGN ENGINEER. THE PRIVATE ENGINEER SHALL PROVIDE AS-BUILT DRAWINGS TO THE CITY OF COACHELLA FOR REVIEW AND APPROVAL PRIOR TO FINAL ACCEPTANCE OF THE PROJECT.
- THE CONTRACTOR SHALL PROTECT ALL SURVEY MONUMENTATION. IF ANY SURVEY MONUMENTS ARE DISTURBED OR DESTROYED, THE CONTRACTOR SHALL RETAIN A LICENSED SURVEYOR TO RE-ESTABLISH AND RECORD THE MONUMENT CHANGE PER STATE LAW.
- CONTRACTOR SHALL NOT INTERRUPT OR DISTURB ANY UTILITY FACILITY WITHOUT AUTHORITY FROM THE UTILITY COMPANIES. WHERE PROTECTION IS REQUIRED TO ENSURE INTEGRITY OF UTILITY FACILITIES (INCLUDING CITY-OWNED UTILITIES). CONTRACTOR SHALL FURNISH AND PLACE ALL NECESSARY PROTECTION.

STREET NOTES

- CONTRACTOR SHALL BE RESPONSIBLE FOR CLEARING OF THE PROPOSED WORK AREA, AND RELOCATION COSTS OF ALL EXISTING UTILITIES. ALL UNDERGROUND FACILITIES WITH LATERALS, SHALL BE IN PLACE PRIOR TO PAVING THE STREET SECTION, INCLUDING, BUT NOT LIMITED TO SEWER, WATER, ELECTRIC, GAS, DRAINAGE, TELEPHONE, CABLE TV, ETC.
- THE CONTRACTOR SHALL TAKE ALL NECESSARY PRECAUTIONS TO PROTECT ADJACENT PROPERTY OWNERS FROM ANY AND ALL DAMAGE THAT MAY OCCUR FROM STORM WATER RUNOFF AND/OR DEPOSITION OF DEBRIS FROM ANY AND ALL WORK IN CONJUNCTION WITH CONSTRUCTION OF THESE IMPROVEMENTS.
- THE CONTRACTOR SHALL BE RESPONSIBLE FOR ALL DAMAGES TO ON-SITE, OFF-SITE, AND ADJACENT UTILITIES, FACILITIES, AND PROPERTY AND SHALL CARRY SUFFICIENT INSURANCE TO PROTECT THE CITY AND THE ADJACENT PROPERTY.
- DEPTH OF BASE MATERIALS AND A.C. PAVING SHALL BE DETERMINED BY THE R-VALUE METHOD, DESIGNATED AS TEST NO. 301-F OF THE STATE OF CALIFORNIA DEPARTMENT OF TRANSPORTATION, HIGHWAY DESIGN MANUAL.
- STREET PAVING SHALL BE INSTALLED IN TWO (2) LIFTS: TOP COURSE 1-1/2" THICK (MINIMUM) 1/2" A.C. PG-70.10 (D1) AND BOTTOM COURSE 2-1/2" THICK (MINIMUM), 3/4" A.C. PG-70-10 (C2).
- WHEEL CHAIR RAMPS SHALL BE CONSTRUCTED AT ALL CURB RETURNS IN CONFORMANCE WITH CITY STANDARD DRAWING S-26 AND ADA REQUIREMENTS.
- THE CONTRACTOR SHALL INSTALL STREET NAME AND STOP SIGNS CONFORMING TO THE CITY STANDARD DRAWING S-27.
- ALL MANHOLE COVERS AND WATER VALVE COVERS SHALL BE ADJUSTED TO GRADE AFTER THE STREETS HAVE BEEN FINAL PAVED PER CITY STDs.
- ALL PRIVATE STREETS AND DRIVEWAYS SHALL BE CONSTRUCTED TO THE STRUCTURAL SECTION DETERMINED BY THE CITY ENGINEER.
- TRIM (SAWCUT) EDGE OF EXISTING PAVEMENT WHERE NEW PAVING JOINS EXISTING TO FORM A CLEAN, SMOOTH STRAIGHT LINE.
- THE CONTRACTOR SHALL NOTIFY THE CITY OF COACHELLA ENGINEERING DEPARTMENT, 619-398-5744, 72 HOURS PRIOR TO STARTING ANY STREET WORK.
- ALL WORKS SHALL CONFORM WITH THE CITY OF COACHELLA IMPROVEMENT STANDARDS AND SPECIFICATIONS AND THE STANDARD SPECIFICATIONS FOR PUBLIC WORKS CONSTRUCTION (GREEN BOOK) LATEST EDITION AND THESE PLANS.
- THE CONTRACTOR SHALL TAKE ALL NECESSARY AND PROPER PRECAUTIONS TO PROTECT ADJACENT PROPERTY OWNERS FROM ANY AND ALL DAMAGE THAT MAY OCCUR FROM STORM WATER RUNOFF AND / OR DEPOSITION OF DEBRIS FROM ANY AND ALL WORK IN CONJUNCTION WITH CONSTRUCTION OF THESE IMPROVEMENT PLANS.
- THE CONTRACTOR SHALL BE RESPONSIBLE FOR ALL WORK AND SHALL MAINTAIN ALL FACILITIES COMPLETE AND INCOMPLETE UNTIL ACCEPTED BY THE CITY.

SHEET INDEX

NO.	DESCRIPTION
1	COVER SHEET
2	PLANS: 52ND AVENUE IMPROVEMENTS
3	PLANS: 52ND AVENUE STRIPING PLANS
4	PLANS: 52ND AVENUE STRIPING PLANS

Section 4216/4216.9 of the Government Code requires a DIG ALERT Identification Number be issued before a "Permit to Excavate" will be valid. For your Dig Alert I.D. Number Call Underground Service Alert 811 two working days before you dig

NO.	REVISION	DATE	APPR.

BENCH MARK: _____ ELEV. _____

DESCRIPTION:

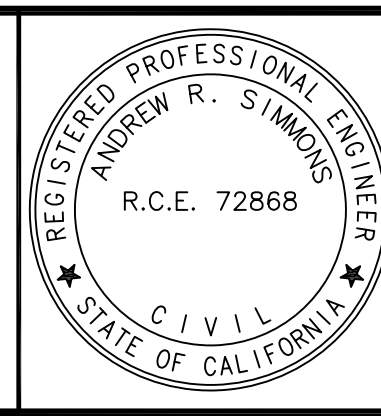

APPROVED BY:

ANDREW R. SIMMONS P.E. ~ CITY ENGINEER _____ DATE _____

R.C.E. 72868

RECOMMENDED FOR APPROVAL BY:

EFRAIN RODRIGUEZ - ASSISTANT ENGINEER _____ DATE _____

SCALE: 1"=40'

PLOT DATE: 10/01/24

DESIGNED BY: ERP

DRAWN BY: ERP

CHECKED BY: _____

CITY OF COACHELLA

53990 ENTERPRISE WAY
COACHELLA, CALIFORNIA 92236
(760) 398-5744

CITY OF COACHELLA
STREET IMPROVEMENT PLANS
52nd Avenue
TITLE SHEET

SHEET	1
OF	4
SHEETS	
F.B.	

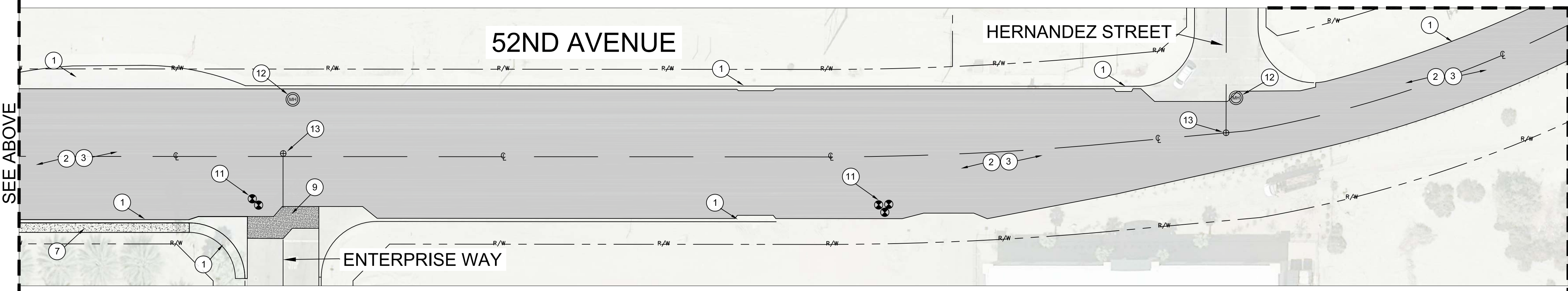
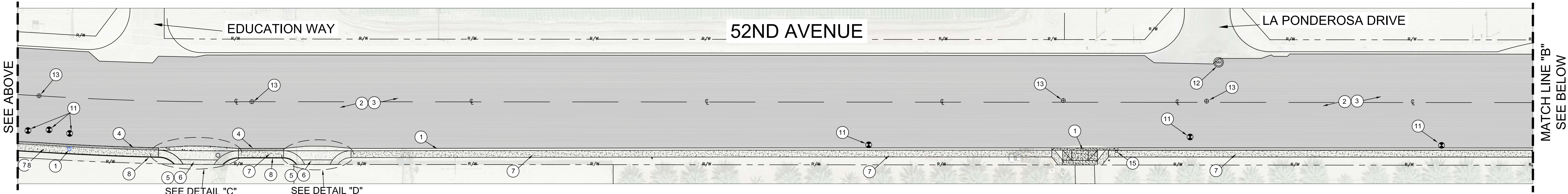
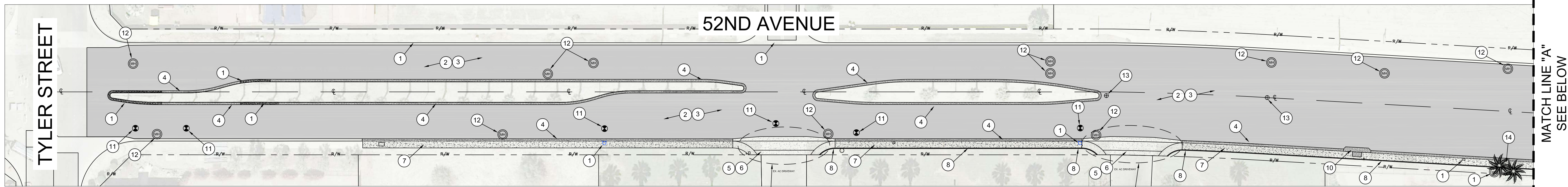

CONSTRUCTION NOTES

1	PROTECT IN PLACE
2	REMOVE EXISTING ASPHALT TO ?" DEPTH
3	CONSTRUCT ?" OF ASPHALT CONCRETE PAVEMENT OVER RE-COMPACTED EXISTING BASE GRADE
4	REMOVE AND REPLACE 8" CURB AND GUTTER PER C.O.C. STD. S-8
5	REMOVE EXISTING DRIVEWAY APPROACH
6	INSTALL COMMERCIAL DRIVEWAY PER C.O.C. STD. S-18
7	INSTALL 6 FOOT WIDE SIDEWALK PER C.O.C S-25.1
8	INSTALL 6" CURB OVER 6" AB PER C.O.C STD. S-10
9	REMOVE AND REPLACE CROSS GUTTER PER C.O.C. STD. S-14
10	REMOVE AND REPLACE CATCH BASIN PER C.O.C. STD. SD-1.1 & SD-2
11	ADJUST EXISTING WATER VALVES TO FINAL GRADE PER CVWD STD W-17 & W-18
12	ADJUST EXISTING SEWER MH TO FINAL GRADE PER CSD STD D-10
13	RESET AND ADJUST SURVEYING MONUMENTS (BY CITY)
14	REMOVE EXISTING PALM TREE
15	ADJUST UTILITY BOX OR MH TO FINAL GRADE

LEGEND

- REMOVE EXISTING A.C. PAVEMENT AND COMPACT EXISTING BASE GRADE. INSTALL ?-INCHES OF ASPHALT CONCRETE PAVEMENT
- EXISTING CONCRETE
- NEW CONCRETE
- EXISTING RIGHT OF WAY
- EXISTING CENTER LINE
- EXISTING WATER VALVE
- EXISTING SEWER MANHOLE

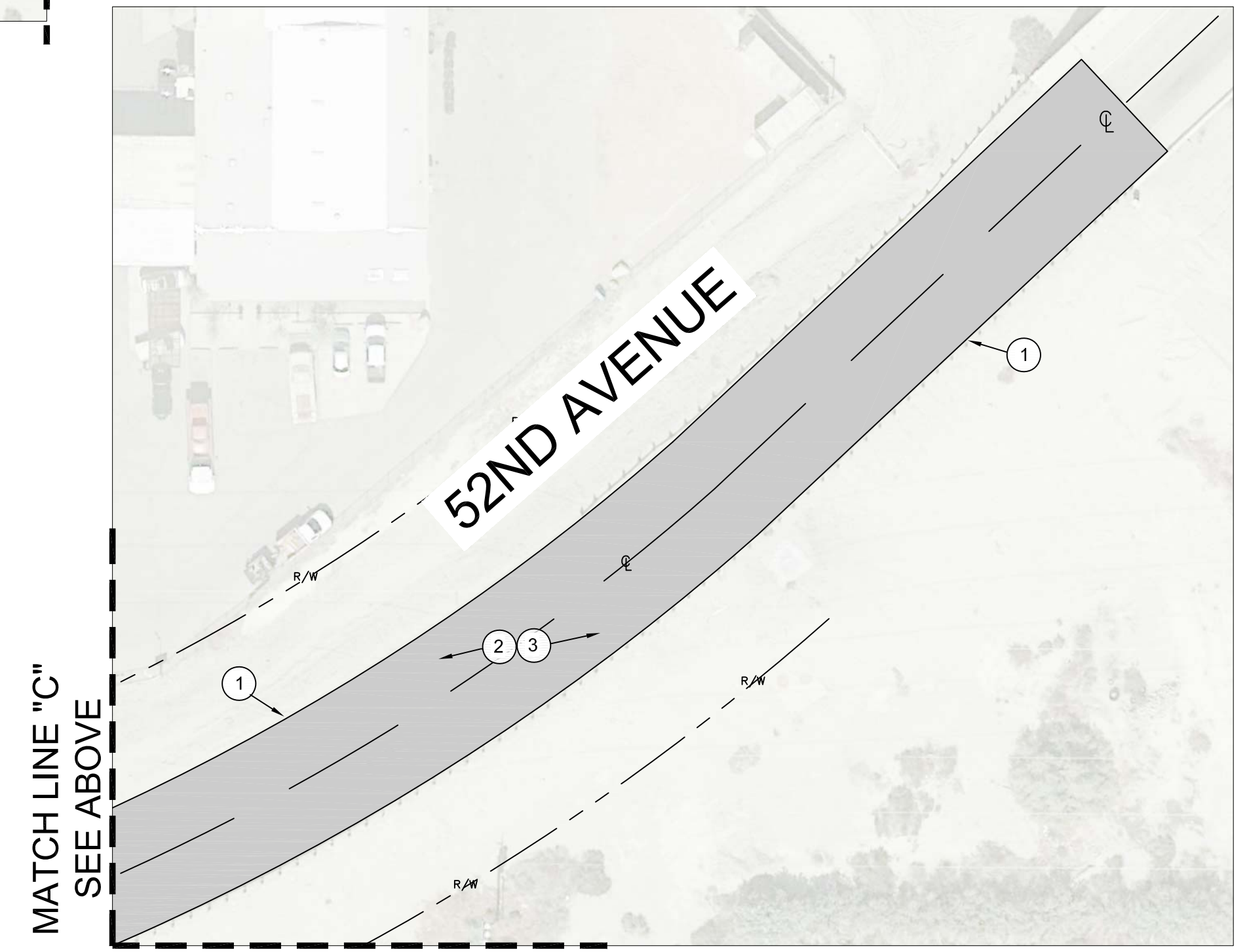
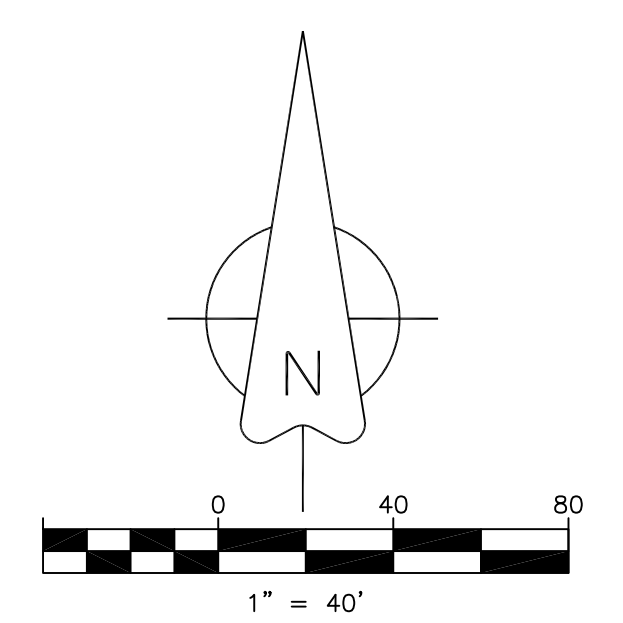

811 Know what's below. Call before you dig.

DIG ALERT Underground Service Alert

Section 4216/4216.9 of the Government Code requires a DIG ALERT Identification Number be issued before a "Permit to Excavate" will be valid. For your Dig Alert I.D. Number Call Underground Service Alert 811 two working days before you dig

NO.	REVISION	DATE	APPR.

BENCH MARK: _____ ELEV. _____

DESCRIPTION:

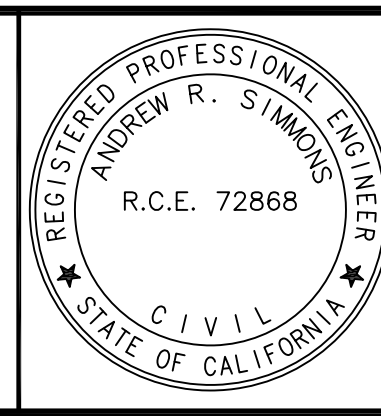

APPROVED BY:

ANDREW R. SIMMONS P.E. ~ CITY ENGINEER _____ DATE _____
R.C.E. 72868

RECOMMENDED FOR APPROVAL BY:

EFRAIN RODRIGUEZ - ASSISTANT ENGINEER _____ DATE _____

SCALE: 1" = 40'

PLOT DATE: 10/01/24

DESIGNED BY: ERP

DRAWN BY: ERP

CHECKED BY: _____

CITY OF COACHELLA

53990 ENTERPRISE WAY
COACHELLA, CALIFORNIA 92236
(760) 398-5744

**CITY OF COACHELLA
STREET IMPROVEMENT PLANS
52ND AVENUE
CONSTRUCTION PLAN**

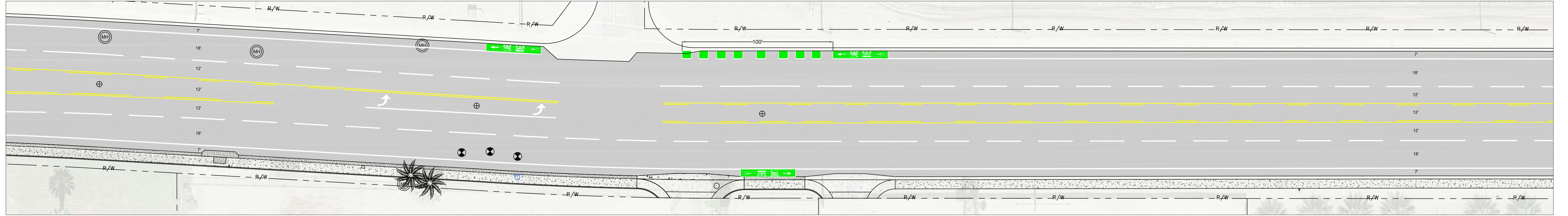
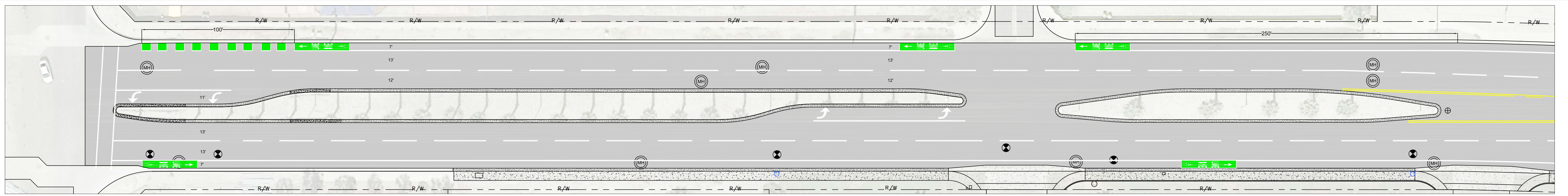

CONSTRUCTION NOTES

16	PAINT YELLOW TRAFFIC LINES AND INSTALL RPM IF APPLICABLE PER CALTRANS STD. A20A & A20B	
17	PAINT WHITE TRAFFIC LINES, AND INSTALL RPM IF APPLICABLE, PER NOTED CALTRANS STD. A20A	
18	PAINT 4" SOLID WHITE LINE	
19	PAINT WHITE PAVEMENT MARKINGS, PER CALTRANS STD. A24A	
20	PAINT BIKE MARKINGS WITH CYCLE GRIP MMAX GREEN PAINT. SEE DETAIL (.....)	
21	PAINT DETAIL 39A PER CALTRANS STD. PLAN A20D WITH CYCLE GRIP MMAX PAINT. SE DETAIL (.....)	
22	PAINT WHITE CROSSWALK PER CALTRANS STD.	

811 Know what's below. Call before you dig.



Section 4216/4216.9 of the Government Code requires a DIG ALERT Identification Number be issued before a "Permit to Excavate" will be valid. For your Dig Alert I.D. Number Call Underground Service Alert 811 two working days before you dig

NO.	REVISION	DATE	APPR.

BENCH MARK: _____ ELEV. _____

DESCRIPTION:

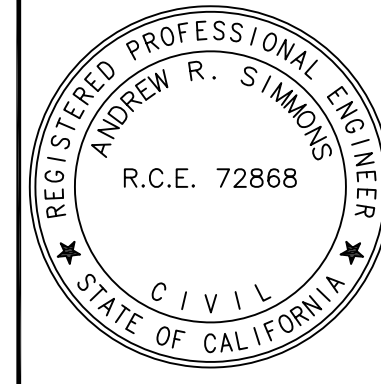

APPROVED BY: _____ DATE _____

ANDREW R. SIMMONS P.E. ~ CITY ENGINEER
R.C.E. 72868

RECOMMENDED FOR APPROVAL BY: _____ DATE _____

EFRAIN RODRIGUEZ - ASSISTANT ENGINEER

SCALE: 1"=30'

PLOT DATE: 10/01/24

DESIGNED BY: ERP

DRAWN BY: ERP

CHECKED BY: _____

CITY OF COACHELLA

53990 ENTERPRISE WAY
COACHELLA, CALIFORNIA 92236
(760) 398-5744

**CITY OF COACHELLA
STREET IMPROVEMENT PLANS
52ND AVENUE
STRIPING PLAN**

SHEET 3 OF 4 SHEETS
F.B.

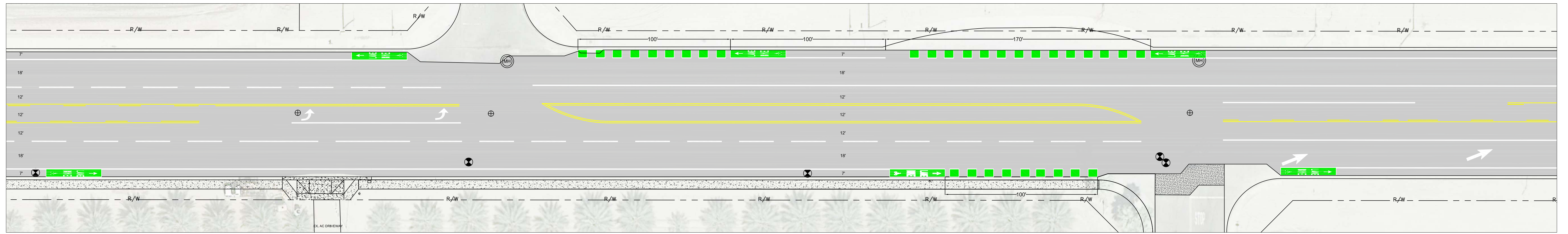

W:\Projects\811\811_2024\811_2024.dwg [SHEET 4] October 01, 2024 - 9:46am acd/ghs



Section 4216/4216.9 of the Government Code requires a DIG ALERT Identification Number be issued before a "Permit to Excavate" will be valid. For your Dig Alert I.D. Number Call Underground Service Alert 811 two working days before you dig

NO.	REVISION	DATE	APPR.

BENCH MARK: _____ ELEV. _____
 DESCRIPTION: _____

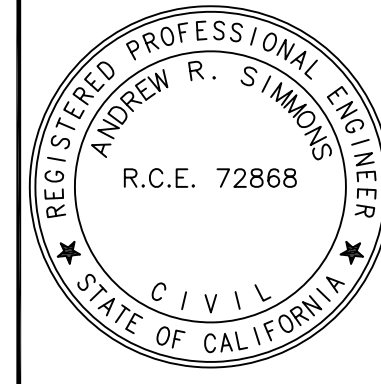

APPROVED BY: _____ DATE _____
 ANDREW R. SIMMONS P.E. ~ CITY ENGINEER
 R.C.E. 72868
 RECOMMENDED FOR APPROVAL BY: _____ DATE _____
 EFRAIN RODRIGUEZ - ASSISTANT ENGINEER

SCALE: 1" = 30'
 PLOT DATE: 10/01/24
 DESIGNED BY: ERP
 DRAWN BY: ERP
 CHECKED BY: _____

CITY OF COACHELLA
 53990 ENTERPRISE WAY
 COACHELLA, CALIFORNIA 92236
 (760) 398-5744

CITY OF COACHELLA
STREET IMPROVEMENT PLANS
52ND AVENUE
STRIPING PLAN

SHEET 4 OF 4 SHEETS
 F.B.