

GRADING PLANS

1. ALL CONSTRUCTION ON-SITE SHALL CONFORM TO THE REQUIREMENTS OF THE CITY OF COACHELLA, TITLE 25 OF THE CALIFORNIA ADMINISTRATIVE CODE, CHAPTER 2 AND THE UNIFORM PLUMBING CODE.
2. ALL GRADING SHALL BE DONE IN CONFORMANCE WITH THE UNIFORM BUILDING CODE CHAPTER 33 LATEST EDITION, REGULATING THE EXCAVATION AND GRADING OF LAND AND AMENDMENTS THERETO, THE REQUIREMENTS OF THE CITY OF COACHELLA AND THE RECOMMENDATION OF THE SOILS REPORT PREPARED BY _____ DATED _____
3. CARE SHALL BE TAKEN TO PROTECT ALL CONSTRUCTION STAKES. RESURVEY RESULTING FROM CARELESS OPERATION SHALL BE BACK-CHARGED TO THE CONTRACTOR.
4. NO WORK SHALL BE ACCOMPLISHED WITHOUT A CITY GRADING PERMIT.
5. NO GRADING SHALL BE STARTED WITHOUT FIRST NOTIFYING BUILDING DEPARTMENT 48 HOURS IN ADVANCE. A PRE-GRADING MEETING AT THE SITE IS REQUIRED BEFORE START OF GRADING WITH THE FOLLOWING PEOPLE PRESENT: OWNER, GRADING CONTRACTOR, DESIGN CIVIL ENGINEER, SOILS ENGINEER, PUBLIC WORKS DEPARTMENT OR ENGINEERING DEPARTMENT OR THEIR REPRESENTATIVE. A 48 HOUR NOTICE REQUIRED PRIOR TO START OF GRADING.
6. THE PERMITTEE OR HIS AGENT SHALL NOTIFY THE ENGINEERING DEPARTMENT WHEN THE GRADING OPERATION IS READY FOR EACH OF THE FOLLOWING INSPECTIONS: (A) INITIAL INSPECTION, WHEN THE PERMITTEE IS READY TO BEGIN WORK BUT NOT LESS THAN TWO DAYS BEFORE ANY GRADING OR BRUSHING IS STARTED. (B) ROUGH GRADING, WHEN ALL ROUGH GRADING HAS BEEN COMPLETED. THIS INSPECTION MAY BE CALLED FOR AT THE COMPLETION OF ROUGH GRADING. (C) FINAL, WHEN ALL WORK, INCLUDING INSTALLATION OF ALL PROTECTIVE DEVICES HAS BEEN COMPLETED AND THE AS-GRADED PLAN, PROFESSIONAL CERTIFICATIONS AND THE REQUIRED REPORTS HAVE BEEN SUBMITTED.
7. FILLS SHALL BE COMPLETED THROUGHOUT TO 90% DENSITY AS DETERMINED BY A.S.T.M. STD. NO. D-1557, LATEST EDITION, 5 LAYER METHOD, AND CERTIFIED BY THE SOILS ENGINEER.
8. AREAS TO BE GRADED SHALL BE PROPERLY PREPARED IN ACCORDANCE WITH THE PRELIMINARY SOILS REPORT AND APPROVED BY THE BUILDING OFFICIAL AND SOILS ENGINEER PRIOR TO PLACING OF FILL.
9. THE EXISTING IRRIGATION LINES AND CISTERNS SHALL BE REMOVED, OR CRUSHED IN PLACE AND BACKFILLED, AND APPROVED BY THE BUILDING OFFICIAL AND SOILS ENGINEER.
10. THE SOILS ENGINEER SHALL BE RESPONSIBLE FOR THE QUALITY OF THE WORK PERFORMED BY THE GRADING CONTRACTOR, AND EXERCISE SUFFICIENT SUPERVISORY CONTROL DURING GRADING TO INSURE COMPLIANCE WITH THE PLANS, SPECIFICATIONS, AND CODE WITHIN HIS PURVIEW.
11. THE DESIGN CIVIL ENGINEER SHALL EXERCISE SUFFICIENT SUPERVISORY CONTROL DURING GRADING AND CONSTRUCTION TO INSURE COMPLIANCE WITH THE PLANS, SPECIFICATIONS, AND CODE WITHIN HIS PURVIEW.
12. DUST SHALL BE CONTROLLED IN ACCORDANCE WITH THE APPROVED FUGITIVE DUST CONTROL PLAN.
13. THE LOCATION AND PROTECTION OF ALL UTILITIES IS THE RESPONSIBILITY OF THE PERMITTEE AND THE PERMITTEE SHALL NOTIFY ALL AFFECTED UTILITIES 48 HOURS IN ADVANCE OF ANY WORK.
14. APPROVED PROTECTIVE MEASURES AND TEMPORARY DRAINAGE PROVISIONS MUST BE USED TO PROTECT ADJOINING PROPERTIES DURING GRADING OF PROJECT.
15. PRIOR TO FINAL APPROVAL, THE DESIGN CIVIL ENGINEER SHALL CERTIFY TO THE BUILDING OFFICIAL THAT THE SITE HAS BEEN GRADED TO THE LINE AND GRADE SHOWN ON THE APPROVED GRADING PLANS.
16. THE DESIGN CIVIL ENGINEER SHALL CERTIFY THAT THE GRADES SHOWN ON THE PLANS MEET THE F.I.R.M. REQUIREMENTS AND THE CITY OF COACHELLA FLOOD PROTECTION ORDINANCE.
17. THE CONTRACTOR SHALL NOT DISTURB EXISTING SURVEY MONUMENTS OR BENCHMARKS NOTED ON THE PLANS. REMOVAL AND REPLACEMENT SHALL BE DONE BY A REGISTERED CIVIL ENGINEER OR LICENSED LAND SURVEYOR ONLY.

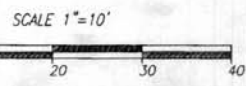

QUANTITY ESTIMATE

THE FOLLOWING EARTHWORK QUANTITIES REPRESENT THE ENGINEER'S ESTIMATE AND ARE NOT FOR BID OR CONTRACT PURPOSES. THE CONTRACTOR SHALL MAKE HIS OWN ESTIMATE OF THE WORK TO BE PERFORMED. THESE QUANTITIES DO NOT INCLUDE SHRINKAGE OR SUBSIDENCE.

FILL - 50 CY
CUT - 50 CY

LEGEND	
TC	= TOP OF CURB
FF	= FINISH FLOOR
FS	= FINISH SURFACE
R/W	= RIGHT OF WAY
TC	= TOP OF CURB
FL	= FLOWLINE
PL	= PROPERTY LINE
CL	= CENTERLINE
()	= EXISTING ELEVATIONS
PA	= PLANTING AREA
FG	= FINISH GRADE

LANDSCAPE LEGEND		SIZE
	SHAMEL ASH	24" BOX
	TEXAS GRASS (RED)	5 GAL
	JUNIPERO (DWARF)	5 GAL
	NADAL PLUMB (DWARF)	5 GAL

ALL LANDSCAPE PLANTS TO BE PROVIDED WITH DRIP SYSTEM IRRIGATION

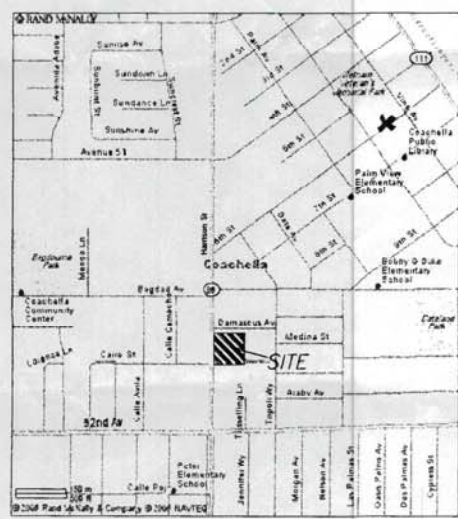

VICINITY MAP
N.T.S.

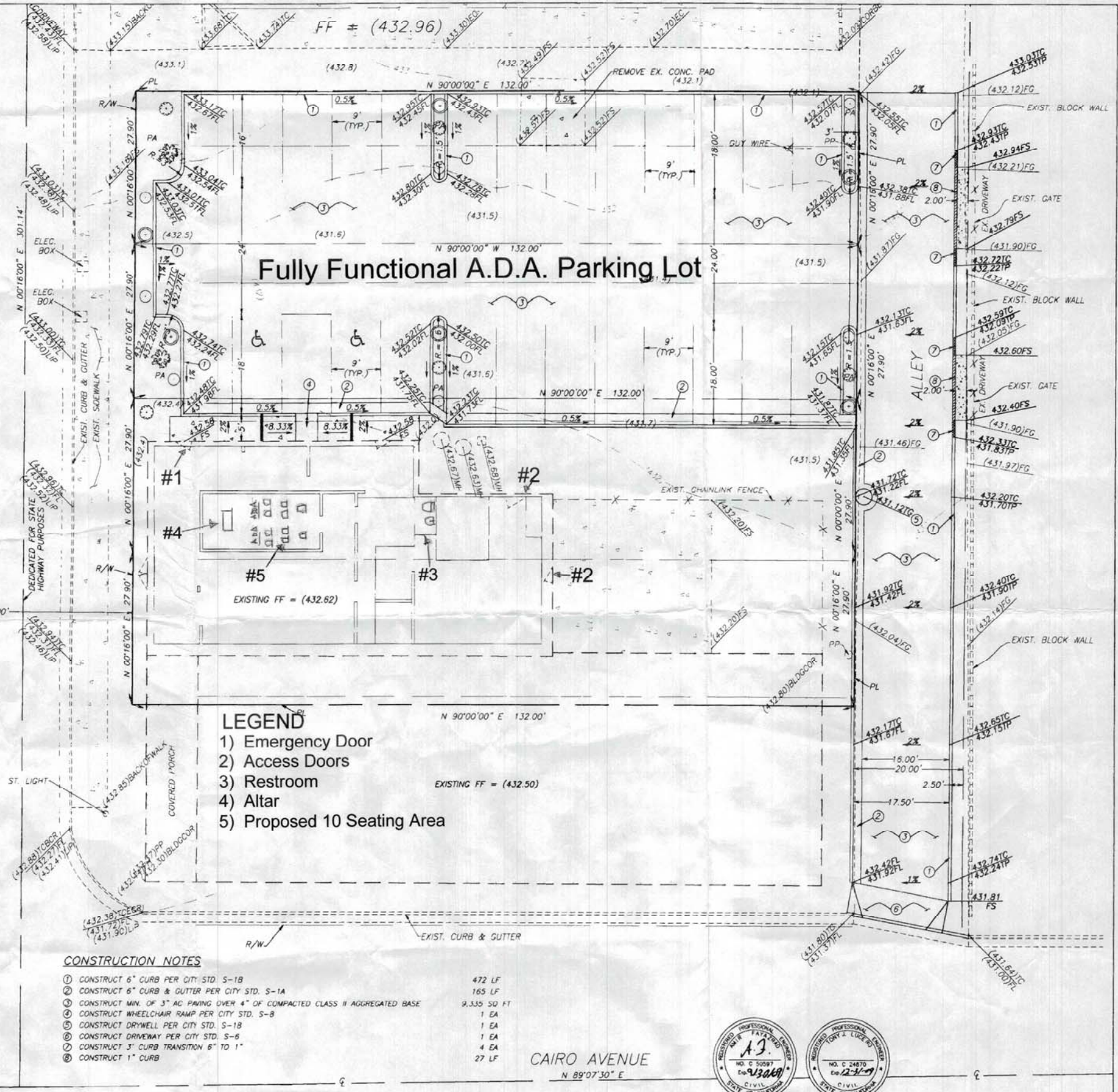

- ### LEGEND
- 1) Emergency Door
 - 2) Access Doors
 - 3) Restroom
 - 4) Altar
 - 5) Proposed 10 Seating Area

CONSTRUCTION NOTES

- 1) CONSTRUCT 6" CURB PER CITY STD. S-1B 472 LF
- 2) CONSTRUCT 6" CURB & GUTTER PER CITY STD. S-1A 165 LF
- 3) CONSTRUCT MIN. OF 3" AC PAVING OVER 4" OF COMPACTED CLASS II AGGREGATED BASE 9,335 SQ FT
- 4) CONSTRUCT WHEELCHAIR RAMP PER CITY STD. S-8 1 EA
- 5) CONSTRUCT DRYWELL PER CITY STD. S-1B 1 EA
- 6) CONSTRUCT DRIVEWAY PER CITY STD. S-8 4 EA
- 7) CONSTRUCT 3" CURB TRANSITION 6" TO 1" 4 EA
- 8) CONSTRUCT 1" CURB 27 LF



IMPORTANT NOTICE CALL BEFORE YOU DIG SECTION 4116 OF THE GOVERNMENT CODE REQUIRES AN INDUSTRY IDENTIFICATION NUMBER BE OBTAINED BEFORE A "TYPICAL" EXCAVATION WILL BE MADE. FOR YOUR PROTECTION, PLEASE CALL UNDERGROUND SERVICE ALERT TOLL FREE 1-800-227-2600 TWO WORKING DAYS BEFORE YOU DIG.	UNAUTHORIZED CHANGES & USES: THE ENGINEER PREPARING THESE PLANS WILL NOT BE RESPONSIBLE FOR OR LIABLE FOR UNAUTHORIZED CHANGES TO OR USES OF THESE PLANS. ALL CHANGES TO THE PLANS MUST BE MADE IN WRITING AND BE APPROVED BY THE ENGINEER. ENGINEER'S NOTE TO CONTRACTOR: CONSTRUCTION CONTRACTOR AGREES THAT IN ACCORDANCE WITH GENERALLY ACCEPTED CONSTRUCTION PRACTICES, CONSTRUCTION CONTRACTOR WILL BE REQUIRED TO ASSUME SOLE AND COMPLETE RESPONSIBILITY FOR JOB SITE CONDITIONS DURING THE COURSE OF CONSTRUCTION OF THE PROJECT, INCLUDING SAFETY OF ALL PERSONS AND PROPERTY. THAT THIS RESPONSIBILITY SHALL BE LIMITED TO THE PERFORMANCE OF THE WORK LIMITED TO NORMAL WORKING HOURS, AND CONSTRUCTION CONTRACTOR FURTHER AGREES TO OBTAIN NECESSARY AND HOLD TECHNICAL PROFESSIONAL WARRANTIES FROM HIM AND ALL QUALITY OF ALL WORK TO BE PERFORMED BY CONSTRUCTION PROFESSIONALS ON THIS PROJECT, CREATING LIABILITY ARISING FROM THE SOLE RESPONSIBILITY OF CONSTRUCTION PROFESSIONALS. THE EXISTENCE AND LOCATION OF ANY UNDERGROUND UTILITIES OR STRUCTURES SHOWN IN THESE PLANS WERE OBTAINED BY A SEARCH OF AVAILABLE RECORDS. TO THE BEST OF OUR KNOWLEDGE, THERE ARE NO EXISTING UTILITIES CREDIT THOSE SHOWN ON THESE PLANS. THE CONTRACTOR IS REQUIRED TO USE ALL PRECAUTIONS NECESSARY TO PROTECT THE UTILITIES SHOWN AND IS RESPONSIBLE FOR THE PROTECTION OF, AND ANY DAMAGE TO THESE LINES OR STRUCTURES.	REVISIONS DATE APP.	(BENCH MARK, SEA LEVEL REF.) S-1 ELEV. 434.50 TOP OF F.M. OR N.E. COR. CAIRO AVE. & HARRISON ST. (BASIS OF BEARING) N 00°16'00" E CL OF STATE HIGHWAY 86 (HARRISON ST.)	AMIR ENGINEERING CIVIL ENGINEERING • LAND SURVEYING 160 LURING DR., STR. A, PALM SPRINGS, CA 92260 PH. (760) 318-7424 FAX (760) 318-7410 (OWNER'S NAME, ADDRESS, AND PHONE NUMBER) SILVIA VELAZQUEZ 51-596 HARRISON ST. COACHELLA, CA TELE: (760) 398-5661	PREPARED UNDER THE DIRECT SUPERVISION OF: Amir Fayazrad 8/18/08 AMIR FAYAZRAD R.C.E. 50597 EXP. 9/30/2009 DATE GEOTECHNICAL CERTIFICATION, IF REQUIRED, BY: NOT APPLICABLE DATE	APPROVED BY CITY OF COACHELLA Danyel J. Lugo 8-15-08 CIVIL ENGINEER 24870 12-31-09 R.C.E. EXP.	CITY OF COACHELLA SITE PLAN GRADING PLAN/PARKING LOT PLAN LEGAL DESCRIPTION POR. LOTS 6 & 8 BLK B & LOTS 7 & 8 BLK B MB 14/058, BENEDICT ADDITION A.P.N.'S: 785-342-004 785-342-005 785-342-006	SHEET 1 OF 1 PRIVATE REFERENCE # V3-J CITY REFERENCE #
		SEC. 5, T. 6 S., R. 8 E., S.B.M.						