

HOURS OF CONSTRUCTION	
<p><b>May 1st through September 30th:</b>  Monday - Friday: 6:00AM to 7:00PM  Saturday: 8:00AM - 5:00PM  Sunday: None  Government Code Holidays: None</p>	<p><b>October 1st through April 30th:</b>  Monday - Friday: 7:00AM to 5:30PM  Saturday: 8:00AM - 5:00PM  Sunday: None  Government Code Holidays: None</p>
<p>Now the contractor, after being informed orally or in writing that the work has caused noise or sounds which disturb any other person's peace and quiet, shall fail, refuse or neglect to take whatever steps or use whatever means are necessary to assure that the work does not again disturb the other person's peace and quiet.</p>	
PROJECT INFORMATION	
<p><b>SCOPE OF WORK:</b>  Installation of Irrigation, Plant Material and Concrete Walkway</p> <p><b>LEGAL ADDRESS:</b>  53800 POLK ST  COACHELLA CA. 92236</p> <p><b>APP Number</b>  APP#: 763-160-012</p> <p><b>PROPERTY TYPE:</b>  PP BUSINESS AND EQUIPMENT</p>	<p><b>OWNER:</b>  PETER SOLOMIN &amp; Co. Inc,  53800 POLK ST  COACHELLA CA. 92236</p> <p><b>DESIGNER:</b>  JOSE GARZA LANDSCAPE CONTRACTOR  AND DRAFTING SERVICES  P.O. Box 5891 La Quinta, CA. 92248  jose@garzaconcepts.com  www.garzaconcepts.com  Lic # 1050039</p>

SHEET INDEX	
SHEET NO.	SHEET DESCRIPTION
L1	COVER SHEET
L2	LANDSCAPE PLAN
L3	LANDSCAPE PLAN
L4	LANDSCAPE PLAN
L5	LANDSCAPE PLAN
L6	LANDSCAPE PLAN
L7	LANDSCAPE PLAN
L8	LANDSCAPE DETAILS
L9	IRRIGATION PLAN
L10	IRRIGATION PLAN
L11	IRRIGATION PLAN
L12	IRRIGATION PLAN
L13	IRRIGATION PLAN
L14	IRRIGATION PLAN
L15	IRRIGATION DETAILS
L16	HARDSCAPE

VICINITY MAP

52nd Ave

52nd Ave

INDUSTRIAL WAY

GRAPEFRUIT BLVD

ENTERPRISE WAY

POLK ST

POLK ST

AVENUE 54

AVENUE 54

PROJECT LOCATION

N

VERIFY CONNETION POINTS FOR POWER TELEPHONE AND CATV SYSTEMS  
PRIOR TO CONSTRUCTION APROXIMATE ONLY LOCATIONS INDICATED FOR  
TRANSFORMER LOCATIONS, ETC.

COMPLY WITH ALL UTILITY COMPANY REQUIREMENTS, PROVIDE ALL  
RELATED CONDUITS, PULL BOXES AND REISERS.



L1



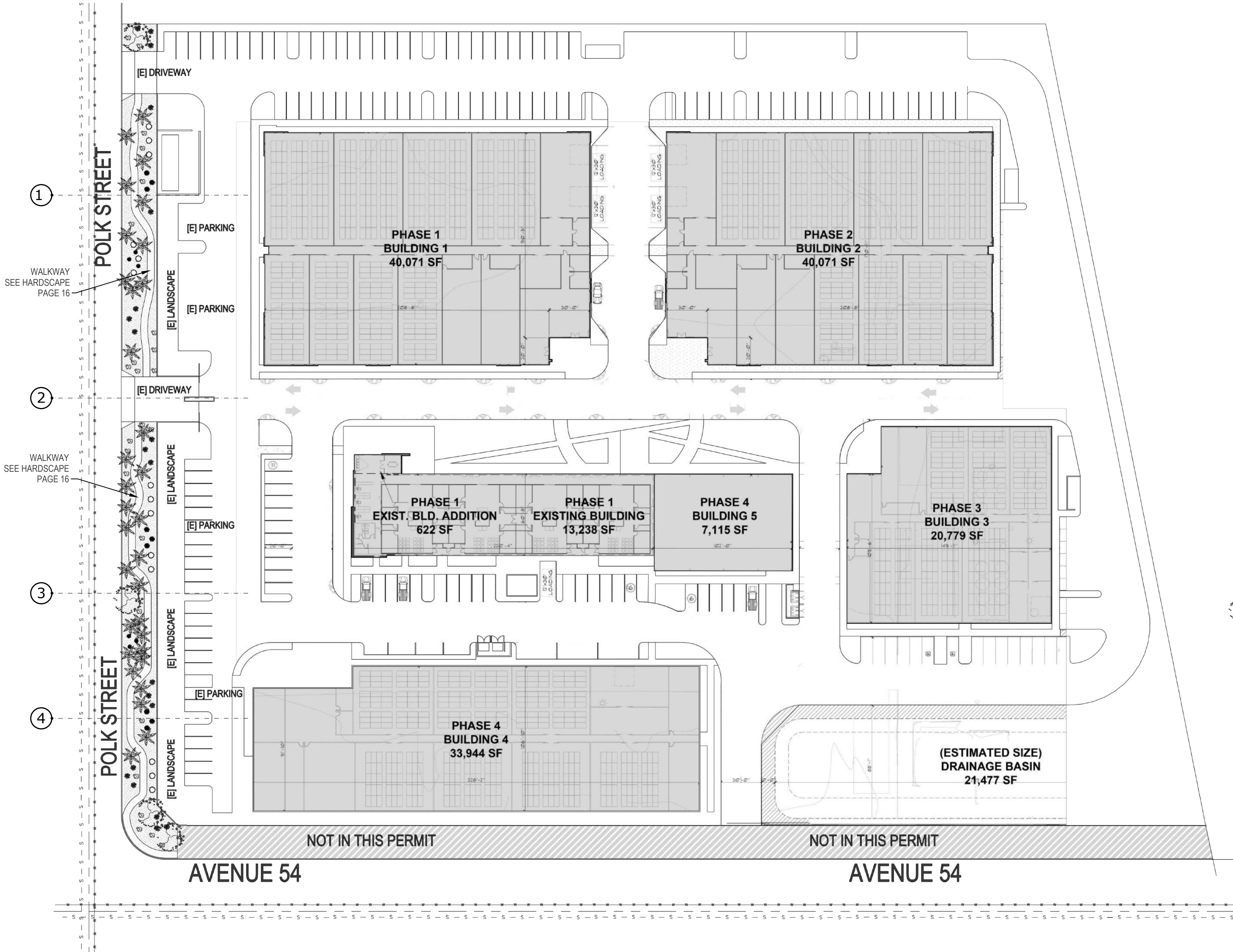

**UTILITY NOTES**  
VERIFY CONNETION POINTS FOR POWER TELEPHONE AND CATV SYSTEMS  
PRIOR TO CONSTRUCTION APPROXIMATE ONLY LOCATIONS INDICATED FOR  
TRANSFORMER LOCATIONS, ETC.  
  
COMPLY WITH ALL UTILITY COMPANY REQUIREMENTS, PROVIDE ALL  
RELATED CONDUITS, PULL BOXES AND REISERS.



48 HOURS BEFORE YOU DIG  
**CALL**  
  
UNDERGROUND SESERVICE ALERT  
1-800-277-2600

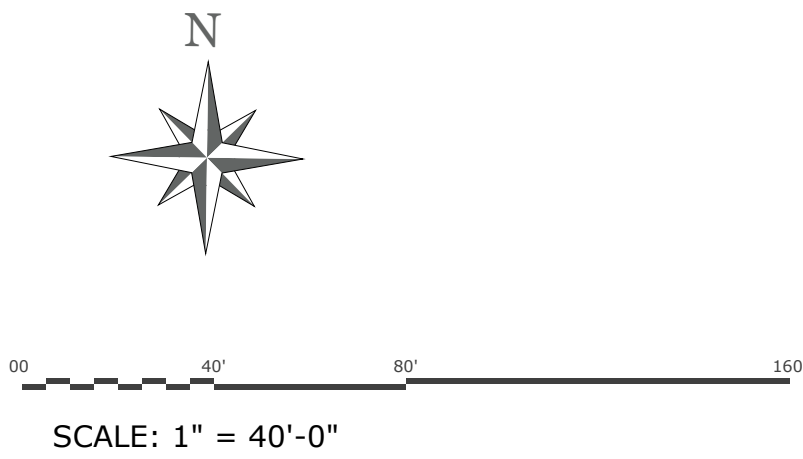

PALMS & TREES						
SYM.	NAME	SIZE	QTY	WATER NEEDS	PLANT FACTOR	COMMENTS
	PRESERVE EXISTING OLEA EUROPA TREE	FIELD GROWN	4	MOD	.50	
	PRESERVE EXISTING WASHINGTONIA FILLIFERA	24" Box	34	MOD	.50	
CACTUS / SHRUBS						
SYM.	NAME	SIZE	QTY	WATER NEEDS	PLANT FACTOR	COMMENTS
	AGAVE AMERICANA CENTURY PLANT	5 GAL	9	LOW	.20	
	CAESALPINIA MEXICANA MEXICAN BIRD OF PARADISE	5 GAL	14	LOW	.20	
	SENNA ARTEMISIOIDES FEATHERY CASSIA	5 GAL	20	LOW	.20	
	DASYLIRION WHEELERI DESERT SPOON	5 GAL	6	LOW	.20	
	LANTANA CAMARA LANTANA	5 GAL	25	MOD	.50	
GRAVEL						
SYM.	QTY	NAME				
	10,008 SQ.FT.	CALIFORNIA GOLD DECOMPOSED GRANITE 3-INCH MINIMUM COMPACTED WITH WEED BARRIER				



AGAVE AMERICANA CENTURY PLANT



CAESALPINIA MEXICANA MEXICAN BIRD OF PARADISE



SENNA ARTEMISIOIDES FEATHERY CASSIA



DASYLIRION WHEELERI DESERT SPOON



LANTANA CAMARA LANTANA

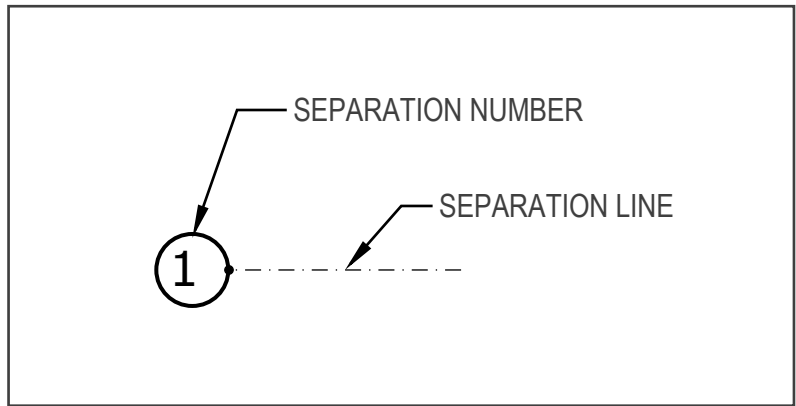

SYMBOL













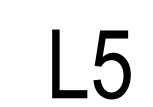
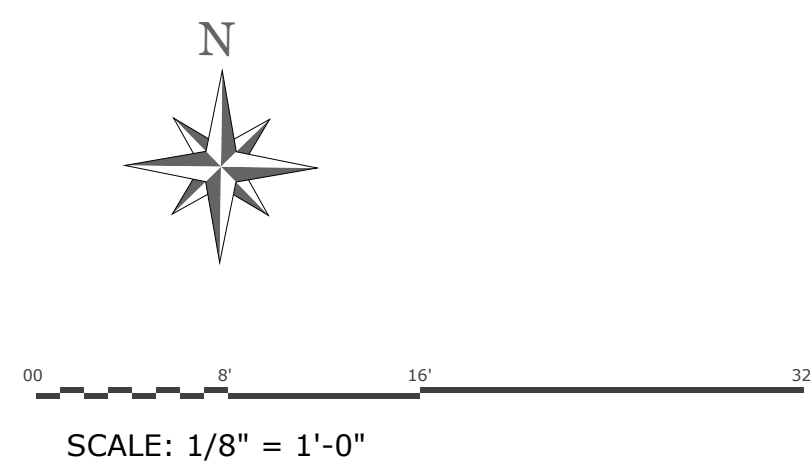



3

4

# POLK STREET

[E] LANDSCAPE

[E] LANDSCAPE

[E] PARKING

UTILITY NOTES

VERIFY CONNETION POINTS FOR POWER TELEPHONE AND CATV SYSTEMS  
PRIOR TO CONSTRUCTION APPROXIMATE ONLY LOCATIONS INDICATED FOR  
TRANSFORMER LOCATIONS, ETC.

COMPLY WITH ALL UTILITY COMPANY REQUIREMENTS, PROVIDE ALL  
RELATED CONDUITS, PULL BOXES AND REISERS.



48 HOURS BEFORE YOU DIG  
CALL

UNDERGROUND SESERVICE ALERT  
1-800-277-2600



SCALE: 1/8" = 1'-0"

PALMS & TREES

SYM.	NAME	SIZE	QTY	WATER NEEDS	PLANT FACTOR	COMMENTS
	PRESERVE EXISTING OLEA EUROPA TREE	FIELD GROWN	4	MOD	.50	
	PRESERVE EXISTING WASHINGTONIA FILLIFERA	24" Box	34	MOD	.50	

CACTUS / SHRUBS

SYM.	NAME	SIZE	QTY	WATER NEEDS	PLANT FACTOR	COMMENTS
	AGAVE AMERICANA CENTURY PLANT	5 GAL	9	LOW	.20	
	CAESALPINIA MEXICANA MEXICAN BIRD OF PARADISE	5 GAL	14	LOW	.20	
	SENNA ARTEMISIOIDES FEATHERY CASSIA	5 GAL	20	LOW	.20	
	DASYLIRION WHEELERI DESERT SPOON	5 GAL	6	LOW	.20	
	LANTANA CAMARA LANTANA	5 GAL	25	MOD	.50	

GRAVEL

SYM.	QTY	NAME
	10,008 SQ.FT.	CALIFORNIA GOLD DECOMPOSED GRANITE 3-INCH MINIMUM COMPACTED WITH WEED BARRIER



AGAVE AMERICANA  
CENTURY PLANT



CAESALPINIA MEXICANA  
MEXICAN BIRD OF PARADISE



SENNA ARTEMISIOIDES  
FEATHERY CASSIA



DASYLIRION WHEELERI  
DESERT SPOON



LANTANA CAMARA  
LANTANA

GARZA CONCEPTS

JOSE GARZA LANDSCAPE CONTRACTOR AND DRAFTING :  
P.O. Box 5891 La Quinta, CA. 92248  
jose@garzaconcepts.com www.garzaconcepts.com  
Lic # 1050039

GARZA CONCEPTS

PROJECT  
STREETSCAPE RENOVATION  
53800 POLK ST  
COACHELLA CA. 92236

LANDSCAPE PLAN

Date Created  
04/16/25

REVISED

1

2

3

4

5

L6



4

POLK S

[E] LANDSCAPE

NOT I

AVENUE 54

UTILITY NOTES

VERIFY CONNETION POINTS FOR POWER TELEPHONE AND CATV SYSTEMS  
PRIOR TO CONSTRUCTION APPROXIMATE ONLY LOCATIONS INDICATED FOR  
TRANSFORMER LOCATIONS, ETC.

COMPLY WITH ALL UTILITY COMPANY REQUIREMENTS, PROVIDE ALL  
RELATED CONDUITS, PULL BOXES AND REISERS.



48 HOURS BEFORE YOU DIG  
CALL

UNDERGROUND SESERVICE ALERT  
1-800-277-2600

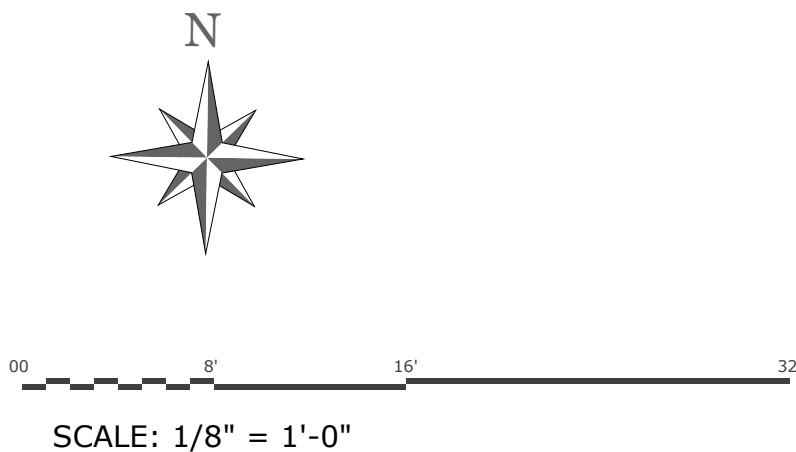

PALMS & TREES						
SYM.	NAME	SIZE	QTY	WATER NEEDS	PLANT FACTOR	COMMENTS
	PRESERVE EXISTING OLEA EUROPA TREE	FIELD GROWN	4	MOD	.50	
	PRESERVE EXISTING WASHINGTONIA FILLIFERA	24" Box	34	MOD	.50	
CACTUS / SHRUBS						
SYM.	NAME	SIZE	QTY	WATER NEEDS	PLANT FACTOR	COMMENTS
	AGAVE AMERICANA CENTURY PLANT	5 GAL	9	LOW	.20	
	CAESALPINIA MEXICANA MEXICAN BIRD OF PARADISE	5 GAL	14	LOW	.20	
	SENNA ARTEMISIOIDES FEATHERY CASSIA	5 GAL	20	LOW	.20	
	DASYLIRION WHEELERI DESERT SPOON	5 GAL	6	LOW	.20	
	LANTANA CAMARA LANTANA	5 GAL	25	MOD	.50	
GRAVEL						
SYM.	QTY	NAME				
	10,008 SQ.FT.	CALIFORNIA GOLD DECOMPOSED GRANITE 3-INCH MINIMUM COMPACTED WITH WEED BARRIER				



AGAVE AMERICANA CENTURY PLANT



CAESALPINIA MEXICANA MEXICAN BIRD OF PARADISE



SENNA ARTEMISIOIDES FEATHERY CASSIA



DASYLIRION WHEELERI DESERT SPOON



LANTANA CAMARA LANTANA



PLANTING NOTES

1. BEFORE ANY PLANTS ARE PLANTED, ALL PLANTING AREAS MUST BE GRADED IN AN ACCEPTABLE MANNER TO ASSURE POSITIVE DRAINAGE PER THE DRADING NOTES.
2. WHERE CIRCUMSTANCES PERMIT, TREES TO BE PLANTED NO CLOSER THAN 18" TO AN EDGE OF HARDSCAPE.
3. REMOVE ALL STAKES FROM VINES.
4. PLANTING MATERIAL THAT IS ACCIMATED TO THE COACHELLA VALLEY MUST BE USED WHENEVER POSSIBLE.
5. WHEN TYING VINES OR ESPALIERS, WIRES SHOULD BE SPACED AS FOLLOWS:  
1ST (2) AT 1'-6" APART FROM FINISHED GRADE, THE NEXT (3) AT 1'-0" APART TO MAKE THE TOOP WIRE AT 6'-0" ABOVE FINISHED GRADE. WIRES SHOULD BE A MINIMUM OF 8'-0" LONG CENTERE ON PLANTS. WHEN VINE OR SPALIERS ARE CLOSER THAN 10'-0" APART, USE A CONTINUOUS WIRE BETWEEN BOTH PLANTS..
6. PLANT MATERIAL LISTED ON LEGEND MAY OR MAY NOT HAVE BEEN APPROVED BY THE AGRICULTURAL COMMISSIONER'S OFFICE. LANDSCAPE CONTRATOR TO CONTACT THE DEVELOPER FOR STATUS OF AGRUCULTURAL COMMISSIONER'S APPROVAL OR DENIAL. PLANT MATIERIAL NOT CONFORMING WITH QUARANTINE LAWS MAY BE DETROYED AND CIVIL ACTION TAKEN. ALL PLANT MATERIAL IS SUBJECT TO INSPECTION AT THE DISCRETION OF THE AGRICULTURAL COMMISSIONER'S OFFICE. ALL PLANT MATERIAL MUST BE FREE RED SCALE (AONIDIELLA AURANTI).
7. NO SHRUBS ARE TO BE PLANTED WITHIN 18" OF HARDSCAPE, MEASURED FROM CENTER OF SHRUB.

DEEP ROOT BARRIER APPLICATION

1. PREPARE THE INITIAL PLANTING HOLE AS ILLUSTRATED ON PLANTING NOTES. IT'S BASED UPON THE COMBINATION OF DESIRE BARRIER DIAMETER AND DEPTH. CONSIDER IF DRAINAGE DEVICES OR AMENDMENTS ARE NEEDED TO CORRECT ANY ADVERSE SOIL OR PLANTING CONDIONS IN THE BACKFILL AREA.
2. ASSEMBLE THE APPROPRATE NUMBER OF DEEP ROOT UNIVERSAL BARRIER PANELS. THE VERTICAL ROOT DEFLECTING RIBS ON THE PANEL MUST FACE INWARD, TOWARD THE ROOT BALL. THIS IS VERY IMPORTANT, OTHERWISE THE ROOTS WILL BECOME GIRDLED BY TRAVELING AROUND THE SMOOTH WALLED SURFACE.
3. NEXT PLACE THE BARRIER IN THE CENTER OF THE PLANTING HOLE, KEEPING IN MIND THAT THE DOUBLE TOP EDGE OF THE BARRIER SHULD BE POSITIONED APPROXIMATELY 1/2" ABOVE GRADE. THIS HELPS RETARD POTENTIAL ROOT OVERGROWTH WHICH CAN LEAD TO UPROOTED HARDSCAPES.
4. BACKFILL AND COMPACT WITH SOIL INSIDE THE BARRIER TO THE LEVEL WHERE THE BOTTOM OF THE ROOT BALL APPROXIMATELY 1" ABOVE GRADE.
5. REMOVE THE TREE FROM ITS CONTAINER, OR CUT AWAY THE TOP PORTION OF BURLAP AND POSITION IN THE CENTER OF THE BARRIER. COMPLETE THE BACKFILL OF THE SOIL. DISTRIBUTE EVENLY TO MAINTAIN THE SHAPE OF THE BARRIER AND COMPACT THE BACKFILL EVERY 4"-6". ROOTS WILL DIE QUICKLY IF LEFT EXPOSED TOT HE ELEMENTS SO KEEP EXPOSURE OF THE ROOTS TO A MINIMUM.
6. IF STOKING OF GUYING IS REQUIRED, IT IS RECOMMENDED OF USING THE SOFT, SAFE AND ECONOMICAL ALTERNATIVE TO TRADITIONAL WIRE AND HOSE, ARBORTIE(SEE WWW.DEEPROOT.COM FOR DETAILS)
7. IF THE TREE(S) WILL BE SUBJECT TO MAINTENANCE WORK SUCH AS LAWN MOWING OR WEED TRIMMING IT IS RECOMMENDED TO INSTALL THE ARBORGARD+ TREE TRUNK PROTECTOR WHICH IS PLACED AROUND THE BASE OF YOUNG TREES TO PROTECT THEM FROM DAMAGE BY WEED TRIMMERS, LAWN MOWERS AND SMALL RODENTS.
8. WATER AND FOLLOW TREE MAINTENANCE PRACTICES.
9. TREES DO REQUIRE CARE AND NURTURING AFTER PLANTING. CONSULT WITH YOUR LOCAL SUPPLIER FOR PROPER CARE PROCEDURES FOR THE SPECIES YOU ARE PLANTING. THE PLANTING INSTRUCTION NOTED ABOVE ARE BY NO MEANS A COMPREHENSIVE GUIDE. RATHER THEY ARE GENERAL GUIDELINES TO PLANTING WITH DEEPROOT BARRIERS AND A SURVEY OF CURRENT PLANTING METHODS. CONDITIONS WILL VARY HOWVER AND IT IS RECOMMENDED THAT AN ARBORIST BE CONSULTED BEFORE PLANTING. ADDITIONAL INFORMATION IS AVAILABLE AT WWW.DEEPROOT.COM

UTILITY NOTES

VERIFY CONNETION POINTS FOR POWER TELEPHONE AND CATV SYSTEMS PRIOR TO CONSTRUCTION APPROXIMATE ONLY LOCATIONS INDICATED FOR TRANSFORMER LOCATIONS, ETC.

COMPLY WITH ALL UTILITY COMPANY REQUIREMENTS, PROVIDE ALL RELATED CONDUITS, PULL BOXES AND REISERS.



48 HOURS BEFORE YOU DIG  
CALL

UNDERGROUND SESERVICE ALERT  
1-800-277-2600

PALM TREE PLANTING NOTES

1. PALMS SHALL BE PLANTED USING ESTABLISHED PLANTING PROCEDURES NOTED ON PLANTING DETAILS.
2. PALM TREE ROOT BALLS SHALL BE TRIMMED OR CUT TO ENSURE RECOVERY FROM TRANSPLANTING SHOCK.
3. PALM TREES MUST BE IN A HEALTHY CONDITION AT TIME OF DELIVERY. PALM TREES DETERMINED UNHEALTHY OR DAMAGED AT TIME OF DELIVERY OR INTALLATION SHALL BE REJECTED BY CONTRACTOR AND REPLACED BY SUBCONTRACTOR AT HIS EXPENSE.
4. ALL PALMS SHALL BE CLEANED OF ECESSEIVE DEAD AND RAGGED FRONDS OR FROND STUBBLE. CUT FRONDS SHOULD BE CUT TO A MAXIMUM LENGHT OF 6".
5. CALLED OUT HEIGHTS OF PALMS SHALL BE THE HEIGHT FROM TOP OF ROOT BALL TO BOTTOM OF LIVE FRONDS.
6. PALM TREES TO BE PROPERLY WATERED IN A SOIL PROPERLY TAMPED AROUND THE ROOT BALL WHEN PLANTING. DO NOT LEAVE ANY VOIDS OF SOIL AROUND ROOT BALLS.
7. PALM TREES SHALL BE PLANTED VERTICALLY, UNLESS NOTED ON THE PLAN.
8. TRUNKS SHOULD BE ROUGHT WITH FRONDS BASES STILL SECURELY ATTACHED.
9. TRUNKS MAY NOT BE TOTALLY SKINNED UNLESS NOTED ON PLAN.
10. TRUNK BASES MAY BE SKINNED TO A MAXIMUM HEIGHT OF 3'-4" (TALLER PALM 6'-0").
11. SKINNED AREAS ABOVE THE 6'-0" MARK WILL BE ACCEPTED, AT THE DIRECTION OF THE LANDSCAPE DESIGNER.
12. CARE SHOULD BE EXERCISED IN THE CABLING DURING TRANSPORT AND PLANTING SO AS NOT TO DAMAGE BARK.
13. SEVERE CRACKING OR HOLED IN THE BASAL TRUNK AREA WILL BOT BE ACCEPTABLE.
14. ONE INITIAL WATERING WILL BE PERFORMED BY SUBCONTRACTOR. BASIN WILL BE LEFT ON EACH PALM SO SUBSEQUENT WATERING CAN BE PERFORMED BY OTHERS. BASIN TO BE REMOVED DURING FINISH GRADING.
15. SUBCONTRACTOR TO UNTIE FROND TOPS (60) DAYS AFTER PLANTING.
16. PALM TREES SHALL BE PLANTED A MINIMUM OF 18" AWAY FROM BUILDING EAVES.
17. IT IS RECOMMENDED THAT ANY PALM TREE PLANTED WITHIN 5'-0" OF ANY WALKWAY, WALL, OR STRUCTURE BE PLANTED WITH DEEP ROOT BARRIER TO A DEPTH OF 2'-0" MINIMUM.
18. WASHINGTONIA ROBUSTA TRUNKS ARE TO HAVE A MINIMUM DIAMETER OF 14" MEASURED 4'-0" HIGH.
19. NO PALM TREE SHALL BE OUT OF THE ORIGINAL GROUND FOR MORE THAN (48) HOURS PRIOR TO PLANTING.

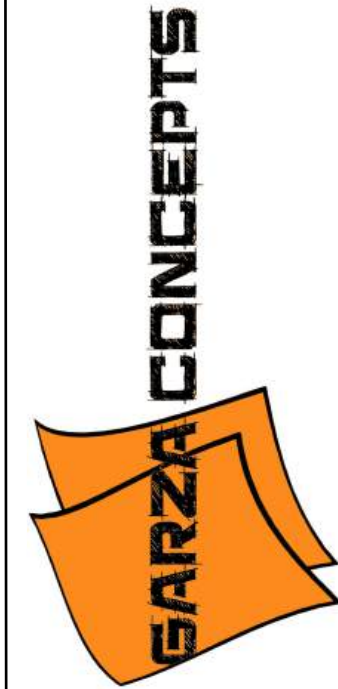
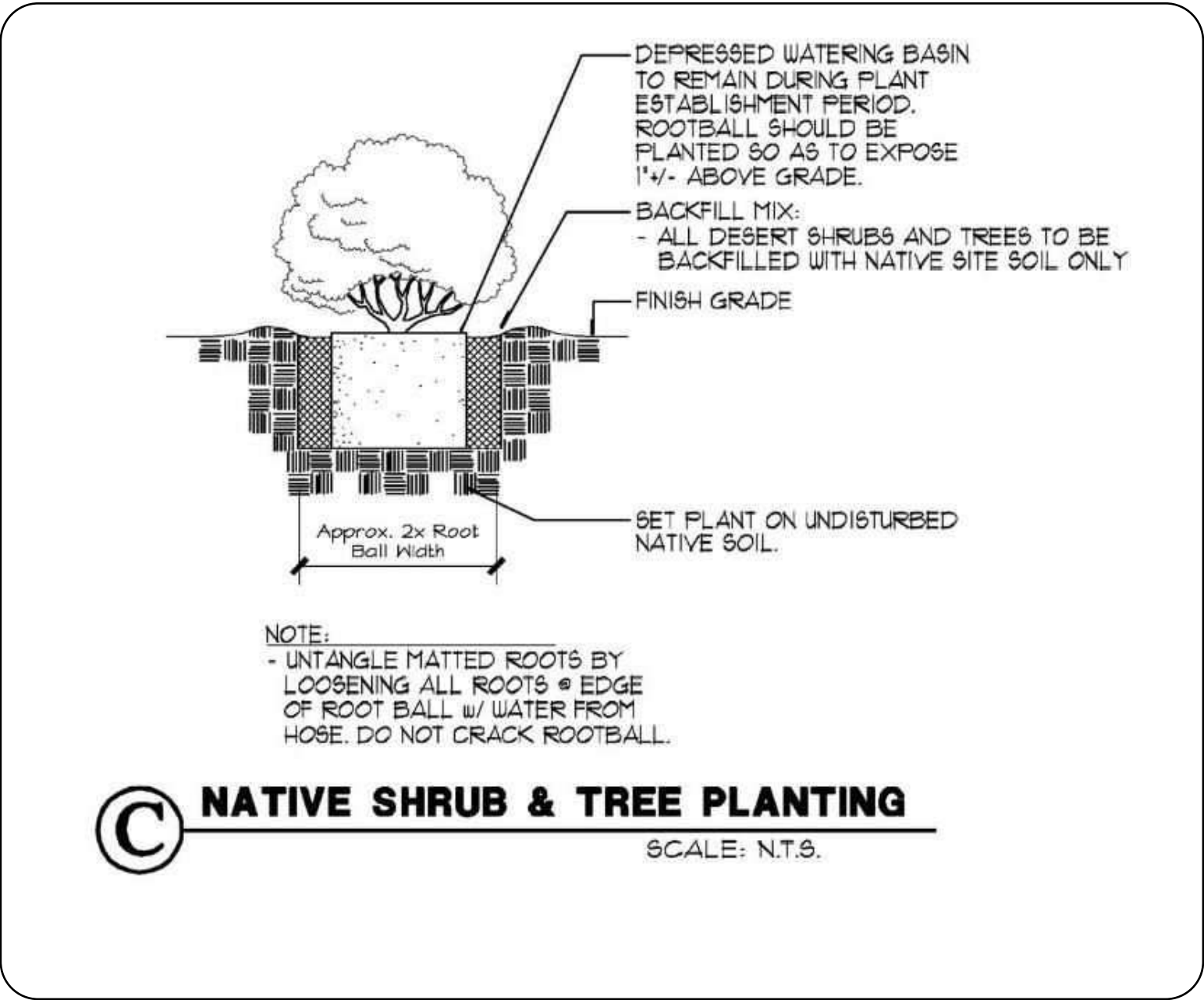
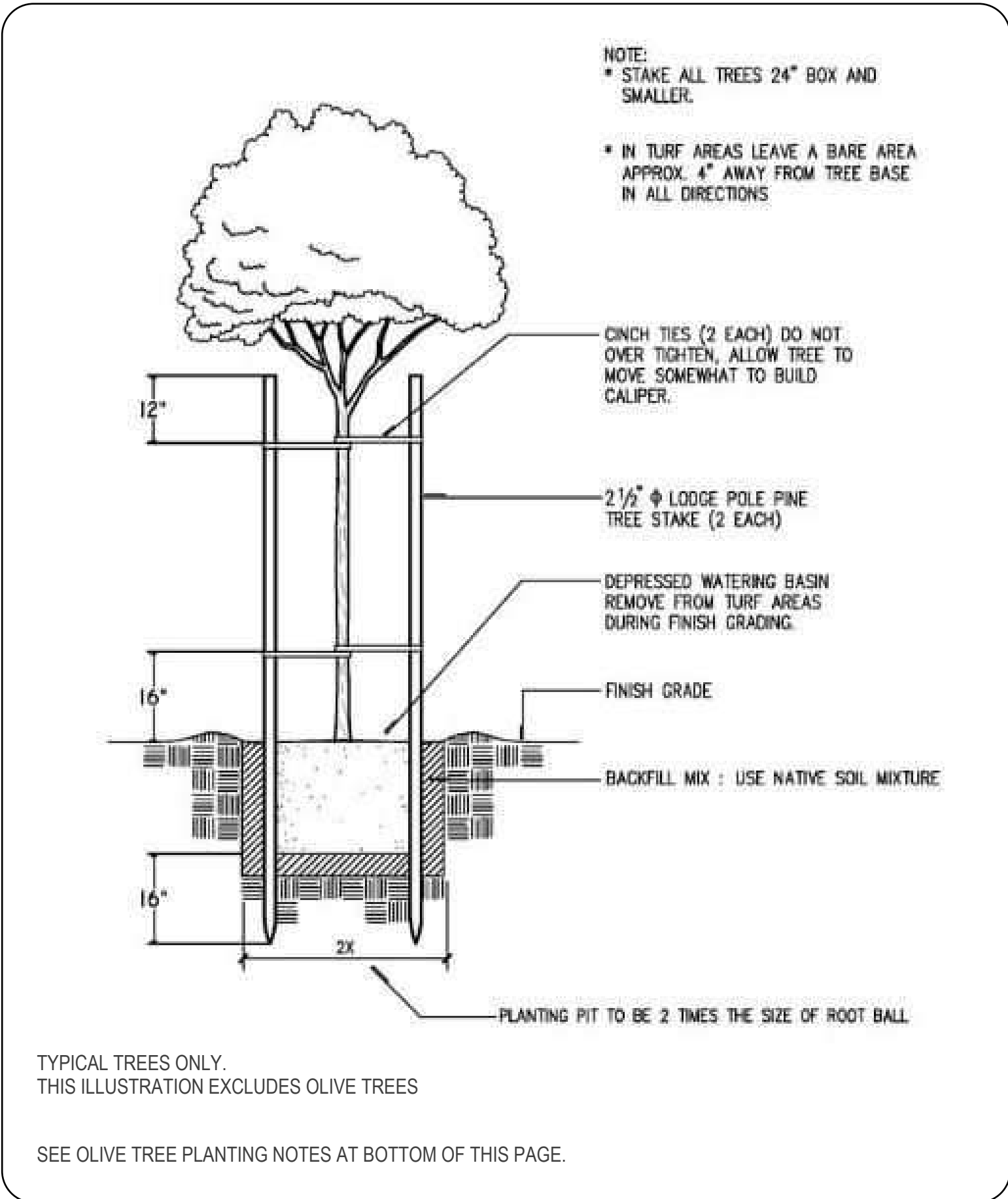



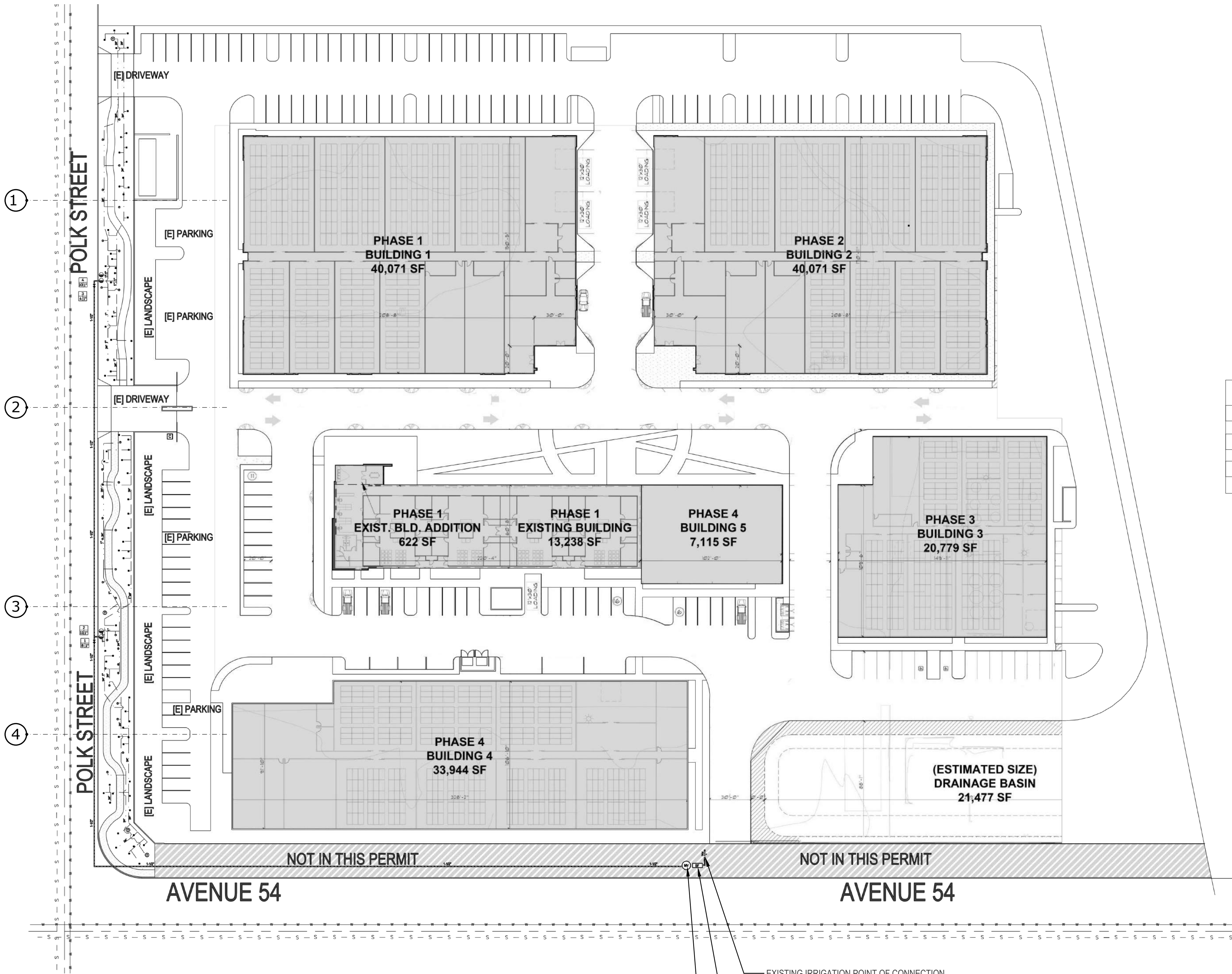

IRRIGATION LEGEND

SYMBOL	MANUFACTURER	MODEL NO.	DESCRIPTION
			EXISTING WATER METER
			POINT OF CONNECTION 1-1/2" DOMESTIC WATER METER INSTALLED BY CVWD. CONTRACTOR SHALL VERIFY POC LOCATION, SIZE, WATER PRESSURE, AND SHALL NOTIFY OWNER(S) AUTHORIZED REPRESENTATIVE OF ANY DISCREPANCIES PRIOR TO CONSTRUCTION. SET PRESSURE TO 70 PSI.
	FEBCO	825YA 1"	REDUCE BACKFLOW PREVENTER. PRIVATE CONTRACTOR TO INSTALL
	RAINBIRD	ESP-LX CONTROLLER	6 STATION MODULAR CONTROLLER. OUTDOOR MODEL. WEATHER BASED CONNTRROLLER
	RAINBIRD	XCZ-100-PRF	ELECTRIC CONTROL VALVE FOR DRIP AREAS AND TREES. SIZE AS NOTED ON PLAN, REFER TO DETAIL SHEET L4.1
	RAINBIRD	XB-10PC-1032	TREE DEEP ROOD BUBBLER - (2) .50 GPH EMITTERS IN PURFORATED PIPE. SEE DETAIL "G" ON PAGE L4.0
	RAINBIRD RAINBIRD	XB-10PC-1032	SERI-BUG EMITTER - .20/.50 GPH - 30 PSI - DRIP
	NIBCO	T-113	FULL PORT VALVE (LINE SIZE). REFER TO IRRIGAITON DETAIL SHEET L4.1

PIPE SIZING CHART

PIPE SIZE	MAX. ALLOWABLE FLOW
1/2"	5 GPM
3/4"	10 GPM
1"	16 GPM
1-1/4"	26 GPM
1-1/2"	40 GPM
2"	60 GPM

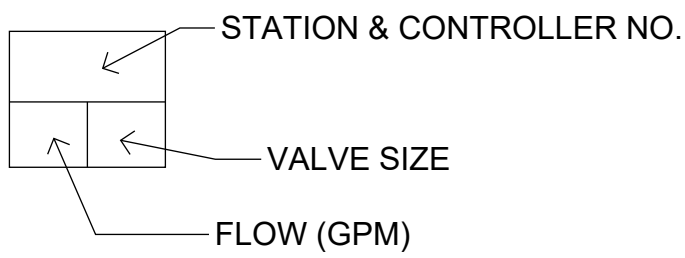

**UTILITY NOTES**  
VERIFY CONNETION POINTS FOR POWER TELEPHONE AND CATV SYSTEMS PRIOR TO CONSTRUCTION APPROXIMATE ONLY LOCATIONS INDICATED FOR TRANSFORMER LOCATIONS, ETC.  
  
COMPLY WITH ALL UTILITY COMPANY REQUIREMENTS, PROVIDE ALL RELATED CONDUITS, PULL BOXES AND REISERS.



48 HOURS BEFORE YOU DIG  
**CALL**

UNDERGROUND SESERVICE ALERT  
1-800-277-2600

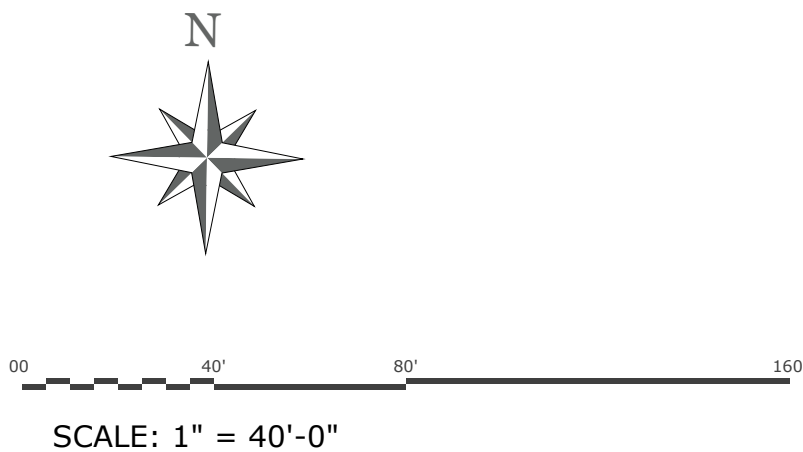



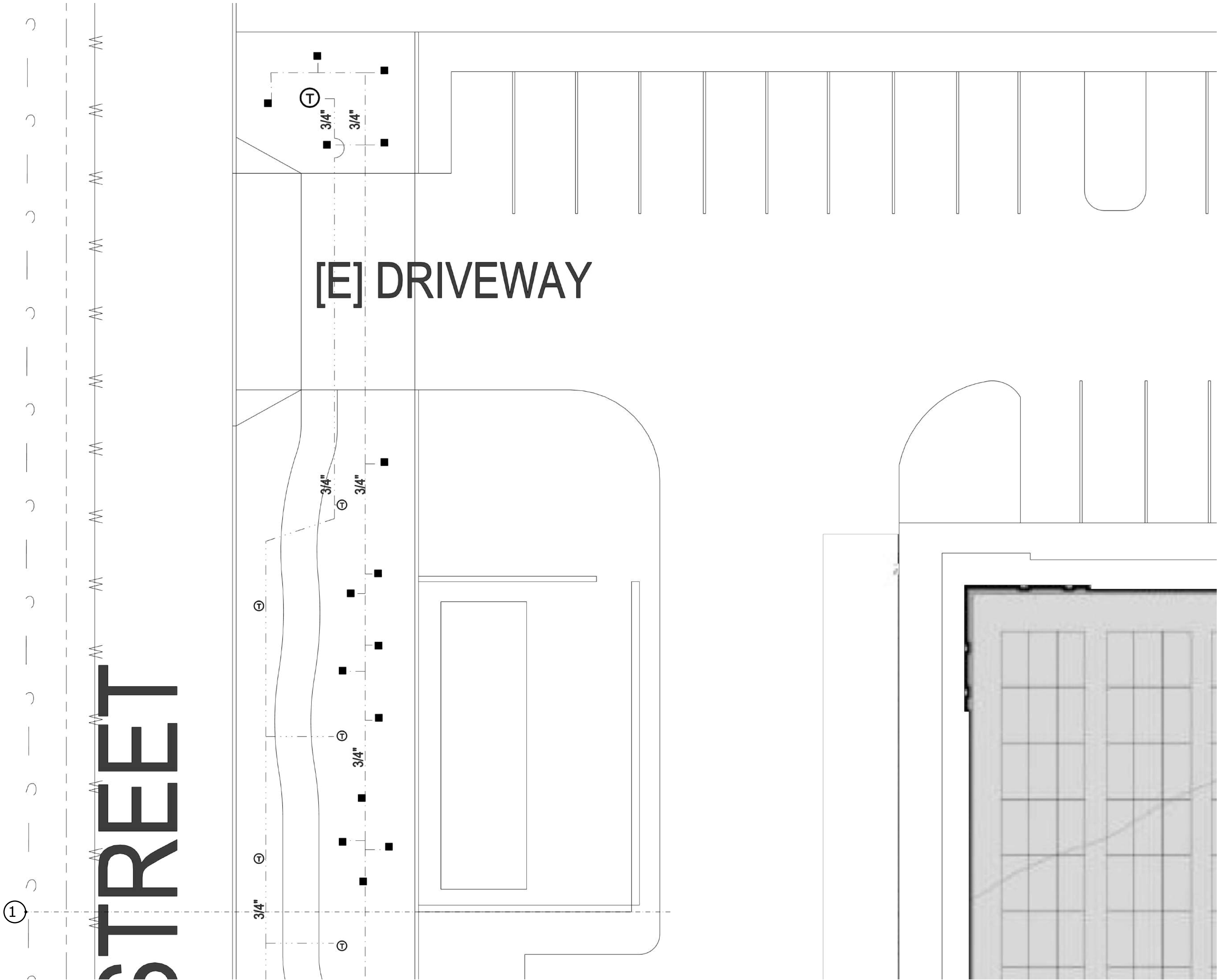

IRRIGATION LEGEND

SYMBOL	MANUFACTURER	MODEL NO.	DESCRIPTION
			EXISTING WATER METER
			POINT OF CONNECTION 1-1/2" DOMESTIC WATER METER INSTALLED BY CVWD. CONTRACTOR SHALL VERIFY POC LOCATION, SIZE, WATER PRESSURE, AND SHALL NOTIFY OWNER(S) AUTHORIZED REPRESENTATIVE OF ANY DISCREPANCIES PRIOR TO CONSTRUCTION. SET PRESSURE TO 70 PSI.
	FEBCO	825YA 1"	REDUCE BACKFLOW PREVENTER. PRIVATE CONTRACTOR TO INSTALL
	RAINBIRD	ESP-LX CONTROLLER	6 STATION MODULAR CONTROLLER. OUTDOOR MODEL. WEATHER BASED CONNTROLLER
	RAINBIRD	XCZ-100-PRF	ELECTRIC CONTROL VALVE FOR DRIP AREAS AND TREES. SIZE AS NOTED ON PLAN, REFER TO DETAIL SHEET L4.1
	RAINBIRD	XB-10PC-1032	TREE DEEP ROOD BUBBLER - (2) .50 GPH EMITTERS IN PURFORATED PIPE. SEE DETAIL "G" ON PAGE L4.0
	RAINBIRD RAINBIRD	XB-10PC-1032	SERI-BUG EMITTER - .20/.50 GPH - 30 PSI - DRIP
	NIBCO	T-113	FULL PORT VALVE (LINE SIZE). REFER TO IRRIGAITON DETAIL SHEET L4.1

PIPE SIZING CHART

PIPE SIZE	MAX. ALLOWABLE FLOW
1/2"	5 GPM
3/4"	10 GPM
1"	16 GPM
1-1/4"	26 GPM
1-1/2"	40 GPM
2"	60 GPM

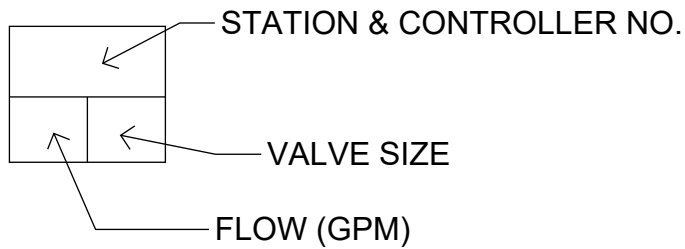

UTILITY NOTES

VERIFY CONNETION POINTS FOR POWER TELEPHONE AND CATV SYSTEMS PRIOR TO CONSTRUCTION APPROXIMATE ONLY LOCATIONS INDICATED FOR TRANSFORMER LOCATIONS, ETC.

COMPLY WITH ALL UTILITY COMPANY REQUIREMENTS, PROVIDE ALL RELATED CONDUITS, PULL BOXES AND REISERS.



48 HOURS BEFORE YOU DIG  
CALL

UNDERGROUND SESERVICE ALERT  
1-800-277-2600

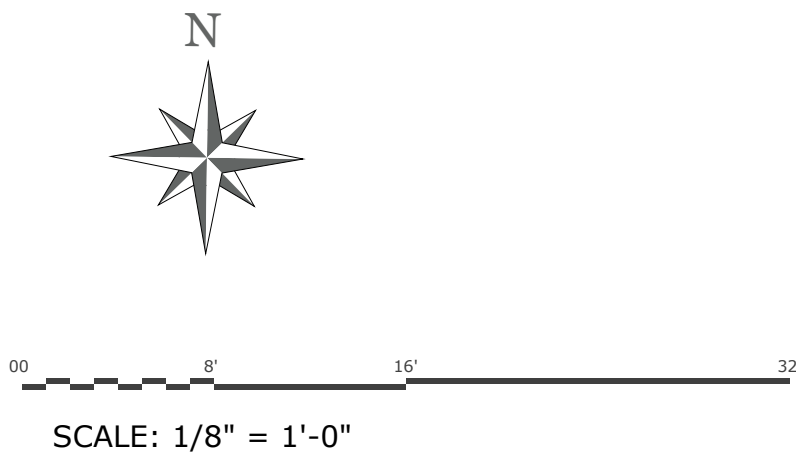







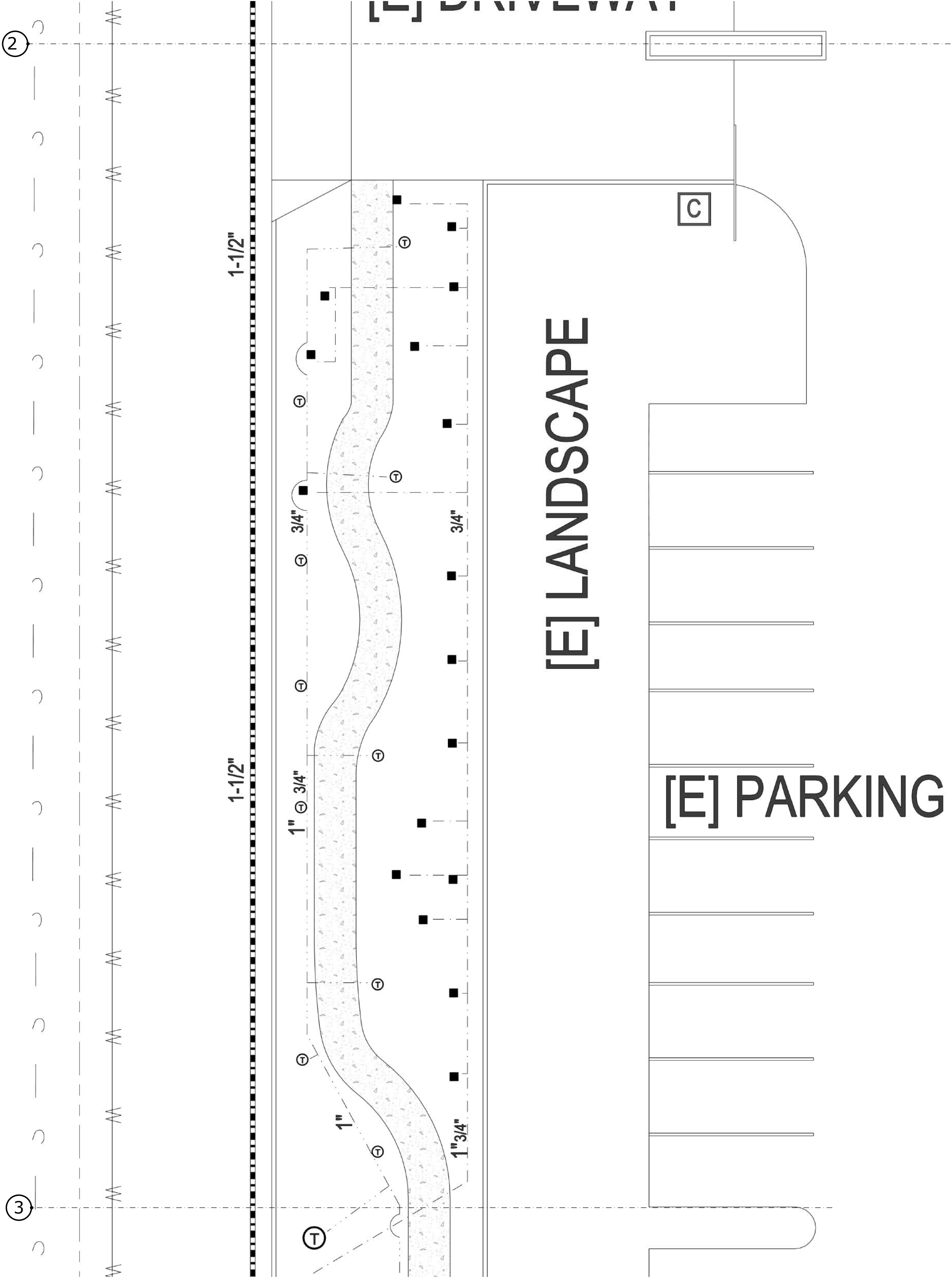

**UTILITY NOTES**  
VERIFY CONNETION POINTS FOR POWER TELEPHONE AND CATV SYSTEMS  
PRIOR TO CONSTRUCTION APPROXIMATE ONLY LOCATIONS INDICATED FOR  
TRANSFORMER LOCATIONS, ETC.  
COMPLY WITH ALL UTILITY COMPANY REQUIREMENTS, PROVIDE ALL  
RELATED CONDUITS, PULL BOXES AND REISERS.



48 HOURS BEFORE YOU DIG  
**CALL**

UNDERGROUND SESERVICE ALERT  
1-800-277-2600

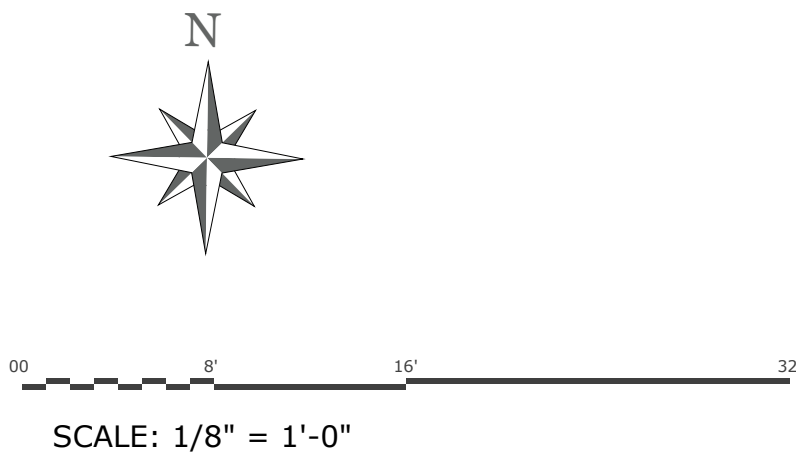

#### IRRIGATION LEGEND

SYMBOL	MANUFACTURER	MODEL NO.	DESCRIPTION
			EXISTING WATER METER
			POINT OF CONNECTION 1-1/2" DOMESTIC WATER METER INSTALLED BY CVWD. CONTRACTOR SHALL VERIFY POC LOCATION, SIZE, WATER PRESSURE, AND SHALL NOTIFY OWNER(S) AUTHORIZED REPRESENTATIVE OF ANY DISCREPANCIES PRIOR TO CONSTRUCTION. SET PRESSURE TO 70 PSI.
	FEBCO	825YA 1"	REDUCE BACKFLOW PREVENTER PRIVATE CONTRACTOR TO INSTALL
	RAINBIRD	ESP-LX CONTROLLER	6 STATION MODULAR CONTROLLER. OUTDOOR MODEL. WEATHER BASED CONNTROLLER
	RAINBIRD	XCZ-100-PRF	ELECTRIC CONTROL VALVE FOR DRIP AREAS AND TREES. SIZE AS NOTED ON PLAN, REFER TO DETAIL SHEET L4.1
	RAINBIRD	XB-10PC-1032	TREE DEEP ROOD BUBBLER - (2) .50 GPH EMITTERS IN PURFORATED PIPE. SEE DETAIL "G" ON PAGE L4.0
	RAINBIRD RAINBIRD	XB-10PC-1032	SERI-BUG EMITTER - .20/.50 GPH - 30 PSI - DRIP
	NIBCO	T-113	FULL PORT VALVE (LINE SIZE). REFER TO IRRIGAITON DETAIL SHEET L4.1

#### PIPE SIZING CHART

PIPE SIZE	MAX. ALLOWABLE FLOW
1/2"	5 GPM
3/4"	10 GPM
1"	16 GPM
1-1/4"	26 GPM
1-1/2"	40 GPM
2"	60 GPM

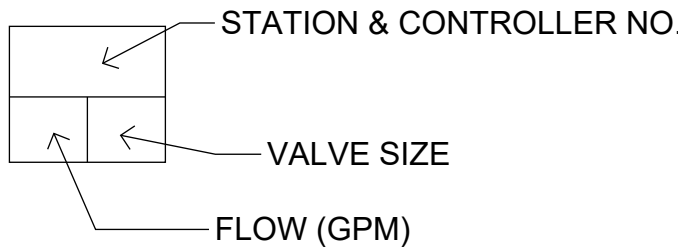



POLK STREET

[E] LANDSCAPE

[E] PARKING

[E] LANDSCAPE

UTILITY NOTES  
VERIFY CONNETION POINTS FOR POWER TELEPHONE AND CATV SYSTEMS  
PRIOR TO CONSTRUCTION APPROXIMATE ONLY LOCATIONS INDICATED FOR  
TRANSFORMER LOCATIONS, ETC.  
COMPLY WITH ALL UTILITY COMPANY REQUIREMENTS, PROVIDE ALL  
RELATED CONDUITS, PULL BOXES AND REISERS.



48 HOURS BEFORE YOU DIG  
CALL

UNDERGROUND SESERVICE ALERT  
1-800-277-2600

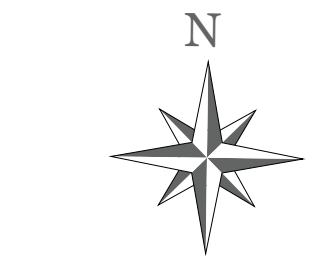

00 8' 16' 32'  
SCALE: 1/8" = 1'-0"

IRRIGATION LEGEND

SYMBOL	MANUFACTURER	MODEL NO.	DESCRIPTION
			EXISTING WATER METER
			POINT OF CONNECTION 1-1/2" DOMESTIC WATER METER INSTALLED BY CVWD. CONTRACTOR SHALL VERIFY POC LOCATION, SIZE, WATER PRESSURE, AND SHALL NOTIFY OWNER(S) AUTHORIZED REPRESENTATIVE OF ANY DISCREPANCIES PRIOR TO CONSTRUCTION. SET PRESSURE TO 70 PSI.
	FEBCO	825YA 1"	REDUCE BACKFLOW PREVENTER PRIVATE CONTRACTOR TO INSTALL
	RAINBIRD	ESP-LX CONTROLLER	6 STATION MODULAR CONTROLLER. OUTDOOR MODEL. WEATHER BASED CONNTROLLER
	RAINBIRD	XCZ-100-PRF	ELECTRIC CONTROL VALVE FOR DRIP AREAS AND TREES. SIZE AS NOTED ON PLAN, REFER TO DETAIL SHEET L4.1
	RAINBIRD	XB-10PC-1032	TREE DEEP ROOD BUBBLER - (2) .50 GPH EMITTERS IN PURFORATED PIPE. SEE DETAIL "G" ON PAGE L4.0
	RAINBIRD RAINBIRD	XB-10PC-1032	SERI-BUG EMITTER - .20/.50 GPH - 30 PSI - DRIP
	NIBCO	T-113	FULL PORT VALVE (LINE SIZE). REFER TO IRRIGAITON DETAIL SHEET L4.1

PIPE SIZING CHART

PIPE SIZE	MAX. ALLOWABLE FLOW
1/2"	5 GPM
3/4"	10 GPM
1"	16 GPM
1-1/4"	26 GPM
1-1/2"	40 GPM
2"	60 GPM

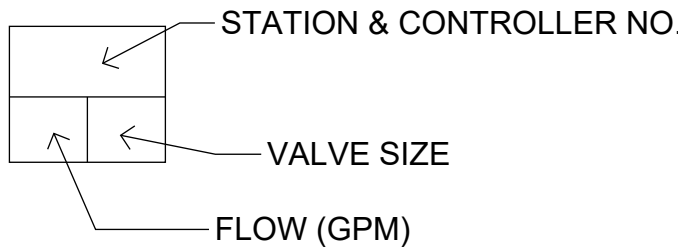

GARZA CONCEPTS  
JOSE GARZA LANDSCAPE CONTRACTOR AND DRAFTING :  
P.O. Box 5891 La Quinta, CA. 92248  
jose@garzaconcepts.com www.garzaconcepts.com  
Lic # 1050039

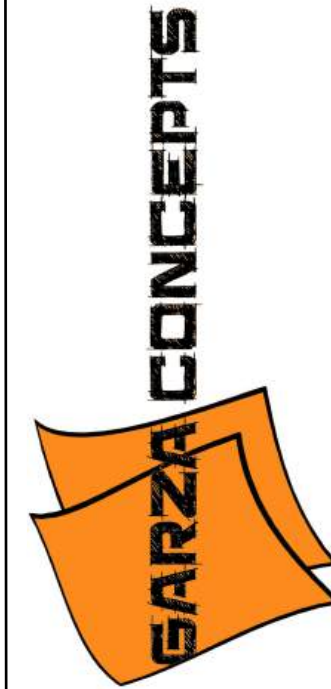

PROJECT  
STREETSCAPE RENOVATION  
53800 POLK ST  
COACHELLA CA. 92236

IRRIGATION PLAN

Date Created  
04/16/25  
REVISED

- 1
- 2
- 3
- 4
- 5

L13



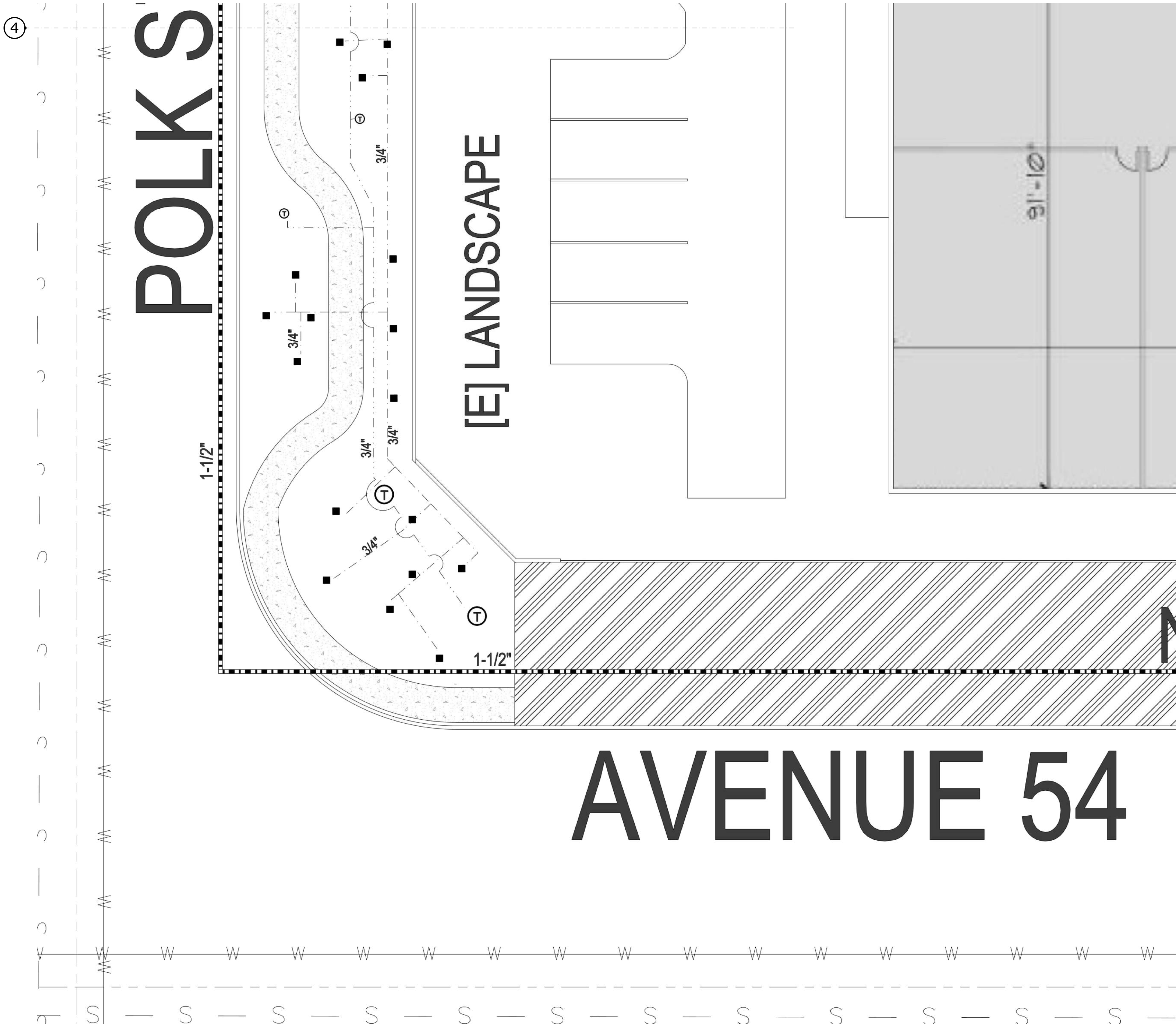

#### IRRIGATION LEGEND

SYMBOL	MANUFACTURER	MODEL NO.	DESCRIPTION
			EXISTING WATER METER
			POINT OF CONNECTION 1-1/2" DOMESTIC WATER METER INSTALLED BY CVWD. CONTRACTOR SHALL VERIFY POC LOCATION, SIZE, WATER PRESSURE, AND SHALL NOTIFY OWNER(S) AUTHORIZED REPRESENTATIVE OF ANY DISCREPANCIES PRIOR TO CONSTRUCTION. SET PRESSURE TO 70 PSI.
	FEBCO	825YA 1"	REDUCE BACKFLOW PREVENTER. PRIVATE CONTRACTOR TO INSTALL.
	RAINBIRD	ESP-LX CONTROLLER	6 STATION MODULAR CONTROLLER. OUTDOOR MODEL. WEATHER BASED CONNTROLLER
	RAINBIRD	XCZ-100-PRF	ELECTRIC CONTROL VALVE FOR DRIP AREAS AND TREES. SIZE AS NOTED ON PLAN, REFER TO DETAIL SHEET L4.1
	RAINBIRD	XB-10PC-1032	TREE DEEP ROOD BUBBLER - (2) .50 GPH EMITTERS IN PURFORATED PIPE. SEE DETAIL "G" ON PAGE L4.0
	RAINBIRD RAINBIRD	XB-10PC-1032	SERI-BUG EMITTER - .20/.50 GPH - 30 PSI - DRIP
	NIBCO	T-113	FULL PORT VALVE (LINE SIZE). REFER TO IRRIGAITON DETAIL SHEET L4.1

#### PIPE SIZING CHART

PIPE SIZE	MAX. ALLOWABLE FLOW
1/2"	5 GPM
3/4"	10 GPM
1"	16 GPM
1-1/4"	26 GPM
1-1/2"	40 GPM
2"	60 GPM

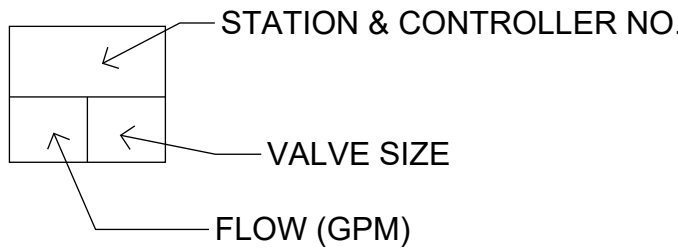

#### UTILITY NOTES

VERIFY CONNETION POINTS FOR POWER TELEPHONE AND CATV SYSTEMS PRIOR TO CONSTRUCTION APPROXIMATE ONLY LOCATIONS INDICATED FOR TRANSFORMER LOCATIONS, ETC.

COMPLY WITH ALL UTILITY COMPANY REQUIREMENTS, PROVIDE ALL RELATED CONDUITS, PULL BOXES AND REISERS.



48 HOURS BEFORE YOU DIG  
CALL

UNDERGROUND SESERVICE ALERT  
1-800-277-2600

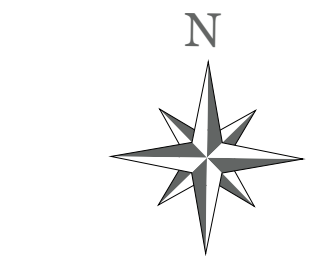

SCALE: 1/8" = 1'-0"

**GARZA CONCEPTS**  
JOSE GARZA LANDSCAPE CONTRACTOR AND DRAFTING :  
P.O. Box 5891 La Quinta, CA. 92248  
jose@garzaconcepts.com www.garzaconcepts.com  
Lic # 1050039

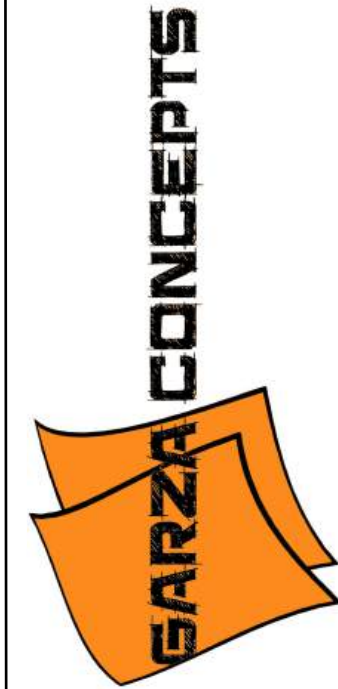

**PROJECT**  
STREETSCAPE RENOVATION  
53800 POLK ST  
COACHELLA CA. 92236

IRRIGATION PLAN

**Date Created**  
04/16/25  
**REVISED**

- 1
- 2
- 3
- 4
- 5

L14



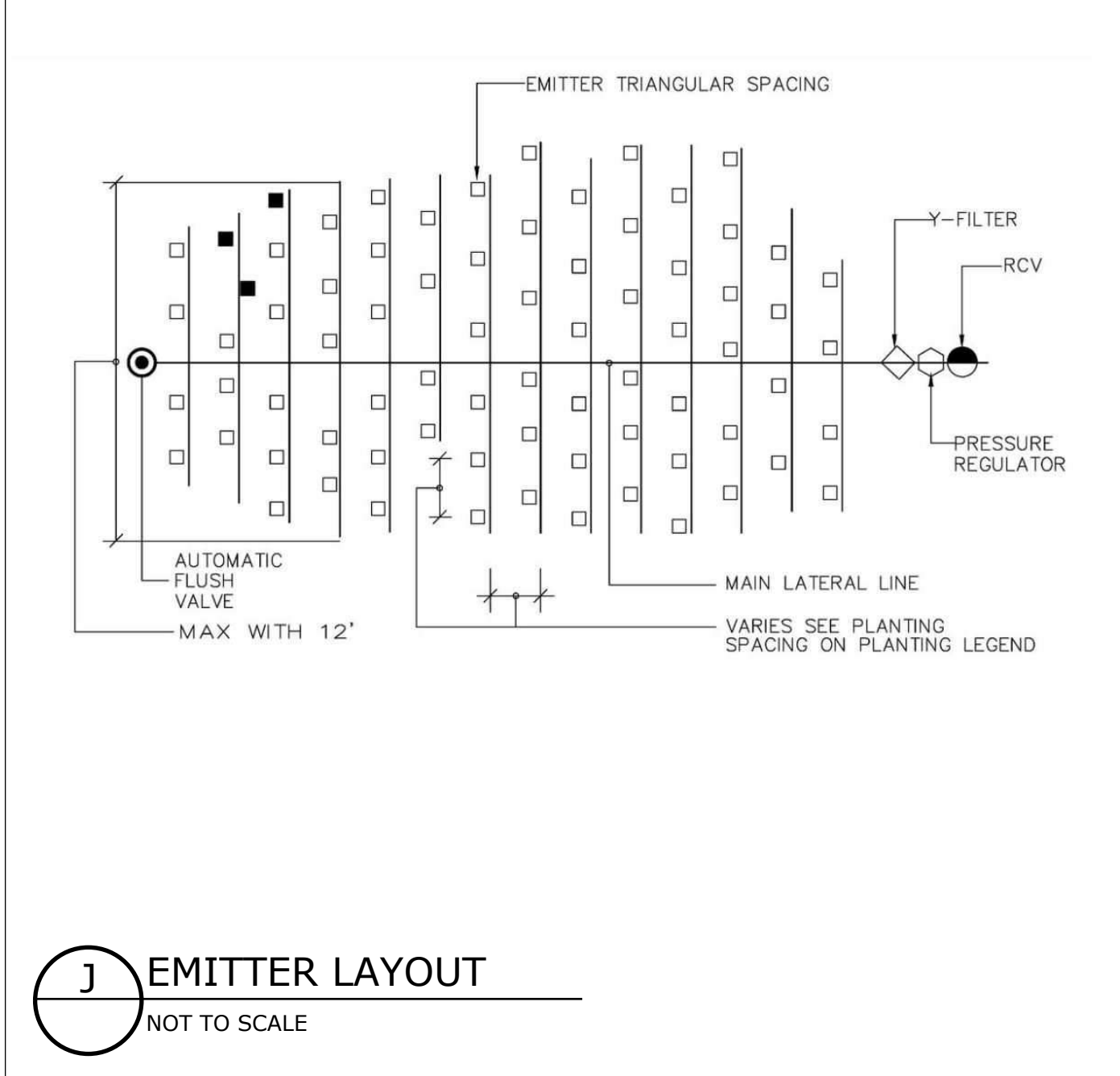
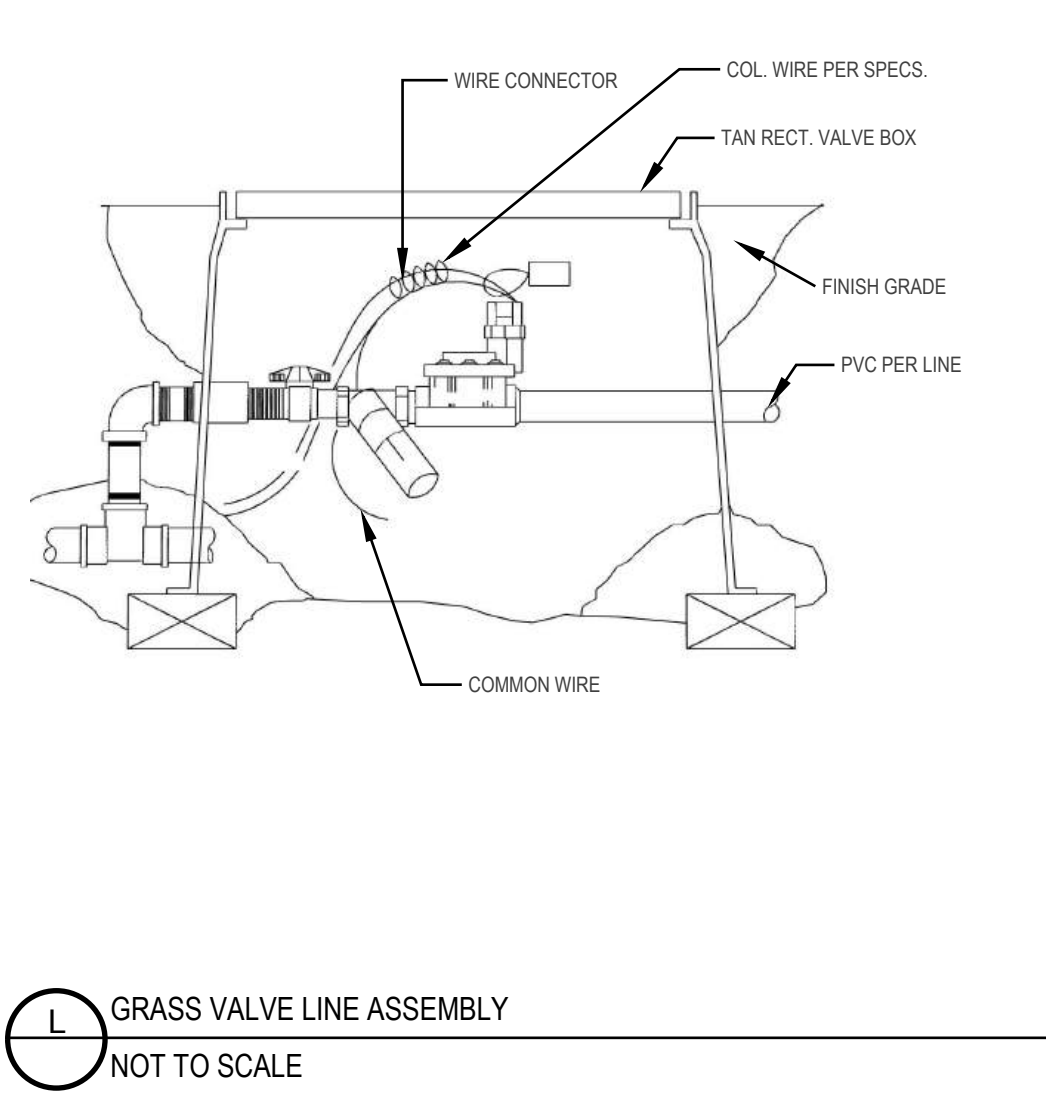
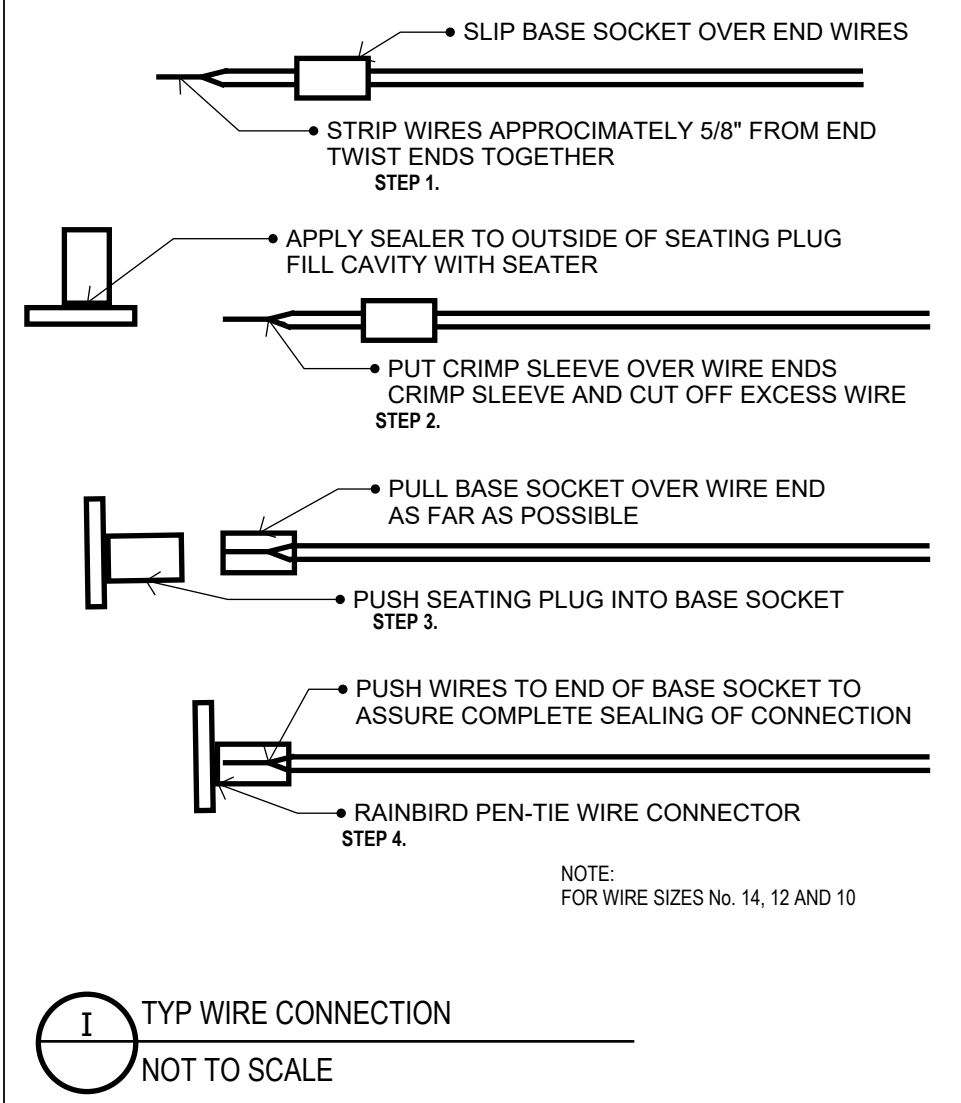
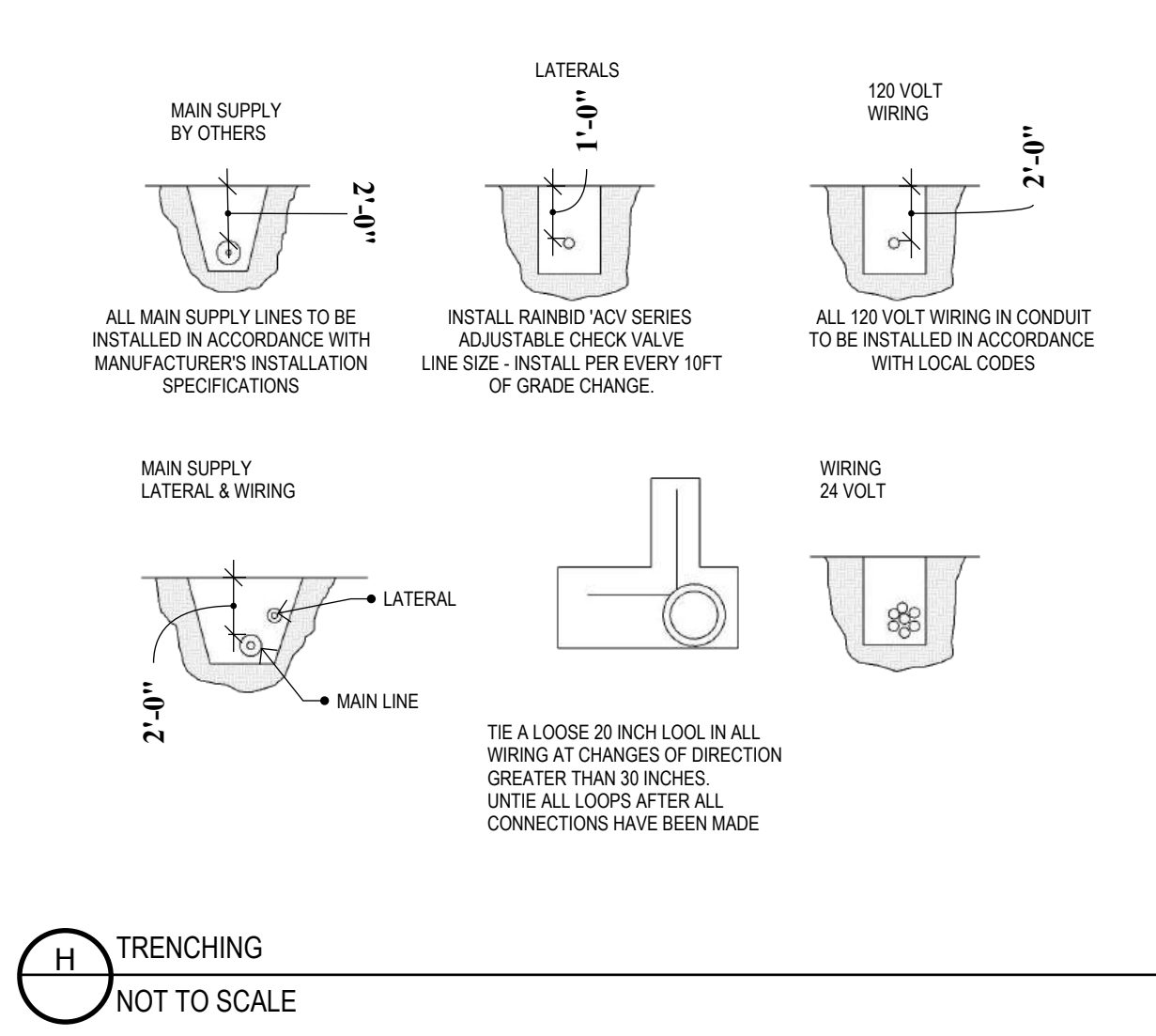
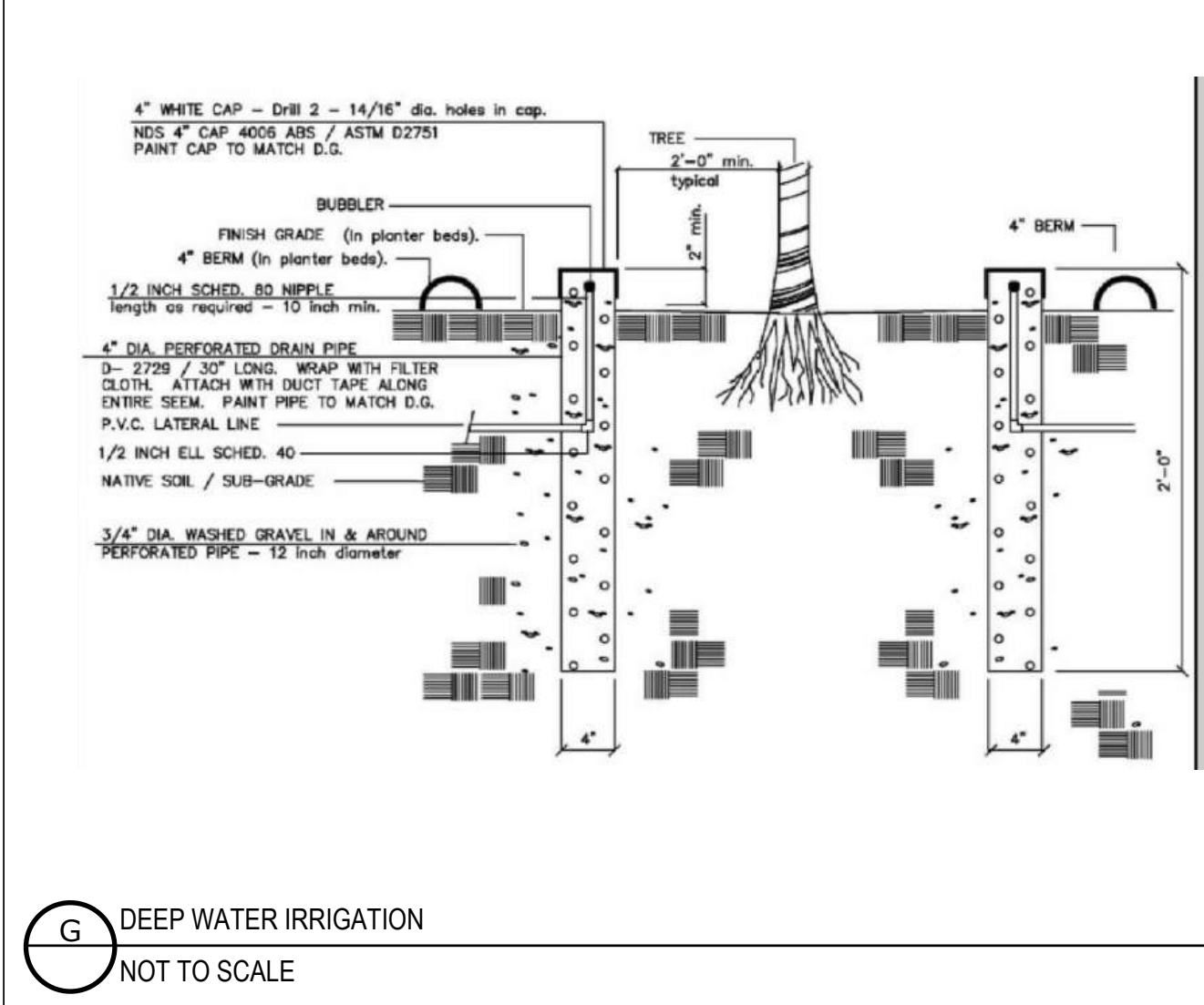
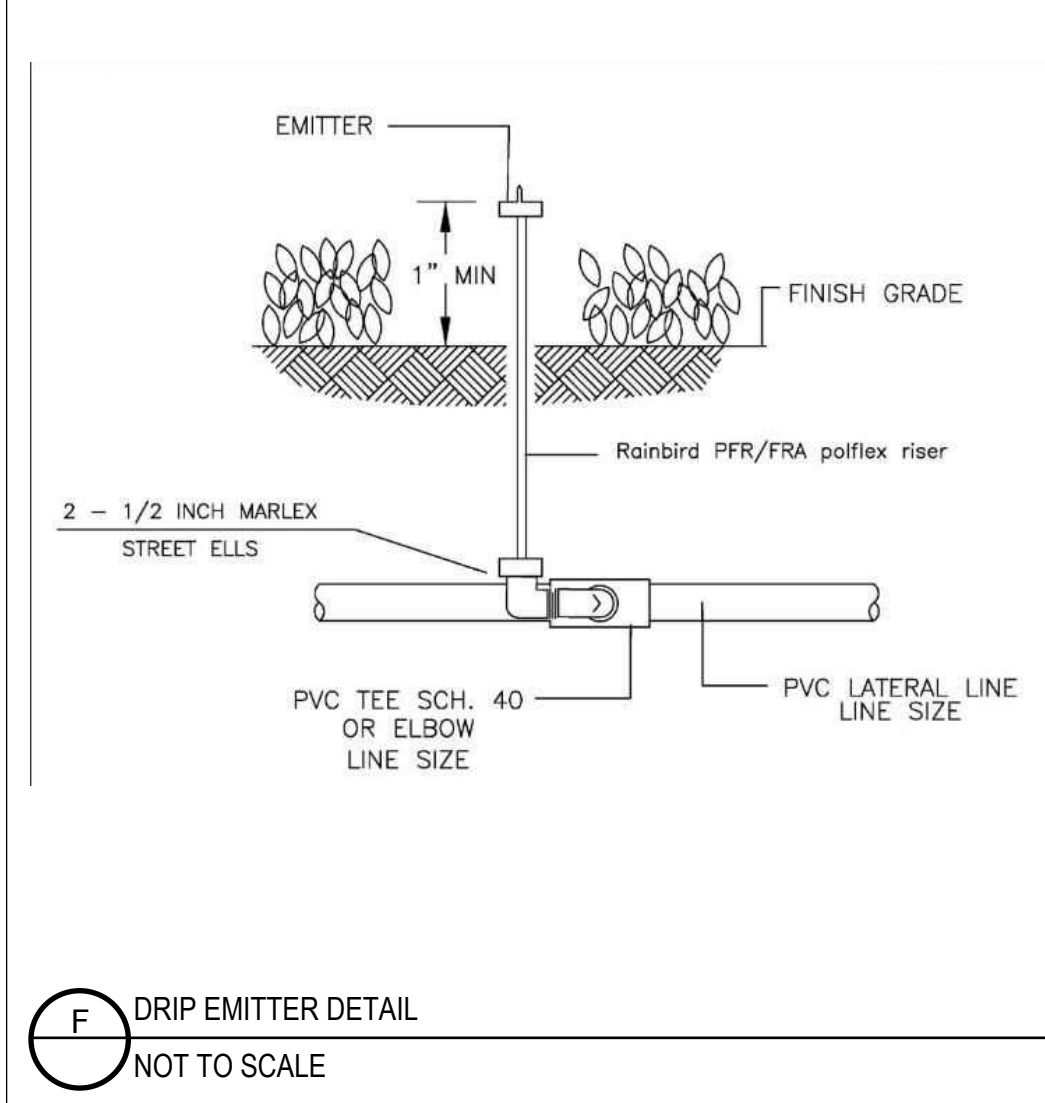
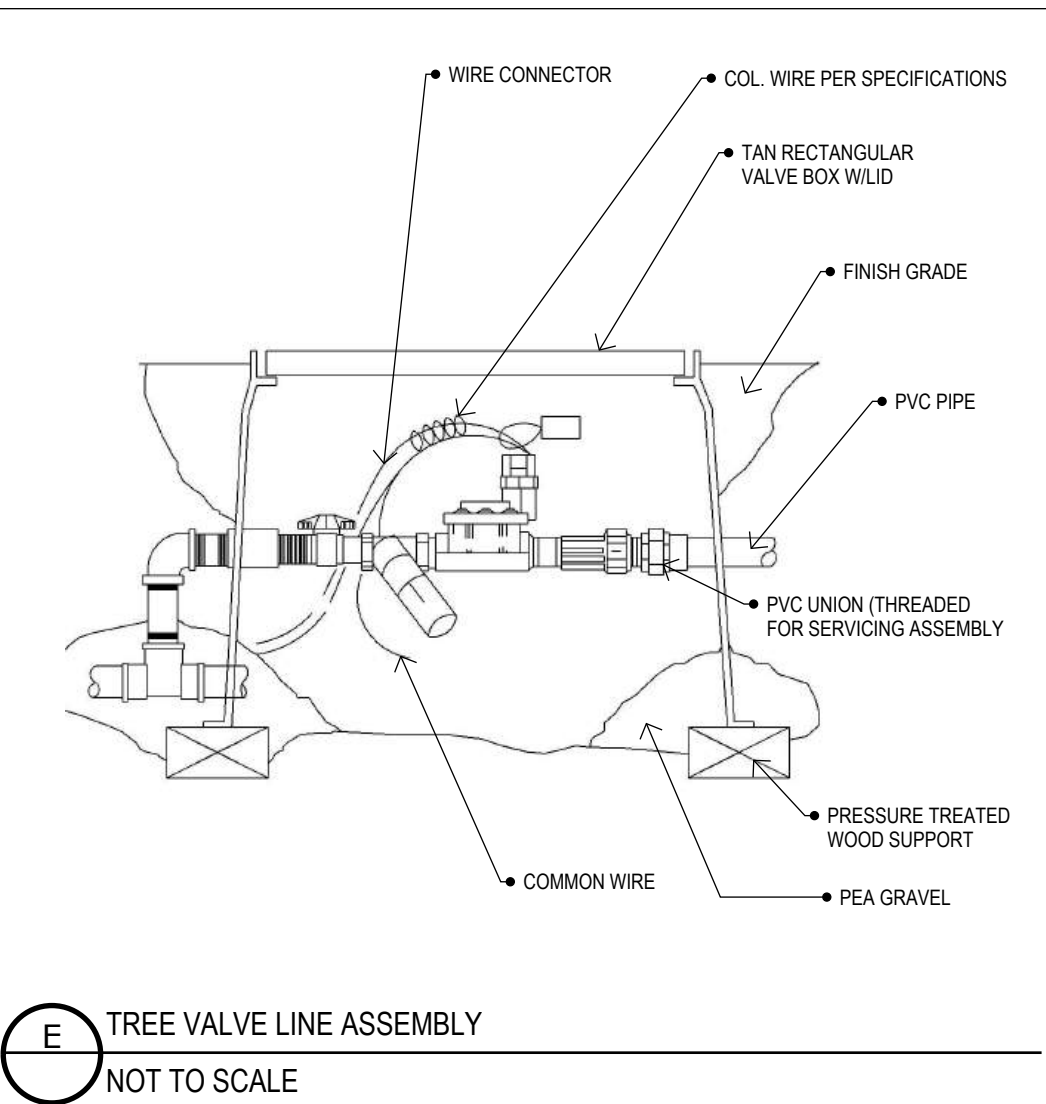
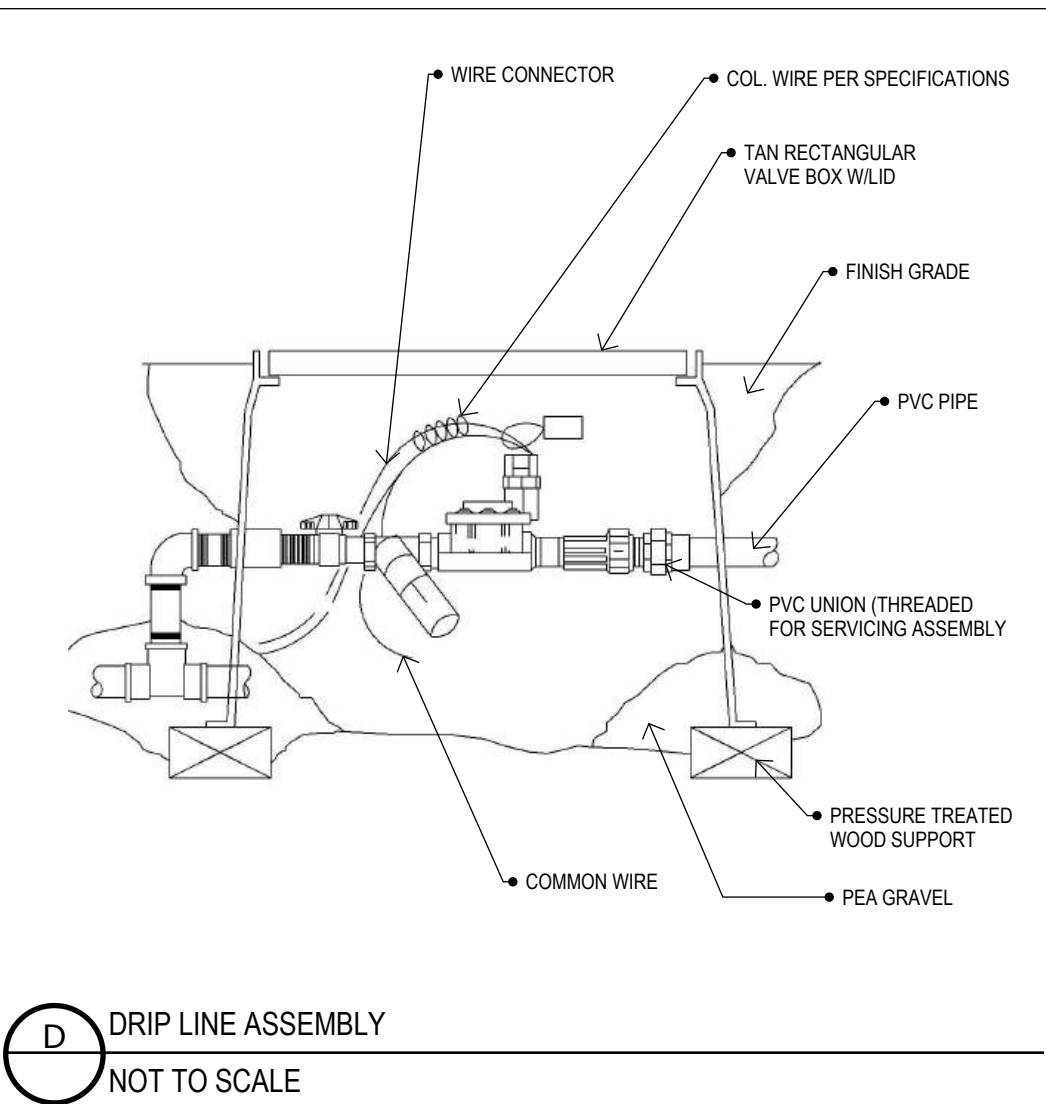
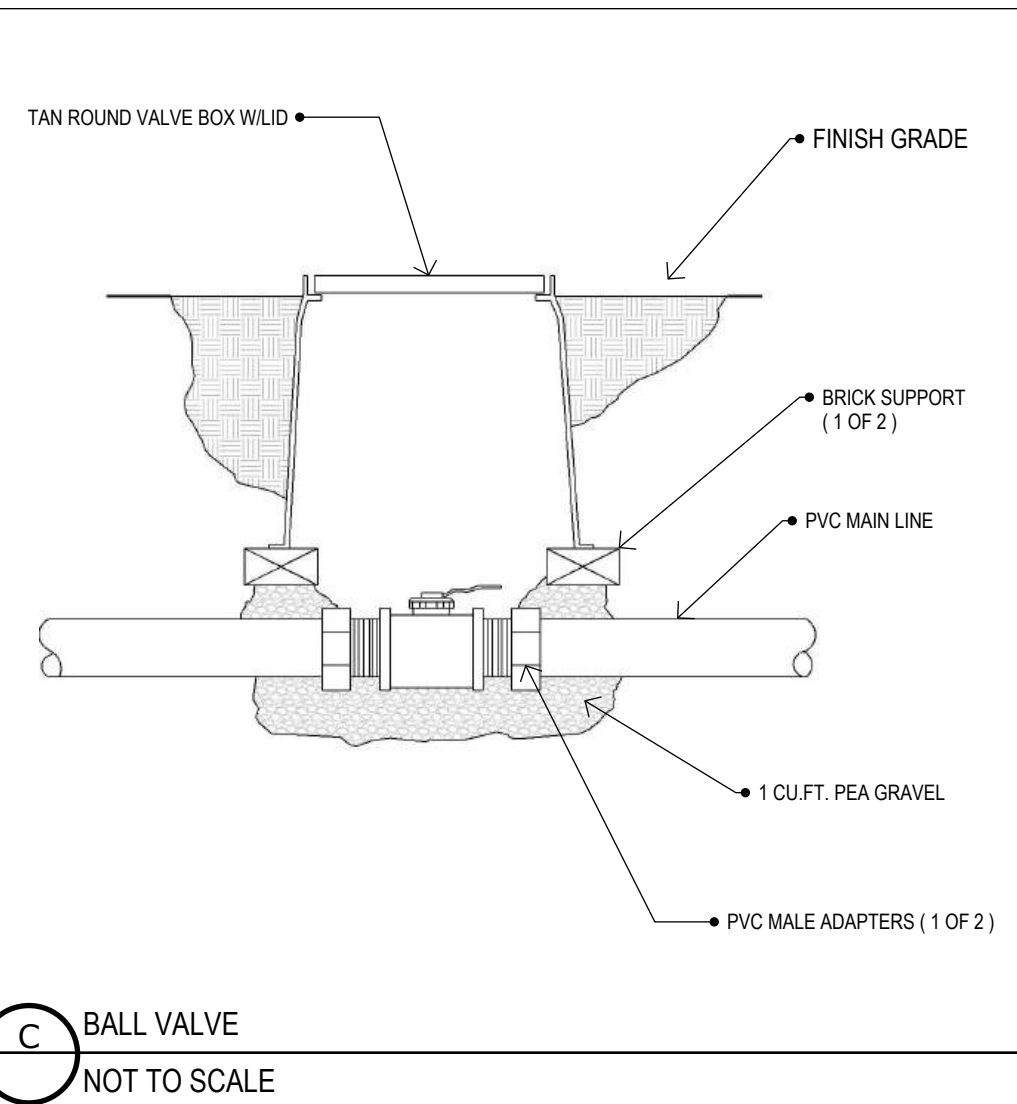
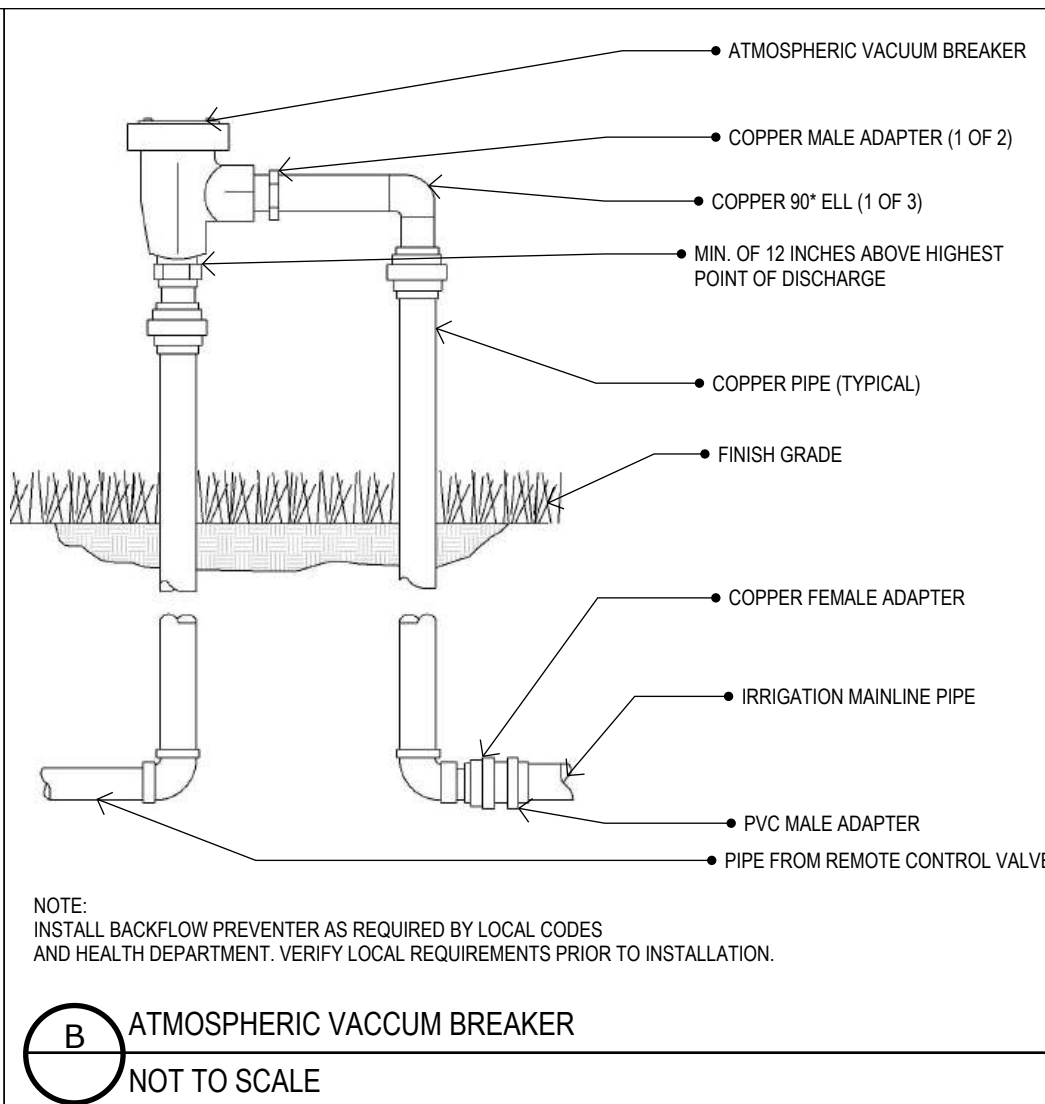
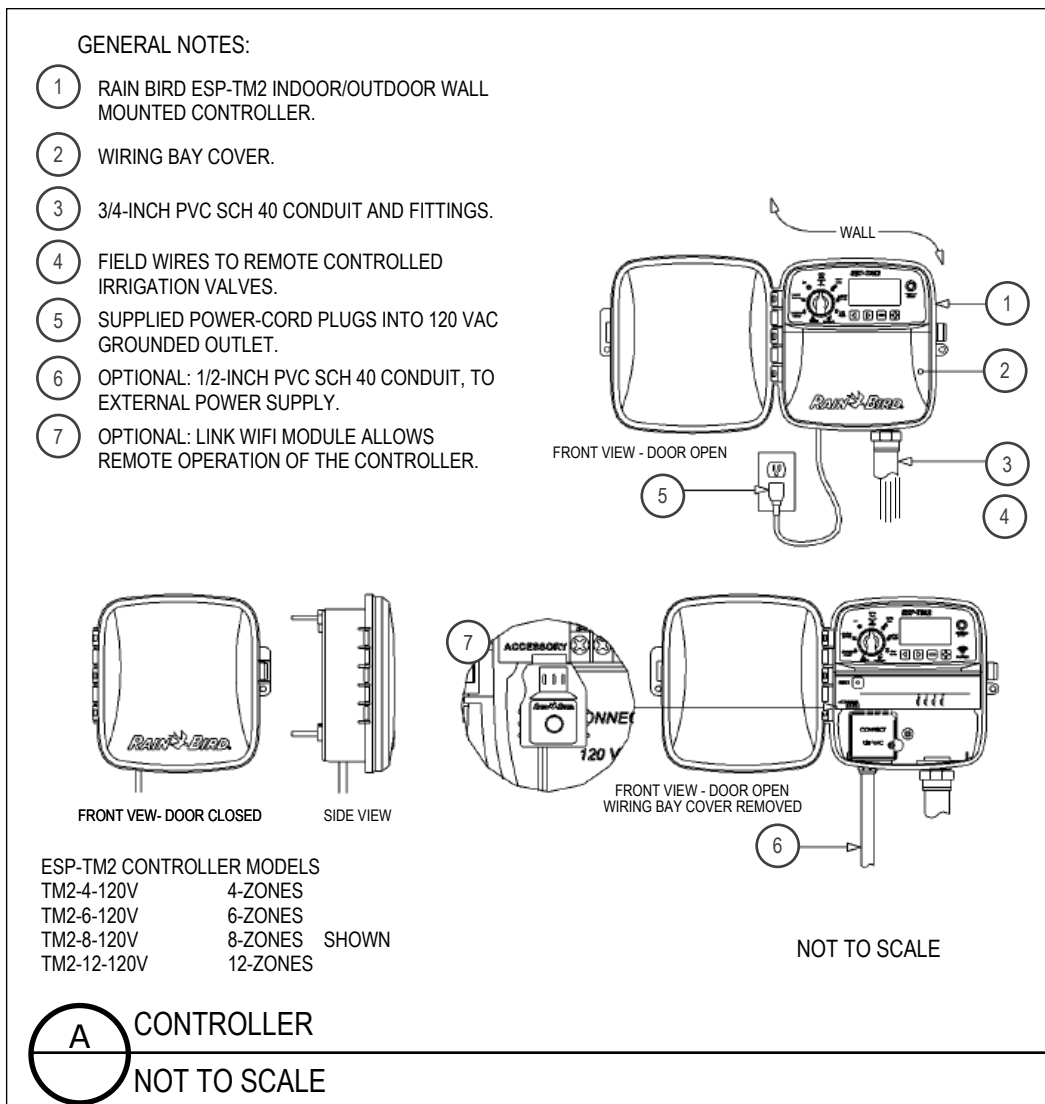

**UTILITY NOTES**

VERIFY CONNETION POINTS FOR POWER TELEPHONE AND CATV SYSTEMS PRIOR TO CONSTRUCTION APROXIMATE ONLY LOCATIONS INDICATED FOR TRANSFORMER LOCATIONS, ETC.

COMPLY WITH ALL UTILITY COMPANY REQUIREMENTS, PROVIDE ALL RELATED CONDUITS, PULL BOXES AND REISERS.

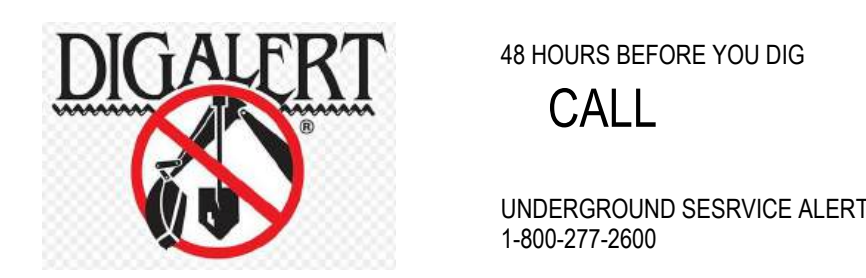

- GENERAL IRRIGATION NOTES**
1. THE SPRINKLER SYSTEM DESIGN IS BASED ON THE MINIMUM OPERATING PRESSURE AND THE MAXIMUM FLOW DEMAND SHOWN ON THE IRRIGATION DRAWINGS AT THE METER OR POINT OF CONNECTION. THE IRRIGATION CONTRACTOR SHALL VERIFY WATER PRESSURE PRIOR TO CONSTRUCTION. REPORT ANY DIFFERENCE BETWEEN THE WATER PRESSURE INDICATED ON THE DRAWINGS AND THE ACTUAL PRESSURE READING AT THE IRRIGATION POINT OF CONNECTION TO THE OWNER'S AUTHORIZED REPRESENTATIVE. IN THE EVENT PRESSURE DIFFERENCES ARE NOT REPORTED PRIOR TO START OF CONSTRUCTION, THE IRRIGATION CONTRACTOR SHALL ASSUME FULL RESPONSIBILITY FOR ANY REVISIONS NECESSARY.
  2. 120 VOLT ELECTRICAL POWER OUTLET AT THE AUTOMATIC CONTROLLER LOCATION SHALL BE PROVIDED BY OTHERS. IT SHALL BE THE RESPONSIBILITY OF THE IRRIGATION CONTRACTOR TO MAKE THE FINAL HOOK-UP FROM THE ELECTRICAL OUTLET TO THE AUTOMATIC CONTROLLER.
  3. THIS DESIGN IS DIAGRAMMATIC. ALL PIPING, VALVES, ETC. SHOWN WITHIN PAVED AREAS IS FOR DESIGN CLARIFICATION ONLY AND SHALL BE INSTALLED IN PLANTING AREAS. AVOID ANY CONFLICTS BETWEEN THE SPRINKLER SYSTEM, PLANTING AND ARCHITECTURAL FEATURES.
  4. DO NOT WILLFULLY INSTALL THE SPRINKLER SYSTEM AS SHOWN ON THE DRAWINGS WHEN IT IS OBVIOUS IN THE FIELD THAT OBSTRUCTIONS, GRADE DIFFERENCES OR DIFFERENCES IN THE AREA DIMENSIONS EXIST THAT MIGHT NOT HAVE BEEN COSIDERED IN THE ENGINEERING. SUCH OBSTRUCTIONS OR DIFFERENCES SHOULD BE BROUGHT TO THE ATTENTION OF THE OWNER'S AUTHORIZED REPRESENTATIVE. IN THE EVENT THIS NOTIFICATION IS NOT PERMORED, THE IRRIGATION CONTRACTOR SHALL ASSUME FULL RESPONSIBILITY FOR ANY REVISIONS NECESSARY.
  5. IT IS THE RESPONSIBILITY OF THE IRRIGATION CONTRACTOR TO FAMILIRIZE HIMSELF WITH ALL GRADE DIFFERENCES, LOCATION OF WALLS, RETAINING WALLS, ETC. HE SHALL COORDINATE HIS WORK WITH THE GENERAL CONTRACTOR AND OTHER SUB-CONTRACTORS FOR THE LOCATION AND THE INSTALLATION OF PIPE SLEEVES THROUGH WALLS, UNDER ROADWAYS, PAVING, STRUCTURES, ETC.
  6. IN ADDITION TO THE CONTROL WIRE SLEEVES SHOWN ON THE DRAWINGS, THE IRRIGATION CONTRACTOR SHALL BE RESPONSIBLE FOR THE INSTALLATION OF CONTROL WIRE SLEEVES OF SUFFICIENT SIZE UNDER ALL OTHER PAVED AREAS.
  7. CONTRACTOR TO CONTACT CITY LANDSCAPE REPRESENTATIVE FOR PRESSURE TEST OF MAINLINE PRIOR TO BACKFILLING TRENCHES.
  8. VALVE BOXES WILL BE BASED WITH PEA GRAVEL
  9. VALVE BOXES WILL BE TAN COLOR WHEN IN DG AREAS
  10. THERE ARE NO CONFLICTING UTILIES WITHIN THE PROJECT AREA.

**GARZA CONCEPTS**

JOSE GARZA LANDSCAPE CONTRACTOR AND DRAFTING :  
P.O. Box 5891 La Quinta, CA. 92248  
jose@garzaconcepts.com www.garzaconcepts.com  
Lic # 1050039

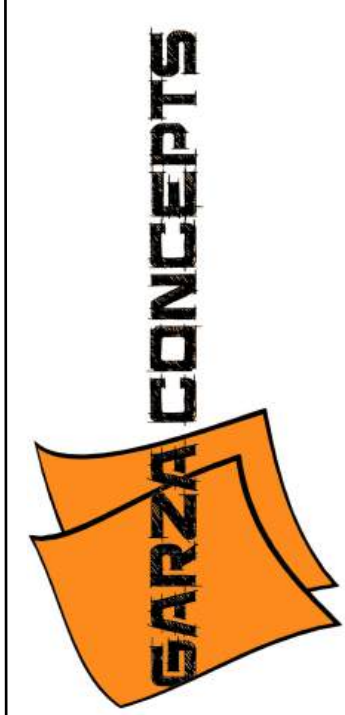

**PROJECT**

STREETSCAPE RENOVATION  
53800 POLK ST  
COACHELLA CA. 92236

**IRRIGATION DETAILS**

**Date Created**  
04/16/25

**REVISED**

- 1
- 2
- 3
- 4
- 5

**L15**





HARDSCAPE LEGEND

SYMBOL	QTY	DESCRIPTION
	3,326 SQ.FT.	4" THICK, 6 FEET WIDE GREY CONCRETE WALKWAY CONTRACTOR TO REFER TO CITY OF COACHELLA BUILDING CODES

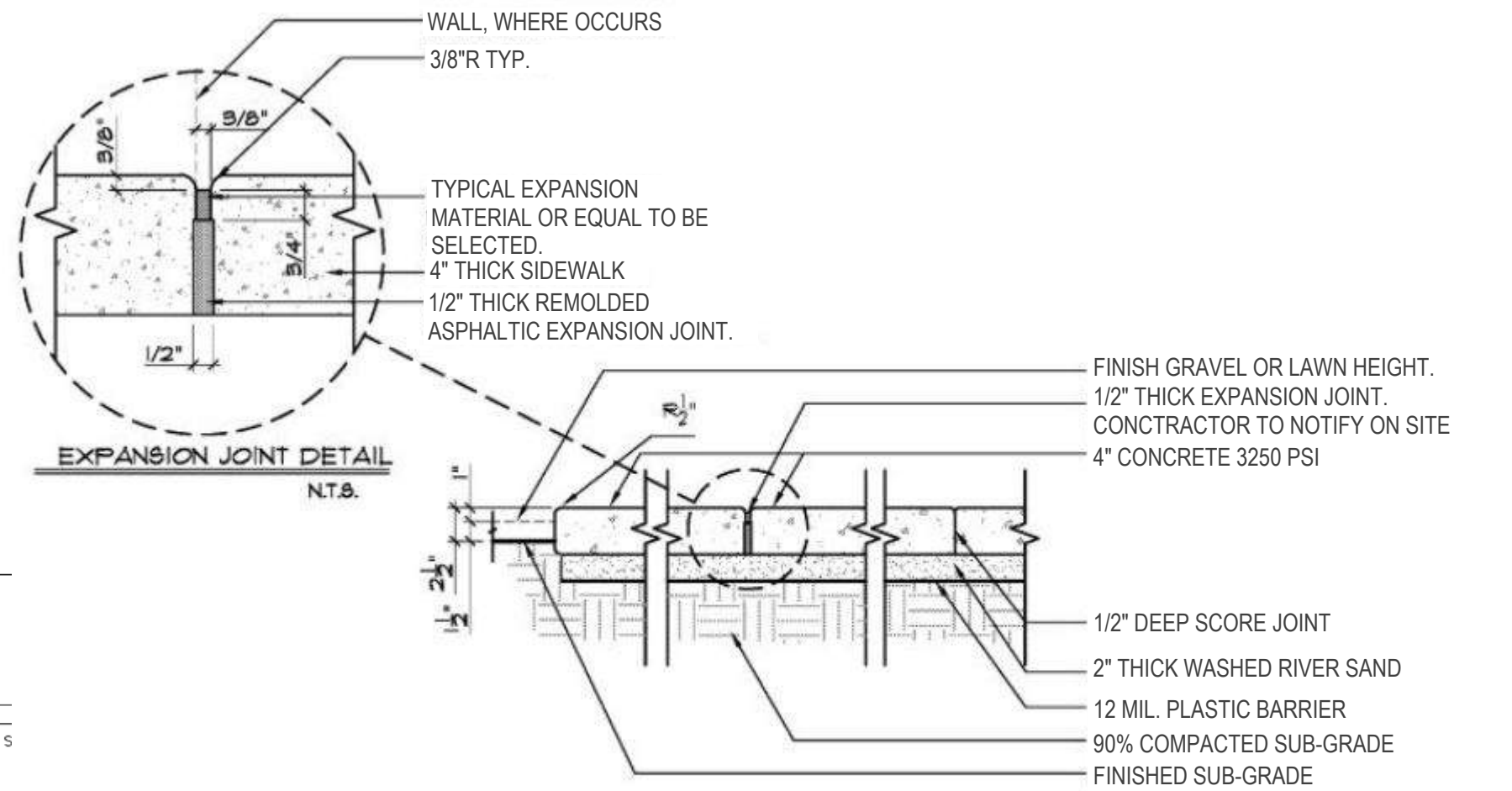
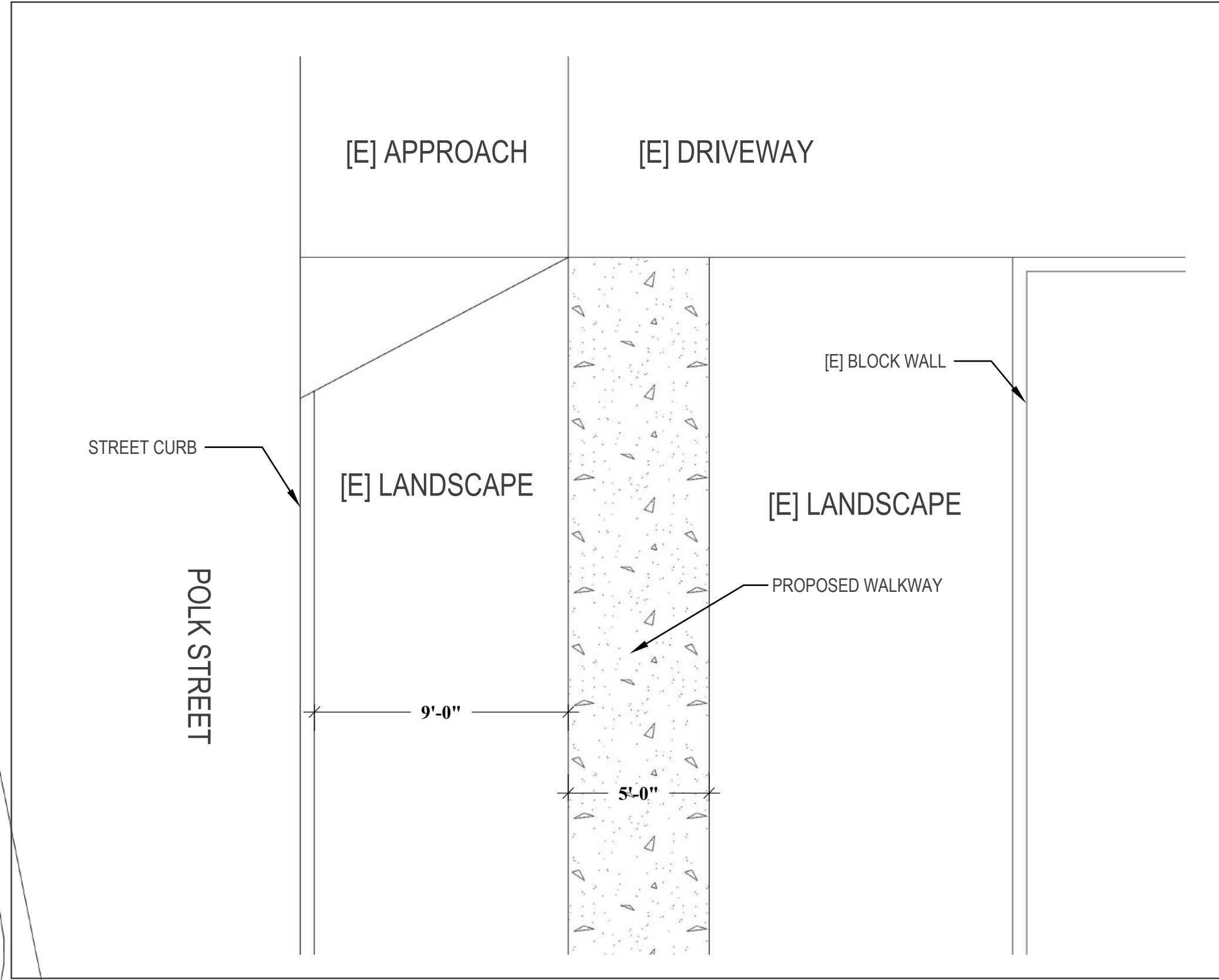

CONCRETE PAD DETAIL  
SHEET L10 SCALE: 1"=1'-0" 1

**UTILITY NOTES**  
VERIFY CONNETION POINTS FOR POWER TELEPHONE AND CATV SYSTEMS  
PRIOR TO CONSTRUCTION APPROXIMATE ONLY LOCATIONS INDICATED FOR  
TRANSFORMER LOCATIONS, ETC.  
  
COMPLY WITH ALL UTILITY COMPANY REQUIREMENTS, PROVIDE ALL  
RELATED CONDUITS, PULL BOXES AND REISERS.



48 HOURS BEFORE YOU DIG  
CALL

UNDERGROUND SESERVICE ALERT  
1-800-277-2600

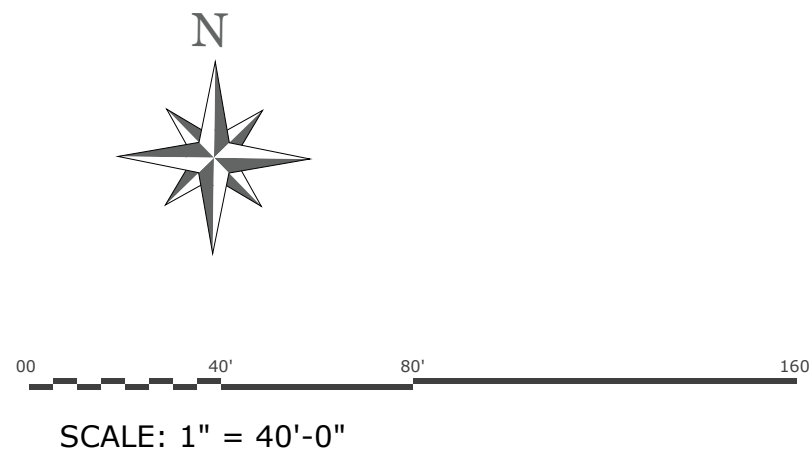

**GARZA CONCEPTS**  
JOSE GARZA LANDSCAPE CONTRACTOR AND DRAFTING :  
P.O. Box 5891 La Quinta, CA. 92248  
jose@garzaconcepts.com www.garzaconcepts.com  
Lic # 1050039



**PROJECT**  
STREETSCAPE RENOVATION  
53800 POLK ST  
COACHELLA CA. 92236

**HARDSCAPE**  
PLAN/DETAILS

**Date Created**  
04/16/25  
**REVISED**

1
2
3
4
5

L16