

Secondary Image Corridor

Attachment 4

Major Arterial

Streets classified as Arterials or Collectors are designated as Secondary Image Corridors. These streets require special treatment and design features reflecting the City's identity and heritage. Secondary Image Corridors would follow the same concepts as Primary Image Corridors, the difference being the extent of the treatment and size of public landscape areas.

Secondary Image Corridors include the following streets:

- Monroe Street
- Jackson Street
- Van Buren Street
- Fredrick Street
- Tyler Street
- Polk Street
- Fillmore Street
- Pierce Street
- Avenue 48
- Avenue 54
- Avenue 60

The Secondary Image Corridor for Major Arterials contain street lights in the center median and in the parkways which are a 30' ht. and are spaced further apart due to being less traveled pedestrian areas. Tall palms in the medians and canopy trees in the parkways create the appropriate vehicular scale.

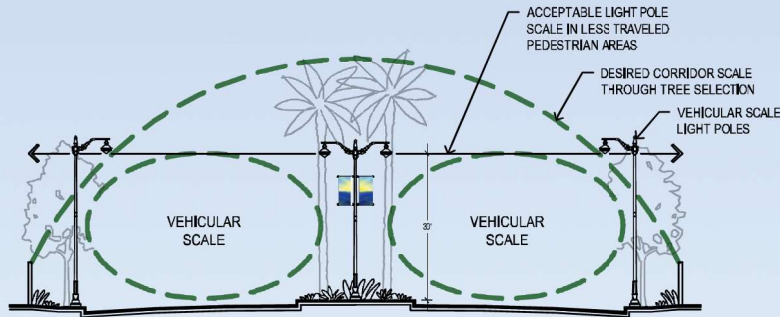

Fig. 18

Typical Street Section- Primary Arterial

DESIGN EMPHASIS

The design emphasis for the secondary image corridors in plan view resembles the primary image corridors. The medians are intended to incorporate large canopy trees consistent with the 'Shady Oasis' concept. Shrub selection should focus on the ease of maintenance through appropriate plant selection, placement, and spacing. Emphasis should be placed on the use of grasses in large swaths through the medians in shrub Group 'E'. Secondary image corridors in business districts and near civic facilities should incorporate lighting, seasonal lighting, and banner poles.

Secondary Image Corridor

Major Arterial

MEDIAN PLANTING

Accent Trees

Botanical Name	Common Name
Cassia sp.	Cassia
Cercidium 'Desert Museum'	Palo Verde
Chitalpa x sp.	Pink Dawn Tree
Lagerstroemia sp.	Crepe Myrtle

Canopy Trees

Botanical Name	Common Name
Chorisia speciosa	Floss Silk Tree
Ficus microcarpa	Indian Laurel Fig
Tipuana tipu	Tipu Tree

Palms

Botanical Name	Common Name
Phoenix dactylifera	Date Palm
Washingtonia filifera	California Fan Palm
Washingtonia robusta	Mexican Fan Palm

Shrub Groupings to be selected per conceptual shrub layout plan. Shrubs to be approved by the City.

Shrubs

Group	Botanical Name	Common Name
A	Agave parryi	
	Echinocactus sp.	Barrel Cactus
	Oenothera speciosa	Mexican Evening Primrose
B	Callistemon 'Little John'	Bottle Brush
	Lantana camera 'New Gold'	Shrub Lantana
C	Artemesia sp.	Artemesia
	Baccharis 'Pigeon Point'	Coyote Bush
	Bougainvillea 'Purple Queen'	Bougainvillea
	Calliandra californica	Fairy Duster
	Carissa macrocarpa	Natal Plum
	Muhlenbergia sp.	Deer Grass
	Senna sp.	Senna
D	Caesalpinia pulcherrima	Dwarf Poinciana
	Leucophyllum 'Thunder Cloud'	Texas Ranger
E	Acacia 'Desert Carpet'	Desert Carpet
	Carex sp.	Carex
	Dalea pulchra	Indigo Bush
	Lantana camera 'Patriot'	Shrub Lantana

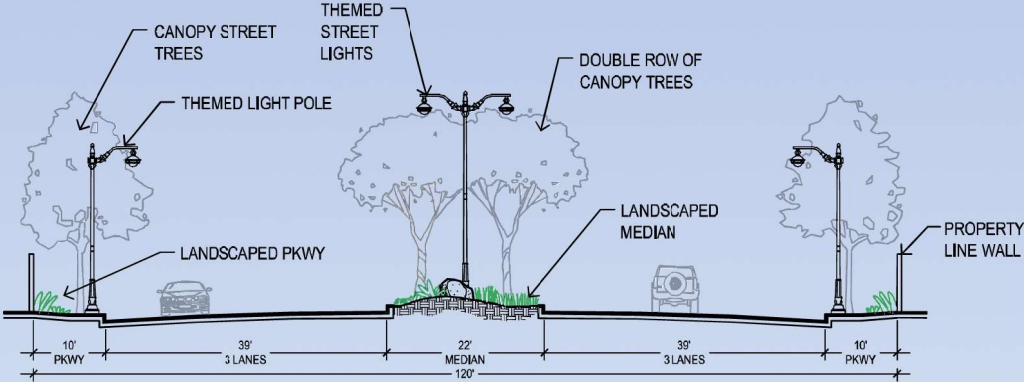

Fig. 19
Typical Street Section- Primary Arterial

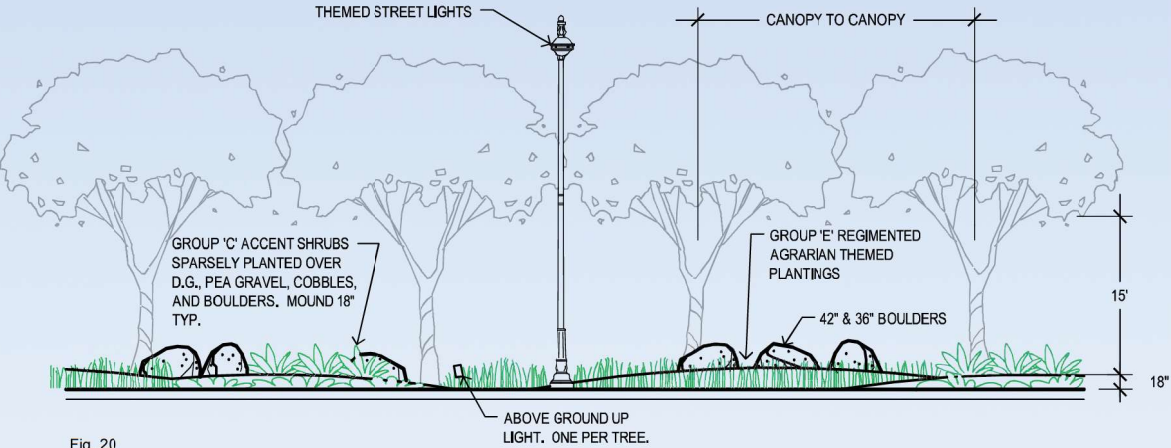

Fig. 20
Typical Median Elevation- Primary Arterial

Secondary Image Corridor

Major Arterial

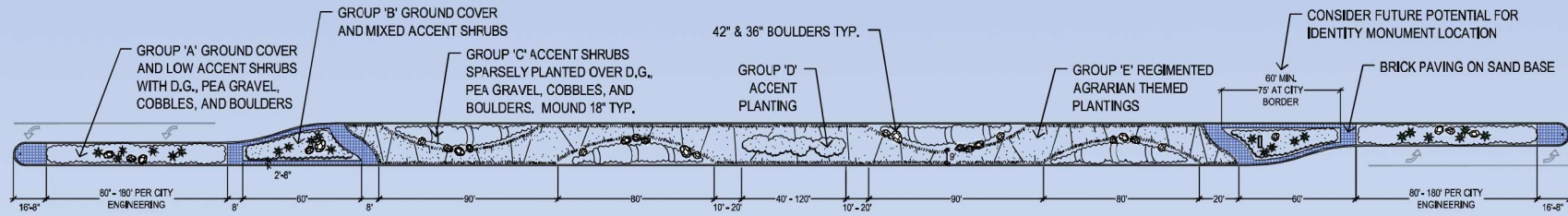

Fig. 21

Conceptual Hardscape and Shrub Layout

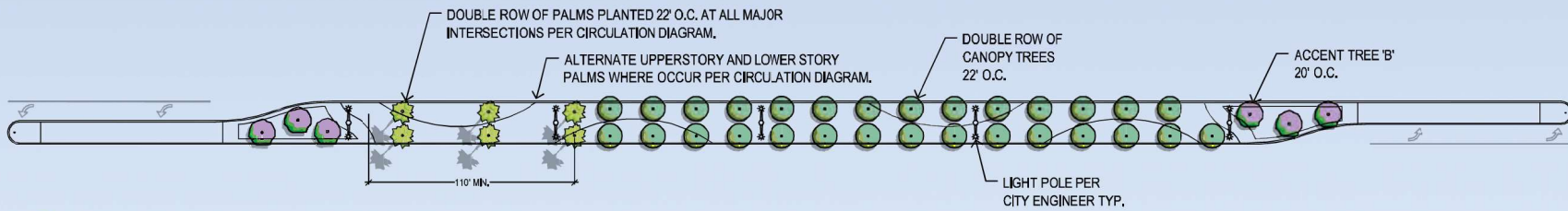

Fig. 22

Conceptual Tree Layout



Fig. 23

Conceptual Grading