

**STATEMENT OF QUALIFICATIONS TO PROVIDE
PLAN REVIEW AND BUILDING INSPECTION SERVICES**

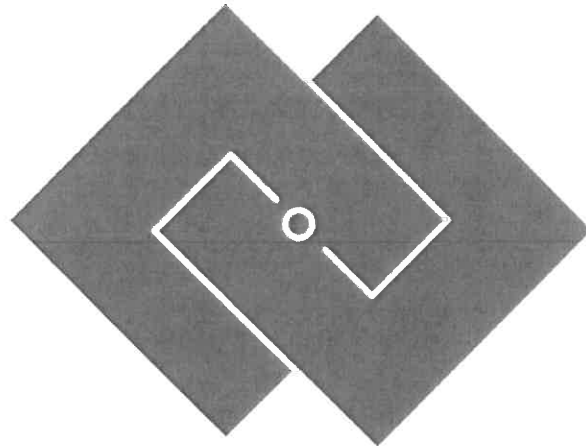

BPR

CONSULTING GROUP

July 2021

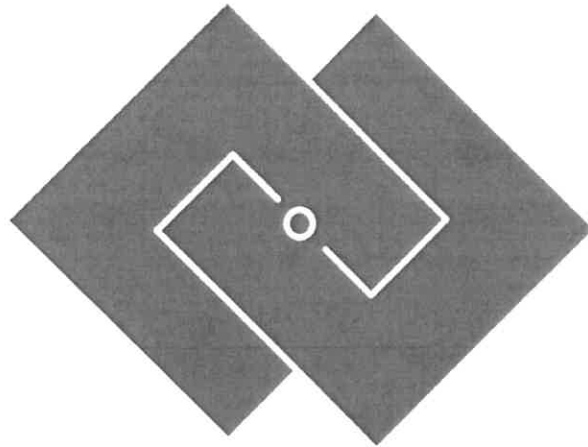

BPR

CONSULTING GROUP

Safe Buildings for Your Community
Efficient Professional Services

July 17, 2021

Mr. Alan Flora
City Manager
City of Clearlake
14050 Olympic Drive
Clearlake, CA 95422



RE: Proposal for Building Safety Services

Dear Mr. Flora,

Thank you for the opportunity to present this proposal which provides a detailed overview of the building department services offered by BPR Consulting Group (BPR). We appreciate your time in reviewing this Proposal and hope that we may be of service to the City of Clearlake.

Our talented staff of Building Officials, Plans Examiners, Building Inspectors, Licensed Engineers, and CASp experts have extensive experience providing all aspects of building department services in support of California communities. Our staff has provided similar building department services for numerous public agencies throughout the State of California; local communities such as the Cities of Woodland, Roseville, Sacramento, Fortuna, Yountville, Napa, American Canyon, Fairfield, Davis, and the County of Butte to name a few.

BPR Consulting Group's staff of experienced building safety personnel provide quality, thorough plan review and inspection services for our clients. Our staff of qualified professionals and our expertise allows us to assist you and your department to maintain service levels during periods of increased workload. Unlike the large national firms, BPR services are focused on supporting Northern California communities in the delivery of high-quality, building department services, tailored to your needs, with the goal of exceeding our clients' expectations by:

- Providing all services in a **cost-effective** manner.
- Providing **qualified and experienced personnel** who have the ability to effectively communicate and explain relevant code requirements.
- Providing a **high level of customer service** for internal and external customers.
- Balancing the need to ensure conformance to standards and regulations with the need for **predictability, uniformity, and efficiency**.

BPR's staff of Building Officials, Plans Examiners, Building Inspectors and Permit Technicians are all appropriately ICC Certified and are experienced and well-versed in providing services to Building Departments.

Please feel free to contact me at 916.204.3178 if you have any questions concerning our qualifications or the services we provide. Thank you for taking the time to review our qualifications. We look forward to the opportunity to work with you and the City of Clearlake.

Sincerely,

A handwritten signature in black ink, appearing to read "Ron Beehler". The signature is fluid and cursive, with the first name "Ron" and last name "Beehler" clearly distinguishable.

Ron Beehler, SE, CBO
Director of Client Services

TABLE OF CONTENTS

SECTION 1

COMPANY OVERVIEW

SECTION 2

QUALIFICATIONS AND EXPERIENCE

SECTION 3

BUILDING SAFETY TECHNICAL CAPABILITIES

SECTION 4

BILLING RATES

SECTION 1

COMPANY OVERVIEW

Seamlessly integrating municipal service professionals in support of public agencies is BPR Consulting Group's sole purpose. BPR was founded by individuals with a long history of serving municipalities and public agencies throughout California and Nevada. We have extensive experience in all aspects of building safety, including building official, plan review, inspection and permit technician services. We have worked with public agencies throughout California to provide these same services.

Our Building Safety Division consists of the following: California licensed structural, civil, mechanical, electrical and fire protection engineers; Certified Access Specialist (CASp) professionals; ICC-certified building officials, plans examiners, inspectors, permit technicians; and highly experienced administrative personnel.

Building department services we provide to municipalities and agencies include:

- Building official services
- Building safety plan review
- Building inspection
- Permit technician services
- CASp plan review and inspection services
- Fire prevention plan review and inspection services

Our team has a proven track record of providing efficient and predictable building department services while meeting or exceeding client expectations. Our key objectives in providing these services to the City of Clearlake are:

- **To remain unmatched in furnishing responsive and knowledgeable jurisdictional services.** Our staff currently serves or has served in all facets of municipal work by direct employment experience or as a consultant. BPR's staff knows and understands what is needed for a building department to operate efficiently.
- **To provide timely and responsive plan review services.** We work with you to help communicate results and information directly to your clients. We have the ability to tailor our services to align with your agency's unique and specific needs.
- **To share our wealth of code knowledge and building industry experience.** Our staff has been intimately involved in the development process for the California building codes. We share this unique knowledge by developing and providing code-related training and instruction at industry sponsored conferences, and in support of local ICC Chapters.
- **To be responsive to your specific staffing needs.** As construction and development activity fluctuates within your community, we can adjust our service levels allowing you to maintain seamless service to your customers.
- **To provide staff who have the appropriate experience, certifications, and knowledge.** We closely evaluate staff qualifications and experience to align with your specific needs.

SECTION 2

QUALIFICATIONS & EXPERIENCE

The following is a small sampling of the types of projects for which we are experienced at providing in support of building departments. We have coordinated in-house, staff-augmentation, building-official services, outsourced building-department, plans-examination services, inspection services, fire plan review and inspection services, and permit technician services to a multitude of public agencies throughout California.

BUILDING OFFICIAL SERVICES

BPR staff have provided Building Official services for many California communities. Our Building Official staff possess experience and are knowledgeable of the laws and regulations associated with building department operations and will use this experience and knowledge to promote efficient services for your department. We can provide full-time or part-time, on-site Building Official services. We also have the ability to provide on-call as needed remote Building Official services and/or Building Official services directly in support of specific major development projects within your community. Our Building Officials are keenly aware of the importance an efficient and predictable building department has on the economic vitality of the communities we serve.

PLAN REVIEW SERVICES

BPR Consulting Group's staff have many years of experience providing plan review for all types of projects ranging from small, simple, tenant-improvement projects to commercial, industrial and high-rise building projects. We review all submitted project documents as needed to verify building code compliance. We have the ability to assign plans examiners with the same qualifications and professional licenses as required for project designers which allows efficient professional communication of plan review related issues. We believe this approach affords a minimum number of plan review cycles allowing projects to move to construction without unnecessary plan review related delays. The following is a small sampling of projects for which BPR's staff have provided plan review services.

CITY OF FRESNO

Community Regional Medical Center:

BPR staff members provided plan review services for the Fresno Community Regional Medical Center (CRMC) expansion – a 58-acre, \$350 million project comprised of a 5-story, 180,000 SF Medical Office Building and a 5-story Parking Structure with approximately 427,900 SF of parking. BPR's staff provided complete building department plan review services for the CRMC Medical Office Building and Parking Structure. Submitted documents were reviewed for compliance with the applicable provisions of the codes and associated standards as adopted by the City of Fresno.



The CRMC Medical Office Building was constructed utilizing structural steel framing supporting composite concrete over steel decking at the floor and roof levels. The foundation utilized conventional spread footings. The lateral force resisting system was designed to utilize moment resisting steel frames. The exterior cladding for the project included light gauge steel framing supporting anodized aluminum panels and glazing. The Medical Office Building includes occupancy classifications B, S, and I-2.1, and Construction Type IA and is a fully sprinkled building.

The CRMC Parking Structure was designed utilizing concrete decks supported by concrete beams and columns, with post-tensioned, cast-in-place concrete construction supported by post-tensioned cast-in-place concrete beams, which in turn are supported by conventionally reinforced cast-in-place concrete columns. The lateral force resisting system consisted of concrete shear walls and concrete moment frames. The exterior cladding was designed to incorporate precast concrete wall panels.

Omni Family Health Facility:

BPR'S staff provided third-party plan review services on behalf of the City of Fresno for the Omni Family Health facility. The project consisted of modifications to the existing mechanical system to isolate air and control pressures in the facility's waiting room. The mechanical system upgrade was designed and plan reviewed for compliance with OSHPD 3 code requirements. Plan review services included review of the mechanical, electrical, energy and green building component modifications for California Building Code requirements including OSHPD3 requirements for healthcare facilities



Staff prepared review letters identifying elements of the final 100% construction documents that did not comply with applicable provisions of the adopted California Building Codes. The plan review team met with the design team to resolve plan review issues. At the completion of the plan review, two (2) sets of reviewed drawings and other required documents were delivered directly to the City of Fresno Building Department. A final review letter addressed to the City of Fresno Building Department was provided at the completion of plan review services indicating that plans were reviewed and found to comply with applicable building codes.

CITY OF HANFORD

New Hanford Fire Station:

BPR's staff provided complete plan review for this new 5,289 square foot fire station consisting of group R-2, B and S-1 occupancy classifications and constructed of Type VB Construction. The estimated project cost was \$2,000,000. The new fire station will support three personnel during duty hours and provide responsive service the southwest and west area of Hanford with a focus on improving response times and better serving the growing community.



Bayer Healthcare, Voluntary Seismic Upgrade: This project consisted of voluntary seismic upgrades to four existing buildings in order to comply with the city seismic strengthening regulations and policies. The design utilized the evaluation and retrofit procedures of ASCE 41-13 and introduced structural steel buckling restrained braced frames into these existing nonductile, reinforced-concrete buildings. The projects ranged in size from 3,400 SF to 60,000 SF, and the buildings included B, F-1 and S-1 Occupancies.

CITY OF SAN RAMON

Aspen Woods Apartments:

BPR staff provided plan review services for this new, 95-unit, senior complex. The facility consists of a basement and 4 floor levels totaling 139,281 SF. This podium style project utilized Type IA and VA construction and included S-2 and R-2 Occupancy Groups. Above the podium structure, western-style platform construction was utilized along with site-built, wood-sheathed, shear walls for lateral support for this exclusive residential project.

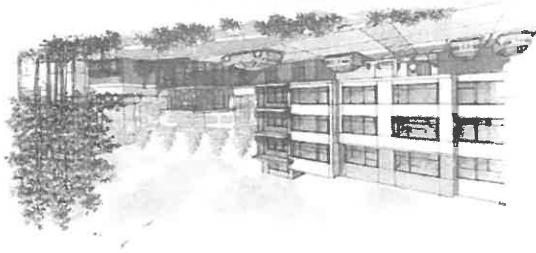

CITY OF VALLEJO

The Lodge at Glen Cove:

BPR staff provided plan review services on behalf of the City of Vallejo for this new, residential, care facility that provides Independent Living, Assisted Living and Memory Care options for its residents. The facility consists of two, three-story buildings totaling 120,312 SF. This project utilized Type VA construction and included A-2, R2.1, B and S Occupancy Groups.



BUILDING INSPECTION SERVICES

BPR Consulting Group maintains a staff of ICC Certified building inspectors available to serve your community. We understand the importance of personality coupled with code knowledge and the ability to explain identified deficiencies in a non-threatening manner. We carefully select inspection staff to ensure that selected staff possess the appropriate skills and knowledge for the types of projects they will be assigned. We value our inspection staff's ability to effectively communicate with city officials, homeowners, builders and others as an important trait necessary for delivery of successful inspection services on behalf of the communities we serve. We have found that demonstrated code knowledge, along with clear and efficient communication, are required ingredients for a fair and transparent inspection program.

PERMIT TECHNICIAN SERVICES

BPR Consulting Group maintains a staff of ICC Certified permit technicians available to serve your community. We understand the importance of the permit technician position. As the first contact by residents and builders alike, the first impression provided by our permit technicians sets the stage for the overall permitting experience. Our permit technicians are knowledgeable of state laws associated with issuance of building permits, have experience with multiple databases utilized by building departments and will quickly learn the unique project routing and approval process used by your department. Additionally, our permit technicians with minimum training, will use your adopted fee schedules to ensure that plan review and building permit related fees are properly assessed. At the completion of the plan review process, required approvals from other departments both within and outside the city, will be verified prior to issuance of building permits.

FIRE PLAN REVIEW & INSPECTION SERVICES

BPR Consulting Group staff are available to provide fire plan review services as needed to verify compliance with California Building and Fire Codes, adopted National Fire Protection Association Standards and local amendments. Plan review services will include review for fire and life safety code compliance relative to the design of fire protection systems including fire sprinkler systems, fire alarm systems, fire suppression systems, fire pump installations, smoke control systems, civil improvement plans, and non-structural building plans for fire and life safety features.

We understand that many municipalities and fire districts adopt local requirements unique to local fire concerns. We will review local requirements to ensure that assigned projects are compliant with current code and locally adopted requirements. We will ensure compliance with Title 24 California Building and Fire Codes, parts 2, 2.5, and 9 – applicable to fire prevention, life safety, mechanical and electrical installations as they relate to fire and life safety for residential, commercial, industrial, existing and historical buildings.

BPR's staff of Fire Plans Examiners and Fire Protection Engineers have performed both building and fire plan review services on a wide variety of projects including industrial, commercial, institutional, assembly, essential service buildings, mixed use, tenant improvements, remodels, adaptive reuse projects and residential developments.

SECTION 3

BUILDING SAFETY TECHNICAL CAPABILITIES

The BPR team holds extensive experience and a proven track record of providing building official, plan review, building inspection, fire plan review and inspection, and permit technician services as needed in a cost-effective manner. Our Building Official services can be tailored to meet your specific needs and budget. Our plan review services focus on providing timely and thorough plan reviews with the goal of issuing code compliant plans so minimum code related issues occur during the construction process. We also work with design teams on major projects providing progressive plan reviews where we identify code compliance issues during the design process resulting in quick approval of the final construction documents. Our Building Inspectors and Permit Technicians are selected based on the needs of the communities we serve. We tailor our services to fit your specific needs.

Our role and mission is to provide the following:

- A **team of professionals** with high-level experience and skills in successfully providing all building department services.
- Utilizing staff with a **customer service focus** and thorough knowledge of building department policies and procedures.
- Promoting **cooperation and partnership** with other jurisdiction departments and outside agencies.
- **Licensed Plan Review Engineer and/or ICC Certified Plans Examiners** for thorough and timely plan reviews.
- **Progressive plan review services** for major and unique projects.
- A **high level of customer service** to both internal and external customers.
- Adjusting services as needed to **meet your workload needs**.
- Services in a **cost-effective manner** that remain within budget constraints.

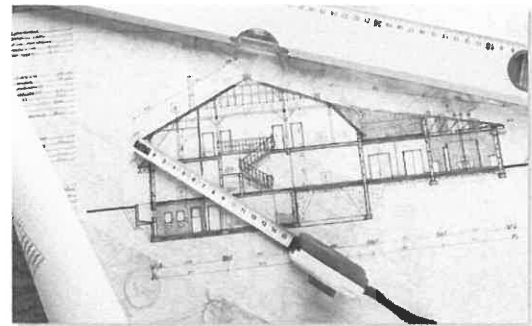

BUILDING & FIRE PLAN REVIEW SERVICES

All plans examination services will be performed by or under the direction of a licensed civil or structural engineer. For unusual or large projects, and when needed to meet aggressive schedules and peak workload demands, additional support will be provided by appropriately qualified staff. Our building officials, plans examiners, and building inspectors maintain a working knowledge of applicable building codes and plan review procedures. Our staff will use their experience and skills to promote efficient services on behalf of your department.

Our staff will work with project applicants and designers in a collaborative and professional manner to quickly identify and resolve code compliance issues. Our Building Officials will collaborate with project designers to identify code compliant procedures to address complicated code issues. Our plans examiners will perform detailed plan reviews to provide complete and accurate construction documents to minimize questions and problems during the construction phase of projects.

TECHNICAL PLANS EXAMINATION CAPABILITIES

BPR's staff possesses significant technical capabilities in all areas of plans examination, competency gained from years of experience providing these same services. All plans examiners are California Licensed Engineers or ICC Certified Plans Examiners with multiple years of experience providing plan review services. Our staff will conduct accelerated or project-specific, phased, plan reviews on an as-needed basis as requested by clients. Our plans examiners have a thorough understanding of code requirements, are able to read, understand and interpret construction documents, energy calculations, geotechnical reports, structural calculations, electrical load calculations, commissioning reports, and other associated design documents. Our plans examination staff have the ability to prepare well-written, plan review letters, communicate effectively orally and in writing and work effectively with jurisdiction staff, project design teams, contractors and the permit applicants. Our plans examiners possess knowledge of the most current state adopted building standards.

ARCHITECTURAL

BPR's non-structural plans examiners have provided plan review services for a vast array of projects including large residential, commercial, institutional, industrial, retail, and OSHPD 2, 3 and 5 medical office buildings. Many of our plans examiners are CASp certified. Completed plan review projects range from single-story, residential projects to complex high-rise buildings and numerous building additions and remodels. We are experienced and familiar with the use and application of the most current editions of the following model codes:

- California Building Standards Code (Title 24) Parts 1 through 6 and 9
- International Building Code (IBC)
- Americans with Disabilities Act Standards for Accessible Design
- ANSI Standards
- NFPA Codes & Standards
- CA Code of Regulations (CCR) Titles 19 and 25
- Jurisdiction-Adopted Amendments or Ordinances

STRUCTURAL

Our structural engineers have experience designing and reviewing all types of projects including residential, multi-family, commercial, and multi-story projects including mid-rise and high-rise projects, institutional projects, industrial projects, retail buildings, schools, medical office buildings and court facilities.

Our structural engineers have experience designing and reviewing projects constructed with all building materials including the following:

- Wood
- Masonry
- Heavy Timber / Timber Frame
- Concrete
- Structural Steel
- Light Gauge Steel Framing
- Straw Bale
- Rammed Earth

Our engineers have designed or reviewed a wide array of structural lateral force resisting systems including:

- Structural steel moment frames
- Buckling-restrained braced frames
- Eccentric braced frames
- Concentric braced frames
- Concrete moment frames
- Wood shear wall systems
- Masonry shear wall systems
- Concrete shear wall systems
- Cantilevered column systems
- Pre-stressed and post-Tensioned Concrete
- Various proprietary lateral force resisting systems

Our structural engineers and inspectors are experienced with the provisions of most model codes including current versions of:

- CCR Title 24, Part 2, Volumes 2 & 2.5
- International Building Code (IBC)
- AISC 341, 358 and 360
- ASCE 7
- ASCE 41
- AISI Standards for Cold Formed Steel
- ANSI / AF&PA NDS for wood framing
- ACI 318
- ACI 530 / TMS 402/602
- CA Historic Building Codes
- CA Existing Building Codes
- NEHRP

MECHANICAL, PLUMBING & ELECTRICAL

BPR's Mechanical and Electrical Engineers are well versed in the California Mechanical, Plumbing and Electrical codes. We will review submitted design documents to ensure compliance to the current edition of the following codes:

- California Building Code
- California Residential Code
- California Plumbing Code
- California Mechanical Code
- California Electrical Code
- Jurisdiction-adopted amendments

Other review services may be provided based on current editions of local or national standards such as:

- International Building Code
- International Residential Code
- International Mechanical Code
- International Plumbing Code
- NFPA Standards 13 (automatic fire sprinkler systems)
- NFPA Standards 20 (fire pumps)
- NFPA Standards 72 (fire alarms)
- NFPA Standards 99 (medical gases)
- NFPA 101 Life Safety Code
- NEHRP Requirements for Existing Building

ENERGY COMPLIANCE

Our engineers and plans examiners are up to date on all California Energy Code requirements as they relate to both new and remodel construction for all project types. The Energy Efficiency Standards for Residential and Non-Residential Buildings were established in 1978 in response to a legislative mandate to reduce California's energy consumption. These standards have been updated since that time to address a multitude of building components, systems and equipment with the goal of having new and updated buildings be more energy efficient, comfortable for building occupants, and less reliant of fossil fuels.

GREEN BUILDING STANDARDS

BPR's staff has a working knowledge of the proper incorporation of CALGreen building criteria into project designs and the resulting potential impact of these standards related to building code compliance and the environment. Our plans examiners will review project documents to verify compliance with adopted Green Building Code Standards as required by state law and local amendments and ordinances.

LEED

Developed by the US Green Building Council (USGBC), LEED provides building owners and operators a framework for identifying and implementing measurable green building design methodologies, construction, operations, and building maintenance. LEED certification consists of a variety of rating systems applicable to multiple building types including commercial as well as residential. Ratings reflect a measure of how well a building performs across many sustainability metrics including: energy savings, water efficiency, CO2 emissions reduction, indoor environmental quality, energy usage and the projects impact on the local environment.

ACCESS COMPLIANCE & CASp REVIEW

All BPR CASp-certified professionals are knowledgeable of state and federal accessibility laws and regulations and possess the expertise necessary to promote access to facilities for persons with disabilities. Our staff are experts in the industry, maintaining appropriate certifications demonstrating their expertise, and are experienced providing services for building departments in a seamless manner balanced and in coordination with our client's expectations and needs. We work collaboratively with our clients to address accessibility plan review and inspection related issues as efficiently as possible.

Our plans examiners are fully trained and familiar with CA Building Code Accessibility requirements and ADA compliance requirements and are available for plan review and/or inspection services. We offer support to municipalities for compliance enforcement and/or developing transition plans. We can assist our clients in researching and providing interpretations of various specific issues related to access compliance including access compliance obligation, transition plan development, construction costs and phasing, and regulation interpretations.

FLOOD ZONES

BPR's staff of engineers and plans examiners have experience in providing plan reviews for projects located in flood zones and areas prone to flooding. BPR Consulting Group's staff has provided numerous plan reviews for projects located in flood zones using FEMA's Technical Bulletins as well as locally adopted ordinances. Additionally, members of our team have participated in state-sponsored committees to establish guideline and building code requirements for projects planned in areas designated as flood zones.

OSHPD 2, 3 & 5

BPR Consulting Group's staff of plans examiners and building inspectors have extensive experience providing plan review and inspection services for OSHPD 2, 3 and 5 projects. Our staff is well versed with the OSHPD 2, 3 and 5 requirements included in the California Building Code. Our inspection staff includes an OSHPD certified

inspector with recent experience providing inspection services for hemodialysis, outpatient surgery, hyperbolic chamber, medical clinics and acute psychiatric facilities.

FIRE CODE PLAN REVIEW

We have an experienced and licensed professional Fire Protection Engineer on staff to address your fire and life safety needs. Our fire safety plan review and inspection staff can quickly and accurately check plans for compliance with applicable fire codes and standards. Our fire protection staff routinely review and inspect projects for compliance with fire and life safety regulations.

Our Fire Plans Examiners and Inspectors have extensive experience in the use and application of the following model codes, standards, and regulations:

- California Fire Code (CFC) and California Building Code (CBC), with local amendments and regulations.
- Adopted National Fire Protection Standards
- California Health and Safety Code
- Appropriate listings (CSFM, U.L., etc.) for common systems and materials
- Fire Department Standards
- Code referenced National Fire Protection Reference Standards
- Municipal, State or Federal regulations enforced by local Fire Agencies

BPR's staff is active with California Fire Prevention Officer's Association, as well as local chapters of International Code Council Building Officials Organizations throughout the State of California.

STANDARD PLAN REVIEW COMPLETION TIMEFRAMES

We complete all **plan reviews** within the timeframes shown below for both commercial and residential projects as our standard business practice. We will accommodate any turnaround schedule agreed to with our clients. We have the ability to provide expedited plan review services when requested.

Project Type	Maximum Turn Around Time (Business Days)	
	Initial Submittal	Backcheck Reviews
Residential (Single Family)		
New Construction	10	5
Addition	10	5
Remodel	10	5
Non-Residential		
New Construction	10	5
Addition	10	5
Remodel, Tenant Improvement	10	5
Large, Complex Commercial or Residential Multi-Family Projects	10	7

TRANSPORTING PLANS

For paper submittal documents, we will arrange for all pick-up and delivery of the plan review documents from your office at no additional cost. We utilize specific methods for project document pick-up and delivery with the goal of providing same-day service.

ELECTRONIC PLAN REVIEW

BPR Consulting Group maintains an efficient cloud-based, electronic-document, submittal system for receiving and sending large electronic document files. Our electronic document portal utilizes a SharePoint system to allow permit applicants and client staff the ability to upload construction documents for our plan review services. BPR Consulting Group has provided electronic plan review services, serving building departments and other public agencies with efficient electronic plan review services. We are prepared to provide electronic plan check services for your community utilizing our **Bluebeam** electronic plan review system, or any electronic plan review system presently used by your department.

Recently we have worked with multiple California communities to transition them to electronic plan reviews. Our clients understand the benefits of electronic plan review, especially for projects with extensive project drawings and associated documents. Electronic plan reviews contribute to a reduction in paper waste by eliminating the need to print multiple copies of documents during the plan review process.

Additional benefits of electronic plan review include: improved turnaround times, secured accessibility to documents, reduced need for paper storage, simplifying archiving of documents and ease of communicating code issues with the design team.

We have had the opportunity to work with many different electronic plan review systems and our preferred system is **Bluebeam**, an industry-leading software used by many jurisdictions, design teams and contractors to review and annotate construction documents. We have worked with multiple clients to purchase and deploy **Bluebeam** software, develop jurisdiction-specific stamps, develop tools to increase efficiencies for electronic plan reviews, and participate and provide ongoing training on the use of the software.

COMMUNICATING PLAN REVIEW RESULTS

Plan review comments, when necessary, will be type written and refer to specific details, drawing or supporting document, and reference applicable code sections. BPR will provide a clear, concise, and thorough plan review letter itemized by specific discipline such as life safety, accessibility, structural, plumbing, mechanical, etc., that can be utilized by clients, designers, contractors, and owners to understand the noted deficiency and make necessary corrections to the project documents. At the completion of each plan review cycle, BPR Consulting Group will return a copy of the plan review comment list to the designated applicant and project representative. If requested, we will coordinate plan review re-checks directly with the designated project applicant. Upon completion of the plan review process, we will return completed plan review documents, in either hard copy or electronic format as needed, ready for final approval and permit issuance.

BUILDING INSPECTION SERVICES

BPR building inspectors are qualified and appropriately ICC-certified to provide requested inspection services. Our inspection staff will perform inspection services to verify that the work of construction is in conformance with the approved project plans as well as identifying issues of non-compliance with applicable building codes. Our field inspection services will include inspection of all portions of projects including project sites as applicable. Our building inspectors will write legible and understandable correction notices, field reports and will be available to answer in-person or telephone inquiries. All inspection personnel assigned will be ICC and/or CASp certified as required.

We understand that many municipalities have amended code sections, policies and ordinances that impact the work that is inspected and approved project plans. Our inspection staff will familiarize themselves with local requirements to ensure that the projects we are inspecting are compliant with current code requirements. Specifically, we will ensure compliance with the applicable provisions of the Title 24 California Building Standards Code, Parts 1 through 12, covering structural, fire prevention, life safety, disabled access, energy conservation, green building, plumbing, mechanical and electrical installations in residential, commercial, industrial, existing and historical buildings. BPR's ICC/CASp certified inspectors have performed building inspection services on a wide variety of construction projects including planned, single-family, residential developments, custom homes, commercial, manufacturing, institutional, assembly, essential service, industrial projects and historically designated buildings. When necessary for large or fast-paced projects, multiple inspectors can be made available. BPR's inspectors will inspect projects to verify conformance with approved project drawings and specifications which will include review of the permit documents to verify that onsite conditions are consistent with the approved documents for size, setbacks, heights and other applicable requirements. At the completion of inspections, BPR's inspectors will update database information, complete necessary forms and documents as required to provide seamless service.

INSPECTOR QUALIFICATIONS & CERTIFICATIONS

BPR will work with you to select appropriately qualified inspectors with applicable experience and specific code knowledge based on the types of projects assigned for inspection. All BPR Consulting Group inspectors are ICC-certified with many maintaining CASp certification. In addition, BPR employs OSHPD certified inspectors available for inspection of OSHPD designated facilities.

Inspection personnel will have the ability to read, understand and interpret construction plans, truss drawings and calculations, prepare and maintain accurate records and reports, communicate effectively orally and in writing and to work effectively with contractors, permit applicants, homeowners and agency staff. Inspectors will possess knowledge of approved and modern methods, materials, tools and safety used in building inspection and the most current building standards. Our inspectors are familiar with most of the common scheduling and tracking systems utilized by building departments and can quickly adapt to your systems and requirements.

PERMIT TECHNICIAN SERVICES

Knowledgeable and personable permit technicians are the first impression the public gets of your building department, and they play a critical role as to how your departments services are perceived. Permit technician services are crucial to the success of the entire building safety workflow within building departments. The ability to convey proper information to permit applicants, properly calculate permit fees, properly route plans to various departments for review, tracking approvals, database management and permit issuance are all critical to the success of your building department. We understand that the ability to deliver excellent customer service, maintaining a smooth flow of permit documents throughout departments, and maintaining accurate and up-to-date records, are all key elements to furnishing first-rate, efficient success of your building department.

Our Permit Technicians will greet and work closely with the customers at the public counter or via telephone, answering questions and providing accurate information. Our Permit Technicians will provide information about permit applications, plan review and inspection requirements, will be organized and have the ability to maintain filing systems necessary for tracking permit applications, permits issued, plan checks in progress, approved project documents and any other records or information important to the efficient operation of your department.

SECTION 4

BILLING RATES

PLAN REVIEW SERVICES

Our standard fee for complete building code plan review services for commercial and residential projects reviewed in our offices is 68% of the plan review fees based on your agency’s adopted fee schedule. Structural only plan review services will be charged at 45% of the plan review fees based on your agency’s adopted fee schedule.

Plan review services will include an initial first review and two, back-check reviews of the submitted documents. Any additional plan review services required beyond the third review will be billed at our hourly rates listed within the Schedule of Hourly Billing Rates included below.

SCHEDULE OF HOURLY BILLING RATES

The rates displayed in the schedule below reflect BPR’s current hourly billing rates.

CLASSIFICATION	HOURLY BILLING RATE
Licensed Plan Review Engineer (structural, civil, electrical, mechanical)	135
ICC Certified Plans Examiner	95
CASp Plans Examiner or Inspector	110
ICC Certified Inspector *	85-110
Fire Protection Engineer	135
ICC Fire Plans Examiner	95
ICC Fire Inspector	95
Permit Technician*	60-70

* Individual billing rates for these services will be negotiated based on certification levels and experience of assigned staff.

- **Shipping:** There is no charge for courier or shipping services for plan reviews conducted off site.
- **Expedited Plan Reviews:** Expedited plan reviews can be provided upon request. Fees for expedited plan review services will be **150%** of the above noted hourly rates.
- **Mileage:** Vehicle mileage utilized while performing city services will be billed at the current IRS vehicle mileage rate.