

Area Development Plan

Section 13, T20N-R16E, Town of Clayton, Winnebago County, Wisconsin

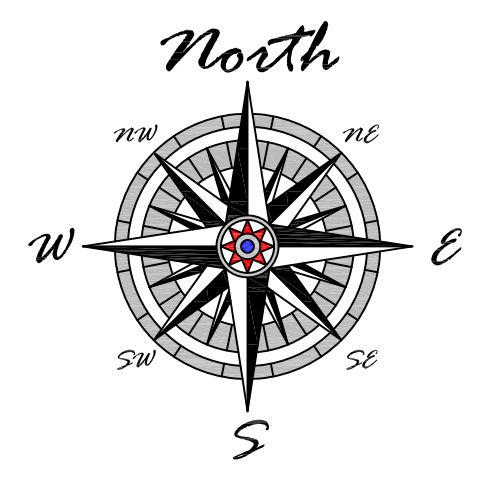
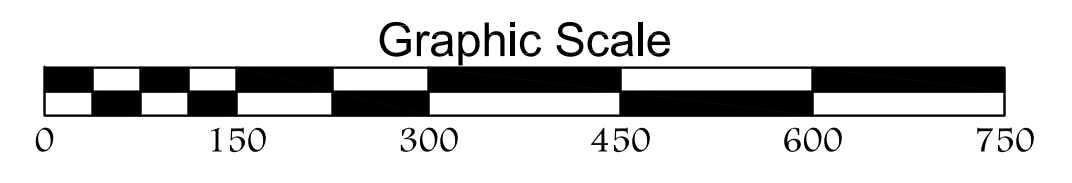

SCALE
1"=150'

DRAWN BY
BAR

Area Development Plan

Mau & Associates, LLP
 LAND SURVEYING & PLANNING
 CIVIL & WATER RESOURCE ENGINEERING
 Phone: 920-434-9670 Website: www.mau-associates.com
 400 Security Blvd Ste 1, Green Bay, WI 54313-9712

Michael Coppens

PROJECT NO.
C-4421
 SHEET NO.
1 of 2
 DRAWING NO.
S-3628

TAX PARCEL NO. 0060354 File: C-4421 Layout 090723.dwg Fieldwork Completed: 09/16/22

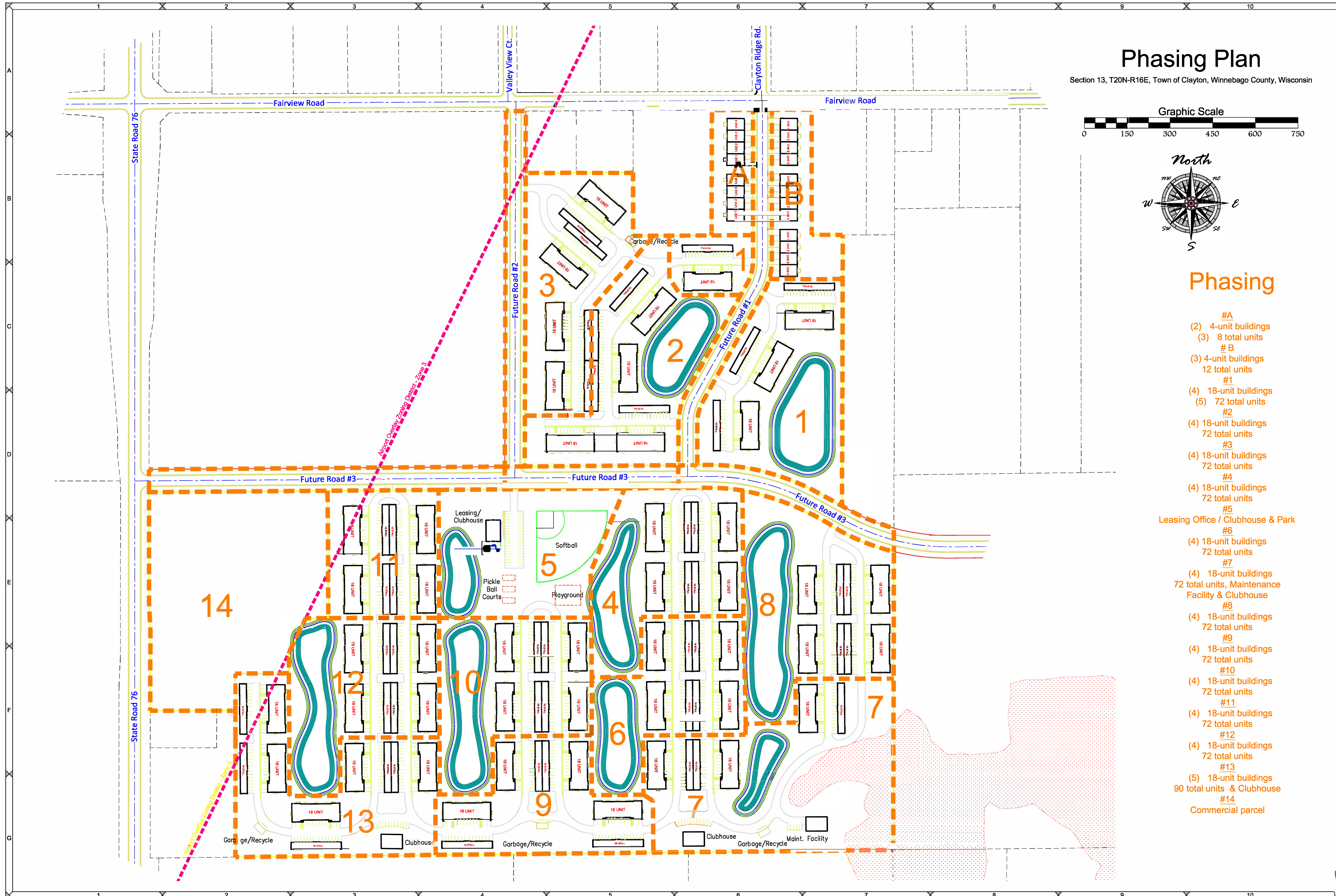

Phasing Plan

Section 13, T20N-R16E, Town of Clayton, Winnebago County, Wisconsin

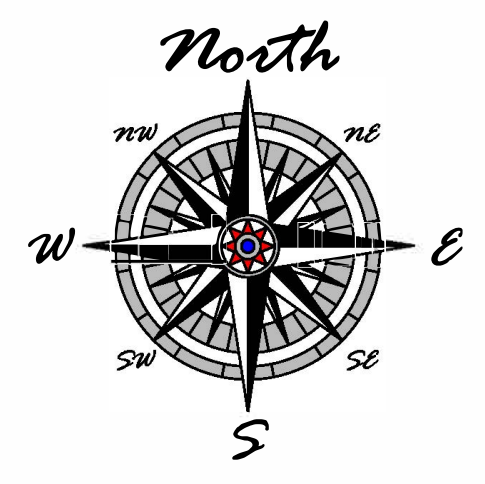
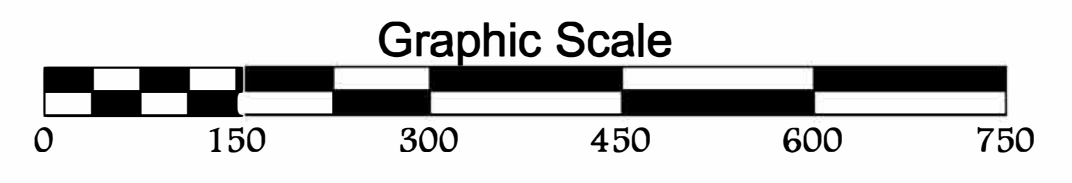

Phasing

- #A
- (2) 4-unit buildings
- (3) 8 total units
- # B
- (3) 4-unit buildings
- 12 total units
- #1
- (4) 18-unit buildings
- (5) 72 total units
- #2
- (4) 18-unit buildings
- 72 total units
- #3
- (4) 18-unit buildings
- 72 total units
- #4
- (4) 18-unit buildings
- 72 total units
- #5
- Leasing Office / Clubhouse & Park
- #6
- (4) 18-unit buildings
- 72 total units
- #7
- (4) 18-unit buildings
- 72 total units, Maintenance Facility & Clubhouse
- #8
- (4) 18-unit buildings
- 72 total units
- #9
- (4) 18-unit buildings
- 72 total units
- #10
- (4) 18-unit buildings
- 72 total units
- #11
- (4) 18-unit buildings
- 72 total units
- #12
- (4) 18-unit buildings
- 72 total units
- #13
- (5) 18-unit buildings
- 90 total units & Clubhouse
- #14
- Commercial parcel

SCALE
1"=150'

DRAWN BY
BAR

Area Development Plan
Phases

Mau & Associates, LLP
LAND SURVEYING & PLANNING
CIVIL & WATER RESOURCE ENGINEER NG
Phone: 920-434-9670 Website: www.mau-associates.com
400 Security Blvd Ste 1, Green Bay, WI 54313-9712

Michael Coppens

PROJECT NO.
C-4421
SHEET NO.
2 of 2
DRAWING NO.
S-3628

TAX PARCEL NO. 0080354
Fieldwork Completed: 09/15/22
Data File: C-4421.dwg

File: C-4421 Layout 090723.dwg