

NOTE:
INTERCEPT EXISTING SERVICES AND EXTEND TO NEW N-36 BOX LOCATION

NOTE:
CUSTOMER TO INTERCEPT (E) 3" CONDUIT AND EXTEND TO XFMR TS62089 WITH NVE INSPECTOR PRESENT. USE CAUTION, EXISTING ENERGIZED CABLE IN THIS AREA.

A PRE CONSTRUCTION MEETING IS REQUIRED ON ALL PROJECTS PLEASE CALL CARSON OPERATIONS AT (775)834-2977 TO SCHEDULE 48 HOURS PRIOR TO CONSTRUCTION.

NV ENERGY APPROVED PLANS SHALL BE ON SITE DURING CONSTRUCTION AND INSPECTION

METER PANEL ADDRESS TAG MUST COMPLY WITH NVE STD. GM0001M SECTION 5.3



NV ENERGY TO FURNISH AND/OR INSTALL:

- APPROX. 10 CKT. FT. 25 KV U/G PRIMARY C/O 1-1/0 CABLE IN 10' OF NEW 1-3"C (CONDUIT BY APPLICANT).
- APPROX. 10CKT. FT. 10 U/G SECONDARY BUSS C/O 1- 350 TX, IN 1-3"C (CONDUIT BY APPLICANT).
- APPROX. 55CKT. FT. U/G SERVICE CABLE TO 1 - 200AMP COMM PANEL C/O 1- 2/0 TX IN 1-3"C (CONDUIT BY APPLICANT).
- 1 - 10 PDM LOAD BREAK TRANSFORMER 75KVA, 12.5GDY/7.2KV, 240/120V, STK.#81-5448.

NV ENERGY TO REMOVE:

- 1 - 10 25KVA O/H TRANSFORMER, 7.2/12.5KV GDY, 120/240V, STK.# 80-7151.

APPLICANT TO FURNISH AND/OR INSTALL:

- 1 - 10 TRANSFORMER PAD 44"x48"x6" PER NVE. STD. PE0010U.
- 1 - 17"x30" H-10 CONCRETE SERVICE/SECONDARY BOX AND LID (NON TRAFFIC AND INCIDENTAL RATED BOX) (SEE YB0052U)
- PROPOSED APPROX. 10FT 4" PVC PRIMARY CONDUIT.
- PROPOSED APPROX. 10 FT. 3" PVC SECONDARY CONDUIT.
- PROPOSED APPROX. 55 FT. 3" PVC SERVICE CONDUIT.

(ABOVE FOOTAGE DOES NOT INCLUDE SWEEPS OR RISERS FOR SECONDARY BOXES, TRANSFORMERS, JUNCTION ENCLOSURES, ETC.)

APPLICANT IS RESPONSIBLE FOR MANDRELLING CONDUIT AND INSTALLING A PULL LINE THAT MEETS OR EXCEEDS THE FOLLOWING REQUIREMENTS:

- THE PULL LINE WILL BE OF A FLAT DESIGN
- SHALL HAVE A MINIMUM BREAKING STRENGTH OF 400 LBS.
- WILL HAVE SEQUENTIAL FOOTAGE MARKINGS
- EXAMPLES OF PULL LINES THAT MEET THESE REQUIREMENTS (NVE. STK.#95-7305)
- NEPTCO "MULE TAPE" (WP400P)
- CONDUX INTERNATIONAL (08096203)
- SEE NVE VOLUME 17, SECTION 4-CD0001U.
- ALL SECONDARY CONDUIT TO BE 3" MINIMUM.
- ALL SERVICE CONDUIT TO BE 3" MINIMUM.
- ALL CONDUIT TO BE A MINIMUM DB120 PVC GRAY BELOW GROUND.
- (ABOVE GROUND RISER CONDUIT TO INCLUDE: SCH 80 SWEEP, 10' OF SCH 80, 2 - 10' SECTIONS OF SCH 40 AND BOLT-ON WEATHER HEAD. SWEEP AND RISER MATERIAL MUST BE OF LIKE KIND, STEEL OR PVC)
- ALL STAKING REQUIREMENTS PER NVE. STD. GI0001U/G/W AND GI0002U.
- PRIMARY RISER RISER MATERIAL C/O 4" (OR 3") MINIMUM DB-120 SWEEP, 10' OF 4" (OR 3") SCHEDULE 80 CONDUIT AND 30' OF SCHEDULE 40 CONDUIT. STAND-OFF BRACKETS AND LAG SCREWS BY NVE. (NVE TO INSTALL 30' OF SCHEDULE 40 CONDUIT ONLY.) TRAFFIC AREAS SHALL BE GALVANIZED RIGID STEEL FOR FIRST 10' OF RISER. SWEEP AND RISER MATERIAL MUST BE OF LIKE KIND. (STEEL OR PVC)

GENERAL COMMENTS:

- CALL NVE INSPECTION REQUEST LINE (775)634-3440 48 HOURS PRIOR TO START OF ALL OVERHEAD OR UNDERGROUND CONSTRUCTION. (INCLUDE PROJECT NUMBER, NAME AND PHONE NUMBER, AND TYPE OF INSPECTION REQUIRED)
- METER PANELS ARE TO BE LABELED IN ACCORDANCE WITH NVE STD. GM0001M SEC. 5.3
- TRANSFORMERS AND SECONDARY BOXES WILL HAVE MINIMUM 3' FLAT AND CLEAR ON ALL FOUR SIDES, 10' CLEAR IN FRONT OF TRANSFORMERS.
- PADMOUNT EQUIPMENT MUST MEET REQUIRED LOCATIONS/CLEARANCES PER NVE. STD. PE0010U ALL SECONDARY BOXES AND PRIMARY VAULTS SHALL BE TO FINISH GRADE.
- ALL MATERIAL SHALL BE ON THE JOB SITE PRIOR TO THE START OF ANY WORK BY NVE.
- REFER TO NVE. STDS. C10001M or US0001M FOR FURTHER CLARIFICATION OF DETAILS.
- COMPACTION TESTS REQUIRED PER NVE. STD. SUB01X.
- NO TREE SHALL BE PLANTED UNDER OR ADJACENT TO ENERGIZED POWER LINES WHICH, AT MATURITY, SHALL GROW WITHIN 10 FEET OF THE ENERGIZED CONDUCTORS. NOR SHALL ANY PERMANENT STRUCTURE, FENCE, SHRUB OR TREE BE PLANTED CLOSER THAN 10 FEET IN FRONT AND 3 FEET FROM ALL OTHER SIDES OF A PAD MOUNTED TRANSFORMER.
- NOTE: DEVELOPER IS RESPONSIBLE FOR ADHERENCE TO NV ENERGY GAS AND ELECTRIC STANDARDS. CONSTRUCTION STANDARDS CAN BE FOUND ON-LINE AT THE FOLLOWING WEB SITE: <https://www.nvenergy.com/business/building-and-new-construction-nv/>
- APPLICANT SHALL BE RESPONSIBLE FOR PROTECTING GAS VALVES, ELECTRIC CABLES, DUCTS, AND OTHER STRUCTURES FROM SUPERIMPOSED LOADING CREATED BY CONSTRUCTION EQUIPMENT OR OTHERWISE. APPLICANT SHALL REPAIR OR PAY FOR ANY DAMAGE DONE TO ABOVE EQUIPMENT TO MEET NVE'S INSPECTOR APPROVAL. NVE STD. VOL. 17 RU0005U
- THIS MAP ILLUSTRATES DATA COLLECTED FROM VARIOUS SOURCES AND MAY NOT REPRESENT A SURVEY OF THE PREMISES. NO RESPONSIBILITY IS ASSUMED AS TO THE SUFFICIENCY OR ACCURACY OF THE DATA DISPLAYED HEREON.
- ALL WORK SHALL BE ACCOMPLISHED IN STRICT ACCORDANCE WITH THE SPECIFICATIONS SET FORTH IN THE ELECTRIC DISTRIBUTION GUIDE, VOL. 17 AS CURRENTLY ADOPTED BY NVE. THE CONTRACTOR SHALL SECURE COPIES OF THE AFOREMENTIONED CONSTRUCTION SPECIFICATIONS ON HIS OR HER OWN BEHALF.
- USE CAUTION! PRIOR TO EXCAVATION, CHECK TO ENSURE ADDITIONAL DEPTH IS NOT REQUIRED TO ACCOMMODATE GAS AND/OR WATER FACILITIES.
- SYMBOLS ARE NOT TO SCALE AND DO NOT NECESSARILY REPRESENT ACTUAL LOCATIONS OF FACILITIES.
- DO NOT OPEN NV ENERGY EQUIPMENT. NV ENERGY EQUIPMENT TO BE OPENED BY QUALIFIED NV ENERGY EMPLOYEES ONLY.

DRAWING	DESIGNED BY	DATE
ELECTRIC	Lino, Robert	5/19/21
GAS		

REVIEWED BY:		
Utility Designer	Engineer	Design Administrator
RIK 5.10.2021		5/31/2021

NO.	REVISION DESCRIPTIONS	DATE	DI
1		5/19/2021	RL
2			
3			
4			
5			
6			
7			



NV ENERGY CONTACT INFORMATION:
 COORDINATOR: LINO, ROBERT
 OFFICE: # (775)834-2828
 CELL: # (775) 385-8919
 FAX: #
 EMAIL: Robert.Lino@nvenergy.com
 DESIGNER: LINO, ROBERT
 INSPECTION HOTLINE: # 888/999-1556

CUSTOMER CONTACT INFORMATION:
 CUSTOMER: AT&T
 ATTENTION: PAUL KRAMER
 PHONE: # 858-361-5052
 FAX: #
 EMAIL: PAUL.KRAMER@SACW.COM
 CUST REP: # PAUL KRAMER
 PHONE: # 858-361-5052
 EMAIL: PAUL.KRAMER@SACW.COM

TOWNSHIP-RANGE-SECTION 1822-22	APN# 00847301
-----------------------------------	------------------

SOURCE INFORMATION:
 1207
 12.5KV NORM OUT OF
 RAY COUCH SUB

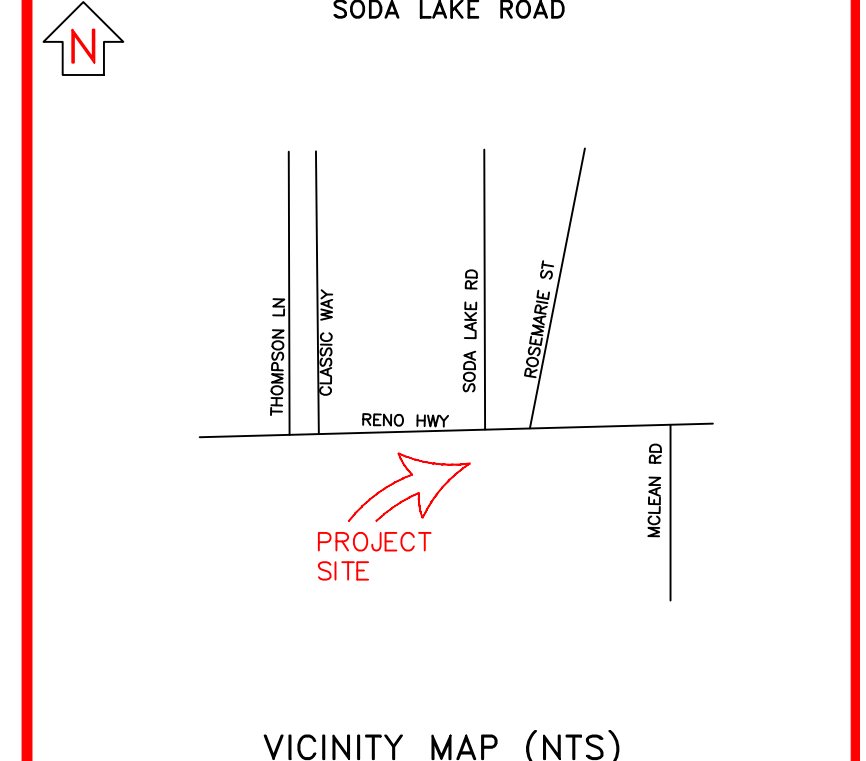

VICINITY MAP (NTS)
 E-5005
 PIONEER-FP-COMM-E-ATT
 MOBILITY

EXHIBIT "A" APPLICANT INSTALLED CONDUIT ELECTRIC DESIGN	AUD#: 3006776261	GAS#: 3006776261	ELE#: 3006776261
SCALE: 1"=50'			
SHEET#: E1 of E1			