

ORDINANCE NO. 983

AN ORDINANCE OF THE CITY OF CHIPLEY, FLORIDA, AMENDING ITS ADOPTED COMPREHENSIVE PLAN; PROVIDING FOR AUTHORITY; PROVIDING FOR FINDINGS OF FACT; PROVIDING FOR FUTURE LAND USE CHANGE OF A PARCEL OF PROPERTY WITH PARCEL NO. 00000000-00-2698-0001 LOCATED AT 1218 CAMPBELLTON AVENUE, FROM LOW DENSITY RESIDENTIAL TO HIGH DENSITY RESIDENTIAL; PROVIDING FOR AMENDMENT TO THE FUTURE LAND USE MAP; PROVIDING FOR A SMALL SCALE AMENDMENT TO THE ADOPTED COMPREHENSIVE PLAN; PROVIDING FOR THE FILING WITH THE CLERK OF CIRCUIT COURT AND THE FLORIDA DEPARTMENT OF COMMERCE; AND DECLARING AN EFFECTIVE DATE.

BE IT ORDAINED BY THE CITY COUNCIL OF CHIPLEY, FLORIDA, AS FOLLOWS:

SECTION 1. AUTHORITY. The authority for enactment of this Ordinance is Section 2 of the City Code, Sections 163.3187 F.S., 166.021 F.S. and the Comprehensive Plan.

SECTION 2. FINDING OF FACT. The City Council of Chipley, Florida finds:

- A. A public hearing has been held by the City Council after “due public notice”; and
- B. This amendment involves changing the Future Land Use designation imposed on a parcel of property with Parcel No. 00000000-00-2698-0001 located at 1218 Campbellton Avenue from Low Density Residential to High Density Residential; and
- C. This amendment is consistent with the City Land Use Regulations and the adopted Comprehensive Plan and is in the best interest of the City and its citizens.

SECTION 3. PURPOSE. The purpose of this Ordinance is to adopt a small-scale comprehensive plan amendment to the City of Chipley Comprehensive Plan also known as Ordinance 983. The amendment is identified as 24S1 and is described in Section 4 herein.

SECTION 4. FUTURE LAND USE MAP AMENDMENT. The Future Land Use Map of the City of Chipley, Florida, is hereby amended by changing the Future Land Use category imposed on a certain parcel of property with Parcel No. 00000000-00-2698-0001 located at 1218 Campbellton Avenue, containing a .417 acre parcel more or less, from Low Density Residential to High Density Residential, and as more specifically described as follows:

SUBJECT PARCEL – Parcel I.D. # 00000000-00-2698-0001.

COMMENCE AT THE SW CORNER OF LOT 10, BLOCK “A” OF
HAGERMAN ADDITION TO THE TOWN OF CHIPLEY, FLORIDA IN

SECTION 33, TOWNSHIP 5 NORTH, RANGE 13 WEST; THENCE RUN EAST ALONG THE NORTH BOUNDARY LINE OF CAMPBELLTON AVENUE 529 FEET TO THE TO THE POINT OF BEGINNING; THENCE N 01 DEGREES 20' WEST FOR 200 FEET; THENCE NORTH 89 DEGREES 20' EAST FOR 91.0 FEET MORE OR LESS TO THE EAST BOUNDARY LINE OF LOT 11, BLOCK "A"; THENCE S01 DEGREES 20' EAST FOR 200 FEET TO THE SOUTHEAST CORNER OF SAID LOT 11 BLOCK "A"; THENCE S89 DEGREES 20' WEST ALONG CAMPBELLTON AVENUE FOR 91.0 FEET MORE OR LESS TO THE POINT OF BEGINNING.

And also;

The land use change imposed on the subject parcel and map change is shown as Exhibit A, which is attached and made a part hereof by reference.

SECTION 5. EFFECTIVE DATE. The effective date of this plan amendment and ordinance shall be thirty-one (31) days after adoption on the second reading by the City Council, unless the amendment is challenged pursuant to Section 163.3187 of the Florida Statutes. If challenged, the effective date shall be a date a final order is issued by the Department of Economic Opportunity or other appropriate authority, finding the amendment in compliance in accordance with Section 163.3184 F.S.

INTRODUCED at a Regular meeting of the City Council of the City of Chipley, Florida, held at City Hall on the 9th day of April, 2024, and **PASSED** at a Regular meeting of the City Council of the City of Chipley, Florida, held at City Hall on the 14th day of May, 2024.

CITY OF CHIPLEY

Tracy L. Andrews, Mayor

ATTEST:

Sherry Snell
City Clerk

The form and legal sufficiency of the foregoing
has been reviewed and approved by the City Attorney.

Michelle Blankenship Jordan, City Attorney

EXHIBIT A

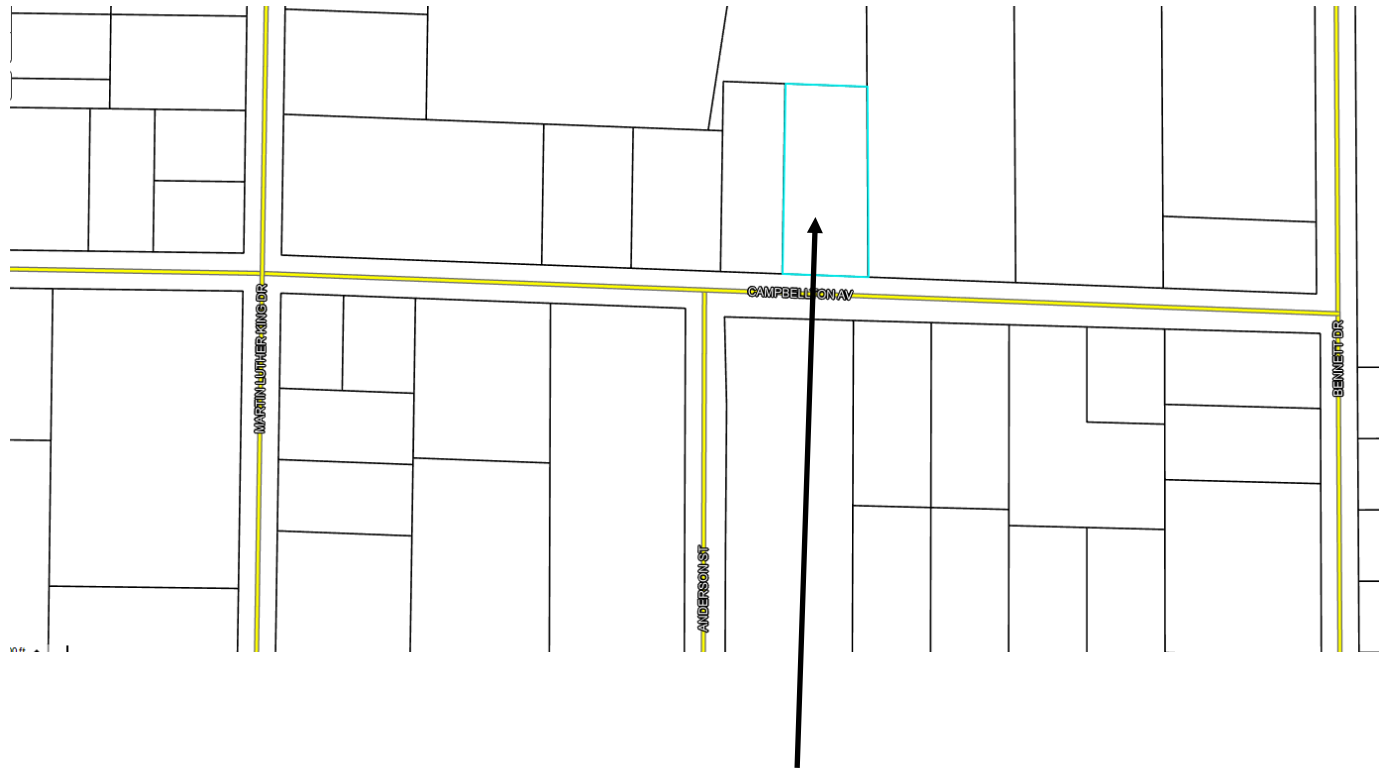

1218 Campbellton Avenue
Parcel No. 00000000-2698-0001
.417 acres more or less