

MATCH LINE SEE SHEET C-105

LIMIT OF RECLAIMED ASPHALT PAVEMENT SECTION

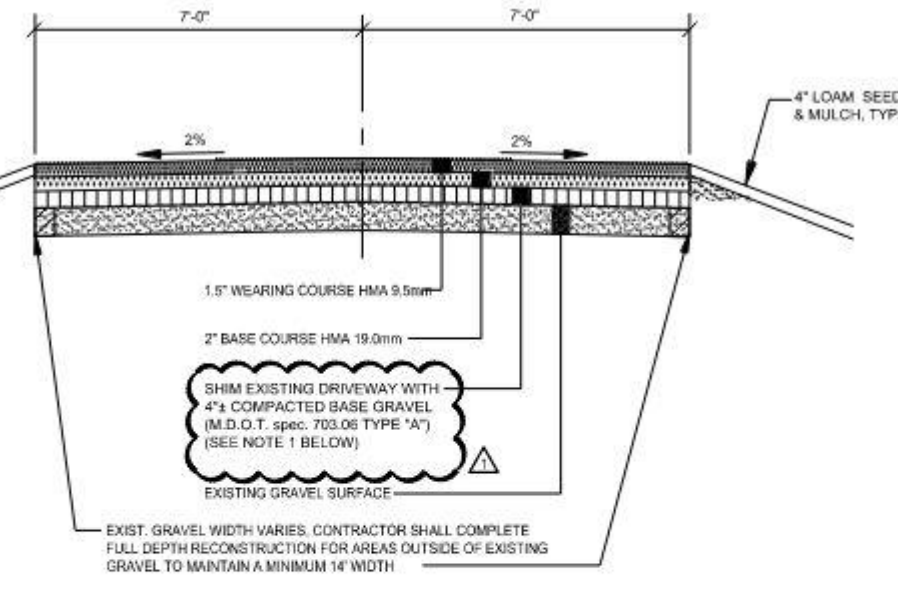

APPROXIMATE AREA OF PAVING = 11,000 S.F.
SEE DETAIL PLAN SHEET C-503

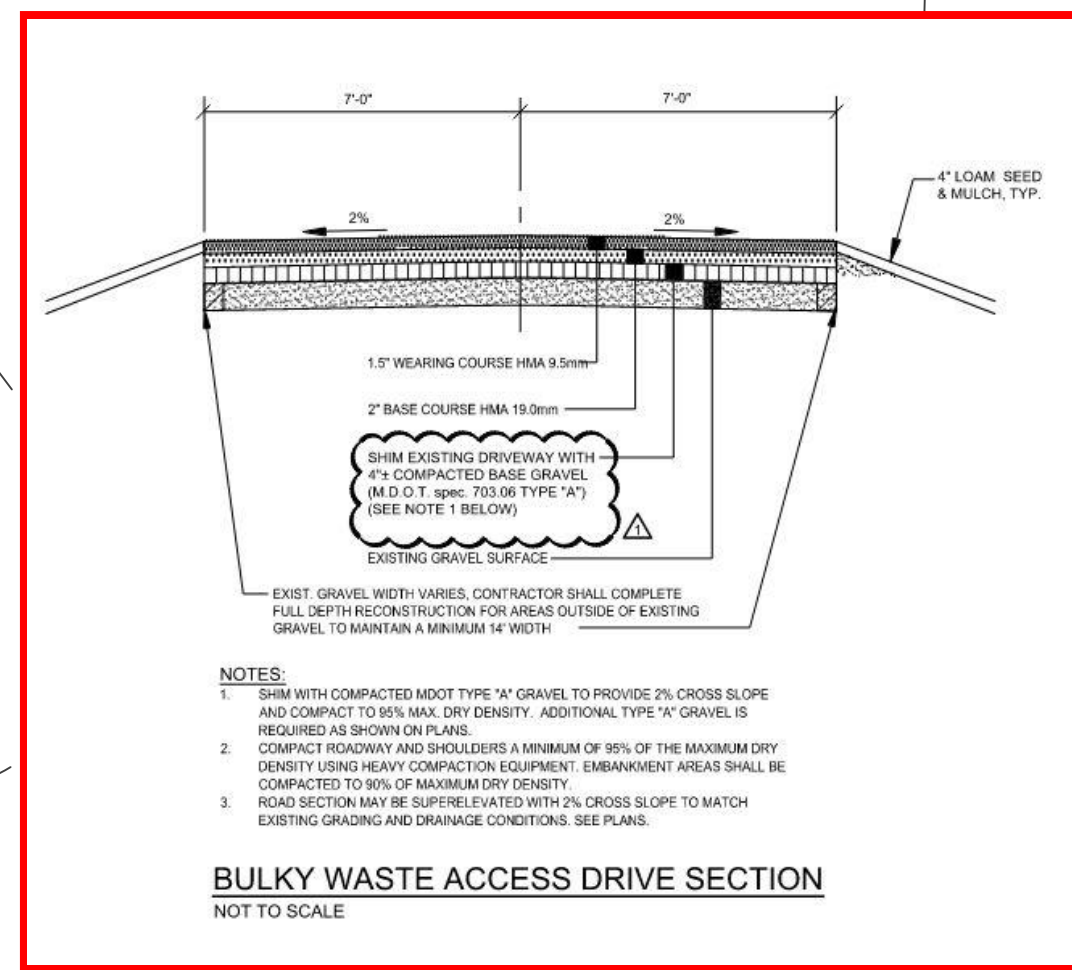
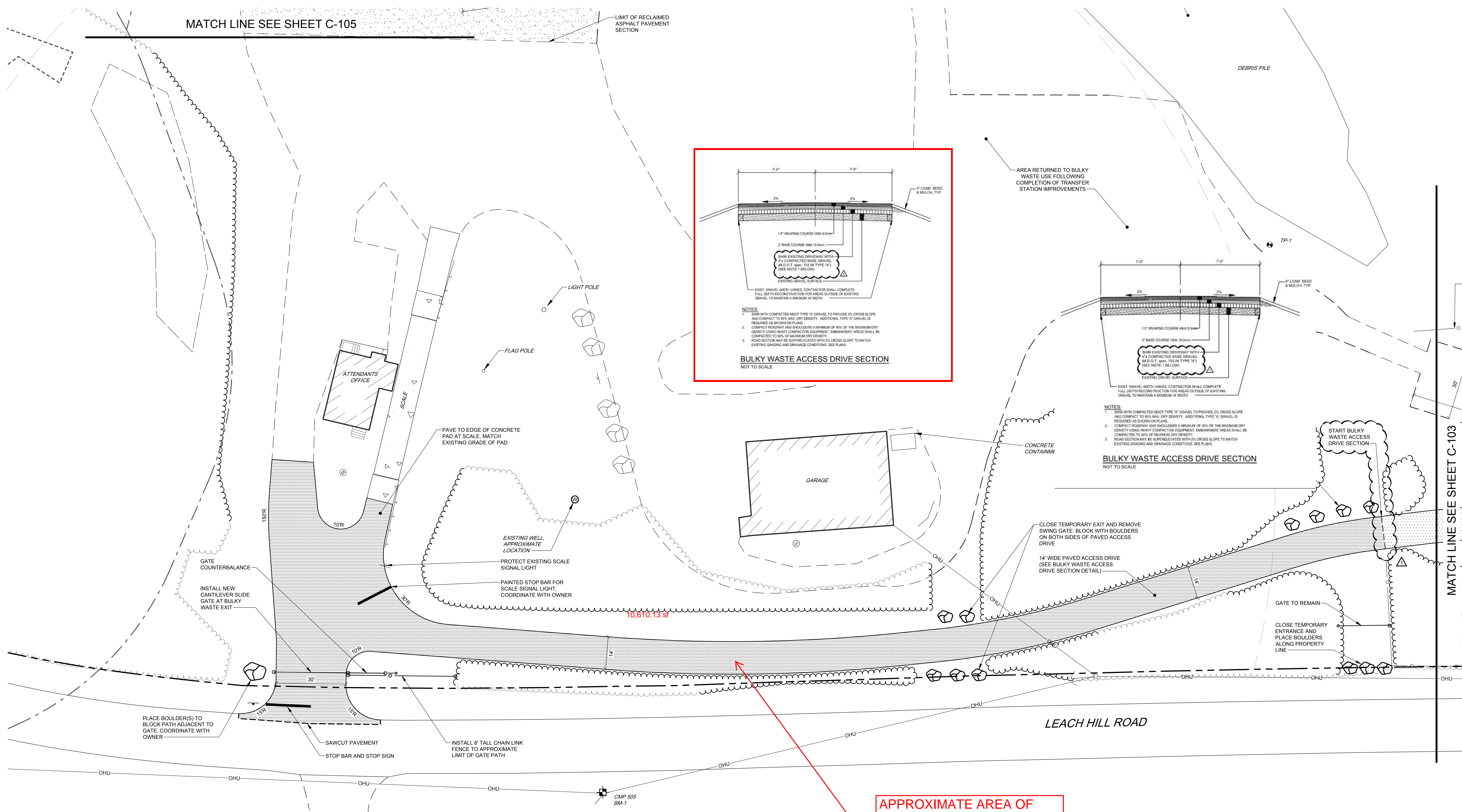
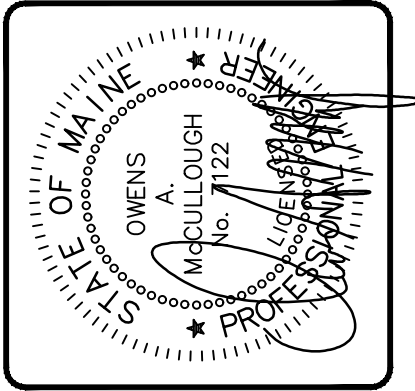
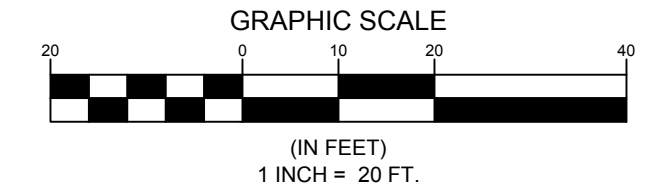

ISSUED FOR ADDENDUM NO. 3
DATE: 02-15-2024
BY: OAM
STATUS: REVISED

THIS PLAN SHALL NOT BE MODIFIED WITHOUT WRITTEN PERMISSION FROM SEBAGO TECHNICS, INC. ANY ALTERATIONS, AUTHORIZED OR OTHERWISE, SHALL BE AT THE USER'S SOLE RISK AND WITHOUT LIABILITY TO SEBAGO TECHNICS, INC.

SEBAGO TECHNICS
 WWW.SEAGOTECHNICS.COM
 75 John Roberts Rd.
 Sullis, IA
 South Portland, ME 04106
 Tel. 207-200-2100

SITE PLAN - 2
 OF:
BULKY WASTE & TRANSFER STATION IMPROVEMENTS
 LEACH HILL ROAD
 CASCO, MAINE 04015
 FOR:
TOWNS OF CASCO & NAPLES
 CASCO - 635 MEADOW ROAD
 NAPLES, P.O. BOX 1757
 NAPLES, ME 04055

DESIGNED	JBP
DRAWN	DAB
CHECKED	OAM
DATE	11/23/2022
SCALE	1" = 20'
PROJECT	20081

SHEET C-104

F:\Projects\20081\20081\DWG\Design\20081_S.dwg - 2/15/2024 4:27 PM - SHELLY STACEY

20081_S.dwg, TAB: C-104, SITE PLAN - 2