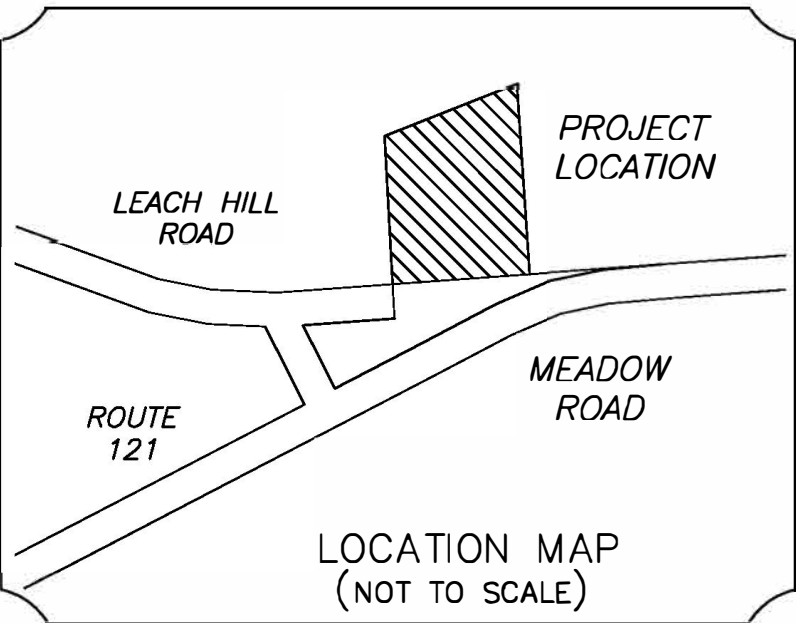
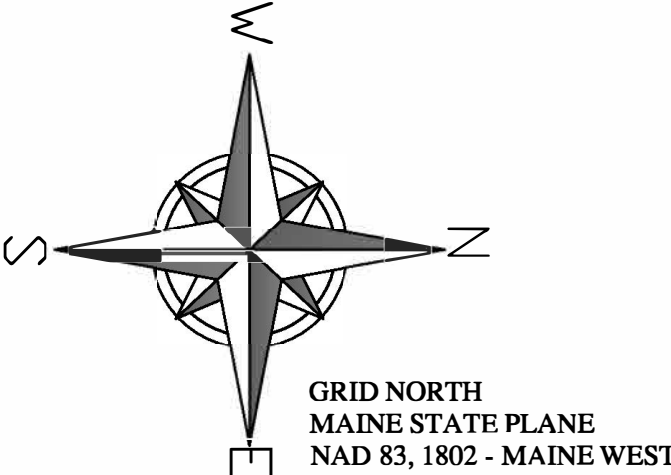
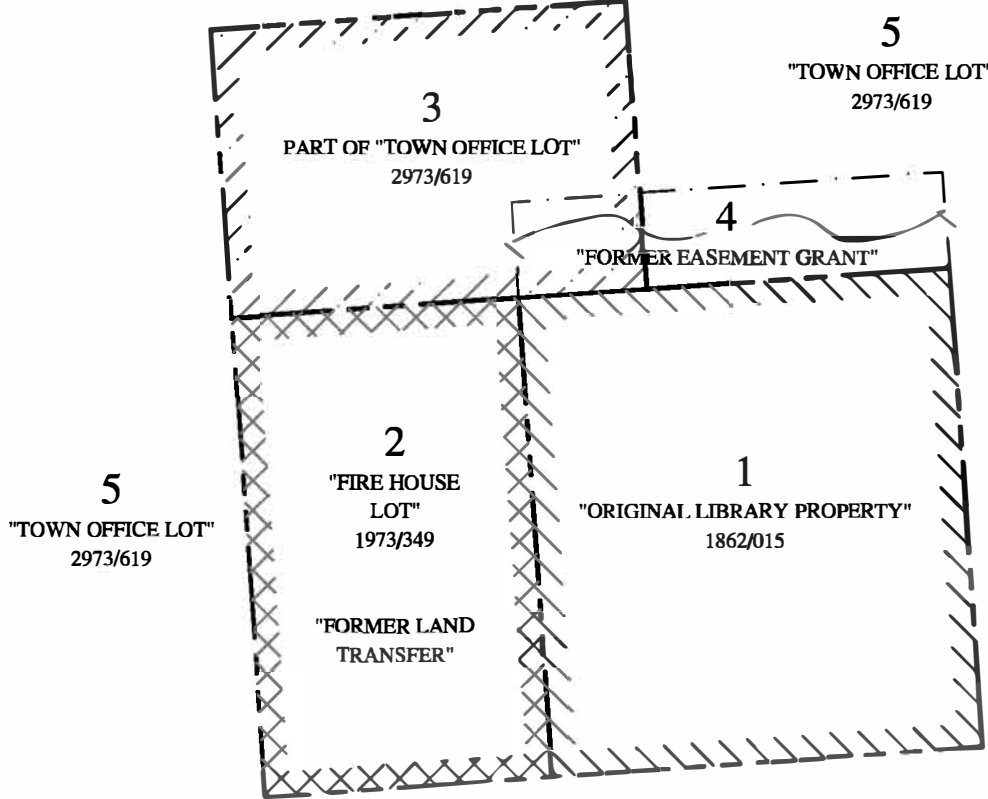

EXHIBIT A



LAND AREA DETAIL:
"ACQUIRED LIBRARY PROPERTY" CONSISTS OF AREAS 2 AND 3.
"LIBRARY PROPERTY" CONSISTS OF AREAS 1, 2 AND 3.



DETAIL

- 1) EXISTING AND PLANNED SETBACKS
2) "EXPANSION AND REBUILD AREAS"

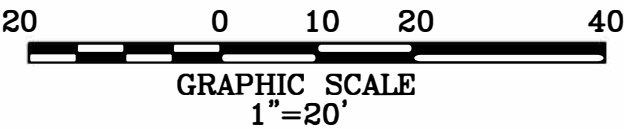
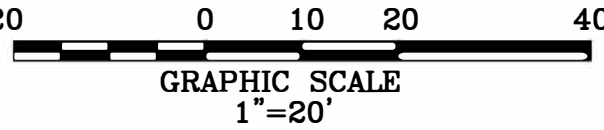
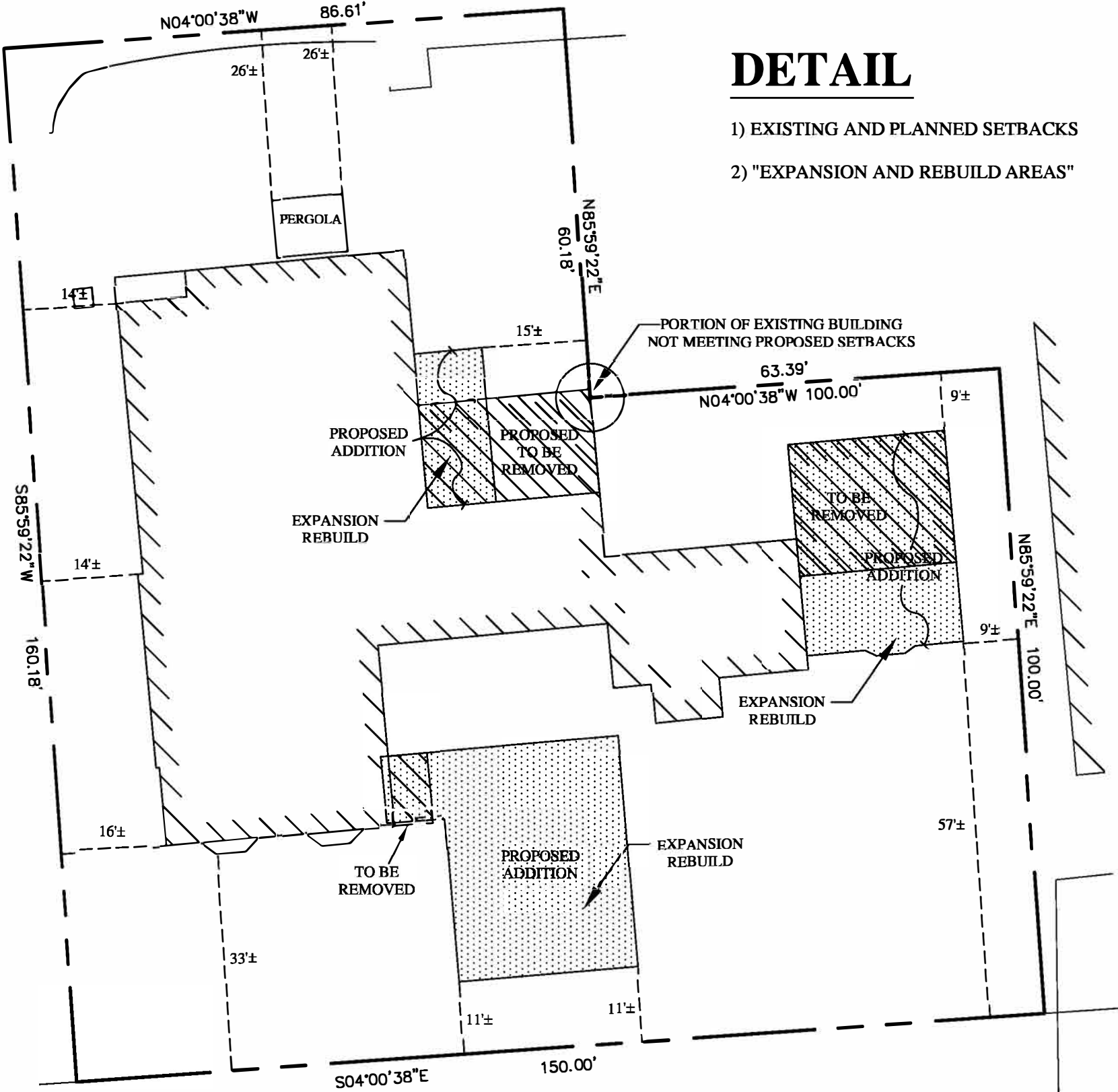

LEGEND:

- WLC — WATER LINE CONNECTION SEE NOTES 7 AND 8
SS — SANITARY SEWER SEE NOTE 5
SD — STORM DRAIN SEE NOTE 6

SURVEY NOTES:

- (1) THE OWNERS OF RECORD ARE THE CASCO LIBRARY ASSOCIATION AS DESCRIBED IN A DEED RECORDED IN BOOK 1862 PAGE 15 AND THE TOWN OF CASCO AS DESCRIBED IN DEEDS RECORDED IN BOOK 2973 PAGE 619, BOOK 1973 PAGE 349, BOOK 1337 PAGE 439, BOOK 6855 PAGE 66 AND BOOK 11665 PAGE 164 IN THE CUMBERLAND COUNTY REGISTRY OF DEEDS.
(2) BEARINGS ARE GRID NORTH.
(3) THE PARCEL CONTAINS APPROXIMATELY 20,212 SQUARE FEET.
(4) THE PROPOSED BUILDING ADDITIONS AND BUILDING AREAS TO BE REMOVED SHOWN ON THE DETAIL INSET ARE SCALED FROM PLAN REFERENCE 4.
(5) REFERENCE IS MADE TO A SUBSURFACE WASTEWATER DISPOSAL SYSTEM VARIANCE REQUEST DATED 9-22-16 REVISED 9-5-17 BY SEBAGO TECHNICS FOR THE GENERAL LOCATION OF THE SEPTIC SYSTEM.
(6) THERE IS A SUMP PUMP CONNECTION TO THE CATCHBASIN (SHOWN GRAPHICALLY-NOT FIELD LOCATED).
(7) THERE IS A WATER LINE ENTERING THE BACK OF THE BUILDING FROM OTHER LAND OF THE TOWN OF CASCO (SHOWN GRAPHICALLY-NOT FIELD LOCATED).
(8) THERE IS A WATER LINE FROM THE WELL TO THE TOWN BUILDING (SHOWN GRAPHICALLY-NOT FIELD LOCATED).
(9) UNABLE TO VERIFY IF OR HOW THE CATCHBASINS ARE CONNECTED.

PLAN REFERENCE:

- (1) BOUNDARY SURVEY 960 MEADOW ROAD CASCO, MAINE FOR: 960 MEADOW ROAD HOLDINGS, LLC DATED FEBRUARY 2020 BY SURVEY INC.
(2) CASCO INN CASCO, MAINE FOR CASCO INN ASSOCIATES DATED APRIL 1986 BY SURVEY INC.
(3) MAINE STATE HIGHWAY COMMISSION RIGHT OF WAY MAP CASCO CUMBERLAND COUNTY DATED SEPTEMBER 1986 SHC FILE NO. 3-182.
(4) REFERENCE IS MADE TO A SET OF PLANS DATED 12-16-2024 FOR THE CASCO PUBLIC LIBRARY ADDITION BY GAF ARCHITECTURE.
(5) MAINE STATE HIGHWAY COMMISSION RIGHT OF WAY MAP STATE AID HIGHWAY NO. 1 CASCO CUMBERLAND COUNTY DATED SEPTEMBER 1965 SHC FILE NO. 3-182.

CERTIFICATION:

I CERTIFY THAT THIS SURVEY CONFORMS TO THE STANDARDS OF THE MAINE BOARD OF LICENSURE FOR PROFESSIONAL LAND SURVEYORS AND IS CORRECT TO THE BEST OF MY KNOWLEDGE, INFORMATION AND BELIEF.

WILLIAM C. SHIPPEN S. 2118

EXISTING CONDITIONS SURVEY

5 LEACH HILL ROAD
CASCO, MAINE

FOR:

CASCO LIBRARY ASSOCIATION
5 LEACH HILL ROAD
CASCO, MAINE 04015
(CLIENT)

SURVEY BY:

SURVEY, INC.
P.O. BOX 210
WINDHAM, ME 04062
(207) 892-2556
INFO@SURVEYINCORPORATED.COM

DWN: DRR
DATE: MARCH 2025

CHK: WCS
JOB NO. 23-243-1

PRELIMINARY