

Kilon Wilson

From: Legal Assistant <legalassistant@nedbarnes.com>
Sent: Thursday, October 28, 2021 9:35 AM
To: Kilon Wilson
Subject: RE: 601 Augusta Ave.
Attachments: DoNotReply@intelsat.com_20211028_071126.pdf

Kilon,

The lot is comprised of all of Lot 1, Part of lots 2, 4 & 5.
It has never been combined into one parcel – there is not a recorded map showing this.

I've attached the map from 1968 and highlighted the lots you own. You will see the line that cuts through lots 2,4 and 5. You will also see the diagonal line that shows what was the Southern Line of Carolina Beach showing that the parcel was not part of the Town of Carolina Beach in 1968 We are unable to find any recorded documents explaining why this parcel of land is not under the Town of Carolina Beach. It is our supposition that when the US Government acquired the large adjacent parcel certain lots were exempted out to create an even boundary line. It appears that this parcel was overlooked at that time. The Town of Carolina Beach should have an Annexation Map that shows when the other lots on your block were incorporated into the Town limits.

You can see from the link below that this parcel is an irregularity to that boundary line.

<https://etax.nhcgov.com/pt/maps/map.aspx?sIndex=8&idx=1&LMparent=20>

Hope this helps!

Thank you,
Kris Redmond
Legal Assistant
910-458-4466

Law Office of Ned M. Barnes
Attorney at Law
A-3 Pleasure Island Plaza (USPS)
1009 N. Lake Park Blvd., Suite C-2 (Overnight)
Carolina Beach, NC 28428
Telephone: 910-458-4466
Facsimile: 910-458-8845

OUR WIRING INSTRUCTIONS HAVE CHANGED AS OF NOV. 15, 2018.

OUR OFFICE IS LOCATED ON THE EAST COAST, EASTERN STANDARD TIME APPLIES. OUR OFFICE HOURS ARE 8:30 AM TO 5:00 PM, EASTERN STANDARD TIME.

10/8



STATE OF NORTH CAROLINA NEW HANOVER CO.
THE CERTIFICATE OF CROCKETT W. HEWLETT,
NOTARY PUBLIC OF NEW HANOVER COUNTY,
IS CERTIFIED TO BE CORRECT.

"E.C. PERSONS" LINE THIS THE 6TH DAY OF MARCH, A.D. 1968
BY LOIS C. LE RAY REG. OF DEEDS
BY *Lois C. Le Ray*

SOUTHERN LINE
OF CAROLINA BEACH
AS SHOWN ON MAP
RECORDED IN MAP
BOOK 2, PAGE 58.

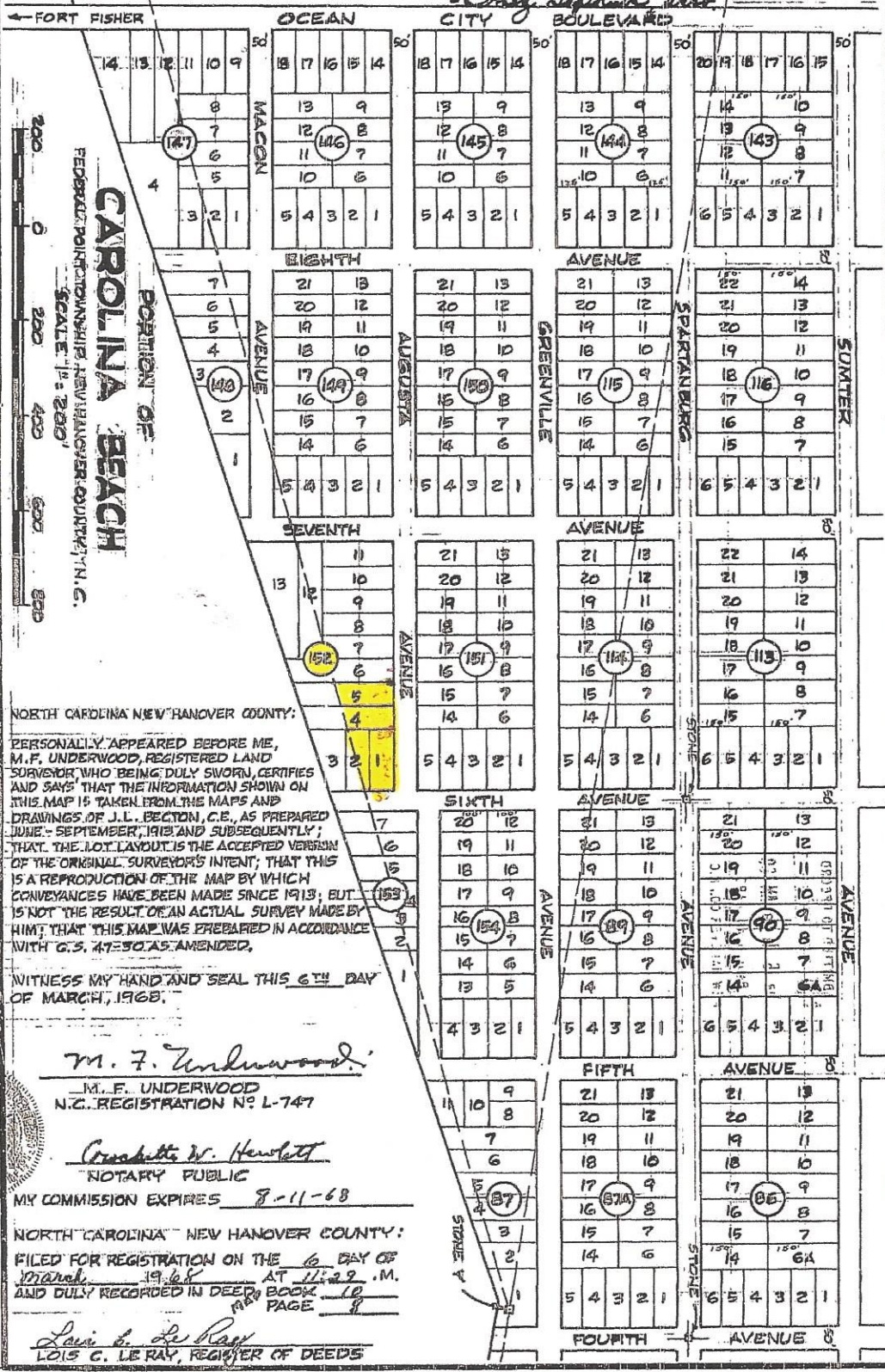

NORTH CAROLINA NEW HANOVER COUNTY:

PERSONALLY APPEARED BEFORE ME,
M. F. UNDERWOOD, REGISTERED LAND
SURVEYOR WHO BEING DULY SWORN, CERTIFIES
AND SAYS THAT THE INFORMATION SHOWN ON
THIS MAP IS TAKEN FROM THE MAPS AND
DRAWINGS OF J. L. BECTON, C.E., AS PREPARED
JUNE, SEPTEMBER, 1913 AND SUBSEQUENTLY;
THAT THE LOT LAYOUT IS THE ACCEPTED VERSION
OF THE ORIGINAL SURVEYOR'S INTENT; THAT THIS
IS A REPRODUCTION OF THE MAP BY WHICH
CONVEYANCES HAVE BEEN MADE SINCE 1913, BUT
IS NOT THE RESULT OF AN ACTUAL SURVEY MADE BY
HIM; THAT THIS MAP WAS PREPARED IN ACCORDANCE
WITH G.S. 47-50 AS AMENDED.

WITNESS MY HAND AND SEAL THIS 6TH DAY
OF MARCH, 1968.

M. F. Underwood

M. F. UNDERWOOD
N.C. REGISTRATION NO. L-747

Crockett W. Hewlett
NOTARY PUBLIC

MY COMMISSION EXPIRES 8-11-68

NORTH CAROLINA NEW HANOVER COUNTY:
FILED FOR REGISTRATION ON THE 6 DAY OF
March 1968 AT 11:22 A.M.
AND DULY RECORDED IN DEED BOOK 18
PAGE 8

Lois C. Le Ray
LOIS C. LE RAY, REGISTER OF DEEDS

