

PARKING CALCULATIONS	
REQUIRED OFF-STREET PARKING:	103.2 (104)
BOAT SLIP - 1 PER SLIP (89 SLIPS)	89
RETAIL (FLOATING PLATFORM)	
1 SPACE PER 200 SF (312/200)	1.6
EATING & DRINKING ESTABLISHMENTS (FLOATING PLATFORM)	
1 SPACE PER 110 SF (INDOOR)	3.0
328 SF/110 SF	
1 SPACE PER 220 SF (OUTDOOR)	3.1
LOWER LEVEL 689 SF/220 SF	
UPPER LEVEL 560SF/220 SF	2.5
RESIDENTIAL	2.0
EMPLOYEE SPACES 1 PER 2 EMPLOYEES	2.0
TOTAL EXISTING AND PROPOSED	104

RETAIL, EATING & DRINKING SF DATA PROVIDED BY THE OWNERS.

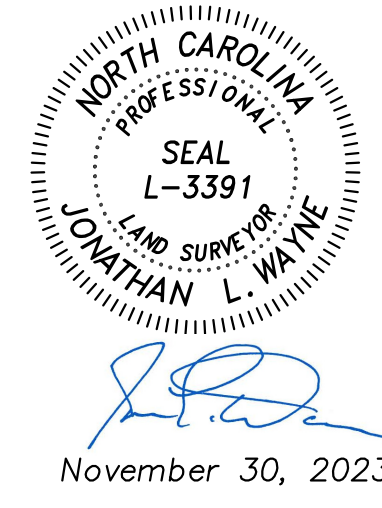
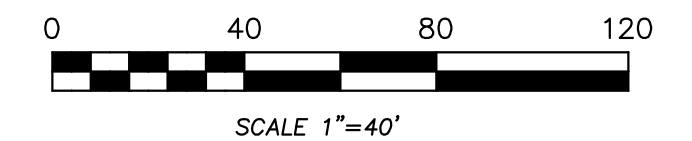
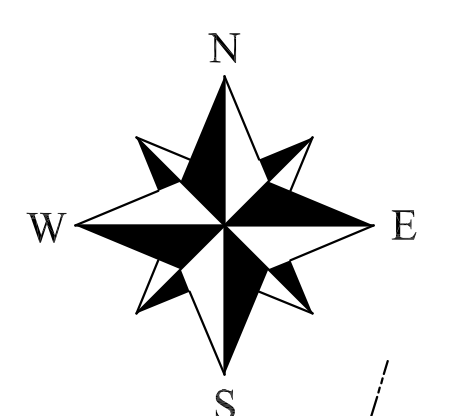
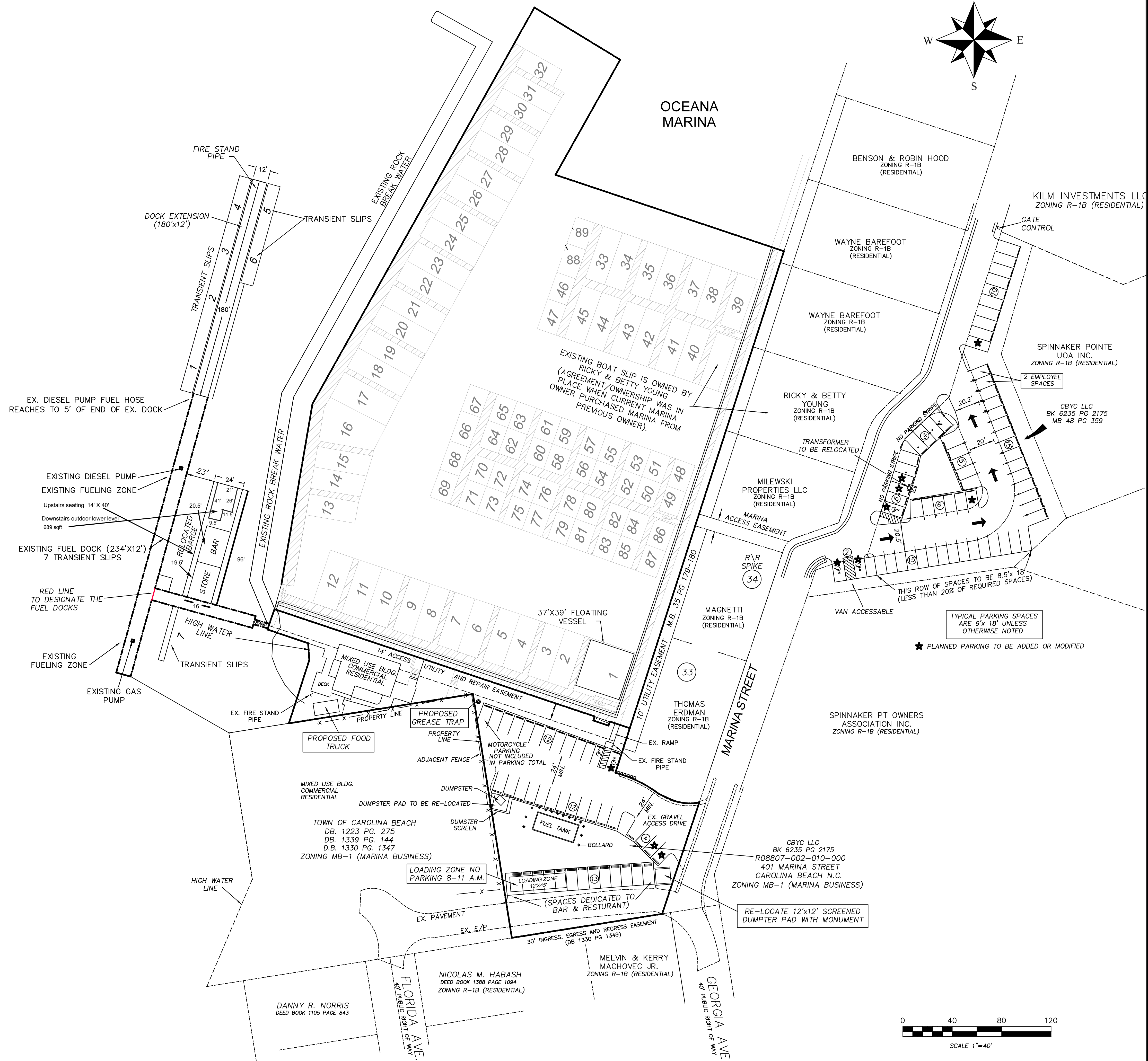

Notes
 The original as-built survey was completed in May of 2008 by Hanover Design Services, P.A. This survey updated the following items only.

1. Barge re-location, Dock Addition
2. Dumpster re-location - Asbuilt
3. Updated Parking based on recent addition & future Additions/Alterations

All Proposed Changes and Alterations to be approved by the Town of Carolina Beach.

NO.	REVISIONS	DATE
1	TOWN COMMENTS, ADDITIONS	10/13/23
2	TOWN COMMENTS, ADDITIONS	11/2/23
3	TOWN COMMENTS, ADDITIONS	11/30/23

Partial As-Built/Parking Layout Revisions
CAROLINA BEACH MARINA AND YACHT CLUB
 401 MARINA STREET
 CAROLINA BEACH, NC

HANOVER DESIGN SERVICES, P.A.
 LAND SURVEYORS, ENGINEERS & LAND PLANNERS

1123 FLORAL PARKWAY
 WILMINGTON, N.C. 28403
 PHONE: (910) 353-8002
 LICENSE # P-C-0597

Copyright © Hanover Design Services, P.A. All rights reserved. Reproduction or use of the contents of this document, or addition or deletion to the content, is prohibited without the written consent of Hanover Design Services, P.A. This document is the property of Hanover Design Services, P.A. and shall remain the property of Hanover Design Services, P.A. even if it is loaned, copied, or otherwise disseminated. It is to be used only for the project and site identified in the title block of this document.