

A person wearing a blue helmet, a black t-shirt, and light blue jeans is riding a teal bicycle on a pump track. The track is made of asphalt and has several mounds. The person is in the middle of a pump stroke, with the front wheel lifted. The background shows a park-like setting with trees, a fence, and some buildings under a clear sky. The overall scene is bright and sunny.

# McGregor Asphalt Pump Track

City Council  
September 12, 2024

# McGregor Asphalt Pump Track Background



### Explanation





-  = 2 feet of Arsenic impacted soil excavated, off-hauled, and replaced with 2 feet of clean fill. Delineation fabric installed at base of clean (2 ft bgs)
-  = Reinforced concrete cap over compacted fill
-  = Delineation fabric separates native soil from 4 inch base rock & 2 inch thick asphalt cap over compacted fill. Includes parking lot & walkway
-  = Landscaping area capped with 2

FIGURE 2  
Project 2x432

## SITE MAP - PROTECTIVE CAP COVERAGE AREA

SITE: MCGREGOR PARK DEVELOPMENT  
ADDRESS: 1560 MCGREGOR PARK DRIVE, CAPITOLA, CA

DATE: MAY 2020 REVISIONS/NOTES:



# McGregor Asphalt Pump Track Background



# McGregor Asphalt Pump Track Background



# McGregor Asphalt Pump Track Background



# McGregor Asphalt Pump Track

## Proposed Project



**FY 2024-25 Budget:** Allocated \$30,000 for pump track refurbishment

- **Additional Funding:** Staff sought donations to supplement budget

**Proposed Project:** Upgrade the earthen track to asphalt

- **Reduced Maintenance**
- **Improved Longevity**
- **Enhanced Riding Experience**

# McGregor Asphalt Pump Track Proposed Project



# McGregor Asphalt Pump Track Construction Contract



## July 2024 RFP

- **Sole Response: American Ramp Company**



## Extensive Experience

- **Space Maximization**
- **Drainage**
- **Long-term Durability**



# McGregor Asphalt Pump Track

## Proposed Design



### Asphalt Pump Track Upgrade

Design services, manufacturing, installation, and construction

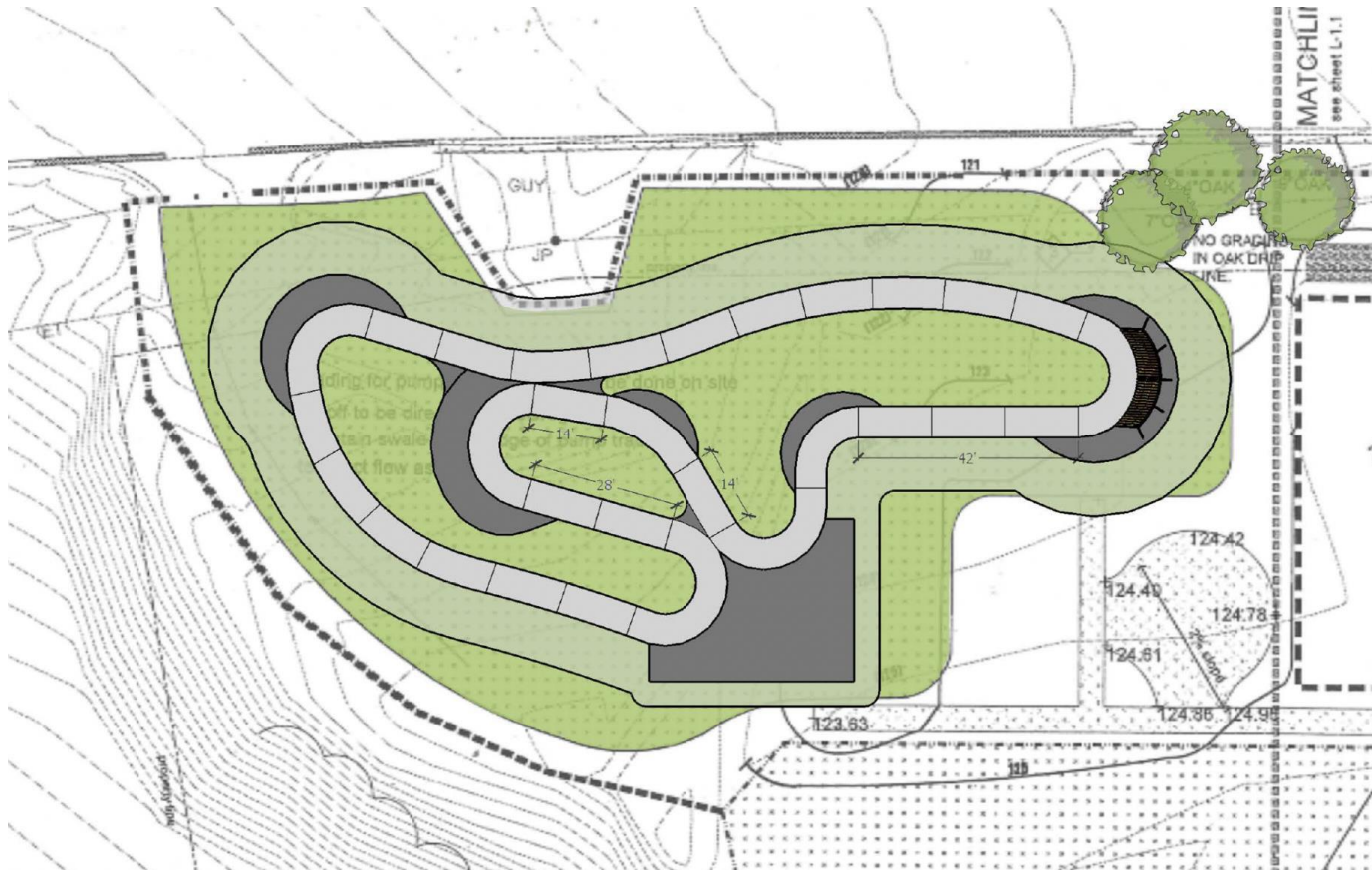

# McGregor Asphalt Pump Track Proposed Design



## Wall Ride Feature

90-degree prefabricated wall ride

Visually appealing and enhances rider experience



# McGregor Asphalt Pump Track

## Monte Foundation Donation



**\$90,000 Donation**

**10-year Recognition Request**

- **Donor acknowledgment on wall ride feature, or**
- **Additional signage on the track**

# McGregor Asphalt Pump Track Timeline



**Design Phase: 8 weeks**



**Construction & Installation: 4-6 weeks**



**Total Estimated Completion: 12-14 weeks**



Expected completion: **Late  
this year or early next year**

Subject to weather

# McGregor Asphalt Pump Track

## Fiscal Impact

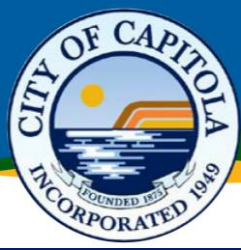

### Total Project Budget

- FY 2024-25 allocation: **\$30,000**
- Monte Foundation donation: **\$90,000**
- Total funding available: **\$120,000**

### Contract with American Ramp Company

- **Within budget** at **\$120,125**.

# Recommended Action



- **Authorize the City Manager** to execute a Professional Services Agreement with American Ramp Company for McGregor Asphalt Pump Track Project in an amount not to exceed \$120,125.
- **Adopt Resolution:** Amend FY 2024-25 Budget to accept \$90,000 donation for project.

