

PRICING AND SCOPE OF WORK - OPTION 1

601 McKinley
Joplin, MO 64801
Toll-free 877-RAMP-778
Local 417-206-6816
Fax 417-206-6888
sales@americanrampcompany.com



**PRICING AND SCOPE LETTER – OPTION 1
PUMP TRACK RENOVATION – CAPITOLA, CA
QUOTE # Q27392
AUGUST 12, 2024**

AMERICAN RAMP COMPANY/ACTION SPORTS CONSTRUCTION - PRICING

DESIGN AND CONSTRUCTION - **\$103,647.00**

Timeline / Construction Duration

- Design: 8 weeks – Estimated completion time of mid-October 2024.
- Construction – Estimated duration of 4-6 weeks completing in mid-December 2024.

AMERICAN RAMP COMPANY/ACTION SPORTS CONSTRUCTION - SCOPE OF WORK

Task 1.0 Design Services:

1.1 Project Start-Up Meeting

- Meet with project team, stakeholders, and team consultants to review scope of work, schedule, project goals, and common understanding of the project.
- Review and finalization of work plan including proposed site program, pedestrian circulation, spectator viewing, and safety sight lines.
- Identify project representatives and communications protocol.

1.2 Project Site Visit & Documentation

- Walk project site with staff to review opportunity and constraints of existing site conditions.

1.3 Present Conceptual Design Package

- Create preliminary Bike Park concept integrating the finding of the public engagement.
- Verify design is responsive to site conditions and budget.
- Submit preliminary site plan and landscape concept depicting integration to existing site.
- Provide illustrations including high quality 3D renderings of Bike Park design

1.4 Revise Conceptual Designs

- Revise preferred conceptual design based on feedback from plan review.

1.5 Present Approved Final Design Package

- Present approved design to Bike Park
- Obtain specific input for revisions.

Task I Deliverables:

- Project schedule.

601 McKinley
Joplin, MO 64801
Toll-free 877-RAMP-778
Local 417-206-6816
Fax 417-206-6888
sales@americanrampcompany.com



- Conceptual Design
- High quality 3D computer renders depicting the features of the conceptual designs.

TASK 2.0- MANUFACTURING, INSTALLATION, AND CONSTRUCTION

2.1 Includes*:

- All labor, supplies, tools, materials, and equipment required per scope of work
- Fabrication and installation of all Bike Park elements
- Rough Grading
- Grooming per scope of work
- Any necessary drainage per requirements
- Construction Fencing
- Bonding

2.2 Excludes*:

- Permanent Fencing
- Permits and fees:
- Site testing and inspections: standard proctor/density testing, onsite concrete cylinders, engineering, surveying, or testing services.
- Taxes
- Off hauling of any organic materials or extra fill materials generated during project.
- Utility, mechanical, electrical, plumbing work, relocation, or repairs of any kind.
- Any surface treatments other than the agreed upon capping materials.
- Professional services provided by Architects, Surveyors, Geo-technical & Electrical Engineers
- Any landscaping
- Dewatering, silt fence, soil stabilization, erosion control.
- Removal and/or replanting of any trees or shrubs.

2.3 CUSTOMER PROVIDES*:

- Unobstructed, safe, and continuous access to work area with heavy equipment. All weather roads for heavy equipment.
- All necessary site information including topography, site surveying, and elevations.
- Water lines marked

Task II Deliverables:

- Fully manufactured, installed, and constructed Bike Park

Add Alternates

- 90-degree prefabricated wallride - **\$16,474.90**
 - Includes shipping, installation, and sales tax
- Park Signage – See attached catalog with various options and examples
 - Does not include shipping, installation, or tax

PRICING AND SCOPE OF WORK - OPTION 2

601 McKinley
Joplin, MO 64801
Toll-free 877-RAMP-778
Local 417-206-6816
Fax 417-206-6888
sales@americanrampcompany.com



PRICING AND SCOPE LETTER – OPTION 2 PUMP TRACK RENOVATION – CAPITOLA, CA QUOTE # Q27392 AUGUST 12, 2024

AMERICAN RAMP COMPANY/ACTION SPORTS CONSTRUCTION - PRICING DESIGN AND CONSTRUCTION - **\$81,600.00**

Timeline / Construction Duration

- Design: 8 weeks – Estimated completion time of mid-October 2024.
- Construction – Estimated duration of 4-6 weeks completing in mid-December 2024.

AMERICAN RAMP COMPANY/ACTION SPORTS CONSTRUCTION - SCOPE OF WORK

Task 1.0 Design Services:

1.1 Project Start-Up Meeting

- Meet with project team, stakeholders, and team consultants to review scope of work, schedule, project goals, and common understanding of the project.
- Review and finalization of work plan including proposed site program, pedestrian circulation, spectator viewing, and safety sight lines.
- Identify project representatives and communications protocol.

1.2 Project Site Visit & Documentation

- Walk project site with staff to review opportunity and constraints of existing site conditions.

1.3 Present Conceptual Design Package

- Create preliminary Bike Park concept integrating the finding of the public engagement.
- Verify design is responsive to site conditions and budget.
- Submit preliminary site plan and landscape concept depicting integration to existing site.
- Provide illustrations including high quality 3D renderings of Bike Park design

1.4 Revise Conceptual Designs

- Revise preferred conceptual design based on feedback from plan review.

1.5 Present Approved Final Design Package

- Present approved design to Bike Park
- Obtain specific input for revisions.

Task I Deliverables:

- Project schedule.

601 McKinley
Joplin, MO 64801
Toll-free 877-RAMP-778
Local 417-206-6816
Fax 417-206-6888
sales@americanrampcompany.com



- Conceptual Design
- High quality 3D computer renders depicting the features of the conceptual designs.

TASK 2.0- MANUFACTURING, INSTALLATION, AND CONSTRUCTION

2.1 Includes*:

- All labor, supplies, tools, and equipment required per scope of work
- Fabrication and installation of all Bike Park elements
- Rough grading
- Grooming per scope of work
- Any necessary drainage per requirements
- Construction Fencing
- Bonding

2.2 Excludes*:

- Permanent Fencing
- Permits and fees:
- Site testing and inspections: standard proctor/density testing, onsite concrete cylinders, engineering, surveying, or testing services.
- Taxes
- Off hauling of any organic materials or extra fill materials generated during project.
- Utility, mechanical, electrical, plumbing work, relocation, or repairs of any kind.
- Any surface treatments other than the agreed upon capping materials.
- Professional services provided by Architects, Surveyors, Geo-technical & Electrical Engineers
- Any landscaping
- Dewatering, silt fence, soil stabilization, erosion control.
- Removal and/or replanting of any trees or shrubs.

2.3 CUSTOMER PROVIDES*:

- Unobstructed, safe, and continuous access to work area with heavy equipment. All weather roads for heavy equipment.
- All necessary site information including topography, site surveying, and elevations.
- Water lines marked
- 120 tons of asphalt and 15 tons of rip rap rock

Task II Deliverables:

- Fully manufactured, installed, and constructed Bike Park

Add Alternates

- 90-degree prefabricated wallride - **\$16,474.90**
 - Includes shipping, installation, and sales tax
- Park Signage – See attached catalog with various options and examples
 - Does not include shipping, installation, or tax

PRELIMINARY DESIGN

Preliminary Pump Track Design

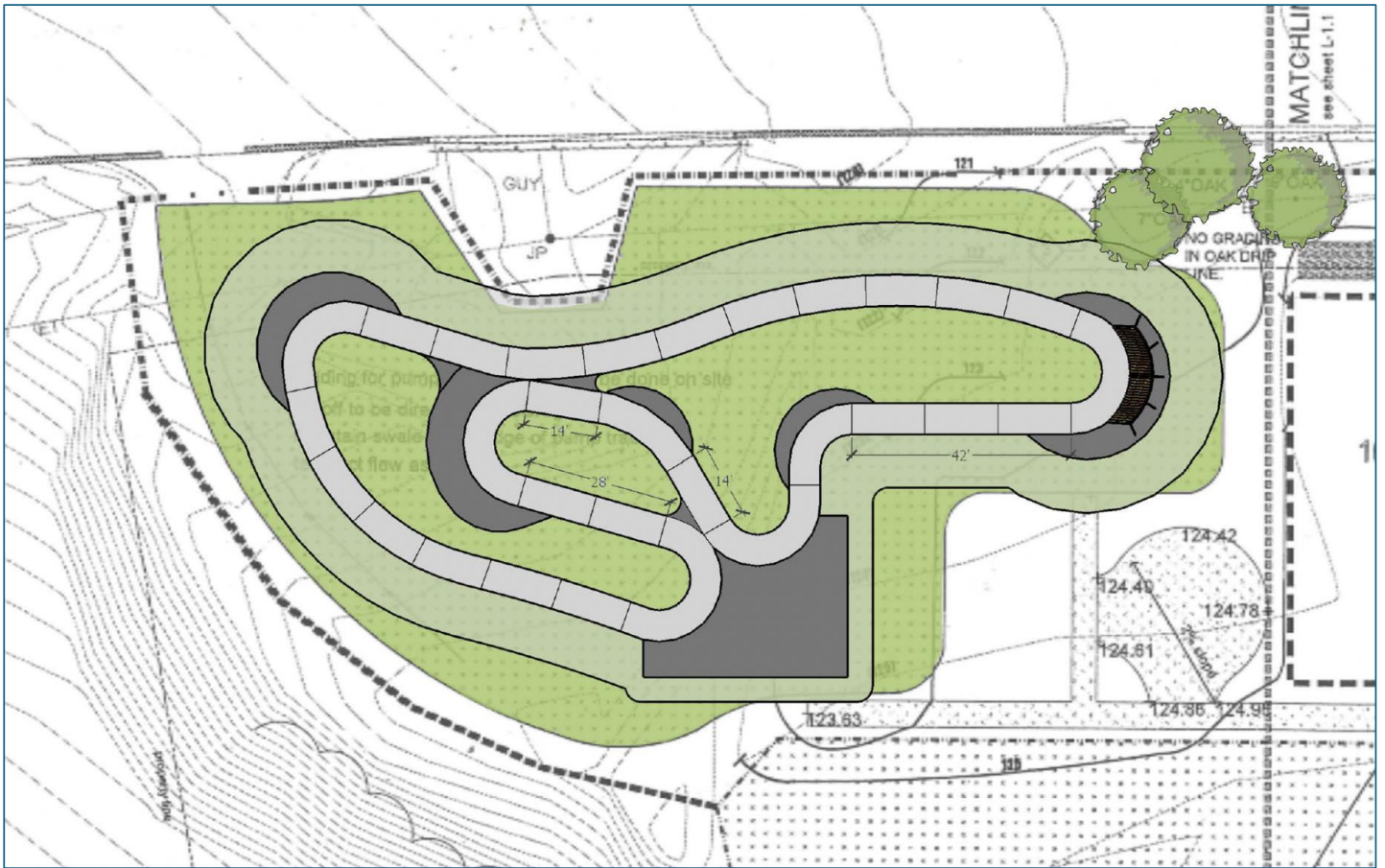

Add Alternate Wall Ride Feature

