

PROJECT DESCRIPTION:
 WE WOULD LIKE TO MAKE THE TEMPORARY OUTDOOR SEATING AREA A PERMANENT ADDITION TO BOLSTER THE LIMITED INDOOR SEATING AREAS.
 THE CURRENT OUTDOOR SEATING AREA IS IN FRONT OF THE EXISTING TAP ROOM AREA AND HAS 6, SIX FOOT LONG PICNIC STYLE TABLES AND 1 SIX FOOT LONG ADA ACCESSIBLE TABLE. THE PERIMETER OF THE SEATING AREA IS ENCLOSED ON FOUR SIDES WITH PLANTERS AND BARRELS, WITH TWO OPENINGS THAT ACCESS TO AND FROM THE TAP ROOM, ONE OF WHICH HAS A WOOD RAMP WITH A NON-SLIP COATING AND ONE ENTRANCE TO ALLOW ACCESS TO AND FROM THE PARKING LOT.

PROJECT DATA:
 GROSS SITE AREA
 45,725 S.F.
 RELEVANT EXISTING ADJACENT BUILDING A 7,072 S.F.
 BUILDING A SECOND FLOOR 2,448 S.F.
 EXISTING ADJACENT BUILD B 4,803 S.F.
 OCCUPANCY - B,F1,S1
 SPRINKLERED
 CONSTRUCTION - V-B
 TOTAL EXISTING PARKING AREA 43 STALLS (41 STANDARD, 2 ACCESSIBLE)
 TOTAL AFFECTED STANDARD PARKING SPACES 9 (8 FOR SEATING, 1 FOR BICYCLE PARKING) AT FRONT OF BUILDING A.

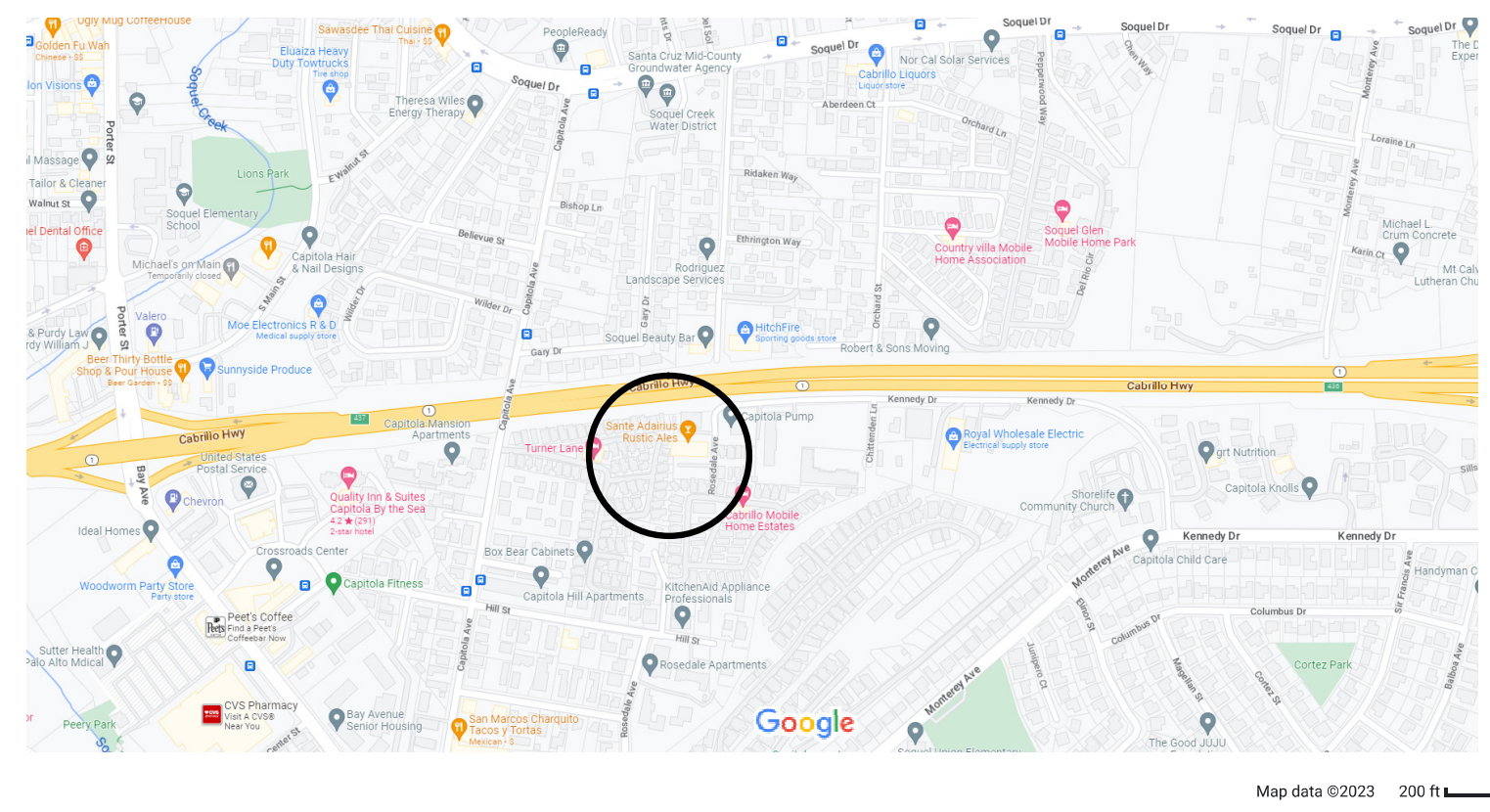

APN
 036-031-01

NO.	DESCRIPTION	BY	DATE

SHEET TITLE:
 PROJECT DESCRIPTION
 SITE MAP
 PROJECT DATA
 PROPOSED SITE PLAN

PROJECT DESCRIPTION:
 SANTE ADARIUS PARKING GARDEN
 100 KENNEDY DRIVE
 CAPITOLA, CA 95010

DRAWINGS PROVIDED BY:
 DOUGLAS McCLOSKEY CONSTRUCTION
 p.o. box 783
 Santa Cruz, ca 95061
 831.247.2687

DATE:
 5/14/2023

SCALE:
 1/16"=1'

SHEET:
A-1

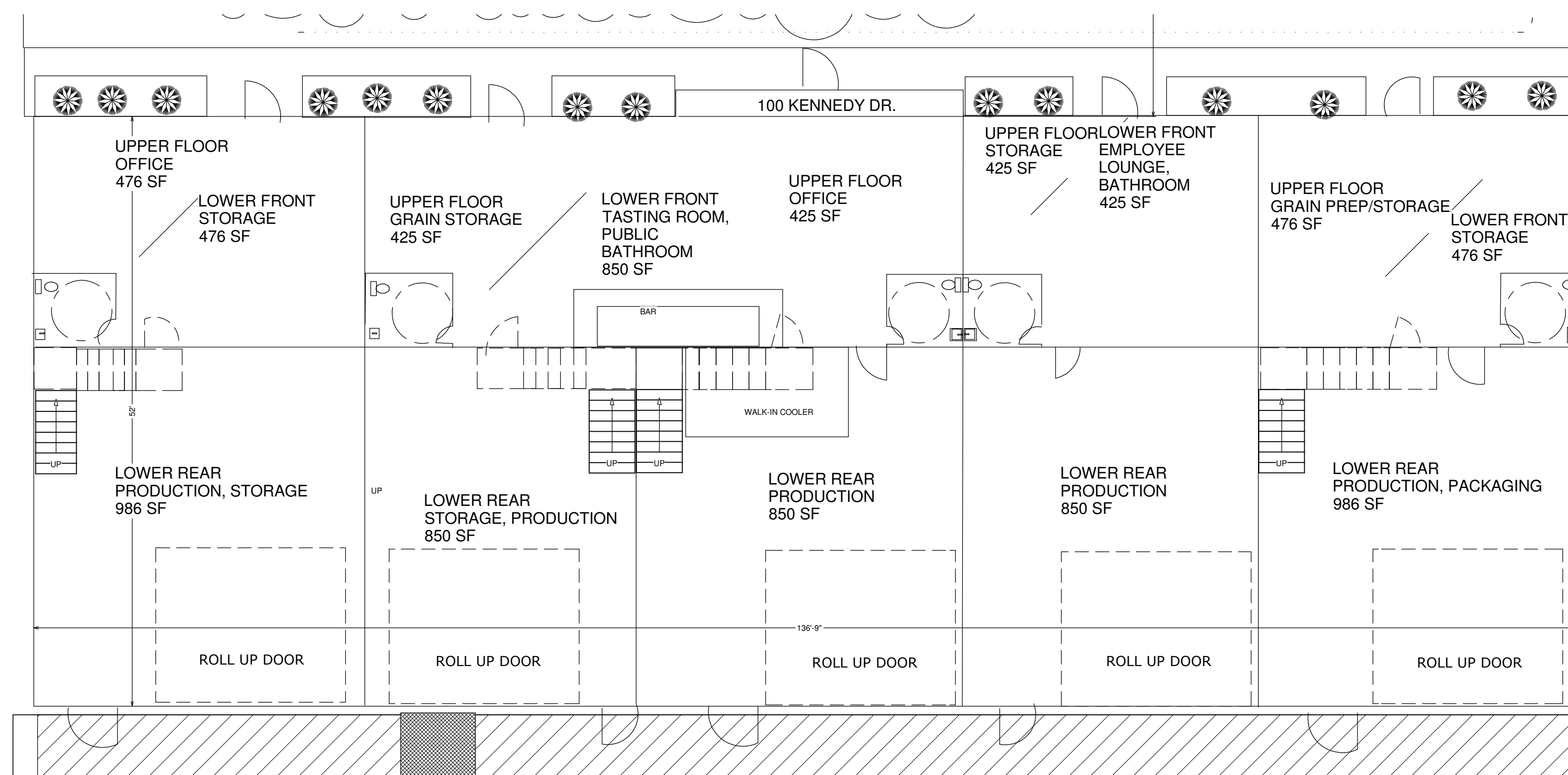

1st Floor

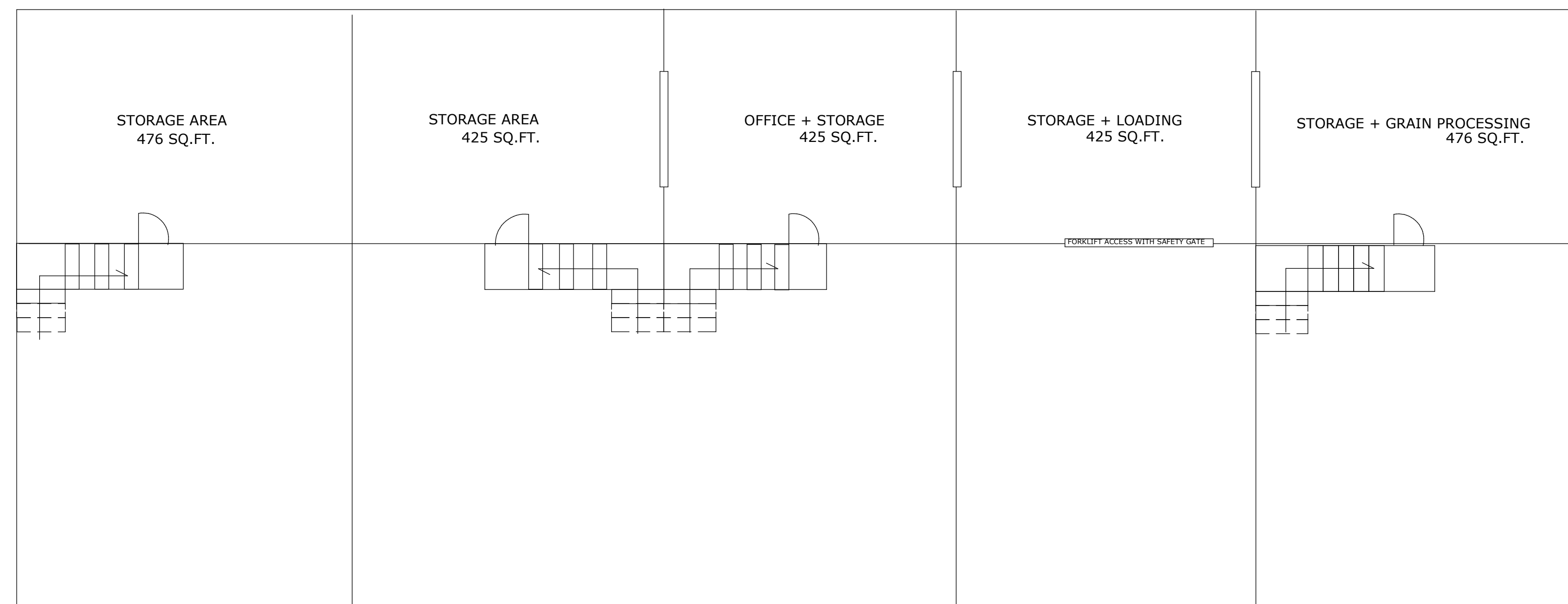

2nd Floor

APN
036-031-01

NO.	DESCRIPTION	BY	DATE

SHEET TITLE:
UPPER AND LOWER FLOOR PLANS

PROJECT DESCRIPTION:
SANTE ADARIUS PARKING GARDEN
100 KENNEDY DRIVE
CAPITOLA, CA 95010

DRAWINGS PROVIDED BY:
DOUGLAS MCCLOSKEY CONSTRUCTION
p.o. box 783
santa cruz, ca 95061
8312472687

DATE:

5/14/2023

SCALE:

1/8"=1'

SHEET:

A-2