

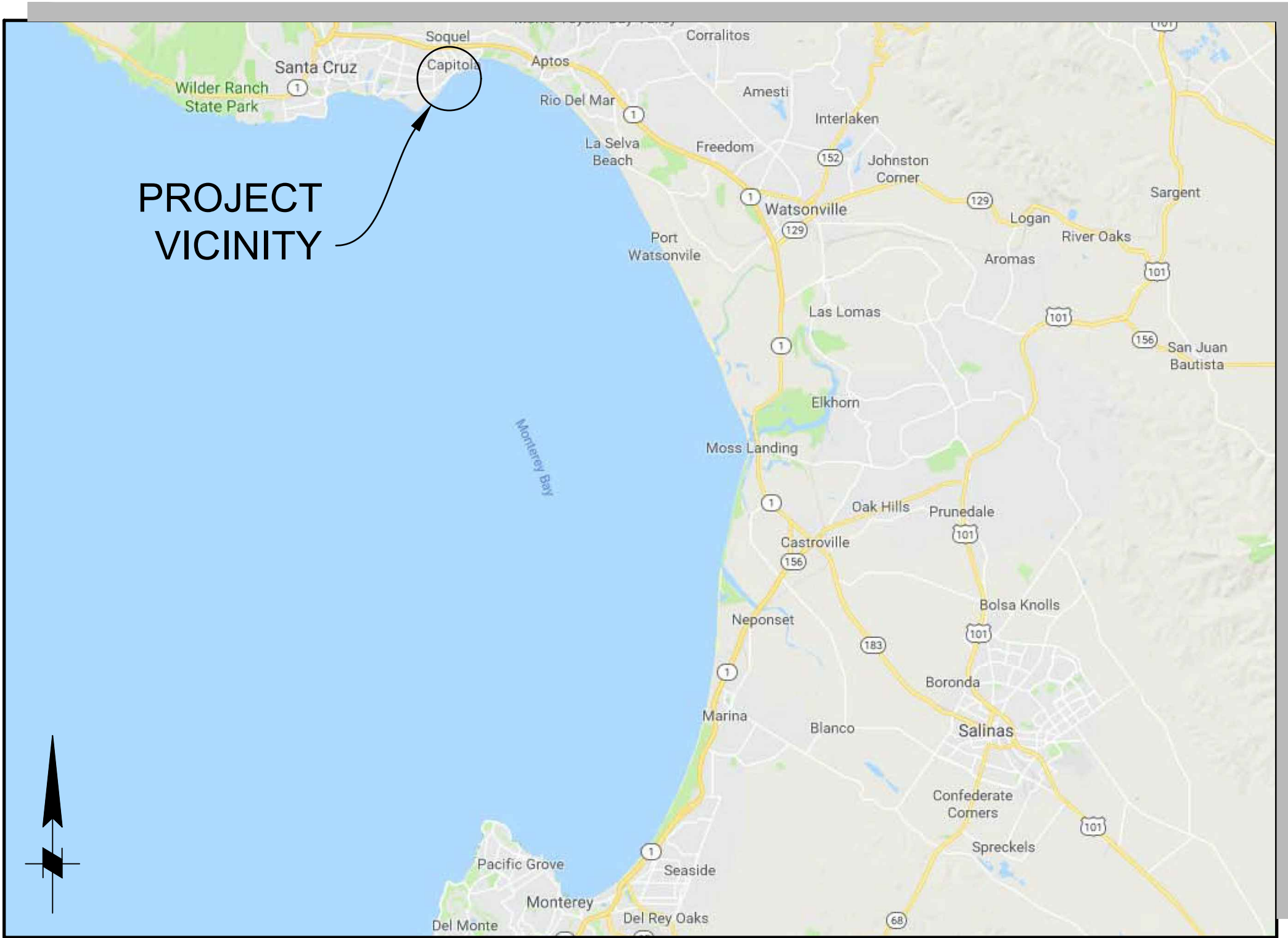
# CAPITOLA WHARF

## RESILIENCY AND PUBLIC ACCESS IMPROVEMENT PHASE 2

Mark	Description	Date	Appr.

CAPITOLA WHARF  
RESILIENCY AND PUBLIC ACCESS  
IMPROVEMENT PHASE 2

TITLE SHEET



VICINITY MAP  
SCALE: NTS

INDEX OF DRAWINGS	
SHEET NO	SHEET TITLE
G-001	TITLE SHEET
G-002	GENERAL NOTES
G-003	EXISTING PHOTOS 1 OF 2
G-004	EXISTING PHOTOS 2 OF 2
C-100	EXISTING WHARF
C-101	OVERALL WHARF STORM DAMAGE
C-102	TRESTLE STORM DAMAGE
C-103	OVERALL WHARF
C-104	WIDENING WHARF PLAN AND SECTION
C-105	WHARF PILE REPAIRS
C-110	DECK, FRAMING AND PILE PLANS (BENTS 0-24)
C-111	DECK, FRAMING AND PILE PLANS (BENTS 24-42)
C-112	DECK, FRAMING AND PILE PLANS (BENTS 42-51)
C-113	DECK AND FRAMING PLANS (BENTS 51-76)
C-114	PILE PLAN (BENTS 51-76)
C-115	ABUTMENT PLAN
C-120	SECTIONS
C-121	TYPICAL DETAILS 1 OF 3
C-122	TYPICAL DETAILS 2 OF 3
C-123	TYPICAL DETAILS 3 OF 3
C-124	SECURITY GATE DETAILS
C-125	DOCK PLAN AND DETAILS
C-126	WHARF RESTROOMS 1 OF 2
C-127	WHARF RESTROOMS 2 OF 2
C-128	WHARF RESTROOMS FOUNDATION DETAILS
C-129	WHARF RESTROOMS RAMP AND LANDING DETAILS
U-001	EXISTING UTILITY PLAN
U-002	PROPOSED UTILITY PLAN
U-003	SEWAGE EJECTOR PUMP NEAR ABUTMENT
U-004	FIRE STANDPIPE PLAN
U-005	SINGLE LINE DIAGRAM AND DETAILS
E-001	ELECTRICAL NOTES
E-002	ELECTRICAL NOTES, ABBREVIATIONS, AND LEGEND
ED101	ELECTRICAL DEMOLITION PLAN
E-101	ELECTRICAL SITE PLAN
E-501	ELECTRICAL DETAILS
E-601	SINGLE LINE DIAGRAM AND SCHEDULE



LOCATION PLAN  
SCALE: NTS

**TIDAL DATUM (MONTEREY GAUGE)**

HIGHEST OBSERVED TIDE	+7.88ft
HIGHEST ASTRONOMICAL TIDE	+7.07ft
MEAN HIGHER HIGH WATER (MHHW)	+5.33ft
MEAN SEA LEVEL (MSL)	+2.83ft
MEAN LOWER LOW WATER (MLLW)	0ft
NORTH AMERICAN VERTICAL DATUM (NAVD)	-0.13ft
LOWEST ASTRONOMICAL TIDE	-1.94ft
LOWEST OBSERVED TIDE	-2.39ft



APPROVED, CITY OF CAPITOLA

Jessica Kahn

REF 81258

Designed by: AC	Drawn by: AC	Reviewed by: BP	Submitted by: MOFFATT & NICHOL
Date: 4/18/2023	MAN Project No.: 9154-01	Drawing code:	Drawing Scale: 1" = 10' (0 SHEET)

2185 N. CALIFORNIA BLVD.  
SUITE 500  
WALNUT CREEK, CA 94596



Sheet Reference No.  
**G-001**

INDEX: 1 OF 32

**GENERAL NOTES**

- 1. ELEVATIONS SHOWN ARE IN FEET REFERENCED TO MEAN LOWER LOW WATER.
- 2. DEMOLITION OF EXISTING FEATURES SHALL BE LIMITED TO THE ITEMS SHOWN ON THE PLANS AND DESCRIBED IN THE SPECIFICATIONS. IT SHALL BE THE CONTRACTOR'S RESPONSIBILITY TO REPAIR AND/OR REPLACE EXISTING FEATURES TO REMAIN THAT ARE DAMAGED BY THE CONTRACTOR.
- 3. WHERE REFERENCE IS MADE TO THE CITY ON THESE DRAWINGS, THE CITY IS DEFINED AS THE CITY OF CAPITOLA OR REPRESENTATIVES OF THE CITY OF CAPITOLA.
- 4. CONTACT THE CITY IMMEDIATELY UPON FINDING ANY FIELD CONDITIONS THAT CONFLICT WITH THE INFORMATION ON THESE DRAWINGS. ALL FIELD ADJUSTMENTS MUST BE APPROVED BY THE CITY BEFORE CONSTRUCTION OF SAID ADJUSTMENTS. FAILURE TO DO SO WILL RESULT IN THE CONTRACTOR ASSUMING FULL RESPONSIBILITY FOR ANY REQUIRED REVISIONS OR FIELD MODIFICATIONS, AS DIRECTED BY THE CITY, AT NO ADDITIONAL COST.
- 5. PROVIDE CONSTRUCTION SITE SECURITY FOR THE DURATION OF THE CONTRACT PERIOD AND AS SPECIFIED.
- 6. FURNISH, INSTALL AND MAINTAIN ALL WARNING SIGNS AND DEVICES NECESSARY TO SAFEGUARD THE GENERAL PUBLIC AND THE WORK, AND PROVIDE PROPER AND SAFE ROUTING OF VEHICULAR AND PEDESTRIAN TRAFFIC DURING THE PERFORMANCE OF THE WORK. THIS REQUIREMENT SHALL APPLY CONTINUOUSLY AND SHALL NOT BE LIMITED TO WORKING HOURS.
- 7. KEEP THE PROJECT SITE IN A NEAT AND ORDERLY CONDITION, FREE OF RUBBISH AND DEBRIS, AT ALL TIMES.
- 8. ALL WORK SHOWN SHALL BE NEW UNLESS OTHERWISE NOTED.
- 9. ALL WORK SHALL CONFORM TO THE PERMIT CONDITIONS ISSUED FOR THE PROJECT BY THE REGULATORY AGENCIES:
  - a. CALIFORNIA COASTAL COMMISSION.
  - b. US ARMY CORP OF ENGINEERING.
  - c. REGIONAL WATER QUALITY CONTROL BOARD.
- 9. AN HISTORIC RECORDS SEARCH HAS BEEN PERFORMED FOR THE PROJECT AND A REVIEW OF THE HISTORIC INTEGRITY PERFORMED. THE FOLLOWING SHALL BE ADHERED TO DURING THE PROJECT:
  - a. NO EXCAVATIONS SHALL OCCUR WITHIN THE ON-SHORE PORTIONS OF THE PROJECT SITE OR STAGING AREA, INCLUDING THE RETAINING WALL AT THE WHARF ENTRANCE, THE WHARF PARKING LOT AND WHARF ROAD.

**CODES AND STANDARDS**

- 1. 2019 CALIFORNIA BUILDING CODE (CBC)
- 2. AMERICAN INSTITUTE OF STEEL CONSTRUCTION (AISC), STEEL CONSTRUCTION MANUAL, 14TH EDITION
- 3. AMERICAN FOREST & PAPER ASSOCIATION, NATIONAL DESIGN SPECIFICATION FOR WOOD CONSTRUCTION, NDS 2018 EDITION
- 4. AMERICAN SOCIETY OF CIVIL ENGINEERS, MINIMUM DESIGN LOADS FOR BUILDING AND OTHER STRUCTURES, ASCE 7-16
- 5. AMERICAN CONCRETE INSTITUTE (ACI), BUILDING CODE REQUIREMENTS FOR STRUCTURAL CONCRETE AND COMMENTARY, ACI 318-19.

**FRP PILES**

- 1. FRP PILE SHALL BE 12"Ø WITH 1/2" WALL THICKNESS AS PRODUCED BY CREATIVE COMPOSITES GROUP OR APPROVED EQUAL.
- 2. FRP PILES SHALL HAVE A THICK HDPE SLEEVE AS PROVIDED BY THE MANUFACTURER. HDPE SLEEVE SHALL EXTEND 1 FT BELOW MUDLINE.
- 3. FRP PILES SHALL HAVE A FRP STRUCTURAL CAP AS PROVIDED BY THE MANUFACTURER. THE FRP CAP SHALL BE INSTALLED PER MANUFACTURER'S RECOMMENDATIONS.

**LUMBER**

- 1. STRUCTURAL LUMBER SHALL BE DOUGLAS FIR-LARCH NO. 1 OR BETTER AS SPECIFIED BY THE WEST COAST LUMBER INSPECTION BUREAU, VISUALLY GRADED LUMBER.
- 2. STRUCTURAL LUMBER SHALL BE CHEMICALLY TREATED WITH ACZA FOR MARINE EXPOSURE, SALTWATER SPLASH PER AWPA STANDARD 4B, 4C.

**HARDWARE**

- 1. ALL STEEL PLATES, BOLTS, LAG BOLTS, NUTS, AND WASHERS SHALL BE HOT DIP GALVANIZED, BOLTS SHALL HAVE FLAT WASHERS AT THE NUT AND HEAD. UNLESS NOTED OTHERWISE.

- 2. BOLTS SHALL CONFORM TO ASTM A307A.
- 3. DECK SCREWS SHALL BE 8" STRONG-DRIVE SDWS TIMBER SS SCREWS.
- 4. DRIFT PIN MATERIAL SHALL BE SS, DIAMETER TO MATCH EXISTING.
- 5. PILE BANDING SHALL BE 3/8" WIDE BY 0.030" THICK 316SS WITH AN "EAR-LOKT" BUCKLE, AS MANUFACTURED BY "BAND-IT" OR APPROVED EQUAL.

**SURFACE PREPARATION OF TIMBER PILES**

- 1. MECHANICALLY (WATER BLAST/WIRE BRUSH) REMOVE GREASE, RUST, MARINE GROWTH, LOOSE AND UNSOUND TIMBER, AND OTHER INHIBITING MATERIALS.
- 2. THE EXTENT OF (E) PILE CLEANING SHALL BE LIMITED TO THE EXTENT OF (N) JACKETS.

**PILE REPAIR**

- 1. TIMBER PILES INDICATED SHALL BE REPAIRED WITH A FIBERGLASS JACKET ENCASING A STEEL REINFORCED GROUT FILL, DENSO SEA-SHIELD FX-70 SYSTEM OR CITY APPROVED EQUAL.
- 2. FIBERGLASS JACKET AND GROUT PORTS SHALL BE INSTALLED PER MANUFACTURER'S SPECIFICATIONS.
- 3. MONITOR PRESSURE-INJECTION OR GRAVITY-FEED APPLICATION TO ENSURE MATERIAL DOES NOT LEAK INTO WATER.
- 4. EXCESS GROUT PUMPED OUT THROUGH PORTS OR JACKET OPENINGS SHALL BE COLLECTED AND REMOVED FROM THE WATER.

**GROUT**

- 1. CEMENTITIOUS UNDERWATER GROUT SHALL BE SIMPSON FX-225 NON-SHRINK CEMENTITIOUS UNDERWATER GROUT OR CITY APPROVED EQUAL.
- 2. MARINE EPOXY GROUT SHALL BE SIMPSON FX-60-6MP MULTI-PURPOSE MARINE EPOXY GROUT OR CITY APPROVED EQUAL.
- 3. TOP SEAL EPOXY SHALL BE FX-763 TROWEL-GRADE EPOXY MIXED WITH FX-702 SILICA FILLER OR CITY APPROVED EQUAL.
- 4. ALL GROUT SHALL BE PLACED TO OBTAIN UNIFORM COVERAGE WITHOUT VOIDS. SUBMIT A GROUTING PROCEDURE FOR APPROVAL BY THE CITY.

**REINFORCEMENT**

- 1. ALL REINFORCEMENT BARS SHALL CONFORM TO ASTM A615 GRADE 60.
- 2. REINFORCING BARS SHALL NOT BE WELDED WITHOUT THE CITY'S APPROVAL.

**CONDUITS**

- 1. CONDUITS SHALL BE RELOCATED AS NECESSARY TO ACCOMMODATE REPAIRS.

**REMOVAL NOTES**

- 1. THE SITE SHALL BE CLEANED OF DEBRIS AT THE END OF EACH DAY AND AT THE CONCLUSION OF REMOVAL WORK.

**ADD ALTERNATE BID ITEMS**

- 1. REPLACING OR REPAIRING PILES AS SHOWN ON SHEET C-103.
- 2. REPLACING EXISTING POWER CABLES FROM PANELBOARD "MDP-L-WHARF" TO BENT 57 AS SHOWN ON SHEET E-101.

**ABBREVIATIONS**

&	AND
@	AT
ACI	AMERICAN CONCRETE INSTITUTE
AISC	AMERICAN INSTITUTE OF STEEL CONSTRUCTION
ASCE	AMERICAN SOCIETY OF CIVIL ENGINEERS
ASTM	ASTM INTERNATIONAL
AWPA	AMERICAN WOOD PROTECTION ASSOCIATION
APPROX	APPROXIMATE
BLDG	BUILDING
CBC	CALIFORNIA BUILDING CODE
CL	CENTER LINE
CLR	CLEAR
CONC	CONCRETE
DIA	DIAMETER
(E)	EXISTING
EHW	EXTREME HIGH WATER
EL	ELEVATION
F&I	FURNISH AND INSTALL
FM	FORCE MAIN
FT	FEET
F.H.	FLAT HEAD
FRP	FIBER REINFORCED POLYMER
HDPE	HIGH DENSITY POLYETHYLENE
HDG	HOT-DIP GALVANIZED
HSS	HOLLOW STRUCTURAL SECTION
HTL	HIGH TIDE LINE
NDS	NATIONAL DESIGN SPECIFICATION
(N)	NEW
MAX	MAXIMUM
MIN	MINIMUM
MHW	MEAN HIGH WATER
MHHW	MEAN HIGHER HIGH WATER
MLLW	MEAN LOWER LOW WATER
MSL	MEAN SEA LEVEL
MTL	MEAN TIDE LEVEL
NTS	NOT TO SCALE
NO.	NUMBER
OC	ON CENTER
O.D.	OUTER DIAMETER
PL	PLATE
SIM	SIMILAR
TYP	TYPICAL
UON	UNLESS OTHERWISE NOTED
VIF	VERIFY IN FIELD
SS	STAINLESS STEEL



Rev.	Date	Description	Mark

**CAPITOLA WHARF  
RESILIENCY AND PUBLIC ACCESS  
IMPROVEMENT PHASE 2**

**GENERAL NOTES**

Designed by:	AC	Drawn by:	BP	Reviewed by:		Submitted by:	MOFFATT & NICHOL
Date:	4/18/2023	M&N Project No.:	9154-01	Drawing Code:		Drawing Scale:	
						Per Scale:	1:1 (0 SHEET)

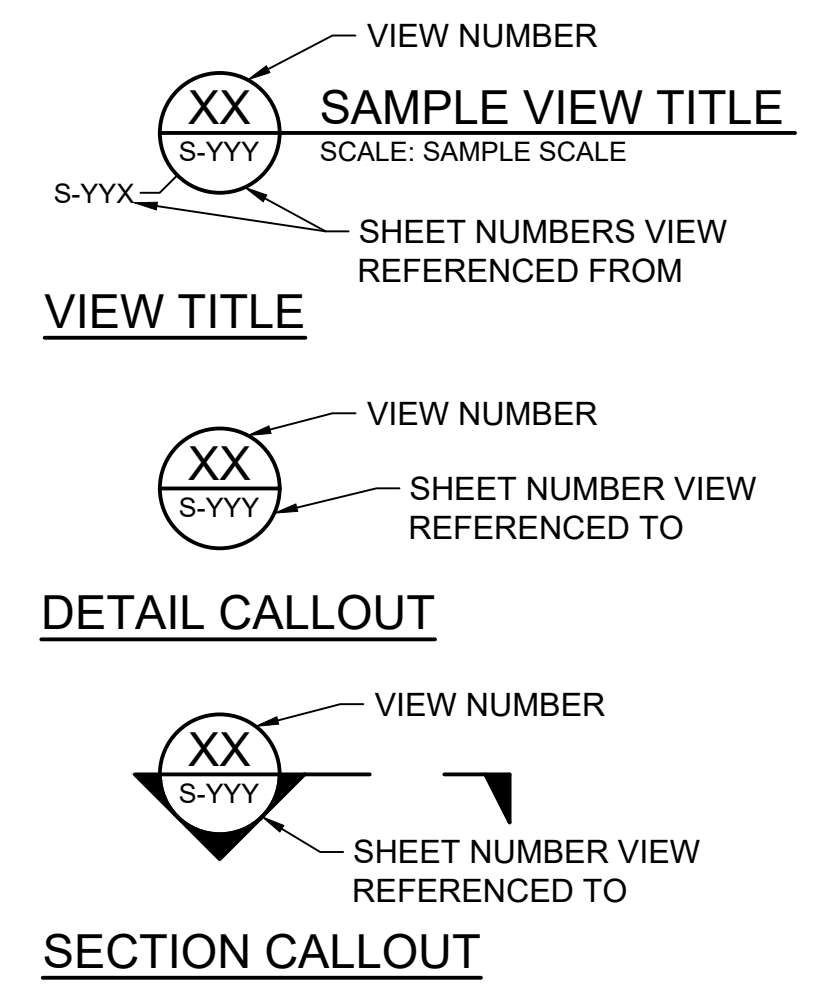
2185 N. CALIFORNIA BLVD.  
SUITE 500  
WALNUT CREEK, CA 94596

**moffatt & nichol**



Sheet Reference No.  
**G-002**  
INDEX: 2 OF 37

**CROSS REFERENCE LEGEND**





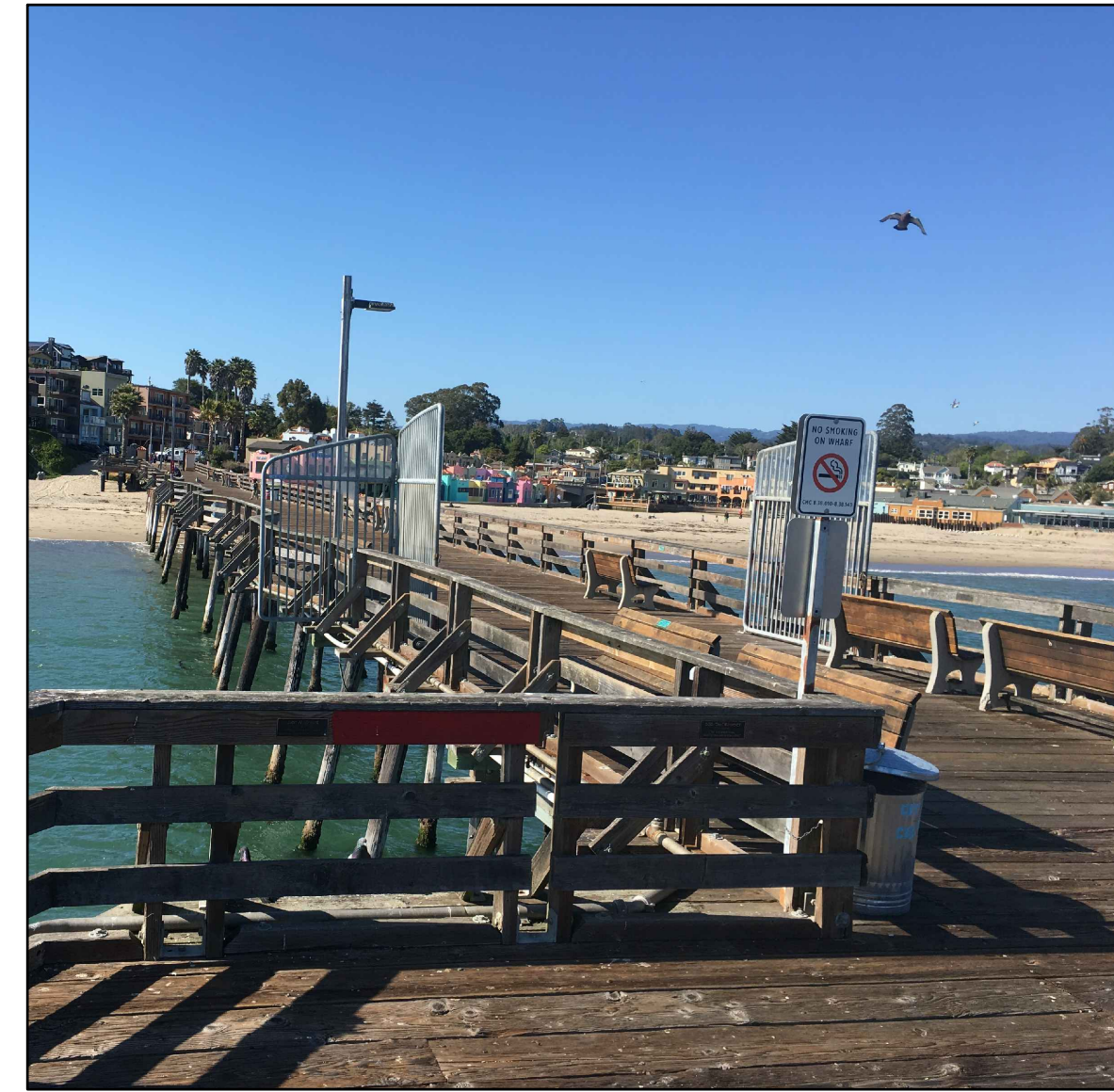
**PHOTO 1**  
OVERALL VIEW OF WHARF



**PHOTO 2**  
ENTRY GATE



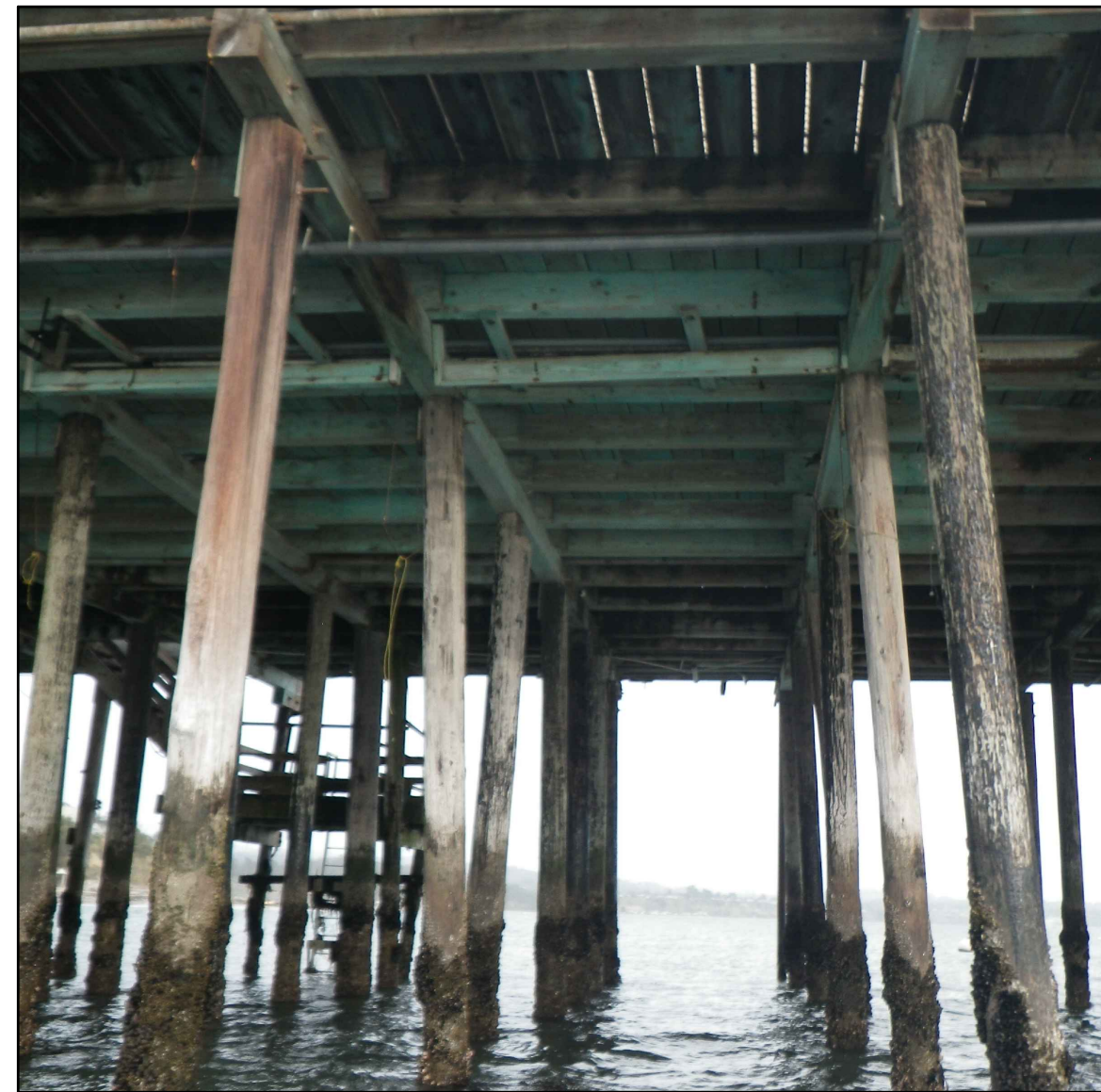
**PHOTO 3**  
WHARF BELOW CRANE



**PHOTO 4**  
SECURITY GATE



**PHOTO 5**  
TRESTLE



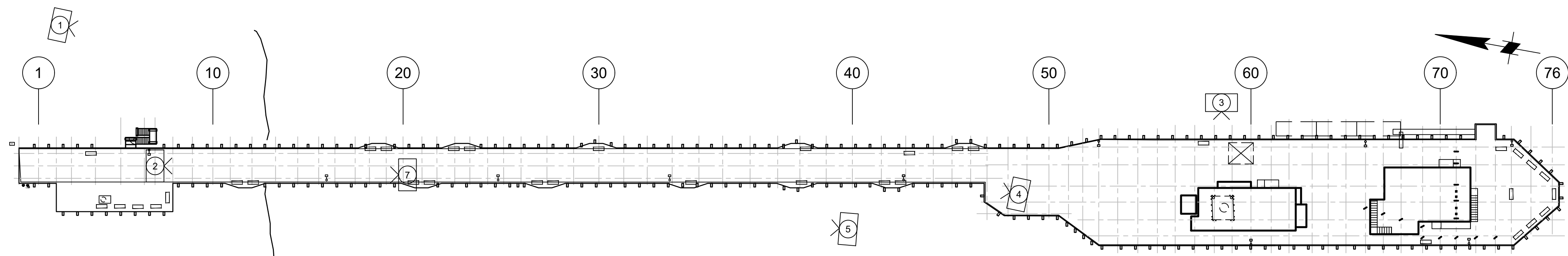
**PHOTO 6**  
BELOW DECK AT BENT 61



**PHOTO 7**  
UTILITIES BELOW DECK



**PHOTO 8**  
UTILITIES AT SEWAGE EJECTOR PUMP



**1 PLAN - PHOTO LOCATIONS**  
SCALE: 1" = 40'

**LEGEND:**

PHOTO REFERENCE SEE G-003  
DIRECTION OF PHOTO

40' 0' 40' 80'  
SCALE: 1"=40'



Mark	Description	Date	Appr.

**CAPITOLA WHARF  
RESILIENCY AND PUBLIC ACCESS  
IMPROVEMENT PHASE 2**

EXISTING PHOTOS 1 OF 2

Designed by: AC	Drawn by: AC	Reviewed by: BP	Submitted by: MOFFATT & NICHOL
Date: 4/18/2023	MAN Project No.: 9154-01	Drawing code:	Drawing Scale: 1" = 10' (0 SHEET)

2185 N. CALIFORNIA BLVD.  
SUITE 500  
WALNUT CREEK, CA 94596

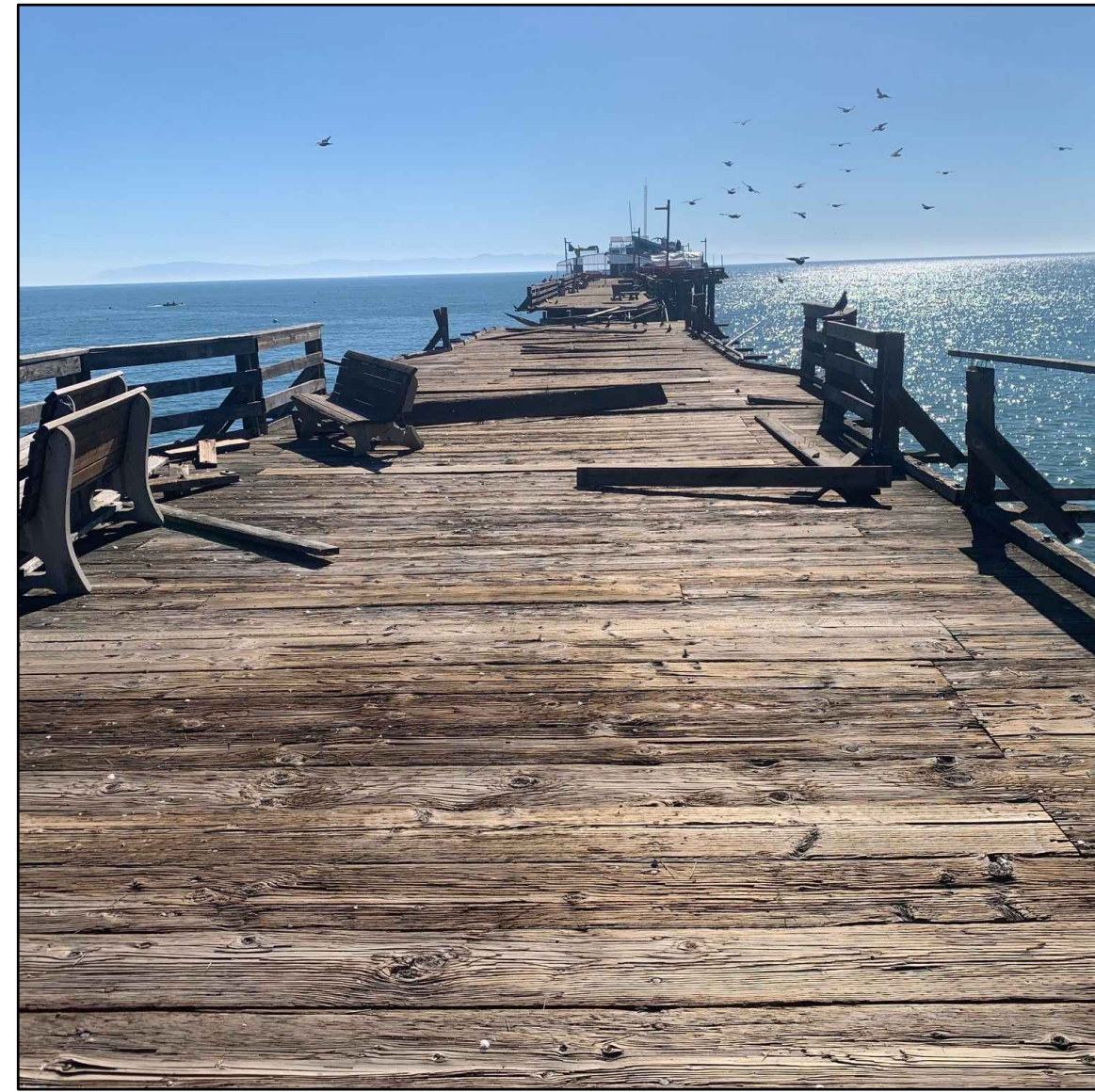
**moffatt & nichol**



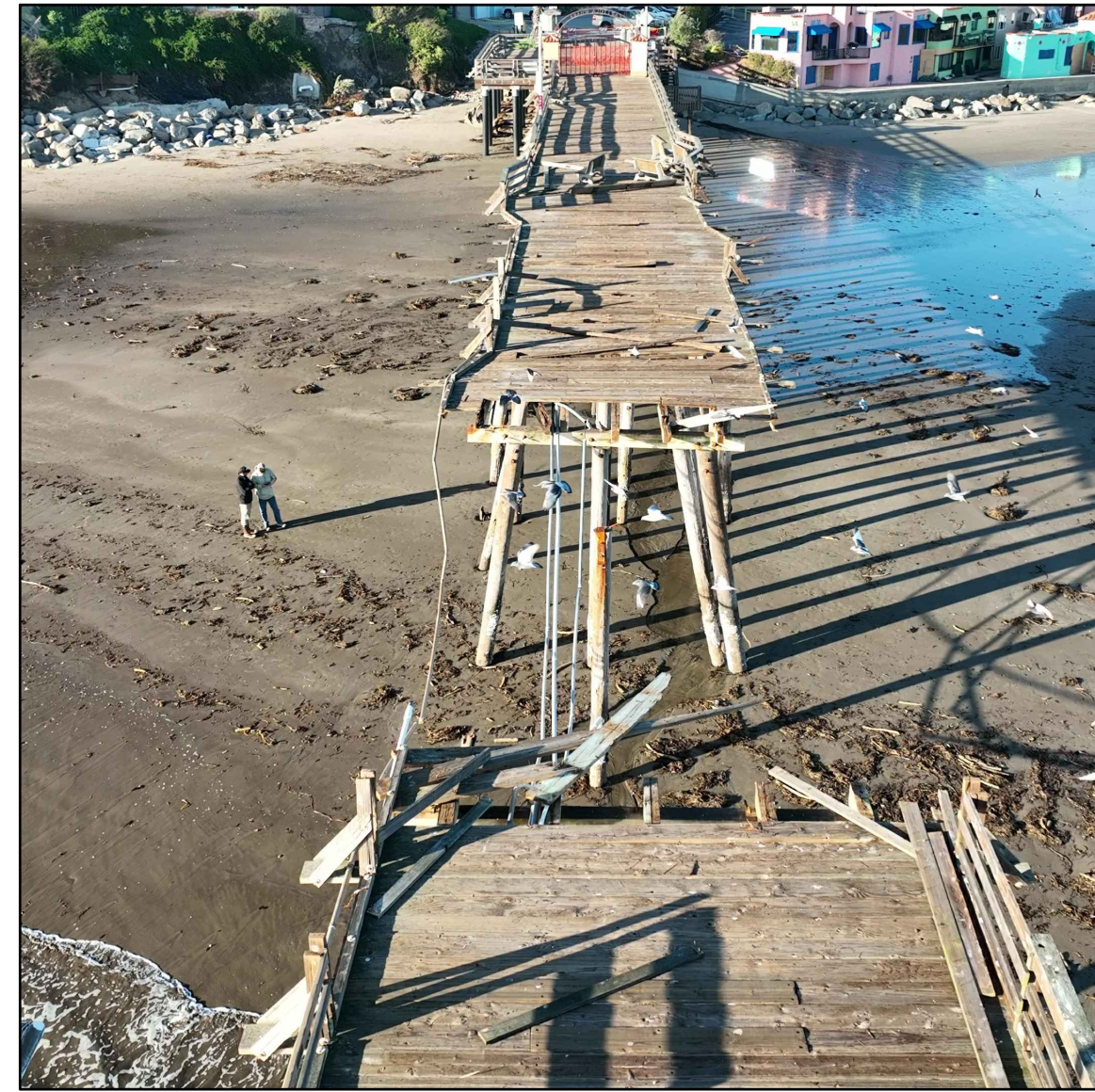
Sheet Reference No.  
**G-003**  
INDEX: 3 OF 37



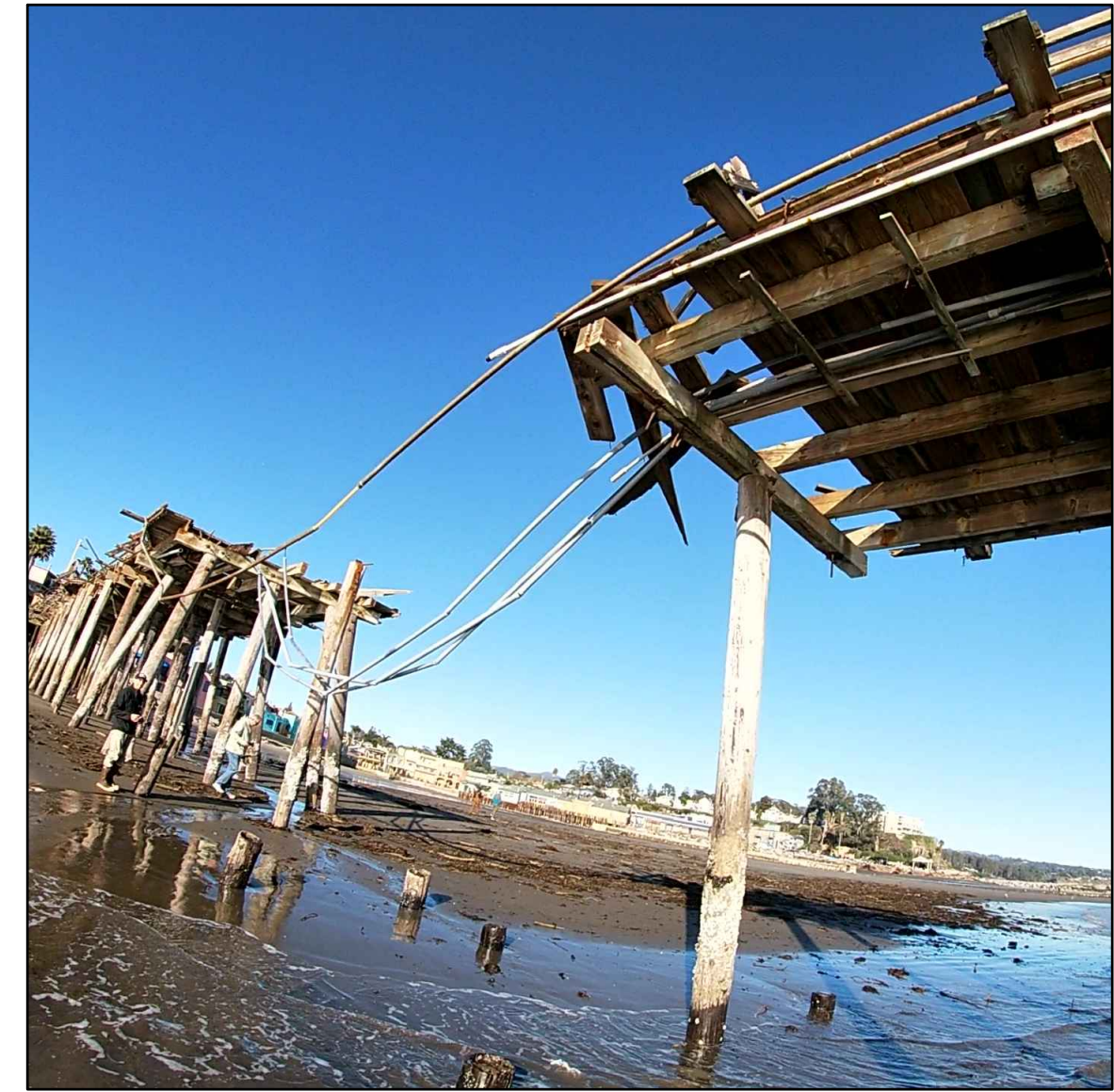
**PHOTO 9**  
STORM DAMAGE AT STAIRS



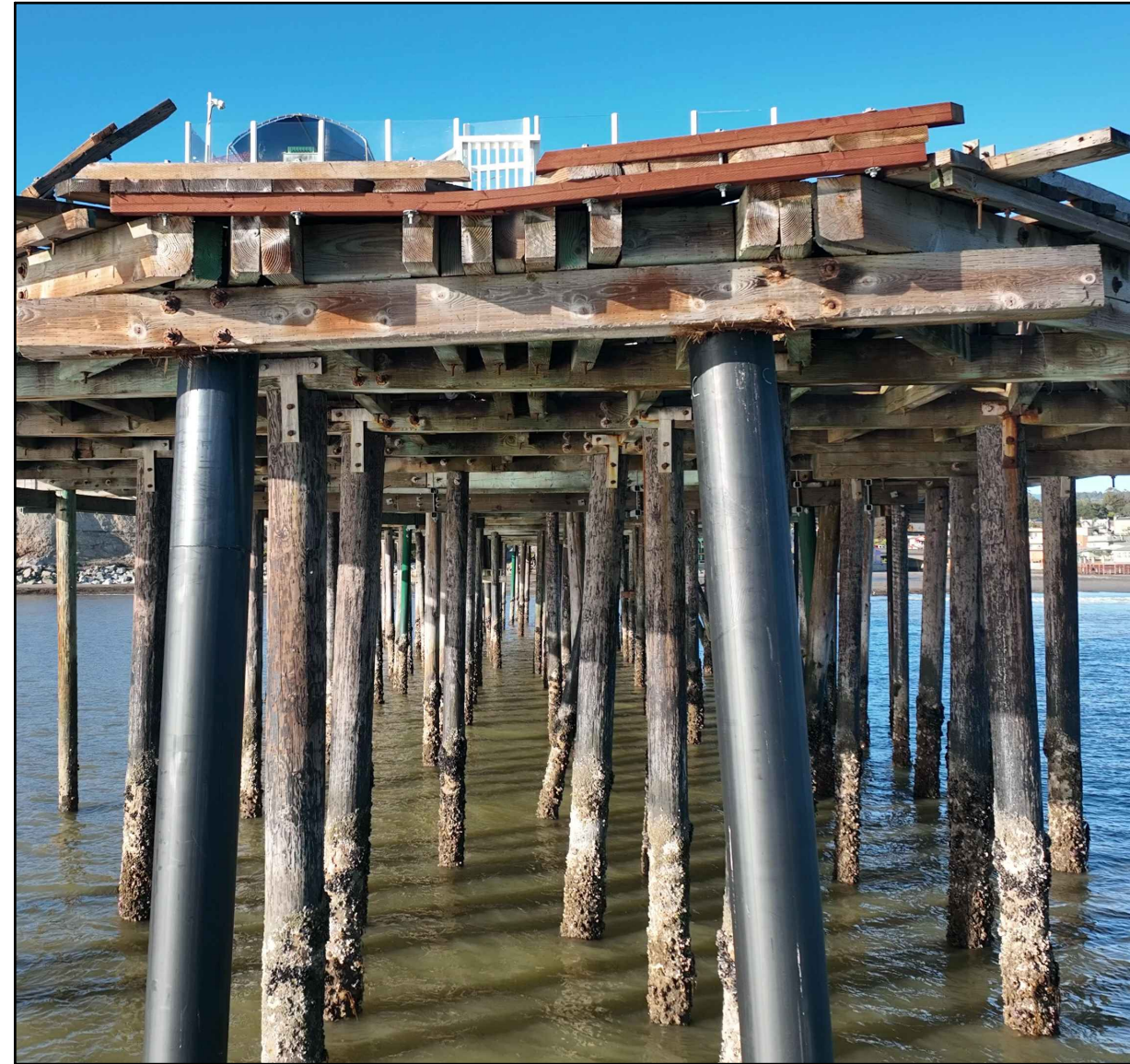
**PHOTO 10**  
STORM DAMAGE AT TRESTLE



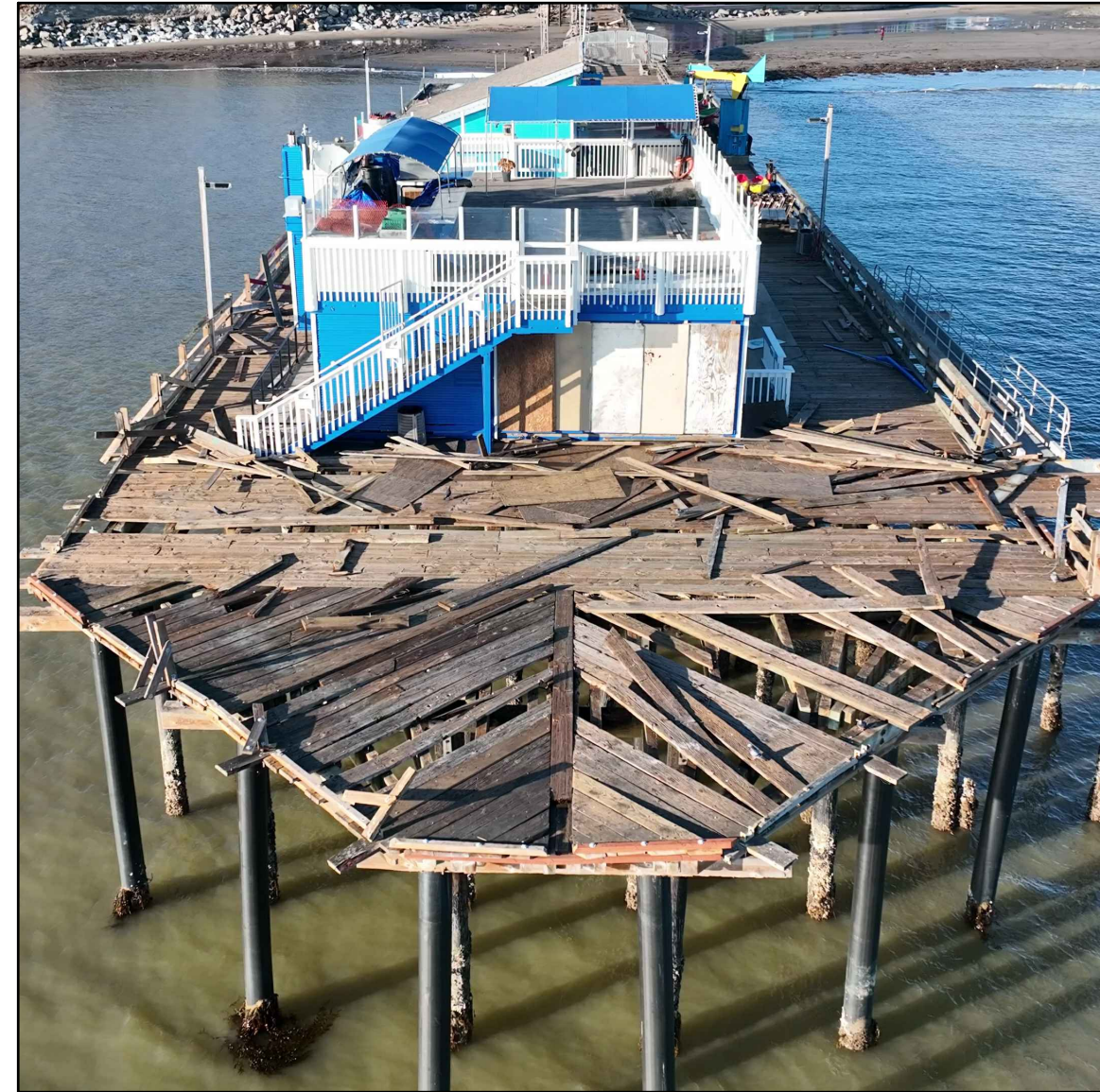
**PHOTO 11**  
STORM DAMAGE AT TRESTLE



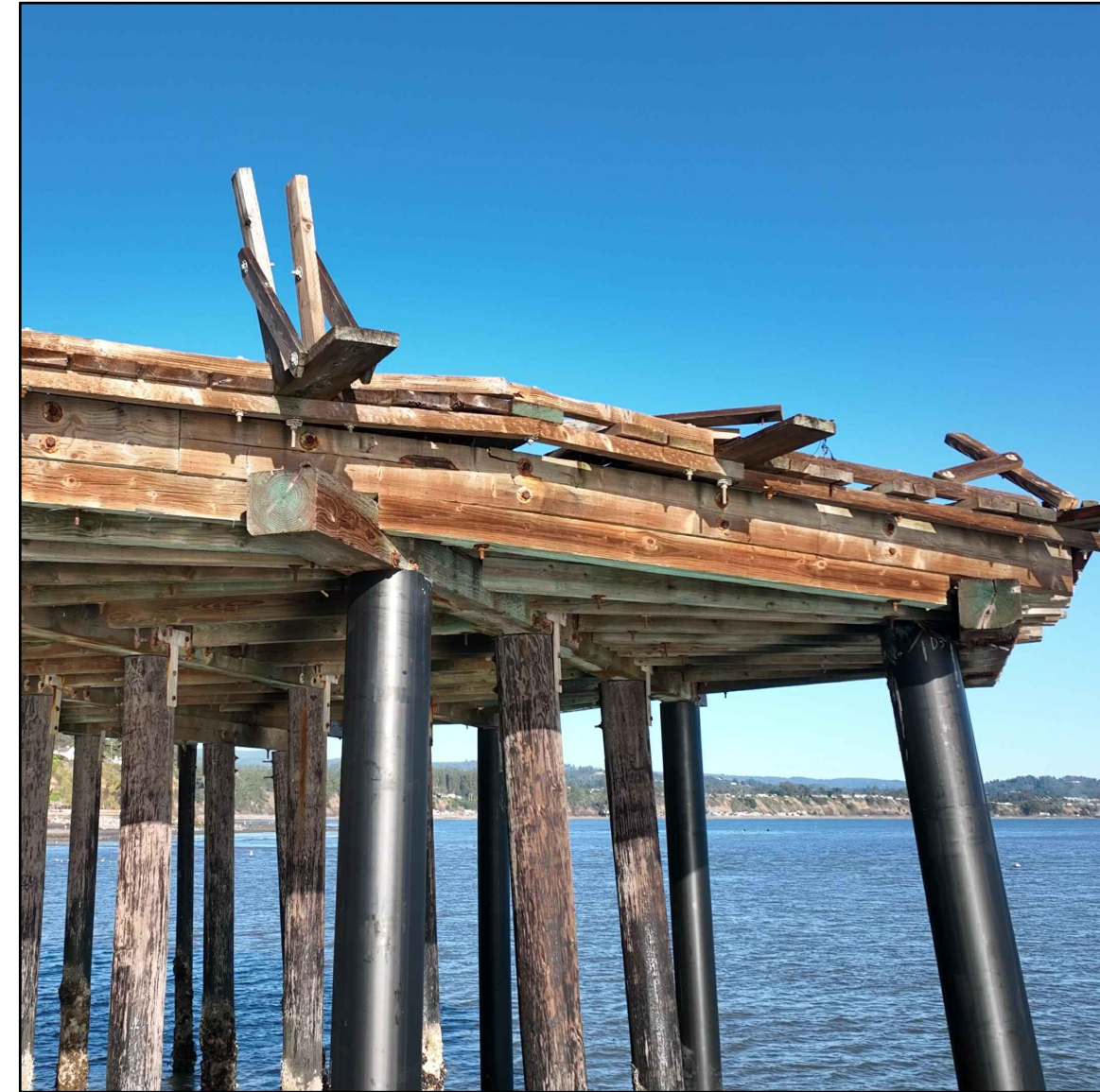
**PHOTO 12**  
STORM DAMAGE AT TRESTLE



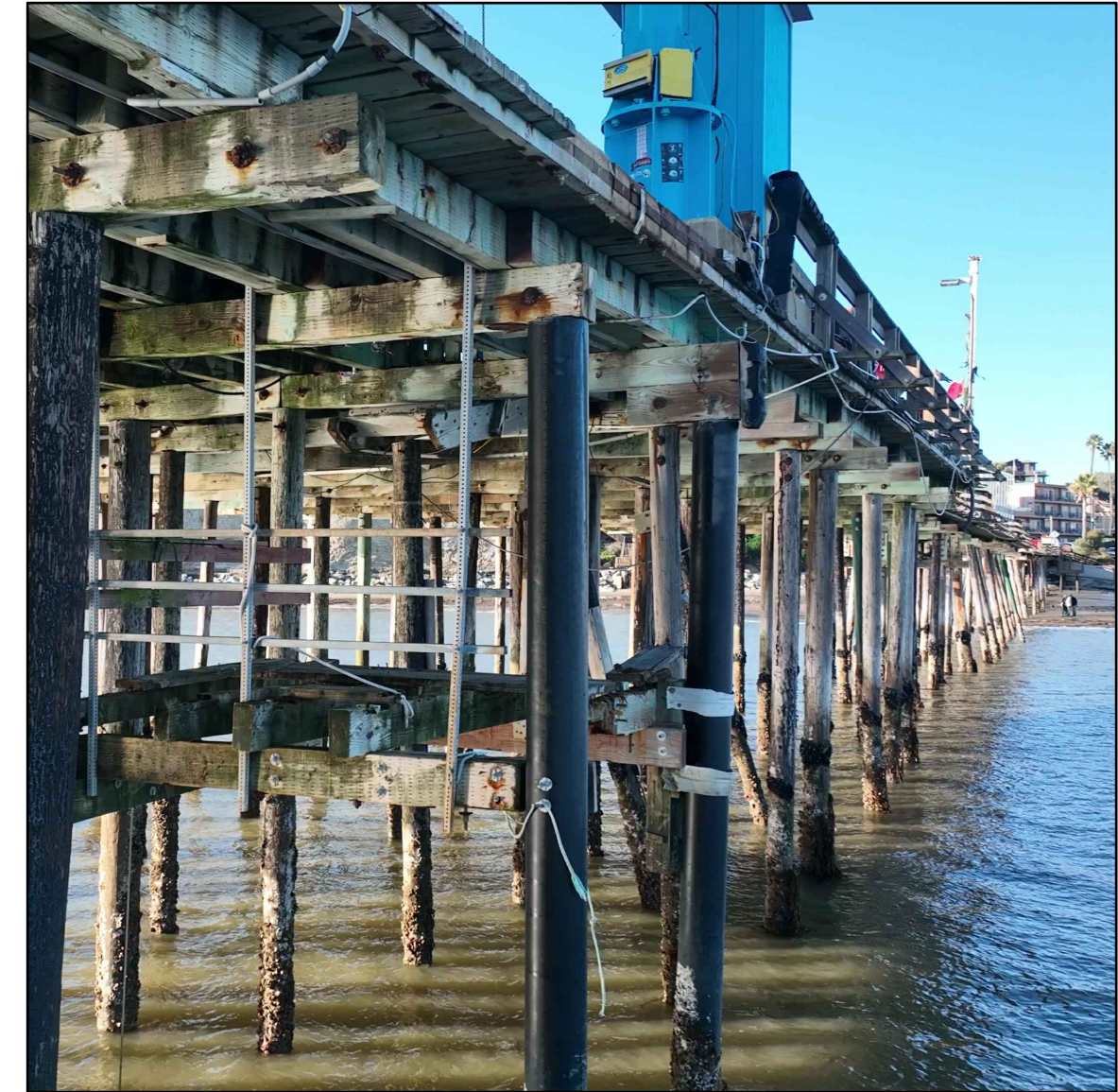
**PHOTO 13**  
PILES OFF PILE CAP AT WHARF HEAD



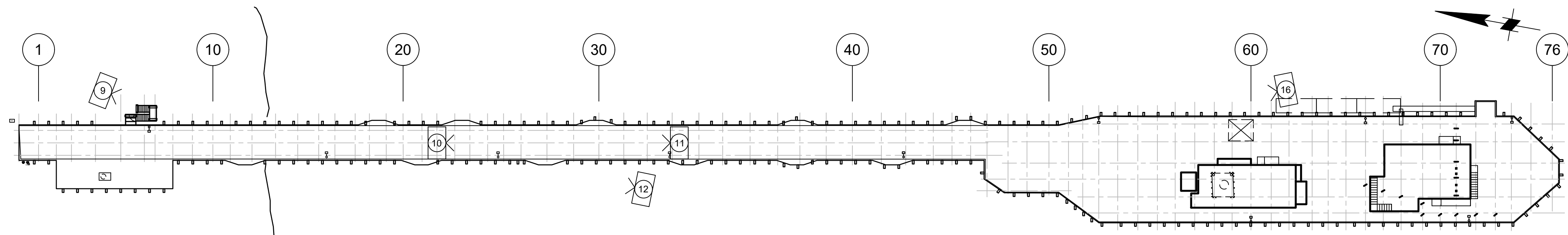
**PHOTO 14**  
WHARF HEAD



**PHOTO 15**  
PILE CAPS AT WHARF HEAD

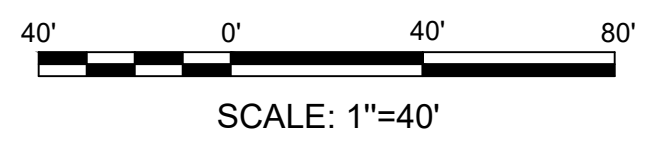


**PHOTO 16**  
WHARF BELOW CRANE



**1 PLAN - PHOTO LOCATIONS**  
SCALE: 1" = 40'

**LEGEND:**  
 PHOTO REFERENCE SEE G-003  
 DIRECTION OF PHOTO



Rev.	Date	Description	Mark

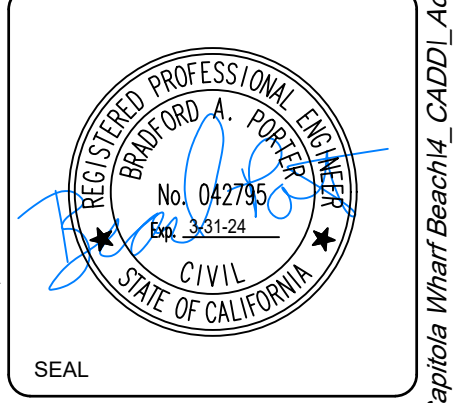
**CAPITOLA WHARF  
RESILIENCY AND PUBLIC ACCESS  
IMPROVEMENT PHASE 2**

EXISTING PHOTOS 2 OF 2

Designed by:	AC	Drawn by:	AC	Reviewed by:	Submitted by:
Date:	4/18/2023	MAN Project No.:	9154-01	Drawing code:	

2185 N. CALIFORNIA BLVD.  
SUITE 500  
WALNUT CREEK, CA 94596

**mofatt & nichol**



Sheet Reference No.  
**G-004**  
INDEX: 4 OF 37



Appr.	Date	Description	Mark

**CAPITOLA WHARF  
RESILIENCY AND PUBLIC ACCESS  
IMPROVEMENT PHASE 2**

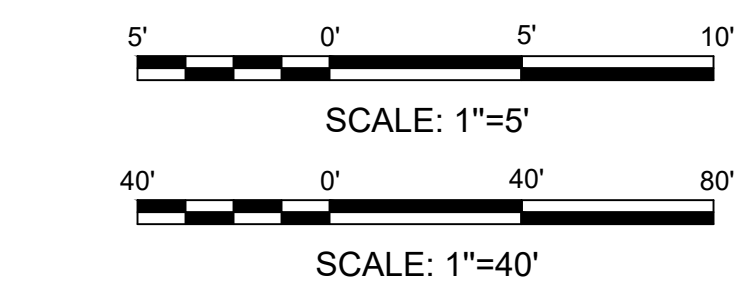
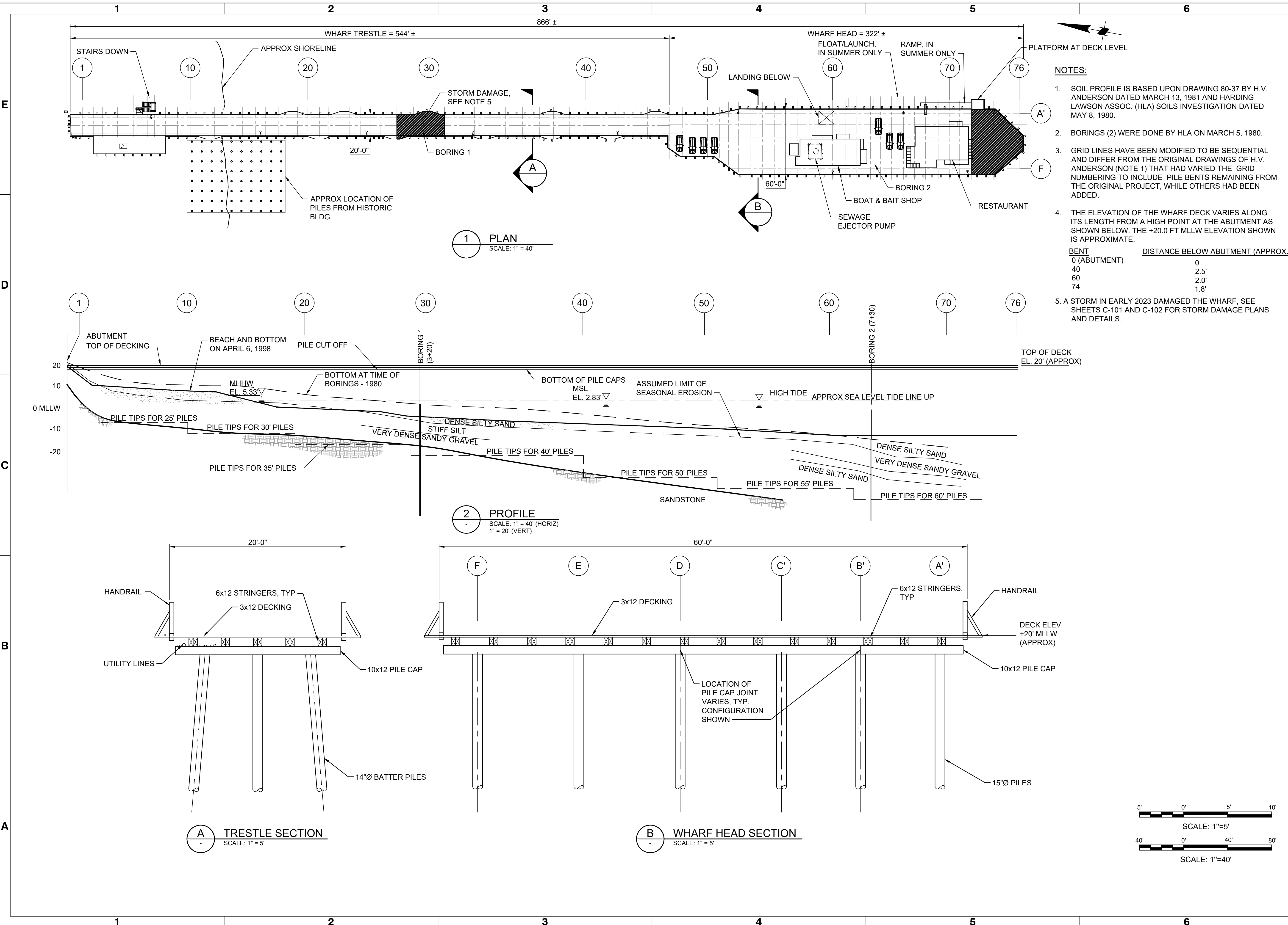
**EXISTING WHARF**

Rev:	Date:	4/18/2023	M&N Project No.:	9154-01	Drawing code:	Drawing Scale:	Per Scale:	1" = 10' (0 SHEET)
Designed by:	AC	Drawn by:	AC	Checked by:	BP	Submitted by:	MOFATT & NICHOL	

2185 N. CALIFORNIA BLVD.  
SUITE 500  
WALNUT CREEK, CA 94596



Sheet Reference No.  
**C-100**  
INDEX: 5 OF 37





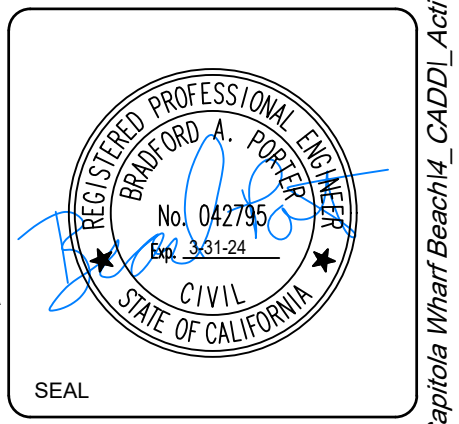
Rev.	Date	Description

**CAPITOLA WHARF  
RESILIENCY AND PUBLIC ACCESS  
IMPROVEMENT PHASE 2**

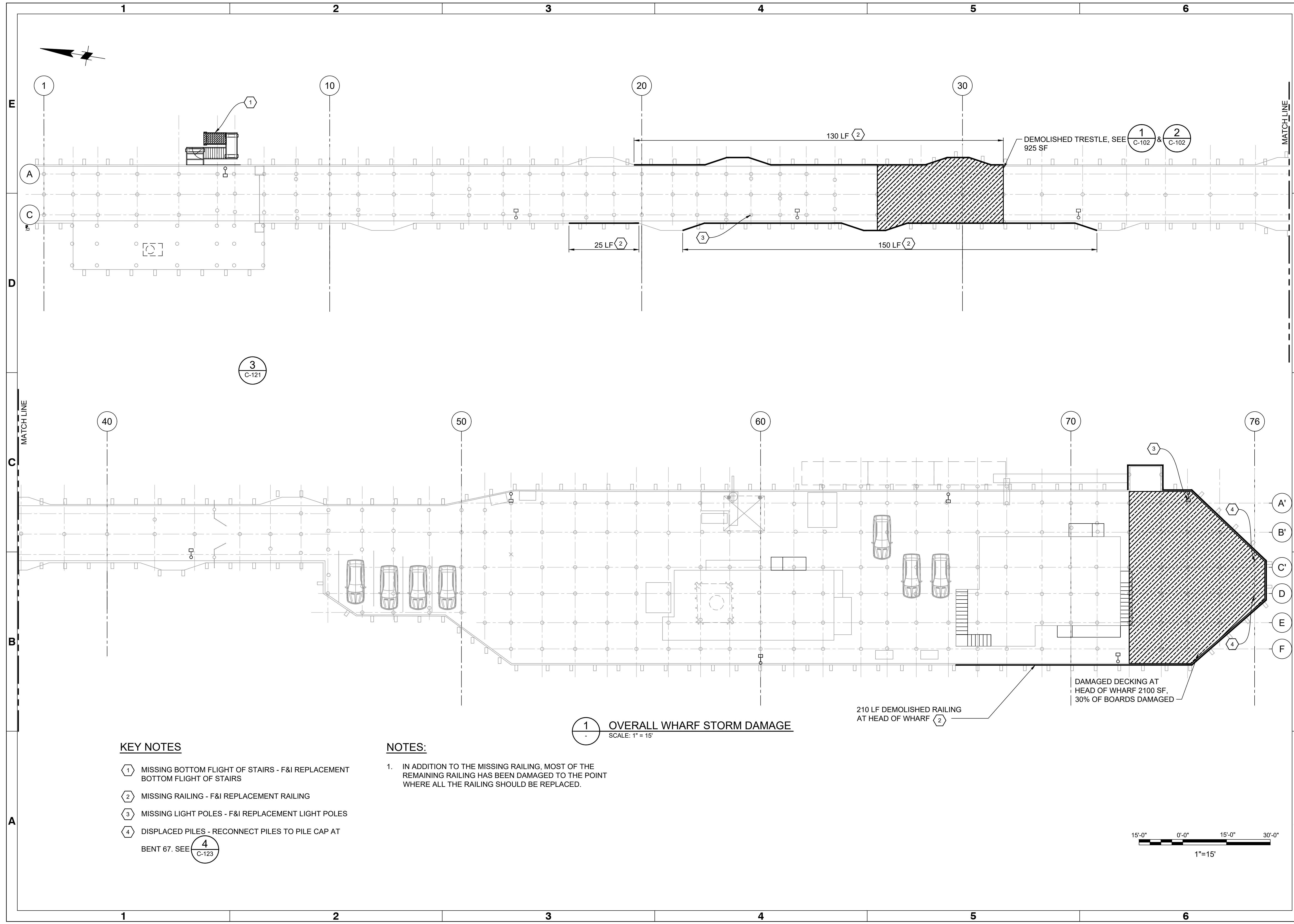
**OVERALL WHARF STORM  
DAMAGE**

Date: 12/16/2022 M&N Project No.: 9154-01	Drawing code:	Drawing Scale: 1" = (0 SHEET)
Designed by: JIE Drawn by: JIE	Checked by: BP	Submitted by: MOFFATT & NICHOL

2185 N. CALIFORNIA BLVD.  
SUITE 500  
WALNUT CREEK, CA 94596



Sheet Reference No.  
**C-101**  
INDEX: 6 OF 37



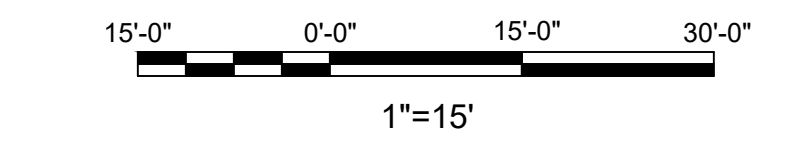
**1 OVERALL WHARF STORM DAMAGE**  
SCALE: 1" = 15'

**KEY NOTES**

- ① MISSING BOTTOM FLIGHT OF STAIRS - F&I REPLACEMENT BOTTOM FLIGHT OF STAIRS
- ② MISSING RAILING - F&I REPLACEMENT RAILING
- ③ MISSING LIGHT POLES - F&I REPLACEMENT LIGHT POLES
- ④ DISPLACED PILES - RECONNECT PILES TO PILE CAP AT BENT 67. SEE **4** C-123

**NOTES:**

1. IN ADDITION TO THE MISSING RAILING, MOST OF THE REMAINING RAILING HAS BEEN DAMAGED TO THE POINT WHERE ALL THE RAILING SHOULD BE REPLACED.





Rev.	Date	Description	Mark

**CAPITOLA WHARF  
RESILIENCY AND PUBLIC ACCESS  
IMPROVEMENT PHASE 2**

**OVERALL WHARF**

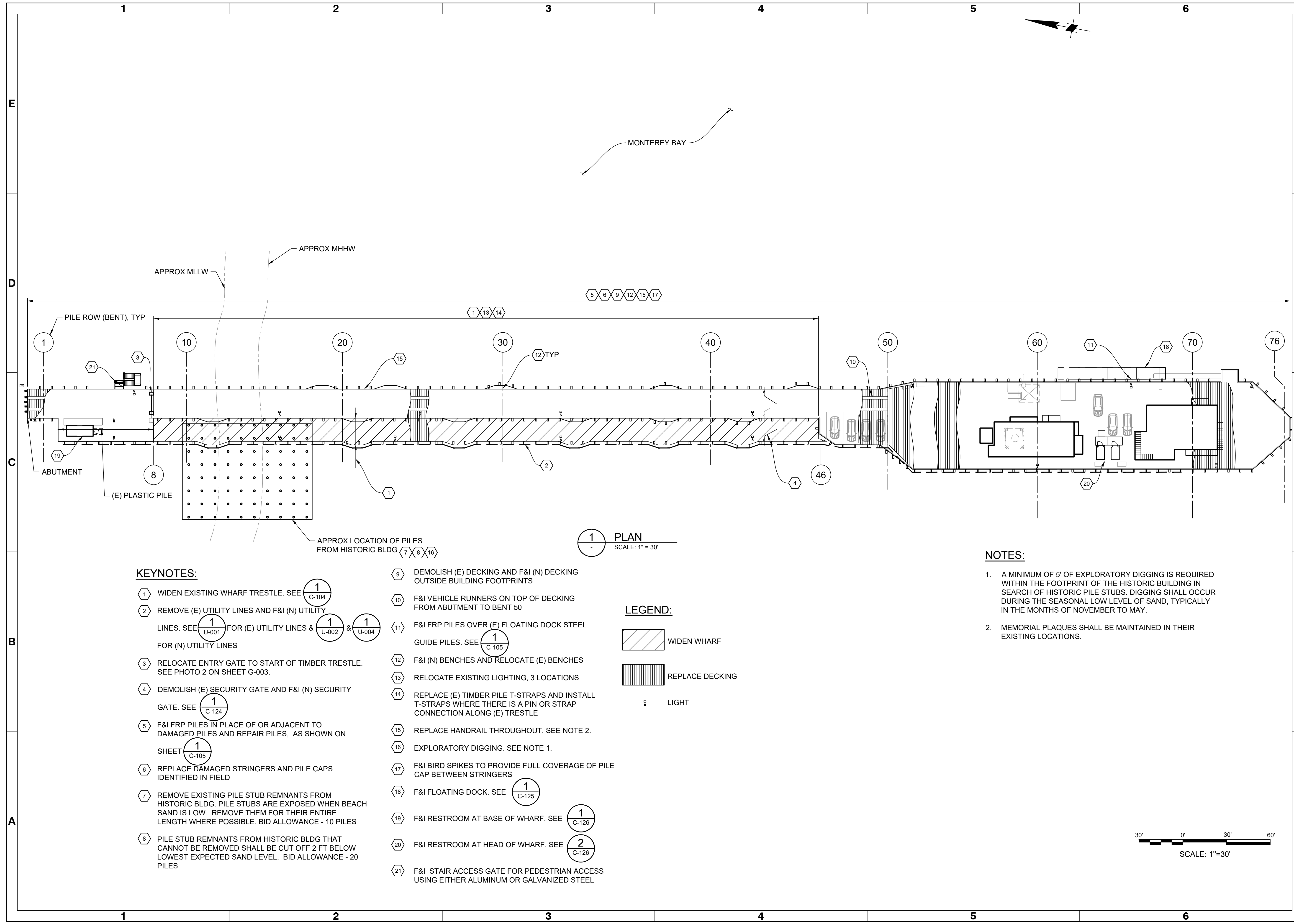
Designed by: AC	Drawn by: AC	Checked by: BP	Reviewed by:	Submitted by: MOFFATT & NICHOL
Date: 4/18/2023	M&N Project No.: 9154-01	Drawing code:	Drawing Scale: 1" = 30'	Plot Scale: 1" = 30' (0 SHEET)

2185 N. CALIFORNIA BLVD.  
SUITE 500  
WALNUT CREEK, CA 94596

**moffatt & nichol**



Sheet Reference No.  
**C-103**  
INDEX: 8 OF 37



**1 PLAN**  
SCALE: 1" = 30'

**KEYNOTES:**

- 1 WIDEN EXISTING WHARF TRESTLE. SEE **1** C-104
- 2 REMOVE (E) UTILITY LINES AND F&I (N) UTILITY LINES. SEE **1** U-001 FOR (E) UTILITY LINES & **1** U-002 & **1** U-004 FOR (N) UTILITY LINES
- 3 RELOCATE ENTRY GATE TO START OF TIMBER TRESTLE. SEE PHOTO 2 ON SHEET G-003.
- 4 DEMOLISH (E) SECURITY GATE AND F&I (N) SECURITY GATE. SEE **1** C-124
- 5 F&I FRP PILES IN PLACE OF OR ADJACENT TO DAMAGED PILES AND REPAIR PILES, AS SHOWN ON SHEET **1** C-105
- 6 REPLACE DAMAGED STRINGERS AND PILE CAPS IDENTIFIED IN FIELD
- 7 REMOVE EXISTING PILE STUB REMNANTS FROM HISTORIC BLDG. PILE STUBS ARE EXPOSED WHEN BEACH SAND IS LOW. REMOVE THEM FOR THEIR ENTIRE LENGTH WHERE POSSIBLE. BID ALLOWANCE - 10 PILES
- 8 PILE STUB REMNANTS FROM HISTORIC BLDG THAT CANNOT BE REMOVED SHALL BE CUT OFF 2 FT BELOW LOWEST EXPECTED SAND LEVEL. BID ALLOWANCE - 20 PILES
- 9 DEMOLISH (E) DECKING AND F&I (N) DECKING OUTSIDE BUILDING FOOTPRINTS
- 10 F&I VEHICLE RUNNERS ON TOP OF DECKING FROM ABUTMENT TO BENT 50
- 11 F&I FRP PILES OVER (E) FLOATING DOCK STEEL GUIDE PILES. SEE **1** C-105
- 12 F&I (N) BENCHES AND RELOCATE (E) BENCHES
- 13 RELOCATE EXISTING LIGHTING, 3 LOCATIONS
- 14 REPLACE (E) TIMBER PILE T-STRAPS AND INSTALL T-STRAPS WHERE THERE IS A PIN OR STRAP CONNECTION ALONG (E) TRESTLE
- 15 REPLACE HANDRAIL THROUGHOUT. SEE NOTE 2.
- 16 EXPLORATORY DIGGING. SEE NOTE 1.
- 17 F&I BIRD SPIKES TO PROVIDE FULL COVERAGE OF PILE CAP BETWEEN STRINGERS
- 18 F&I FLOATING DOCK. SEE **1** C-125
- 19 F&I RESTROOM AT BASE OF WHARF. SEE **1** C-126
- 20 F&I RESTROOM AT HEAD OF WHARF. SEE **2** C-126
- 21 F&I STAIR ACCESS GATE FOR PEDESTRIAN ACCESS USING EITHER ALUMINUM OR GALVANIZED STEEL

**LEGEND:**

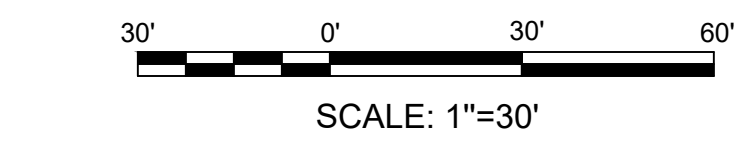
WIDEN WHARF

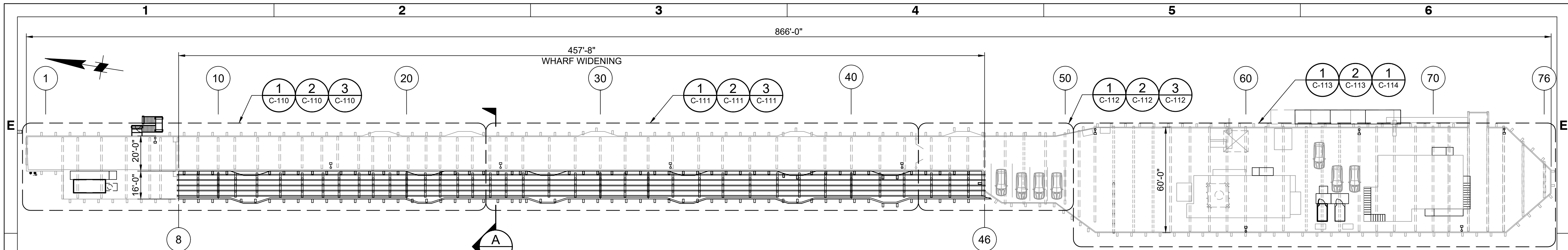
REPLACE DECKING

LIGHT

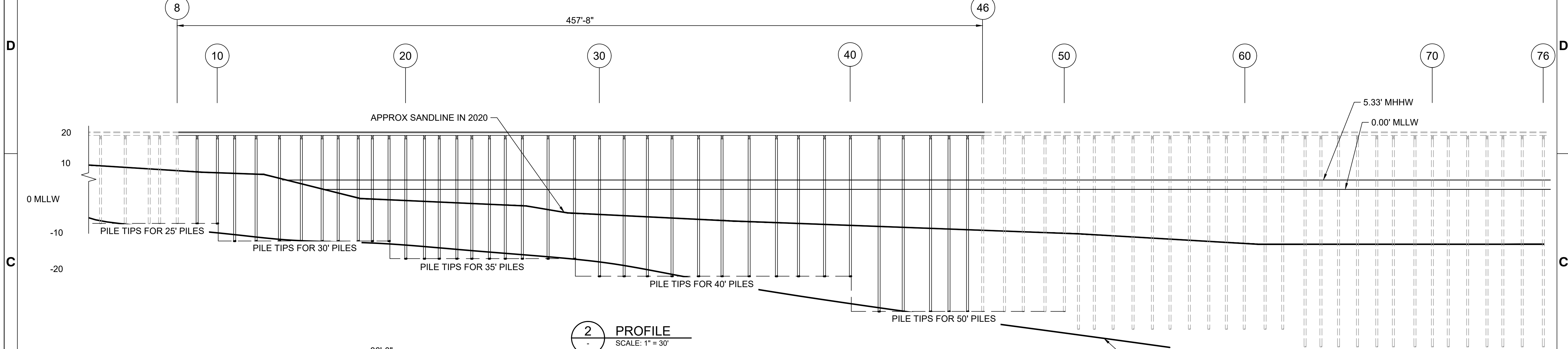
**NOTES:**

1. A MINIMUM OF 5' OF EXPLORATORY DIGGING IS REQUIRED WITHIN THE FOOTPRINT OF THE HISTORIC BUILDING IN SEARCH OF HISTORIC PILE STUBS. DIGGING SHALL OCCUR DURING THE SEASONAL LOW LEVEL OF SAND, TYPICALLY IN THE MONTHS OF NOVEMBER TO MAY.
2. MEMORIAL PLAQUES SHALL BE MAINTAINED IN THEIR EXISTING LOCATIONS.

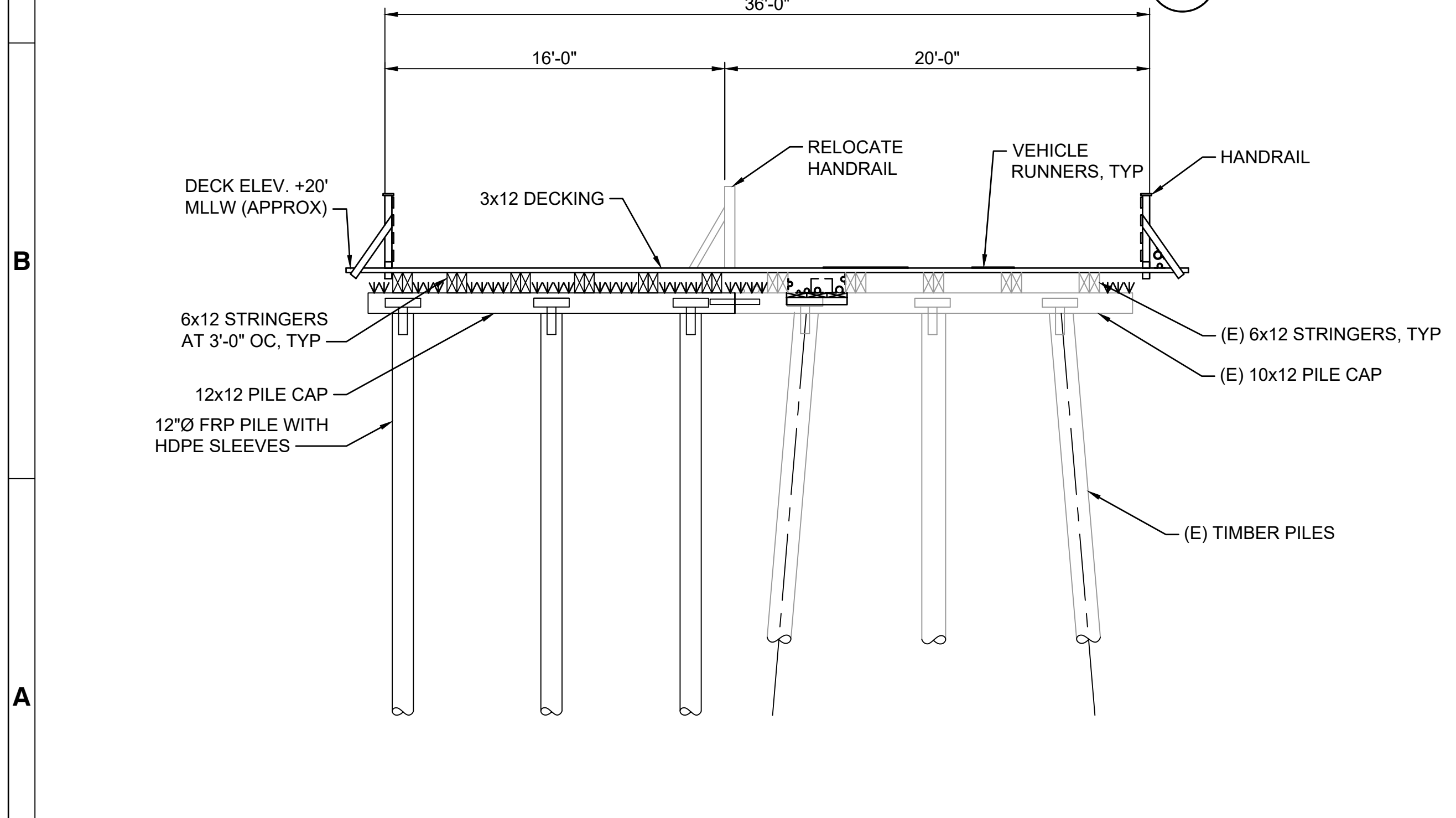




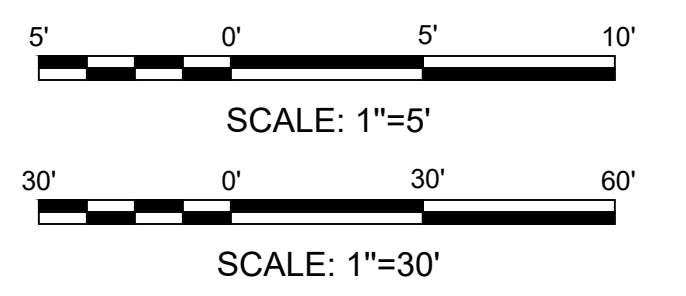
**1 PLAN**  
SCALE: 1" = 30'



**2 PROFILE**  
SCALE: 1" = 30'



**A SECTION**  
SCALE: 1" = 5'



Mark	Description	Date	Appr.

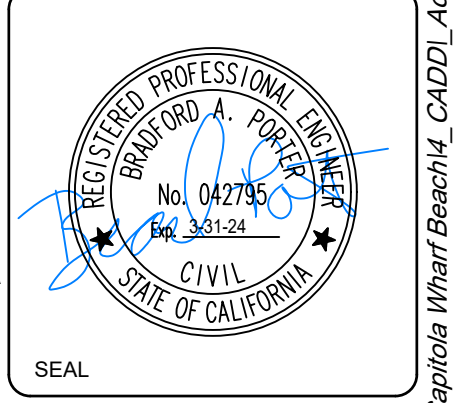
**CAPITOLA WHARF  
RESILIENCY AND PUBLIC ACCESS  
IMPROVEMENT PHASE 2**

**WIDENING WHARF PLAN  
AND SECTION**

Designed by: AC	Date: 4/18/2023	Rev:
Dwn by: AC	M&N Project No.: 9154-01	4/18/2023
Reviewed by: BP	Drawing code:	1:1 (0 SHEET)
Submitted by: MOFFATT & NICHOL	Drawing Scale:	1:1 (0 SHEET)

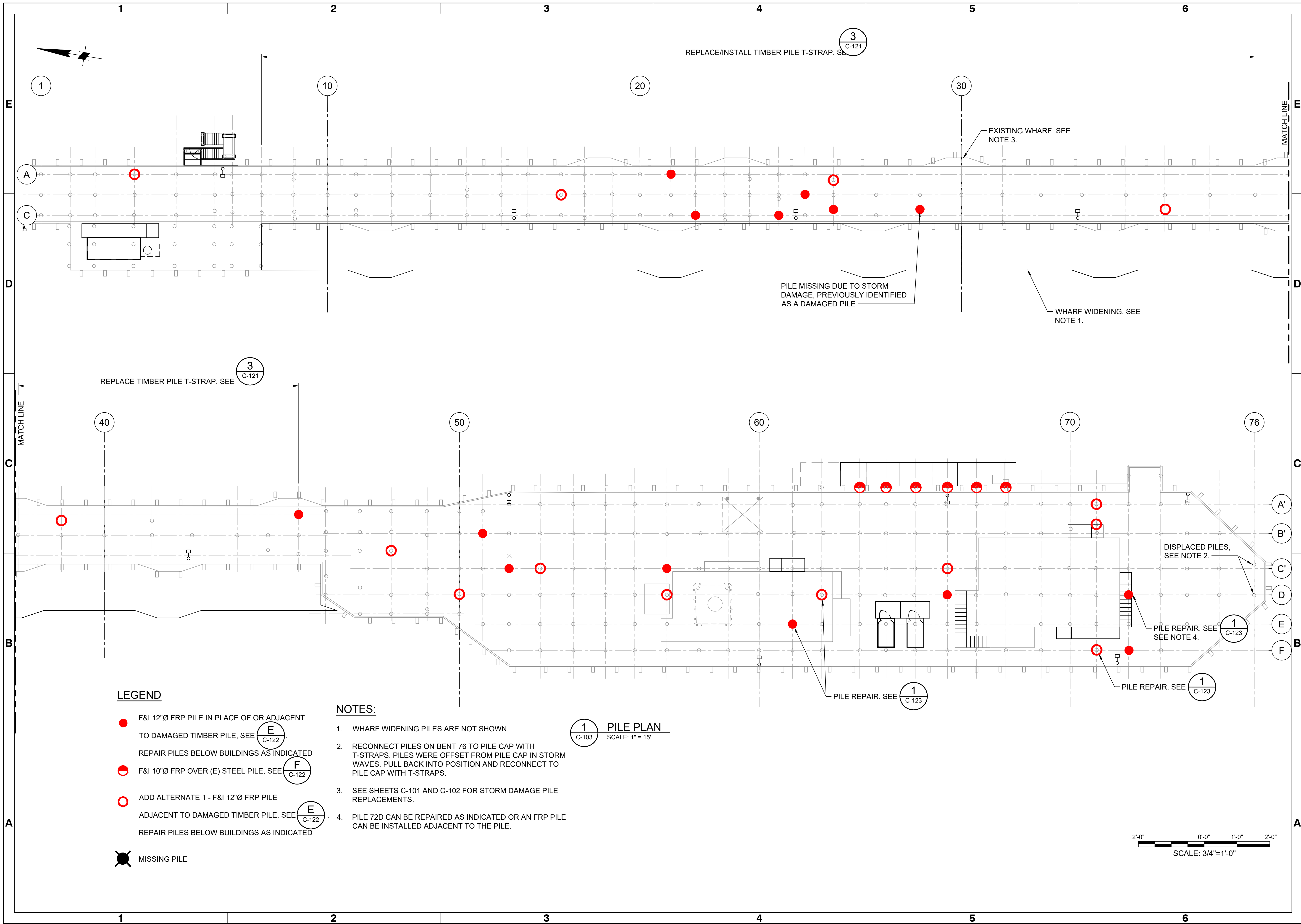
2185 N. CALIFORNIA BLVD.  
SUITE 500  
WALNUT CREEK, CA 94596

**moffatt & nichol**



Sheet Reference No.  
**C-104**  
INDEX: 9 OF 37





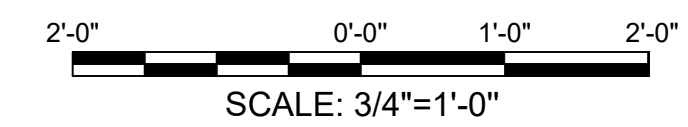
**LEGEND**

- F&I 12"Ø FRP PILE IN PLACE OF OR ADJACENT TO DAMAGED TIMBER PILE, SEE E  
C-122
- REPAIR PILES BELOW BUILDINGS AS INDICATED
- ⊖ F&I 10"Ø FRP OVER (E) STEEL PILE, SEE F  
C-122
- ADD ALTERNATE 1 - F&I 12"Ø FRP PILE ADJACENT TO DAMAGED TIMBER PILE, SEE E  
C-122
- REPAIR PILES BELOW BUILDINGS AS INDICATED
- ⊗ MISSING PILE

**NOTES:**

1. WHARF WIDENING PILES ARE NOT SHOWN.
2. RECONNECT PILES ON BENT 76 TO PILE CAP WITH T-STRAPS. PILES WERE OFFSET FROM PILE CAP IN STORM WAVES. PULL BACK INTO POSITION AND RECONNECT TO PILE CAP WITH T-STRAPS.
3. SEE SHEETS C-101 AND C-102 FOR STORM DAMAGE PILE REPLACEMENTS.
4. PILE 72D CAN BE REPAIRED AS INDICATED OR AN FRP PILE CAN BE INSTALLED ADJACENT TO THE PILE.

1  
C-103 **PILE PLAN**  
SCALE: 1" = 15'



Rev.	Date	Description

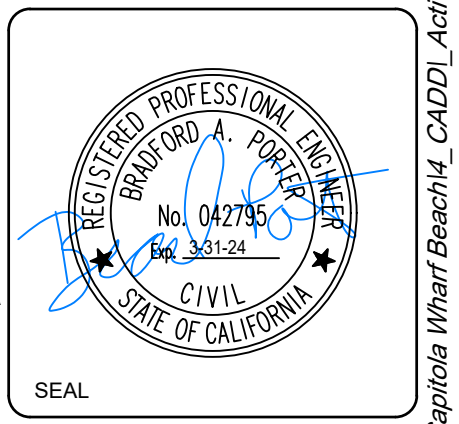
**CAPITOLA WHARF  
RESILIENCY AND PUBLIC ACCESS  
IMPROVEMENT PHASE 2**

**WHARF PILE REPAIRS**

Designed by: AC	Drawn by: AC	Reviewed by: BP	Submitted by: MORFATT & NICHOL
Date: 4/18/2023	MAN Project No.: 9154-01	Drawing code:	Drawing Scale: 1" (0 SHEET)

2185 N. CALIFORNIA BLVD.  
SUITE 500  
WALNUT CREEK, CA 94596

**morfatt & nichol**



Sheet Reference No.  
**C-105**

INDEX: 10 OF 37

File: C:\MOC\154-01 Capitola Wharf Beach CADD\Active\Wharf\_Sheet Set\15401-C-105 - Piled. 4/19/2023 1:52 PM by CANEPA, ALLISON ; Saved: 4/19/2023 8:45 AM by JESTRADA







Rev.	Date	Description	Mark

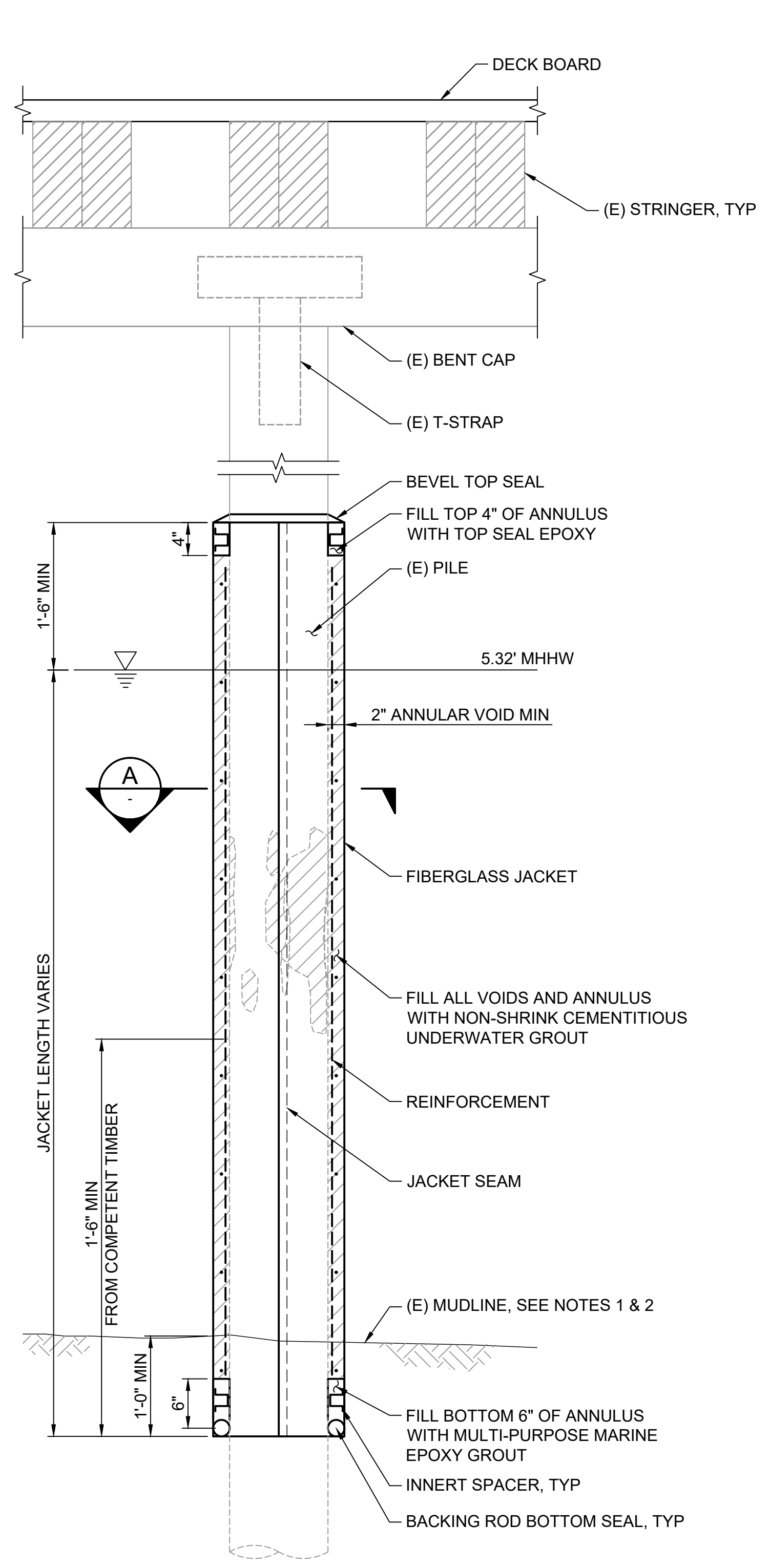
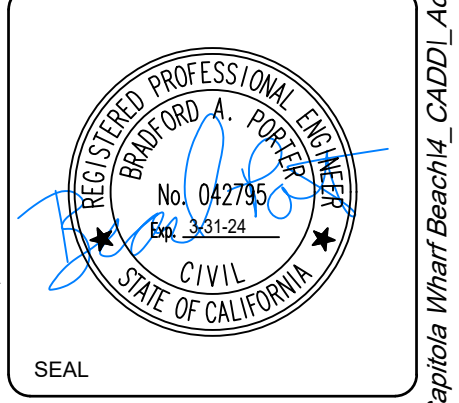
**CAPITOLA WHARF  
RESILIENCY AND PUBLIC ACCESS  
IMPROVEMENT PHASE 2**

**TYPICAL DETAILS 3 OF 3**

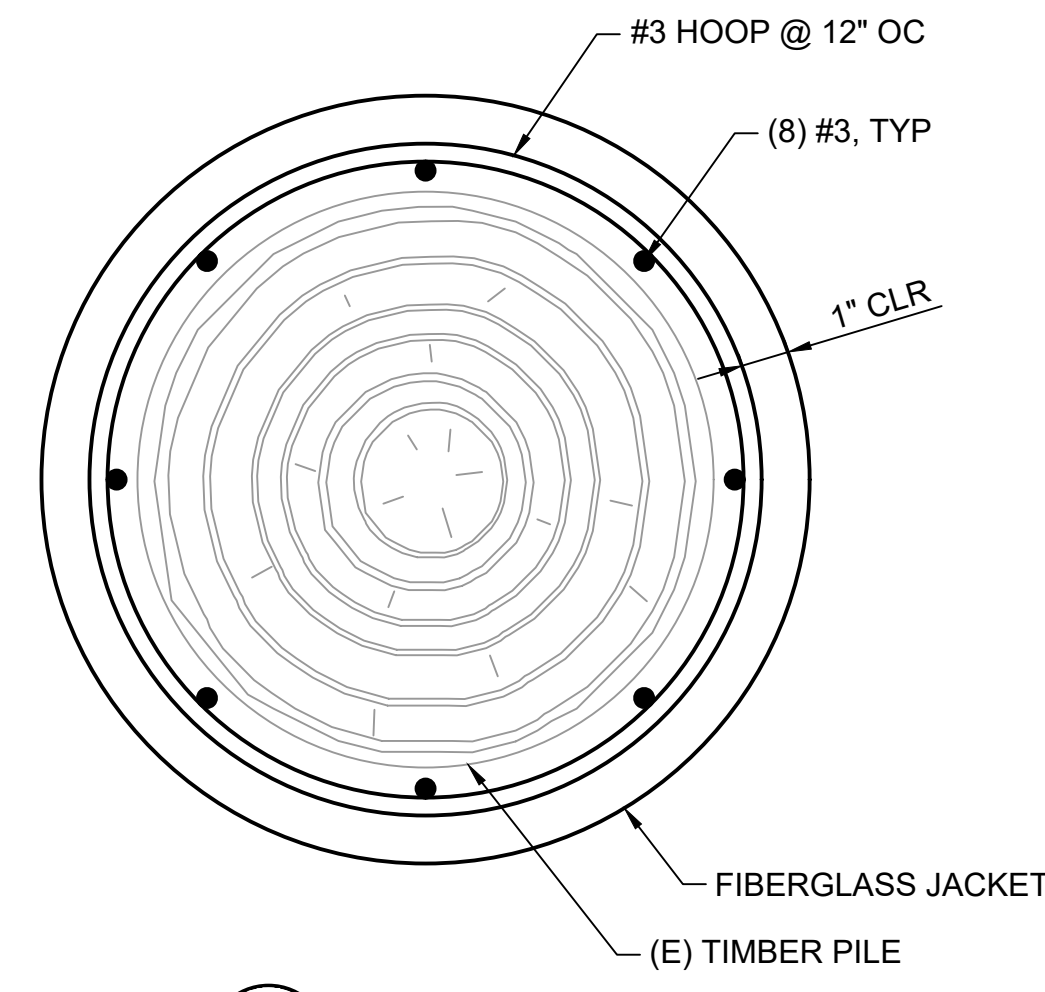
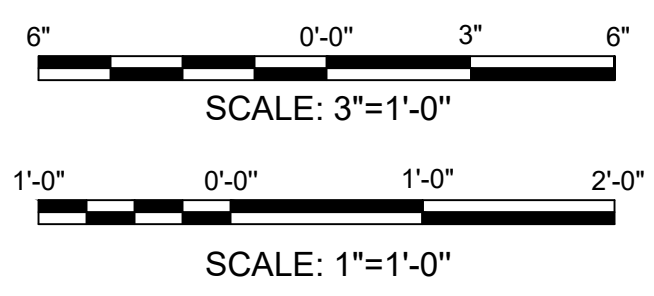
Designed by:	AC	Drawn by:	AC	Reviewed by:	MOFFATT & NICHOL	Submitted by:	MOFFATT & NICHOL
Date:	4/18/2023	M&N Project No.:	9154-01	Drawing code:		Per scale:	1:1 (0 SHEET)
2185 N. CALIFORNIA BLVD. SUITE 500 WALNUT CREEK, CA 94596		Drawn by:	BP	Reviewed by:		Submitted by:	

2185 N. CALIFORNIA BLVD.  
SUITE 500  
WALNUT CREEK, CA 94596

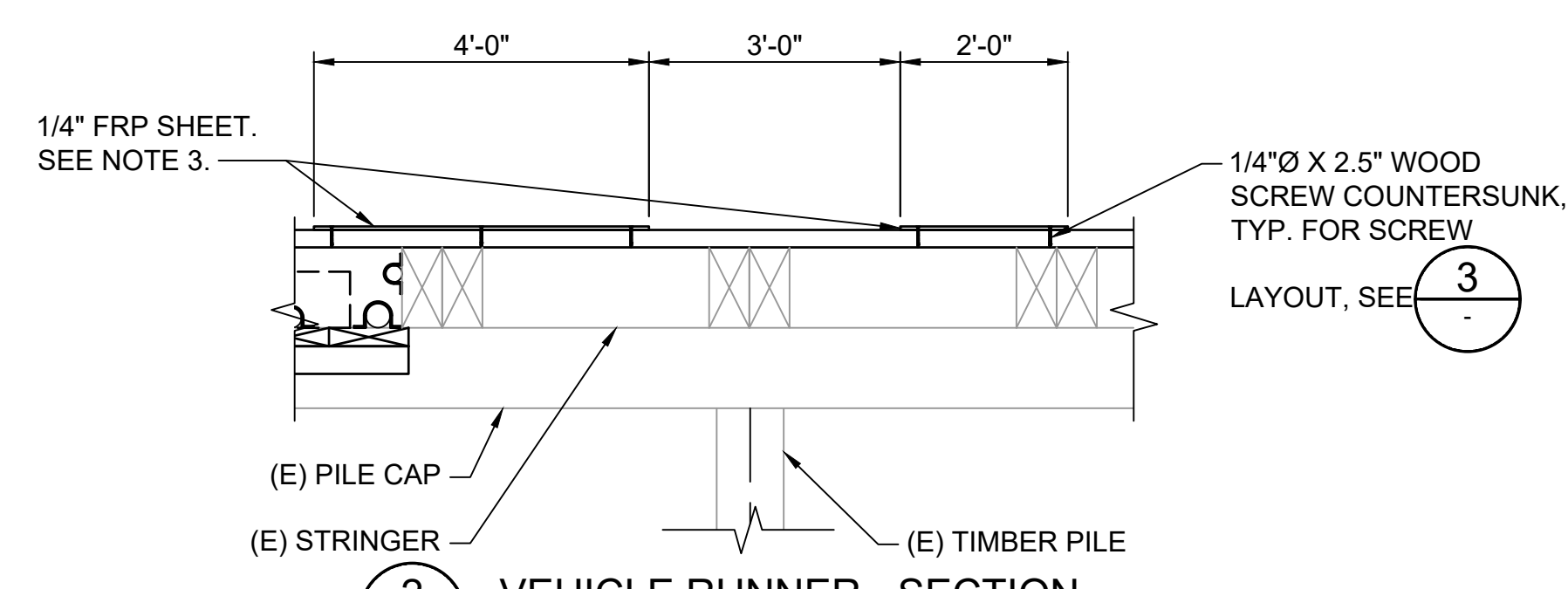
**moffatt & nichol**



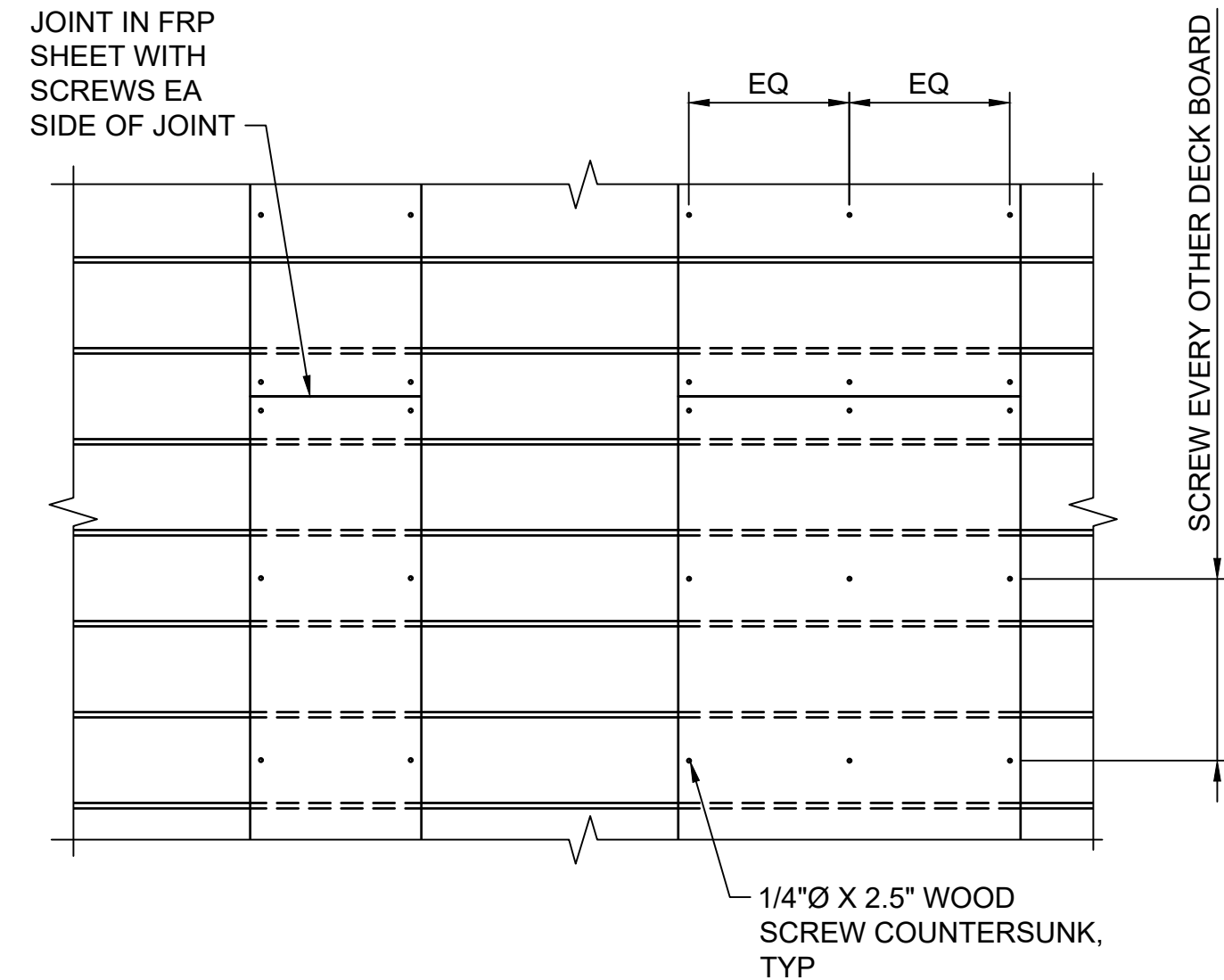
**1 PILE REPAIR DETAIL**  
SCALE: 1" = 1'-0"



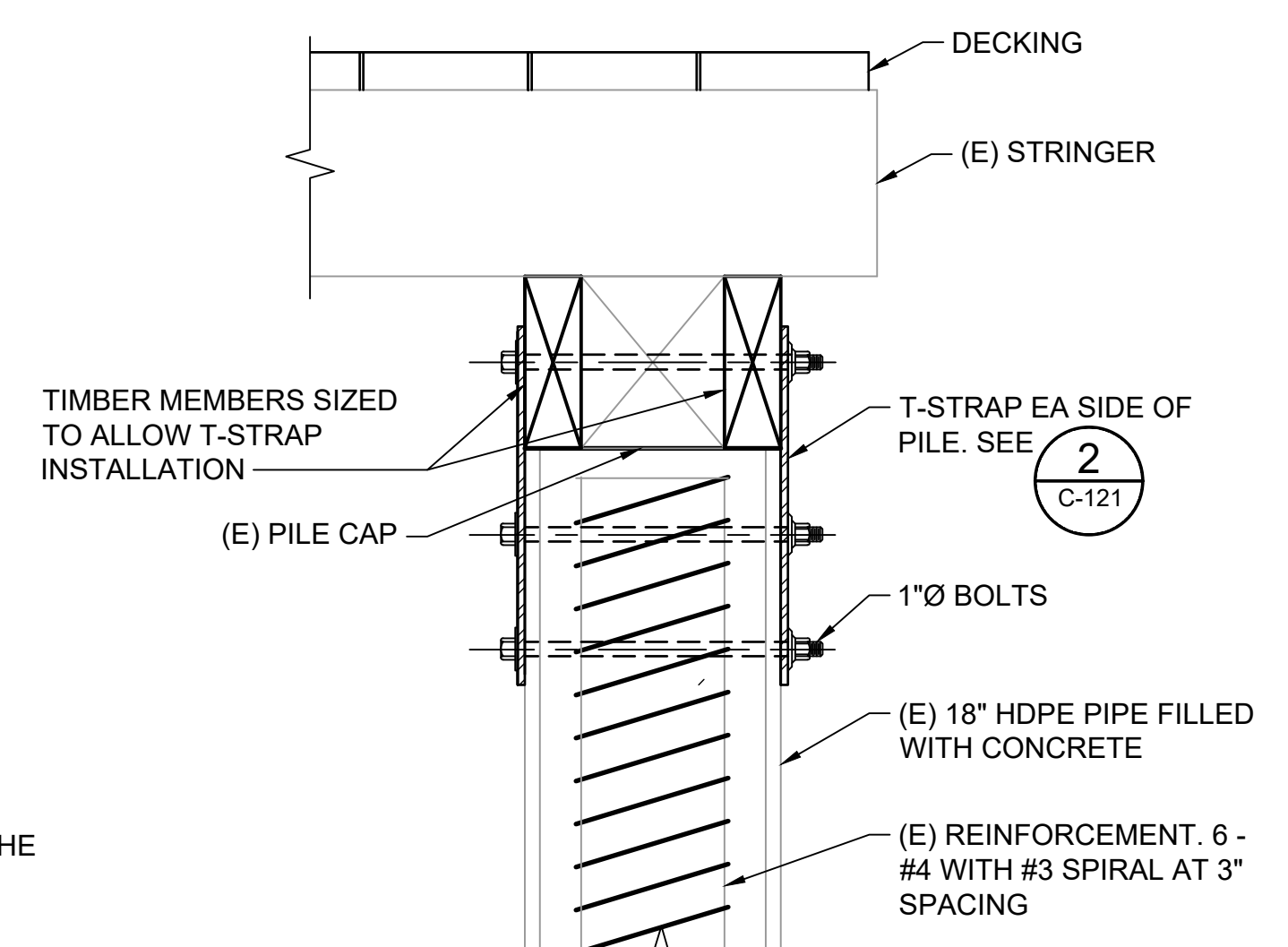
**A SECTION**  
SCALE: 3" = 1'-0"



**2 VEHICLE RUNNER - SECTION**  
SCALE: 1/2" = 1'-0"



**3 VEHICLE RUNNER - DETAIL**  
SCALE: 1/2" = 1'-0"



**4 PILE CAP RECONNECTION**  
SCALE: 1" = 1'-0"

- NOTES:**
- EXCAVATE THE AREA AROUND THE PILE TO EXTEND THE PILE JACKET BELOW MUDLINE.
  - AFTER INSTALLATION OF THE JACKET IS COMPLETE, BACKFILL THE EXCAVATED AREA AROUND THE PILE WITH NATIVE MATERIAL.
  - FRP SHEET SHALL BE PROFORM FLAT SHEET WITH ALUMINUM OXIDE GRIT SURFACE BY GRATING SYSTEMS, INC OR CITY APPROVED EQUAL.



Rev.	Date	Description

**CAPITOLA WHARF  
RESILIENCY AND PUBLIC ACCESS  
IMPROVEMENT PHASE 2**

**SECURITY GATE DETAILS**

Designed by: AC	Drawn by: AC	Reviewed by: BP	Submitted by: MOFFATT & NICHOL
Date: 4/18/2023	M&N Project No.: 9154-01	Drawing code:	Per Scale: 1" = (0 SHEET)

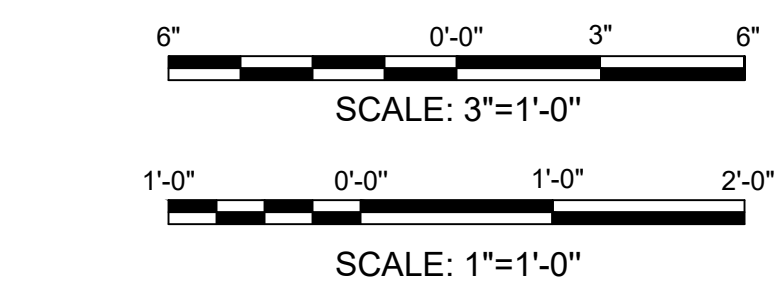
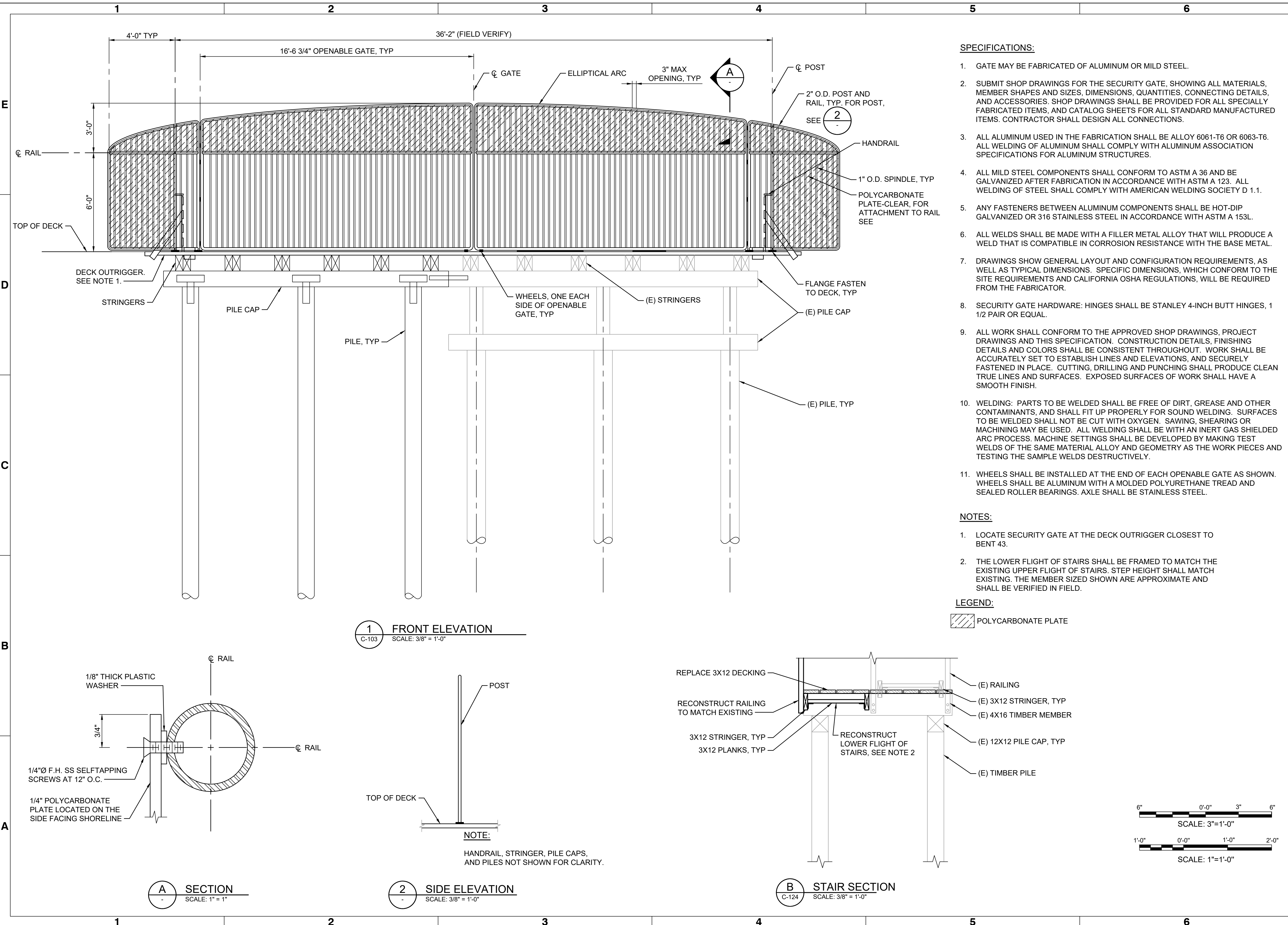
2185 N. CALIFORNIA BLVD.  
SUITE 500  
WALNUT CREEK, CA 94596

**moffatt & nichol**



Sheet Reference No.  
**C-124**

INDEX: 21 OF 37



DRAWING SCALES SHOWN BASED ON 22"x34" DRAWING







Rev.	Date	Description	Mark

**CAPITOLA WHARF  
RESILIENCY AND PUBLIC ACCESS  
IMPROVEMENT PHASE 2**

**WHARF RESTROOMS  
2 OF 2**

Designed by: JIE	Drawn by: JIE	Reviewed by: BP	Submitted by: MCFATT & NICHOL
Date: 4/18/2023	M&N Project No.: 9154-01	Drawing code:	Per Scale: 1:1 (0 SHEET)

2185 N. CALIFORNIA BLVD.  
SUITE 500  
WALNUT CREEK, CA 94596

**mofatt & nichol**



Sheet Reference No.  
**C-127**

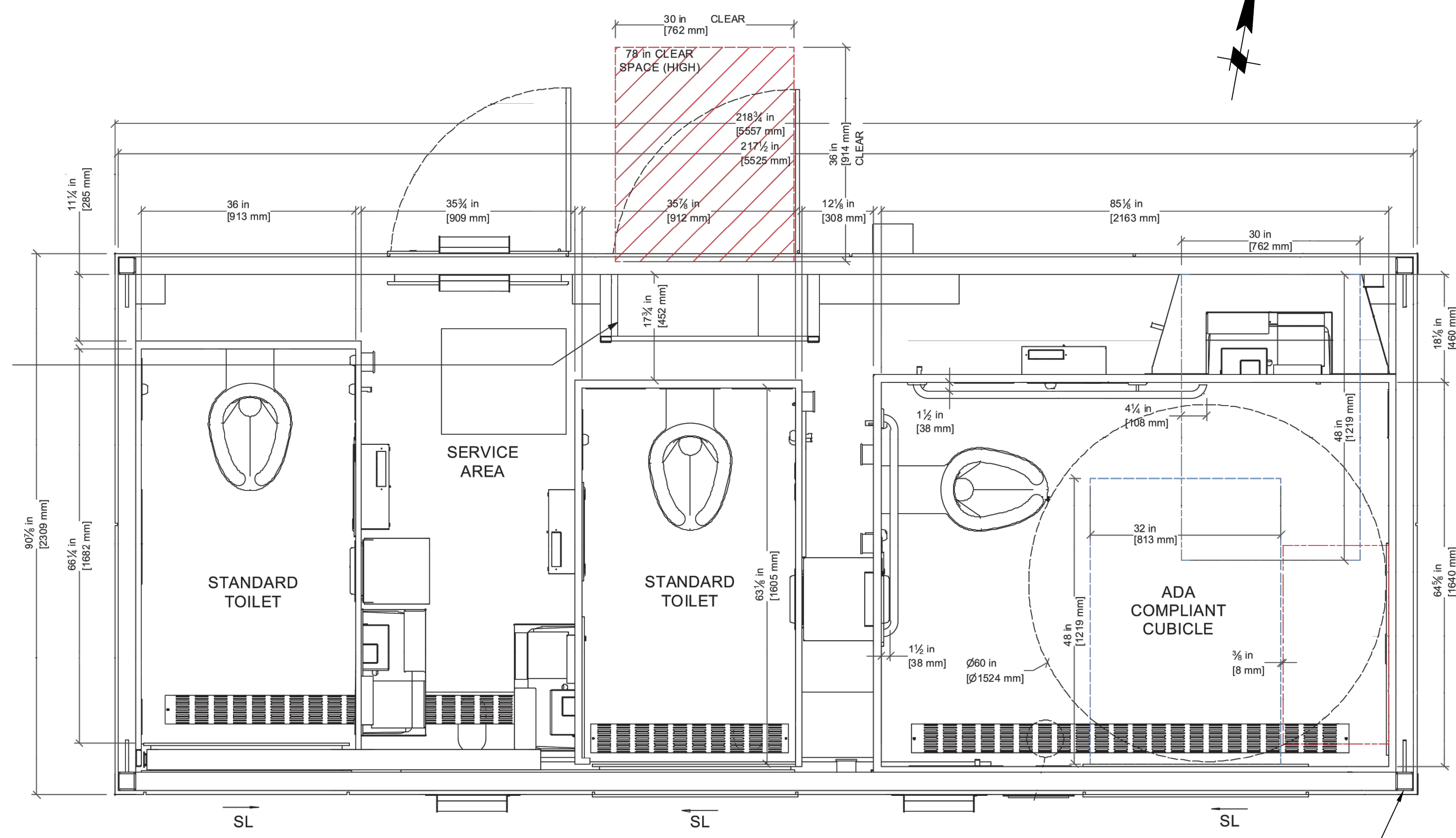
INDEX: 24 OF 37



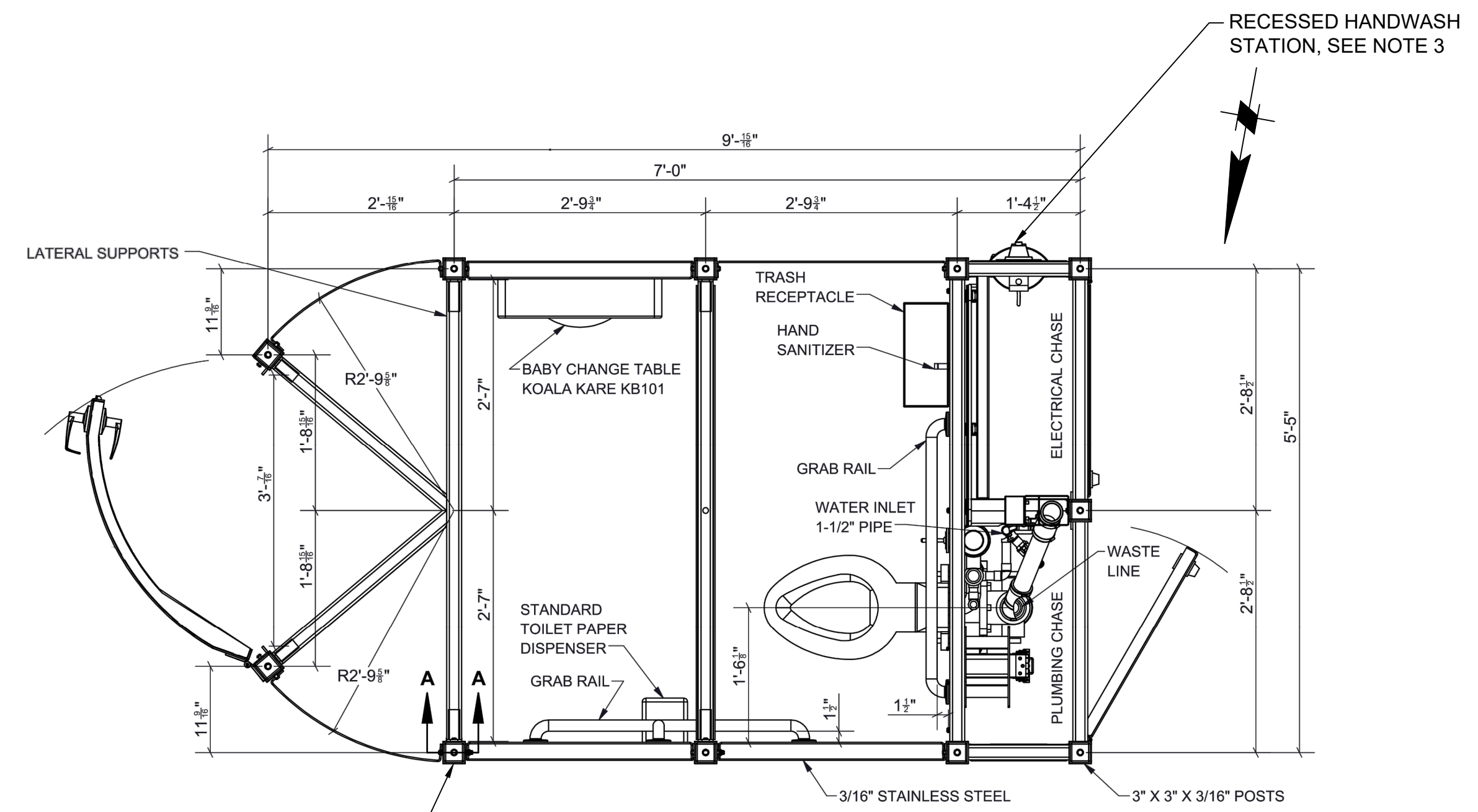
**2** 3-STALL PREFABRICATED RESTROOM  
SCALE: NTS



**4** 1-STALL PREFABRICATED RESTROOM  
SCALE: NTS



**1** 3-STALL PREFABRICATED RESTROOM PLAN  
SCALE: 3/4" = 1'-0"



**3** 1-STALL PREFABRICATED RESTROOM PLAN  
SCALE: 3/4" = 1'-0"

**NOTES:**

- MODEL SHOWN FOR THE PREFABRICATED RESTROOM - 3 STALLS IS THE JUPITER TRIPLE BY EXELOO, OR APPROVED EQUAL.
- MODEL SHOWN FOR THE PREFABRICATED RESTROOM - 1 STALL IS THE 316 SS PORTLAND LOO BY MADDEN FABRICATION OR APPROVED EQUAL.
- RECESSED HANDWASH STATION SHOULD BE LOCATED ON THE SIDE FACING THE BOAT & BAIT SHOP, ENSURE THAT THE STATION IS ACCESSIBLE PER CBC GUIDELINES.

