

### SURFACE LEGEND

-  GRAY CONCRETE PAVING
-  RUBBER RESILIENT SURFACE
-  RESILIENT WOOD WALKWAY
-  SOD
-  RAIN GARDEN PLANTING
-  CALIFORNIA MEADOW - NATIVE HYDROSEED
-  SENSORY PLANTING

### CONCEPT LEGEND

- ① EXISTING PARKING LOT
- ② ENTRY MONUMENT
- ③ GROUP PICNIC TABLE (3)
- ④ TRASH CONTAINERS
- ⑤ FENCING - 48" TALL
- ⑥ SEATING PAD
- ⑦ SLOPED WALKWAY
- ⑧ GAME TABLE
- ⑨ BANNER POLE
- ⑩ BENCH (4)
- ⑪ TRIKE TRACK
- ⑫ HANDRAIL AT THE CLIMBING SLOPE

### PLAY EQUIPMENT

- A 3-BAY SWING
- B VOLTA SPINNER
- C 4-SEATS ROCKER
- D 5-12 COMPOSITE PLAY STRUCTURE
- E INCLUSIVE WHIRL
- F WHIMSY RIDER DOLPHIN (2)
- G PLAY SHIP
- H COZY DOME
- I STRAIGHT SLIDE (2)
- J PERCUSSION CAJON BOX (2)
- K SANSA RIMBA
- L NOVO TEARDROP COUNTER
- M LOOP CLIMBERS (2)
- N ROCK CLIMBERS
- O RUBBER BALL CLIMBERS (4)
- P COMMUNICATION BOARD



Preferred Plan  
 Jade Street Park Universally Accessible Playground  
 City of Capitola  
 4400 Jade St, Capitola, CA 95010

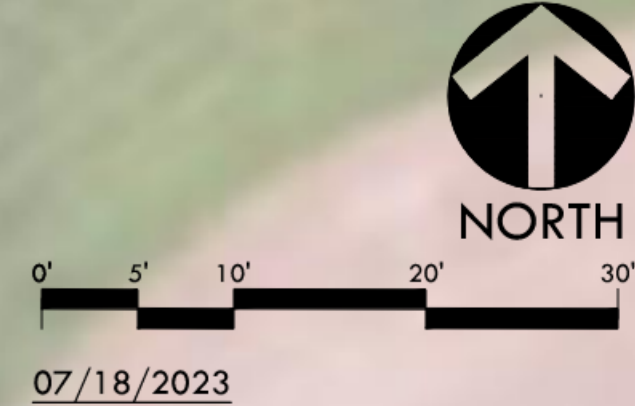

07/18/2023

1:\Projects\SC\2023\23003000 - Capitola Jade St Playground RFP\CAD\Concept\_A\Jade St Color Plan.dwg Jul 18, 2023 10:51am



**Jade Street Playground Project - Preferred Plan**

July 18, 2023

**City of Capitola**

Verde Design Inc.

Preliminary Construction Cost Estimate  
 VERDE DESIGN PROJECT NO. 2300300

Completed by: DL  
 Reviewed by: TY

Cost Estimate: Play Area

\$1,157,089

Cost Estimate: Play Area with Construction Contingencies

\$1,492,644

ITEM DESCRIPTION	QUANTITY	UNIT	UNIT PRICE	EXTENDED PRICE
<b>1 Site Clearing and Demolition</b>				<b>\$54,538.60</b>
Tree Protection	5	ea.	\$500.00	\$2,500.00
Spray, Clear, Grub and Strip existing landscape areas	16,425	sf	\$0.50	\$8,212.50
Demolish DG Paving	1,224	sf	\$2.50	\$3,060.00
Demolish and Remove Existing Play Equipment	1	allow	\$20,000.00	\$20,000.00
Demolish Hardscape	896	sf	\$1.60	\$1,433.60
Demolish 24" Concrete Curb at Play Area	405	lf	\$10.00	\$4,050.00
Demolish Concrete Edgeband	51	sf	\$15.00	\$765.00
Remove and Reused at Dog Walkway	9,235	sf	\$0.50	\$4,617.50
Remove and Salvage Bench	6	ea.	\$200.00	\$1,200.00
Remove and Salvage Trash Receptcle	3	ea.	\$200.00	\$600.00
Remove Drinking Fountain	1	ea.	\$1,000.00	\$1,000.00
Remove Signage	1	ea.	\$500.00	\$500.00
Remove Irrigation Pipe, Valves, and Heads, and Cap Main and Lateral Lines	1	ls	\$1,500.00	\$1,500.00
Demolish and Remove Existing Tree	3	ea.	\$1,200.00	\$3,600.00
Miscellaneous Demolition	1	ls	\$1,500.00	\$1,500.00
<b>2 Site Grading and Earthwork</b>				<b>\$60,201.93</b>
Rough Grading	31,049	sf	\$1.40	\$43,468.60
Off-haul and Disposal (allowance 6")	279	cy	\$60.00	\$16,733.33
<b>3 Drainage / Utilities</b>				<b>\$56,277.83</b>
Drainage	14,122	sf	\$2.50	\$35,305.00
Drainage Point of Connection	1	ls	\$1,500.00	\$1,500.00
<b>C3 Area (Hardscape)</b>				
Biofiltration Soil -24"	69	cy	\$85.00	\$5,899.63
Biofiltration Drain Rock Base - 24" depth	937	sf	\$3.60	\$3,373.20
6" Perforated Underdrain	80	lf	\$60.00	\$4,800.00
Cleanouts	2	ea	\$500.00	\$1,000.00
Rasied Catch Basin -18"	2	ea	\$2,200.00	\$4,400.00
<b>4 Hardscape</b>				<b>\$352,768.00</b>
Std. Concrete Paving - Pedestrian	3,621	sf	\$14.00	\$50,694.00
Concrete Paving with Thickened Edge	487	lf	\$50.00	\$24,350.00
Resilient Surfacing with Aggregate Base	7,814	sf	\$25.00	\$195,350.00
Resilient Surfacing at Sloped Concrete Slab at Toddler Play Area	451	sf	\$40.00	\$18,040.00
Resilient Wood Walkway on Grade w/ recycled Existing Wood Fiber	0	sf	\$1.75	\$0.00
Wood Header at Resilient Wood Walkway	633	lf	\$8.00	\$5,064.00
Concrete Seating Pad	1	ea	\$2,000.00	\$2,000.00
Concrete Trike Track	1,520	sf	\$14.00	\$21,280.00
Sloped Walkway at Toddler Area - Concrete Paving	515	sf	\$25.00	\$12,875.00
<b>Edgeband / Curb</b>				
12" Wide Concrete Edgeband	46	lf	\$75.00	\$3,450.00
6" Wide Concrete Curb	81	lf	\$65.00	\$5,265.00
12" Wide Concrete Curb	92	lf	\$100.00	\$9,200.00
Footing for Sloped Concrete at Resilient Surfacing	80	lf	\$65.00	\$5,200.00
<b>5 Gateway &amp; Fencing</b>				<b>\$89,675.00</b>
Entry Monument	1	ls	\$50,000.00	\$50,000.00
48" Tall Metal Fence	405	lf	\$95.00	\$38,475.00
Handrail at Climbing Slope	10	lf	\$120.00	\$1,200.00
<b>6 Site Furnishings</b>				<b>\$20,528.00</b>
Group Picnic Table - 4 Seat w/ 1 ADA	3	ea.	\$3,528.00	\$10,584.00
Reinstall Existing Bench	6	ea	\$200.00	\$1,200.00
Game Table	1	ea.	\$2,344.00	\$2,344.00
Reinstall Existing Trash Receptcle	2	ea.	\$200.00	\$400.00
Banner Pole	1	ea.	\$2,500.00	\$2,500.00
Communication Board	1	ea.	\$3,500.00	\$3,500.00

**7 Playground Equipment** **\$399,786.04**

**5-12 Years PlayArea**

**Climber and Slide Zone**

5-12 Composite play Struture (simplified)	1	ea.	\$145,000.00	\$145,000.00
Burke 4 Seat Orb Rocker	1	ea.	\$8,550.00	\$8,550.00

**Swing and Sway Zone**

3-Bay Swing w/ (2) Belt, (2) Full Bucket & (1) Molded Bucket seats	1	ea.	\$12,000.00	\$12,000.00
Volta Spinner	1	ea.	\$8,000.00	\$8,000.00
Inclusive Whirl (Gametime)	1	ea.	\$18,000.00	\$18,000.00

**Tot Play**

**Climber and Slide Zone**

Small Embankment Slide	2	ea.	\$3,000.00	\$6,000.00
Cozy Dome	1	ea.	\$5,680.00	\$5,680.00
Novo Teardrop Counter Climber	1	ea.	\$3,000.00	\$3,000.00
Imagination Play Ship	1	ea.	\$17,995.00	\$17,995.00
Whimsy Rider Dolphin w/ Coil Spring	2	ea.	\$1,840.00	\$3,680.00
Hillside Loop Climber	2	ea.	\$180.00	\$360.00
Rock Climber	1	ls	\$1,250.00	\$1,250.00
Rubber Ball Climber	4	ea.	\$180.00	\$720.00

**Sensory Play Zone**

Percussion Cajon Box	2	ea.	\$2,500.00	\$5,000.00
Sansa Rimba	1	ea.	\$3,800.00	\$3,800.00

**Play Equipment Subtotal Estimate:**

**\$239,035.00**

<b>Tax, 9.25%</b>	\$22,110.74
<b>Freight, approx. 10%</b>	\$23,903.50
<b>Installation, approx. 35%</b>	\$83,662.25
<b>Contractor mark-up, at 10%</b>	\$23,903.50
<b>Manufacturer's schedule surcharge 3%</b>	\$7,171.05

**8 Irrigation and Planting**

**\$123,313.10**

Planting (Shrubs, Ground Covers, Mulch, Fine Grading)	2138	sf	\$2.50	\$5,345.00
Sod Grass	6102	sf	\$2.30	\$14,034.60
Native Hydroseed	6726	sf	\$0.50	\$3,363.00
Tree 1.5 gallon	36	ea.	\$800.00	\$28,800.00
Bark Mulch	8,864	sf	\$0.75	\$6,648.00
Landscape - 90 day Maintenance Period	14,966	sf	\$0.25	\$3,741.50
Irrigation (Main/Lateral Line, Drip & Bubbler)	14,966	sf	\$3.50	\$52,381.00
Remote Control Valves	3	ea.	\$1,000.00	\$3,000.00
Quick Coupler Valves	3	ea.	\$500.00	\$1,500.00
Gate Valves	4	ea.	\$500.00	\$2,000.00
Wiring	1	ls	\$1,000.00	\$1,000.00
Retrofit Existing Irrigation	1	ls	\$1,500.00	\$1,500.00

**Estimated Construction Subtotal**

**\$1,157,088.50**

Survey, Permits, Traffic, SWPPP, etc. - 3%	\$34,713.00
Mobilization, Bonding & Project Management -10%	\$115,709.00
Bidding & Inflation Contingency 5% (First Year)	\$57,854.00
Construction Contingency 6%	\$69,425.00
Design Contingency 5%	\$57,854.00

**Total Estimated Project Field Construction Costs:**

**\$1,492,643.50**