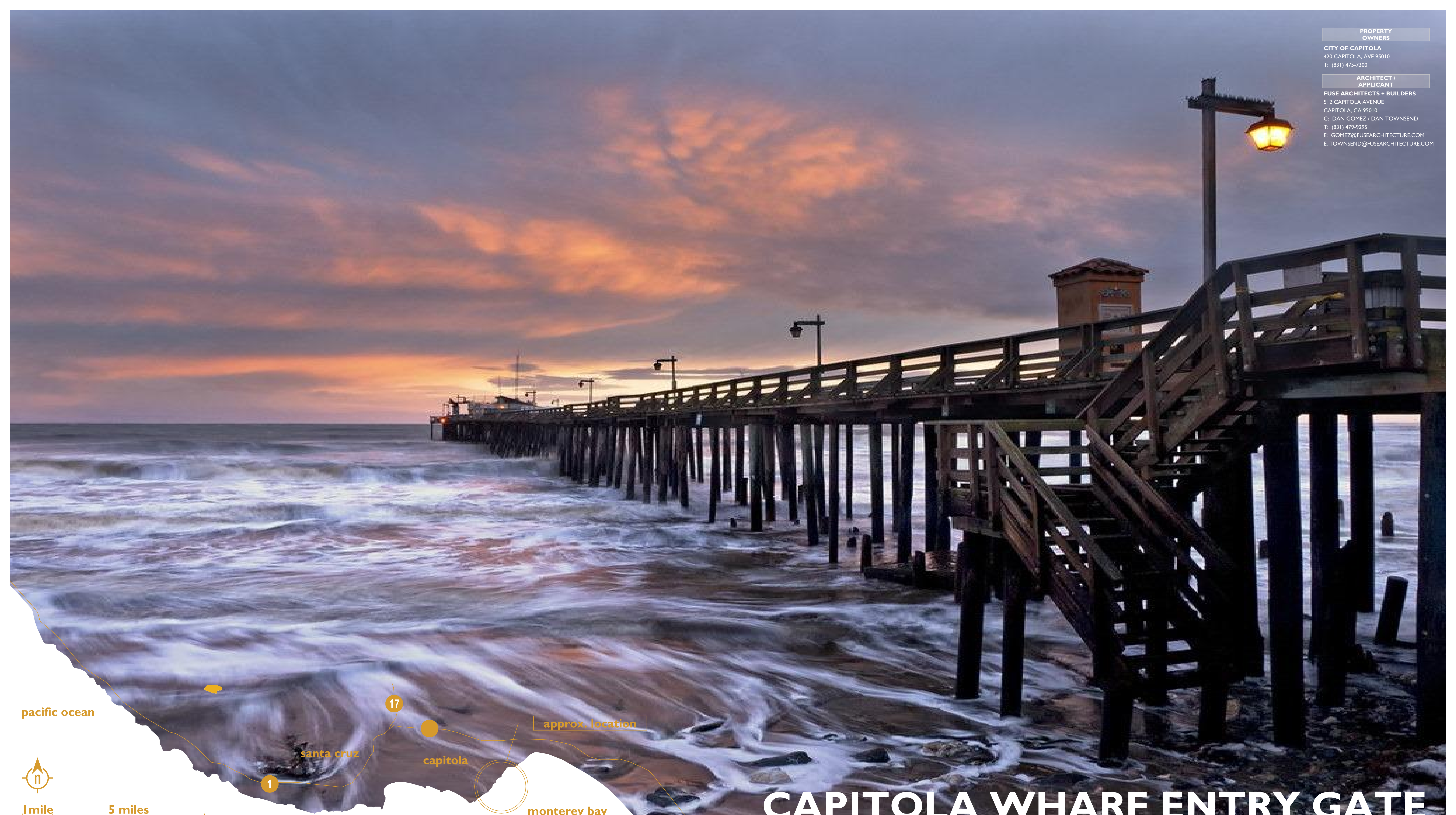


PROPERTY OWNERS

CITY OF CAPITOLA  
420 CAPITOLA AVE 95010  
T: (831) 475-7300

ARCHITECT / APPLICANT

FUSE ARCHITECTS + BUILDERS  
512 CAPITOLA AVENUE  
CAPITOLA, CA 95010  
C: DAN GOMEZ / DAN TOWNSEND  
T: (831) 479-9295  
E: GOMEZ@FUSEARCHITECTURE.COM  
E. TOWNSEND@FUSEARCHITECTURE.COM



pacific ocean



1 mile 5 miles



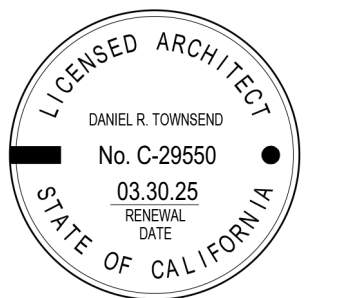
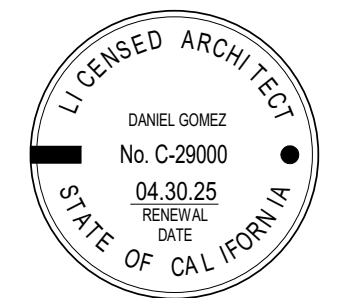
DIRECTIONS FROM SANTA CRUZ  
FOLLOW CA-1 NORTH | 7.5 MILES / EXIT BAY AVE  
TOWARDS CAPITOLA VILLAGE

# CAPITOLA WHARF ENTRY GATE

CITY OF CAPITOLA + CAPITOLA + CALIFORNIA + 95010

SCHEMATIC DESIGN - CONCEPTUAL PLAN

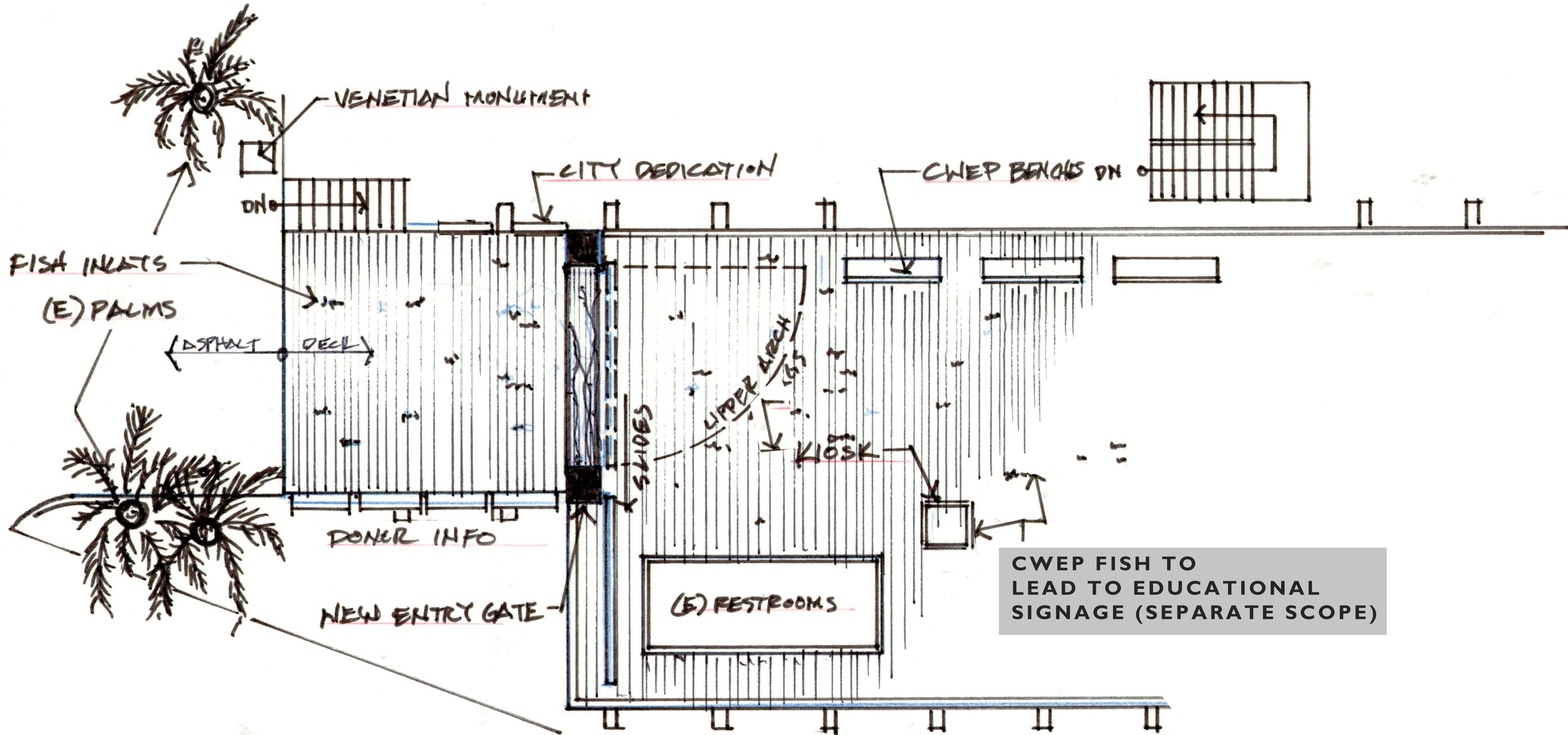
02.28.2024





**CAPITOLA WHARF ENTRY GATE**

1400 WHARF ROAD  
CAPITOLA CA 95010

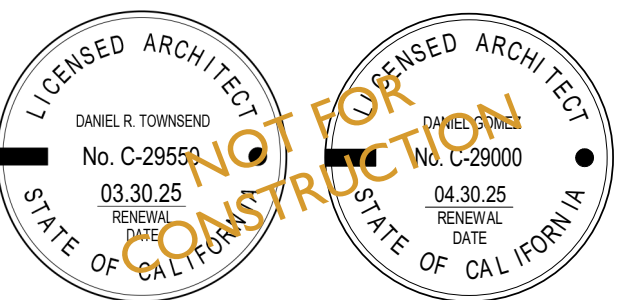


1 SITE PLAN ENTRY

**Project Submittal Record**

Revision	Date	Issue Description
0	02/20/2024	SCHEMATIC DESIGN

Seal/Signature



**Project Name**

CAPITOLA WHARF ENTRY GATE / CONCEPTUAL PLAN

Accessor's Parcel Number  
APN #: CITY PROPERTY / WHARF

**Sheet Title**

PROPOSED ENTRY PLAN - ENLARGED

Scale  
As Indicated

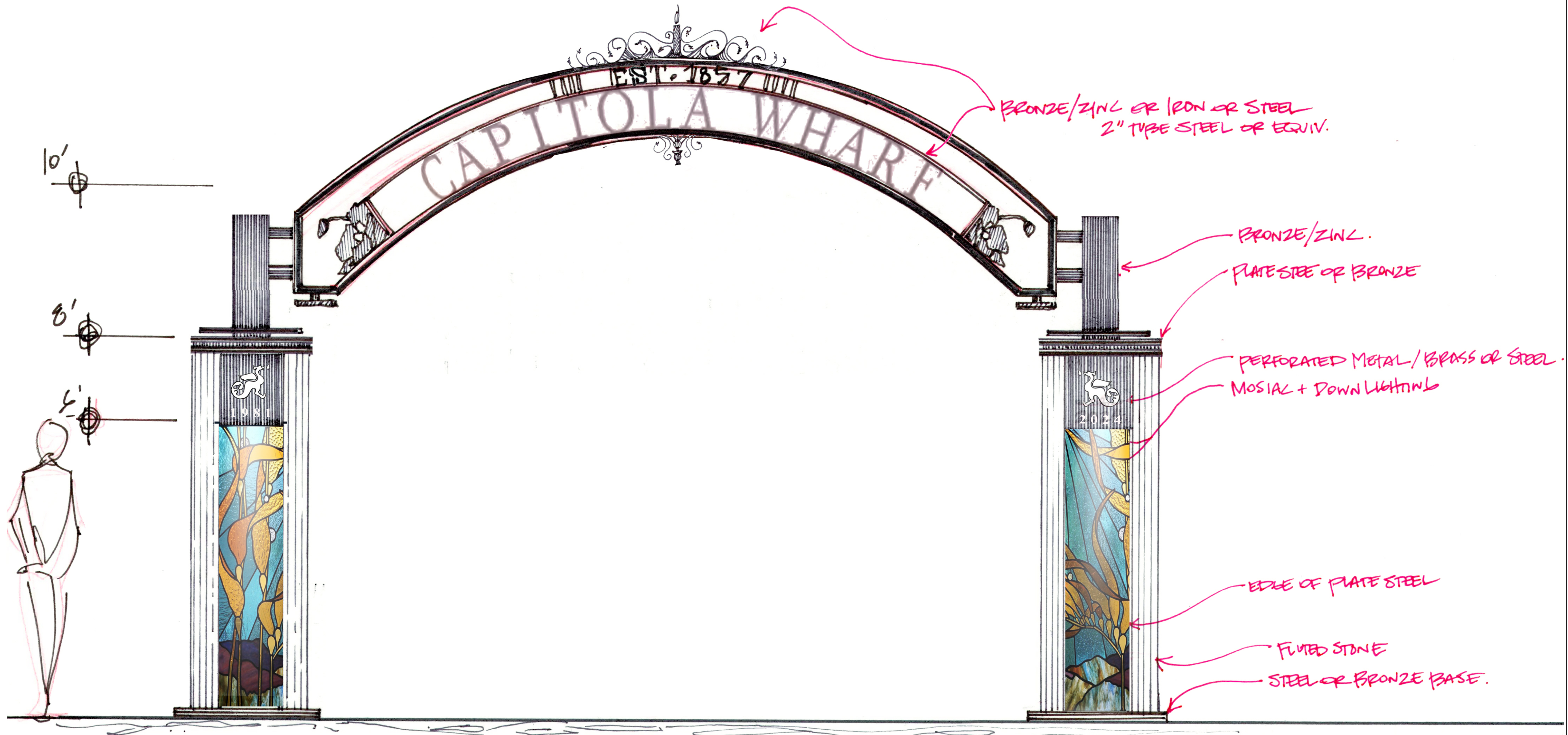
AI



**CAPITOLA WHARF ENTRY GATE**

1400 WHARF ROAD  
CAPITOLA CA 95010

**fuse** architects + builders  
512 Capitola Ave + Capitola + California + 95010  
fusearchitecture.com 831.479.9295



**Project Submittal Record**

Revision	Date	Issue Description
0	02/20/2024	SCHEMATIC DESIGN

**Seal/Signature**



**Project Name**

CAPITOLA WHARF ENTRY GATE / CONCEPTUAL PLAN

**Accessor's Parcel Number**

APN #: CITY PROPERTY / WHARF

**Sheet Title**

ENTRY GATE ENLARGED

**Scale**

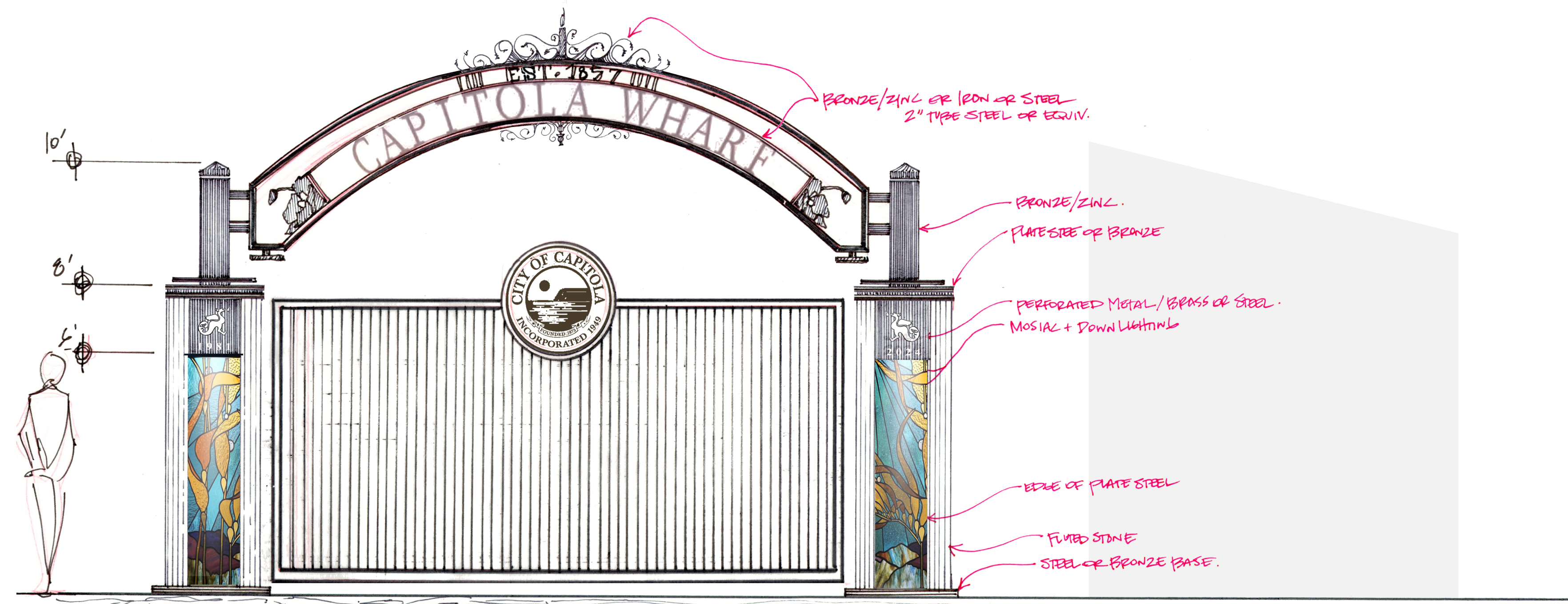
As Indicated

**A2**

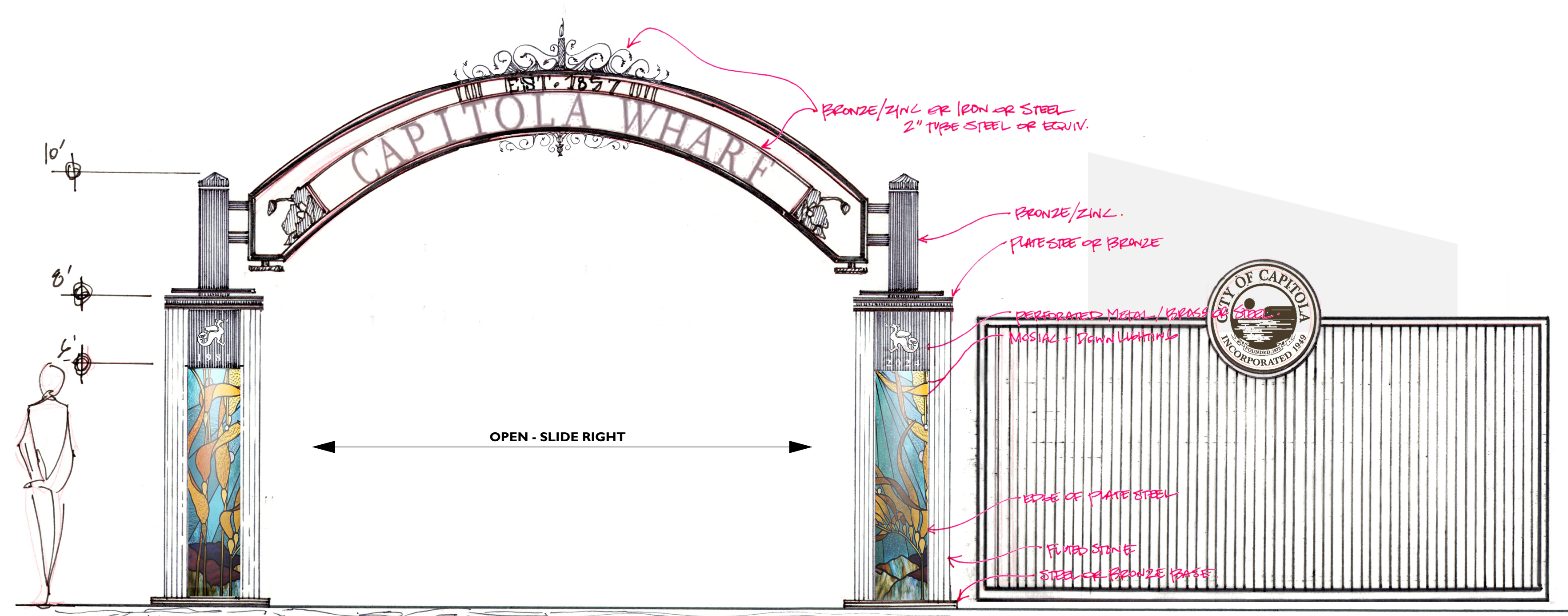
WHARF ENTRY GATE - ENLARGED

1:0.49





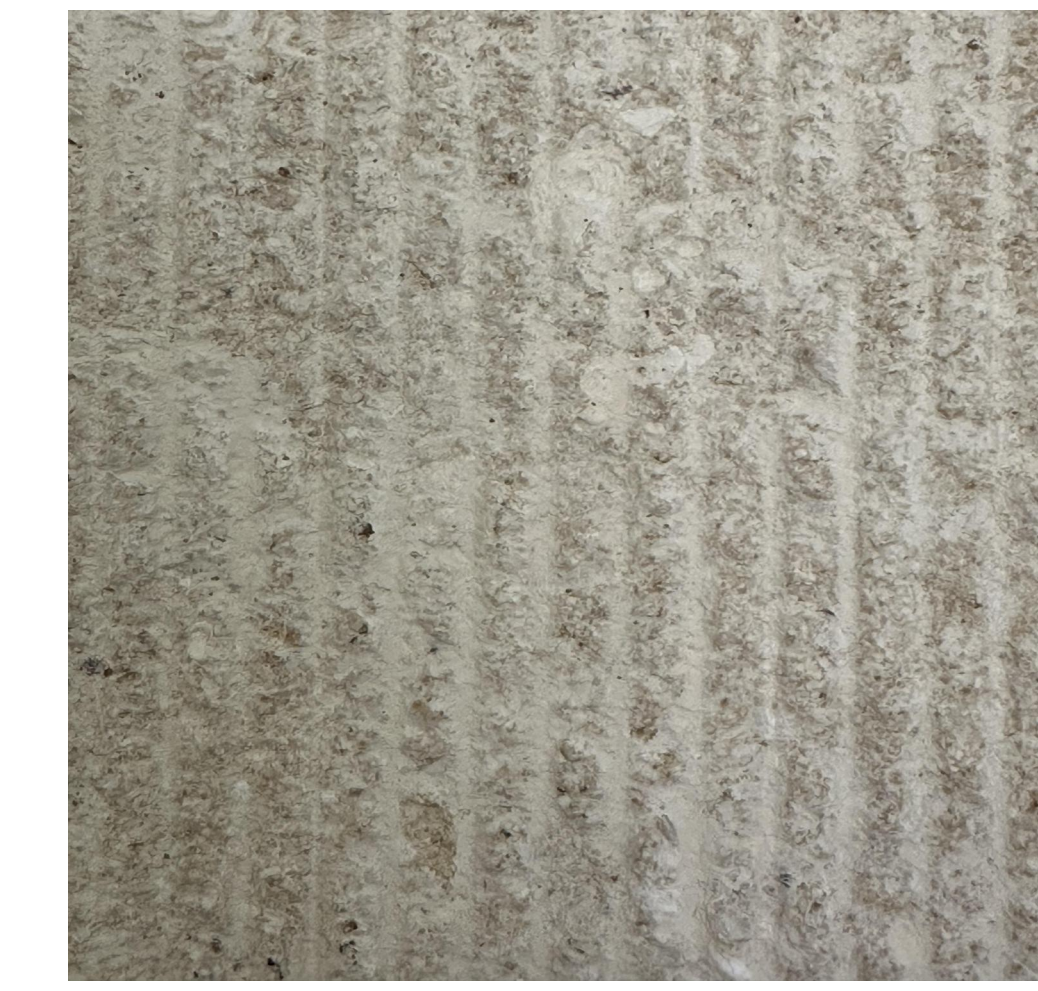
1 DRAFT01.WHARF GATE 1' = 1'-0"



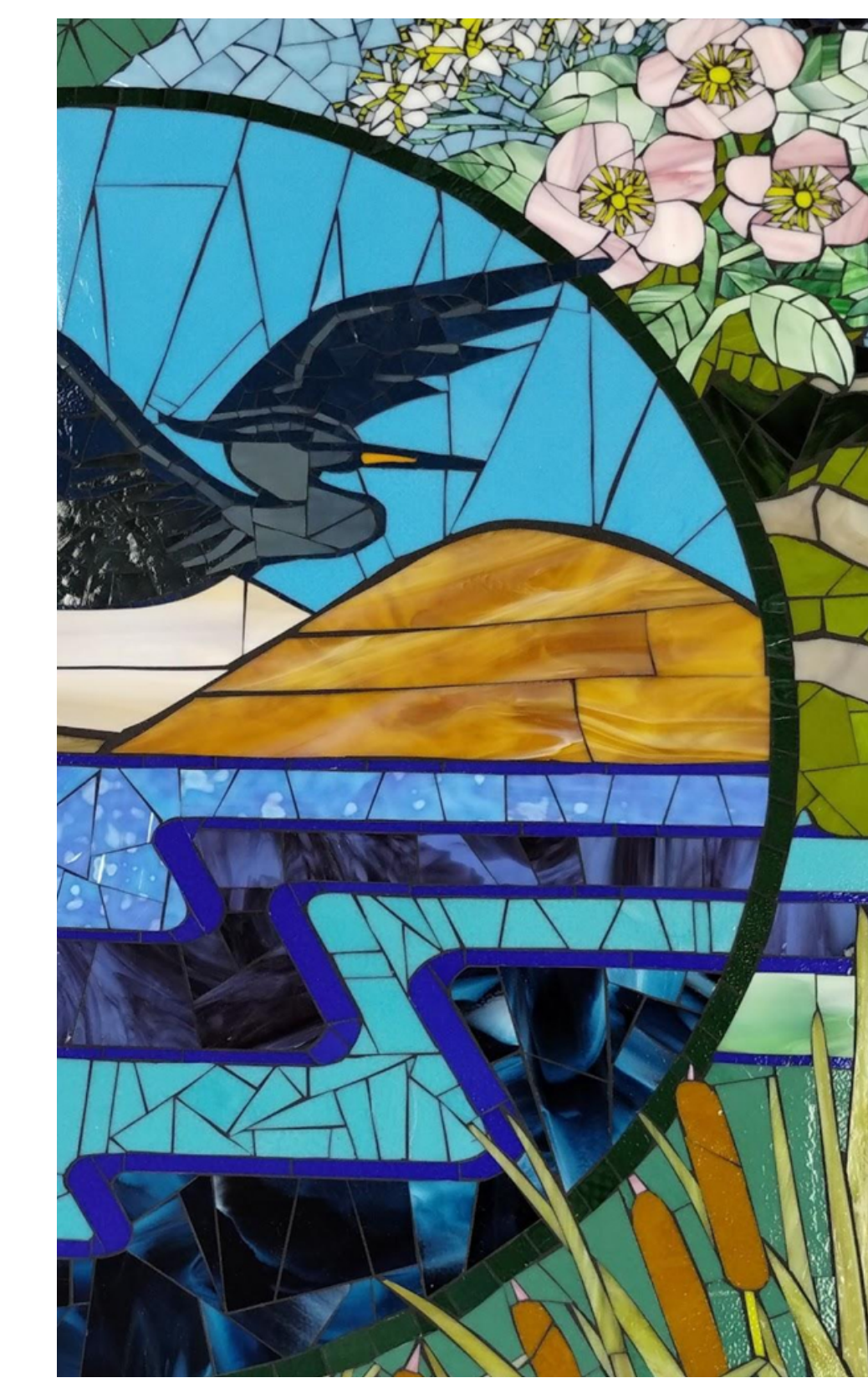
2 DRAFT01.WHARF GATE - OPEN 1' = 1'-0"



TREATED BRONZE FINISH



FLUTED STONE / SAND FINISH



CROCETTI MOSAIC

# CAPITOLA WHARF ENTRY GATE

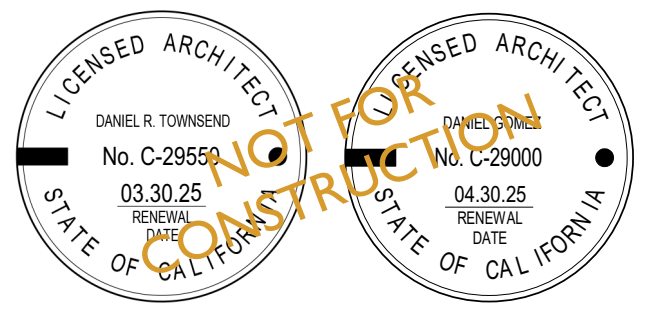
1400 WHARF ROAD  
CAPITOLA CA 95010



**Project Submittal Record**

Revision	Date	Issue Description
0	02/20/2024	SCHEMATIC DESIGN

Seal/ Signature



**Project Name**  
CAPITOLA WHARF ENTRY GATE / CONCEPTUAL PLAN

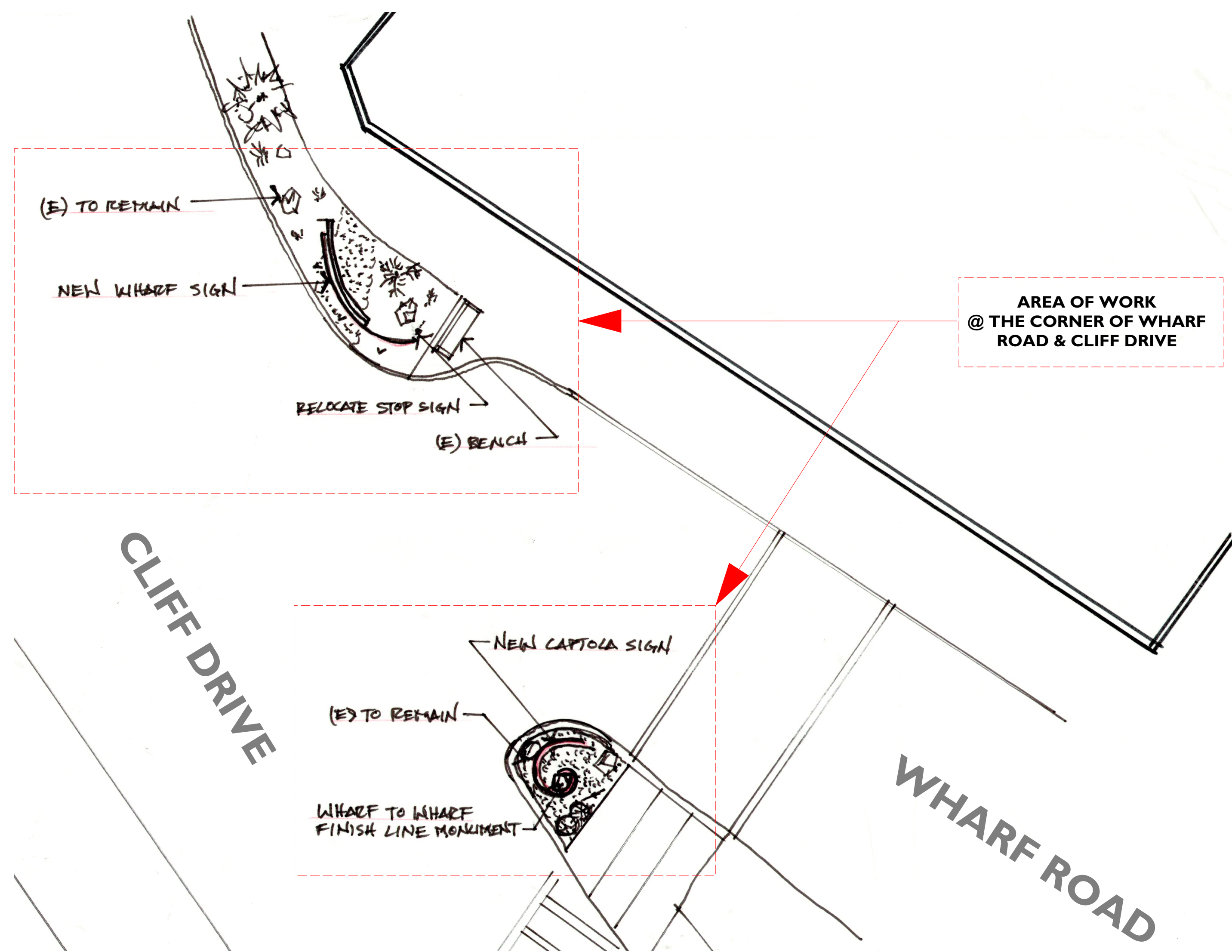
**Accessor's Parcel Number**  
APN #: CITY PROPERTY / WHARF

**Sheet Title**  
GATE ELEVATIONS & FINISHES

**Scale**  
As Indicated

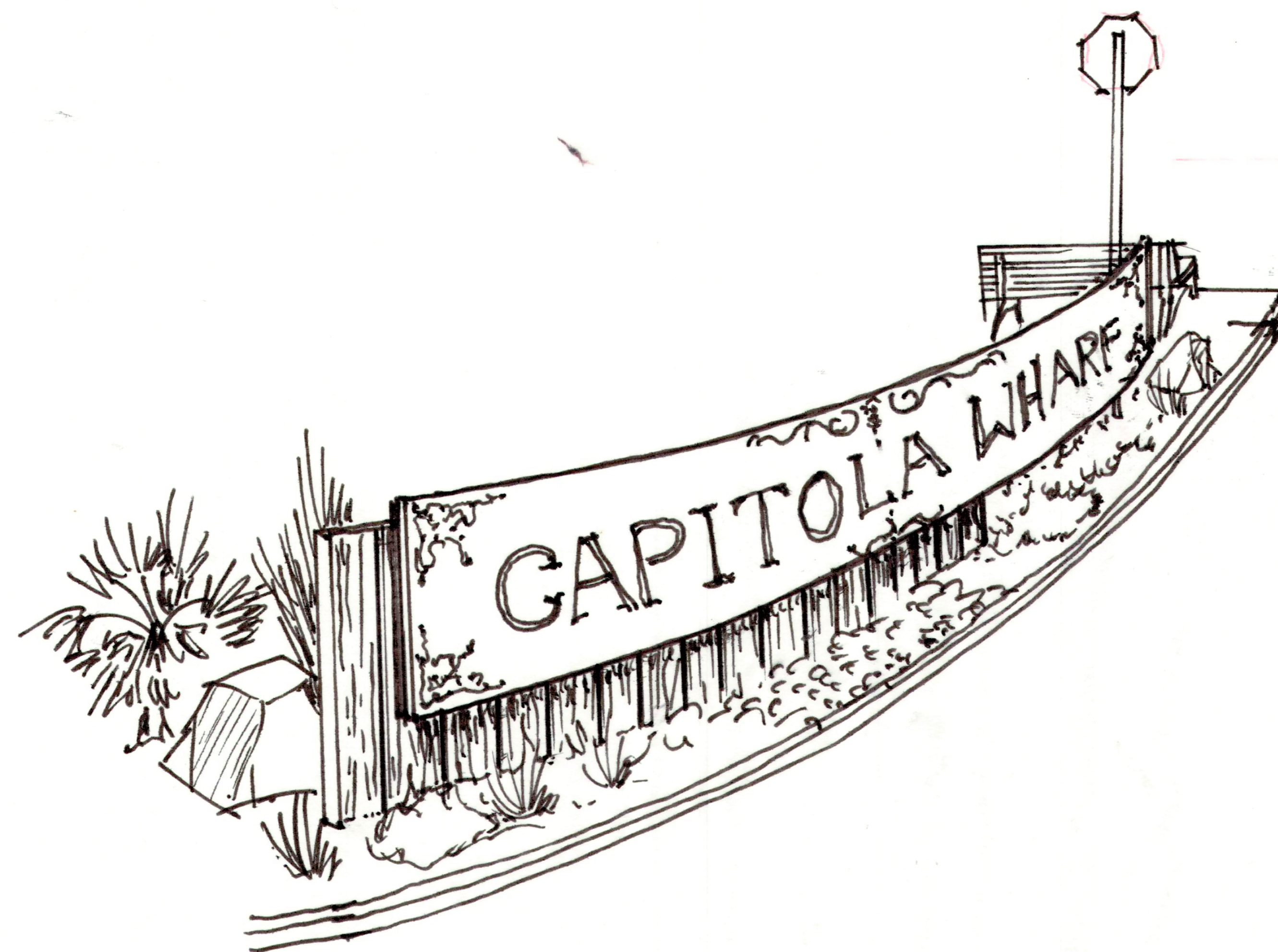
A3





2

SIGNAGE SITE MAP

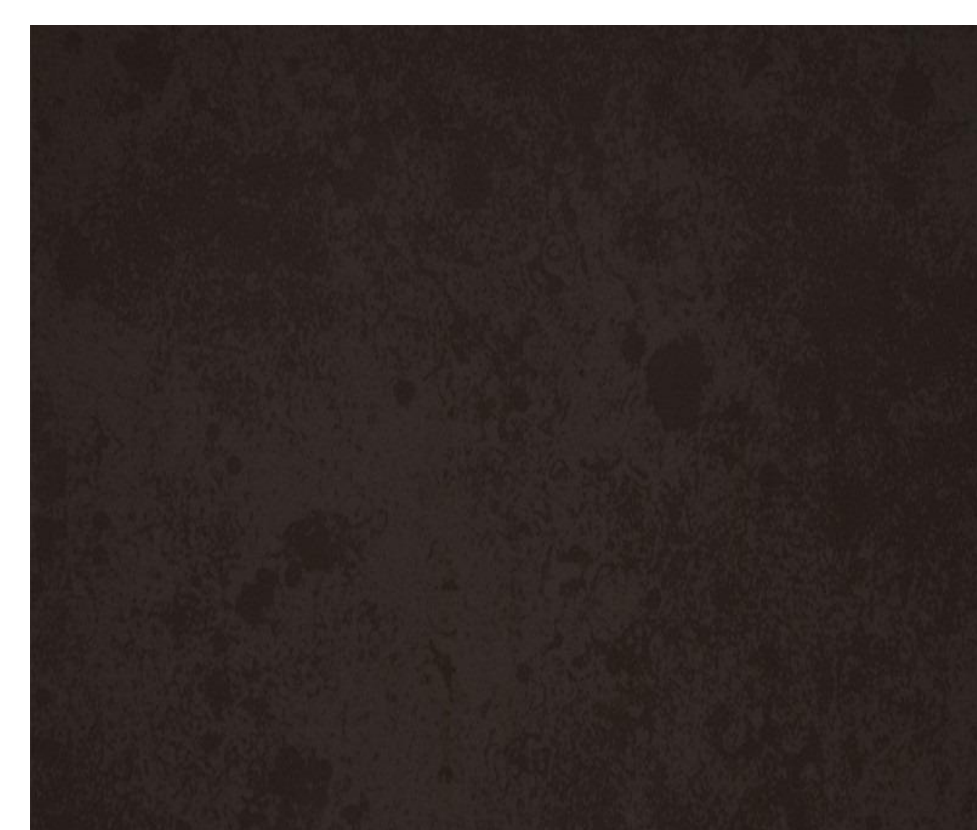


1

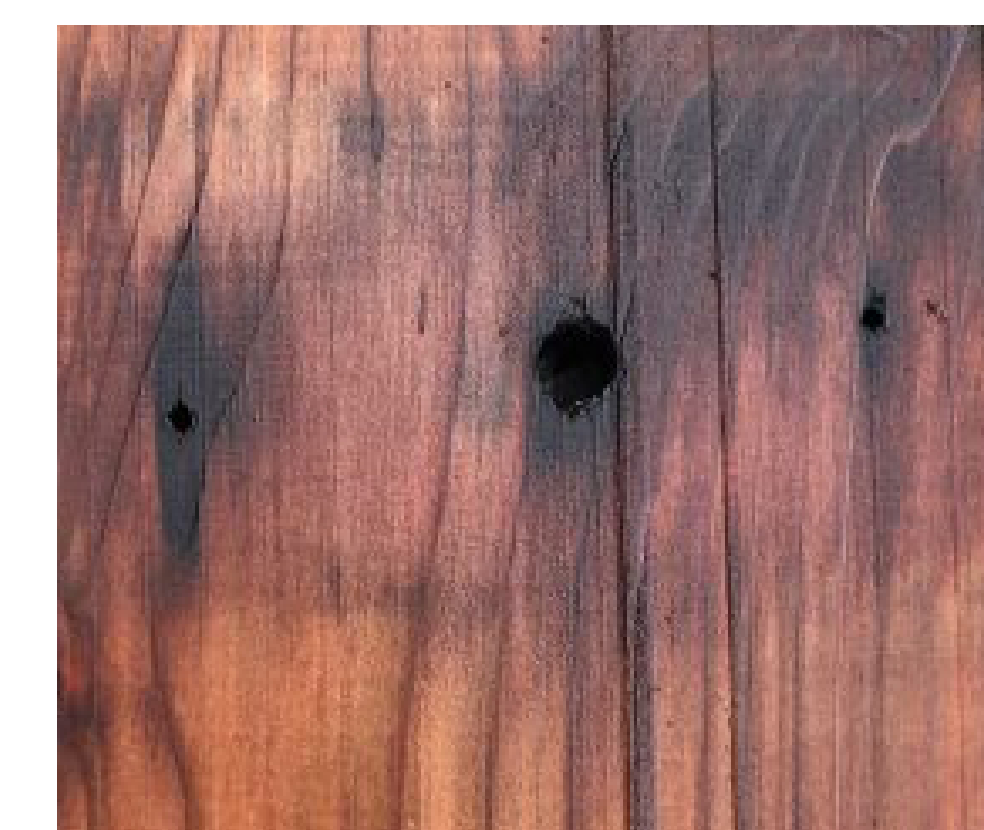
STREET SIGN



3D REPRESENTATION OF STREET SIGNAGE (ENLARGED ON SHEET A6)



TREATED BRONZE FINISH OR EQUIV. METAL FINISH



REPURPOSED WHARF PLANKS OR EQUIV.



STAINLESS STEEL LETTER ON STANDOFFS OR CAN BE INTERNALLY ILLUMINATED

**CAPITOLA WHARF ENTRY GATE**

1400 WHARF ROAD  
CAPITOLA CA 95010

**fuse** architects + builders  
512 Capitola Ave + Capitola + California + 95010  
fusearchitecture.com 831.479.9295

**Project Submittal Record**

Revision	Date	Issue Description
0	02/20/2024	SCHEMATIC DESIGN

Seal/ Signature



**Project Name**

CAPITOLA WHARF ENTRY GATE / CONCEPTUAL PLAN

**Accessor's Parcel Number**

APN #: CITY PROPERTY / WHARF

**Sheet Title**

STREET SIGNAGE

**Scale**

As Indicated

**A4**



**CAPITOLA WHARF ENTRY GATE**

1400 WHARF ROAD  
CAPITOLA CA 95010

**fuse** architects + builders  
512 Capitola Ave + Capitola + California + 95010  
fusearchitecture.com 831.479.9295

**SELECTED FINISHES:** BRONZE PLATE OVER WOODEN SUBSTRATE WITH STAINLESS STEEL LETTERS ON STANDOFFS, MOUNTED TO THE GROUND / METAL IS BACKLIT.

**ALTERNATE FINISHES FOR COST SAVINGS USING THE SAME FINISHES OR EQUIV:**

1. ELIMINATE THE METAL PLATE, ATTACHING THE STAINLESS STEEL LETTERS DIRECTLY TO THE WOOD.
2. CREATE A BACK-LIT STEEL SIGN WITH OPEN LETTERS TO REPLACE THE METAL & STAINLESS STEEL LETTER COMBINATION / EXAMPLE: CAPITOLA HOTEL SIGNAGE.

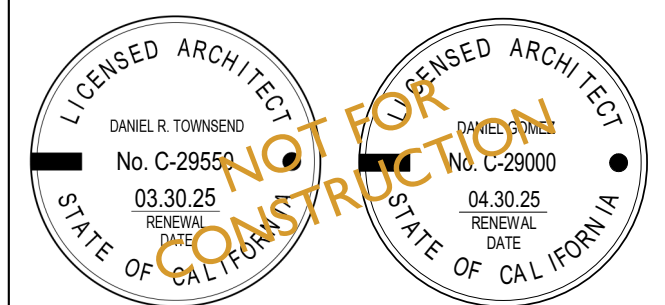


**ENLARGED 3D REPRESENTATION OF STREET SIGNAGE**

**Project Submittal Record**

Revision	Date	Issue Description
0	02/20/2024	SCHEMATIC DESIGN

**Seal/ Signature**



**Project Name**

CAPITOLA WHARF ENTRY GATE / CONCEPTUAL PLAN

**Accessor's Parcel Number**

APN #: CITY PROPERTY / WHARF

**Sheet Title**

STREET SIGNAGE ENLARGED

**Scale**

As Indicated

**A5**





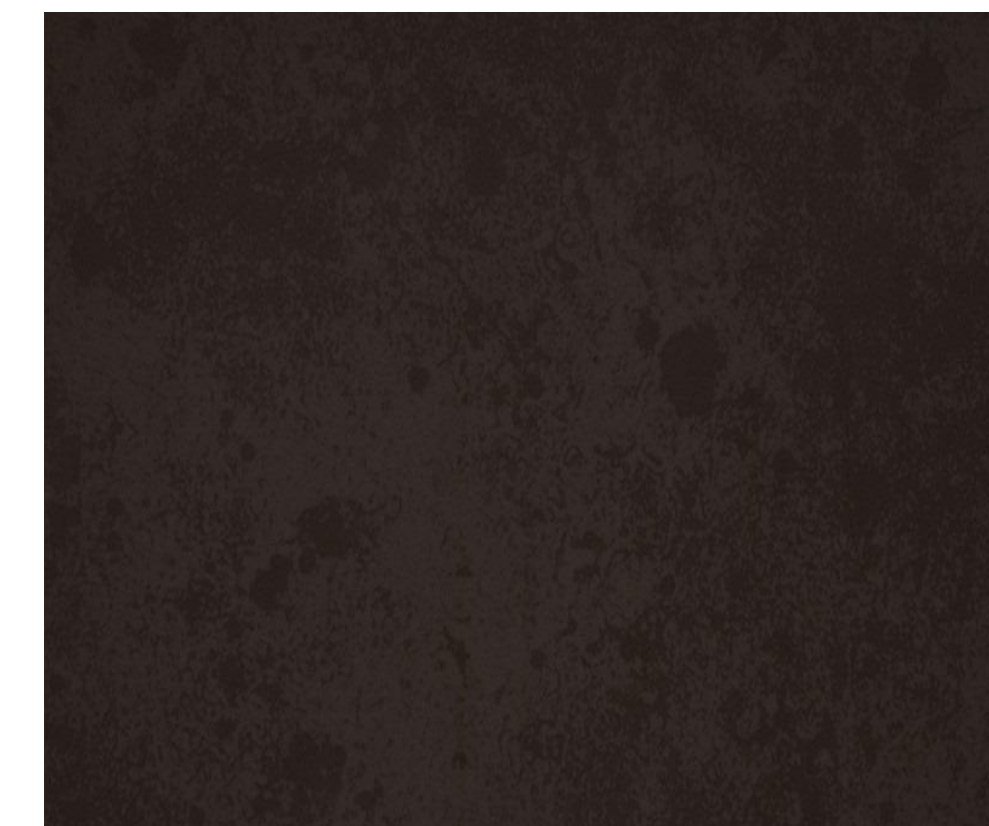
ENLARGED 3D REPRESENTATION OF STREET SIGNAGE @ WHARF TO WHARF FINISH LINE



ENLARGED 3D REPRESENTATION OF STREET SIGNAGE @ THE CORNER OF WHARF ROAD & CLIFF DRIVE



REPURPOSED WHARF PLANKS OR EQUIV.



TREATED BRONZE FINISH OR EQUIV. METAL FINISH



STAINLESS STEEL LETTER ON STANDOFFS OR CAN BE INTERNALLY ILLUMINATED

**CAPITOLA WHARF ENTRY GATE**

1400 WHARF ROAD  
CAPITOLA CA 95010

**fuse** architects + builders  
512 Capitola Ave + Capitola + California + 95010  
fusearchitecture.com 831.479.9295

**Project Submittal Record**

Revision	Date	Issue Description
0	02/20/2024	SCHEMATIC DESIGN

Seal/ Signature



**Project Name**

CAPITOLA WHARF ENTRY GATE / CONCEPTUAL PLAN

**Accessor's Parcel Number**

APN #: CITY PROPERTY / WHARF

**Sheet Title**

STREET SIGNAGE ENLARGED AT BOTH LOCATIONS

**Scale**

As Indicated

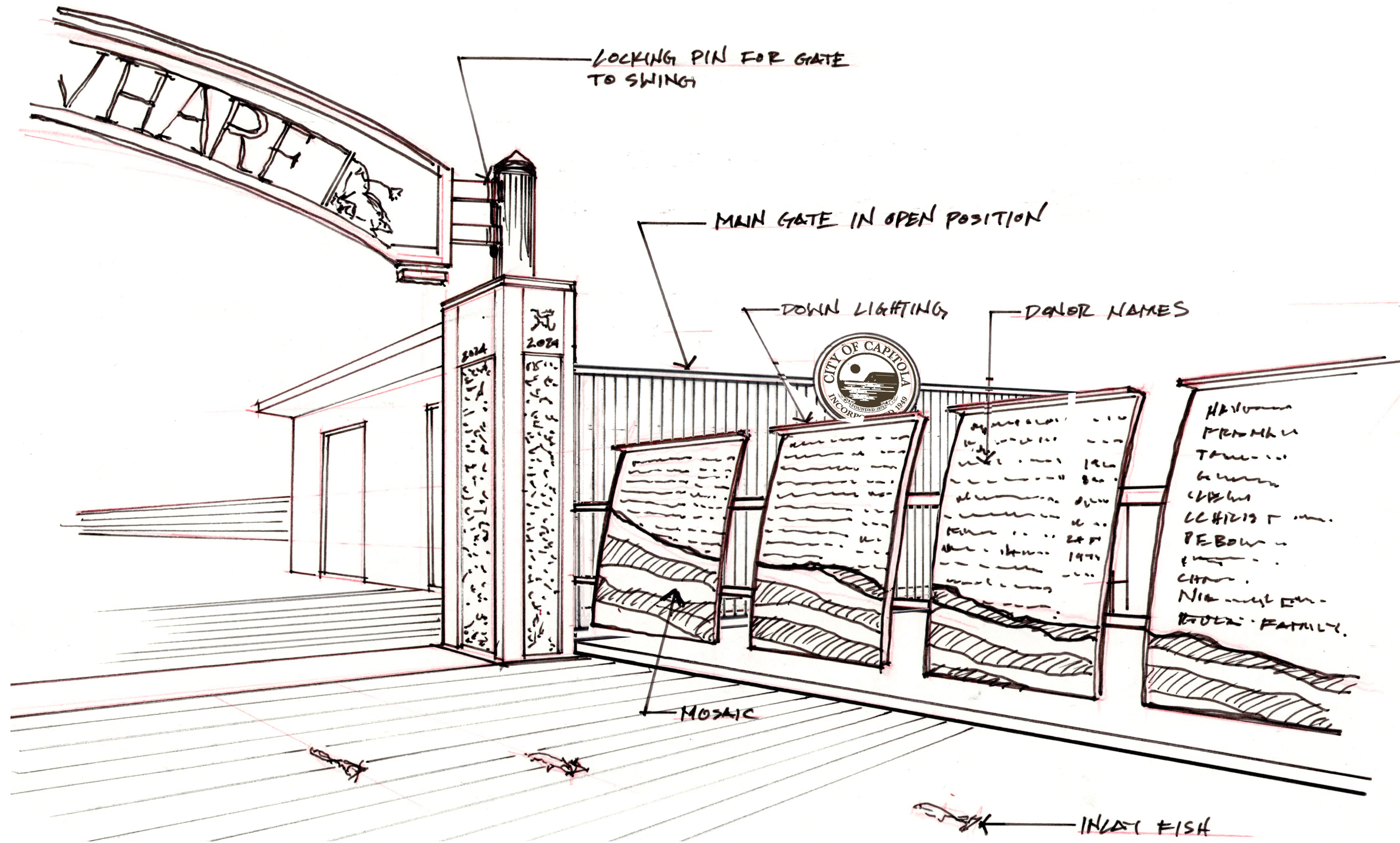
**A6**



**CAPITOLA WHARF ENTRY GATE**

1400 WHARF ROAD  
CAPITOLA CA 95010

**fuse** architects + builders  
512 Capitola Ave + Capitola + California + 95010  
fusearchitecture.com 831.479.9295



**Project Submittal Record**

Revision	Date	Issue Description
0	02/20/2024	SCHEMATIC DESIGN

Seal/ Signature



**Project Name**

CAPITOLA WHARF ENTRY GATE / CONCEPTUAL PLAN

**Accessor's Parcel Number**

APN #: CITY PROPERTY / WHARF

**Sheet Title**

PROPOSED DONOR WALL

**Scale**

As Indicated

**A7**

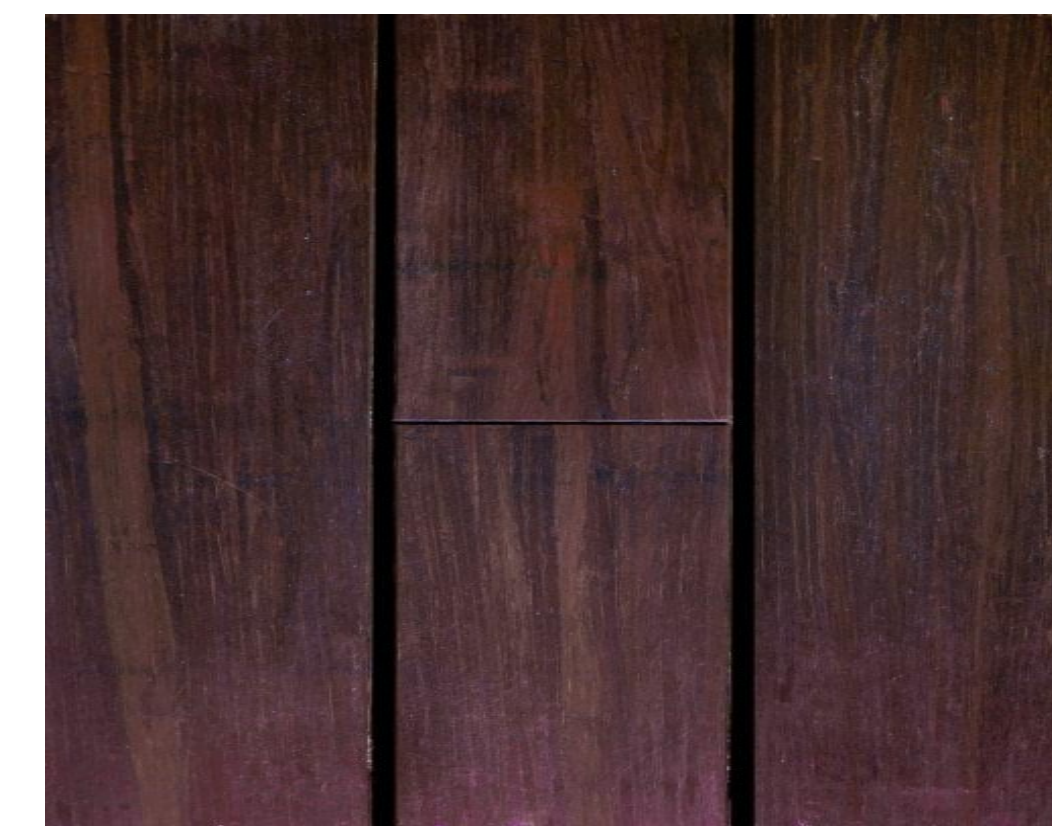
**OPTION 01 - WHARF DONOR WALL**



**CROCETTI MOSAIC WITHIN DONOR WALL**



**TREATED BRONZE FINISH**



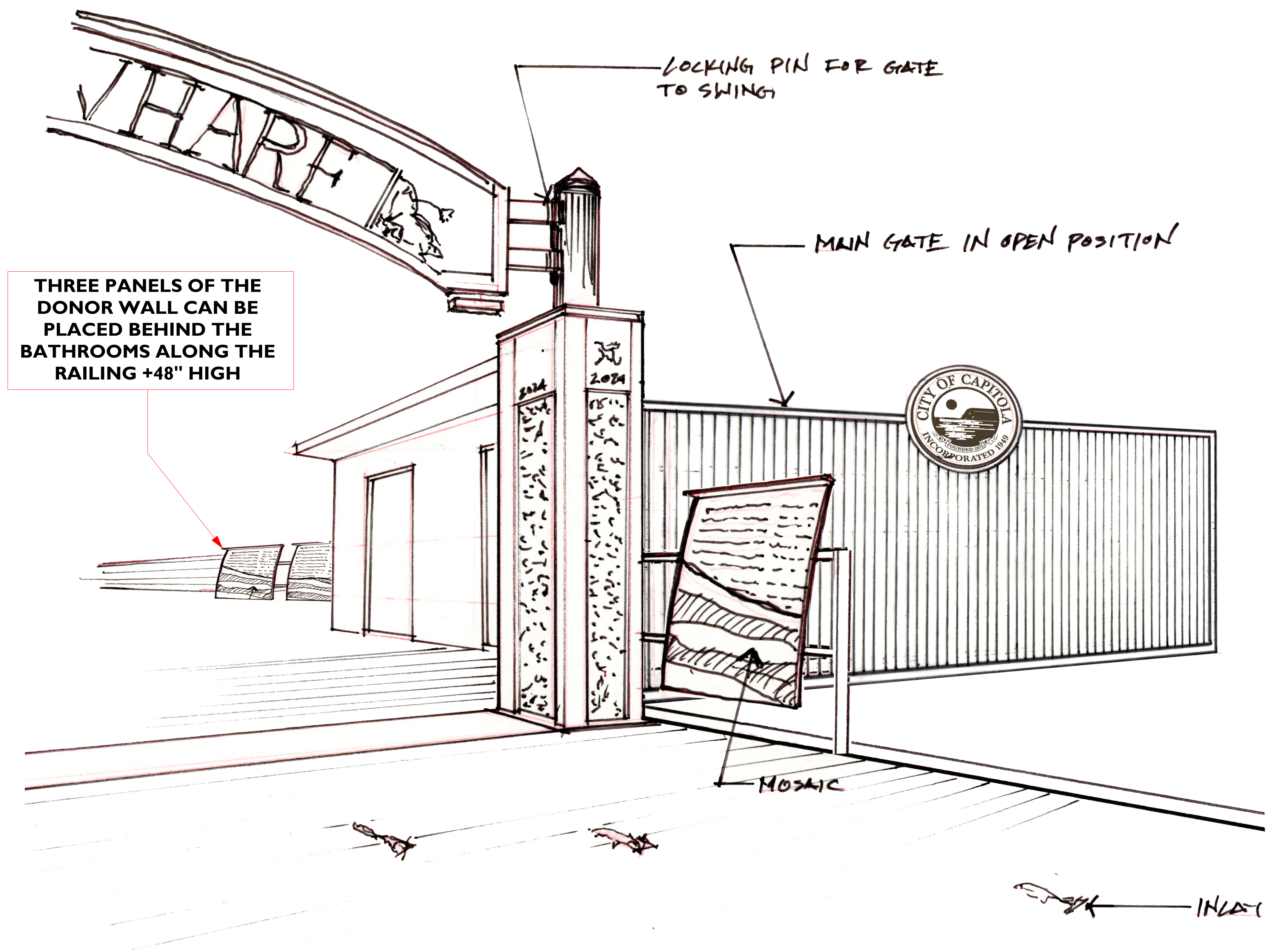
**VERTICAL WOOD COMPOSITE TO CLAD BATHROOM**



**CAPITOLA  
WHARF  
ENTRY GATE**

1400 WHARF ROAD  
CAPITOLA CA 95010

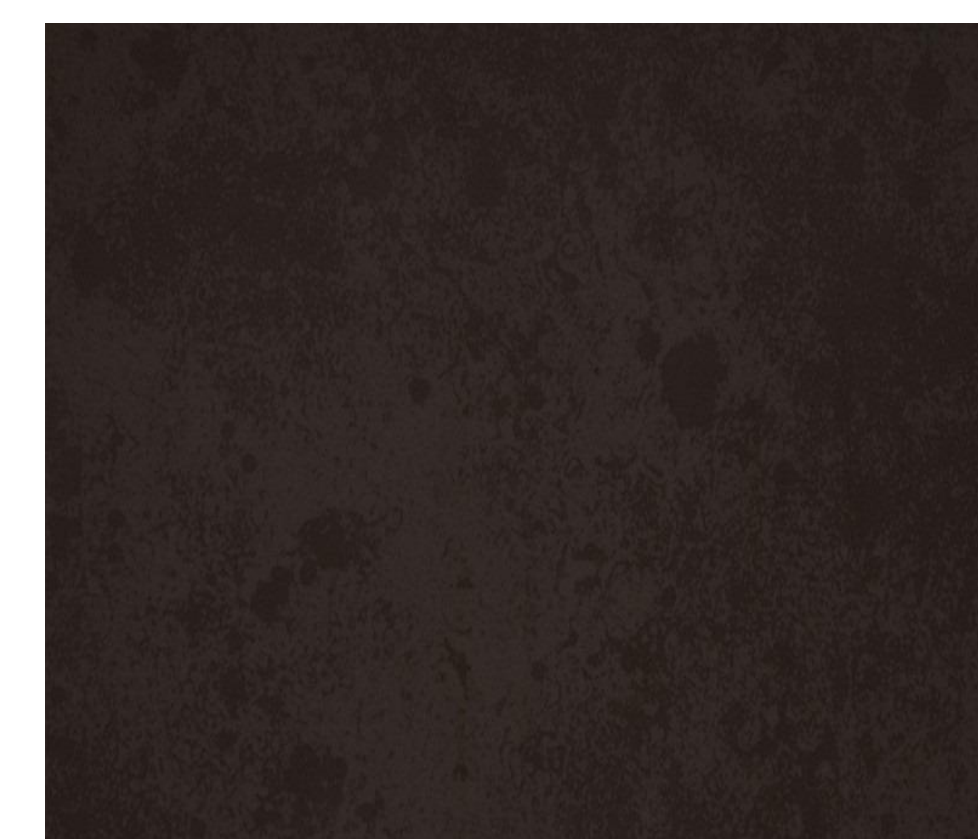
**fuse**   
architects + builders  
512 Capitola Ave + Capitola + California + 95010  
fusearchitecture.com 831.479.9295



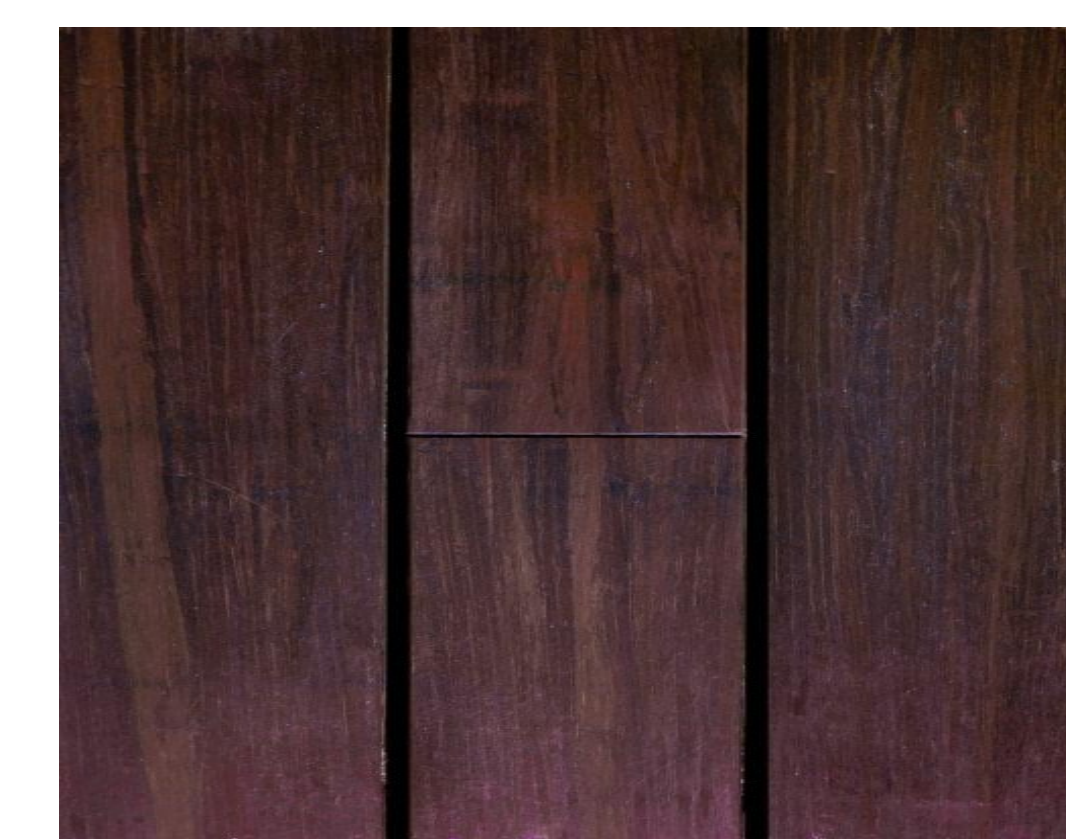
**OPTION 02 - WHARF DONOR WALL**



**CROCETTI MOSAIC WITHIN  
DONOR WALL**



**TREATED BRONZE FINISH**

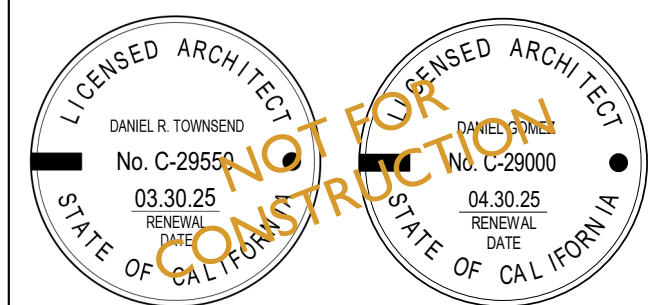


**VERTICAL WOOD COMPOSITE  
TO CLAD BATHROOM**

**Project Submittal Record**

Revision	Date	Issue Description
0	02/20/2024	SCHEMATIC DESIGN

Seal/ Signature



**Project Name**

CAPITOLA WHARF ENTRY  
GATE / CONCEPTUAL PLAN

**Accessor's Parcel Number**

APN #: CITY PROPERTY / WHARF

**Sheet Title**

ALTERNATE DONOR WALL

**Scale**

As Indicated

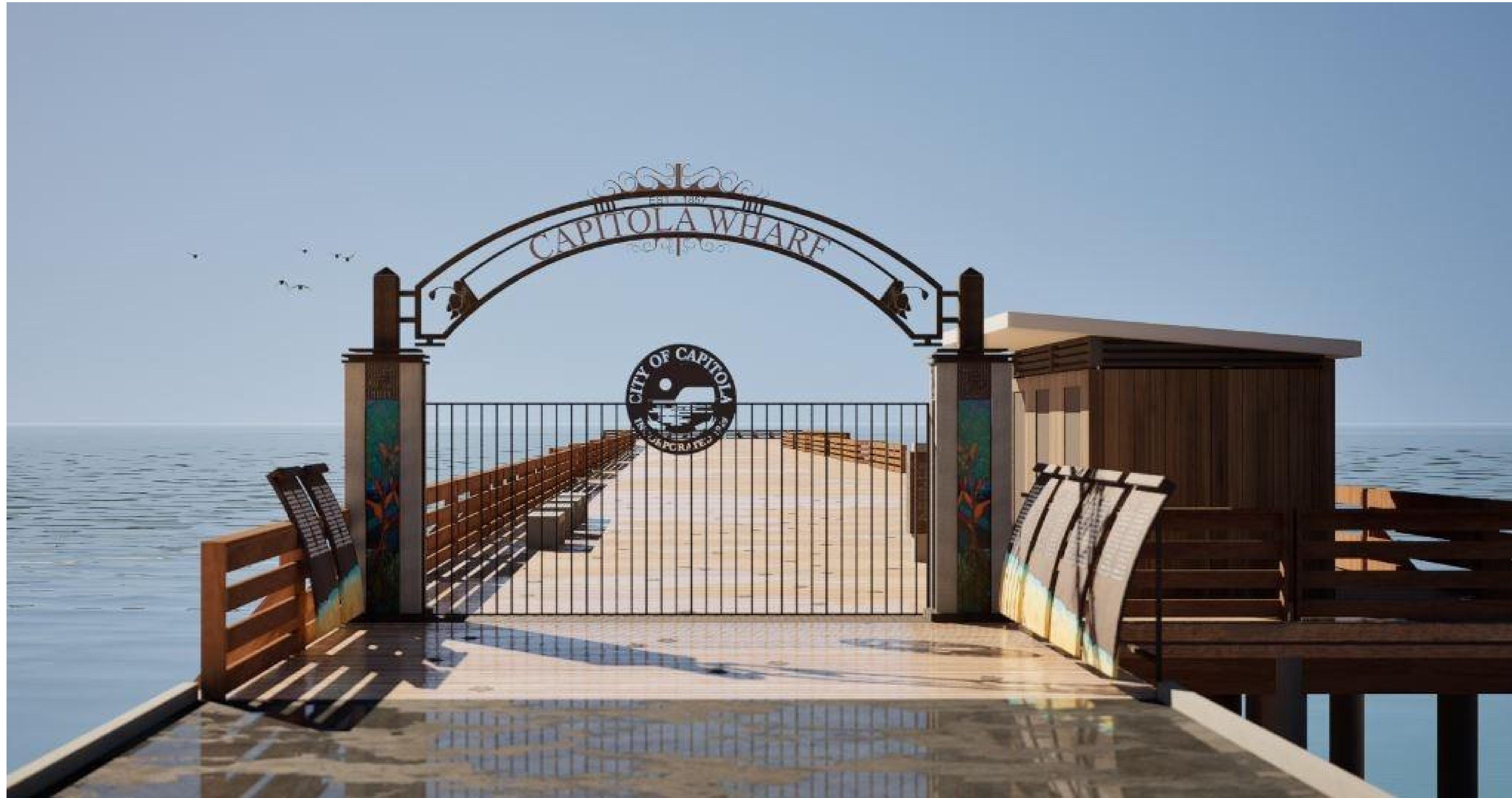
**A8**



**CAPITOLA  
WHARF  
ENTRY GATE**

1400 WHARF ROAD  
CAPITOLA CA 95010

**fuse**   
architects + builders  
512 Capitola Ave + Capitola + California + 95010  
fusearchitecture.com 831.479.9295

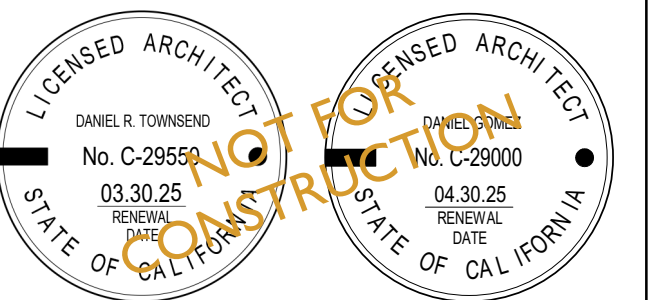


**ENLARGED 3D REPRESENTATION OF WHARF ENTRY GATE - OPTION 01**

**Project Submittal Record**

Revision	Date	Issue Description
0	02/20/2024	SCHEMATIC DESIGN

**Seal/ Signature**



**Project Name**

CAPITOLA WHARF ENTRY  
GATE / CONCEPTUAL PLAN

**Accessor's Parcel Number**

APN #: CITY PROPERTY / WHARF

**Sheet Title**

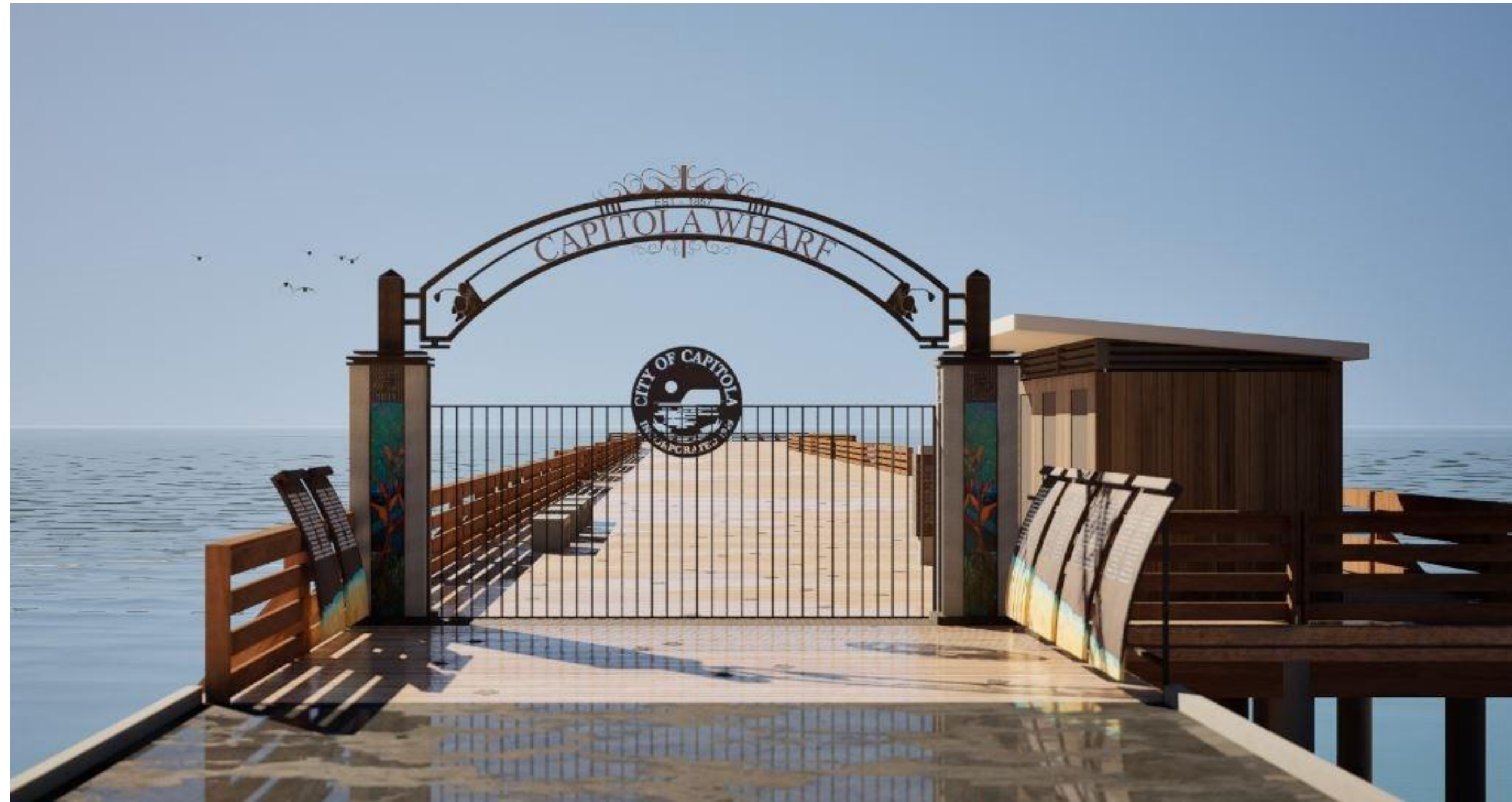
PROPOSED GATE RENDERINGS -  
OPTION 01 DONOR WALL

**Scale**

As Indicated

**A8**





ENLARGED 3D REPRESENTATION OF THE ENTRY GATE (SEE ANIMATION LOOP)



ENLARGED 3D REPRESENTATION OF THE ENTRY GATE - OPENING (SEE ANIMATION LOOP)



ENLARGED 3D REPRESENTATION OF THE ENTRY GATE - OPENING (SEE ANIMATION LOOP)

# CAPITOLA WHARF ENTRY GATE

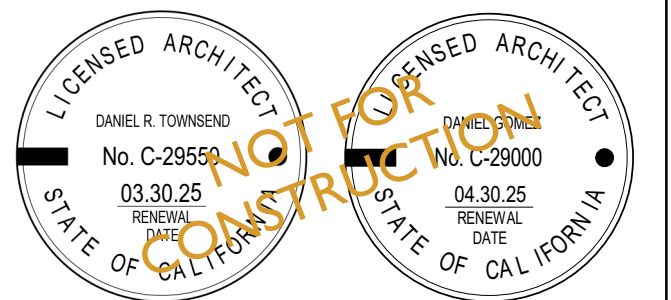
1400 WHARF ROAD  
CAPITOLA CA 95010

**fuse** architects + builders  
512 Capitola Ave + Capitola + California + 95010  
fusearchitecture.com 831.479.9295

### Project Submittal Record

Revision	Date	Issue Description
0	02/20/2024	SCHEMATIC DESIGN

### Seal/ Signature



### Project Name

CAPITOLA WHARF ENTRY GATE / CONCEPTUAL PLAN

### Accessor's Parcel Number

APN #: CITY PROPERTY / WHARF

### Sheet Title

PROPOSED GATE RENDERINGS - OPTION 01 DONOR WALL

### Scale

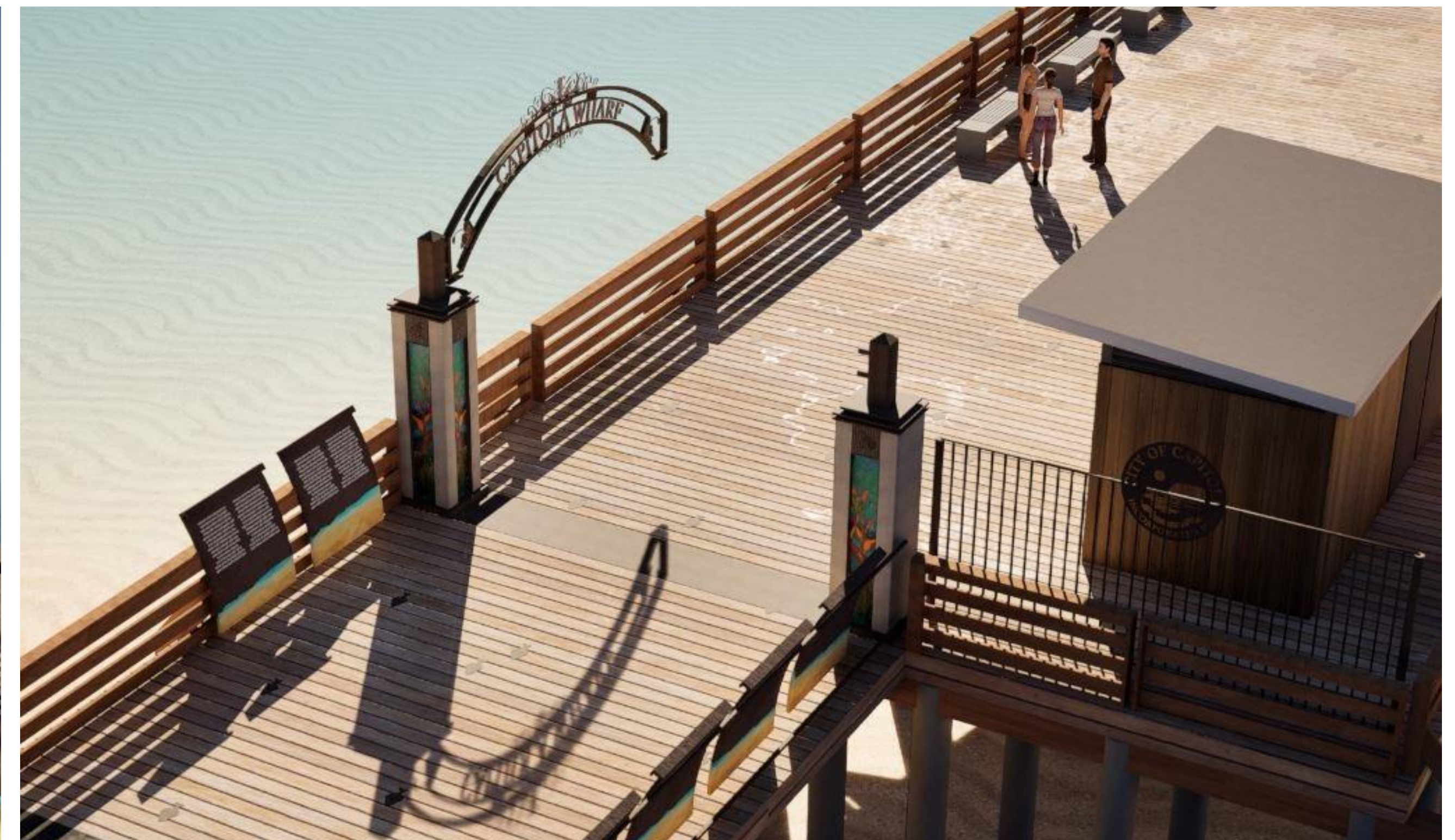
As Indicated

**A9**





ENLARGED 3D REPRESENTATION OF THE ENTRY GATE - ALL THE WAY OPEN FOR EQUIPMENT ACCESS (SEE ANIMATION LOOP)



# CAPITOLA WHARF ENTRY GATE

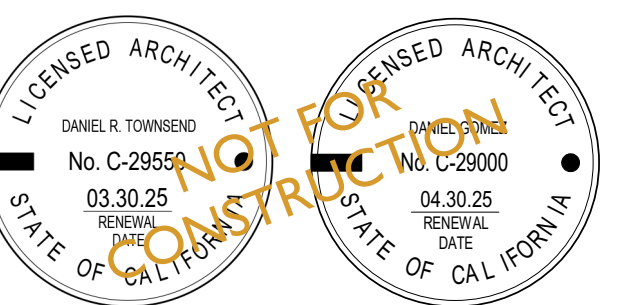
1400 WHARF ROAD  
CAPITOLA CA 95010

**fuse** architects + builders  
512 Capitola Ave + Capitola + California + 95010  
fusearchitecture.com 831.479.9295

### Project Submittal Record

Revision	Date	Issue Description
0	02/20/2024	SCHEMATIC DESIGN

### Seal/ Signature



### Project Name

CAPITOLA WHARF ENTRY GATE / CONCEPTUAL PLAN

### Accessor's Parcel Number

APN #: CITY PROPERTY / WHARF

### Sheet Title

PROPOSED GATE RENDERINGS - OPTION 01 DONOR WALL

### Scale

As Indicated

**A10**



**CAPITOLA  
WHARF  
ENTRY GATE**

1400 WHARF ROAD  
CAPITOLA CA 95010

**fuse**   
architects + builders  
512 Capitola Ave + Capitola + California + 95010  
fusearchitecture.com 831.479.9295

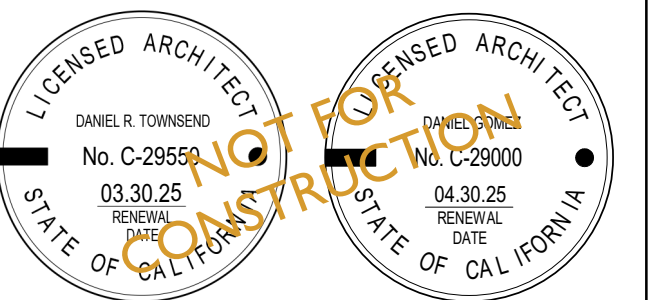


**ENLARGED 3D REPRESENTATION OF WHARF ENTRY GATE - OPTION 02 DONOR WALL**

**Project Submittal Record**

Revision	Date	Issue Description
0	02/20/2024	SCHEMATIC DESIGN

**Seal/ Signature**



**Project Name**

CAPITOLA WHARF ENTRY  
GATE / CONCEPTUAL PLAN

**Accessor's Parcel Number**

APN #: CITY PROPERTY / WHARF

**Sheet Title**

PROPOSED GATE RENDERINGS -  
OPTION 02 DONOR WALL

**Scale**

As Indicated

**A11**





ENLARGED 3D REPRESENTATION OF THE ENTRY GATE (SEE ANIMATION LOOP)  
OPTION 02 DONOR WALL SHOWN



ENLARGED 3D REPRESENTATION OF THE ENTRY GATE - OPENING (SEE ANIMATION LOOP)



ENLARGED 3D REPRESENTATION OF THE ENTRY GATE - OPENING (SEE ANIMATION LOOP) - OPTION 02

**CAPITOLA  
WHARF  
ENTRY GATE**

1400 WHARF ROAD  
CAPITOLA CA 95010

**fuse**   
architects + builders  
512 Capitola Ave + Capitola + California + 95010  
fusearchitecture.com 831.479.9295

**Project Submittal Record**

Revision	Date	Issue Description
0	02/20/2024	SCHEMATIC DESIGN

**Seal/ Signature**



**Project Name**

CAPITOLA WHARF ENTRY  
GATE / CONCEPTUAL PLAN

**Accessor's Parcel Number**

APN #: CITY PROPERTY / WHARF

**Sheet Title**

PROPOSED GATE RENDERINGS -  
OPTION 02 DONOR WALL

**Scale**

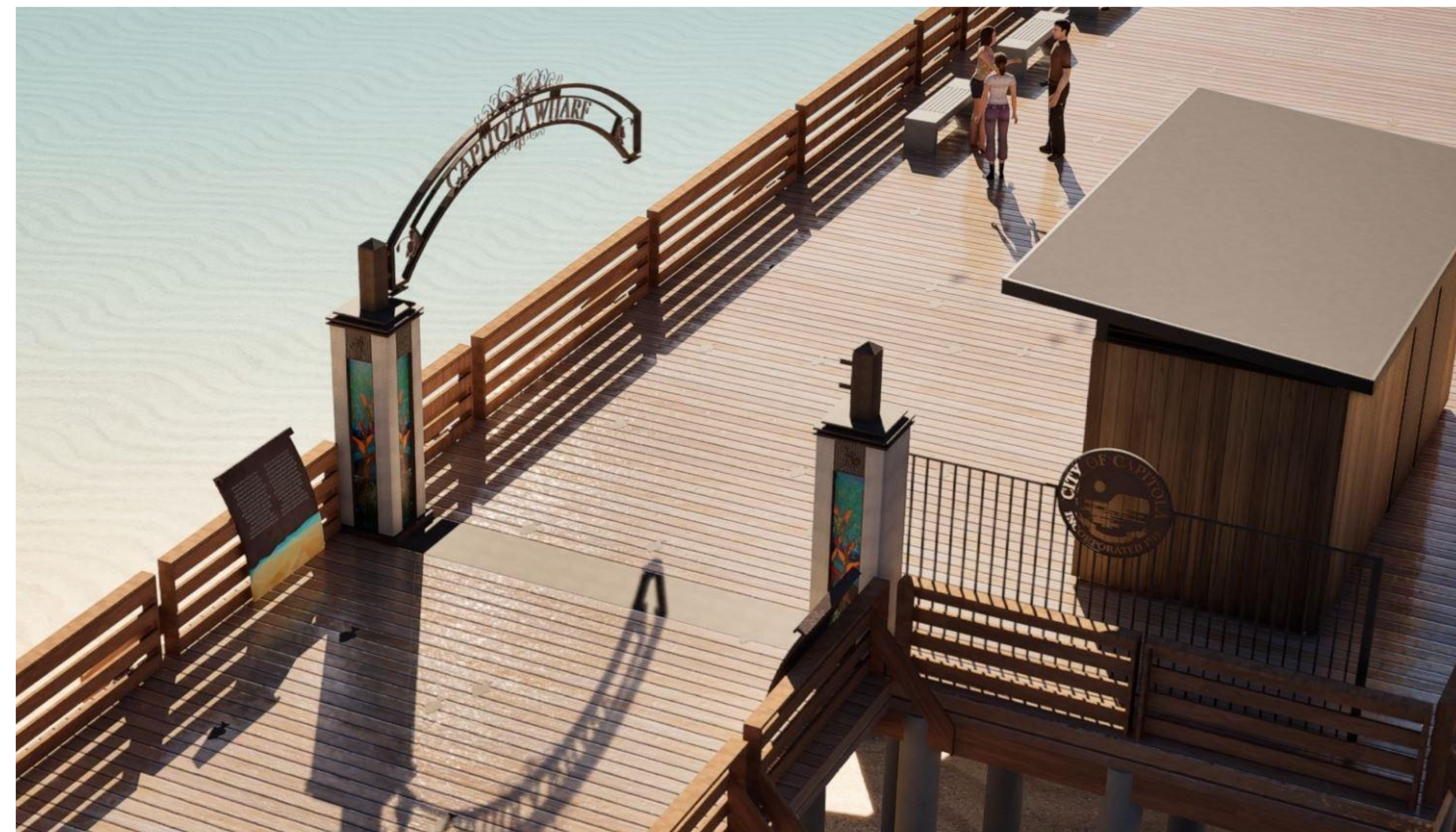
As Indicated

**A12**





ENLARGED 3D REPRESENTATION OF THE ENTRY GATE - ALL THE WAY OPEN FOR EQUIPMENT ACCESS (SEE ANIMATION LOOP) - DONOR WALL OPTION 02



# CAPITOLA WHARF ENTRY GATE

1400 WHARF ROAD  
CAPITOLA CA 95010

**fuse** architects + builders  
512 Capitola Ave + Capitola + California + 95010  
fusearchitecture.com 831.479.9295

**Project Submittal Record**

Revision	Date	Issue Description
0	02/20/2024	SCHEMATIC DESIGN

**Seal/ Signature**



**Project Name**

CAPITOLA WHARF ENTRY GATE / CONCEPTUAL PLAN

**Accessor's Parcel Number**

APN #: CITY PROPERTY / WHARF

**Sheet Title**

PROPOSED GATE RENDERINGS - OPTION 02 DONOR WALL

**Scale**

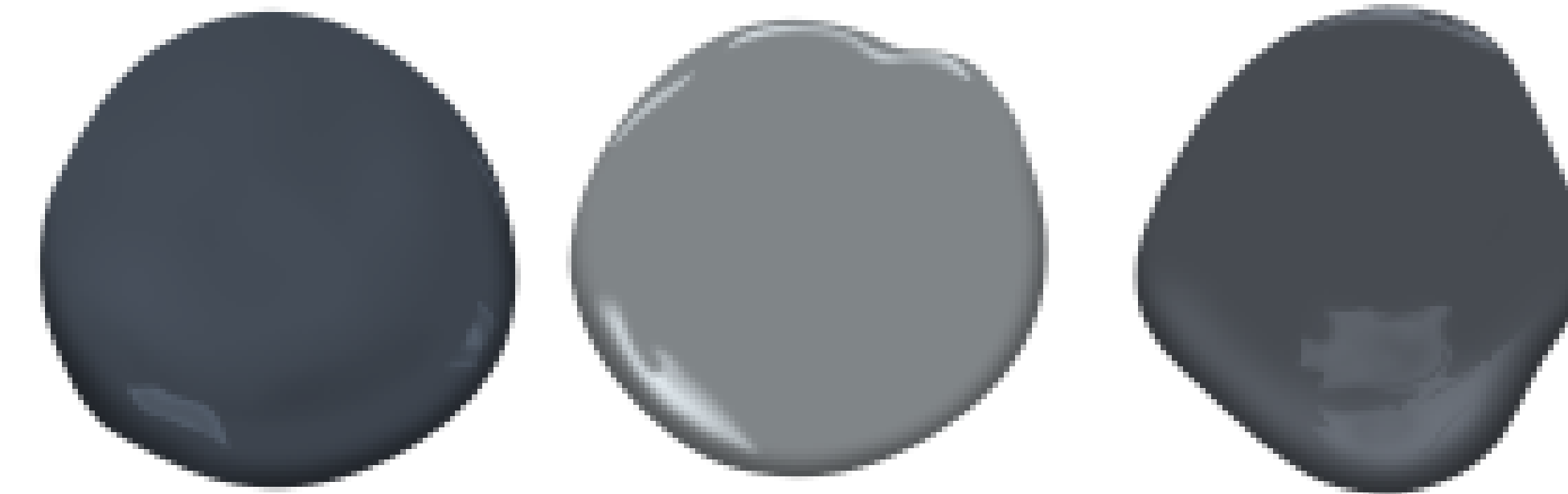
As Indicated

**A13**

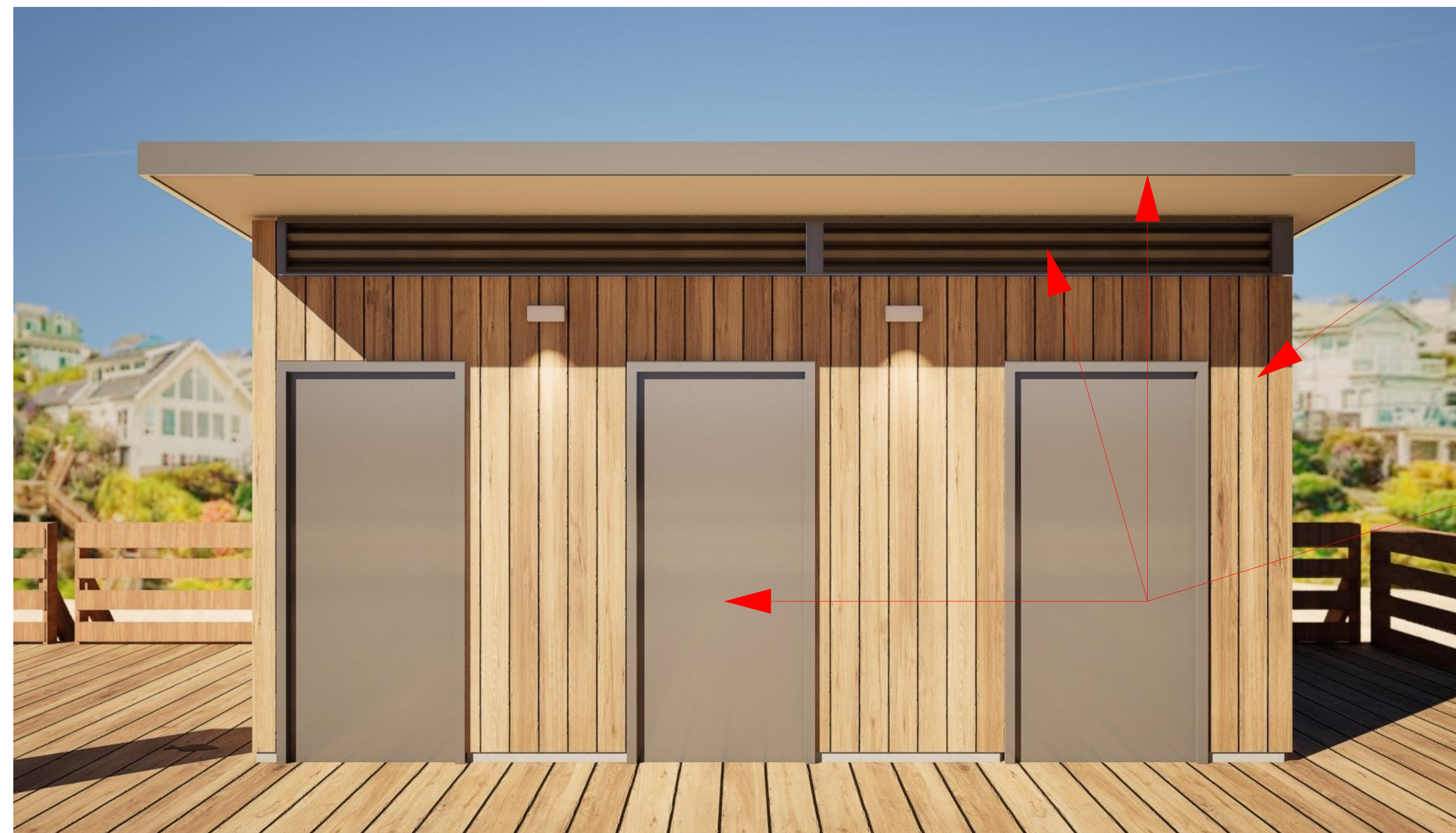




**IMAGE OF THE BLUE BATHROOMS AS THEY EXIST AND ARE INSTALLED**



**ALTERNATE PAINT COLORS  
IF PAINT IS ELECTED  
(NOTE: PAINT IS NOT SUGGESTED)**



**ENLARGED 3D REPRESENTATION OF THE BATHROOMS AT THE ENTRY GATE**

COMPOSITE WOOD CLADDING  
OVER THE TOP OF THE EXISTING  
FINISH

ALL STAINLESS STEEL AREAS TO  
BE LEFT OPEN / WOOD  
COMPOSITE TO TRIM AROUND  
STAINLESS FINISH



**VERTICAL WOOD COMPOSITE  
TO CLAD BATHROOM**

**CAPITOLA  
WHARF  
ENTRY GATE**

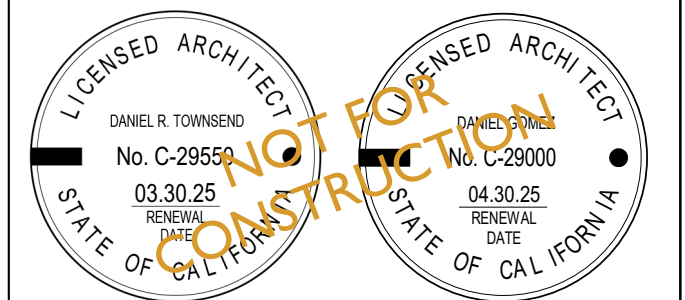
1400 WHARF ROAD  
CAPITOLA CA 95010



**Project Submittal Record**

Revision	Date	Issue Description
0	02/20/2024	SCHEMATIC DESIGN

**Seal/ Signature**



**Project Name**

CAPITOLA WHARF ENTRY  
GATE / CONCEPTUAL PLAN

**Accessor's Parcel Number**

APN #: CITY PROPERTY / WHARF

**Sheet Title**

PROPOSED BATHROOM  
CLADDING

**Scale**

As Indicated

**A14**





**LIGHT POLES SPECIFIED BY CWEP - DARK SKY APPROVED / RECOMENDED COLOR: DARK GRAY / BLACK OR EQUIV.**



**BENCHES SPECIFIED BY CWEP - RECOMENDED COLOR / FINISH: NATURAL WOOD OR EQUIV.**



**VIEWING STATIONS SPECIFIED BY CWEP**



**PICNIC TABLES SPECIFIED BY CWEP - RECOMENDED COLOR / FINISH: NATURAL WOOD OR EQUIV.**



**TRASH CANS SPECIFIED BY CWEP - RECOMENDED COLOR / FINISH: NATURAL WOOD OR EQUIV.**

**CAPITOLA WHARF ENTRY GATE**

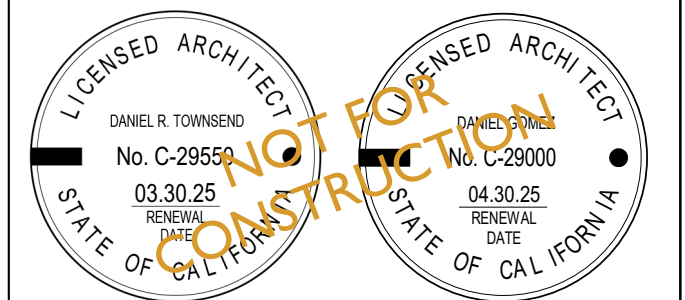
1400 WHARF ROAD  
CAPITOLA CA 95010



**Project Submittal Record**

Revision	Date	Issue Description
0	02/20/2024	SCHEMATIC DESIGN

**Seal/ Signature**



**Project Name**

CAPITOLA WHARF ENTRY GATE / CONCEPTUAL PLAN

**Accessor's Parcel Number**

APN #: CITY PROPERTY / WHARF

**Sheet Title**

CWEP SPECIFIED LIGHT POLES & BENCHES

**Scale**

As Indicated

**A15**