

# LANDSCAPE UPDATE WITH TREE REMOVAL

APN: 03614411

501 EL SALTO DRIVE  
CAPITOLA, CA 95010

## CONTENTS:

- L1 Cover Sheet
- L2 Proposed Planting / Proposed Tree Removal
- L3 Irrigation Design / Water Use Calculations
- L4 Layout of Existing and Proposed Features
- L5 Construction Specs.

## LOCATION MAP

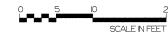

ALYSON FLYNN  
LANDSCAPE ARCHITECT & ASSOCIATES  
1000 Highway 101  
Hollister, CA 95023  
Phone (408) 274-1114  
Landscape Architect No. 3071



Ducky Grabill  
501 El Salto Drive  
Capitola, CA 95010

Date Oct 6, 2021  
Scale 1/8" = 1'-0"  
Drawn CLL/AF  
Sheet 1  
of 5 Sheets

Revisions	By
Sept. 01, 2021	CL
Sept. 23, 2021	CL

This plan is for general construction only, it is not fully detailed or specified. It is the responsibility of the contractor and/or owner to select, resolve, and install all construction features, planting materials, irrigation systems, and/or areas drains and drainage pipes.

The Landscape Architect will not be observing construction of this project. The contractor/owner is solely responsible for the quality control and construction standards, and the placement of all landscape features for this project.

All construction shall meet or exceed the latest edition of codes adopted by the local governing agencies.

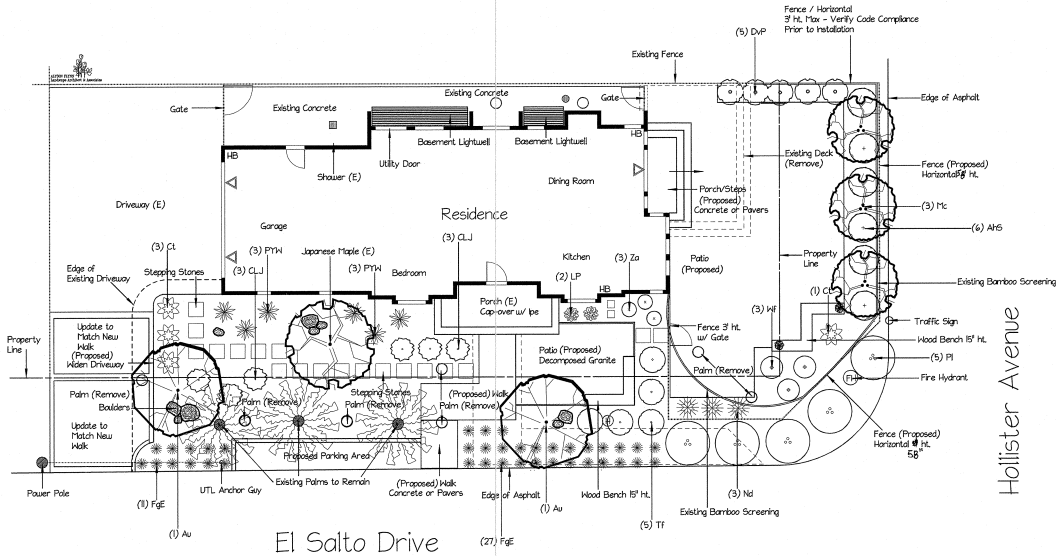

Plant List

Qty	Botanical Name	Common Name	Size	Water Use / Origin
<b>Trees</b>				
Au 2	Arbutus unedo	STRAWBERRY TREE	15 gal	Low
Mc 3	Myrica californica	CALIFORNIA WAX MYRTLE	15 gal	Low / CA NATIVE
<b>Shrubs</b>				
AHS 16	Alysicarpus huggellii Santa Cruz	SANTA CRUZ BLUE HEBECLUS	5 gal	Low
CLJ 6	Calliternon Little John	LITTLE JOHN BOTTLEBRUSH BUSH	2 gal	Low
Cl 4	Chenopodium tectorum	SHALL CAPE RUSH	2 gal	Low
DVP 5	Dodonaea viscosa Purpurea	FLORIDIA HORSESEED BUSH	5 gal	Low
Nd 3	Nandina domestica	HEAVENLY BARBOO	2 gal	Low
PI 5	Prunus lyonii	CATALINA CHERRY	5 gal	Low / CA NATIVE
ME 3	Hesperis matronalis	AUSTRALIAN ROSEMARY	2 gal	Low
<b>Ornamental Grasses</b>				
FgE 30	Festuca glauca El Jih Blue	BLUISH BLUE FESCUE	1 gal	Low
<b>Perennials and Annuals</b>				
LP 2	Limonium Persea	SEA LAVENDER	1 gal	Low
PHY 6	Phoradendron flavo-olivaceum	YELLOW WAVE FLAX	5 gal	Low
TF 5	Teucrium fruticosum	BUSH GERMANDER	1 gal	Low
Za 3	Zantedeschia aethiopica	WHITE CALLA LILY	1 gal	Moderate to Medium

Apply 2"-3" layer of fir bark on all planting areas or Small Gravel

NOTES:

- = Existing Palms to Be Removed
- = Existing Rock/Boulders on Site - Relocate as Shown

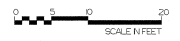

ALYSON FLYNN  
LANDSCAPE ARCHITECT & ASSOCIATES  
50 San Tropez Drive  
San Diego, CA 92108  
Phone: (608) 274-4114  
Landscape Architect No. 3074



Ducky Grabill  
501 El Salto Drive  
Capitola, CA 95010

This plan is for general construction only, it is not fully detailed or specified. It is the responsibility of the contractor and/or owner to select, resolve, and install all construction features, planting materials, irrigation systems, and/or area drains and drainage pipe.

The Landscape Architect will not be observing construction of this project. The contractor/owner is solely responsible for the quality control and construction standards, and the placement of all landscape features for this project.

All construction shall meet or exceed the latest edition of codes adopted by the local governing agencies.

## MAWA, ETWU AND ETAF CALCULATIONS

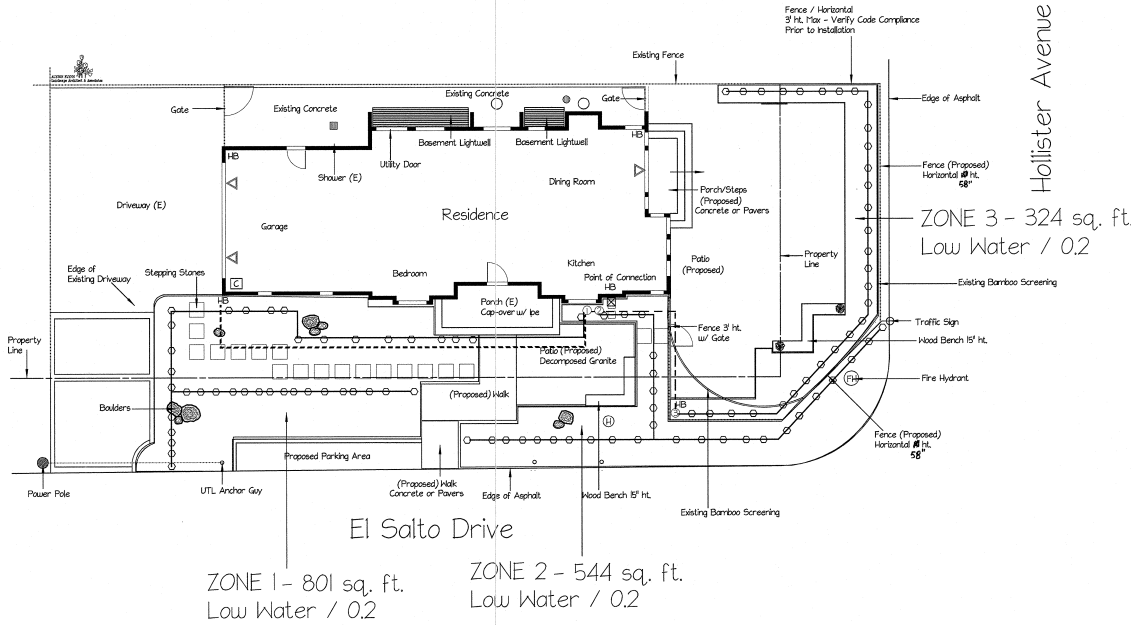

Water Control ETS by the Site	ETAF System per acre
Base Year Landscape Area	0.88
Water Control ETS by the Site	20.75
Water Control ETS by the Site (with 10% Rainfall)	9
Water Control ETS by the Site (with 10% Rainfall)	11
Water Control ETS by the Site (with 10% Rainfall)	11

ETAF System per acre	ETAF System per acre
Water Control ETS by the Site	0.88
Water Control ETS by the Site	20.75
Water Control ETS by the Site (with 10% Rainfall)	9
Water Control ETS by the Site (with 10% Rainfall)	11
Water Control ETS by the Site (with 10% Rainfall)	11

ETAF System per acre	ETAF System per acre
Water Control ETS by the Site	0.88
Water Control ETS by the Site	20.75
Water Control ETS by the Site (with 10% Rainfall)	9
Water Control ETS by the Site (with 10% Rainfall)	11
Water Control ETS by the Site (with 10% Rainfall)	11

ETAF System per acre	ETAF System per acre
Water Control ETS by the Site	0.88
Water Control ETS by the Site	20.75
Water Control ETS by the Site (with 10% Rainfall)	9
Water Control ETS by the Site (with 10% Rainfall)	11
Water Control ETS by the Site (with 10% Rainfall)	11

### ETAF CALCULATIONS

Regular Landscape Area  
 Total ETAF x Area 334  
 Total Area 1669  
 Average ETAF 0.20

Average ETAF for Regular Landscape Areas  
 Must be .55 or Below for Residential Areas.

Irrigation Legend						
SYMBOL	DESCRIPTION	BRAND	MODEL	SPRAY NOZZLE	PATTERN *	
(NOT SHOWN)	⊕	EHTTERS	1/2 GPH	RAN BRD	XB-05PC	# PER PLANT
	○	XER-BRD-80		RAN BRD	XER-BRD-80	2 PER EA, 1 GAL 4 PER EA 5 GAL (QTY AS NECESSARY)
	⊕	ELECTRIC VALVES		RAN BRD	100-RGA	
	⊕	PRESSURE VACUUM BREAKER		MILBENS	475M1.2 - F (LEAD FREE)	
	⊕	CONTROLLER		RAN BRD	STB - 20 WiFi Smart Irrigation WiFi Sprinkler Timer - 6 Zone	
	HB	Hose Bib				
	---	PIPING / TUBING		SCH/CLASS	TYPE	SIZE
	---	MAN LINE PIPING		SCH 40	PVC	1" (Irrigation Supply Line)
	---	LATERAL LINE		CLASS 200	PVC	3/4"
	(NOT SHOWN)	TUBING		RAN BRD	1/4"	
						50 PSI - MAN LINE PIPING
						INSTALL A PRESSURE REGULATOR AS NECESSARY.
						INSTALL AN AUTOMATIC RAN SHUT-OFF DEVICE

\*I have complied with the criteria of the Water Conservation in Landscaping Ordinance and applied them for the efficient use of water in the Landscape design plan.  
 \*I have complied with the Criteria of the Water Conservation in Landscaping Ordinance and applied them accordingly for the efficient use of water in the Irrigation design plan.

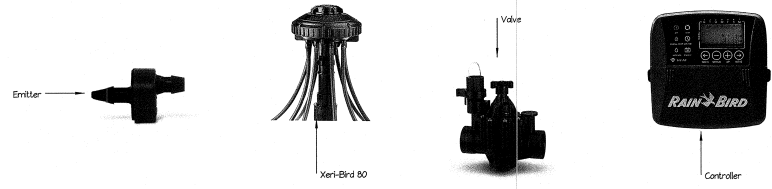

ALYSON FLYNN  
 LANDSCAPE ARCHITECT & ASSOCIATES  
 50 San Tropez Drive  
 San Francisco, CA 94114  
 Phone: (415) 274-1114  
 Landscape Architect No. 3874

Ducky Grabbill  
 501 El Salto Drive  
 Capitola, CA 95010

Date Oct 18, 2020  
 Scale 1/8" = 1' 0"  
 Drawn CLL/AF  
 Sheet L3  
 of 5 Sheets

Revisions	By
Sept. 01, 2022	CLL
Sept. 21, 2022	CLL

This plan is for general construction only, it is not fully detailed or specified. It is the responsibility of the contractor and/or owner to select, resolve, and install all construction features, planting materials, irrigation systems, and/or areas drains and drainage pipe.

The Landscape Architect will not be observing construction of this project. The contractor/owner is solely responsible for the quality control and construction standards, and the placement of all landscape features for this project.

All construction shall meet or exceed the latest edition of codes adopted by the local governing agencies.



FENCE DETAIL →  
1" = 1'  
SCALE

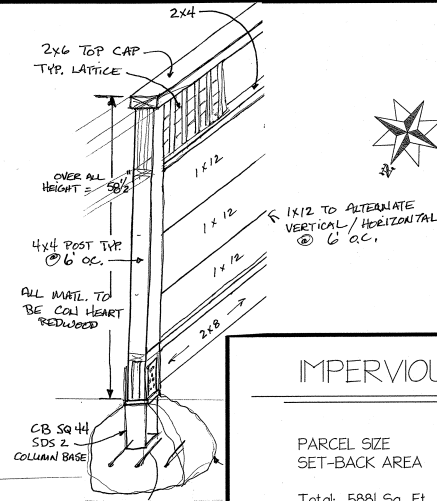

### IMPERVIOUS COVERAGE

PARCEL SIZE 4008 Sq. Ft.  
SET-BACK AREA 1873 Sq. Ft.

Total: 5881 Sq. Ft.

#### EXISTING SITE COVERAGE:

Dwelling 1396 Sq. Ft.  
Driveway 907 Sq. Ft.  
Deck, Walkway, Patio 1785 Sq. Ft.

Total: 4088 Sq. Ft.

#### PROPOSED SITE COVERAGE:

Dwelling 1396 Sq. Ft.  
Driveway 985 Sq. Ft.  
Walkways and Patio 1605 Sq. Ft.  
Pervious Decomposed Granite Patio (151 Sq. Ft.)

Total Proposed Impervious Coverage 3986 Sq. Ft.

Proposed Impervious Coverage Reduction 102 Sq. Ft.

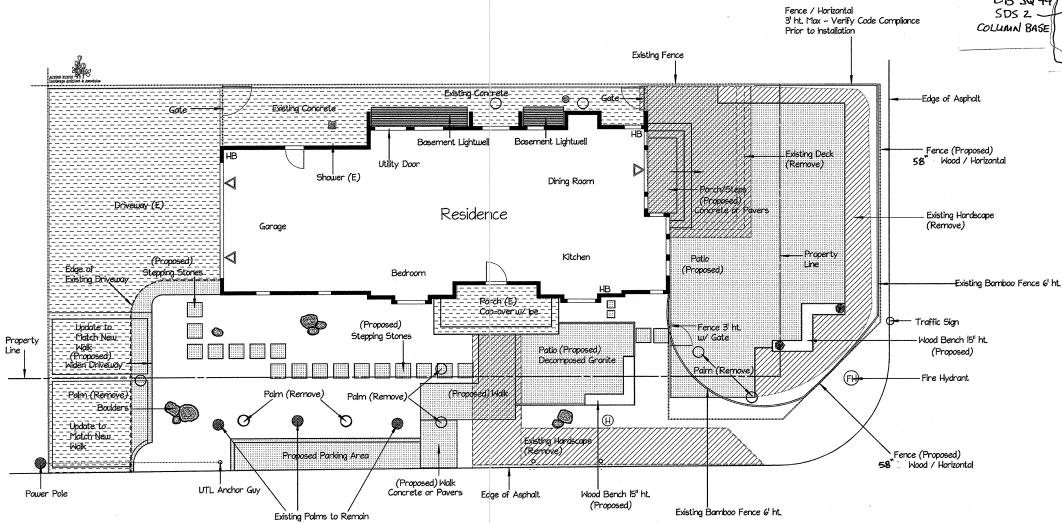

El Salto Drive

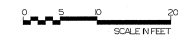
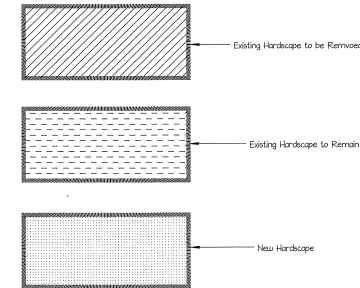

ALYSON FEINER  
LANDSCAPE ARCHITECT & ASSOCIATES  
501 El Salto Drive  
Capitola, CA 95023  
Phone: (408) 274-4114  
Landscape Architect No. 5074



Ducky Grabil  
501 El Salto Drive  
Capitola, CA 95010

Date Oct 18, 2022

Scale 1/8" = 1'-0"

Drawn CLL/AF

Sheet L4

of 5 Sheets

