

SCHMIDT
ARCHITECTS, P.C.
16101 SW 72ND AVENUE
SUITE 135
PORTLAND, OR 97224
(503) 220-8517
www.schmidtarchitectspc.com

PARKER VILLAGE
NW 38TH AVE & NW PARKER STREET
CAMAS, WASHINGTON



PROJECT NO.
2025-101
DATE:
06/10/2025
DRAWN BY:
MEB
CHECKED BY:
FMS

REVISIONS

2025-101 Site Renders /
Cover

COVER

1 PLAZA LOOKING TO SOUTHWEST

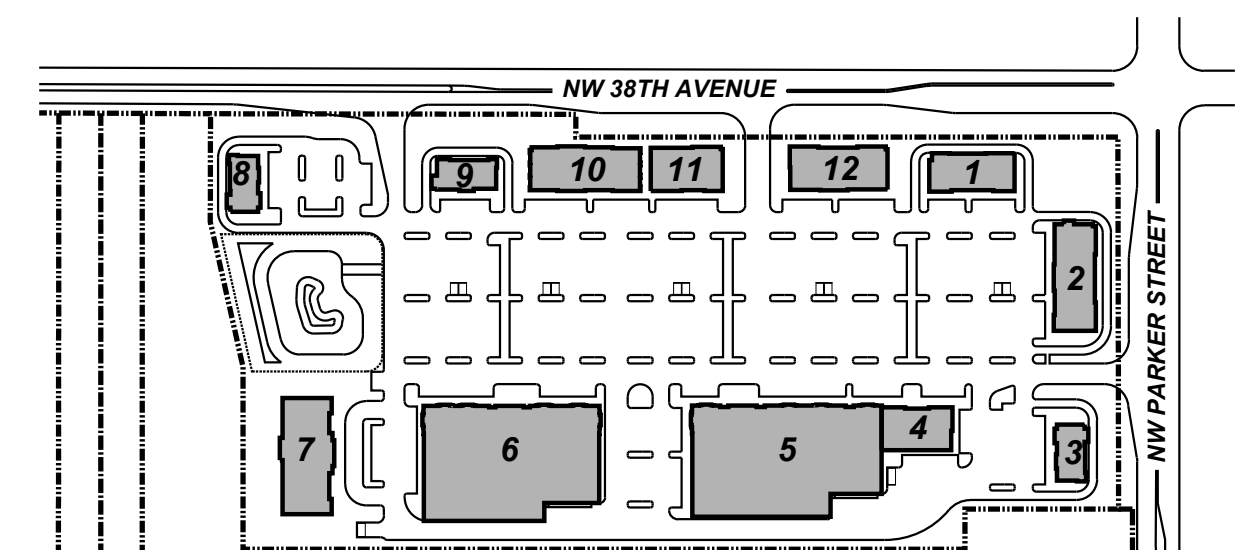

KEY PLAN
N.T.S.

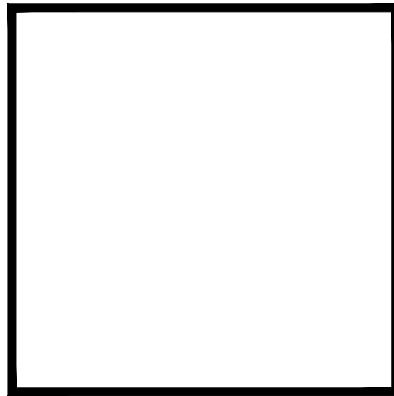

SCHMIDT
ARCHITECTS, P.C.
16101 SW 72ND AVENUE
SUITE 135
PORTLAND, OR 97224
(503) 220-8517
www.schmidtarchitectspc.com

PARKER VILLAGE
NW 38TH AVE & NW PARKER STREET
CAMAS, WASHINGTON



1 SITE
VIEW FROM SOUTHEAST



2 SITE
VIEW FROM NORTHEAST

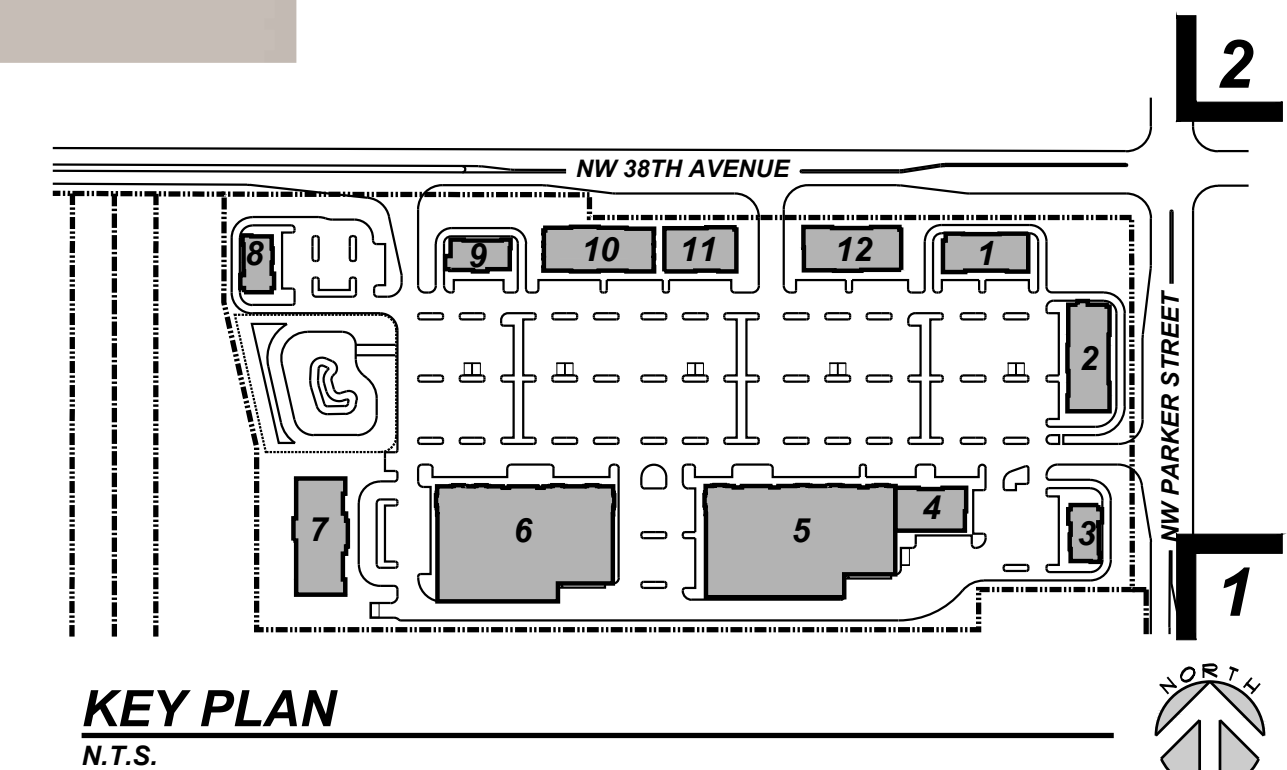

KEY PLAN
N.T.S.

PROJECT NO.
2025-101

DATE:
06/10/2025

DRAWN BY:
MEB

CHECKED BY:
FMS

REVISIONS

2025-101 Site Renders /
Site Views | East

SITE VIEWS
SITE
VIEWS
1

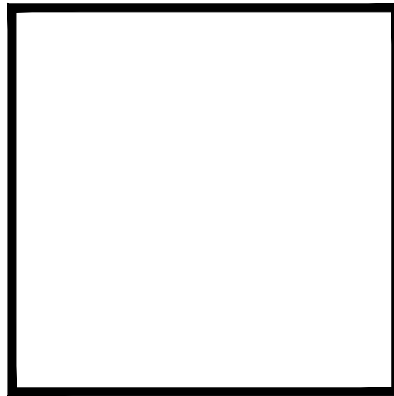

SCHMIDT
ARCHITECTS, P.C.
16101 SW 72ND AVENUE
SUITE 135
PORTLAND, OR 97224
(503) 220-8517
www.schmidtarchitectspc.com

PARKER VILLAGE
NW 38TH AVE & NW PARKER STREET
CAMAS, WASHINGTON



1 SITE VIEW FROM NORTHWEST



2 SITE VIEW FROM SOUTHWEST

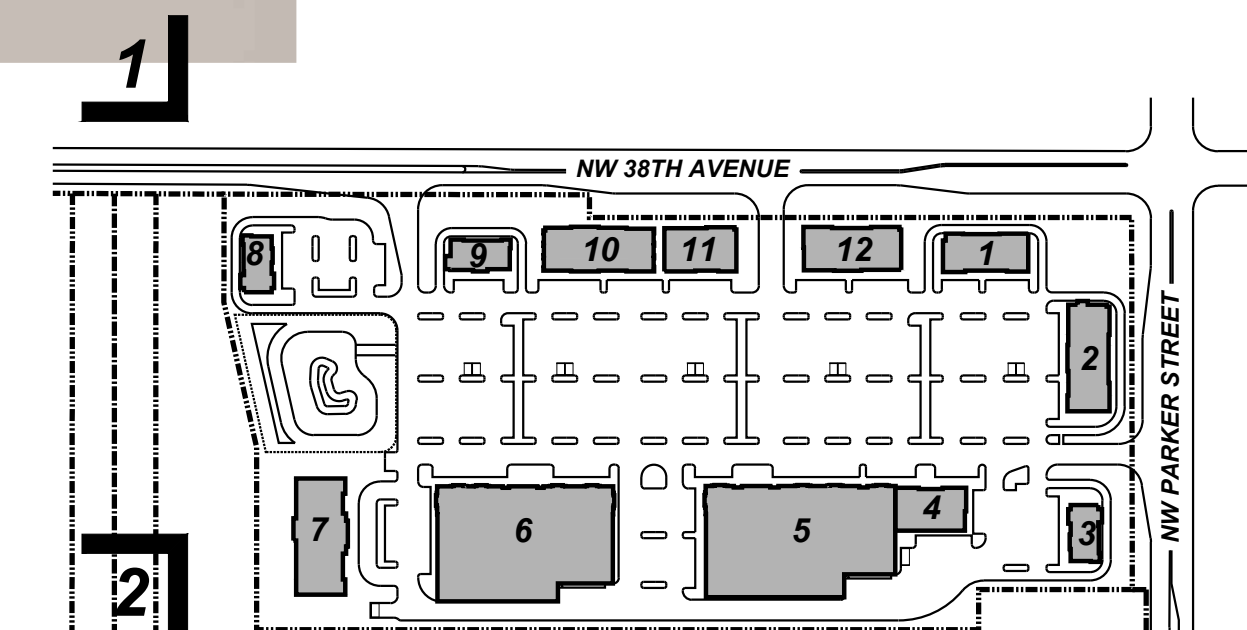

KEY PLAN
N.T.S.

PROJECT NO.
2025-101

DATE:
06/10/2025

DRAWN BY:
MEB

CHECKED BY:
FMS

REVISIONS

2025-101 Site Renders /
Site View 2 West

SITE VIEWS
SITE VIEWS
2



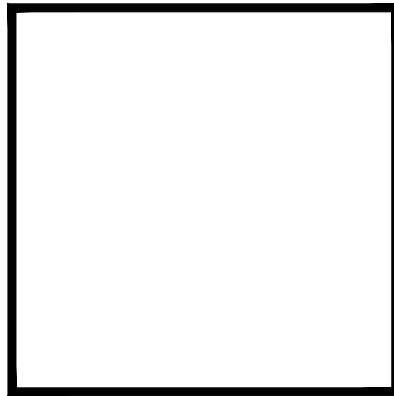

SCHMIDT
ARCHITECTS, P.C.
16101 SW 72ND AVENUE
SUITE 135
PORTLAND, OR 97224
(503) 220-8517
www.schmidtarchitectspc.com

PARKER VILLAGE
NW 38TH AVE & NW PARKER STREET
CAMAS, WASHINGTON



1 BUILDINGS '09', '10', & '11'
LOOKING NORTH



2 PLAZA AT BUILDINGS '10' & '11'
LOOKING NORTH



3 BUILDINGS '11', '12', '01', & '02'
LOOKING NORTH

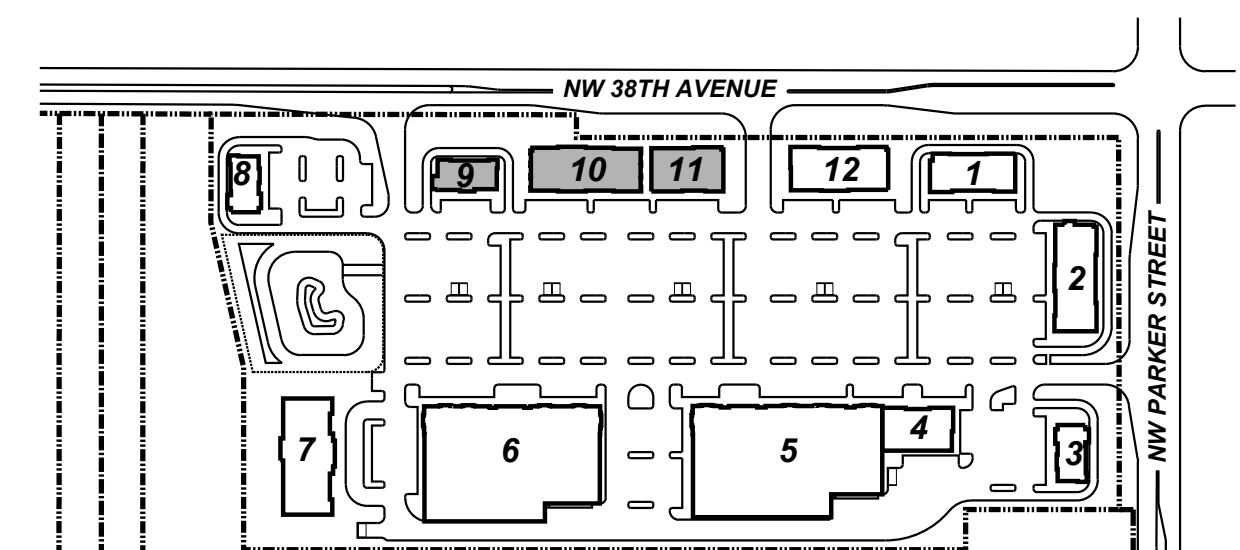

KEY PLAN
N.T.S.

PROJECT NO.
2025-101

DATE:
06/10/2025

DRAWN BY:
MEB

CHECKED BY:
FMS

REVISIONS

2025-101 Site Renders /
Site Views 3 Parking Lot

SITE VIEWS
SITE
VIEWS
'3'



1 **SITE BUILDING '8'**



2 **SITE BUILDING '9'**



3 **SITE BUILDING '10'**

SCHMIDT
ARCHITECTS, P.C.
16101 SW 72ND AVENUE
SUITE 135
PORTLAND, OR 97224
(503) 220-8517
www.schmidtarchitectspc.com

PARKER VILLAGE
NW 38TH AVE & NW PARKER STREET
CAMAS, WASHINGTON

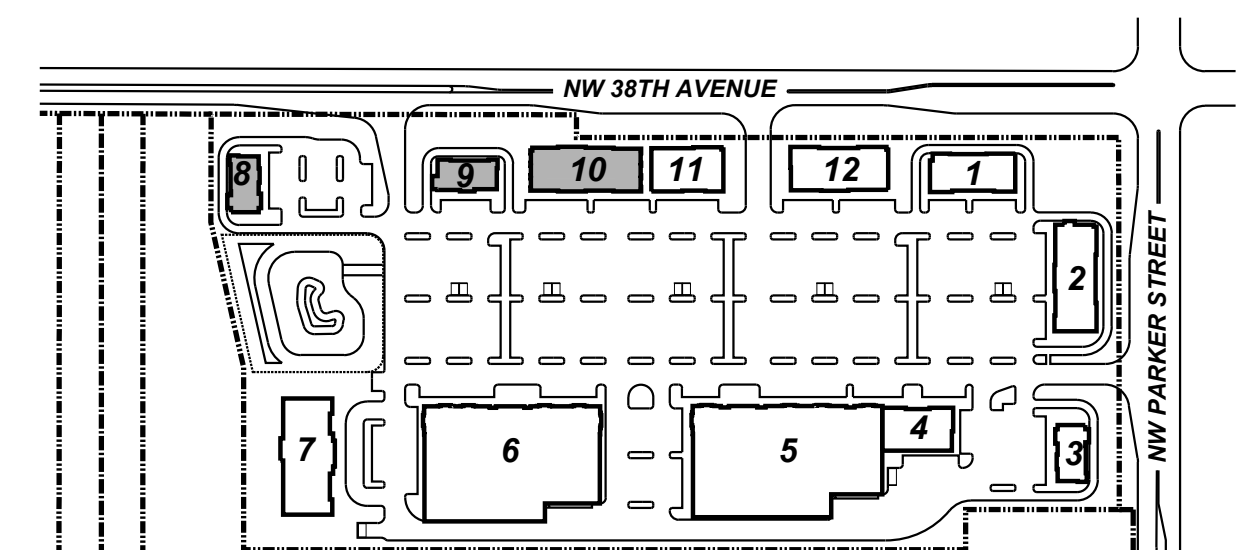

KEY PLAN
N.T.S.

PROJECT NO.
2025-101

DATE:
06/10/2025

DRAWN BY:
MEB

CHECKED BY:
FMS

REVISIONS

2025-101 Site Renders /
Site Tour

SITE TOUR
SITE TOUR
1

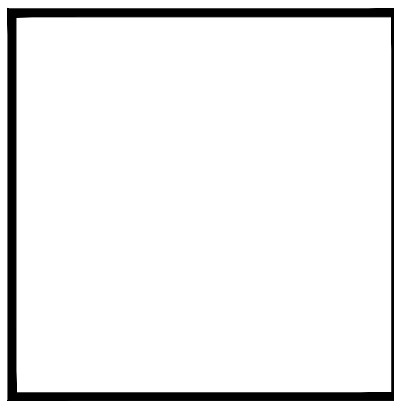

SCHMIDT
ARCHITECTS, P.C.
16101 SW 72ND AVENUE
SUITE 135
PORTLAND, OR 97224
(503) 220-8517
www.schmidtarchitectspc.com

PARKER VILLAGE
NW 38TH AVE & NW PARKER STREET
CAMAS, WASHINGTON



1 **SITE BUILDING '11'**



2 **SITE BUILDING '12'**



3 **SITE BUILDING '1'**

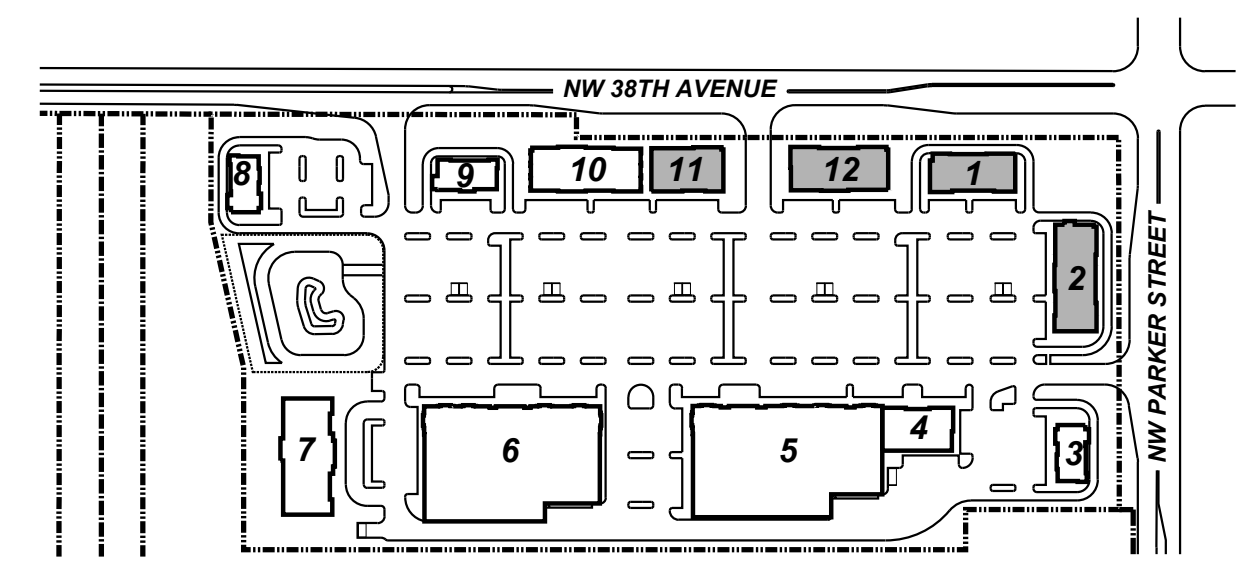

KEY PLAN
N.T.S.

PROJECT NO. 2025-101
DATE: 06/10/2025
DRAWN BY: MEB
CHECKED BY: FMS
REVISIONS
2025-101 Site Renders / Site Tour2

SITE TOUR
TOUR
2



1 **SITE BUILDING '2'**



2 **SITE BUILDING '3'**



3 **SITE BUILDING '4'**

SCHMIDT
ARCHITECTS, P.C.
16101 SW 72ND AVENUE
SUITE 135
PORTLAND, OR 97224
(503) 220-8517
www.schmidtarchitectspc.com

PARKER VILLAGE
NW 38TH AVE & NW PARKER STREET
CAMAS, WASHINGTON

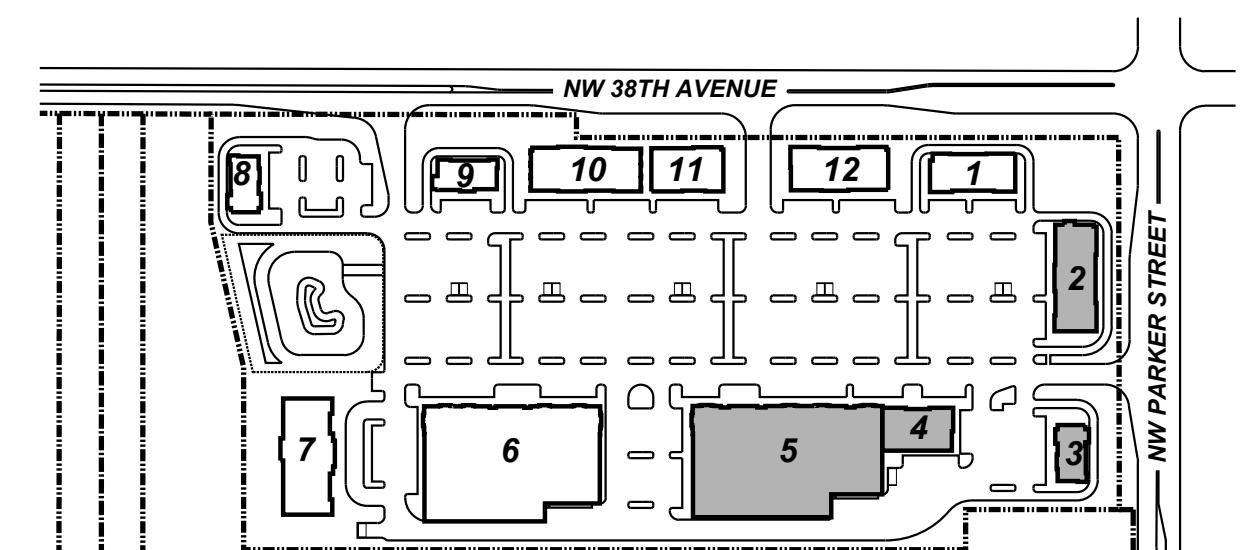

KEY PLAN
N.T.S.

PROJECT NO.
2025-101

DATE :

DRAWN BY :

CHECKED BY :
FMS

REVISIONS

2025-101 Site Renders /
Site Tour 3

SITE TOUR
TOUR
3



1 SITE BUILDING '5'



2 SITE BUILDING '6'



3 SITE BUILDING '7'

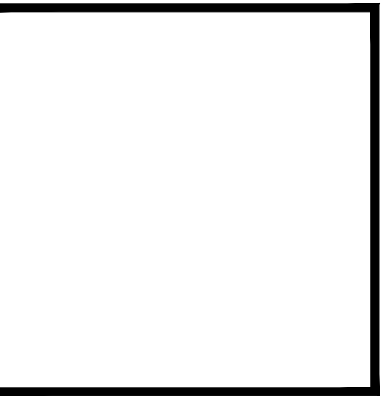

SCHMIDT
ARCHITECTS, P.C.
16101 SW 72ND AVENUE
SUITE 135
PORTLAND, OR 97224
(503) 220-8517
www.schmidtarchitectspc.com

PARKER VILLAGE
NW 38TH AVE & NW PARKER STREET
CAMAS, WASHINGTON

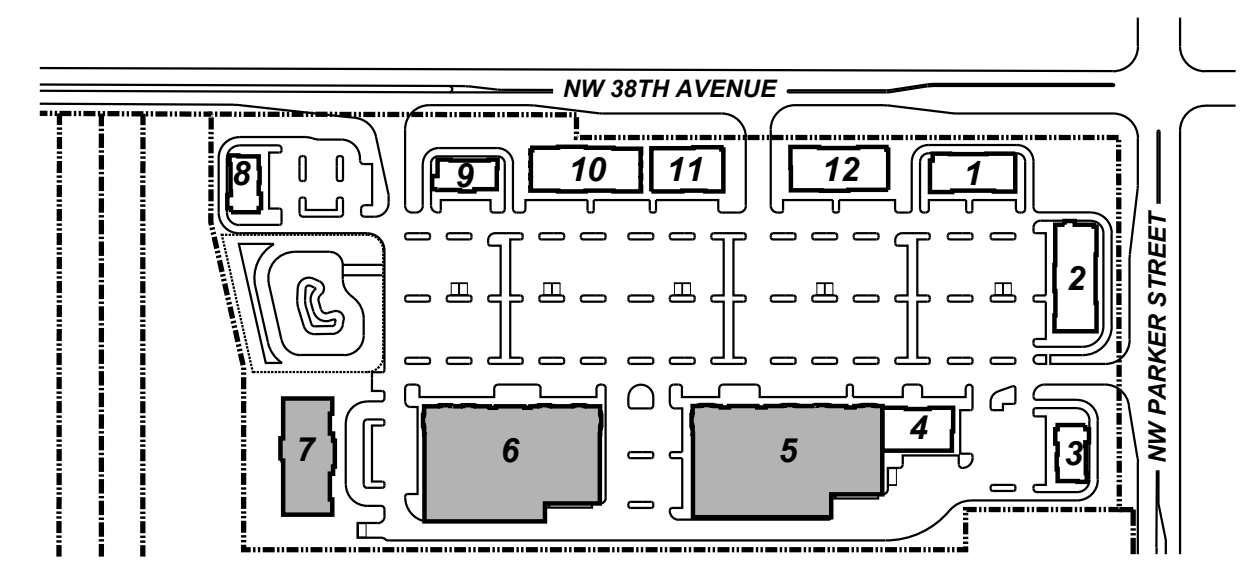

KEY PLAN
N.T.S.



PROJECT NO. 2025-101
DATE: 06/10/2025
DRAWN BY: MEB
CHECKED BY: FMS
REVISIONS
2025-101 Site Renders / Site Tour 4

SITE TOUR
TOUR
4



1 BUILDING '2'
NORTHWEST CORNER



2 BUILDING '2'
SOUTHEAST CORNER

SCHMIDT
ARCHITECTS, P.C.
16101 SW 72ND AVENUE
SUITE 135
PORTLAND, OR 97224
(503) 220-8517
www.schmidtarchitectspc.com

PARKER VILLAGE
NW 38TH AVE & NW PARKER STREET
CAMAS, WASHINGTON

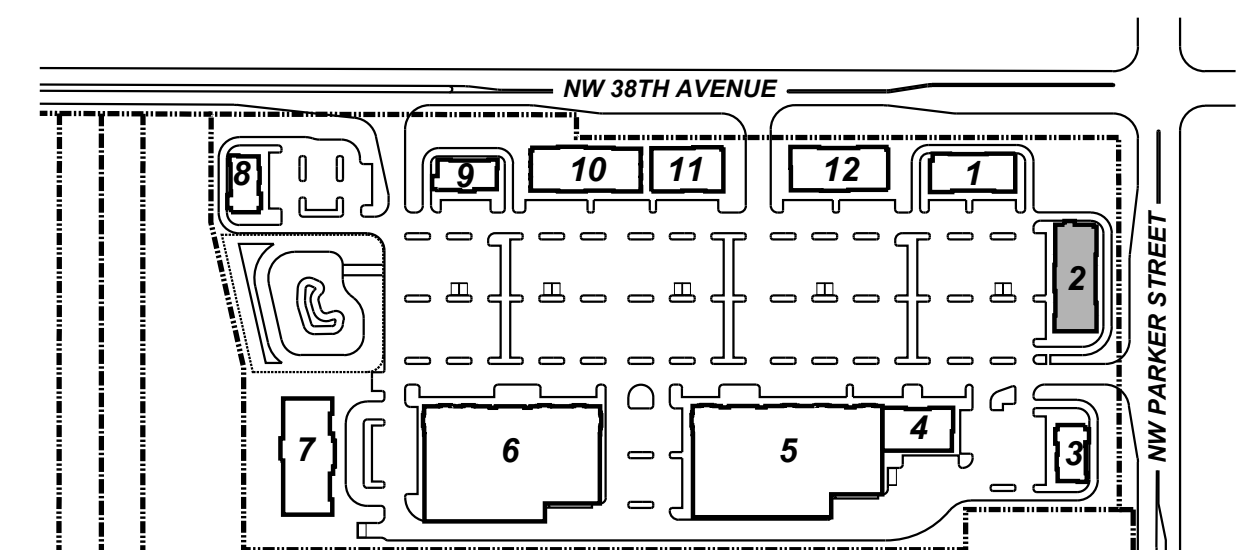

KEY PLAN
N.T.S.

PROJECT NO.
2025-101

DATE:
06/10/2025

DRAWN BY:
MEB

CHECKED BY:
FMS

REVISIONS

2025-101 Site Renders /
Bldg '2' Corners

BUILDING '2'
BLDG
'2'



BUILDING '4'
NORTHEAST CORNER

1



BUILDING '4'
SOUTHEAST CORNER

2

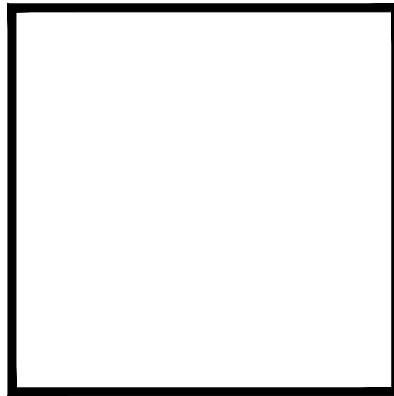

SCHMIDT
ARCHITECTS, P.C.
16101 SW 72ND AVENUE
SUITE 135
PORTLAND, OR 97224
(503) 220-8517
www.schmidtarchitectspc.com

PARKER VILLAGE
NW 38TH AVE & NW PARKER STREET
CAMAS, WASHINGTON

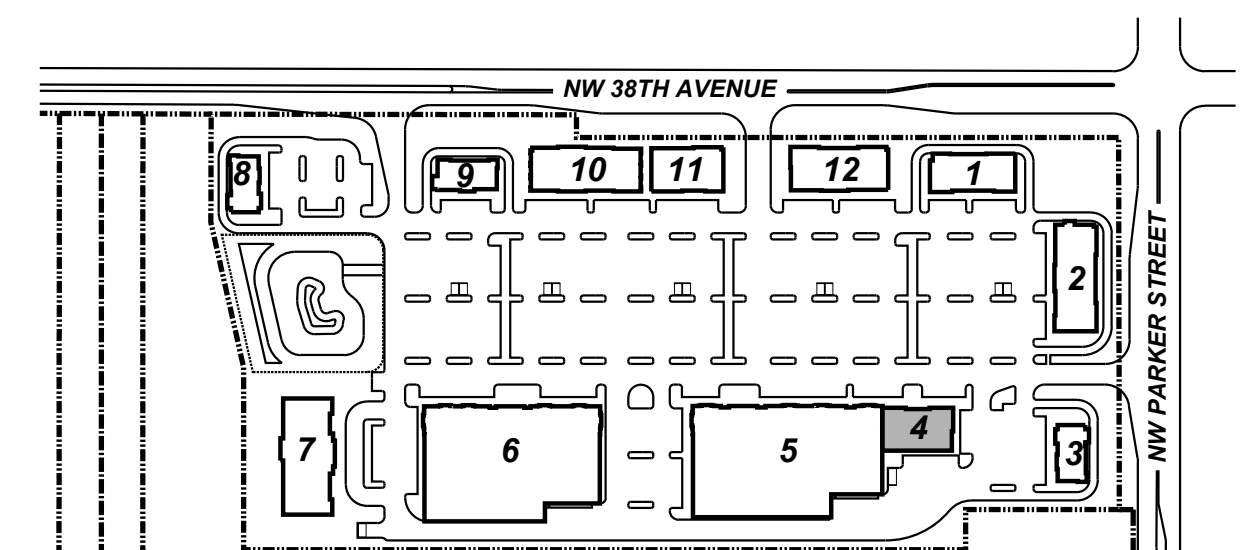

KEY PLAN
N.T.S.

PROJECT NO.
2025-101

DATE:
06/10/2025

DRAWN BY:
MEB

CHECKED BY:
FMS

REVISIONS

2025-101 Site Renders /
Bldg '4' Corners

BUILDING '4'
BLDG
'4'

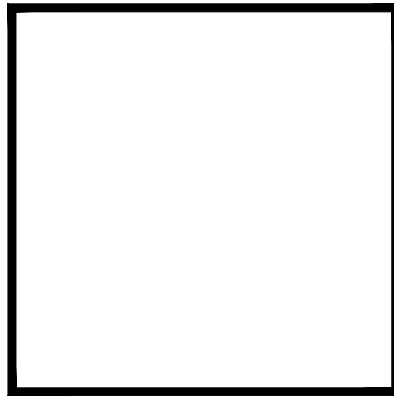

SCHMIDT
ARCHITECTS, P.C.
16101 SW 72ND AVENUE
SUITE 135
PORTLAND, OR 97224
(503) 220-8517
www.schmidtarchitectspc.com



1 BUILDING '6'
NORTHEAST CORNER



2 BUILDING '6'
SOUTHWEST CORNER

PARKER VILLAGE
NW 38TH AVE & NW PARKER STREET
CAMAS, WASHINGTON

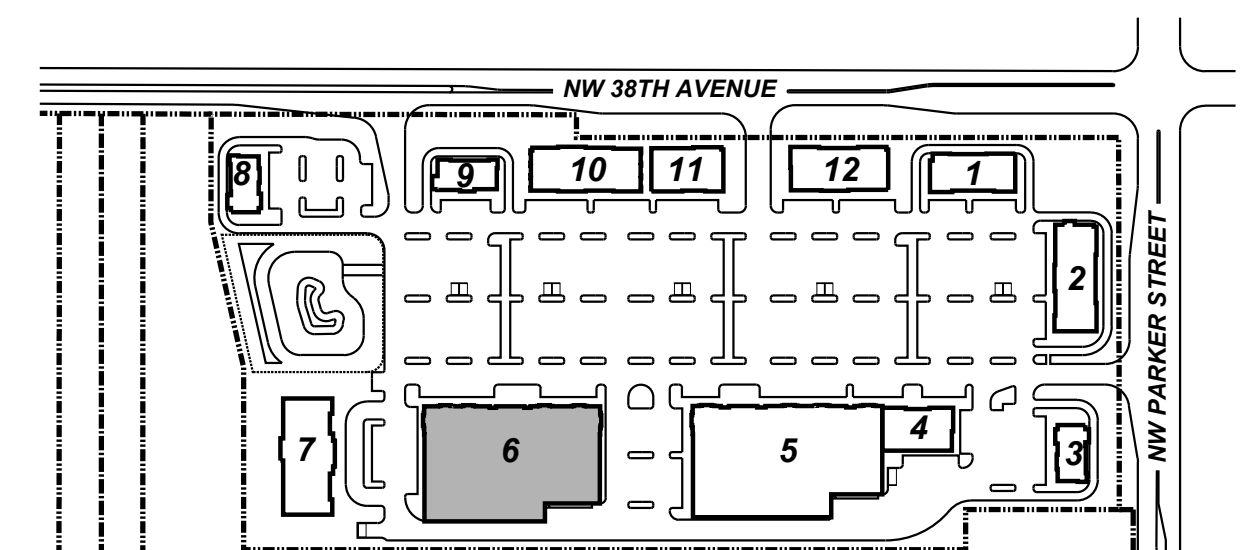

KEY PLAN
N.T.S.

PROJECT NO.
2025-101

DATE:
06/10/2025

DRAWN BY:
MEB

CHECKED BY:
FMS

REVISIONS

2025-101 Site Renders /
Bldg '6' Corners

BUILDING '6'
BLDG
'6'



1 **BUILDING '7'**
NORTHEAST CORNER

2 **BUILDING '7'**
SOUTHWEST CORNER

SCHMIDT
ARCHITECTS, P.C.
16101 SW 72ND AVENUE
SUITE 135
PORTLAND, OR 97224
(503) 220-8517
www.schmidtarchitectspc.com

PARKER VILLAGE
NW 38TH AVE & NW PARKER STREET
CAMAS, WASHINGTON

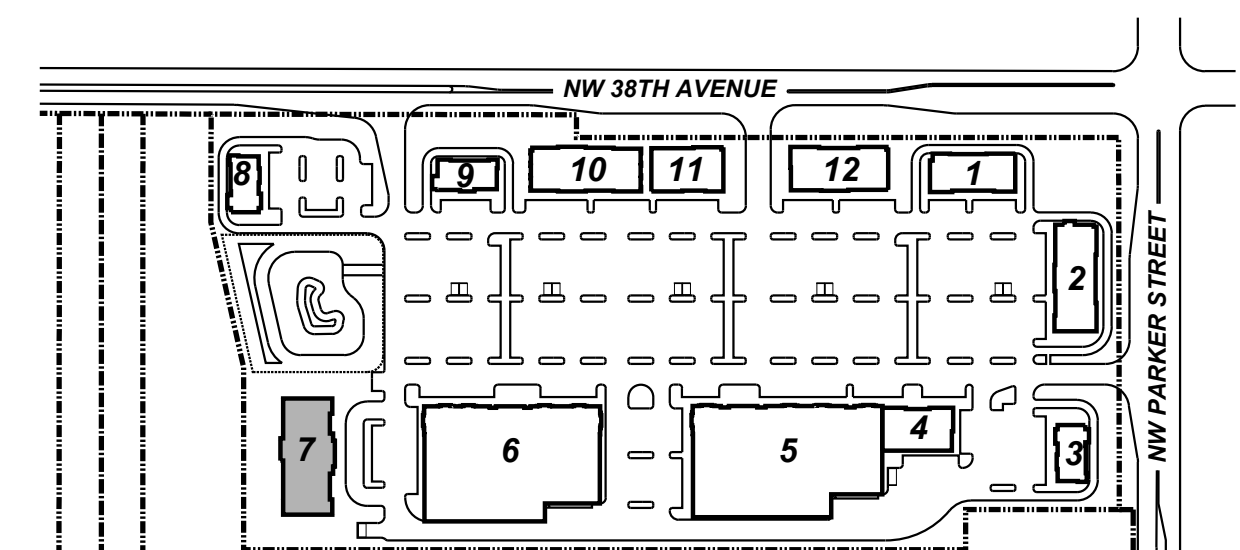

KEY PLAN
N.T.S.



PROJECT NO.
2025-101
DATE:
06/10/2025
DRAWN BY:
MEB
CHECKED BY:
FMS

REVISIONS

2025-101 Site Renders /
Bldg '7' Corners

BUILDING '7'
BLDG
'7'

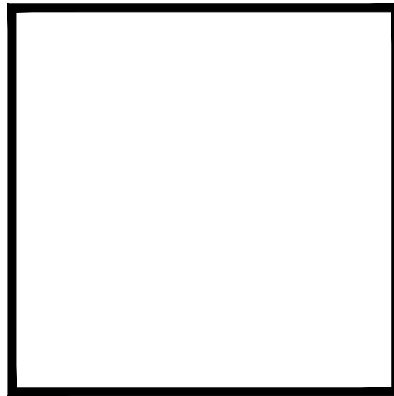

SCHMIDT
ARCHITECTS, P.C.
16101 SW 72ND AVENUE
SUITE 135
PORTLAND, OR 97224
(503) 220-8517
www.schmidtarchitectspc.com



1 BUILDING '8'
SOUTHWEST CORNER

2 BUILDING '8'
NORTHEAST CORNER

PARKER VILLAGE
NW 38TH AVE & NW PARKER STREET
CAMAS, WASHINGTON

PROJECT NO.
2025-101

DATE:

06/10/2025

DRAWN BY:

MEB

CHECKED BY:

FMS

REVISIONS

2025-101 Site Renders /
Bldg '8' Corners

BUILDING '8'
BLDG
'8'

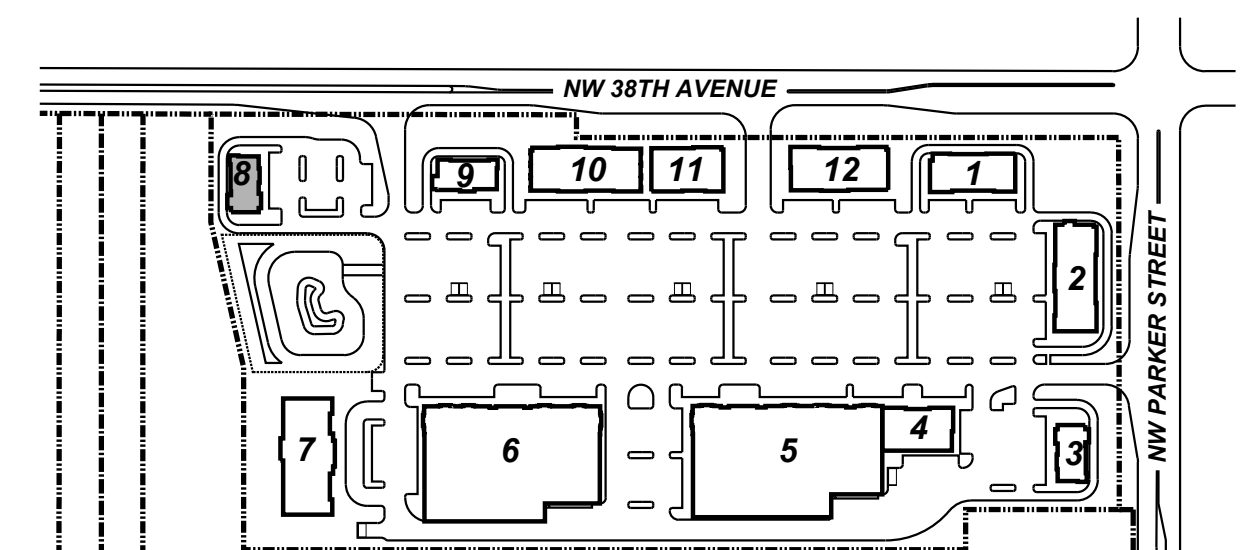

KEY PLAN
N.T.S.





1 **BUILDING '10'**
SOUTHWEST CORNER

2 **BUILDING '10'**
NORTHEAST CORNER

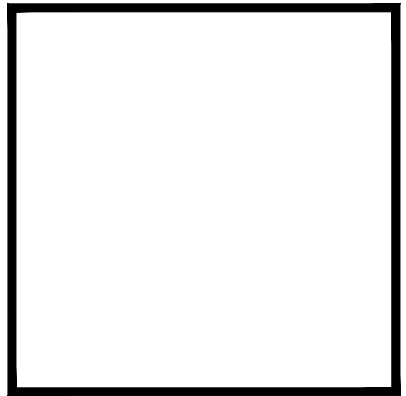

SCHMIDT
ARCHITECTS, P.C.
16101 SW 72ND AVENUE
SUITE 135
PORTLAND, OR 97224
(503) 220-8517
www.schmidtarchitectspc.com

PARKER VILLAGE
NW 38TH AVE & NW PARKER STREET
CAMAS, WASHINGTON

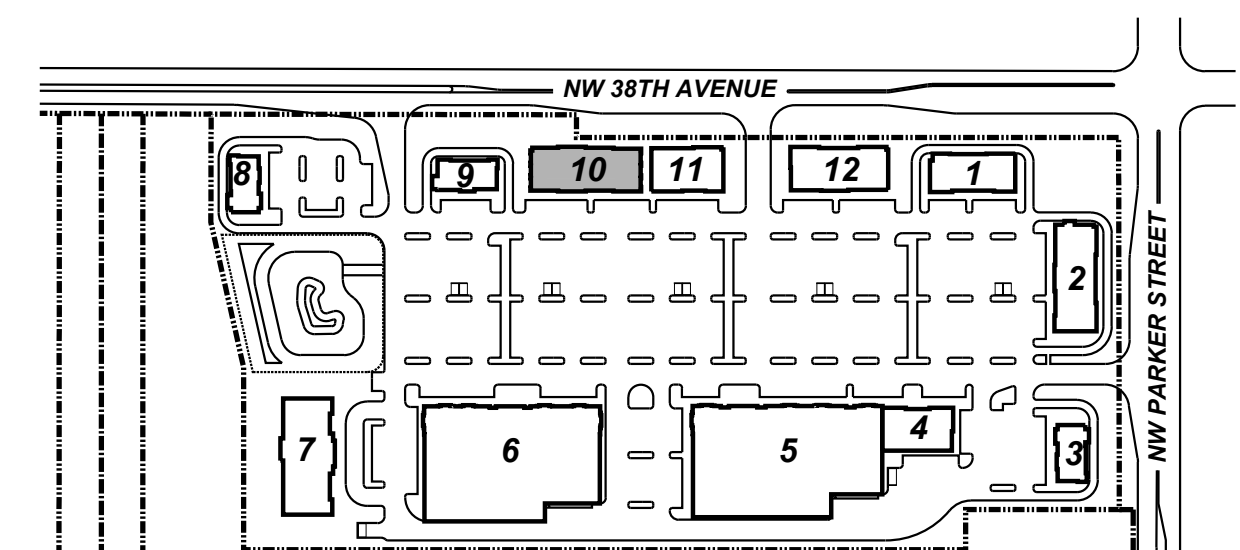

KEY PLAN
N.T.S.



PROJECT NO.
2025-101

DATE :

DRAWN BY :

CHECKED BY :
FMS

REVISIONS

2025-101 Site Renders /
Bldg '10' Corners

BUILDING '10'
BLDG
'10'



1 **BUILDING '11'**
SOUTHWEST CORNER

2 **BUILDING '11'**
NORTHEAST CORNER

SCHMIDT
ARCHITECTS, P.C.
16101 SW 72ND AVENUE
SUITE 135
PORTLAND, OR 97224
(503) 220-8517
www.schmidtarchitectspc.com

PARKER VILLAGE
NW 38TH AVE & NW PARKER STREET
CAMAS, WASHINGTON

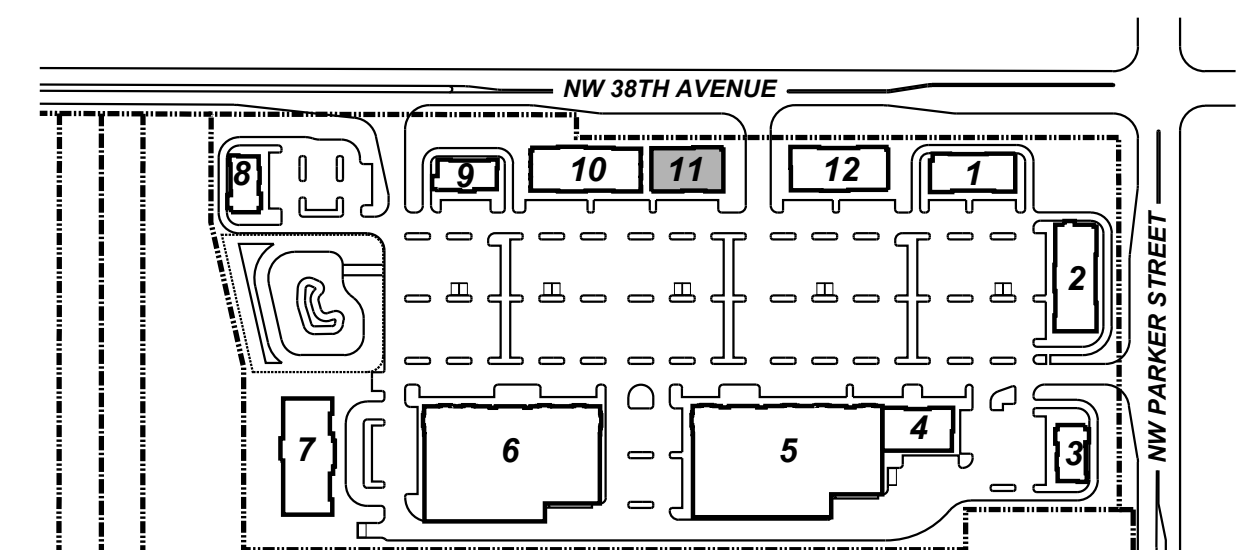

KEY PLAN
N.T.S.

PROJECT NO.
2025-101

DATE:
06/10/2025

DRAWN BY:
MEB

CHECKED BY:
FMS

REVISIONS

2025-101 Site Renders /
Bldg '11' Corners

BUILDING '11'
BLDG
'11'



1 **BUILDING '12'**
SOUTHWEST CORNER

2 **BUILDING '12'**
NORTHEAST CORNER

SCHMIDT
ARCHITECTS, P.C.
16101 SW 72ND AVENUE
SUITE 135
PORTLAND, OR 97224
(503) 220-8517
www.schmidtarchitectspc.com

PARKER VILLAGE
NW 38TH AVE & NW PARKER STREET
CAMAS, WASHINGTON

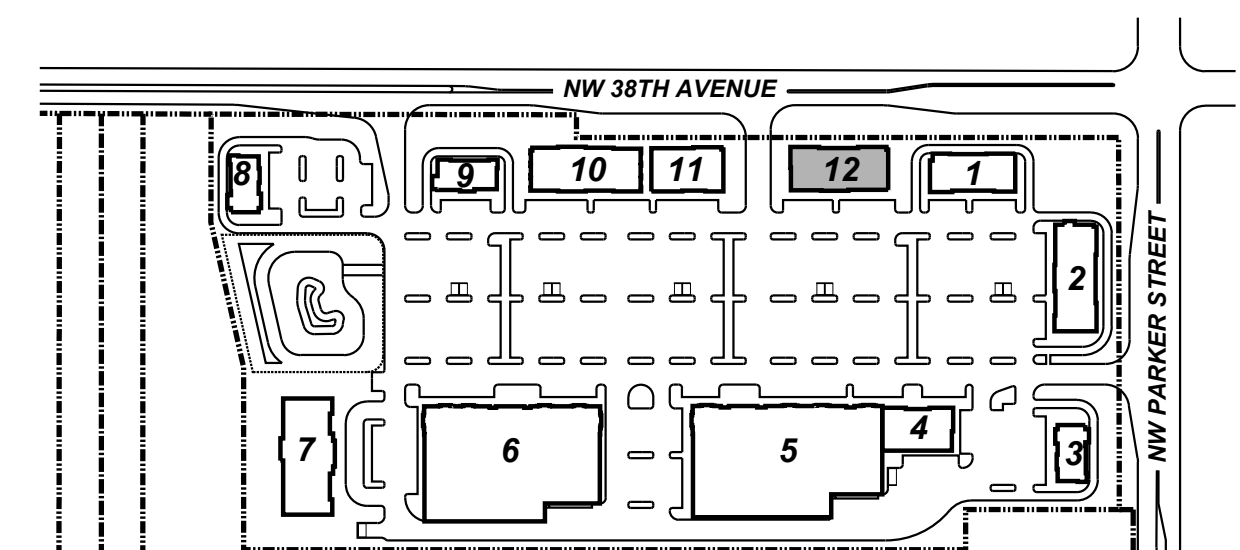

KEY PLAN
N.T.S.

PROJECT NO.
2025-101

DATE:
06/10/2025

DRAWN BY:
MEB

CHECKED BY:
FMS

REVISIONS

2025-101 Site Renders /
Bldg '12' Corners

BUILDING '12'
BLDG
'12'