



CLARK COUNTY WASHINGTON

www.clark.wa.gov/assessor

ASSESSOR'S OFFICE
Peter Van Nortwick, Assessor

1300 Franklin Street
PO Box 5000
Vancouver, WA 98666-5000
360.397.2391
360.397.6046 f

October 20th, 2023

Robert Maul
Planning Manager
Camas, WA 98607

Dear Mr. Maul,

You will find enclosed the Certification of Sufficiency of the petition for annexation of land to the City of Camas: Weakly Property Annexation.

Please contact me should you have any questions regarding this annexation.

Sincerely,

A handwritten signature in black ink, appearing to read 'Peter Van Nortwick', is written over a horizontal line.

Peter Van Nortwick
Clark County Assessor

Enclosed:

Certification of Sufficiency
Annexation Legal Description
Annexation Map

Certification of Sufficiency
Weakly Property Annexation

The City of Camas on August 16th, 2023, submitted for review by Clark County Assessor, a petition to annex to the City, approximately 41.12 acres of land known as the Weakly Property Annexation. Subject to the requirements of 35A.01.040 I now certify the following in my capacity as Clark County Assessor:

1. On August 16th, 2023, the City of Camas submitted for certification by the Clark County Assessor a petition to annex to the City eleven (8) parcels of land and associated road and public utility rights-of-way, totaling approximately 41.12 acres.
2. The legal description and map of the area proposed for annexation, as provided by the City, are attached to this certification. According to the map provided by the City, this area is in unincorporated Clark County and within the urban growth boundary.
3. The city is completing annexation pursuant to the sixty percent method of annexation RCW 35A.14.120 – 150
4. The Clark County Assessor initiated determination of petition sufficiency on October 20th, 2023, which is the “terminal date” as defined in 35A.01.040
5. The area proposed for annexation has a certified annexation value for general taxation of \$4,451,064.00.
6. Petition signatures provided by the City represent valid owner signatures of a combined total assessed value for general taxation of not less than 60% of the total assessed value for general taxation of all property in the proposed annexation area. This review did not address the legal sufficiency of any proxy or utility covenant, only the sufficiency of the presence of signatures thereon.

Therefore, based on the petition certification request and supporting materials submitted by the City, I hereby declare and certify that the petition represents the affirmative consent of properties totaling more than 60% of the value according to the assessed valuation for general taxation purposes of the property proposed for annexation.

Given under my hand and seal this October 20th, 2023.

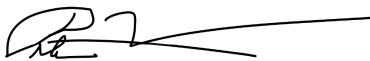

Peter Van Nortwick
Clark County Assessor



PAGE 1 OF 5

**60% PETITION FOR ANNEXATION
INTO THE CITY OF CAMAS**

We the undersigned hereby petition the City of Camas to have our property as described below annexed to the City of Camas. We certify that we are the legal owners of such property and are aware that our signatures will be combined with the required signatures to represent at least sixty percent (60%) or more of the total value of all property within the area we are asking to be annexed.

A legal description will be required for the entire annexation area at time of formal petition submittal.

****The City Council requires assumption of existing city indebtedness by the area to be annexed****

Yes _____ No X

****The City Council requires the simultaneous adoption of a proposed comprehensive plan designation for the area to be annexed****

Yes _____ No X

WARNING: Every person who signs this petition with any other than his or her true name, or who knowingly signs more than one of these petitions, or signs a petition seeking an election when he or she is not a legal voter, or signs a petition when he or she is otherwise not qualified to sign, or who makes herein any false statement, shall be guilty of a misdemeanor.

| PARCEL # | SIGN & PRINT NAME | ADDRESS | DATE SIGNED | OWNER | VOTER |
|-----------|---|---------------------------------------|-------------|-------|-------|
| 175762000 | <i>Betty Jane Kreiter</i> BETTY JANE KREITER | 23404 NE WEAKLEY RD CAMAS WA 98607 | 6/23/23 | X | X |
| | <i>Mark Fricke</i> MARK FRICKE | | 6/28/23 | X | X |
| | | | | | |

June Puntillo Fricke
June Puntillo Fricke

6/28/23 X X



PAGE 2
OF 5

**60% PETITION FOR ANNEXATION
INTO THE CITY OF CAMAS**

We the undersigned hereby petition the City of Camas to have our property as described below annexed to the City of Camas. We certify that we are the legal owners of such property and are aware that our signatures will be combined with the required signatures to represent at least sixty percent (60%) or more of the total value of all property within the area we are asking to be annexed.

A legal description will be required for the entire annexation area at time of formal petition submittal.

****The City Council requires assumption of existing city indebtedness by the area to be annexed****

Yes _____ No xx _____

****The City Council requires the simultaneous adoption of a proposed comprehensive plan designation for the area to be annexed****

Yes _____ No xx _____

WARNING: Every person who signs this petition with any other than his or her true name, or who knowingly signs more than one of these petitions, or signs a petition seeking an election when he or she is not a legal voter, or signs a petition when he or she is otherwise not qualified to sign, or who makes herein any false statement, shall be guilty of a misdemeanor.

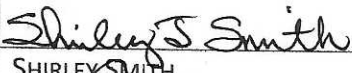
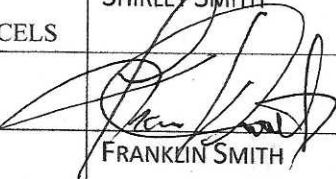
| PARCEL # | SIGN & PRINT NAME | ADDRESS | DATE SIGNED | OWNER | VOTER |
|------------------------|---|---------------------------------------|-------------|-------|-------|
| 175765000 175763000 |  SHIRLEY SMITH | 23609 NE WEAKLEY RD CAMAS WA 98607 | 6/24/2023 | yes | yes |
| 2 PARCELS |  FRANKLIN SMITH | | 6/24/2023 | yes | yes |



PAGE 3
OF 5

**60% PETITION FOR ANNEXATION
INTO THE CITY OF CAMAS**

We the undersigned hereby petition the City of Camas to have our property as described below annexed to the City of Camas. We certify that we are the legal owners of such property and are aware that our signatures will be combined with the required signatures to represent at least sixty percent (60%) or more of the total value of all property within the area we are asking to be annexed.

A legal description will be required for the entire annexation area at time of formal petition submittal.



****The City Council requires assumption of existing city indebtedness by the area to be annexed****

Yes _____ No xx _____

****The City Council requires the simultaneous adoption of a proposed comprehensive plan designation for the area to be annexed****

Yes _____ No xx _____

WARNING: Every person who signs this petition with any other than his or her true name, or who knowingly signs more than one of these petitions, or signs a petition seeking an election when he or she is not a legal voter, or signs a petition when he or she is otherwise not qualified to sign, or who makes herein any false statement, shall be guilty of a misdemeanor.

| PARCEL # | SIGN & PRINT NAME | ADDRESS | DATE SIGNED | OWNER | VOTER |
|-----------|--|---------------------------------------|-------------|-------|-------|
| 175768000 |  YOLANDA IVANITY | 23523 NE WEAKLEY RD CAMAS WA 98607 | 6/28/23 | X | |
| |  RUSLAN IVANITY | | 6-28-23 | X | |



PAGE 4
OF 5

**60% PETITION FOR ANNEXATION
INTO THE CITY OF CAMAS**

We the undersigned hereby petition the City of Camas to have our property as described below annexed to the City of Camas. We certify that we are the legal owners of such property and are aware that our signatures will be combined with the required signatures to represent at least sixty percent (60%) or more of the total value of all property within the area we are asking to be annexed.

A legal description will be required for the entire annexation area at time of formal petition submittal.



****The City Council requires assumption of existing city indebtedness by the area to be annexed****

Yes _____ No xx

****The City Council requires the simultaneous adoption of a proposed comprehensive plan designation for the area to be annexed****

Yes _____ No xx

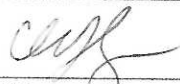
WARNING: Every person who signs this petition with any other than his or her true name, or who knowingly signs more than one of these petitions, or signs a petition seeking an election when he or she is not a legal voter, or signs a petition when he or she is otherwise not qualified to sign, or who makes herein any false statement, shall be guilty of a misdemeanor.

| PARCEL # | SIGN & PRINT NAME | ADDRESS | DATE SIGNED | OWNER | VOTER |
|-----------|---|---------------------------------------|-------------|-------|-------|
| 175767000 |  MARIA T ALBERTY-JORDAN | 23415 NE WEAKLEY RD CAMAS WA 98607 | 6-27-23 | ✓ | ✓ |
| |  MICHAEL JORDAN | | 6/27/23 | ✓ | ✓ |



PAGE 5
OF 5

**60% PETITION FOR ANNEXATION
INTO THE CITY OF CAMAS**

We the undersigned hereby petition the City of Camas to have our property as described below annexed to the City of Camas. We certify that we are the legal owners of such property and are aware that our signatures will be combined with the required signatures to represent at least sixty percent (60%) or more of the total value of all property within the area we are asking to be annexed.

A legal description will be required for the entire annexation area at time of formal petition submittal.

****The City Council requires assumption of existing city indebtedness by the area to be annexed****

Yes _____ No xx _____

****The City Council requires the simultaneous adoption of a proposed comprehensive plan designation for the area to be annexed****

Yes _____ No xx _____

WARNING: Every person who signs this petition with any other than his or her true name, or who knowingly signs more than one of these petitions, or signs a petition seeking an election when he or she is not a legal voter, or signs a petition when he or she is otherwise not qualified to sign, or who makes herein any false statement, shall be guilty of a misdemeanor.

| PARCEL # | SIGN & PRINT NAME | ADDRESS | DATE SIGNED | OWNER | VOTER |
|-----------|---|---------------------------------------|--------------|-------|-------|
| 175764000 | <i>Lucille Wheeler</i> LUCILLE WHEELER | 23401 NE WEAKLEY RD CAMAS WA 98607 | 06/27/2023 ✓ | | ✓ |
| | <i>Dale Wheeler</i> DALE WHEELER | | 06/27/23 ✓ | | ✓ |
| | | | | | |
| | | | | | |

Camas Annexation

A tract of land in the Northwest Quarter of Section 27 and the Northeast Quarter of Section 28, Township 2 North, Range 3 East, Willamette Meridian, in Clark County Washington, more particularly described as follows.

Beginning at the Northwest corner of Section 27; thence West 20.00 feet to the West boundary of the NE 232nd Ave. right-of-way; thence South $01^{\circ}13'19''$ West 301.02 feet; thence West 20.00 feet to the Northeast Corner of Parcel 1 of Short Plat 1-606; thence South $01^{\circ}13'19''$ West along the west boundary of said right-of-way 990.00 feet to the Southeast corner of Parcel 2 of Short Plat 1-618; thence South $89^{\circ}06'25''$ East 10.00 feet; thence South $01^{\circ}13'19''$ West 25.56 feet; thence South $89^{\circ}06'25''$ East 1354.43 feet to the Southeast corner of the Northwest quarter of the Northwest Quarter of Section 27; thence North $01^{\circ}28'19''$ East 1321.12 feet to the Northeast corner of the Northwest quarter of the Northwest Quarter of Section 27; thence North $89^{\circ}18'02''$ West 1330.22 feet to Northwest corner of Section 27 and the Point of Beginning.

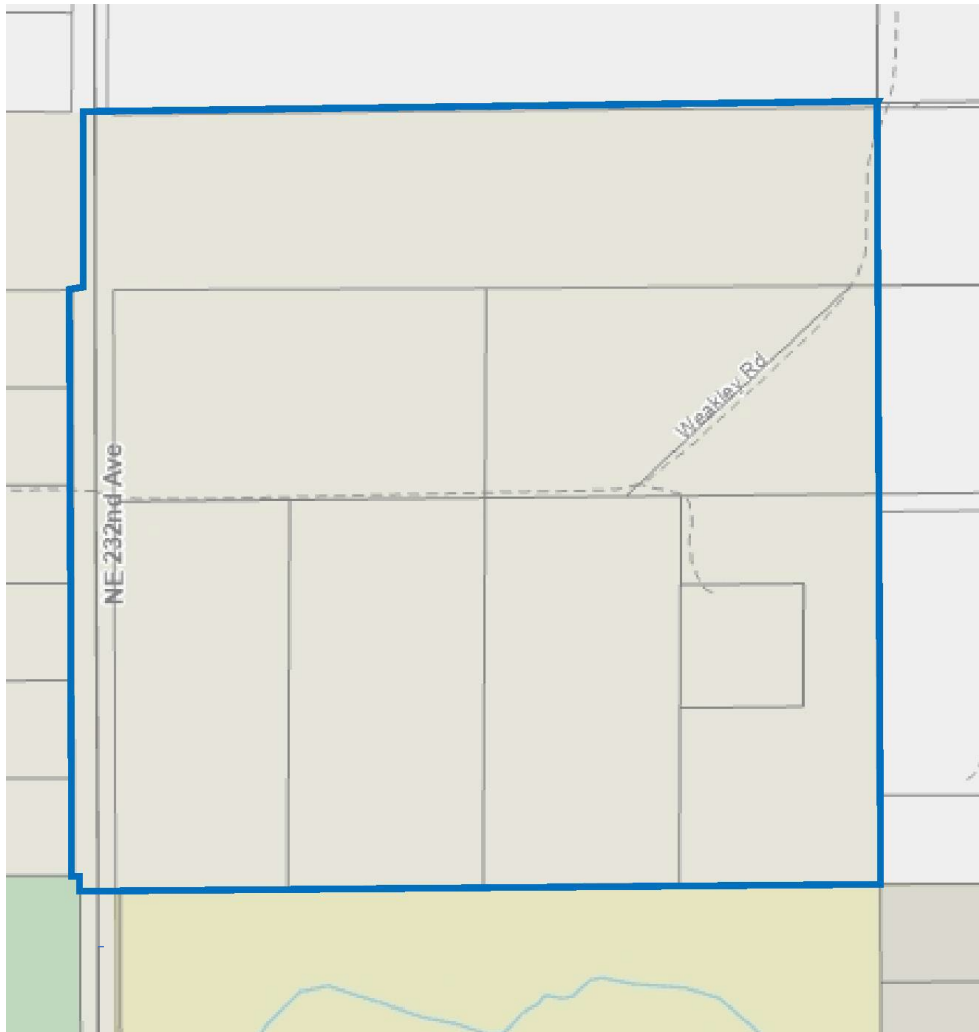

231212

231223

Clark County

231281

231274

Camas