

INNOVATIVE PROPERTY GROUP LLC
2027 NW SIERRA LN
CAMAS, WA 98607

COUNTY PROPERTIES EAST LLC
4857 NW LAKE RD #320
CAMAS, WA 98607

LOFTS AT CAMAS MEADOWS PHASE
II LLC
2370 E 3RD LP STE 100
VANCOUVER, WA 98661

COUNTY PROPERTIES EAST LLC
4857 NW LAKE RD #320
CAMAS, WA 98607

COUNTY PROPERTIES EAST LLC
4857 NW LAKE RD #320
CAMAS, WA 98607

VANPORT MANUFACTURING INC &
HERTRICH ADOLF
PO BOX 97
BORING, OR 97009

CM#3 LLC
4857 NW LAKE ROAD, SUITE 320
CAMAS, WA 98607

BLT CLUB LLC
6733 NW LONGBOW LANE
CAMAS, WA 98603

LOFTS AT CAMAS MEADOWS PHASE I
LLC
2370 E 3RD LOOP STE 100
VANCOUVER, WA 98661

FAR FROM PAR LLC
504 NE 5TH AVE
CAMAS, WA 98607

DJT PROPERTIES LLC
805 SW BROADWAY SUITE 700
PORTLAND, OR 97205

PLEXSYS INTERFACE PRODUCTS INC
4900 NW CAMAS MEADOWS DR
CAMAS, WA 98607

CM #567 LLC
915 W 11TH ST
VANCOUVER, WA 98660

COUNTY PROPERTIES EAST LLC
4857 NW LAKE RD #320
CAMAS, WA 98607

LOFTS AT CAMAS MEADOWS PHASE I
LLC
2370 E 3RD LOOP STE 100
VANCOUVER, WA 98661

FAR FROM PAR LLC
504 NE 5TH AVE
CAMAS, WA 98607

CM #567 LLC
915 W 11TH ST
VANCOUVER, WA 98660

EAST VANCOUVER OWNER LLC
1821 DOCK ST SUITE 100
TACOMA, WA 98402

PEDWAR DEVELOPMENT GROUP LLC
4711 NW CAMAS MEADOWS DR
CAMAS, WA 98607

CM#3 LLC
4857 NW LAKE ROAD, SUITE 320
CAMAS, WA 98607

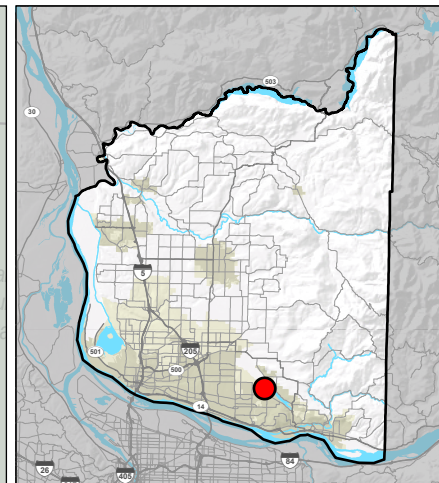
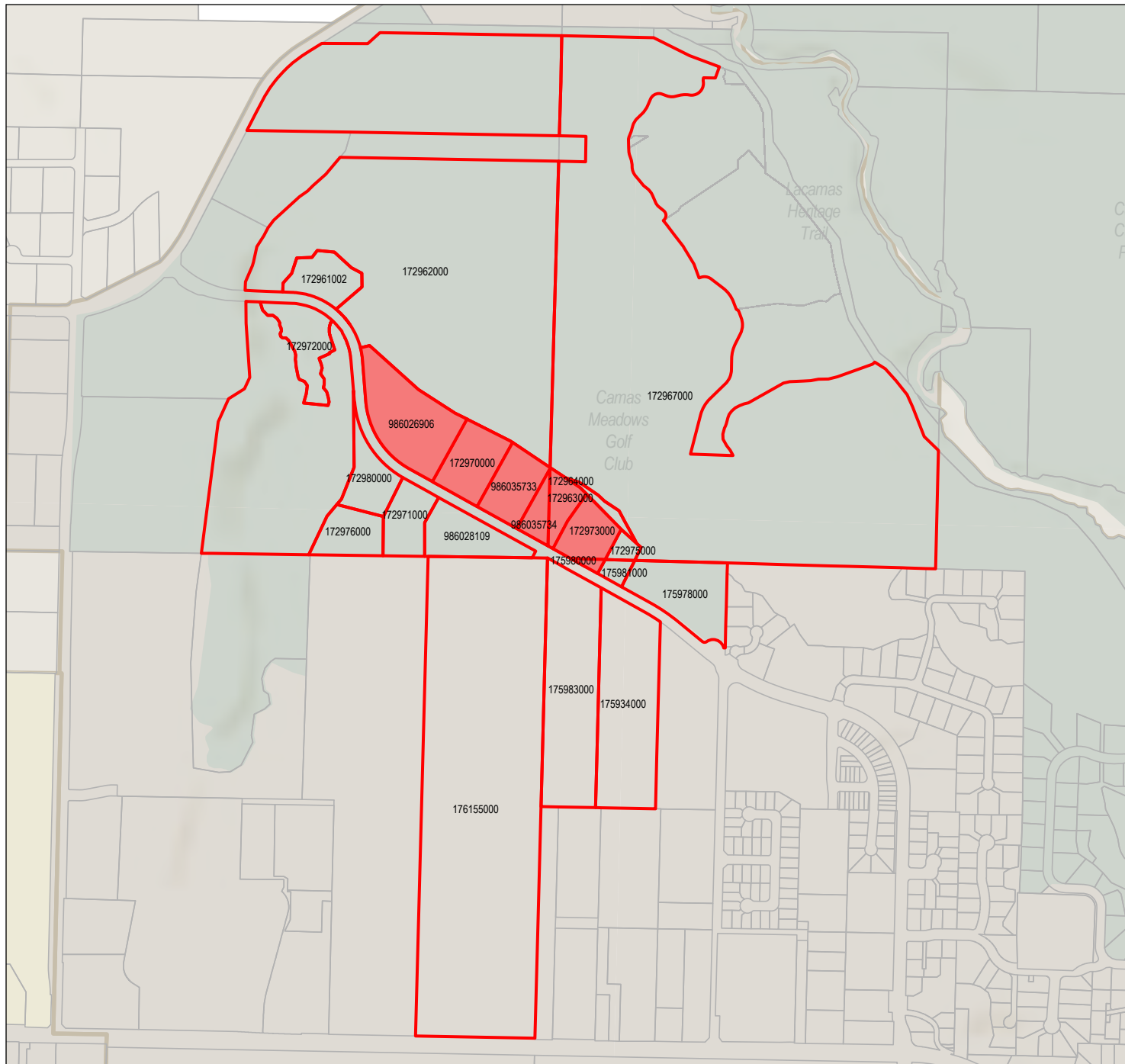

VANPORT MANUFACTURING INC &
HERTRICH ADOLF
PO BOX 97
BORING, OR 97009

LOFTS AT CAMAS MEADOWS PHASE
II LLC
2370 E 3RD LP STE 100
VANCOUVER, WA 98661



**PID(s): 175980000, 172973000,
172963000, 986035734,
986035733, 172970000,
986026906,
300-Foot Buffer**

KEY

-  Subject Property
-  Buffer Selection
-  Parcels



NOTE: Information shown on this map was collected from several sources. Clark County accepts no responsibility for any inaccuracies that may be present.

