

Preliminary Circulation Plan For:

13th Street Site Plan

A Subdivision Located In The City Of Camas, Washington

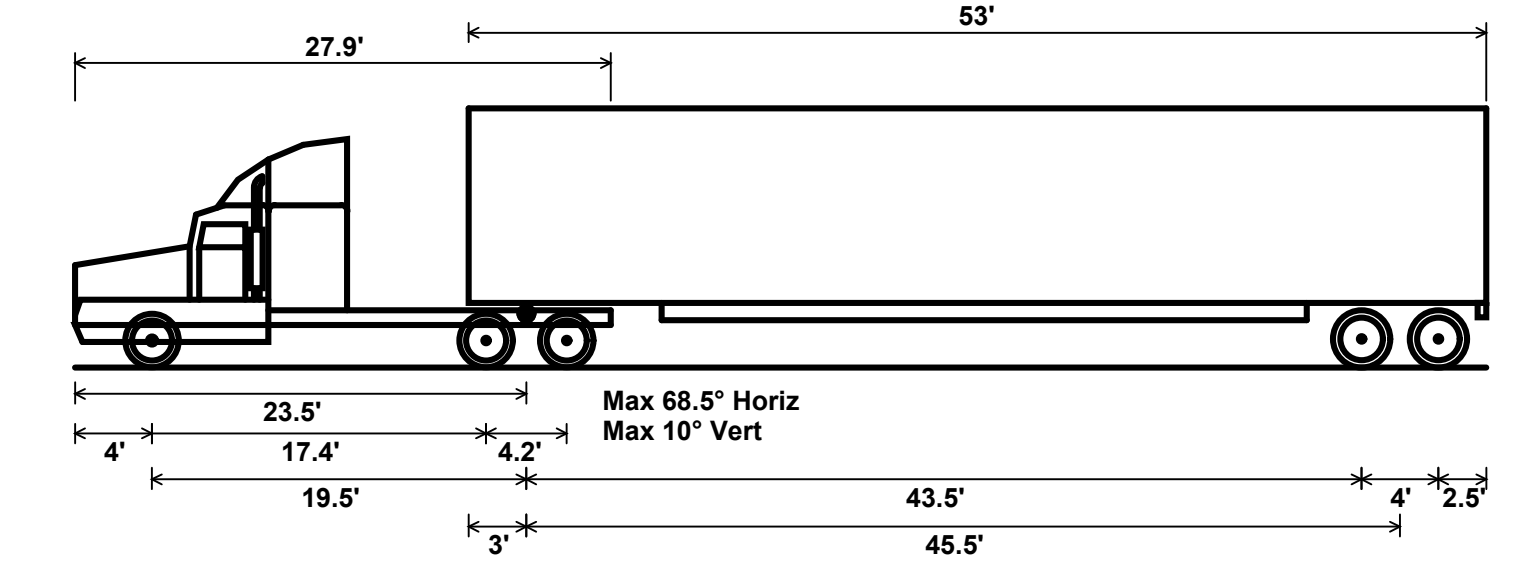
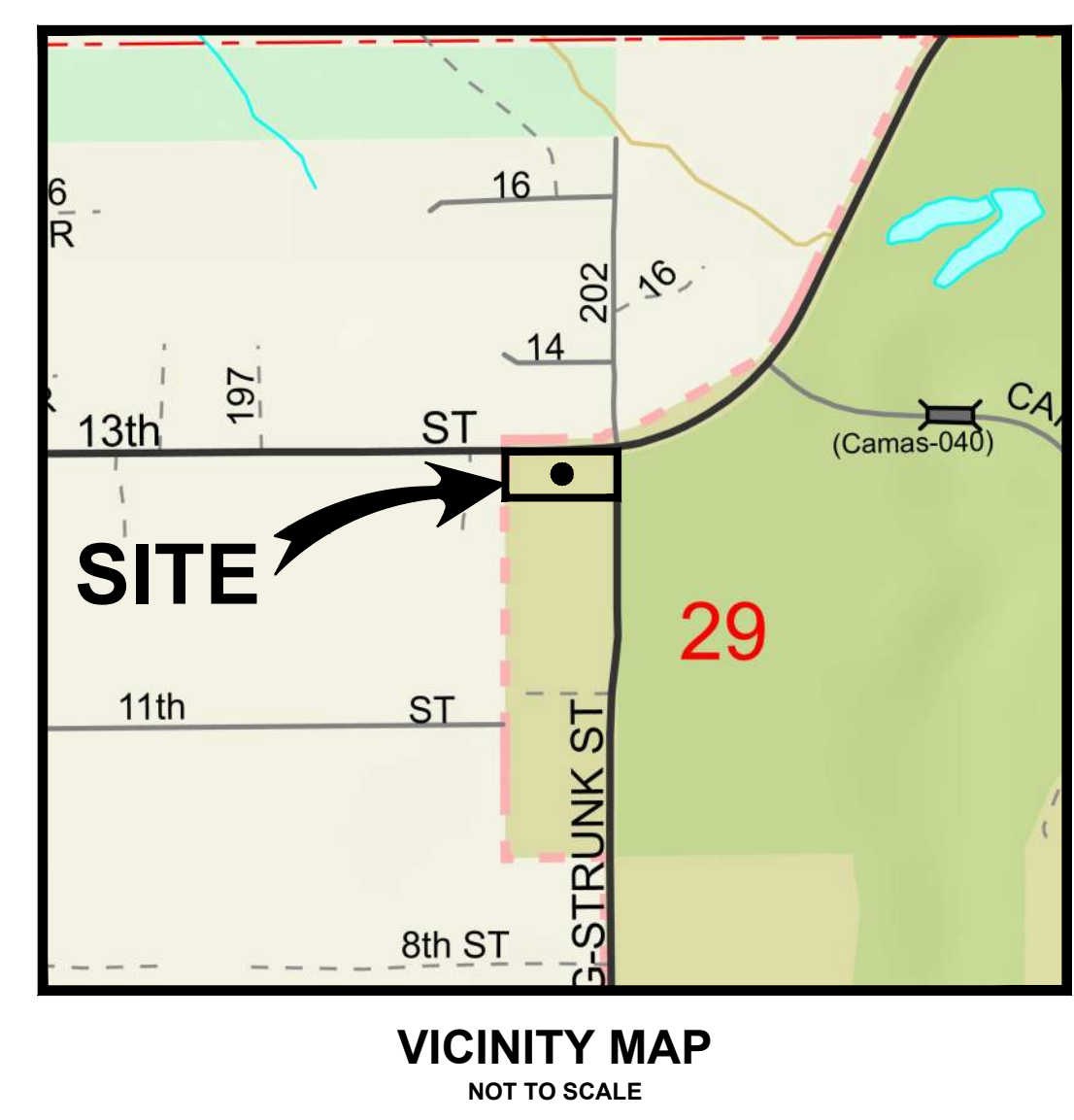

WB-67 - Interstate Semi-Trailer
 Overall Length 73.50ft
 Overall Width 8.50ft
 Overall Body Height 13.50ft
 Min Body Ground Clearance 1.334ft
 Max Track Width 8.500ft
 Lock-to-lock time 6.00s
 Max Steering Angle (Virtual) 28.40°

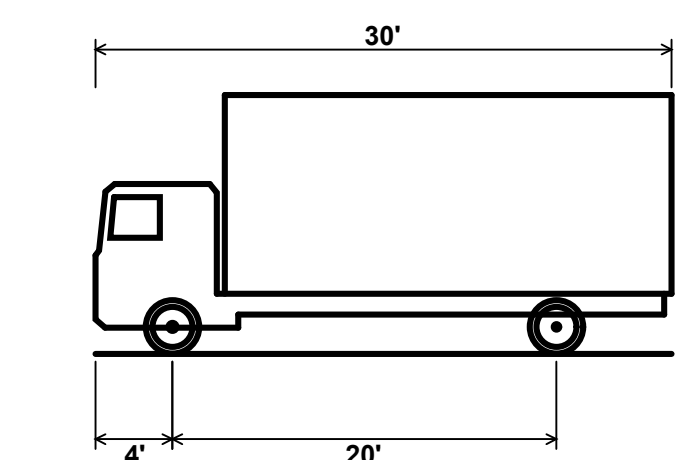

SU-30 - Single Unit Truck
 Overall Length 30.00ft
 Overall Width 8.00ft
 Overall Body Height 13.50ft
 Min Body Ground Clearance 1.367ft
 Track Width 8.000ft
 Lock-to-lock time 5.00s
 Max Steering Angle (Virtual) 31.80°

GENERAL NOTES

APPLICANT:
 Taz Kahn
 3993 NW Currawong Court
 Camas, WA 98607
 TKahnusa@gmail.com

OWNER:
 Pak USA Camas LLC
 20107 NE 13th Street
 Camas, WA 98607

CIVIL ENGINEER:
 PLS Engineering
 Contact: Travis Johnson, PE
 604 W Evergreen Blvd
 Vancouver, WA 98660
 PH: (360) 944-6519
 pm@plsengineering.com

SITE ADDRESS:
 Parcel # 176148-000
 20101 NE 13TH ST
 Camas, WA 98607

CIRCULATION DISCUSSION:
 This plan shows that a WB-67 truck can enter and exit the site for deliveries. Note that the turning path does not impact access to the gas pumps. This is the largest possible design vehicle. Additionally, a SU-30 truck path is shown circulating the site. This indicates sufficient space on site for deliveries.

Revisions	1	2	3	4	5	6



Project No.	3632
SCALE:	H: 1" = 20' V: N/A
DESIGNED BY:	SWG
DRAFTED BY:	JSV
REVIEWED BY:	TGJ

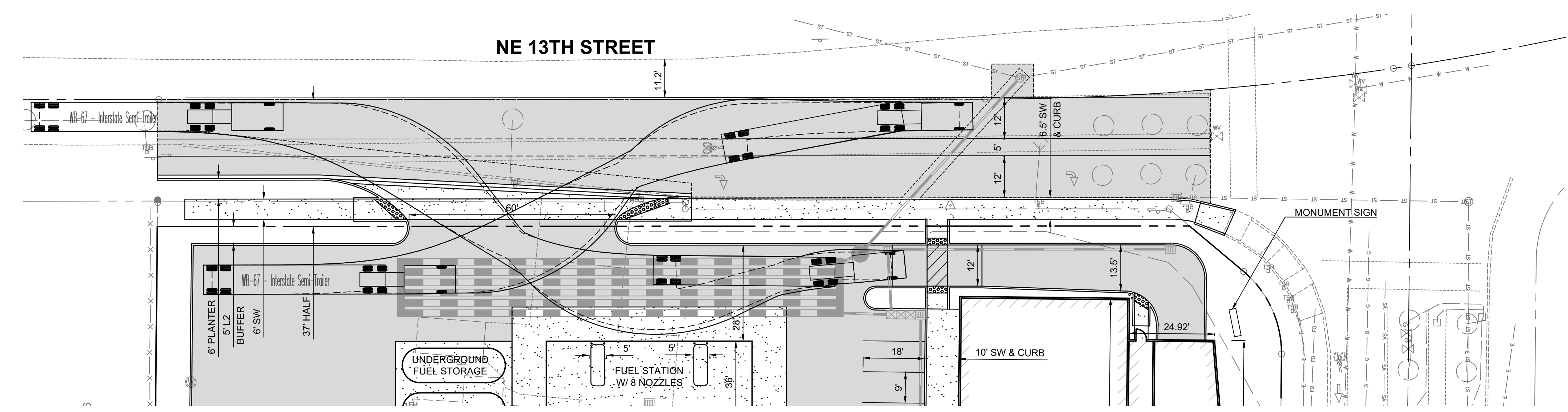

Large Truck Delivery Path

Legend

- Proposed Asphalt Concrete
- Proposed Cement Concrete

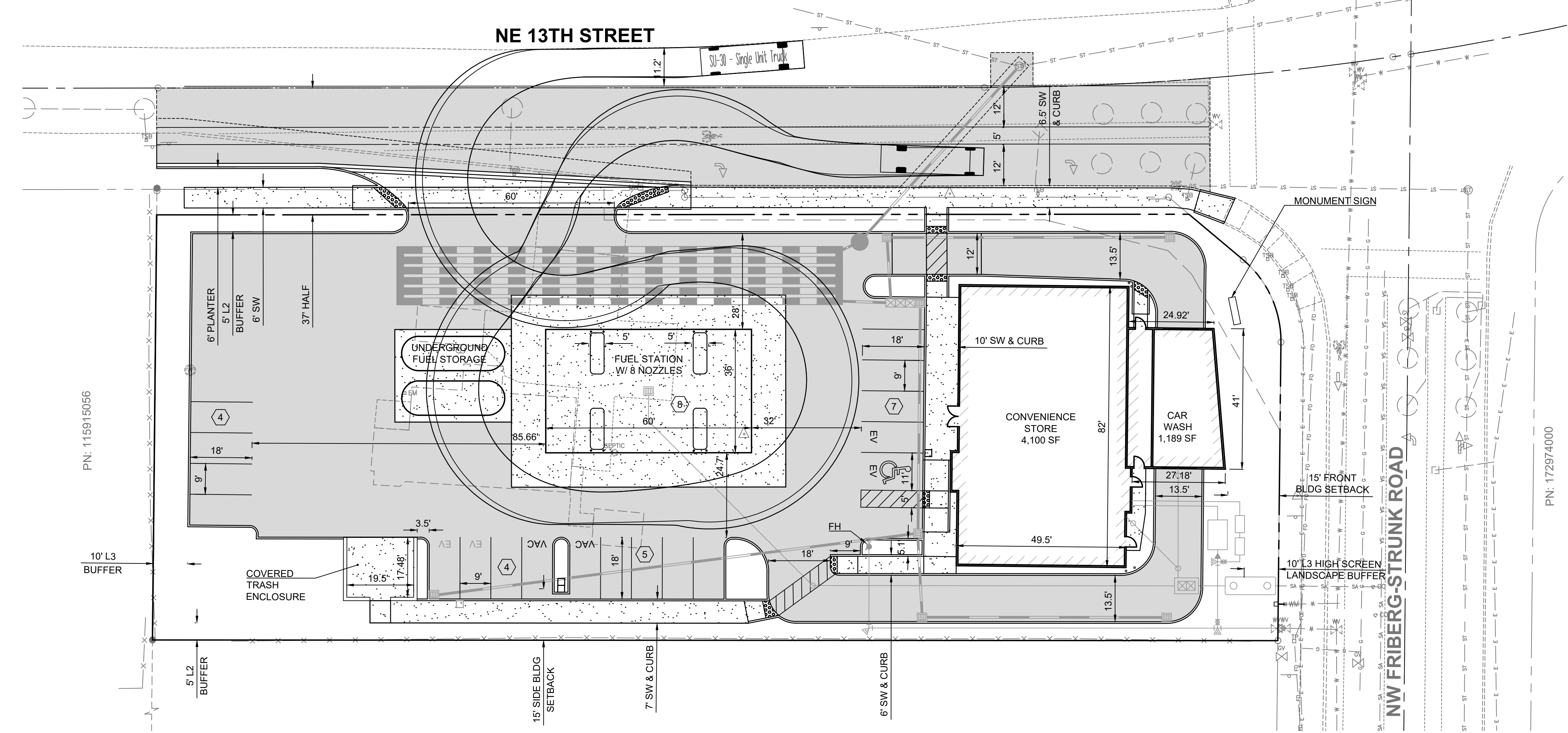
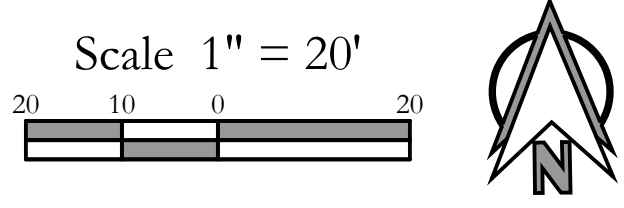

Small Truck Delivery Path