

VICINITY MAP
NOT TO SCALE

Legend	
Proposed Asphalt Concrete	
Proposed Cement Concrete	

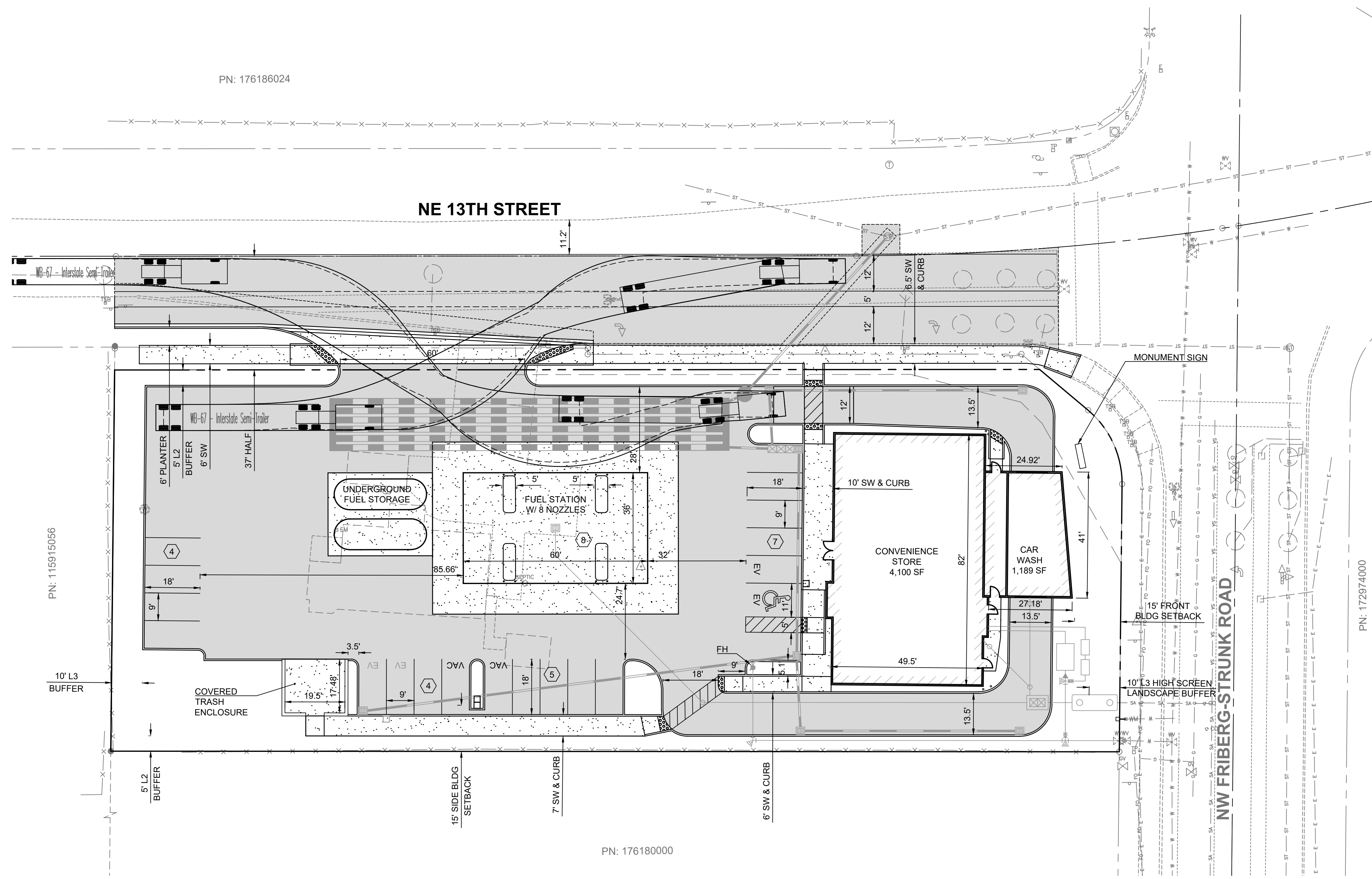
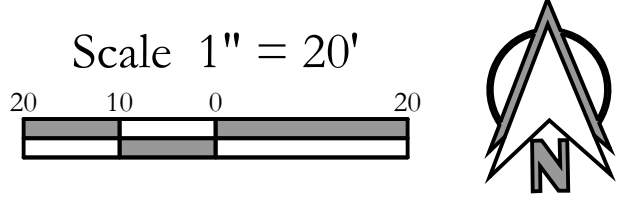

GENERAL NOTES

APPLICANT:
Taz Kahn
3993 NW Currawong Court
Camas, WA 98607
TKahnusa@gmail.com

OWNER:
Pak USA Camas LLC
20107 NE 13th Street
Camas, WA 98607

CIVIL ENGINEER:
PLS Engineering
Contact: Travis Johnson, PE
604 W Evergreen Blvd
Vancouver, WA 98660
PH: (360) 944-6519
pm@plsengineering.com

SITE ADDRESS:
Parcel # 176148-000
20101 NE 13TH ST
Camas, WA 98607

CIRCULATION DISCUSSION:
This plan shows that a WB-67 truck can enter and exit the site for deliveries. Note that the turning path does not impact access to the gas pumps. This is the largest possible design vehicle. Since it can access the site, smaller delivery vehicles can as well.

Preliminary Circulation Plan For:
13th Street Site Plan
A Subdivision Located In The City Of Camas, Washington

Revisions	
No.	Description
1	
2	
3	
4	
5	
6	



Project No. 3632
SCALE: H: 1" = 20'
V: N/A
DESIGNED BY: SWG
DRAFTED BY: JSV
REVIEWED BY: TGJ