

## MINISTER-GLAESER SURVEYING INC.

*Vancouver Office – 2200 E. Evergreen Blvd., Vancouver, Washington 98661  
(360) 694-3313 (360) 694-8410 FAX  
Pasco Office – 6303 Burden Blvd. Suite E, Pasco, Washington 99301  
(509) 544-7802 (509) 544-7862 FAX*

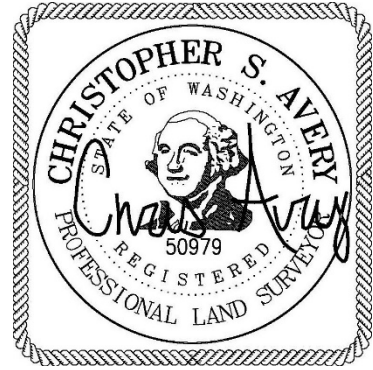

Signed: 11/06/23

### EXHIBIT "A"

#### **GOODWIN 28TH ST ANNEXATION AREA DESCRIPTION:**

An area of land located in a portion of the Northwest quarter and the Northeast quarter of the Southwest quarter of Section 21, Township 2 North, Range 3 East of the Willamette Meridian, and in a portion of the Thomas J. Fletcher Donation Land Claim, in Clark County, Washington, more particularly described as follows;

**COMMENCING** at the Center of said Section 21, according to Survey Book 69, Page 129, records of Clark County Surveyor (ROS 69-129);

Thence North  $88^{\circ}42'39''$  West, along the North line of the Southwest quarter of said Section 21, for a distance of 492.64 feet, to the Northeast corner of the West half of the West half of the East half of the Northeast quarter of said Southwest quarter;

Thence South  $01^{\circ}24'59''$  West, along the East line thereof, for a distance of 30.00 feet to the South right-of-way line of NE 28<sup>th</sup> Street and the **TRUE POINT OF BEGINNING**;

Thence South  $01^{\circ}24'59''$  West, continuing along said East line, for a distance of 1289.34 feet, to the Southeast corner of said West half;

Thence North  $88^{\circ}36'41''$  West, along the South line of the North half of said Southwest quarter of Section 21, for a distance of 1298.70 feet, to a point on the East line of the Thomas J. Fletcher Donation Land Claim (DLC);

Thence North  $01^{\circ}13'48''$  East, along the East line of said DLC, for a distance of 272.07 feet;

Thence North  $65^{\circ}33'34''$  West, along the West line of the Thad & Sally Freese tract according to Deed in Auditors File Number 5821320 and ROS 69-129, for a distance of 180.00 feet, to an angle point;

Thence North  $32^{\circ}24'28''$  West, along the West line of said Freese Tract, for a distance of 385.14 feet, to the South right-of-way line of NE Godwin Road, according to Clark County Road Bin Project 365-A Sheet 3;

Thence the following courses and distances along the South right-of-way line of said NE Godwin Road which transitions to said NE 28<sup>th</sup> Street;

Thence North  $43^{\circ}44'21''$  East, for a distance of 261.33 feet;

Thence along the arc of a tangent 925.00 foot radius curve to the right, the long chord of which bears North  $56^{\circ}44'51''$  East, with a chord distance of 416.42 feet through a central angle of  $26^{\circ}01'00''$ , for an arc distance of 420.02 feet;

Thence North  $69^{\circ}45'21''$  East, for a distance of 355.00 feet;

Thence along the arc of a tangent 925.00 foot radius curve to the right, the long chord of which bears North  $80^{\circ}31'21''$  East, with a chord distance of 345.60 feet through a central angle of  $21^{\circ}32'00''$ , for an arc distance of 347.64 feet;

Thence South  $88^{\circ}42'39''$  East, for a distance of 491.90 feet to the **TRUE POINT OF BEGINNING.**

CONTAINING: 40.43 acres of land.

**BASIS OF BEARINGS:** Survey Book 69, Page 129, records of Clark County Surveyor. Right-of-way determined from modeling Road Bin Project 365-A Sheet 3, and rotating the centerline of the road at the Center of Section 21, onto the North line of the Southwest quarter of Section 21 according to said ROS 69-129.