

LUMINAIRE SCHEDULE

- A POLE MOUNTED LUMINAIRE, 100 WATT HPS LAMP, TYPE 3 DISTRIBUTION, 240 V, HPF, ONE PIECE EXTRUDED ALUMINUM HOUSING, FINISH PER ARCHITECT/OWNER, TEMPERED GLASS LENS. PROVIDE POLE AND BASE, FINISH PER ARCHITECT. (MOUNTING HEIGHT 15' UNLESS SPECIFIED OTHERWISE.)
HOLOPHANE WA-100HP-xxx-x-3 OR APPROVED EQUIVALENT.
POLE: HOLOPHANE NORTH YORKSHIRE NY14C/17-CA/finish OR APPROVED EQUIVALENT.
- C WALL MOUNTED LUMINAIRE, 70 WATT HPS LAMP, 120 VOLT, CUTOFF OPTICS, HPF, WHITE FINISH. MOUNTING HEIGHT 12' UNLESS SPECIFIED OTHERWISE.
LITHONIA TWAC-70S-120 OR APPROVED EQUIVALENT.
- S EXISTING POLE MOUNTED LUMINAIRE.

SHEET LEGEND

- POLE LIGHT - LUMINAIRES AS SHOWN
- LUMINAIRE, WALL-MOUNTED
- A DESIGNATES LUMINAIRE TYPE (SEE LUMINAIRE SCHEDULE)

NOTE: A DASHED LINE (---) INDICATES THE APPROXIMATE 0.5 FOOTCANDLE (FC) LIGHTING LEVEL FROM EACH FIXTURE.

PROJECT:
CAMAS MEADOWS TOWNS

NW CAMAS MEADOWS DR.
CAMAS, WASHINGTON

PREPARED FOR:
TOLL BROTHERS

PREPARED BY:
STANDRIDGE INC.
703 BROADWAY, SUITE 610
VANCOUVER, WA 98660
(360) 597-9240

STAMP:

PROJECT LEAD:

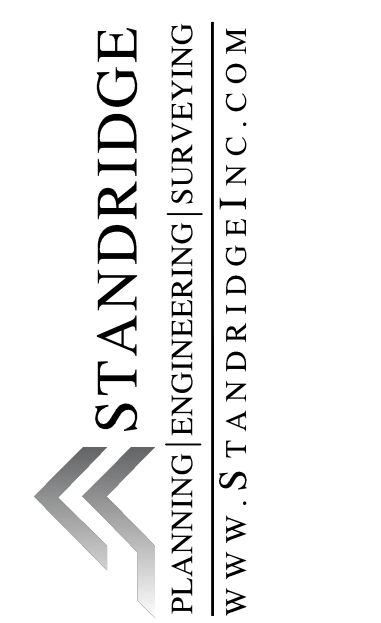

REV. DATE DESCRIPTION

REV.	DATE	DESCRIPTION

PRELIMINARY LIGHTING PLAN

PROJECT NO.: TB1001
DESIGN BY: CDB
REVIEWED BY: LKS
DATE: 7/29/2022

SHEET

C-08

