

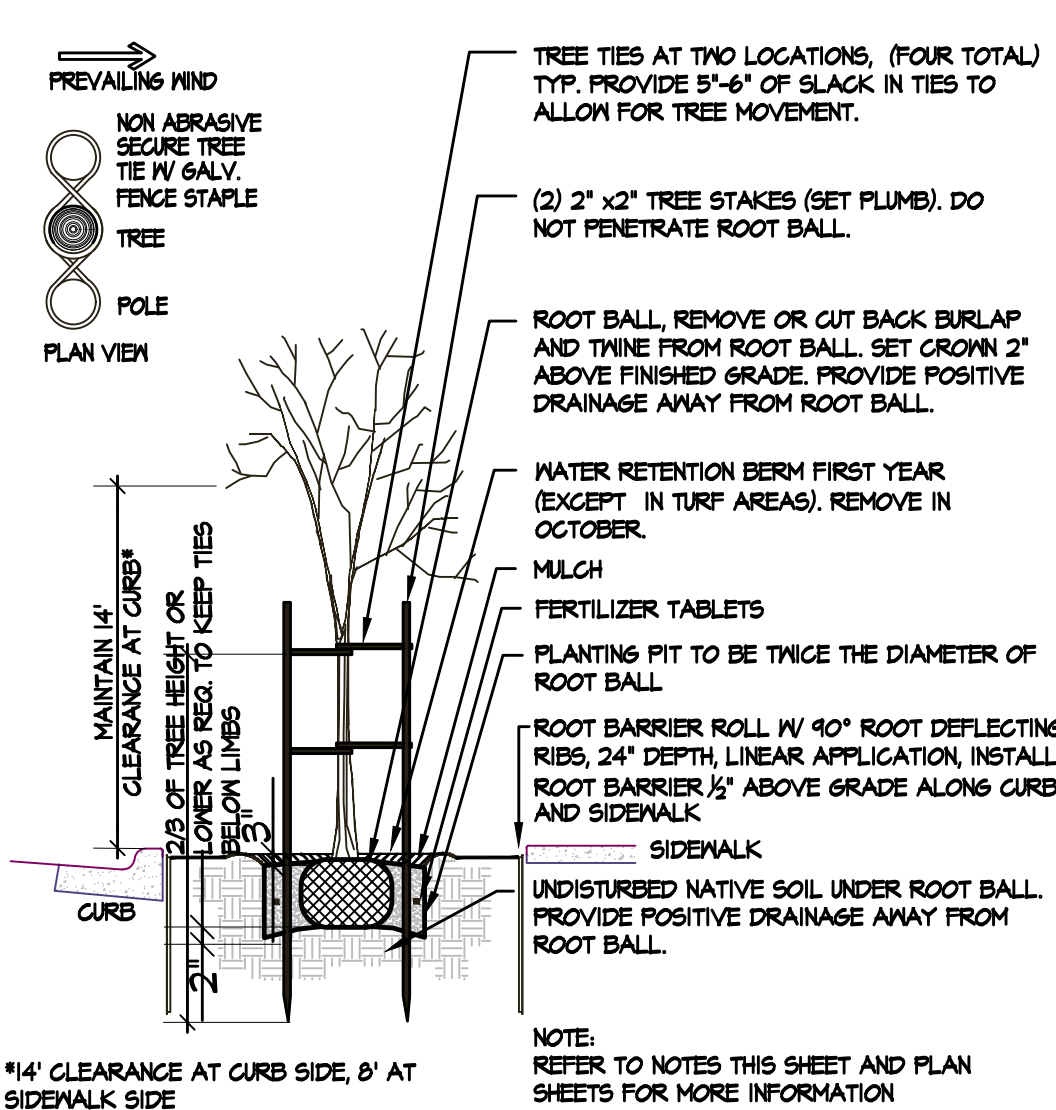

RESERVE AT GREEN MOUNTAIN

2625 NE Goodwin Road
Camas, Washington



A B & B Tree Planting - Street Tree Detail
Not To Scale SECTION / PLAN VIEW

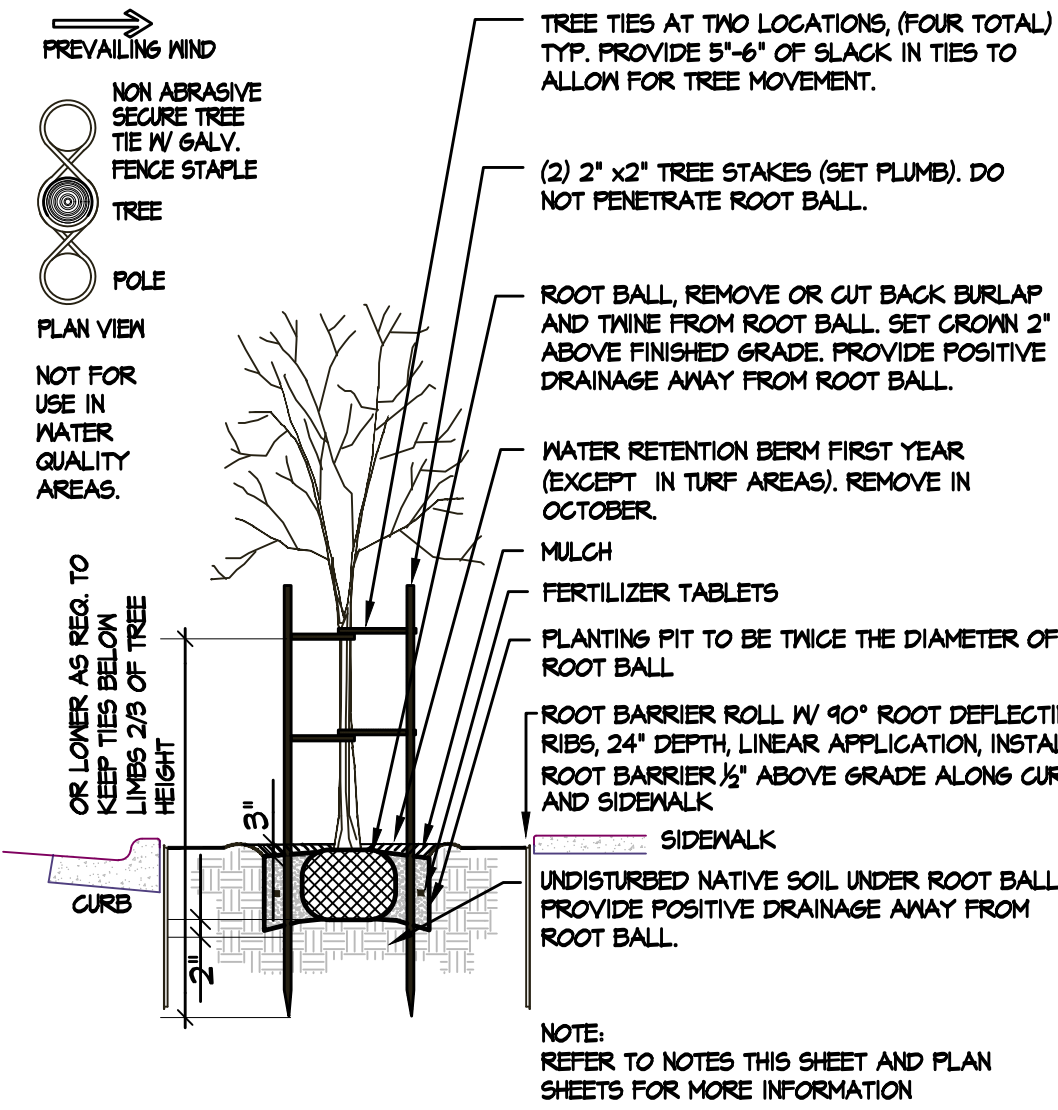

B B & B Tree Planting Detail
Not To Scale SECTION / PLAN VIEW

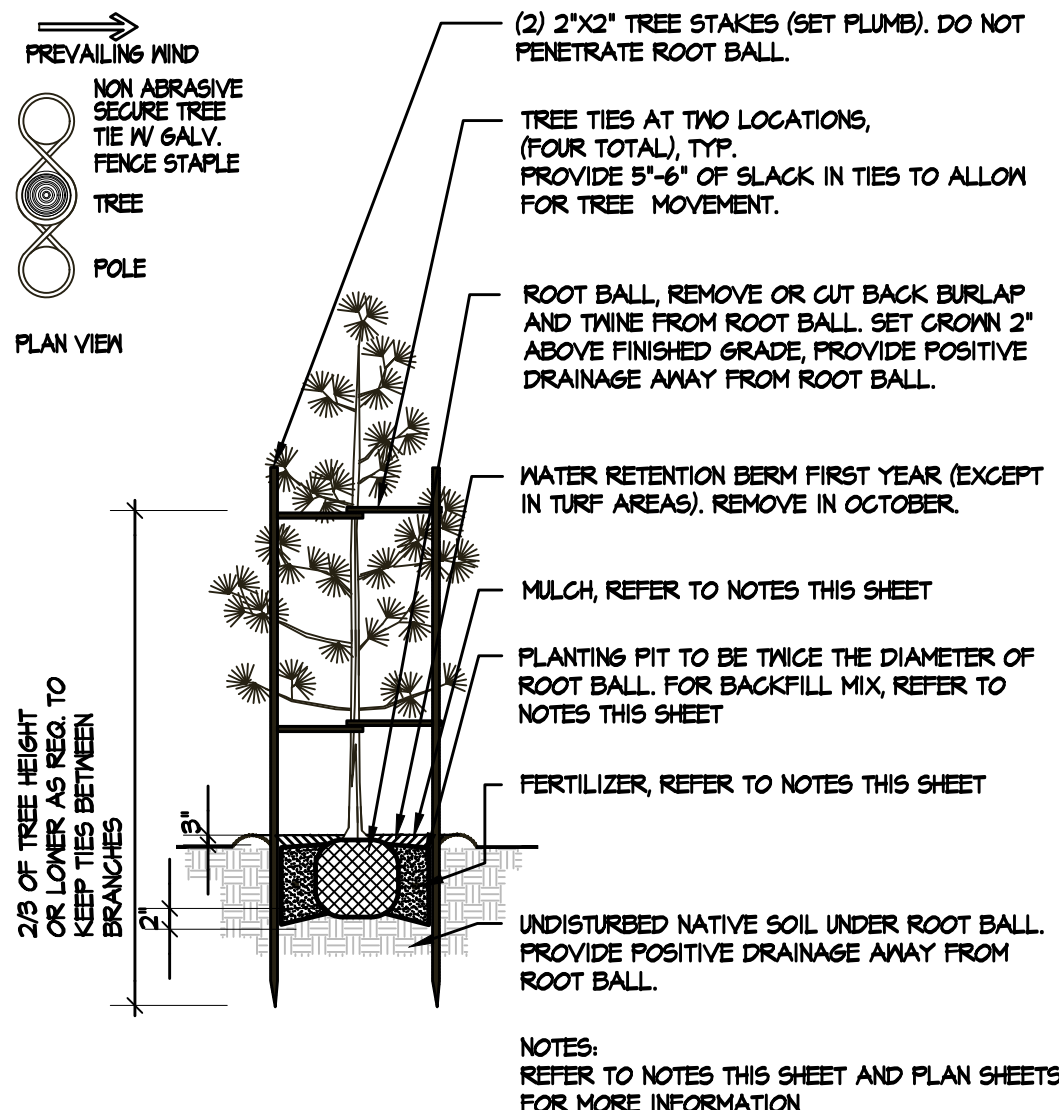

C B & B Tree Planting Detail: Evergreen under 8' Height
Not To Scale SECTION / PLAN VIEW

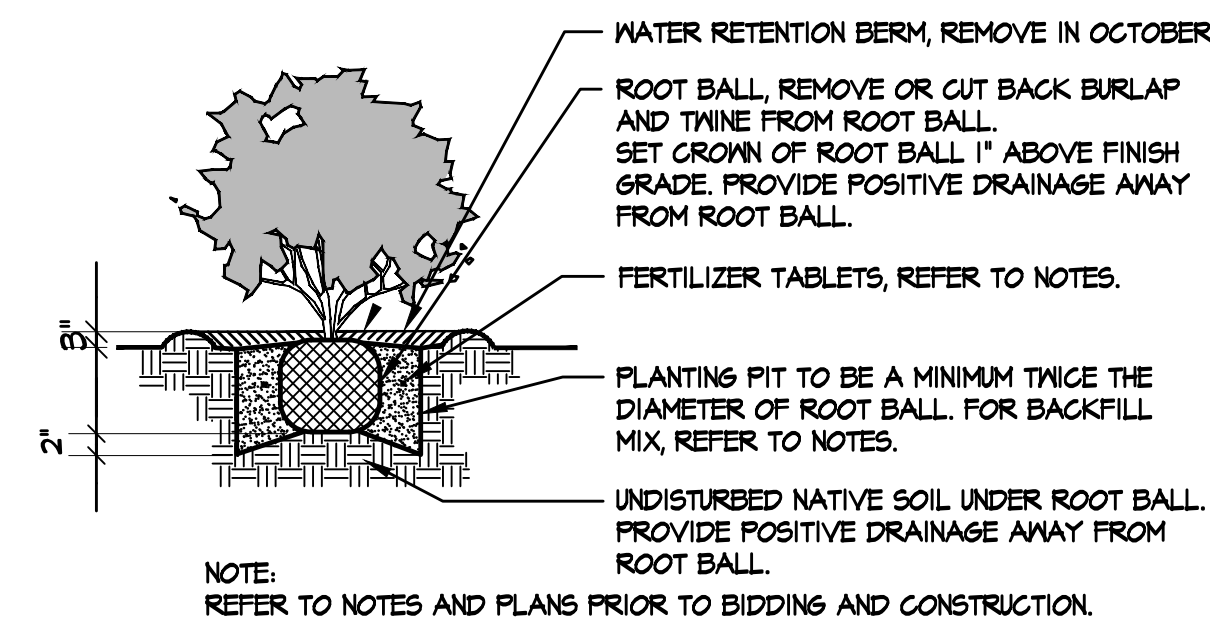

D B & B Shrub Planting Detail
Not To Scale SECTION

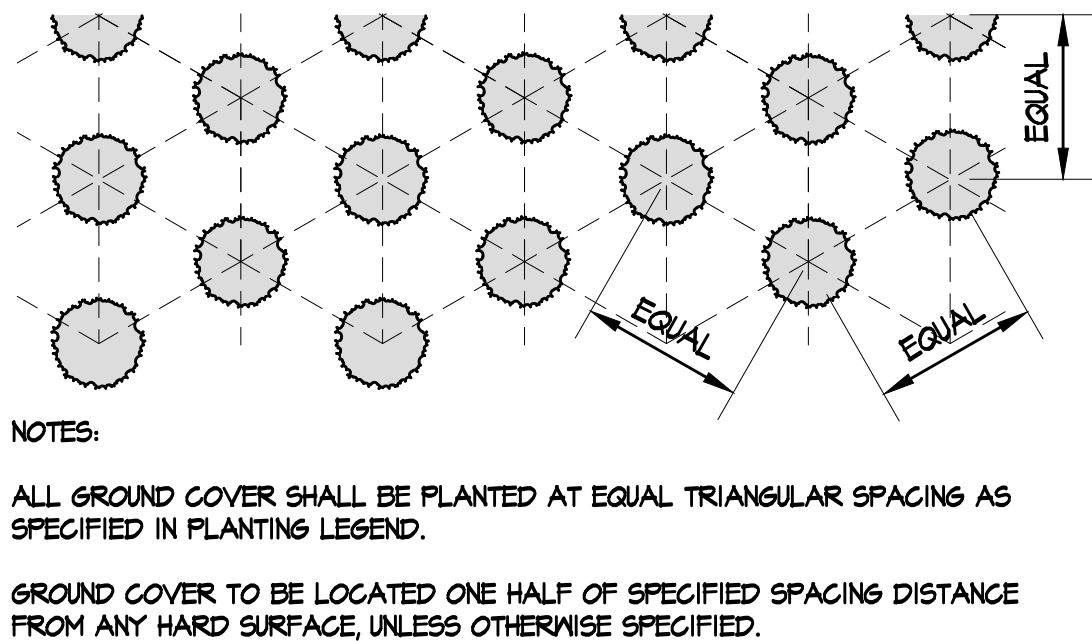

E Ground Cover Planting Detail
Not To Scale PLAN VIEW

PLANTING NOTES

- ALL BOUNDARIES, EASEMENTS, UTILITIES AND LEGAL ENCUMBRANCES TO BE CONFIRMED WITH OWNER PRIOR TO BEGINNING WORK. PROPERTY LINES AND SURVEY INFORMATION PROVIDED BY PLS ENGINEERING.
- IN NO WAY IS THIS PLAN TO BE INTERPRETED TO EXCEED THE LEGAL BOUNDARIES OF THE OWNER'S REAL PROPERTY.
- THE LANDSCAPE DESIGNER ASSUMES NO RESPONSIBILITY FOR THE LOCATION OF BOUNDARIES, UTILITIES AND WETLANDS.
- THIS PLAN SHALL BE INSTALLED TO MEET ALL APPLICABLE CITY, COUNTY, STATE AND FEDERAL CODES.
- THIS PLAN SHALL BE CONSIDERED PRELIMINARY UNTIL APPROVED BY ALL GOVERNING AGENCIES. IMPLEMENTATION OF THIS PLAN SHALL NOT PROCEED UNTIL ISSUANCE OF ALL RELATED PERMITS.
- PLANT QUANTITIES ARE FOR INFORMATION ONLY. IN CASE OF ANY DISCREPANCY, THE PLAN SHALL GOVERN.
- ALL WORK IS TO BE PERFORMED BY LICENSED CONTRACTORS AND EXPERIENCED WORKERS.
- THE CONTRACTOR IS TO VERIFY THE LOCATION OF EXISTING UNDERGROUND UTILITIES AND STRUCTURES PRIOR TO PERFORMING ANY EXCAVATION. CONTRACTOR SHALL REPAIR ANY DAMAGE TO UTILITIES CAUSED BY THE CONTRACTOR'S WORK, AT NO ADDITIONAL COST TO THE OWNER. CONTACT ALL UTILITY PROVIDERS SERVING THE SITE AREA 48 HOURS PRIOR TO ANY EXCAVATION.
- ALL PLANT MATERIALS SHALL MATCH SPECIFICATIONS PER SPECIES AND SHALL COMPLY WITH ANSI Z60.1 'STANDARD FOR NURSERY STOCK'.
- THE CONTRACTOR SHALL ADHERE TO THE WASHINGTON ASSOCIATION OF NURSERYMEN'S GUIDELINES FOR PLANTING PRACTICES.
- THE CONTRACTOR SHALL REPAIR ANY DAMAGE TO EXISTING ELEMENTS ON AND OFF SITE, RESULTING FROM THE CONTRACTOR'S WORK.
- THE CONTRACTOR IS RESPONSIBLE FOR THE VIABILITY OF ALL PLANT MATERIAL FOR 2 YEARS AFTER COMPLETION OF PLANTING. DISEASED, DYING, OR DEAD PLANT MATERIAL SHALL BE REPLACED BY THE CONTRACTOR DURING THE TWO YEAR PERIOD AND MAINTAINED FOR AN ADDITIONAL 2 YEAR PERIOD.
- IMMEDIATELY UPON BID AWARD, CONTRACTOR SHALL SECURE THE PLANT MATERIALS AS SPECIFIED FROM AVAILABLE SOURCES. IN THE EVENT THAT PLANT MATERIALS ARE NOT AVAILABLE, CONTACT LANDSCAPE ARCHITECT FOR APPROVED SUBSTITUTIONS. NO SUBSTITUTION FOR PLANT MATERIAL WILL BE ALLOWED WITHOUT PRIOR WRITTEN APPROVAL OF THE LANDSCAPE ARCHITECT.
- TOP DRESS ALL SHRUB AND GROUND COVER AREAS (NOT LAWN) WITH 3" OF FIR BARK MULCH. SUBMIT SAMPLE TO THE LANDSCAPE ARCHITECT FOR APPROVAL PRIOR TO CONSTRUCTION.
- TREE LOCATIONS MAY BE ADJUSTED IN THE FIELD TO SUIT SITE REQUIREMENTS AS DIRECTED BY THE LANDSCAPE ARCHITECT.
- THE CONTRACTOR SHALL ENSURE THAT ALL EXCAVATED PLANTING PITS HAVE POSITIVE DRAINAGE. PLANT PITS FULLY FLOODED WITH WATER SHALL DRAIN WITHIN (12) HOURS OF FILLING.
- FINISH GRADE SHALL BE SET TO ALLOW POSITIVE DRAINAGE.
- ROTOTILL 2" OF COMPOST INTO ALL PLANTED AREAS.
- INCORPORATE PEAT INTO THE ROOT ZONE OF RHODODENDRONS, AZALEAS AND OTHER ACID LOVING PLANTS.
- INCORPORATE 10-20-20 FERTILIZER INTO THE ROOT ZONE OF ALL NEW PLANTINGS.
- RONSTAR, OR APPROVED EQUAL, PREEMERGENT HERBICIDE TO BE APPLIED TO ALL PLANTED AREAS PER MANUFACTURERS INSTRUCTIONS.
- EXISTING VEGETATION TO BE SPRAYED WITH ROUNDUP, OR APPROVED EQUAL, PER MANUFACTURERS INSTRUCTIONS. SUFFICIENT TIME SHALL BE GIVEN TO ALLOW EXISTING MATERIAL TO DIE. REMOVE EXISTING 2".
- THE PROPERTY OWNER IS RESPONSIBLE FOR MAINTAINING TURF PLANTED WITHIN THE RIGHT OF WAY.
- CROWN LAWN AREAS AND GRADE TO PROVIDE POSITIVE DRAINAGE.
- ROLL LAWN AREA TO INSURE PROPER COMPACTION TO MINIMIZE SETTILING.
- AMEND SOIL IN LAWN AREAS WITH 80 LBS. OF DOLOMITE LIME AND 40 LBS. OF 10-20-20 SLOW RELEASE FERTILIZER OR EQUIVALENT. PROVIDE A 3" LAYER OF SANDY LOAM TOPSOIL FOR LAWN AND BED AREA.
- SEED LAWN AREAS WITH GRASS SEED MANUFACTURER'S RECOMMENDATIONS. COVER SEED WITH FINE MULCH APPLIED WITH ROLLER OR HYDROSEED.
- THE PROPERTY OWNER IS RESPONSIBLE FOR MAINTAINING TURF PLANTED WITHIN THE RIGHT OF WAY.
- PLANT MATERIAL SHALL BE PLANTED 1/4 ROOT CROWN 1" ABOVE FINISHED GRADE TO ALLOW POSITIVE DRAINAGE AWAY FROM CROWN.
- STAKE ALL TREES OVER 6 FT. IN HEIGHT PER DETAILS ON THIS SHEET.
- REFER TO DETAILS FOR ADDITIONAL INFORMATION.
- ALL PLANTING SHALL BE HAND WATERED OR IRRIGATED BY AN AUTOMATIC UNDERGROUND SPRINKLER SYSTEM.
- ALL PLANT MATERIALS FURNISHED ARE TO BE HEALTHY, UNIFORMLY BRANCHED AND WITH WELL DEVELOPED FIBROUS ROOT SYSTEMS.
- ALL PLANT MATERIALS FURNISHED ARE TO BE FREE FROM DEAD OR BROKEN BRANCHES, LICHENS, SCARS, BROKEN BARK OR WOUNDS. ALL PLANT MATERIALS WILL BE INSECT, MITE, AND DISEASE FREE ACCORDING TO THE REQUIREMENTS OF THE WASHINGTON STATE DEPARTMENT OF AGRICULTURE FOR NURSERY PLANT MATERIALS SOLD FOR WHOLESALE OR RETAIL. ALL PRUNING WOUNDS MUST BE WELL HEALED WITH NO EVIDENCE OF DECAY.
- FIELD CONFIRM ALL SITE CONDITIONS, AREAS AND SIZES PRIOR TO BIDDING & CONSTRUCTION. DO NOT SCALE FROM PLANS.

DRAWN: BOP	CHECKED: CB
SCALE: NTS	DATE: 05/16/25
JOB #: 25-1967	
ISSUED FOR: FLR	
REVISIONS:	
△	
△	
△	
△	
△	
△	
SHEET NAME: PLANTING DETAILS	
SHEET #:	
L2	
SHEET 2	of 2