

DATE	NO.	REVISION

DRAWN:	DESIGNED:	CHECKED:
SCALE: AS SHOWN	DATE: AUGUST 2021	
PROJECT NO. E20-093		



FIRWOOD
DESIGN GROUP

399 EAST HISTORIC COLUMBIA RIVER HIGHWAY
TROUTDALE, OREGON 97060
BUS. (503) 668-3737 FAX: (503) 668-3788

DAVID LUGLIANI
16420 SE MCGILLRAY BLVD
VANCOUVER, WA 98683

TREE PRESERVATION & LANDSCAPE PLAN (1) 9
AIRBROOK RV SITE DEVELOPMENT PLAN 13

LEGEND

-  PROPOSED LANDSCAPE TREE 1
-  PROPOSED LANDSCAPE TREE 2

KEY NOTES:

- 1 1 MEDIUM TREE PER 6 PARKING SPACES PER CITY OF CAMAS LANDSCAPING REQUIREMENTS. TREES TO BE PLANTED IN A PARKING ISLAND WITH MIN. SIZE 8' X 8'. THREE TREES FOR 15 PROPOSED PARKING SPACES.

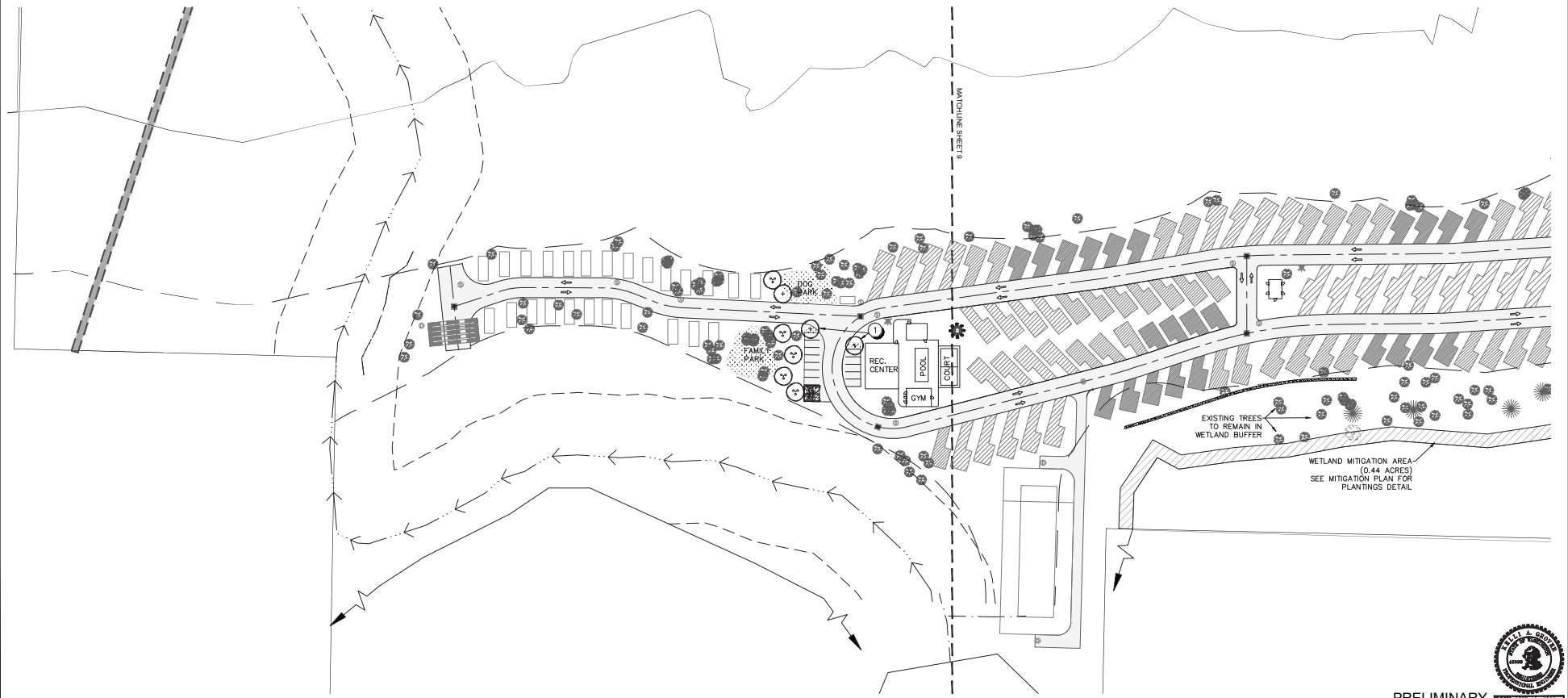
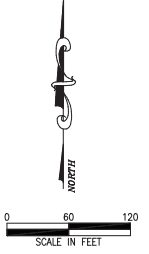

PRELIMINARY

DATE:	NO.	REVISION

DRAWN:	DESIGNED:	CHECKED:
SCALE: AS SHOWN	DATE: AUGUST 2021	
PROJECT NO. E20-093		

FIRWOOD
DESIGN GROUP

359 EAST HISTORIC COLUMBIA RIVER HIGHWAY
TROUTDALE, OREGON 97060
BUS. (503) 668-3737 FAX: (503) 668-3788

DAVID LUGLIANI
16420 SE MCGILLRAY BLVD
VANCOUVER, WA 98683

TREE PRESERVATION & LANDSCAPE PLAN (2)
AIRBROOK RV SITE DEVELOPMENT PLAN